



Lat40°, Inc. 1635 Foxtrail Drive, Suite 325 Loveland, CO 970-776-3321

# CUT & FILL DIAGRAM

STATE ANTELOPE 34-12 PAD

SECTION: 12  
TOWNSHIP: 5N  
RANGE: 62W

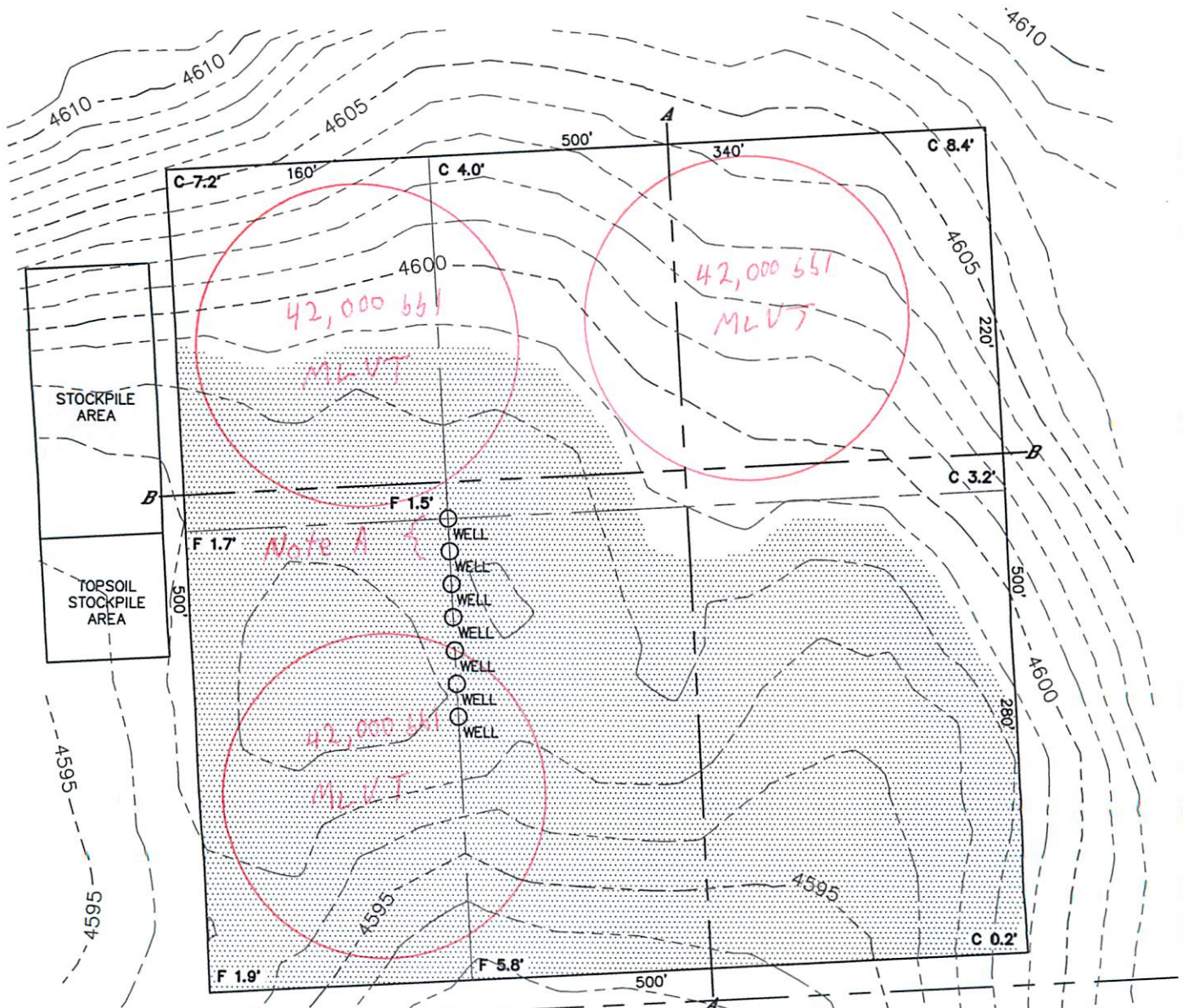

Notes:

A - Only 2 North Well slots will have been drilled when implementing this Plan.

**OPERATOR: BONANZA CREEK ENERGY, INC.**

**LOCATION: 300' FSL, 1924' FEL**

**EXISTING ELEV= 4597.1'**

**PROPOSED ELEV= 4598.6'**

**DISTURBANCE= 6.0 ACRES**

**ESTIMATED EARTHWORK:**

**TOPSOIL= 9,259 CY**

**CUT= 10,409 CY**

**FILL= 10,399 CY**

**EXCESS= 10 CY**

## NOTE:

- 1) Ground elevations are based on an observed GPS elevation (NAVD 1988 DATUM).
- 2) No allowance has been made for soil expansion or compaction
- 3) Proposed elevation does not account for top soil removal.
- 4) Top soil volume assumes 12" depth across entire location.
- 5) Fill slopes 2:1
- 6) Cut slopes 1.5:1

## LEGEND

EX. CONTOUR	---
PRO. CONTOUR	---
FILL AREA	



DATE: 10/29/2012  
PROJECT#: 2012072