

**Garden Creek 21-32H**  
 Sec.8-T11N-R63W  
 Weld County, Colorado

Surface Location			
NAD 1927 (NADCON CONUS) Colorado North 501			
Ground Elevation: 5162.0 Rig@ 5184.0usft (TBD)			
Northing	Easting	Latitude	Longitude
567471.91	2321787.81	40° 53' 7.131 N	104° 20' 10.599 W

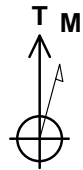
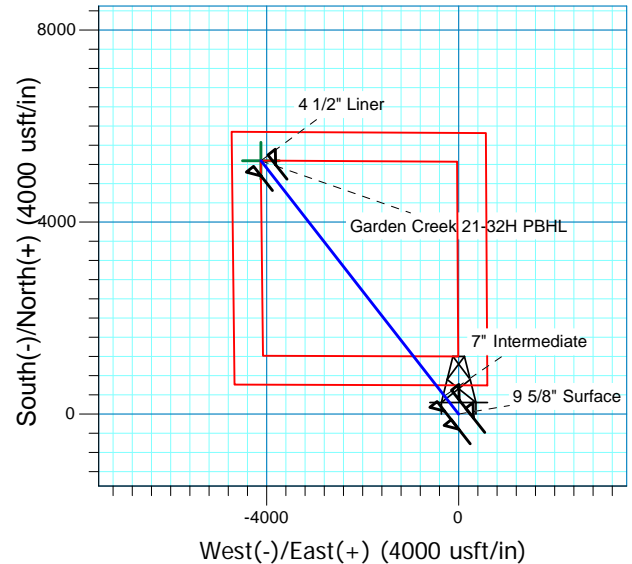
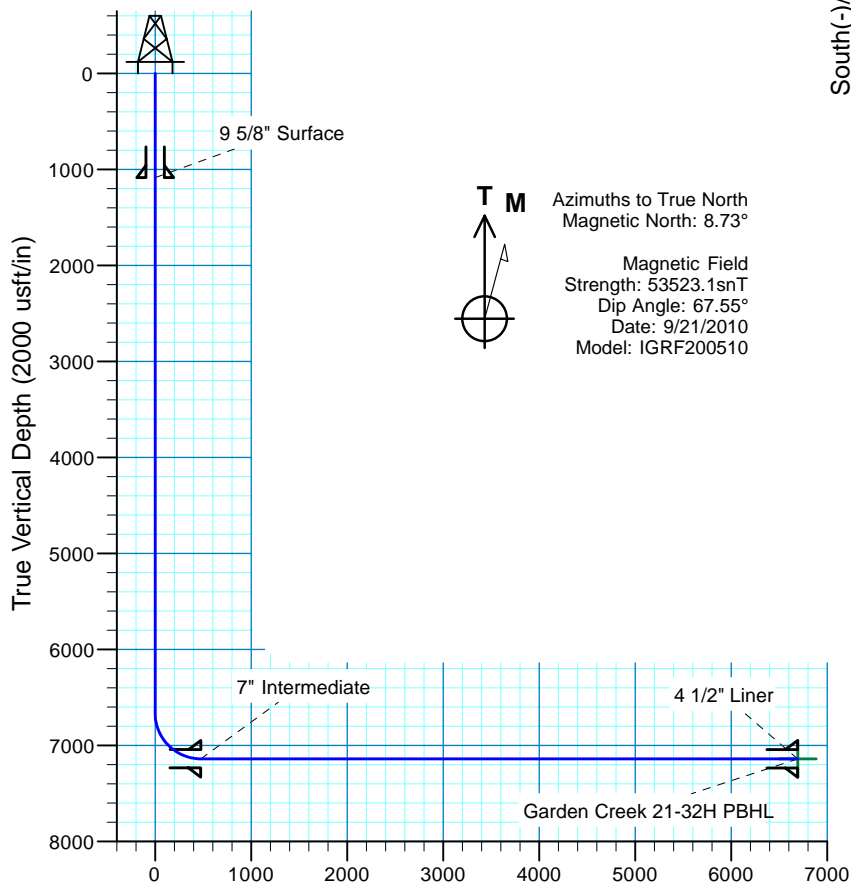

Azimuths to True North  
 Magnetic North: 8.73°  
 Magnetic Field  
 Strength: 53523.1snT  
 Dip Angle: 67.55°  
 Date: 9/21/2010  
 Model: IGRF200510

Project: DJ - Hereford Ranch  
 Site: Garden Creek 21-32H  
 Well: Garden Creek 21-32H  
 Plan: APD Plan (Plat Cert 12/8/14)

Vertical Section at 322.05° (2000 usft/in)

SECTION DETAILS										
Sec	MD	Inc	Azi	TVD	+N/-S	+E/-W	Dleg	TFace	VSect	Target
1	0.0	0.00	0.00	0.0	0.0	0.0	0.00	0.00	0.0	
2	6663.5	0.00	0.00	6663.5	0.0	0.0	0.00	0.00	0.0	
3	7413.5	90.00	322.05	7141.0	376.5	-293.6	12.00	322.05	477.5	Garden Creek 21-32H PBHL
4	13630.8	90.00	322.05	7141.0	5279.4	-4116.7	0.00	0.00	6694.7	Garden Creek 21-32H PBHL
TARGET DETAILS										
Name	TVD	+N/-S	+E/-W	Northing	Easting	Latitude	Longitude	Shape		
Garden Creek 21-32H (Landing Target)	7141.0	1221.0	-426.1	568687.22	2321345.76	40° 53' 19.195 N	104° 20' 16.146 W	Point		
Garden Creek 21-32H PBHL	7141.0	5279.4	-4116.7	572696.88	2317602.20	40° 53' 59.292 N	104° 21' 4.205 W	Point		