

DALEY LAND SURVEYING, INC.

PARKER, CO. 80134

303 953 9841

EXISTING CONTOURS SCHAEFER 24-3-7HC WELL PAD

SECTION 24, TOWNSHIP 1 SOUTH, RANGE 67 WEST OF THE 6TH P.M.

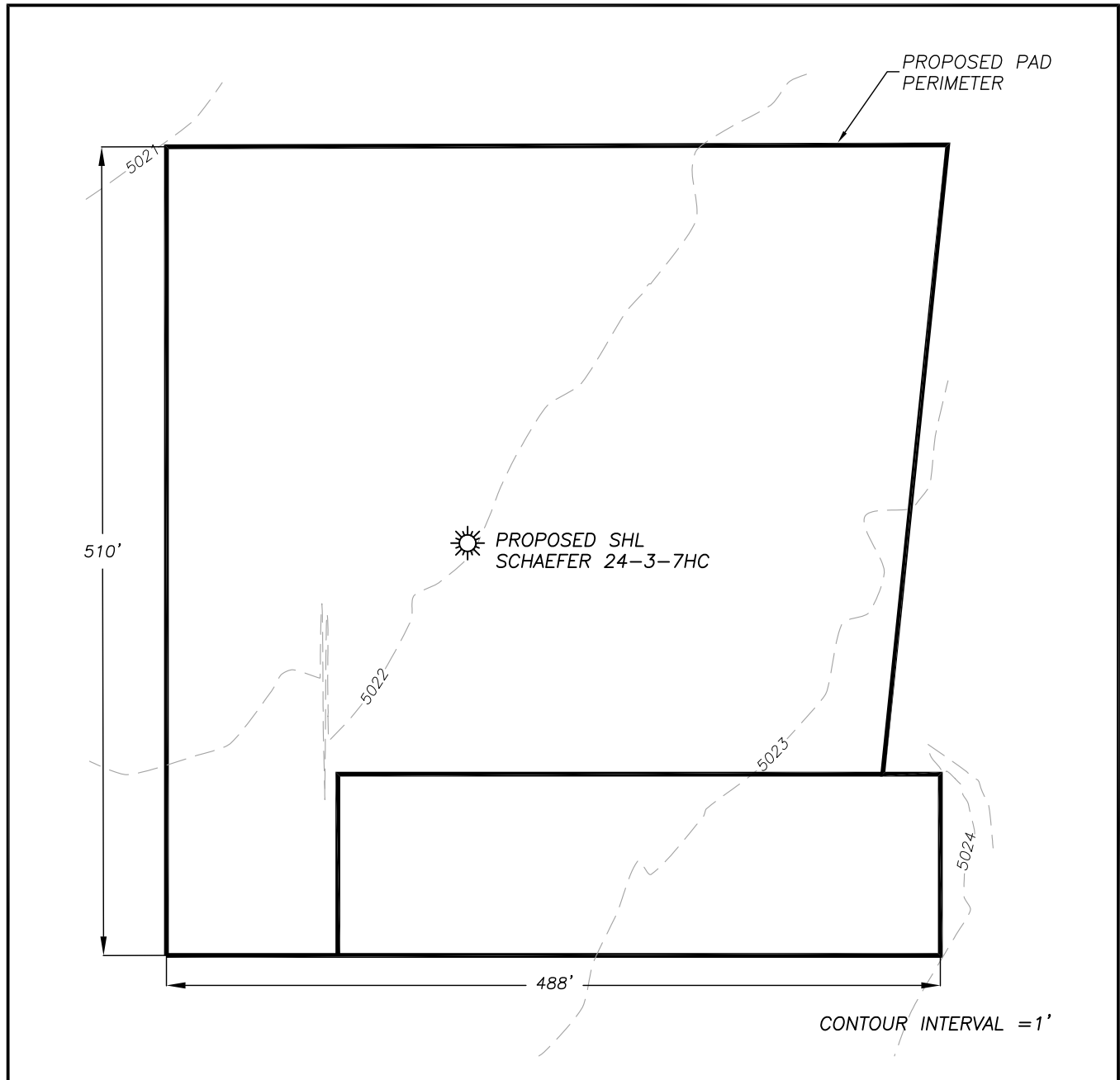

0 100
SCALE: 1" = 100'

PROPOSED PAD CONTOURS

SCHAEFER 24-3-7HC WELL PAD

SECTION 24, TOWNSHIP 1 SOUTH, RANGE 67 WEST OF THE 6TH P.M.

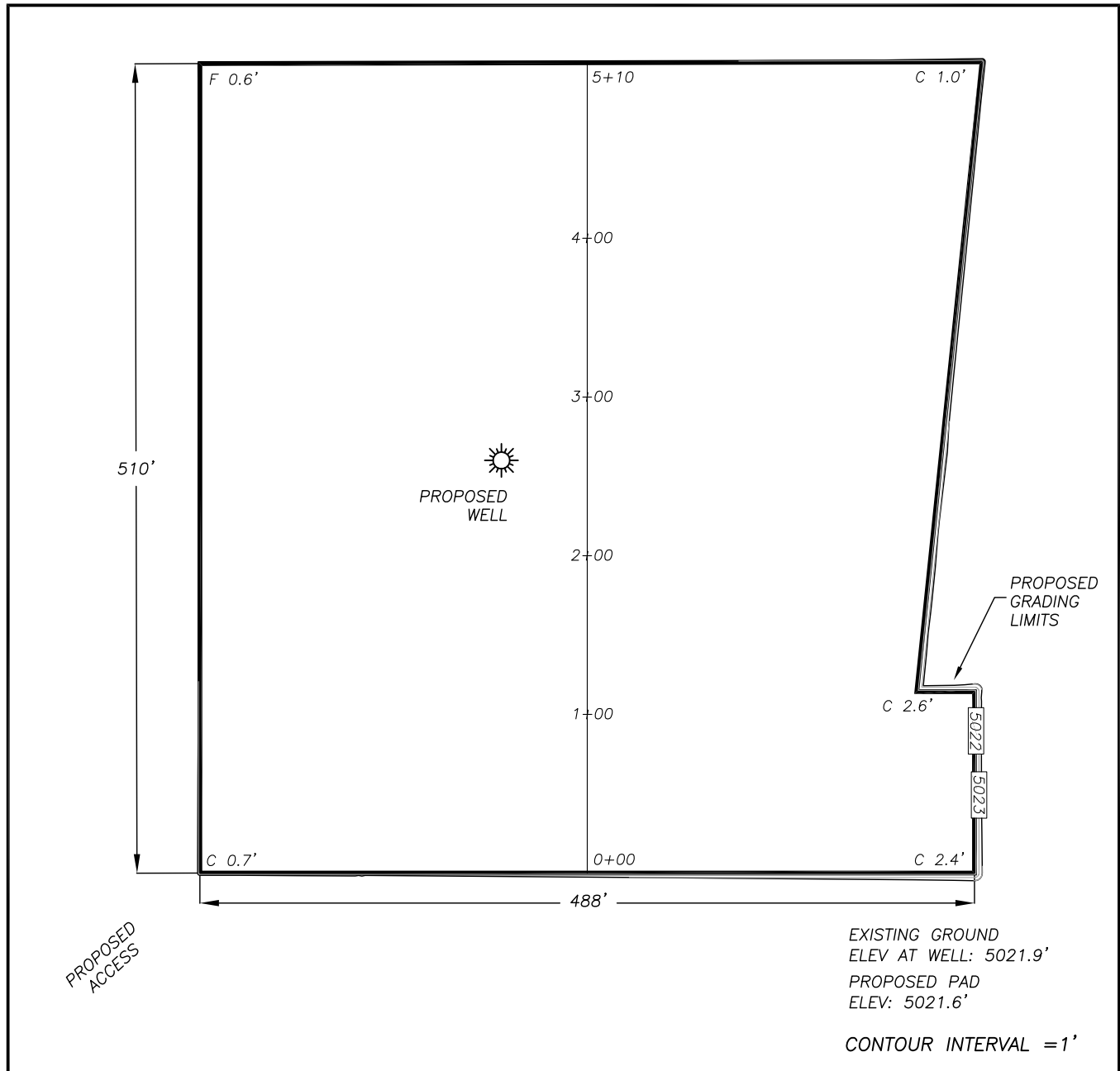

PROPOSED PAD

Top of pad elevation: 5080.2'
Cut slope ratio: 2.0
Fill slope ratio: 2.0
Cut Swell Factor: 1.00
Fill Shrink Factor: 1.00

PAD EARTHWORK VOLUMES

Total cut: 6266± C.Y.
Total fill: 216± C.Y.
Balance Export: 6050± C.Y.
(8" Topsoil)
Area: 5.7 Acres

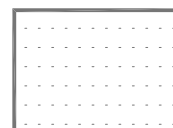

AREA OF
PROPOSED CUT

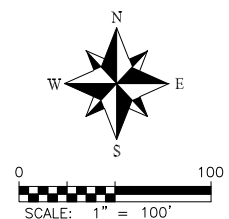

PROPOSED PAD CROSS SECTIONS SCHAEFER 24-3-7HC WELL PAD

SECTION 24, TOWNSHIP 1 SOUTH, RANGE 67 WEST OF THE 6TH P.M.

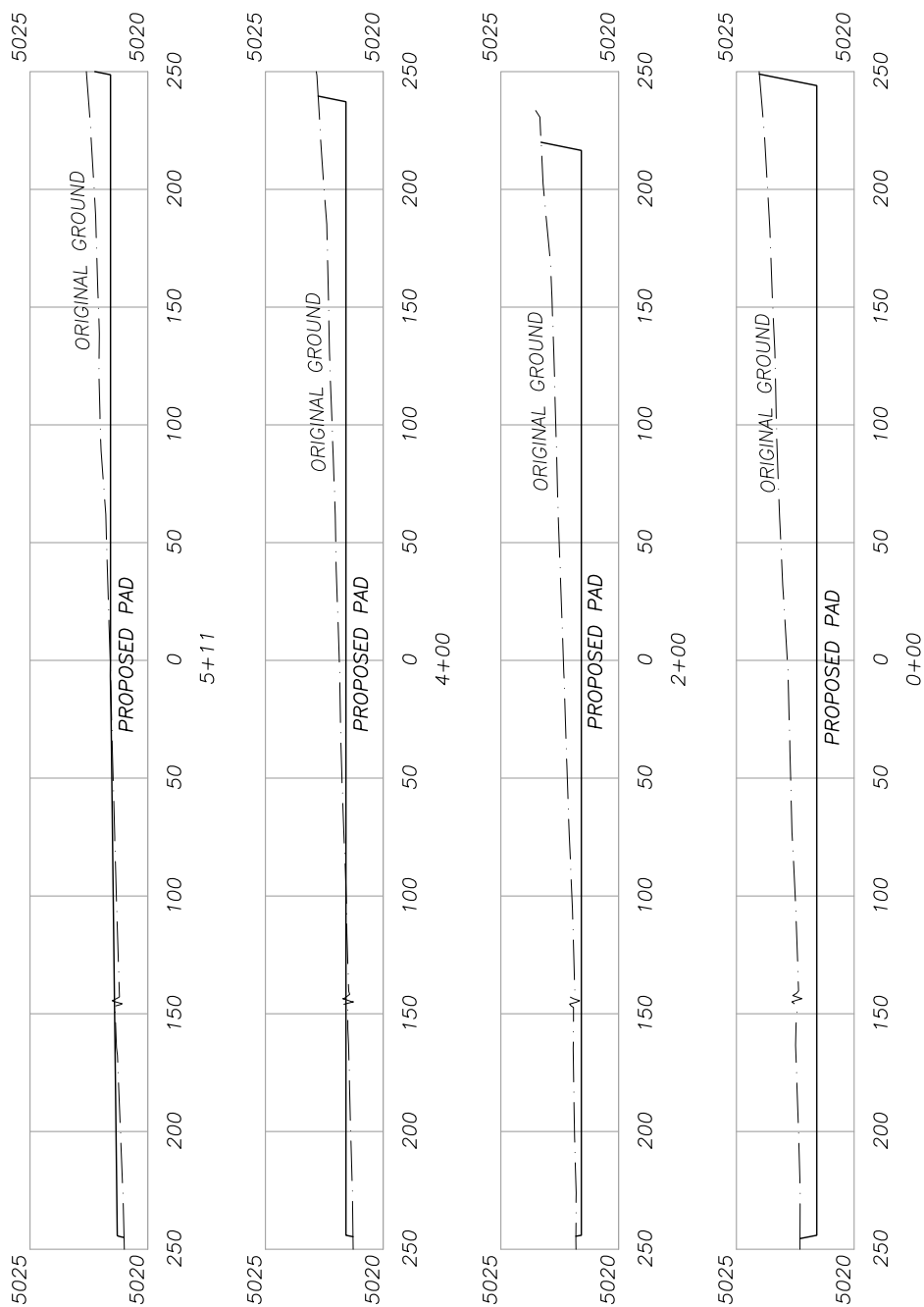

Horizontal Scale 50
Vertical Scale 5

PROPOSED RIG LAYOUT SCHAEFER 24-3-7HC WELL PAD

SECTION 24, TOWNSHIP 1 SOUTH, RANGE 67 WEST OF THE 6TH P.M.

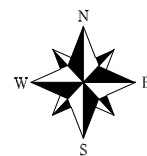
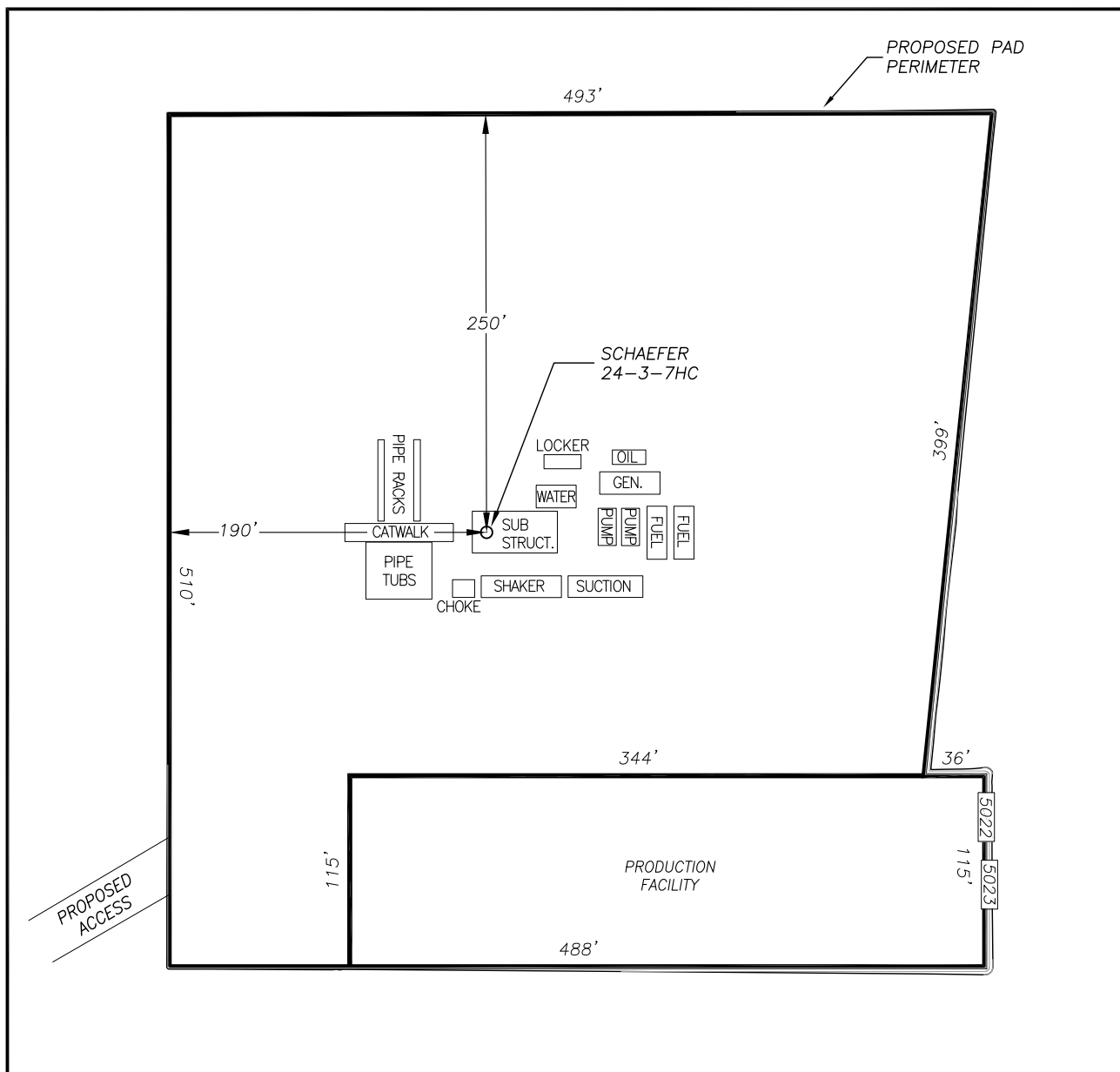

0 100
SCALE: 1" = 100'

PROPOSED PRODUCTION FACILITY
SCHAEFER 24-3-7HC WELL PAD

SECTION 24, TOWNSHIP 1 SOUTH, RANGE 67 WEST OF THE 6TH P.M.

