



Physical Address: 345 Comanche St.
Mail to: Box 384, Kiowa, CO 80117
Ph. 303-621-8672 - Fax 303-621-7749
www.highprairiesurvey.com

Job # 14387-Bogenhagen #1 (Re-Entry)

Inv # 3562

High Prairie Surveying of Kiowa, Colorado, in accordance with a request from **Pronghorn Operating LLC**, has determined the location of **Bogenhagen #1 (Re-Entry)** to be **658 feet FSL**, and **1977 feet FWL**, (90° off Section lines) of **SECTION 31**, Township **14s**, Range **46w** of the 6th Principal Meridian, **Cheyenne County**, Colorado.

Date: Staked on 11/14/14 drawn on 11/24/14.

Re: Staked by Elijah Frane
Drawn: Drawn by Elijah Frane

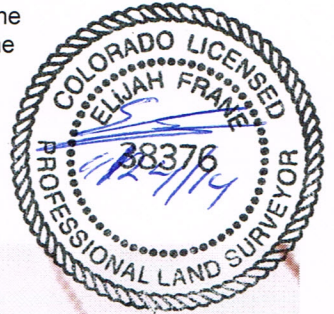

1000' Hydrology Map

There are no apparent surface water areas or riparian areas within 1000' of proposed well pad.

PRONGHORN OPERATING
SE 1/4 SEC. 31-14S-46W
BOGENHAGEN #1 (RE-ENTRY)
CHEYENNE Co, COLORADO

