

ANNOTATIONS

TVD	MD	Inc	Azi	+N/-S	+E/-W	Vsect	Departure	Annotation
200.00	200.00	0.00	0.00	0.00	0.00	0.00	14.53	Start Build 1.50
532.90	533.32	5.00	178.71	-14.53	0.33	14.53	739.11	Hold 5° Inc, 178.71° Az
8815.00	8847.06	5.00	178.71	-738.92	16.61	739.11	1492.56	KOP 8°/100
9467.66	9949.56	93.20	178.71	-1492.18	33.62	1492.56	5500.00	Landing Pt 93.2° Inc
9243.61	13963.26	93.20	178.71	-5498.60	124.14	5500.00	5585.40	Begin 2°/100 Drop
9240.11	14048.73	91.49	178.71	-5583.97	126.06	5585.40	10473.42	Hold 91.49° Inc
9112.91	18938.41	91.49	178.71	-10470.75	236.47	10473.42	10473.42	End of Completions
9110.00	19050.36	91.49	178.71	-10582.63	239.00	10585.33	10585.33	TD at 19050.36

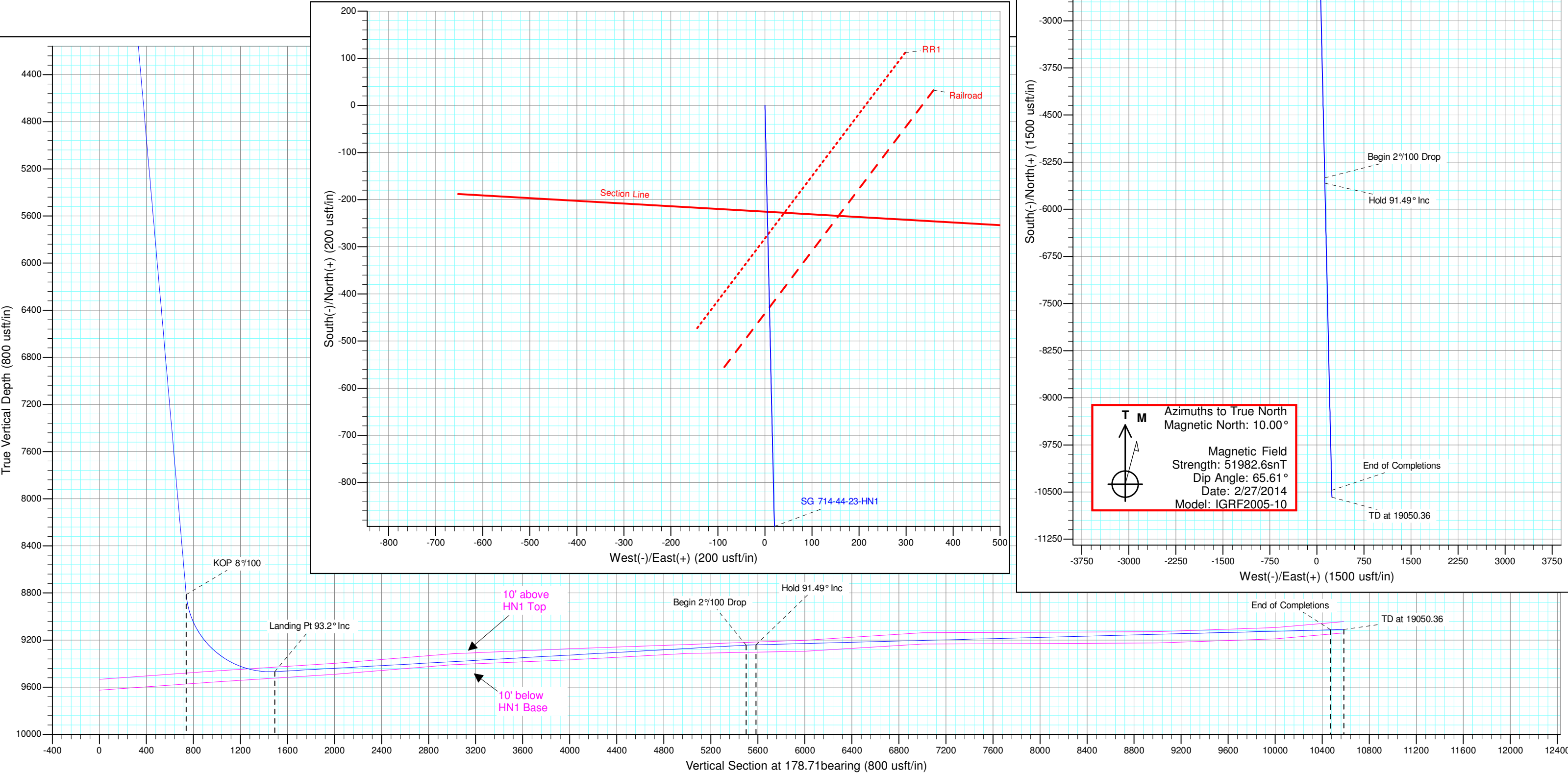



## **PICEANCE VLY NAD 83**

**SG 22-07S-096W**

**Nolte 14-44 Pad**

**SG 714-44-23-HN1 - Slot B11**

**Wellbore #1**

**Plan: Plan #6 19Nov14 kjs**

## **Standard Plan - Geographic with VS**

**19 November, 2014**



**WPX**  
Standard Plan - Geographic with VS

<b>Company:</b>	PICEANCE VLY NAD 83			<b>Local Co-ordinate Reference:</b>	Well SG 714-44-23-HN1 - Slot B11
<b>Project:</b>	SG 22-07S-096W			<b>TVD Reference:</b>	WELL @ 5128.00usft (Original Well Elev)
<b>Site:</b>	Nolte 14-44 Pad			<b>MD Reference:</b>	WELL @ 5128.00usft (Original Well Elev)
<b>Well:</b>	SG 714-44-23-HN1			<b>North Reference:</b>	True
<b>Wellbore:</b>	Wellbore #1			<b>Survey Calculation Method:</b>	Minimum Curvature
<b>Design:</b>	Plan #6 19Nov14 kjs			<b>Database:</b>	COMPASS-PICEANCE

<b>Project</b>	SG 22-07S-096W				
<b>Map System:</b>	US State Plane 1983		<b>System Datum:</b>	Mean Sea Level	
<b>Geo Datum:</b>	North American Datum 1983				
<b>Map Zone:</b>	Colorado Central Zone			Using geodetic scale factor	

<b>Site</b>	Nolte 14-44 Pad				
<b>Site Position:</b>		<b>Northing:</b>	1,592,215.40 usft	<b>Latitude:</b>	39.43120
<b>From:</b>	Map	<b>Easting:</b>	2,273,979.20 usft	<b>Longitude:</b>	-108.07069
<b>Position Uncertainty:</b>	0.00 usft	<b>Slot Radius:</b>	13.200 in	<b>Grid Convergence:</b>	-1.62 °

<b>Well</b>	SG 714-44-23-HN1 - Slot B11					
<b>Well Position</b>	<b>+N/-S</b>	0.00 usft	<b>Northing:</b>	1,592,106.26 usft	<b>Latitude:</b>	39.43090
	<b>+E/-W</b>	0.00 usft	<b>Easting:</b>	2,273,975.81 usft	<b>Longitude:</b>	-108.07069
<b>Position Uncertainty</b>		0.00 usft	<b>Wellhead Elevation:</b>	0.00 usft	<b>Ground Level:</b>	5,095.00 usft

<b>Wellbore</b>	Wellbore #1				
<b>Magnetics</b>	<b>Model Name</b>	<b>Sample Date</b>	<b>Declination (°)</b>	<b>Dip Angle (°)</b>	<b>Field Strength (nT)</b>
	IGRF2005-10	2/27/2014	10.00	65.61	51,983

<b>Design</b>	Plan #6 19Nov14 kjs				
<b>Audit Notes:</b>					
<b>Version:</b>	<b>Phase:</b>	PLAN	<b>Tie On Depth:</b>	0.00	
<b>Vertical Section:</b>	<b>Depth From (TVD) (usft)</b>	<b>+N/-S (usft)</b>	<b>+E/-W (usft)</b>	<b>Direction (bearing)</b>	
	0.00	0.00	0.00	178.71	

<b>Survey Tool Program</b>	<b>Date</b>	11/19/2014			
<b>From (usft)</b>	<b>To (usft)</b>	<b>Survey (Wellbore)</b>	<b>Tool Name</b>	<b>Description</b>	
0.00	19,050.35	Plan #6 19Nov14 kjs (Wellbore #1)	MWD	MWD - Standard	



**WPX**  
Standard Plan - Geographic with VS

<b>Company:</b>	PICEANCE VLY NAD 83	<b>Local Co-ordinate Reference:</b>	Well SG 714-44-23-HN1 - Slot B11
<b>Project:</b>	SG 22-07S-096W	<b>TVD Reference:</b>	WELL @ 5128.00usft (Original Well Elev)
<b>Site:</b>	Nolte 14-44 Pad	<b>MD Reference:</b>	WELL @ 5128.00usft (Original Well Elev)
<b>Well:</b>	SG 714-44-23-HN1	<b>North Reference:</b>	True
<b>Wellbore:</b>	Wellbore #1	<b>Survey Calculation Method:</b>	Minimum Curvature
<b>Design:</b>	Plan #6 19Nov14 kjs	<b>Database:</b>	COMPASS-PICEANCE

Planned Survey										
MD (usft)	Inc (°)	Azi (azimuth) (bearing)	TVD (usft)	N/S (usft)	E/W (usft)	V. Sec (usft)	Northing (usft)	Easting (usft)	Latitude (°)	Longitude (°)
0.00	0.00	0.00	0.00	0.00	0.00	0.00	1,592,106.26	2,273,975.81	39.43	-108.07
200.00	0.00	0.00	200.00	0.00	0.00	0.00	1,592,106.26	2,273,975.81	39.43	-108.07
<b>Start Build 1.50</b>										
400.00	3.00	178.71	399.91	-5.23	0.12	5.23	1,592,101.03	2,273,975.78	39.43	-108.07
533.32	5.00	178.71	532.90	-14.53	0.33	14.53	1,592,091.73	2,273,975.73	39.43	-108.07
<b>Hold 5° Inc, 178.71° Az</b>										
600.00	5.00	178.71	599.32	-20.34	0.46	20.35	1,592,085.92	2,273,975.69	39.43	-108.07
800.00	5.00	178.71	798.56	-37.77	0.85	37.78	1,592,068.49	2,273,975.59	39.43	-108.07
1,000.00	5.00	178.71	997.80	-55.19	1.24	55.21	1,592,051.06	2,273,975.49	39.43	-108.07
1,200.00	5.00	178.71	1,197.04	-72.62	1.63	72.64	1,592,033.63	2,273,975.39	39.43	-108.07
1,400.00	5.00	178.71	1,396.28	-90.05	2.02	90.07	1,592,016.20	2,273,975.29	39.43	-108.07
1,600.00	5.00	178.71	1,595.52	-107.47	2.42	107.50	1,591,998.77	2,273,975.19	39.43	-108.07
1,710.30	5.00	178.71	1,705.40	-117.08	2.63	117.11	1,591,989.16	2,273,975.13	39.43	-108.07
<b>Base Fort Union</b>										
1,800.00	5.00	178.71	1,794.76	-124.90	2.81	124.93	1,591,981.34	2,273,975.09	39.43	-108.07
1,865.49	5.00	178.71	1,860.00	-130.60	2.94	130.64	1,591,975.63	2,273,975.05	39.43	-108.07
<b>13 3/8"</b>										
2,000.00	5.00	178.71	1,994.00	-142.32	3.20	142.36	1,591,963.91	2,273,974.98	39.43	-108.07
2,200.00	5.00	178.71	2,193.24	-159.75	3.59	159.79	1,591,946.48	2,273,974.88	39.43	-108.07
2,400.00	5.00	178.71	2,392.47	-177.18	3.98	177.22	1,591,929.05	2,273,974.78	39.43	-108.07
2,600.00	5.00	178.71	2,591.71	-194.60	4.37	194.65	1,591,911.62	2,273,974.68	39.43	-108.07
2,610.64	5.00	178.71	2,602.32	-195.53	4.39	195.58	1,591,910.69	2,273,974.67	39.43	-108.07
<b>Mesaverde</b>										
2,800.00	5.00	178.71	2,790.95	-212.03	4.77	212.08	1,591,894.19	2,273,974.58	39.43	-108.07
3,000.00	5.00	178.71	2,990.19	-229.46	5.16	229.51	1,591,876.76	2,273,974.48	39.43	-108.07
3,200.00	5.00	178.71	3,189.43	-246.88	5.55	246.94	1,591,859.33	2,273,974.37	39.43	-108.07
3,400.00	5.00	178.71	3,388.67	-264.31	5.94	264.38	1,591,841.90	2,273,974.27	39.43	-108.07
3,600.00	5.00	178.71	3,587.91	-281.73	6.33	281.81	1,591,824.47	2,273,974.17	39.43	-108.07



WPX

Standard Plan - Geographic with VS

<b>Company:</b>	PICEANCE VLY NAD 83	<b>Local Co-ordinate Reference:</b>	Well SG 714-44-23-HN1 - Slot B11
<b>Project:</b>	SG 22-07S-096W	<b>TVD Reference:</b>	WELL @ 5128.00usft (Original Well Elev)
<b>Site:</b>	Nolte 14-44 Pad	<b>MD Reference:</b>	WELL @ 5128.00usft (Original Well Elev)
<b>Well:</b>	SG 714-44-23-HN1	<b>North Reference:</b>	True
<b>Wellbore:</b>	Wellbore #1	<b>Survey Calculation Method:</b>	Minimum Curvature
<b>Design:</b>	Plan #6 19Nov14 kjs	<b>Database:</b>	COMPASS-PICEANCE

Planned Survey										
MD (usft)	Inc (°)	Azi (azimuth) (bearing)	TVD (usft)	N/S (usft)	E/W (usft)	V. Sec (usft)	Northing (usft)	Easting (usft)	Latitude (°)	Longitude (°)
3,800.00	5.00	178.71	3,787.15	-299.16	6.72	299.24	1,591,807.04	2,273,974.07	39.43	-108.07
3,963.16	5.00	178.71	3,949.68	-313.38	7.04	313.46	1,591,792.82	2,273,973.99	39.43	-108.07
Approx. Top Gas										
4,000.00	5.00	178.71	3,986.39	-316.59	7.12	316.67	1,591,789.61	2,273,973.97	39.43	-108.07
4,200.00	5.00	178.71	4,185.63	-334.01	7.51	334.10	1,591,772.18	2,273,973.87	39.43	-108.07
4,400.00	5.00	178.71	4,384.86	-351.44	7.90	351.53	1,591,754.75	2,273,973.77	39.43	-108.07
4,600.00	5.00	178.71	4,584.10	-368.87	8.29	368.96	1,591,737.32	2,273,973.66	39.43	-108.07
4,800.00	5.00	178.71	4,783.34	-386.29	8.68	386.39	1,591,719.90	2,273,973.56	39.43	-108.07
5,000.00	5.00	178.71	4,982.58	-403.72	9.07	403.82	1,591,702.47	2,273,973.46	39.43	-108.07
5,004.55	5.00	178.71	4,987.12	-404.12	9.08	404.22	1,591,702.07	2,273,973.46	39.43	-108.07
Cameo Coals										
5,200.00	5.00	178.71	5,181.82	-421.14	9.47	421.25	1,591,685.04	2,273,973.36	39.43	-108.07
5,400.00	5.00	178.71	5,381.06	-438.57	9.86	438.68	1,591,667.61	2,273,973.26	39.43	-108.07
5,531.76	5.00	178.71	5,512.31	-450.05	10.12	450.16	1,591,656.12	2,273,973.19	39.43	-108.07
Rollins SS										
5,600.00	5.00	178.71	5,580.30	-456.00	10.25	456.11	1,591,650.18	2,273,973.16	39.43	-108.07
5,771.85	5.00	178.71	5,751.49	-470.97	10.59	471.09	1,591,635.20	2,273,973.07	39.43	-108.07
Cozzette										
5,800.00	5.00	178.71	5,779.54	-473.42	10.64	473.54	1,591,632.75	2,273,973.05	39.43	-108.07
6,000.00	5.00	178.71	5,978.78	-490.85	11.03	490.97	1,591,615.32	2,273,972.95	39.43	-108.07
6,012.94	5.00	178.71	5,991.67	-491.98	11.06	492.10	1,591,614.19	2,273,972.95	39.43	-108.07
Corcoran										
6,200.00	5.00	178.71	6,178.01	-508.28	11.42	508.40	1,591,597.89	2,273,972.85	39.43	-108.07
6,210.01	5.00	178.71	6,187.99	-509.15	11.44	509.28	1,591,597.02	2,273,972.85	39.43	-108.07
Upper Sego										
6,400.00	5.00	178.71	6,377.25	-525.70	11.82	525.84	1,591,580.46	2,273,972.75	39.43	-108.07
6,556.15	5.00	178.71	6,532.81	-539.31	12.12	539.44	1,591,566.85	2,273,972.67	39.43	-108.07
Lower Sego										



**WPX**  
Standard Plan - Geographic with VS

<b>Company:</b>	PICEANCE VLY NAD 83	<b>Local Co-ordinate Reference:</b>	Well SG 714-44-23-HN1 - Slot B11
<b>Project:</b>	SG 22-07S-096W	<b>TVD Reference:</b>	WELL @ 5128.00usft (Original Well Elev)
<b>Site:</b>	Nolte 14-44 Pad	<b>MD Reference:</b>	WELL @ 5128.00usft (Original Well Elev)
<b>Well:</b>	SG 714-44-23-HN1	<b>North Reference:</b>	True
<b>Wellbore:</b>	Wellbore #1	<b>Survey Calculation Method:</b>	Minimum Curvature
<b>Design:</b>	Plan #6 19Nov14 kjs	<b>Database:</b>	COMPASS-PICEANCE

Planned Survey										
MD (usft)	Inc (°)	Azi (azimuth) (bearing)	TVD (usft)	N/S (usft)	E/W (usft)	V. Sec (usft)	Northing (usft)	Easting (usft)	Latitude (°)	Longitude (°)
6,600.00	5.00	178.71	6,576.49	-543.13	12.21	543.27	1,591,563.03	2,273,972.65	39.43	-108.07
6,762.22	5.00	178.71	6,738.10	-557.26	12.52	557.40	1,591,548.89	2,273,972.57	39.43	-108.07
<b>Loyd A</b>										
6,800.00	5.00	178.71	6,775.73	-560.56	12.60	560.70	1,591,545.60	2,273,972.55	39.43	-108.07
7,000.00	5.00	178.71	6,974.97	-577.98	12.99	578.13	1,591,528.17	2,273,972.45	39.43	-108.07
7,200.00	5.00	178.71	7,174.21	-595.41	13.38	595.56	1,591,510.74	2,273,972.34	39.43	-108.07
7,346.45	5.00	178.71	7,320.10	-608.17	13.67	608.32	1,591,497.98	2,273,972.27	39.43	-108.07
<b>Castlegate</b>										
7,400.00	5.00	178.71	7,373.45	-612.83	13.77	612.99	1,591,493.31	2,273,972.24	39.43	-108.07
7,597.54	5.00	178.71	7,570.24	-630.05	14.16	630.21	1,591,476.10	2,273,972.14	39.43	-108.07
<b>Castlegate Hot GR</b>										
7,600.00	5.00	178.71	7,572.69	-630.26	14.17	630.42	1,591,475.88	2,273,972.14	39.43	-108.07
7,697.58	5.00	178.71	7,669.90	-638.76	14.36	638.92	1,591,467.38	2,273,972.09	39.43	-108.07
<b>Marapos</b>										
7,800.00	5.00	178.71	7,771.93	-647.69	14.56	647.85	1,591,458.45	2,273,972.04	39.43	-108.07
7,915.66	5.00	178.71	7,887.15	-657.76	14.78	657.93	1,591,448.37	2,273,971.98	39.43	-108.07
<b>Mancos-B</b>										
8,000.00	5.00	178.71	7,971.17	-665.11	14.95	665.28	1,591,441.02	2,273,971.94	39.43	-108.07
8,200.00	5.00	178.71	8,170.40	-682.54	15.34	682.71	1,591,423.59	2,273,971.84	39.43	-108.07
8,400.00	5.00	178.71	8,369.64	-699.97	15.73	700.14	1,591,406.16	2,273,971.73	39.43	-108.07
8,600.00	5.00	178.71	8,568.88	-717.39	16.12	717.57	1,591,388.73	2,273,971.63	39.43	-108.07
8,797.00	5.00	178.71	8,765.13	-734.56	16.51	734.74	1,591,371.57	2,273,971.53	39.43	-108.07
<b>9 5/8"</b>										
8,800.00	5.00	178.71	8,768.12	-734.82	16.52	735.00	1,591,371.30	2,273,971.53	39.43	-108.07
8,847.06	5.00	178.71	8,815.00	-738.92	16.61	739.11	1,591,367.20	2,273,971.51	39.43	-108.07
<b>KOP 8°/100</b>										
8,872.05	7.00	178.71	8,839.86	-741.53	16.67	741.72	1,591,364.59	2,273,971.49	39.43	-108.07
<b>Top Buck Peak</b>										



**WPX**  
Standard Plan - Geographic with VS

<b>Company:</b>	PICEANCE VLY NAD 83	<b>Local Co-ordinate Reference:</b>	Well SG 714-44-23-HN1 - Slot B11
<b>Project:</b>	SG 22-07S-096W	<b>TVD Reference:</b>	WELL @ 5128.00usft (Original Well Elev)
<b>Site:</b>	Nolte 14-44 Pad	<b>MD Reference:</b>	WELL @ 5128.00usft (Original Well Elev)
<b>Well:</b>	SG 714-44-23-HN1	<b>North Reference:</b>	True
<b>Wellbore:</b>	Wellbore #1	<b>Survey Calculation Method:</b>	Minimum Curvature
<b>Design:</b>	Plan #6 19Nov14 kjs	<b>Database:</b>	COMPASS-PICEANCE

Planned Survey										
MD (usft)	Inc (°)	Azi (azimuth) (bearing)	TVD (usft)	N/S (usft)	E/W (usft)	V. Sec (usft)	Northing (usft)	Easting (usft)	Latitude (°)	Longitude (°)
8,996.92	16.99	178.71	8,961.84	-767.44	17.25	767.63	1,591,338.68	2,273,971.34	39.43	-108.07
<b>Top Niobrara</b>										
9,000.00	17.24	178.71	8,964.79	-768.35	17.27	768.54	1,591,337.77	2,273,971.34	39.43	-108.07
9,017.66	18.65	178.71	8,981.59	-773.79	17.39	773.98	1,591,332.33	2,273,971.31	39.43	-108.07
<b>Niobrara Hot GR Marker</b>										
9,051.24	21.33	178.71	9,013.14	-785.26	17.65	785.46	1,591,320.85	2,273,971.24	39.43	-108.07
<b>Niobrara Restivity Marker</b>										
9,124.56	27.20	178.71	9,079.96	-815.38	18.33	815.58	1,591,290.73	2,273,971.07	39.43	-108.07
<b>Niobrara HN2</b>										
9,200.00	33.24	178.71	9,145.11	-853.32	19.19	853.53	1,591,252.78	2,273,970.85	39.43	-108.07
9,400.00	49.24	178.71	9,295.03	-984.68	22.15	984.93	1,591,121.39	2,273,970.10	39.43	-108.07
9,438.13	52.29	178.71	9,319.14	-1,014.20	22.82	1,014.46	1,591,091.86	2,273,969.93	39.43	-108.07
<b>Top Horizontal Target</b>										
9,486.81	56.18	178.71	9,347.59	-1,053.69	23.71	1,053.95	1,591,052.37	2,273,969.70	39.43	-108.07
<b>HN1</b>										
9,600.00	65.24	178.71	9,402.91	-1,152.28	25.94	1,152.57	1,590,953.77	2,273,969.14	39.43	-108.07
9,646.56	68.96	178.71	9,421.03	-1,195.15	26.91	1,195.45	1,590,910.88	2,273,968.90	39.43	-108.07
<b>HN1 Base</b>										
9,800.00	81.24	178.71	9,460.41	-1,343.11	30.25	1,343.45	1,590,762.90	2,273,968.05	39.43	-108.07
9,949.56	93.20	178.71	9,467.66	-1,492.18	33.62	1,492.56	1,590,613.80	2,273,967.20	39.43	-108.07
<b>Landing Pt 93.2° Inc - LP SG 714-44-23-HN1</b>										
10,000.00	93.20	178.71	9,464.84	-1,542.53	34.76	1,542.92	1,590,563.44	2,273,966.91	39.43	-108.07
10,200.00	93.20	178.71	9,453.68	-1,742.17	39.27	1,742.61	1,590,363.76	2,273,965.77	39.43	-108.07
10,400.00	93.20	178.71	9,442.52	-1,941.80	43.78	1,942.30	1,590,164.09	2,273,964.63	39.43	-108.07
10,600.00	93.20	178.71	9,431.35	-2,141.44	48.29	2,141.98	1,589,964.41	2,273,963.49	39.43	-108.07
10,800.00	93.20	178.71	9,420.19	-2,341.08	52.80	2,341.67	1,589,764.74	2,273,962.35	39.42	-108.07
11,000.00	93.20	178.71	9,409.02	-2,540.71	57.31	2,541.36	1,589,565.06	2,273,961.21	39.42	-108.07
11,200.00	93.20	178.71	9,397.86	-2,740.35	61.82	2,741.05	1,589,365.39	2,273,960.07	39.42	-108.07



# WPX

## Standard Plan - Geographic with VS

<b>Company:</b>	PICEANCE VLY NAD 83	<b>Local Co-ordinate Reference:</b>	Well SG 714-44-23-HN1 - Slot B11
<b>Project:</b>	SG 22-07S-096W	<b>TVD Reference:</b>	WELL @ 5128.00usft (Original Well Elev)
<b>Site:</b>	Nolte 14-44 Pad	<b>MD Reference:</b>	WELL @ 5128.00usft (Original Well Elev)
<b>Well:</b>	SG 714-44-23-HN1	<b>North Reference:</b>	True
<b>Wellbore:</b>	Wellbore #1	<b>Survey Calculation Method:</b>	Minimum Curvature
<b>Design:</b>	Plan #6 19Nov14 kjs	<b>Database:</b>	COMPASS-PICEANCE

Planned Survey										
MD (usft)	Inc (°)	Azi (azimuth) (bearing)	TVD (usft)	N/S (usft)	E/W (usft)	V. Sec (usft)	Northing (usft)	Easting (usft)	Latitude (°)	Longitude (°)
11,400.00	93.20	178.71	9,386.69	-2,939.99	66.33	2,940.74	1,589,165.71	2,273,958.93	39.42	-108.07
11,600.00	93.20	178.71	9,375.53	-3,139.63	70.84	3,140.42	1,588,966.04	2,273,957.79	39.42	-108.07
11,800.00	93.20	178.71	9,364.37	-3,339.26	75.35	3,340.11	1,588,766.36	2,273,956.65	39.42	-108.07
12,000.00	93.20	178.71	9,353.20	-3,538.90	79.86	3,539.80	1,588,566.69	2,273,955.51	39.42	-108.07
12,200.00	93.20	178.71	9,342.04	-3,738.54	84.37	3,739.49	1,588,367.01	2,273,954.37	39.42	-108.07
12,400.00	93.20	178.71	9,330.87	-3,938.17	88.88	3,939.18	1,588,167.33	2,273,953.24	39.42	-108.07
12,600.00	93.20	178.71	9,319.71	-4,137.81	93.39	4,138.87	1,587,967.66	2,273,952.10	39.42	-108.07
12,800.00	93.20	178.71	9,308.54	-4,337.45	97.90	4,338.55	1,587,767.98	2,273,950.96	39.42	-108.07
13,000.00	93.20	178.71	9,297.38	-4,537.09	102.41	4,538.24	1,587,568.31	2,273,949.82	39.42	-108.07
13,200.00	93.20	178.71	9,286.22	-4,736.72	106.92	4,737.93	1,587,368.63	2,273,948.68	39.42	-108.07
13,400.00	93.20	178.71	9,275.05	-4,936.36	111.43	4,937.62	1,587,168.96	2,273,947.54	39.42	-108.07
13,600.00	93.20	178.71	9,263.89	-5,136.00	115.94	5,137.31	1,586,969.28	2,273,946.40	39.42	-108.07
13,800.00	93.20	178.71	9,252.72	-5,335.64	120.45	5,336.99	1,586,769.61	2,273,945.26	39.42	-108.07
13,963.26	93.20	178.71	9,243.61	-5,498.60	124.14	5,500.00	1,586,606.61	2,273,944.33	39.42	-108.07
Begin 2°/100 Drop										
14,000.00	92.47	178.71	9,241.79	-5,535.28	124.96	5,536.69	1,586,569.92	2,273,944.12	39.42	-108.07
14,048.73	91.49	178.71	9,240.11	-5,583.97	126.06	5,585.40	1,586,521.22	2,273,943.84	39.42	-108.07
Hold 91.49° Inc										
14,200.00	91.49	178.71	9,236.18	-5,735.15	129.48	5,736.61	1,586,370.01	2,273,942.98	39.42	-108.07
14,400.00	91.49	178.71	9,230.97	-5,935.03	134.00	5,936.55	1,586,170.09	2,273,941.83	39.41	-108.07
14,600.00	91.49	178.71	9,225.77	-6,134.92	138.51	6,136.48	1,585,970.17	2,273,940.69	39.41	-108.07
14,800.00	91.49	178.71	9,220.57	-6,334.80	143.03	6,336.41	1,585,770.25	2,273,939.55	39.41	-108.07
15,000.00	91.49	178.71	9,215.37	-6,534.68	147.54	6,536.34	1,585,570.33	2,273,938.41	39.41	-108.07
15,200.00	91.49	178.71	9,210.16	-6,734.56	152.06	6,736.28	1,585,370.41	2,273,937.27	39.41	-108.07
15,400.00	91.49	178.71	9,204.96	-6,934.44	156.57	6,936.21	1,585,170.50	2,273,936.13	39.41	-108.07
15,600.00	91.49	178.71	9,199.76	-7,134.32	161.09	7,136.14	1,584,970.58	2,273,934.99	39.41	-108.07
15,800.00	91.49	178.71	9,194.55	-7,334.20	165.61	7,336.07	1,584,770.66	2,273,933.85	39.41	-108.07



WPX

Standard Plan - Geographic with VS

<b>Company:</b>	PICEANCE VLY NAD 83	<b>Local Co-ordinate Reference:</b>	Well SG 714-44-23-HN1 - Slot B11
<b>Project:</b>	SG 22-07S-096W	<b>TVD Reference:</b>	WELL @ 5128.00usft (Original Well Elev)
<b>Site:</b>	Nolte 14-44 Pad	<b>MD Reference:</b>	WELL @ 5128.00usft (Original Well Elev)
<b>Well:</b>	SG 714-44-23-HN1	<b>North Reference:</b>	True
<b>Wellbore:</b>	Wellbore #1	<b>Survey Calculation Method:</b>	Minimum Curvature
<b>Design:</b>	Plan #6 19Nov14 kjs	<b>Database:</b>	COMPASS-PICEANCE

Planned Survey											
MD (usft)	Inc (°)	Azi (azimuth) (bearing)	TVD (usft)	N/S (usft)	E/W (usft)	V. Sec (usft)	Northing (usft)	Easting (usft)	Latitude (°)	Longitude (°)	
16,000.00	91.49	178.71	9,189.35	-7,534.08	170.12	7,536.00	1,584,570.74	2,273,932.71	39.41	-108.07	
16,200.00	91.49	178.71	9,184.15	-7,733.97	174.64	7,735.94	1,584,370.82	2,273,931.56	39.41	-108.07	
16,400.00	91.49	178.71	9,178.95	-7,933.85	179.15	7,935.87	1,584,170.90	2,273,930.42	39.41	-108.07	
16,600.00	91.49	178.71	9,173.74	-8,133.73	183.67	8,135.80	1,583,970.98	2,273,929.28	39.41	-108.07	
16,800.00	91.49	178.71	9,168.54	-8,333.61	188.19	8,335.73	1,583,771.06	2,273,928.14	39.41	-108.07	
17,000.00	91.49	178.71	9,163.34	-8,533.49	192.70	8,535.67	1,583,571.14	2,273,927.00	39.41	-108.07	
17,200.00	91.49	178.71	9,158.14	-8,733.37	197.22	8,735.60	1,583,371.22	2,273,925.86	39.41	-108.07	
17,400.00	91.49	178.71	9,152.93	-8,933.25	201.73	8,935.53	1,583,171.30	2,273,924.72	39.41	-108.07	
17,600.00	91.49	178.71	9,147.73	-9,133.13	206.25	9,135.46	1,582,971.38	2,273,923.58	39.41	-108.07	
17,800.00	91.49	178.71	9,142.53	-9,333.02	210.77	9,335.40	1,582,771.46	2,273,922.43	39.41	-108.07	
18,000.00	91.49	178.71	9,137.32	-9,532.90	215.28	9,535.33	1,582,571.54	2,273,921.29	39.40	-108.07	
18,200.00	91.49	178.71	9,132.12	-9,732.78	219.80	9,735.26	1,582,371.62	2,273,920.15	39.40	-108.07	
18,400.00	91.49	178.71	9,126.92	-9,932.66	224.31	9,935.19	1,582,171.70	2,273,919.01	39.40	-108.07	
18,600.00	91.49	178.71	9,121.72	-10,132.54	228.83	10,135.13	1,581,971.78	2,273,917.87	39.40	-108.07	
18,800.00	91.49	178.71	9,116.51	-10,332.42	233.35	10,335.06	1,581,771.86	2,273,916.73	39.40	-108.07	
18,938.41	91.49	178.71	9,112.91	-10,470.75	236.47	10,473.42	1,581,633.51	2,273,915.94	39.40	-108.07	
End of Completions - EOC SG 714-44-23-HN1											
19,000.00	91.49	178.71	9,111.31	-10,532.30	237.86	10,534.99	1,581,571.94	2,273,915.59	39.40	-108.07	
19,050.36	91.49	178.71	9,110.00	-10,582.63	239.00	10,585.33	1,581,521.60	2,273,915.30	39.40	-108.07	
TD at 19050.36 - TD / PBHL SG 714-44-23-HN1 (revised)											

Casing Points					
Measured Depth (usft)	Vertical Depth (usft)	Name	Casing Diameter (in)	Hole Diameter (in)	
1,865.49	1,860.00	13 3/8"	13.375	17.500	
8,797.00	8,765.13	9 5/8"	9.625	12.250	



<b>Company:</b>	PICEANCE VLY NAD 83	<b>Local Co-ordinate Reference:</b>	Well SG 714-44-23-HN1 - Slot B11
<b>Project:</b>	SG 22-07S-096W	<b>TVD Reference:</b>	WELL @ 5128.00usft (Original Well Elev)
<b>Site:</b>	Nolte 14-44 Pad	<b>MD Reference:</b>	WELL @ 5128.00usft (Original Well Elev)
<b>Well:</b>	SG 714-44-23-HN1	<b>North Reference:</b>	True
<b>Wellbore:</b>	Wellbore #1	<b>Survey Calculation Method:</b>	Minimum Curvature
<b>Design:</b>	Plan #6 19Nov14 kjs	<b>Database:</b>	COMPASS-PICEANCE

Formations					
Measured Depth (usft)	Vertical Depth (usft)	Name	Lithology	Dip (°)	Dip Direction (bearing)
6,210.01	6,208.00	Upper Sego		-2.25	178.71
7,346.45	7,344.00	Castlegate		-2.25	178.71
7,597.54	7,595.00	Castlegate Hot GR		-2.25	178.71
2,610.64	2,610.00	Mesaverde		-2.25	178.71
8,872.05	8,869.00	Top Buck Peak		-2.25	178.71
9,438.13	9,359.00	Top Horizontal Target		-2.25	178.71
5,531.76	5,530.00	Rollins SS		-2.25	178.71
3,963.16	3,962.00	Approx. Top Gas		-2.25	178.71
8,996.92	8,992.00	Top Niobrara		-2.25	178.71
9,124.56	9,112.00	Niobrara HN2		-2.25	178.71
9,051.24	9,044.00	Niobrara Restivity Marker		-2.25	178.71
9,017.66	9,012.00	Niobrara Hot GR Marker		-2.25	178.71
1,710.30	1,710.00	Base Fort Union		-2.25	178.71
5,771.85	5,770.00	Cozzette		-2.25	178.71
9,646.56	9,468.00	HN1 Base		-2.25	178.71
7,697.58	7,695.00	Marapos		-2.25	178.71
7,915.66	7,913.00	Mancos-B		-2.25	178.71
6,012.94	6,011.00	Corcoran		-2.25	178.71
9,486.81	9,389.00	HN1		-2.25	178.71
6,762.22	6,760.00	Loyd A		-2.25	178.71
5,004.55	5,003.00	Cameo Coals		-2.25	178.71
6,556.15	6,554.00	Lower Sego		-2.25	178.71



## WPX

### Standard Plan - Geographic with VS

<b>Company:</b>	PICEANCE VLY NAD 83	<b>Local Co-ordinate Reference:</b>	Well SG 714-44-23-HN1 - Slot B11
<b>Project:</b>	SG 22-07S-096W	<b>TVD Reference:</b>	WELL @ 5128.00usft (Original Well Elev)
<b>Site:</b>	Nolte 14-44 Pad	<b>MD Reference:</b>	WELL @ 5128.00usft (Original Well Elev)
<b>Well:</b>	SG 714-44-23-HN1	<b>North Reference:</b>	True
<b>Wellbore:</b>	Wellbore #1	<b>Survey Calculation Method:</b>	Minimum Curvature
<b>Design:</b>	Plan #6 19Nov14 kjs	<b>Database:</b>	COMPASS-PICEANCE

Plan Annotations					
Measured Depth (usft)	Vertical Depth (usft)	Local Coordinates		Comment	
		+N/-S (usft)	+E/-W (usft)		
200.00	200.00	0.00	0.00	Start Build 1.50	
533.32	532.90	-14.53	0.33	Hold 5° Inc, 178.71° Az	
8,847.06	8,815.00	-738.92	16.61	KOP 8°/100	
9,949.56	9,467.66	-1,492.18	33.62	Landing Pt 93.2° Inc	
13,963.26	9,243.61	-5,498.60	124.14	Begin 2°/100 Drop	
14,048.73	9,240.11	-5,583.97	126.06	Hold 91.49° Inc	
18,938.41	9,112.91	-10,470.75	236.47	End of Completions	
19,050.36	9,110.00	-10,582.63	239.00	TD at 19050.36	

Checked By: _____	Approved By: _____	Date: _____
-------------------	--------------------	-------------