

# T3N, R65W

S 89°27'17" W 5137.83' (M)

NW. COR.  
SEC. 21, T3N, R65W  
FOUND 2 1/2" ALUM. CAP  
L.S. NO. 32829

NE. COR.  
SEC. 21, T3N, R65W  
FOUND 3 1/4" BRASS CAP  
L.S. NO. 16415

**SURFACE LOCATION**  
GROUND ELEVATION= 4847.2'  
NAD 83  
LATITUDE= 40.205450°  
LONGITUDE= -104.673394°

**BOTTOM HOLE LOCATION**  
NAD 83  
LATITUDE= 40.189301°  
LONGITUDE= -104.675078°

LATITUDE= 40°11'21.485"  
LONGITUDE= -104°40'30.281"

CENTER 1/4 COR.  
SEC. 21, T3N, R65W  
FOUND 2 1/2" ALUM. CAP  
L.S. NO. 9644

E. 1/4 COR.  
SEC. 21, T3N, R65W  
FOUND 3 1/4" ALUM. CAP  
L.S. NO. 10855

N 00°03'59" W 5267.10' (M)

S 89°27'18" W  
2586.18' (C)

S 89°27'14" W  
2581.97' (M)

## 21

S 04°02'17" W 5902' GRID  
S 04°34'20" W TRUE  
S 03°47'43" E MAGNETIC

**SKIM 13N-28HZ**  
SURFACE LOCATION

N 00°26'28" W  
2644.49' (M)

N 00°54'23" W 2641.60' (M)

SW. COR.  
SEC. 21, T3N, R65W  
SET 2 1/2" ALUM. CAP  
L.S. NO. 38305

S. 1/4 COR.  
SEC. 21, T3N, R65W  
FOUND 2 1/2" ALUM. CAP  
L.S. NO. 30120

SE. COR.  
SEC. 21, T3N, R65W  
FOUND 2 1/2" ALUM. CAP  
L.S. NO. 23501

S 89°41'52" W 2603.41' (M)

S 89°23'22" W 2603.43' (M)

MATCH LINE  
SEE SHEET 1B

WELL BORE CONTINUES  
INTO SECTION 28

### NOTES:

- ▲ INDICATES FOUND SECTION CORNER
- INDICATES CALCULATED CORNER
- ELEVATION BASED ON NAVD88 (GEOID09)
- BASIS OF BEARING DERIVED FROM COLORADO COORDINATE SYSTEM 1983 NORTH ZONE UNLESS OTHERWISE NOTED.
- ALL MEASURED DISTANCES ARE GRID.
- COMBINED SCALE FACTOR: .99972948
- OPERATOR: ROB WILSON / PDOP = 1.4
- SEE ADDENDUM TO WELL LOCATION CERTIFICATE FOR EXISTING IMPROVEMENTS WITHIN 500' OF THE WELL PAD.
- WELL FOOTAGES ARE MEASURED AT RIGHT ANGLES TO THE SECTION LINES.
- THE BOTTOM OF HOLE BEARS S04°02'17"W 5902' FROM THE SURFACE LOCATION.

### CERTIFICATE OF SURVEYOR:

THIS IS TO CERTIFY THAT THE ABOVE PLAT WAS PREPARED FROM FIELD NOTES OF ACTUAL SURVEY MADE BY ME OR UNDER MY SUPERVISION AND THAT THE SAME ARE TRUE AND CORRECT TO THE BEST OF MY KNOWLEDGE AND BELIEF. THIS CERTIFICATE DOES NOT REPRESENT A LAND SURVEY PLAT OR IMPROVEMENT SURVEY PLAT AS DEFINED BY C.S. 38-51-102 AND CANNOT BE RELIED UPON TO DETERMINE OWNERSHIP.

*Benjamin J. Reenders*  
PROFESSIONAL LAND SURVEYOR  
8/20/14

BENJAMIN J. REENDERS  
PROFESSIONAL LAND SURVEYOR  
COLORADO REGISTRATION NUMBER 48320

NOTICE:  
ACCORDING TO COLORADO STATE LAW YOU MUST COMMENCE ANY LEGAL ACTION BASED UPON ANY DEFECT IN THIS SURVEY WITHIN THREE YEARS AFTER YOU FIRST DISCOVER SUCH DEFECT. IN NO EVENT MAY ANY ACTION BASED UPON ANY DEFECT IN THIS SURVEY BE COMMENCED MORE THAN TEN YEARS FROM THE DATE ON THE CERTIFICATION SHOWN HEREON.

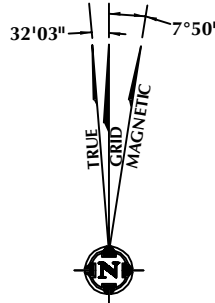

NOTE:  
MAGNETIC NORTH IS CURRENT AS OF 7/29/2014.  
MAGNETIC NORTH CHANGES WEST 0°08' PER YEAR.



SCALE: 1" = 1000'

### WELL PAD - SKIM STATE 4N-21HZ

SKIM 13N-28HZ  
WELL LOCATION CERTIFICATE  
639' FSL & 1256' FWL SWSW (SURFACE)  
LOCATED IN SECTION 21  
50' FSL & 792' FWL SWSW (BOTTOM)  
LOCATED IN SECTION 28  
T3N, R65W, 6TH P.M.  
WELD COUNTY, COLORADO

**Kerr-McGee Oil &  
Gas Onshore L.P.**  
1099 18th Street  
Denver, Colorado 80202



### CONSULTING, LLC

SHERIDAN OFFICE  
2155 North Main Street  
Sheridan, Wyoming 82801  
Phone 307-674-0609

LOVELAND OFFICE  
1635 Foxtrail Drive, Suite 204  
Loveland, Colorado 80538  
Phone 970-776-4331

DRAFTED BY:	LMO	CHECKED BY:	BJR	SHEET NO: <b>1A</b> 1A OF 1
DATE DRAFTED:	8/8/14	DATE SURVEYED:	8/7/14	
REVISED:	8/20/14	FILE NAME:	14-46	

# T3N, R65W

N. 1/4 COR.  
SEC. 28, T3N, R65W  
FOUND 2 1/2" ALUM. CAP  
L.S. NO. 30120

MATCH LINE  
SEE SHEET 1A

NW. COR.  
SEC. 28, T3N, R65W  
SET 2 1/2" ALUM. CAP  
L.S. NO. 38305

NE. COR.  
SEC. 28, T3N, R65W  
FOUND 2 1/2" ALUM. CAP  
L.S. NO. 23501

**SURFACE LOCATION**  
GROUND ELEVATION= 4847.2'  
NAD 83  
LATITUDE= 40.205450°  
LONGITUDE= -104.673394°

LATITUDE= 40°12'19.621"  
LONGITUDE= -104°40'24.219"

**BOTTOM HOLE LOCATION**  
NAD 83  
LATITUDE= 40.189301°  
LONGITUDE= -104.675078°

LATITUDE= 40°11'21.485"  
LONGITUDE= -104°40'30.281"

E. 1/4 COR.  
SEC. 28, T3N, R65W  
FOUND 3 1/4" ALUM. CAP  
L.S. NO. 7242

N. 00°31'13" W 5299.76' (M)

S 04°02'17" W 5902' GRID  
S 04°34'20" W TRUE  
S 03°47'43" E MAGNETIC

N 00°39'38" W  
2642.52' (C)

N 00°48'06" W 2649.20' (M)

S 89°32'08" W  
2609.86' (C)

S 89°32'08" W  
2609.97' (C)

28

N 00°39'38" W  
2645.40' (C)

N 00°47'56" W 2640.95' (M)

BOTTOM OF HOLE:  
50' FSL & 792' FWL

S. 1/4 COR.  
SEC. 28, T3N, R65W  
FOUND 2 1/2" ALUM. CAP  
L.S. NO. 9644

SE. COR.  
SEC. 28, T3N, R65W  
FOUND 3 1/4" ALUM. CAP  
L.S. NO. 7242

SW. COR.  
SEC. 28, T3N, R65W  
FOUND 2 1/2" ALUM. CAP  
L.S. NO. 23501

N 00°31'13" W 5299.76' (M)

2599'

1274'

50'

792'

516'

1824'

S 89°26'14" W 2616.34' (M)

S 89°26'15" W 2616.33' (M)

### NOTES:

- ▲ INDICATES FOUND SECTION CORNER
- INDICATES CALCULATED CORNER
- ELEVATION BASED ON NAVD88 (GEOID09)
- BASIS OF BEARING DERIVED FROM COLORADO COORDINATE SYSTEM 1983 NORTH ZONE UNLESS OTHERWISE NOTED.
- ALL MEASURED DISTANCES ARE GRID.
- COMBINED SCALE FACTOR: .99972948
- OPERATOR: ROB WILSON / PDOP = 1.4
- SEE ADDENDUM TO WELL LOCATION CERTIFICATE FOR EXISTING IMPROVEMENTS WITHIN 500' OF THE WELL PAD.
- WELL FOOTAGES ARE MEASURED AT RIGHT ANGLES TO THE SECTION LINES.
- THE BOTTOM OF HOLE BEARS S04°02'17"W 5902' FROM THE SURFACE LOCATION.

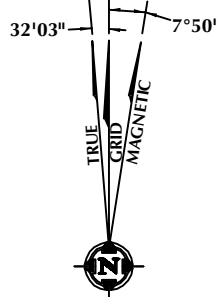
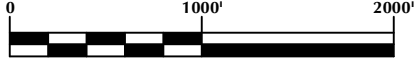

NOTE:  
MAGNETIC NORTH IS CURRENT AS OF 7/29/2014.  
MAGNETIC NORTH CHANGES WEST 0°08' PER YEAR.

### CERTIFICATE OF SURVEYOR:

THIS IS TO CERTIFY THAT THE ABOVE PLAT WAS PREPARED FROM FIELD NOTES OF ACTUAL SURVEY MADE BY ME OR UNDER MY SUPERVISION AND THAT THE SAME ARE TRUE AND CORRECT TO THE BEST OF MY KNOWLEDGE AND BELIEF. THIS CERTIFICATE DOES NOT REPRESENT A LAND SURVEY PLAT OR IMPROVEMENT SURVEY PLAT AS DEFINED BY C.S. 38-51-102 AND CANNOT BE RELIED UPON TO DETERMINE OWNERSHIP.

*Benjamin J. Reenders*  
PROFESSIONAL LAND SURVEYOR  
38305  
8/20/14

BENJAMIN J. REENDERS  
PROFESSIONAL LAND SURVEYOR  
COLORADO REGISTRATION NUMBER 18330

NOTICE:  
ACCORDING TO COLORADO STATE LAW YOU MUST COMMENCE ANY LEGAL ACTION BASED UPON ANY DEFECT IN THIS SURVEY WITHIN THREE YEARS AFTER YOU FIRST DISCOVER SUCH DEFECT. IN NO EVENT MAY ANY ACTION BASED UPON ANY DEFECT IN THIS SURVEY BE COMMENCED MORE THAN TEN YEARS FROM THE DATE ON THE CERTIFICATION SHOWN HEREON.

### WELL PAD - SKIM STATE 4N-21HZ

SKIM 13N-28HZ  
WELL LOCATION CERTIFICATE  
639' FSL & 1256' FWL SWSW (SURFACE)  
LOCATED IN SECTION 21  
50' FSL & 792' FWL SWSW (BOTTOM)  
LOCATED IN SECTION 28  
T3N, R65W, 6TH P.M.  
WELD COUNTY, COLORADO

**Kerr-McGee Oil &  
Gas Onshore L.P.**  
1099 18th Street  
Denver, Colorado 80202



### CONSULTING, LLC

SHERIDAN OFFICE  
2155 North Main Street  
Sheridan, Wyoming 82801  
Phone 307-674-0609

LOVELAND OFFICE  
1635 Foxtrail Drive, Suite 204  
Loveland, Colorado 80538  
Phone 970-776-4331

DRAFTED BY:	LMO	CHECKED BY:	BJR	SHEET NO: <b>1B</b> 1B OF 1
DATE DRAFTED:	8/8/14	DATE SURVEYED:	8/7/14	
REVISED:	8/20/14	FILE NAME:	14-46	

K:\ADARKO\2014\14\_46\_MOSER\_WELL-STAKING\_21HZ\PLATS\SKIM\_4N-21HZ\_SOUTH.dwg, 8/21/2014 10:35:58 AM, bobbb

K:\ANADARKO\2014\2014\_46\_MOSER\_WELL-STAKING\_3N65WGIS\Maps\_ABC\SKIM 4N-21HZ\SKIM 13N-28HZ.mxd 8/18/2014 4:45:31 PM

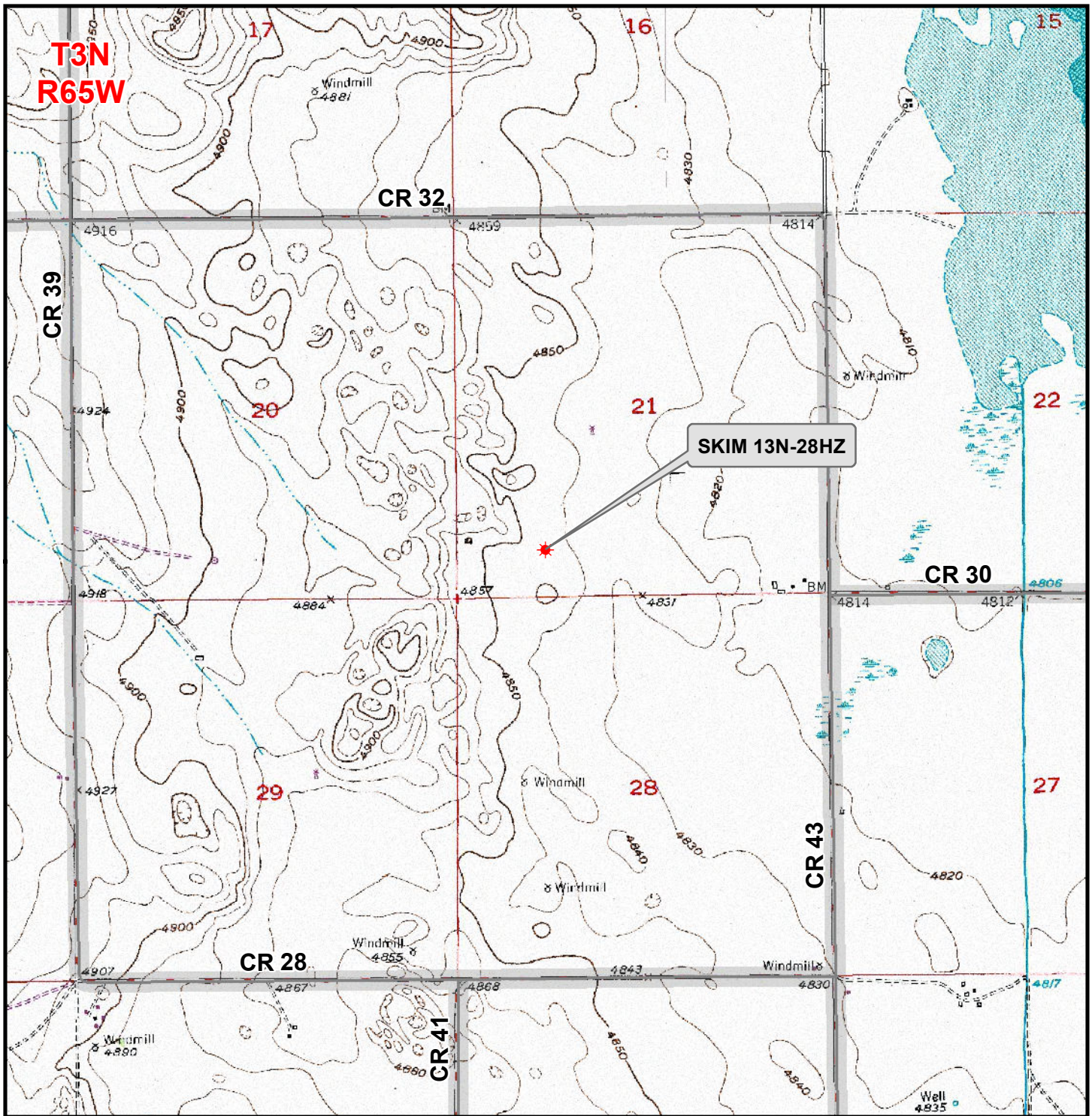

**Legend**

- Well - Fee - Proposed
- Road - Primitive - Existing
- Road - Improved - Existing
- Road - County - Existing
- Road - Highway - Existing

**WELL PAD - SKIM STATE 4N-21HZ**  
**GENERAL LOCATION MAP**  
**SKIM 13N-28HZ**  
**LOCATED IN SECTION 21**  
**T3N, R65W, 6th P.M.**  
**WELD COUNTY, COLORADO**

**Kerr-McGee Oil & Gas Onshore L.P.**  
 1099 18th Street  
 Denver, Colorado 80202



**CONSULTING, LLC**  
 SHERIDAN OFFICE: 2155 North Main Street, Sheridan, Wyoming 82801, Phone 307-674-0609  
 LOVELAND OFFICE: 1635 Foxtail Drive, Suite 204, Loveland, Colorado 80538, Phone 970-776-4331

SCALE: 1" = 2,000ft	NAD83 CO-Nft
DRAWN: TL	DATE: 30 July 2014
REVISED: JELo	DATE: 20 Aug 2014