



Bill Barrett Corp.
Project: Weld Co., CO
Site: Sec.15-T4N-R62W
Well: Anschutz Eq Farms 4-62-15-0461CH2
Wellbore: Wellbore #1
Design: Design #1
Lat: 40° 19' 8.411 N
Long: 104° 18' 46.120 W
Pad GL: 4518.00
KB: WELL @ 4534.00ufst (Original Well Elev)

MD	Inc	Azi	TVD	+N/-S	+E/-W	Dleg	TFace	VSect	Annotation
0.00	0.00	0.00	0.00	0.00	0.00	0.00	0.00	0.00	
900.00	0.00	0.00	900.00	0.00	0.00	0.00	0.00	0.00	Start Build 2.00
1191.04	5.82	58.43	1190.54	7.73	12.58	2.00	58.43	-7.41	Start 3613.60 hold at 1191.04 MD
4804.63	5.82	58.43	4785.50	199.62	324.82	0.00	180.00	-191.16	Start Drop -2.00
5095.67	0.00	0.00	5076.04	207.35	337.40	2.00	180.00	-198.57	Start 500.01 hold at 5095.67 MD
5595.98	0.00	0.00	5576.05	537.35	198.37	0.00	198.37	10.00	Start 537.00 hold at 5595.98 MD
6497.94	90.23	178.52	6149.00	-367.67	352.27	10.00	178.52	376.64	Start 9662.70 hold at 6497.94 MD
16160.63	90.23	178.52	6111.00	-1002.27	601.99	0.00	0.00	10039.27	TD at 16160.63

+N/-S	+E/-W	Northing	Easting	Latitude	Longitude	Slot
0.00	0.00	1361269.644	3331029.582	40° 19' 8.411 N	104° 18' 46.120 W	

Name	TVD	+N/-S	+E/-W	Latitude	Longitude	Shape
Anschutz Eg Farms 4-62-15-0461CH2 tgt	6111.00	-10027.06	601.99	40° 17' 29.321 N	104° 18' 38.351 W	Point

TVD	MD	Name
6149.00	6497.94	7" Csq.

Geodetic System: US State Plane 1983
Datum: North American Datum 1983
Ellipsoid: GRS 1980
Zone: Colorado Northern Zone

A diagram showing a wheel with a vertical force vector T acting upwards from the center and a diagonal force vector M acting upwards and to the right from the center.

Magnetic Field
Strength: 52800.6snT
Dip Angle: 66.95°
Date: 08/28/2014
Model: IGRF2010

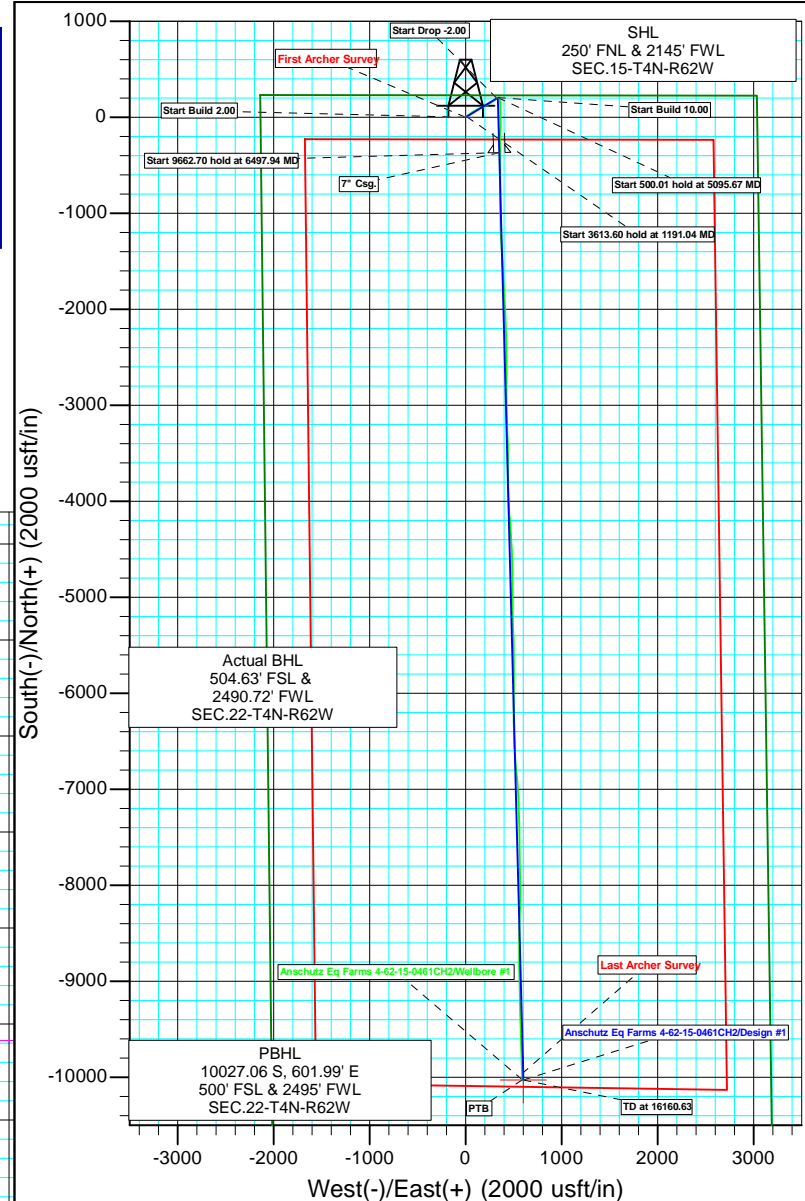

Created By: Ricky Osburn

Date: 9:51, October 20 2014



Bill Barrett Corporation

Bill Barrett Corp.

Weld Co., CO

Sec.15-T4N-R62W

Anschutz Eq Farms 4-62-15-0461CH2

Wellbore #1

Survey: Survey #1

Standard Survey Report

19 September, 2014

Archer

Company:	Bill Barrett Corp.	Local Co-ordinate Reference:	Well Anschutz Eq Farms 4-62-15-0461CH2
Project:	Weld Co., CO	TVD Reference:	WELL @ 4534.00usft (Original Well Elev)
Site:	Sec.15-T4N-R62W	MD Reference:	WELL @ 4534.00usft (Original Well Elev)
Well:	Anschutz Eq Farms 4-62-15-0461CH2	North Reference:	True
Wellbore:	Wellbore #1	Survey Calculation Method:	Minimum Curvature
Design:	Wellbore #1	Database:	EDMDBBW

Project	Weld Co., CO		
Map System:	US State Plane 1983	System Datum:	Mean Sea Level
Geo Datum:	North American Datum 1983		
Map Zone:	Colorado Northern Zone		

Site		Sec.15-T4N-R62W			
Site Position:		Northing:	1,361,232.866 usft	Latitude:	40° 19' 8.231 N
From:	Lat/Long	Easting:	3,329,639.637 usft	Longitude:	104° 19' 4.069 W
Position Uncertainty:	0.00 usft	Slot Radius:	13-3/16 "	Grid Convergence:	0.76 °

Well	Anschutz Eq Farms 4-62-15-0461CH2					
Well Position	+N/-S	0.00 usft	Northing:	1,361,269.644 usft	Latitude:	40° 19' 8.411 N
	+E/-W	0.00 usft	Easting:	3,331,029.582 usft	Longitude:	104° 18' 46.120 W
Position Uncertainty		0.00 usft	Wellhead Elevation:	usft	Ground Level:	4,518.00 usft

Wellbore	Wellbore #1				
Magnetics	Model Name	Sample Date	Declination (°)	Dip Angle (°)	Field Strength (nT)
	IGRF2010	2014/08/28	8.18	66.95	52,801

Design	Wellbore #1				
Audit Notes:					
Version:	1.0	Phase:	ACTUAL	Tie On Depth:	0.00
Vertical Section:	Depth From (TVD) (usft)	+N/-S (usft)	+E/-W (usft)	Direction (°)	
	0.00	0.00	0.00	178.52	

Survey Program	Date	2014/09/19			
From (usft)	To (usft)	Survey (Wellbore)	Tool Name	Description	
833.00	16,115.00	Survey #1 (Wellbore #1)	MWD	MWD - Standard	

Survey									
Measured Depth (usft)	Inclination (°)	Azimuth (°)	Vertical Depth (usft)	+N/-S (usft)	+E/-W (usft)	Vertical Section (usft)	Dogleg Rate (°/100usft)	Build Rate (°/100usft)	Turn Rate (°/100usft)
0.00	0.00	0.00	0.00	0.00	0.00	0.00	0.00	0.00	0.00
First Archer Survey									
833.00	0.10	73.60	833.00	0.21	0.70	-0.19	0.01	0.01	0.00
896.00	0.10	18.40	896.00	0.27	0.77	-0.25	0.15	0.00	-87.62
990.00	1.90	25.20	989.98	1.76	1.46	-1.72	1.92	1.91	7.23
1,081.00	3.80	31.60	1,080.86	5.69	3.68	-5.60	2.11	2.09	7.03
1,173.00	4.50	45.00	1,172.63	10.84	7.83	-10.64	1.30	0.76	14.57
1,265.00	6.40	55.90	1,264.21	16.27	14.63	-15.89	2.34	2.07	11.85
1,356.00	6.80	63.00	1,354.61	21.56	23.63	-20.94	1.00	0.44	7.80
1,447.00	5.80	58.00	1,445.06	26.44	32.33	-25.60	1.25	-1.10	-5.49
1,539.00	6.40	50.20	1,536.54	32.19	40.21	-31.14	1.11	0.65	-8.48
1,631.00	7.00	52.30	1,627.91	38.90	48.58	-37.63	0.70	0.65	2.28
1,723.00	7.90	53.50	1,719.13	46.09	58.10	-44.57	0.99	0.98	1.30

Company:	Bill Barrett Corp.	Local Co-ordinate Reference:	Well Anschutz Eq Farms 4-62-15-0461CH2
Project:	Weld Co., CO	TVD Reference:	WELL @ 4534.00usft (Original Well Elev)
Site:	Sec.15-T4N-R62W	MD Reference:	WELL @ 4534.00usft (Original Well Elev)
Well:	Anschutz Eq Farms 4-62-15-0461CH2	North Reference:	True
Wellbore:	Wellbore #1	Survey Calculation Method:	Minimum Curvature
Design:	Wellbore #1	Database:	EDMDBBW

Survey										
Measured Depth (usft)	Inclination (°)	Azimuth (°)	Vertical Depth (usft)	+N/-S (usft)	+E/-W (usft)	Vertical Section (usft)	Dogleg Rate (°/100usft)	Build Rate (°/100usft)	Turn Rate (°/100usft)	
1,815.00	7.60	61.30	1,810.29	52.77	68.52	-50.98	1.19	-0.33	8.48	
1,907.00	7.00	57.40	1,901.55	58.71	78.58	-56.66	0.85	-0.65	-4.24	
1,999.00	6.90	61.20	1,992.87	64.40	88.15	-62.10	0.51	-0.11	4.13	
2,091.00	7.70	59.80	2,084.12	70.16	98.32	-67.60	0.89	0.87	-1.52	
2,182.00	9.10	57.80	2,174.15	77.06	109.68	-74.20	1.57	1.54	-2.20	
2,274.00	8.00	67.60	2,265.13	83.38	121.75	-80.20	1.98	-1.20	10.65	
2,366.00	7.50	64.30	2,356.29	88.42	133.08	-84.95	0.73	-0.54	-3.59	
2,457.00	6.60	63.60	2,446.60	93.32	143.12	-89.59	0.99	-0.99	-0.77	
2,549.00	7.10	74.60	2,537.95	97.18	153.33	-93.19	1.52	0.54	11.96	
2,641.00	8.40	70.60	2,629.10	100.92	165.16	-96.62	1.53	1.41	-4.35	
2,732.00	7.70	64.90	2,719.21	105.72	176.95	-101.11	1.17	-0.77	-6.26	
2,824.00	8.00	61.20	2,810.35	111.42	188.14	-106.52	0.64	0.33	-4.02	
2,916.00	6.90	58.00	2,901.57	117.43	198.43	-112.27	1.28	-1.20	-3.48	
3,007.00	7.70	64.30	2,991.83	122.97	208.56	-117.54	1.24	0.88	6.92	
3,099.00	9.50	64.60	3,082.79	128.90	220.98	-123.15	1.96	1.96	0.33	
3,191.00	9.10	60.80	3,173.58	135.71	234.19	-129.61	0.80	-0.43	-4.13	
3,283.00	8.80	59.60	3,264.46	142.82	246.61	-136.40	0.38	-0.33	-1.30	
3,375.00	9.40	60.50	3,355.31	150.08	259.22	-143.33	0.67	0.65	0.98	
3,467.00	9.80	56.80	3,446.02	158.06	272.31	-150.98	0.80	0.43	-4.02	
3,559.00	9.20	56.30	3,536.76	166.43	284.98	-159.02	0.66	-0.65	-0.54	
3,650.00	8.40	54.50	3,626.68	174.33	296.44	-166.61	0.93	-0.88	-1.98	
3,742.00	7.70	54.80	3,717.78	181.78	306.95	-173.79	0.76	-0.76	0.33	
3,833.00	6.20	50.60	3,808.11	188.42	315.73	-180.20	1.74	-1.65	-4.62	
3,925.00	6.10	57.00	3,899.58	194.23	323.66	-185.81	0.75	-0.11	6.96	
4,019.00	5.80	55.90	3,993.07	199.62	331.79	-190.98	0.34	-0.32	-1.17	
4,114.00	5.50	55.40	4,087.61	204.89	339.51	-196.05	0.32	-0.32	-0.53	
4,209.00	4.90	66.50	4,182.22	209.10	346.98	-200.06	1.23	-0.63	11.68	
4,304.00	2.70	81.70	4,277.01	211.04	352.91	-201.85	2.53	-2.32	16.00	
4,398.00	1.20	115.30	4,370.95	210.94	355.99	-201.67	1.94	-1.60	35.74	
4,492.00	1.50	172.00	4,464.93	209.30	357.06	-200.00	1.39	0.32	60.32	
4,586.00	1.50	156.00	4,558.90	206.95	357.73	-197.65	0.44	0.00	-17.02	
4,681.00	1.20	207.40	4,653.88	204.93	357.77	-195.63	1.26	-0.32	54.11	
4,775.00	1.20	195.00	4,747.86	203.11	357.07	-193.82	0.28	0.00	-13.19	
4,870.00	1.10	188.10	4,842.84	201.25	356.68	-191.97	0.18	-0.11	-7.26	
4,964.00	0.90	236.80	4,936.82	199.95	355.94	-190.69	0.90	-0.21	51.81	
5,059.00	0.70	227.20	5,031.82	199.15	354.89	-189.91	0.25	-0.21	-10.11	
5,154.00	0.40	152.70	5,126.81	198.46	354.61	-189.23	0.74	-0.32	-78.42	
5,248.00	0.70	354.40	5,220.81	198.74	354.71	-189.51	1.15	0.32	-168.40	
5,344.00	0.50	39.50	5,316.81	199.64	354.92	-190.41	0.52	-0.21	46.98	
5,438.00	0.60	97.80	5,410.80	199.89	355.66	-190.64	0.58	0.11	62.02	
5,533.00	2.30	151.30	5,505.77	198.15	357.07	-188.87	2.11	1.79	56.32	
5,580.00	7.20	170.80	5,552.60	194.42	358.00	-185.11	10.83	10.43	41.49	
5,627.00	11.80	175.60	5,598.94	186.71	358.84	-177.38	9.92	9.79	10.21	
5,674.00	16.00	179.60	5,644.56	175.44	359.25	-166.10	9.16	8.94	8.51	
5,720.00	18.40	178.40	5,688.50	161.84	359.50	-152.50	5.27	5.22	-2.61	
5,767.00	23.50	179.10	5,732.37	145.05	359.85	-135.70	10.86	10.85	1.49	
5,815.00	29.00	179.50	5,775.41	123.83	360.11	-114.48	11.46	11.46	0.83	
5,862.00	33.10	179.60	5,815.66	99.59	360.29	-90.25	8.72	8.72	0.21	
5,910.00	33.10	178.00	5,855.88	73.38	360.84	-64.04	1.82	0.00	-3.33	
5,957.00	37.00	176.70	5,894.35	46.43	362.11	-37.06	8.45	8.30	-2.77	
6,005.00	42.50	175.00	5,931.24	15.83	364.35	-6.42	11.68	11.46	-3.54	
6,052.00	46.50	177.50	5,964.76	-17.03	366.48	26.49	9.29	8.51	5.32	
6,100.00	51.40	181.30	5,996.27	-53.20	366.81	62.66	11.82	10.21	7.92	
6,147.00	54.50	186.20	6,024.60	-90.61	364.33	99.99	10.61	6.60	10.43	

Company:	Bill Barrett Corp.	Local Co-ordinate Reference:	Well Anschutz Eq Farms 4-62-15-0461CH2
Project:	Weld Co., CO	TVD Reference:	WELL @ 4534.00usft (Original Well Elev)
Site:	Sec.15-T4N-R62W	MD Reference:	WELL @ 4534.00usft (Original Well Elev)
Well:	Anschutz Eq Farms 4-62-15-0461CH2	North Reference:	True
Wellbore:	Wellbore #1	Survey Calculation Method:	Minimum Curvature
Design:	Wellbore #1	Database:	EDMDBBW

Survey									
Measured Depth (usft)	Inclination (°)	Azimuth (°)	Vertical Depth (usft)	+N/-S (usft)	+E/-W (usft)	Vertical Section (usft)	Dogleg Rate (°/100usft)	Build Rate (°/100usft)	Turn Rate (°/100usft)
6,195.00	58.20	186.00	6,051.19	-130.33	360.09	139.59	7.72	7.71	-0.42
6,242.00	63.60	181.20	6,074.05	-171.29	357.55	180.47	14.54	11.49	-10.21
6,289.00	69.10	178.20	6,092.90	-214.32	357.80	223.49	13.08	11.70	-6.38
6,336.00	70.20	177.80	6,109.25	-258.36	359.34	267.55	2.47	2.34	-0.85
6,384.00	74.50	179.00	6,123.80	-304.07	360.61	313.28	9.27	8.96	2.50
6,431.00	78.80	180.30	6,134.65	-349.78	360.89	358.99	9.54	9.15	2.77
6,479.00	81.50	179.80	6,142.86	-397.07	360.85	406.26	5.72	5.62	-1.04
6,526.00	85.40	179.50	6,148.22	-443.76	361.13	452.93	8.32	8.30	-0.64
6,536.00	85.90	179.50	6,148.98	-453.73	361.22	462.90	5.00	5.00	0.00
6,613.00	88.20	180.70	6,152.94	-530.62	361.09	539.77	3.37	2.99	1.56
6,708.00	89.80	179.70	6,154.60	-625.60	360.75	634.71	1.99	1.68	-1.05
6,803.00	90.00	179.90	6,154.76	-720.60	361.09	729.68	0.30	0.21	0.21
6,897.00	90.60	180.00	6,154.27	-814.60	361.17	823.65	0.65	0.64	0.11
6,993.00	89.50	179.00	6,154.19	-910.59	362.01	919.64	1.55	-1.15	-1.04
7,087.00	89.90	179.50	6,154.68	-1,004.58	363.24	1,013.63	0.68	0.43	0.53
7,182.00	89.30	178.90	6,155.34	-1,099.57	364.56	1,108.62	0.89	-0.63	-0.63
7,277.00	88.90	177.80	6,156.84	-1,194.51	367.30	1,203.60	1.23	-0.42	-1.16
7,372.00	90.10	178.40	6,157.66	-1,289.46	370.45	1,298.59	1.41	1.26	0.63
7,466.00	90.40	176.80	6,157.25	-1,383.37	374.38	1,392.58	1.73	0.32	-1.70
7,561.00	88.80	175.40	6,157.92	-1,478.14	380.84	1,487.49	2.24	-1.68	-1.47
7,656.00	90.40	176.10	6,158.58	-1,572.87	387.88	1,582.37	1.84	1.68	0.74
7,751.00	91.40	176.00	6,157.09	-1,667.64	394.43	1,677.27	1.06	1.05	-0.11
7,846.00	90.40	176.00	6,155.60	-1,762.39	401.05	1,772.16	1.05	-1.05	0.00
7,940.00	91.30	176.90	6,154.20	-1,856.20	406.87	1,866.09	1.35	0.96	0.96
8,034.00	91.50	178.60	6,151.91	-1,950.10	410.56	1,960.05	1.82	0.21	1.81
8,129.00	91.30	178.20	6,149.58	-2,045.03	413.21	2,055.02	0.47	-0.21	-0.42
8,223.00	91.40	178.10	6,147.37	-2,138.95	416.25	2,148.99	0.15	0.11	-0.11
8,318.00	89.20	177.80	6,146.87	-2,233.89	419.64	2,243.98	2.34	-2.32	-0.32
8,412.00	90.90	178.50	6,146.79	-2,327.83	422.68	2,337.97	1.96	1.81	0.74
8,506.00	91.20	178.30	6,145.07	-2,421.78	425.30	2,431.96	0.38	0.32	-0.21
8,601.00	91.70	179.60	6,142.66	-2,516.73	427.04	2,526.92	1.47	0.53	1.37
8,696.00	91.30	180.20	6,140.18	-2,611.70	427.21	2,621.86	0.76	-0.42	0.63
8,791.00	89.10	180.20	6,139.85	-2,706.69	426.88	2,716.81	2.32	-2.32	0.00
8,885.00	91.00	180.20	6,139.76	-2,800.69	426.55	2,810.77	2.02	2.02	0.00
8,980.00	89.00	179.70	6,139.76	-2,895.68	426.63	2,905.73	2.17	-2.11	-0.53
9,075.00	89.10	179.00	6,141.34	-2,990.66	427.71	3,000.71	0.74	0.11	-0.74
9,170.00	89.30	178.80	6,142.66	-3,085.64	429.53	3,095.70	0.30	0.21	-0.21
9,264.00	89.30	178.50	6,143.81	-3,179.60	431.75	3,189.69	0.32	0.00	-0.32
9,359.00	88.90	177.80	6,145.31	-3,274.54	434.81	3,284.68	0.85	-0.42	-0.74
9,454.00	89.80	177.50	6,146.38	-3,369.45	438.71	3,379.66	1.00	0.95	-0.32
9,549.00	91.70	180.20	6,145.14	-3,464.41	440.62	3,474.64	3.47	2.00	2.84
9,643.00	92.20	179.70	6,141.94	-3,558.36	440.70	3,568.55	0.75	0.53	-0.53
9,737.00	90.70	179.70	6,139.56	-3,652.32	441.19	3,662.50	1.60	-1.60	0.00
9,832.00	90.20	179.50	6,138.82	-3,747.32	441.85	3,757.48	0.57	-0.53	-0.21
9,923.00	90.00	179.00	6,138.66	-3,838.31	443.04	3,848.47	0.59	-0.22	-0.55
10,015.00	90.30	177.50	6,138.42	-3,930.26	445.85	3,940.47	1.66	0.33	-1.63
10,107.00	90.60	177.10	6,137.69	-4,022.16	450.19	4,032.44	0.54	0.33	-0.43
10,198.00	91.30	176.10	6,136.19	-4,112.98	455.58	4,123.38	1.34	0.77	-1.10
10,290.00	88.80	175.00	6,136.10	-4,204.70	462.72	4,215.25	2.97	-2.72	-1.20
10,382.00	89.30	176.40	6,137.63	-4,296.42	469.62	4,307.12	1.62	0.54	1.52
10,473.00	89.30	176.60	6,138.74	-4,387.25	475.17	4,398.06	0.22	0.00	0.22
10,565.00	90.40	178.80	6,138.98	-4,479.17	478.87	4,490.04	2.67	1.20	2.39
10,657.00	89.50	176.50	6,139.06	-4,571.08	482.64	4,582.02	2.68	-0.98	-2.50
10,749.00	89.80	177.90	6,139.63	-4,662.97	487.13	4,673.99	1.56	0.33	1.52

Company:	Bill Barrett Corp.	Local Co-ordinate Reference:	Well Anschutz Eq Farms 4-62-15-0461CH2
Project:	Weld Co., CO	TVD Reference:	WELL @ 4534.00usft (Original Well Elev)
Site:	Sec.15-T4N-R62W	MD Reference:	WELL @ 4534.00usft (Original Well Elev)
Well:	Anschutz Eq Farms 4-62-15-0461CH2	North Reference:	True
Wellbore:	Wellbore #1	Survey Calculation Method:	Minimum Curvature
Design:	Wellbore #1	Database:	EDMDBBW

Survey									
Measured Depth (usft)	Inclination (°)	Azimuth (°)	Vertical Depth (usft)	+N/-S (usft)	+E/-W (usft)	Vertical Section (usft)	Dogleg Rate (°/100usft)	Build Rate (°/100usft)	Turn Rate (°/100usft)
10,841.00	91.00	180.40	6,138.98	-4,754.95	488.50	4,765.98	3.01	1.30	2.72
10,933.00	91.40	180.20	6,137.06	-4,846.92	488.01	4,857.91	0.49	0.43	-0.22
11,024.00	91.50	179.90	6,134.75	-4,937.89	487.93	4,948.85	0.35	0.11	-0.33
11,116.00	89.50	179.70	6,133.95	-5,029.89	488.26	5,040.82	2.18	-2.17	-0.22
11,208.00	88.80	179.10	6,135.32	-5,121.87	489.22	5,132.80	1.00	-0.76	-0.65
11,299.00	89.20	178.20	6,136.90	-5,212.83	491.36	5,223.78	1.08	0.44	-0.99
11,391.00	89.20	177.30	6,138.19	-5,304.75	494.97	5,315.76	0.98	0.00	-0.98
11,490.00	89.90	178.80	6,138.97	-5,403.69	498.34	5,414.75	1.67	0.71	1.52
11,582.00	90.20	179.00	6,138.89	-5,495.67	500.11	5,506.75	0.39	0.33	0.22
11,674.00	89.80	178.30	6,138.89	-5,587.64	502.28	5,598.75	0.88	-0.43	-0.76
11,766.00	89.10	179.60	6,139.77	-5,679.62	503.96	5,690.74	1.60	-0.76	1.41
11,858.00	89.90	180.40	6,140.57	-5,771.61	503.96	5,782.71	1.23	0.87	0.87
11,950.00	91.10	180.90	6,139.77	-5,863.60	502.92	5,874.64	1.41	1.30	0.54
12,042.00	91.30	180.40	6,137.84	-5,955.58	501.88	5,966.55	0.59	0.22	-0.54
12,133.00	92.10	179.90	6,135.14	-6,046.54	501.64	6,057.47	1.04	0.88	-0.55
12,225.00	91.00	180.10	6,132.65	-6,138.50	501.64	6,149.41	1.22	-1.20	0.22
12,317.00	91.10	179.50	6,130.97	-6,230.48	501.96	6,241.37	0.66	0.11	-0.65
12,408.00	91.60	179.30	6,128.82	-6,321.45	502.91	6,332.33	0.59	0.55	-0.22
12,500.00	90.20	179.20	6,127.38	-6,413.43	504.11	6,424.31	1.53	-1.52	-0.11
12,592.00	90.20	178.00	6,127.06	-6,505.40	506.36	6,516.31	1.30	0.00	-1.30
12,684.00	89.50	176.40	6,127.30	-6,597.29	510.86	6,608.28	1.90	-0.76	-1.74
12,776.00	89.30	175.70	6,128.26	-6,689.06	517.19	6,700.19	0.79	-0.22	-0.76
12,868.00	88.30	173.60	6,130.19	-6,780.64	525.77	6,791.95	2.53	-1.09	-2.28
12,960.00	90.10	174.40	6,131.47	-6,872.12	535.38	6,883.65	2.14	1.96	0.87
13,052.00	89.80	175.70	6,131.55	-6,963.77	543.32	6,975.48	1.45	-0.33	1.41
13,143.00	91.80	177.30	6,130.28	-7,054.59	548.88	7,066.41	2.81	2.20	1.76
13,235.00	92.10	176.80	6,127.15	-7,146.41	553.61	7,158.33	0.63	0.33	-0.54
13,327.00	91.80	179.30	6,124.02	-7,238.30	556.74	7,250.26	2.74	-0.33	2.72
13,419.00	90.20	179.40	6,122.42	-7,330.28	557.78	7,342.24	1.74	-1.74	0.11
13,511.00	90.80	179.20	6,121.61	-7,422.26	558.90	7,434.22	0.69	0.65	-0.22
13,603.00	91.30	178.30	6,119.93	-7,514.23	560.91	7,526.21	1.12	0.54	-0.98
13,694.00	90.60	179.00	6,118.42	-7,605.19	563.05	7,617.19	1.09	-0.77	0.77
13,786.00	90.70	178.60	6,117.37	-7,697.16	564.98	7,709.19	0.45	0.11	-0.43
13,881.00	89.50	179.80	6,117.21	-7,792.15	566.31	7,804.18	1.79	-1.26	1.26
13,975.00	89.50	179.20	6,118.03	-7,886.14	567.13	7,898.16	0.64	0.00	-0.64
14,068.00	90.70	178.30	6,117.87	-7,979.12	569.16	7,991.15	1.61	1.29	-0.97
14,162.00	90.80	179.80	6,116.64	-8,073.09	570.71	8,085.14	1.60	0.11	1.60
14,256.00	89.80	181.60	6,116.14	-8,167.08	569.57	8,179.06	2.19	-1.06	1.91
14,351.00	90.00	181.60	6,116.31	-8,262.04	566.91	8,273.93	0.21	0.21	0.00
14,446.00	90.20	181.40	6,116.14	-8,357.01	564.43	8,368.80	0.30	0.21	-0.21
14,541.00	90.80	181.50	6,115.32	-8,451.97	562.02	8,463.67	0.64	0.63	0.11
14,636.00	89.20	180.50	6,115.32	-8,546.96	560.37	8,558.58	1.99	-1.68	-1.05
14,730.00	89.50	181.10	6,116.38	-8,640.94	559.05	8,652.50	0.71	0.32	0.64
14,825.00	89.40	180.30	6,117.29	-8,735.93	557.89	8,747.42	0.85	-0.11	-0.84
14,919.00	90.40	179.60	6,117.46	-8,829.93	557.97	8,841.39	1.30	1.06	-0.74
15,014.00	90.50	179.00	6,116.71	-8,924.91	559.13	8,936.38	0.64	0.11	-0.63
15,109.00	91.20	179.10	6,115.30	-9,019.89	560.71	9,031.36	0.74	0.74	0.11
15,204.00	89.60	177.80	6,114.64	-9,114.85	563.28	9,126.36	2.17	-1.68	-1.37
15,299.00	89.70	177.20	6,115.22	-9,209.76	567.42	9,221.34	0.64	0.11	-0.63
15,394.00	88.80	179.10	6,116.46	-9,304.69	570.49	9,316.32	2.21	-0.95	2.00
15,488.00	88.30	178.80	6,118.84	-9,398.65	572.21	9,410.29	0.62	-0.53	-0.32
15,582.00	89.90	178.70	6,120.32	-9,492.61	574.26	9,504.27	1.71	1.70	-0.11
15,677.00	89.90	178.00	6,120.48	-9,587.57	577.00	9,599.27	0.74	0.00	-0.74
15,772.00	90.30	178.40	6,120.32	-9,682.52	579.98	9,694.27	0.60	0.42	0.42

Company:	Bill Barrett Corp.	Local Co-ordinate Reference:	Well Anschutz Eq Farms 4-62-15-0461CH2
Project:	Weld Co., CO	TVD Reference:	WELL @ 4534.00usft (Original Well Elev)
Site:	Sec.15-T4N-R62W	MD Reference:	WELL @ 4534.00usft (Original Well Elev)
Well:	Anschutz Eq Farms 4-62-15-0461CH2	North Reference:	True
Wellbore:	Wellbore #1	Survey Calculation Method:	Minimum Curvature
Design:	Wellbore #1	Database:	EDMDBBW

Survey										
Measured Depth (usft)	Inclination (°)	Azimuth (°)	Vertical Depth (usft)	+N/-S (usft)	+E/-W (usft)	Vertical Section (usft)	Dogleg Rate (°/100usft)	Build Rate (°/100usft)	Turn Rate (°/100usft)	
15,867.00	90.70	178.10	6,119.49	-9,777.47	582.88	9,789.27	0.53	0.42	-0.32	
15,961.00	91.40	178.10	6,117.77	-9,871.41	586.00	9,883.25	0.74	0.74	0.00	
Last Archer Survey										
16,051.00	91.60	177.90	6,115.41	-9,961.32	589.14	9,973.21	0.31	0.22	-0.22	
PTB - Anschutz Eq Farms 4-62-15-0461CH2 tgt										
16,115.00	91.60	177.90	6,113.62	-10,025.25	591.48	10,037.18	0.00	0.00	0.00	

Survey Annotations					
Measured Depth (usft)	Vertical Depth (usft)	Local Coordinates			
		+N/-S (usft)	+E/-W (usft)	Comment	
833.00	833.00	0.21	0.70	First Archer Survey	
16,051.00	6,115.41	-9,961.32	589.14	Last Archer Survey	
16,115.00	6,113.62	-10,025.25	591.48	PTB	

Checked By: _____ Approved By: _____ Date: _____