

LOCATION DRAWING  
WASHINGTON LC12-775 PAD & ADAMS LC12-747 PAD

SECTION: 12  
TOWNSHIP: 9N  
RANGE: 59W

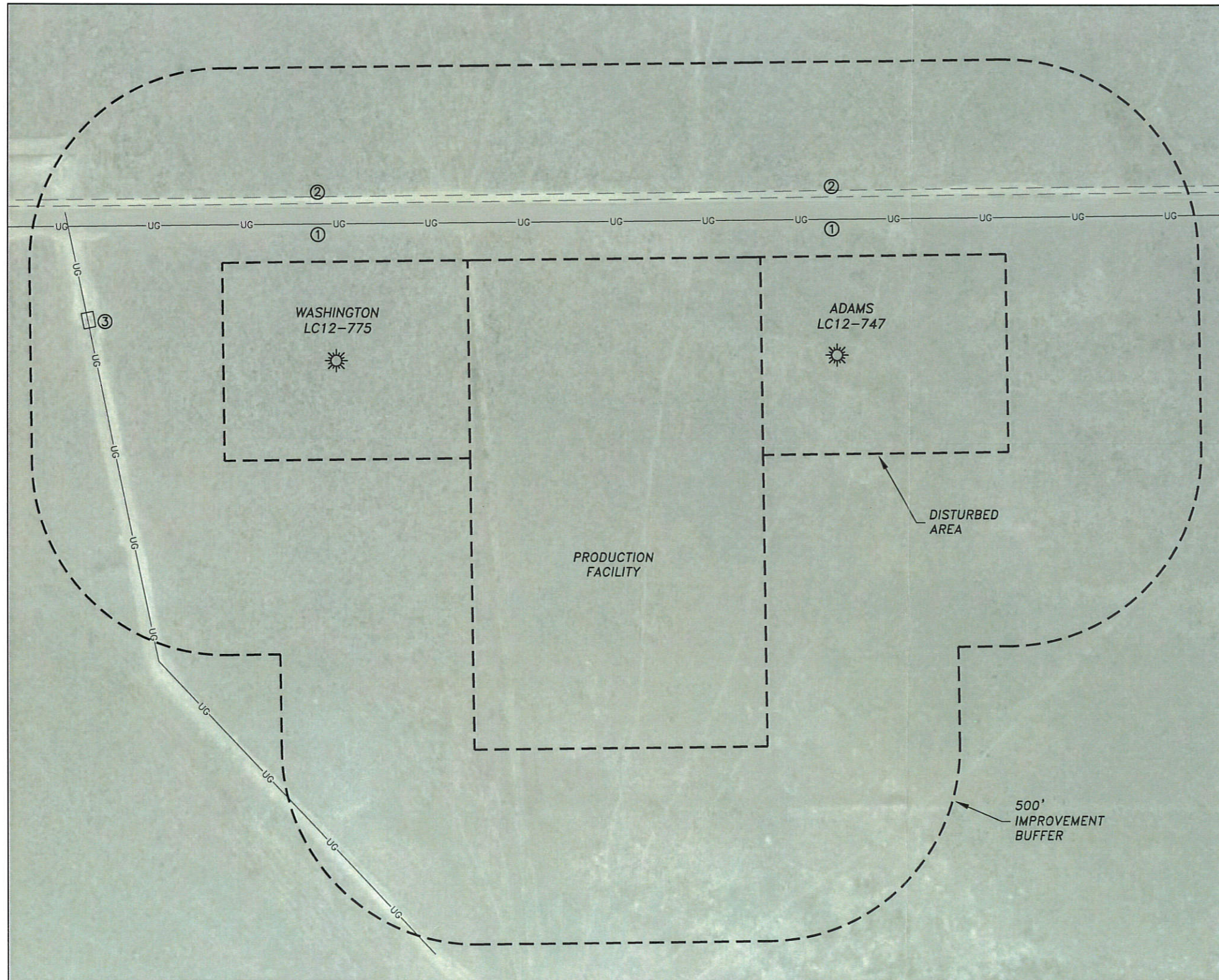

**IMPROVEMENTS:**  
(MEASURED FROM THE PROPOSED WASHINGTON LC12-775 WELL)

1. GAS LINE: 352'± N
2. ACCESS RD.: 405'± N
3. GAS LINE/VALVE: 630'± W

**IMPROVEMENTS:**  
(MEASURED FROM THE PROPOSED ADAMS LC12-747 WELL)

1. GAS LINE: 349'± N
2. ACCESS RD.: 407'± N
3. GAS LINE/VALVE: 1924'± W

**NEAREST CULTURAL ITEMS:**  
(AS MEASURED FROM THE NEAREST PROPOSED WELLHEAD OR LIMITS OF THE PROPOSED PRODUCTION FACILITY, MLVT AREA CLOSEST TO THE REFERENCED CULTURAL ITEM).

1. BUILDING: 5280'+
2. BUILDING UNIT: 5280'+
3. HIGH OCC. BLD. UNIT: 5280'+
4. DES. OUTSIDE ACTIVITY AREA: 5280'+
5. PUBLIC ROAD: 1640'± W
6. ABOVE GROUND UTILITY: 1613'± W
7. RAILROAD: 5280'+
8. PROPERTY LINE: 145'± N

