

T3N, R65W

NW. COR.
SEC. 21, T3N, R65W
FOUND 2 1/2" ALUM. CAP
L.S. NO. 32829

SURFACE LOCATION
GROUND ELEVATION= 4816.6'
NAD 83
LATITUDE= 40.202511°
LONGITUDE= -104.662071°

LATITUDE= 40°12'09.041"
LONGITUDE= -104°39'43.454"

BOTTOM HOLE LOCATION
NAD 83
LATITUDE= 40.218034°
LONGITUDE= -104.660239°

LATITUDE= 40°13'04.924"
LONGITUDE= -104°39'36.859"

BOTTOM OF HOLE:
50' FNL & 246' FEL

NE. COR.
SEC. 21, T3N, R65W
FOUND 3 1/4" BRASS CAP
L.S. NO. 16415

E. 1/4 COR.
SEC. 21, T3N, R65W
FOUND 3 1/4" ALUM. CAP
L.S. NO. 10855

SE. COR.
SEC. 21, T3N, R65W
FOUND 2 1/2" ALUM. CAP
L.S. NO. 23501

CENTER 1/4 COR.
SEC. 21, T3N, R65W
FOUND 2 1/2" ALUM. CAP
L.S. NO. 9644

S. 1/4 COR.
SEC. 21, T3N, R65W
FOUND 2 1/2" ALUM. CAP
L.S. NO. 30120

SW. COR.
SEC. 21, T3N, R65W
SET 2 1/2" ALUM. CAP
L.S. NO. 38305

MATCH LINE
SEE SHEET 1A

21

CERTIFICATE OF SURVEYOR:

THIS IS TO CERTIFY THAT THE ABOVE PLAT WAS PREPARED FROM FIELD NOTES OF ACTUAL SURVEY MADE BY ME OR UNDER MY SUPERVISION AND THAT THE SAME ARE TRUE AND CORRECT TO THE BEST OF MY KNOWLEDGE AND BELIEF. THIS CERTIFICATE DOES NOT REPRESENT A LAND SURVEY PLAT OR IMPROVEMENT SURVEY PLAT AS DEFINED BY C.R.S. 38-51-102 AND CANNOT BE RELIED UPON TO DETERMINE OWNERSHIP.

Benjamin J. Reenders
BENJAMIN J. REENDERS
PROFESSIONAL LAND SURVEYOR
COLORADO REGISTRATION NUMBER 4836
8/20/14

NOTICE:
ACCORDING TO COLORADO STATE LAW YOU MUST COMMENCE ANY LEGAL ACTION BASED UPON ANY DEFECT IN THIS SURVEY WITHIN THREE YEARS AFTER YOU FIRST DISCOVER SUCH DEFECT. IN NO EVENT MAY ANY ACTION BASED UPON ANY DEFECT IN THIS SURVEY BE COMMENCED MORE THAN TEN YEARS FROM THE DATE ON THE CERTIFICATION SHOWN HEREON.

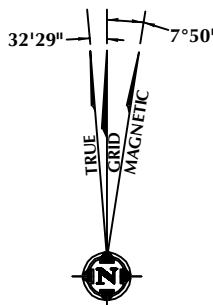

NOTE:
MAGNETIC NORTH IS CURRENT AS OF 7/29/2014.
MAGNETIC NORTH CHANGES WEST 0°08' PER YEAR.

NOTES:

- ▲ INDICATES FOUND SECTION CORNER
- INDICATES CALCULATED CORNER
- ELEVATION BASED ON NAVD88 (GEOID09)
- BASIS OF BEARING DERIVED FROM COLORADO COORDINATE SYSTEM 1983 NORTH ZONE UNLESS OTHERWISE NOTED.
- ALL MEASURED DISTANCES ARE GRID.
- COMBINED SCALE FACTOR: .99972948
- OPERATOR: ROB WILSON / PDOP = 1.4
- SEE ADDENDUM TO WELL LOCATION CERTIFICATE FOR EXISTING IMPROVEMENTS WITHIN 500' OF THE WELL PAD.
- WELL FOOTAGES ARE MEASURED AT RIGHT ANGLES TO THE SECTION LINES.
- THE BOTTOM OF HOLE BEARS N04°37'41"E 5678' FROM THE SURFACE LOCATION.

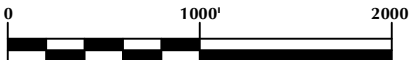

SCALE: 1" = 1000'

WELL PAD - CHEESE 16N-28HZ

CHEESE STATE 26C-21HZ
WELL LOCATION CERTIFICATE
429' FNL & 785' FEL NENE (SURFACE)
LOCATED IN SECTION 28
50' FNL & 246' FEL NENE (BOTTOM)
LOCATED IN SECTION 21
T3N, R65W, 6TH P.M.
WELD COUNTY, COLORADO

**Kerr-McGee Oil &
Gas Onshore L.P.**
1099 18th Street
Denver, Colorado 80202



CONSULTING, LLC

SHERIDAN OFFICE
2155 North Main Street
Sheridan, Wyoming 82801
Phone 307-674-0609

LOVELAND OFFICE
1635 Foxtrail Drive, Suite 204
Loveland, Colorado 80538
Phone 970-776-4331

DRAFTED BY:	LMO	CHECKED BY:	BJR	SHEET NO:
DATE DRAFTED:	8/5/14	DATE SURVEYED:	7/23/14	1B
REVISED:	8/20/14	FILE NAME:	14-46	1B OF 1

K:\ANADARKO\2014\2014_46_MOSER_WELL-STAKING_3N65W\GIS\Maps_ABC\CHEESE 16N-28HZ\CHEESE STATE 26C-21HZ.mxd 8/18/2014 4:17:45 PM

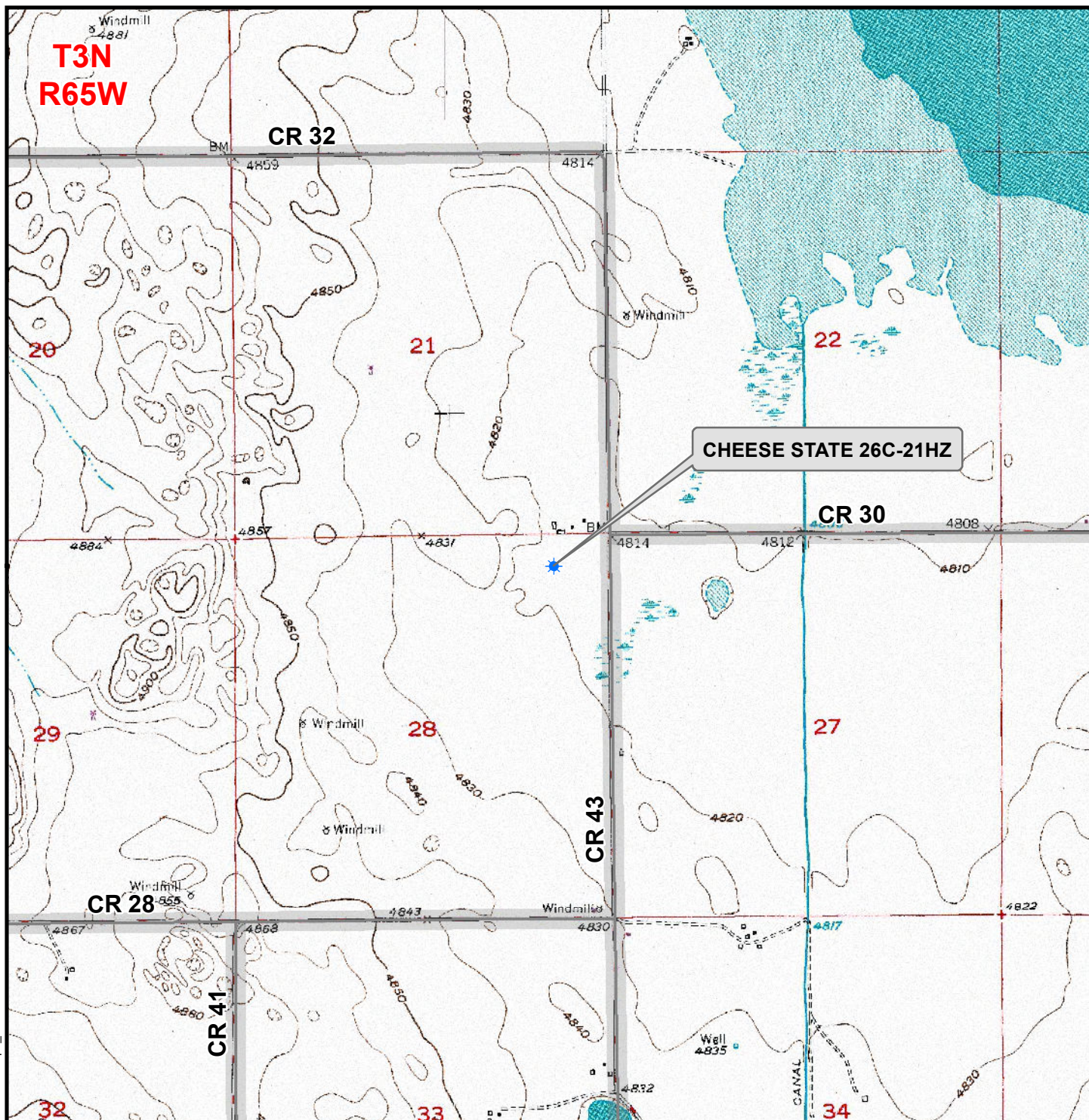

Legend

- ★ Well - State - Proposed ===== Road - Primitive - Existing ——— Road - County - Existing
———— Road - Improved - Existing ——— Road - Highway - Existing

WELL PAD - CHEESE 16N-28HZ

**GENERAL LOCATION MAP
CHEESE STATE 26C-21HZ
LOCATED IN SECTION 28
T3N, R65W, 6th P.M.
WELD COUNTY, COLORADO**

**Kerr-McGee Oil &
Gas Onshore L.P.**

1099 18th Street
Denver, Colorado 80202



CONSULTING, LLC

SHERIDAN OFFICE
2155 North Main Street
Sheridan, Wyoming 82801
Phone 307-674-0609

LOVELAND OFFICE
1635 Foxtail Drive, Suite 204
Loveland, Colorado 80538
Phone 970-776-4331



SCALE: 1" = 2,000ft

NAD83 CO-Nft

DRAWN: TL

DATE: 30 July 2014

REVISED: JELO

DATE: 20 Aug 2014