

NOTE: Under Colorado law, you must commence any legal action based upon any defect in this certificate within three years after defect is discovered. In no event, may any action based upon any defect in this survey be commenced more than ten years after date of this certificate shown hereon. (13-80105 C.R.S.)

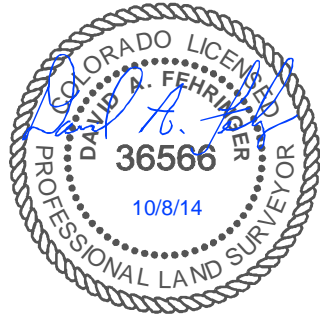

CERTIFICATE OF SURVEYOR

I, David A. Fehring of Lander, Wyoming hereby certify that this well location certificate was prepared from notes taken during an actual survey on SEPTEMBER 21, 2014; and that it correctly shows the drilling location of BONANZA CREEK ENERGY, INC., STATE ANTELOPE 24-1-36XRLNB as staked during said survey. This map does not represent a boundary survey or an improvement location plat and should not be used for the establishment of boundary lines.

NOTES:

- All bearings are GRID based upon the Colorado State Plane Coordinate System, North Zone, NAD83(2011) derived from post-processed static GPS observations.
- Distances are at GROUND
- Vertical Datum is NAVD88 based upon GPS observations
- PDOP value equals 1.3.
- GPS operator: John Stoddard.
- Undisturbed ground elevation at wellhead = 4670.3'
- (M) Measured distance; (R) Record distance
- Nearest Cultural Distances
 - Buildings: 5280+
 - Building Unit: 5280+
 - High Occupancy Building Unit: 5280'+
 - Designated Outside Activity Area: 5280'+
 - Public Road: 5280+
 - Above Ground Utility: 4762'+/-
 - Railroad: 5280'+
 - Property Line: 3835' +/-

WELL COORDINATES

	NAD 83		COLORADO NORTH NAD83	
	LATITUDE	LONGITUDE	NORTHING	EASTING
24-1-36XRLNB	40.42374	104.27565	1399562	3340864
SURFACE	40.42423	104.27361	1399750	3341429
TARGET 1	40.42423	104.27361	1399750	3341429
BOTTOM HOLE	40.45022	104.27392	1409214	3341212

SHEET NO:
1 of 2

Fremont
ENGINEERING & SURVEYING
64 COAL MINE RD.
LANDER, WY 82520
307-349-0840
fes@wyoming.com

Drawn By: DAF
Checked By: KDWK
Date: 10/9/14
Revision:
Date:
Explanation:

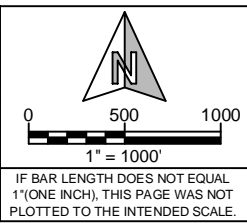

WELL LOCATION CERTIFICATE
STATE ANTELOPE 24-1-36XRLNB
358' FSL, 1411' FWL
SE $\frac{1}{4}$ SW $\frac{1}{4}$, SECTION 1,
T.5N., R.62W., 6th PM
WELD COUNTY, COLORADO

BONANZA CREEK
410 17th Street
Denver, CO 80202
(720) 440-6100

2.5° AC LS28657
LAT 40.45128°N
LONG 104.28140°W

2.5° AC LS38019
LAT 40.45182°N
LONG 104.26199°W

N87°03'57"E - 5309.34' (M)

BOTTOM HOLE LOCATION

1980'

460'

N01°11'40"W - 5101.38' (M)

S00°04'58"E - 5254.26' (M)

T.6N R.62W
36

N01°18'46"W - 9466.53'
FROM TARGET TO BH

2.5° AC LS32828
LAT 40.43728°N
LONG 104.28092°W

3.25° AC LS7242
LAT 40.43740°N
LONG 104.28222°W

N88°42'12"E - 5204.98' (M)

NOTE: Under Colorado law, you must commence any legal action based upon any defect in this certificate within three years after defect is discovered. In no event, may any action based upon any defect in this survey be commenced more than ten years after date of this certificate shown hereon. (13-80105 C.R.S.)

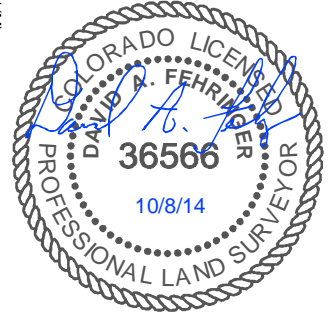

CERTIFICATE OF SURVEYOR

I, David A. Fehring of Lander, Wyoming hereby certify that this well location certificate was prepared from notes taken during an actual survey on SEPTEMBER 21, 2014; and that it correctly shows the drilling location of BONANZA CREEK ENERGY, INC., STATE ANTELOPE 24-1-36XRLNB as staked during said survey. This map does not represent a boundary survey or an improvement location plat and should not be used for the establishment of boundary lines.

NOTES:

- All bearings are GRID based upon the Colorado State Plane Coordinate System, North Zone, NAD83(2011) derived from post-processed static GPS observations.
- Distances are at GROUND
- Vertical Datum is NAVD88 based upon GPS observations
- PDOP value equals 1.3.
- GPS operator: John Stoddard.
- Undisturbed ground elevation at wellhead = 4670.3'
- (M) Measured distance; (R) Record distance
- Nearest Cultural Distances
 - Buildings: 5280+
 - Building Unit: 5280+
 - High Occupancy Building Unit: 5280'+
 - Designated Outside Activity Area: 5280'+
 - Public Road: 5280+
 - Above Ground Utility: 4762'+/-
 - Railroad: 5280'+
 - Property Line: 3835' +/-

WELL COORDINATES

	NAD 83		COLORADO NORTH NAD83	
	LATITUDE	LONGITUDE	NORTHING	EASTING
24-1-36XRLNB	40.42374	104.27565	1399562	3340864
SURFACE	40.42423	104.27361	1399750	3341429
TARGET 1	40.45022	104.27392	1409214	3341212
BOTTOM HOLE				

SHEET NO:

2 of 2



Drawn By: DAF
Checked By: KDWK
Date: 10/9/14
Revision:
Date:
Explanation:

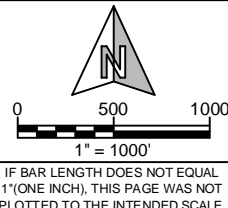

WELL LOCATION CERTIFICATE

STATE ANTELOPE 24-1-36XRLNB
460' FNL, 1980' FWL
NE $\frac{1}{4}$ NW $\frac{1}{4}$, SECTION 36,
T.6N., R.62W., 6th PM
WELD COUNTY, COLORADO

