

C:\FES PROJECTS\1319-01\_BONANZA\5N-62W.dwg SECTION 1\_LAYOUT.dwg SAVED DATE 2014-10-13 11:22

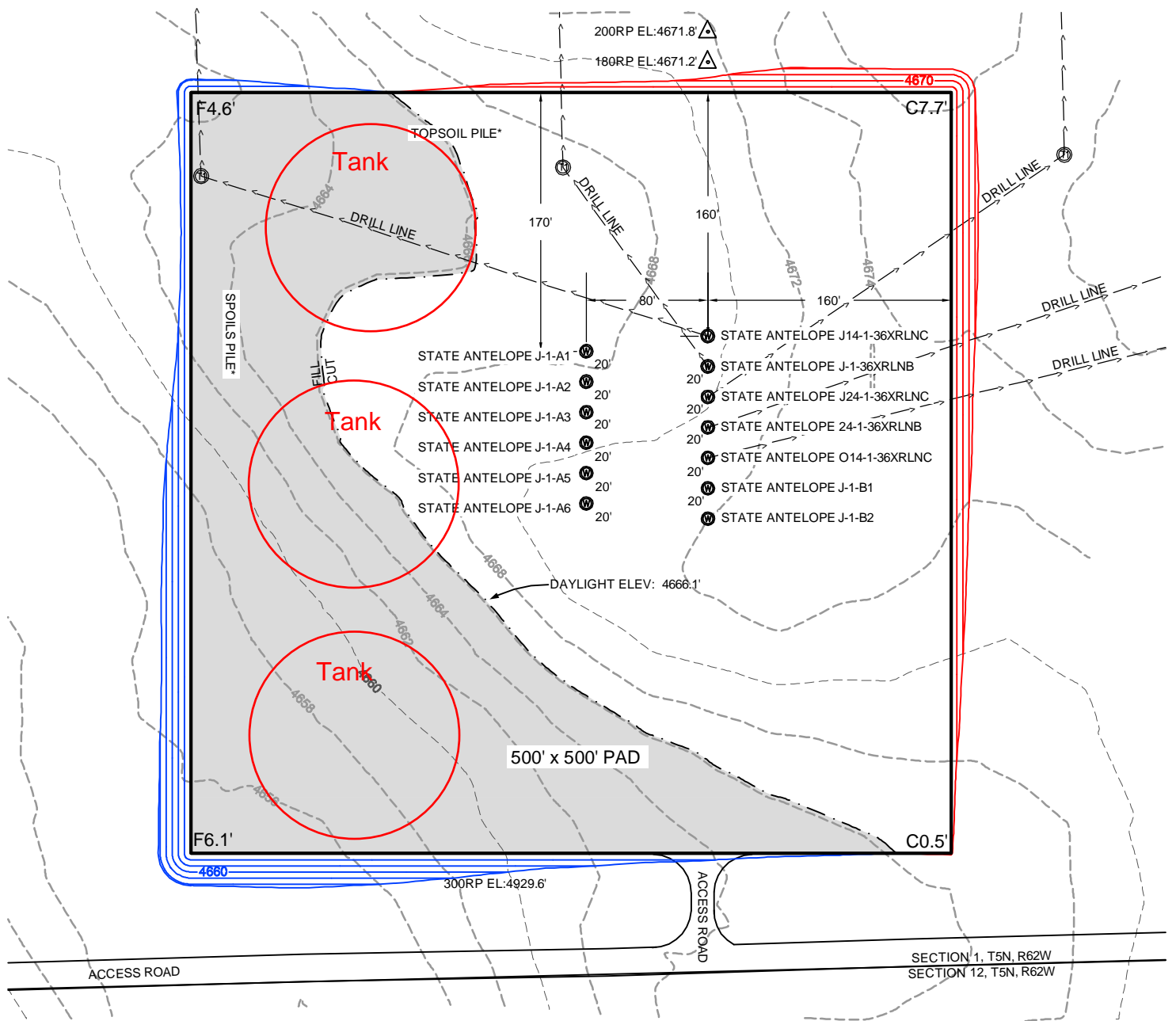

DESIGN INFORMATION & EARTH VOLUMES  
EXISTING GRADE @ CENTER LOCATIONS = 4,669.5'  
DESIGN GRADE OF PAD = 4666.5'  
CUT SLOPES = 2.0:1  
FILL SLOPES = 2.0:1  
TOTAL CUT FOR WELL PAD = 23,619 C.Y.  
TOTAL FILL FOR WELL PAD = 17,311 C.Y.  
TOPSOIL @ 6" DEPTH (ESTIMATED) = 4,400 C.Y.  
SHRINKAGE (10%) = 1,925 C.Y.  
EXCESS MATERIAL = 14 C.Y.  
TOTAL DISTURBANCE OF PAD = 6.3 AC. +/-

WELL TABULATION (A LINE)  
STATE ANTELOPE J-1-A1  
SURFACE (410'FSL;1332FWL)  
STATE ANTELOPE J-1-A2  
SURFACE (390'FSL;1332FWL)  
STATE ANTELOPE J-1-A3  
SURFACE (370'FSL;1331FWL)  
STATE ANTELOPE J-1-A4  
SURFACE (350'FSL;1331FWL)  
STATE ANTELOPE J-1-A5  
SURFACE (330'FSL;1330FWL)  
STATE ANTELOPE J-1-A6  
SURFACE (310'FSL;1330FWL)

WELL TABULATION (B LINE)  
STATE ANTELOPE J-14-36XRLNC  
SURFACE (418'FSL;1413FWL)  
STATE ANTELOPE J-1-36XRLNB  
SURFACE (397'FSL;1412FWL)  
STATE ANTELOPE J-24-36XRLNC  
SURFACE (377'FSL;1412FWL)  
STATE ANTELOPE J-24-1-36XRLNB  
SURFACE (357'FSL;1411FWL)  
STATE ANTELOPE O24-1-36XRLNC  
SURFACE (337'FSL;1411FWL)  
STATE ANTELOPE J-1-B1  
SURFACE (317'FSL;1410FWL)  
STATE ANTELOPE J-1-B2  
SURFACE (297'FSL;1410FWL)

NOTES:  
• PDOP value equals 1.4.  
• GPS operator: John Stoddard.  
• Vegetation: Range Grass  
• Surface Use: Range  
• Contour Elevation = 2'  
• Contractor shall place topsoil and spoils piles at owners discretion.  
• Facilities placement recommended for cut areas.  
• Nearest Cultural Distances (Facilities)  
Buildings: 5280+  
Building Unit: 5280+  
High Occupancy Building Unit: 5280+  
Designated Outside Activity Area: 5280+  
Public Road: 5280+  
Above Ground Utility: 4542'+/-  
Railroad: 5280+  
Property Line: 3672' +/-

**Fremont**  
ENGINEERING & SURVEYING  
64 COAL MINE RD.  
LANDER, WY 82520  
307-349-0840  
fes@wyoming.com

Drawn By: DAF  
Checked By: KDWK  
Date: 9/28/14  
Revision:  
Date:  
Explanation:

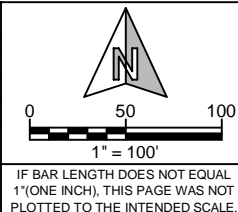

#### PROPOSED LAYOUT

STATE ANTELOPE J-I PAD  
SW 1/4, SECTION 1,  
T.5N., R.62W., 6th PM  
WELD COUNTY, COLORADO



410 17th Street  
Denver, CO 80202  
(720) 440-6100

SHEET  
1  
OF  
9