

K:\BONANZA CREEK\2014_61_CROW VALLEY_SEC_18_T7N_R62W\GIS\Maps_ABC\CrowValley V-21 Hydro.mxd 9/15/2014 2:59:43 PM

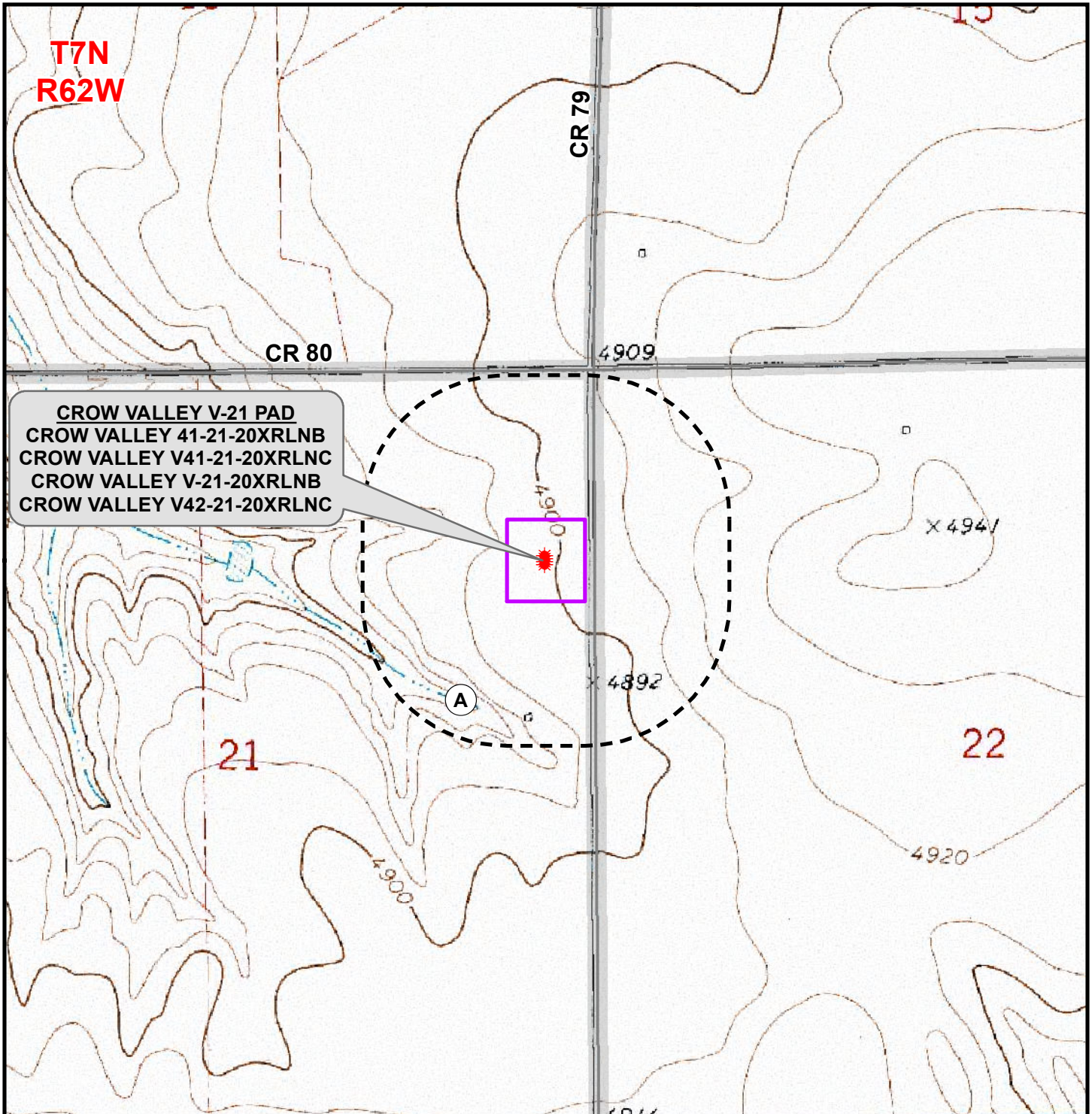

Legend

- Well -Proposed
- 1,000ft Disturbance Buffer
- Disturbed Area

A - DRAINAGE ±1,102ft SW

* All distances measured to reference well: CROW VALLEY V-21-20XRLNB

WELL PAD - CROW VALLEY V-21

HYDROLOGY MAP
 CROW VALLEY 41-21-20XRLNB,
 CROW VALLEY V41-21-20XRLNC,
 CROW VALLEY V-21-20XRLNB &
 CROW VALLEY V42-21-20XRLNC
 LOCATED IN E1/2 NE1/4
 SECTION 21, T7N, R62W, 6th P.M.
 WELD COUNTY, COLORADO



410 17th Street, Suite 1400
 Denver, Colorado 80202



CONSULTING, LLC

SHERIDAN OFFICE 2155 North Main Street Sheridan, Wyoming 82801 Phone 307-674-0609
 LOVELAND OFFICE 1635 Foxtail Drive, Suite 204 Loveland, Colorado 80538 Phone 970-776-4331



SCALE: 1" = 1,000ft

NAD83 CO-Nft

DRAWN: JELo

DATE: 5 Sept 2014

REVISED:

DATE: