

# Great Western Operating Company, LLC

Location Colorado  
Field Wattenberg  
Installation Beierle

Slot Slot #14  
Well Beierle KE 26-361HN  
Wellbore Beierle KE 26-361HN (PWB)

## WELL PROFILE DATA

Point	MD	Inc	Azi	TVD	North	East	deg/100ft	V. Sect
Tie on	16.20	0.00	0.00	16.20	0.00	0.00	0.00	0.00
KOP	4100.00	0.00	0.00	4100.00	0.00	0.00	0.00	0.00
End of Build	5132.41	30.97	74.33	5082.86	73.53	262.20	3.00	25.94
End of Hold	7445.60	30.97	74.33	7066.23	394.96	1408.41	0.00	139.32
Target EP - 460 FNL, 1	8197.49	90.00	179.52	7499.00	-39.63	1662.77	13.00	636.38
T.D. & Target TD - 470	12555.47	90.00	179.52	7499.00	-4397.45	1699.52	0.00	4714.44

East (feet) ->

1600 1200 800 400 0 -400 -800 -1200 -1600 -2000

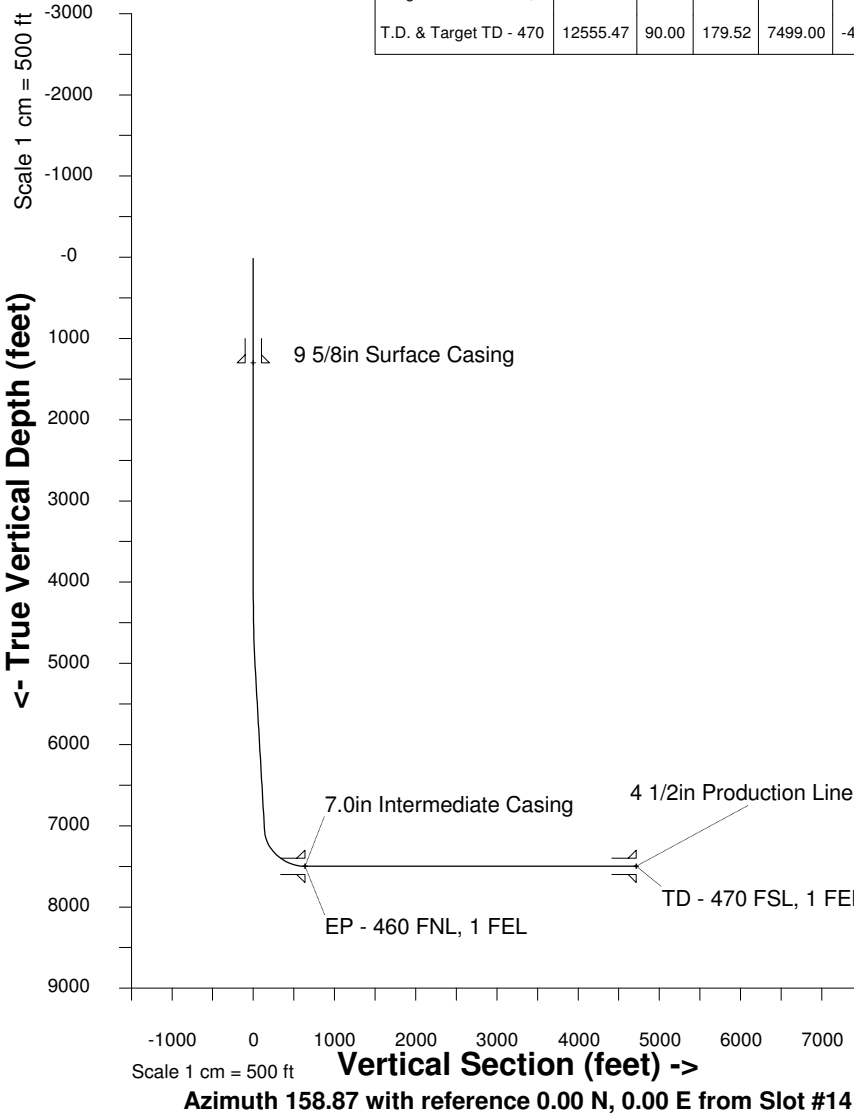

Created by admin  
Date plotted 12-Sep-2014  
Plot reference is Beierle KE 26-361HN (PWB).  
Ref wellpath is Beierle KE 26-361HN (PWP#1).  
Coordinates are in feet reference Slot #14.  
True Vertical Depths are reference Rig Datum.  
Measured Depths are reference Rig Datum.  
Rig Datum: Planned Datum #1  
Rig Datum to Mean Sea Level: 5133.50 ft.  
Plot North is aligned to GRID North.

