

GREAT WESTERN OIL & GAS COMPANY

PRODUCTION FACILITY LAYOUT FOR

KODAK SOUTH FD 26-A, 25-202HC, 25-239HN, 25-279HN, 27-299HN,
27-259HC, 27-222HN, 26-B, 25-399HN, 25-362HN, 25-319HN, 25-282HC,
27-339HN, 27-339HC, 27-379HN & 27-382HN
SECTION 26, T6N, R67W, 6th P.M.
SE 1/4 SW 1/4

FIGURE #4

SCALE: 1" = 100'
DATE: 11-02-13
DRAWN BY: J.S.
REV: 03-23-14
REV: 05-22-14 J.W.

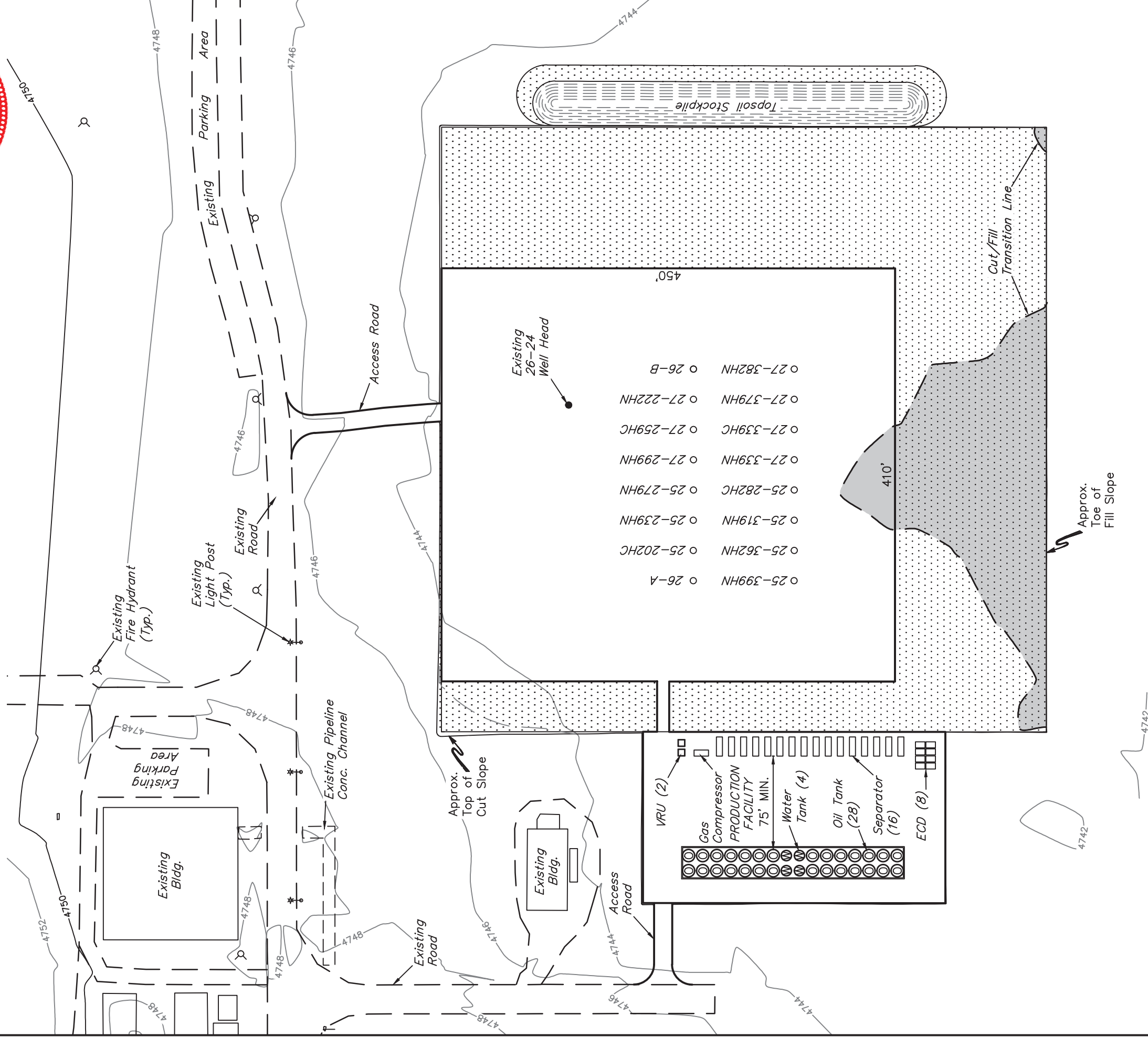

RECLAIMED AREA

APPROXIMATE ACREAGE
RECLAIMED = ± 4.344 ACRES
UN-RECLAIMED = ± 5.885 ACRES
TOTAL = ± 10.229 ACRES

85 So. 200 East * Vernal, Utah 84078 * (435) 789-1017