

GREAT WESTERN OIL & GAS COMPANY

CONSTRUCTION LAYOUT FOR

KODAK SOUTH FD 26-A, 25-202HC, 25-239HN, 25-279HN, 27-299HN,
27-259HC, 27-222HN, 26-B, 25-399HN, 25-362HN, 25-319HN, 25-282HC,
27-339HN, 27-339HC, 27-379HN & 27-382HN
SECTION 26, T6N, R67W, 6th P.M.
SE 1/4 SW 1/4

FIGURE #1

SCALE: 1" = 100'
DATE: 11-02-13
DRAWN BY: J.S.
REV: 03-23-14
REV: 05-22-14 J.W.

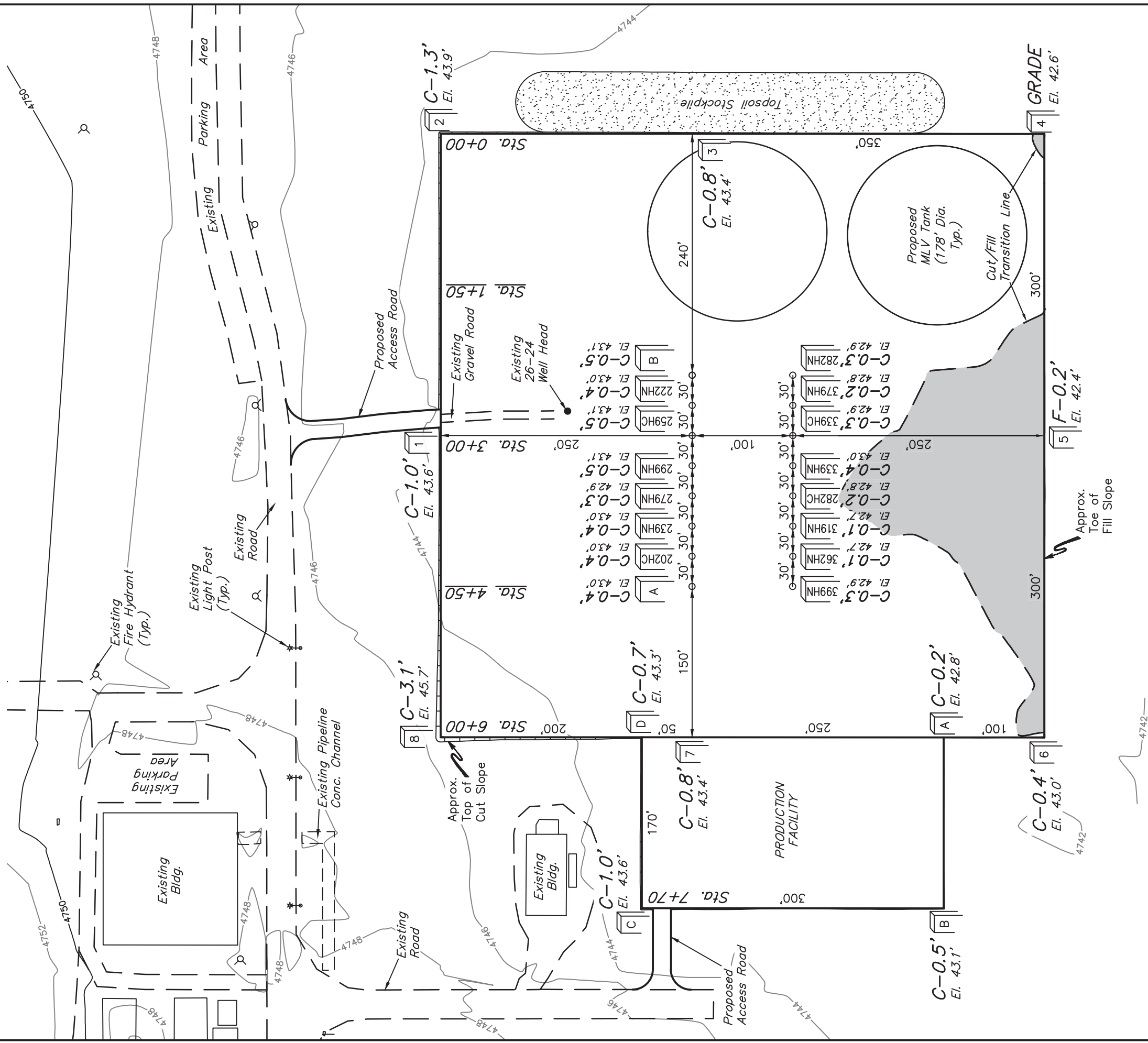

Elev. Ungraded Ground At 27-259HC Loc. Stake = 4743.1'
FINISHED GRADE ELEV. AT 27-259HC LOC. STAKE = 4742.6'

UTAH ENGINEERING & LAND SURVEYING
85 So. 200 East * Vernal, Utah 84078 * (435) 789-1017

X-Section
Scale
1" = 100'
DATE: 11-02-13
DRAWN BY: J.S.
REV: 03-23-14

GREAT WESTERN OIL & GAS COMPANY
CONSTRUCTION LAYOUT CROSS SECTIONS FOR
KODAK SOUTH FD 26-A, 25-202HC, 25-239HN, 25-279HN, 27-299HN,
27-259HC, 27-222HN, 26-B, 25-399HN, 25-362HN, 25-319HN, 25-282HC,
27-339HN, 27-339HC, 27-379HN & 27-382HN
SECTION 26, T6N, R67W, 6th P.M.
SE 1/4 SW 1/4

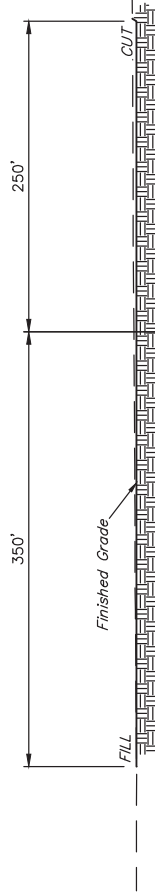
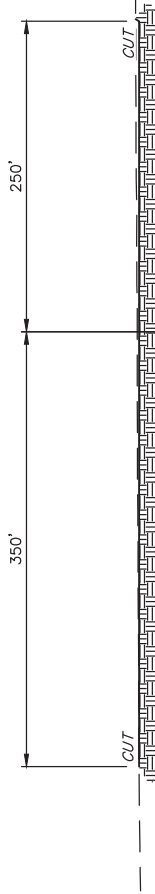
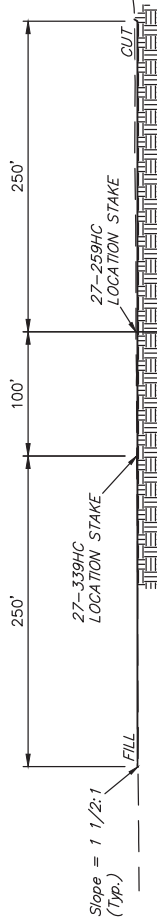
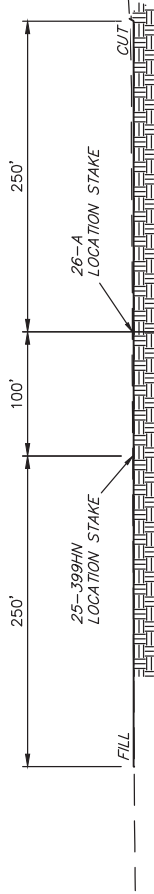
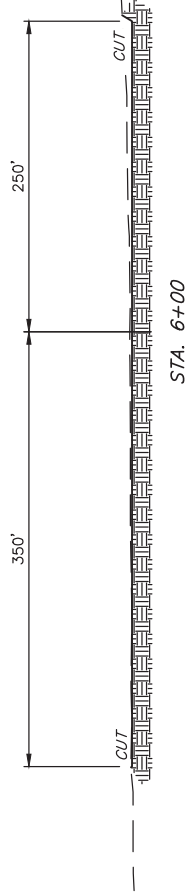
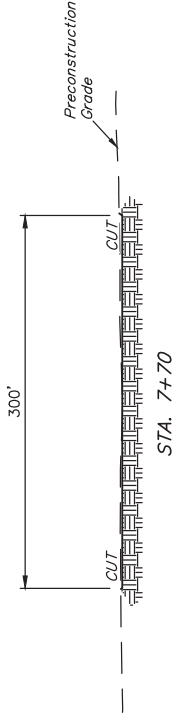

NOTE:
Topsoil should not be
Stripped Below Finished
Grade on Substructure Area.

* NOTE:
FILL QUANTITY INCLUDES
5% FOR COMPACTION

APPROXIMATE YARDAGES

(6") Topsoil Stripping = 7,670 Cu. Yds.
Remaining Location = 2,470 Cu. Yds.
TOTAL CUT = 10,140 CU. YDS.
FILL = 2,470 CU. YDS.

EXCESS MATERIAL
Topsoil = 7,670 Cu. Yds.
EXCESS UNBALANCE = 0 Cu. Yds.
(After Interim Rehabilitation)

APPROXIMATE ACREAGE
WELL SITE DISTURBANCE =
ACCESS ROAD DISTURBANCE =
TOTAL =

UNINTAH ENGINEERING & I
85 So. 200 East • Vernal, Utah 8407