



Lat40°, Inc. 1635 Foxtrail Drive, Suite 325 Loveland, CO 970-776-3321

NOTIFICATION ZONE DRAWING

SUDEN 34U-HZ PAD

SECTION: 34
TOWNSHIP: 5N
RANGE: 64W

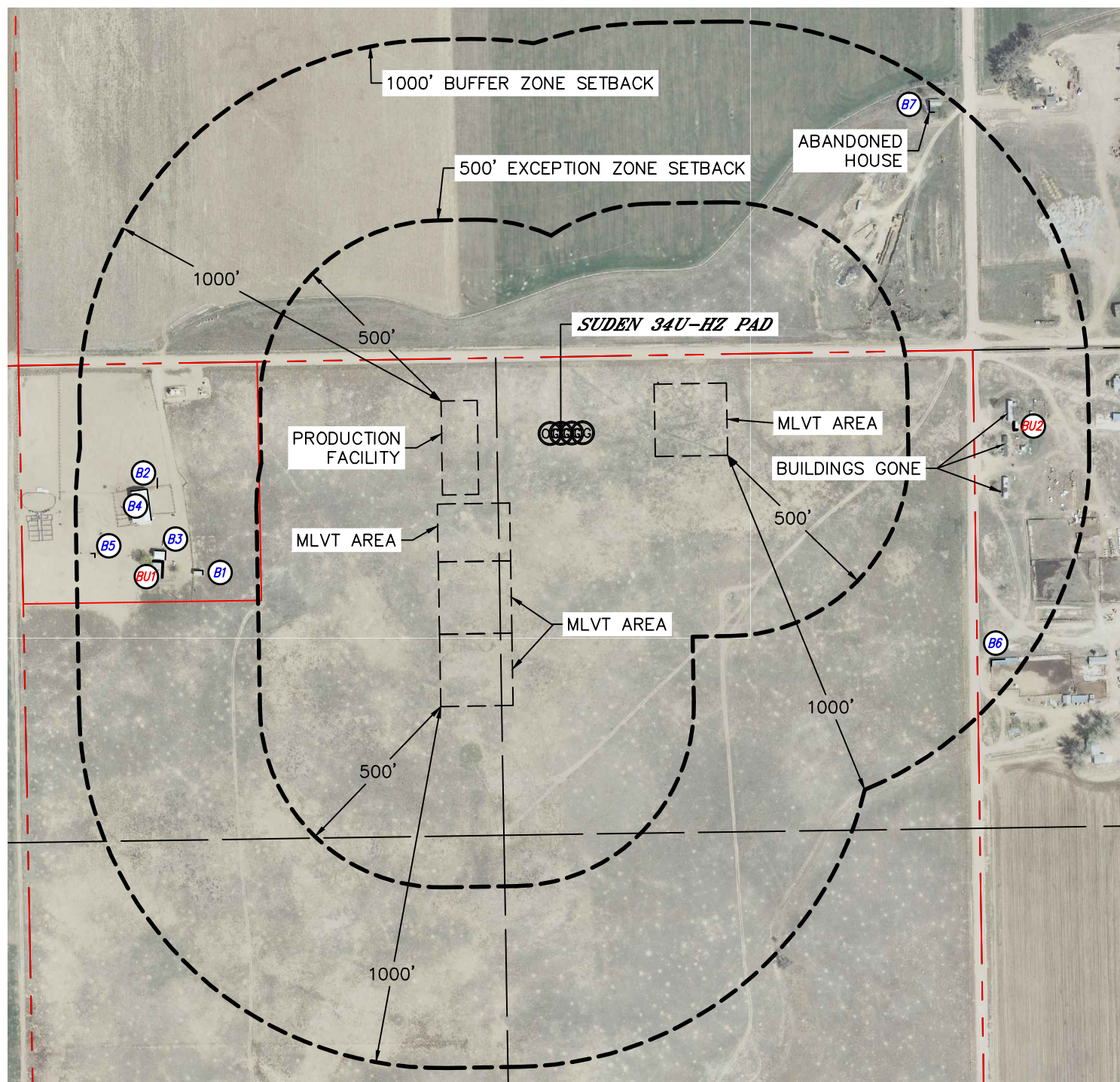

EXCEPTION ZONE:

NO EXISTING BUILDING UNITS WITH EXCEPTION ZONE

BUFFER ZONE:

- BUILDING UNIT BU1 ±761' W
- BUILDING UNIT BU2 ±792' E

LEGEND

- PROPERTY LINE
- BUILDING
- BUILDING UNIT

(DISTANCES MEASURED FROM THE CENTER OF THE PROPOSED WELL HEAD OR LIMITS OF THE PROPOSED PRODUCTION FACILITY CLOSEST TO REFERENCED BUILDING UNIT)

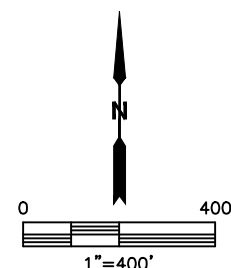

DATE: 10/30/2014
PROJECT#: 2013181