

KOCH EXPLORATION COMPANY
WRD FEDERAL #30-34 ON EXISTING #29-31 PAD
LOCATED IN RIO BLANCO COUNTY, COLORADO
SECTION 29, T2N, R96W, 6th P.M.

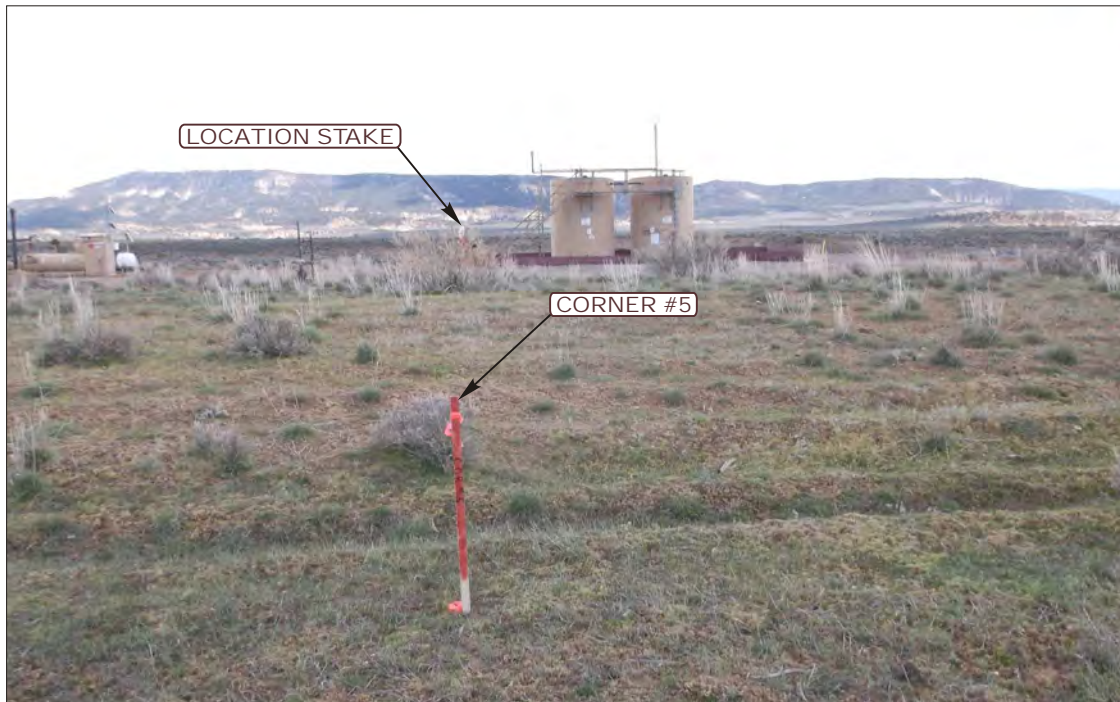

PHOTO: VIEW FROM CORNER #5 TO LOCATION STAKE

CAMERA ANGLE: SOUTHEASTERLY



PHOTO: VIEW FROM BEGINNING OF EXISTING ACCESS

CAMERA ANGLE: SOUTHWESTERLY



- Since 1964 -

U&LS Uintah Engineering & Land Surveying
85 South 200 East Vernal, Utah 84078
(435) 789-1017 * FAX (435) 789-1813

LOCATION PHOTOS

03 **18** **13**
MONTH DAY YEAR

PHOTO

P1

TAKEN BY: M.P.

DRAWN BY: C.L.

REV: 04-21-14 J.M.F.

KOCH EXPLORATION COMPANY
WRD FEDERAL #30-34 ON EXISTING #29-31 PAD
LOCATED IN RIO BLANCO COUNTY, COLORADO
SECTION 29, T2N, R96W, 6th P.M.



PHOTO: VIEW OF LOCATION STAKE

CAMERA ANGLE: NORTHERLY



PHOTO: VIEW OF LOCATION STAKE

CAMERA ANGLE: EASTERLY



- Since 1964 -

UELS Uintah Engineering & Land Surveying
85 South 200 East Vernal, Utah 84078
(435) 789-1017 * FAX (435) 789-1813

LOCATION PHOTOS

03 **18** **13**
MONTH DAY YEAR

TAKEN BY: M.P.

DRAWN BY: C.I.

REV: 04-21-14 J.M.F.

PHOTO
P2

KOCH EXPLORATION COMPANY
WRD FEDERAL #30-34 ON EXISTING #29-31 PAD
 LOCATED IN RIO BLANCO COUNTY, COLORADO
 SECTION 29, T2N, R96W, 6th P.M.



PHOTO: VIEW OF LOCATION STAKE

CAMERA ANGLE: SOUTHERLY



PHOTO: VIEW OF LOCATION STAKE

CAMERA ANGLE: WESTERLY



- Since 1964 -



Uintah Engineering & Land Surveying
 85 South 200 East Vernal, Utah 84078
 (435) 789-1017 * FAX (435) 789-1813

LOCATION PHOTOS

03	18	13
MONTH	DAY	YEAR

PHOTO

P3

TAKEN BY: M.P.

DRAWN BY: C.I.

REV: 04-21-14 J.M.F.