

# KERR-MCGEE OIL & GAS ONSHORE LP

Location: COLORADO Slot: SLOT#22 DOLPH 2N-1HZ (662'FSL & 755'FEL, SEC.1)  
 Field: WELD COUNTY (KERR MCGEE) Well: DOLPH 2N-1HZ  
 Facility: SEC.01-T2N-R66W Wellbore: DOLPH 2N-1HZ PWB



Plot reference wellpath is DOLPH 2N-1HZ (REV-B.0) PWB

True vertical depths are referenced to ENSIGN 145 (13KB) (RKB)	Grid System: NAD83 / Lambert Colorado SP, Northern Zone (501), US feet
Measured depths are referenced to ENSIGN 145 (13KB) (RKB)	North Reference: True north
ENSGN 145 (13KB) (RKB) to Mean Sea Level: 5001 feet	Scale: True distance
Mean Sea Level to Mud line (At Slot: SLOT#22 DOLPH 2N-1HZ (662'FSL & 755'FEL, SEC.1)): 0 feet	Depths are in feet
Coordinates are in feet referenced to Slot	Created by: preccain on 13/Oct/2014

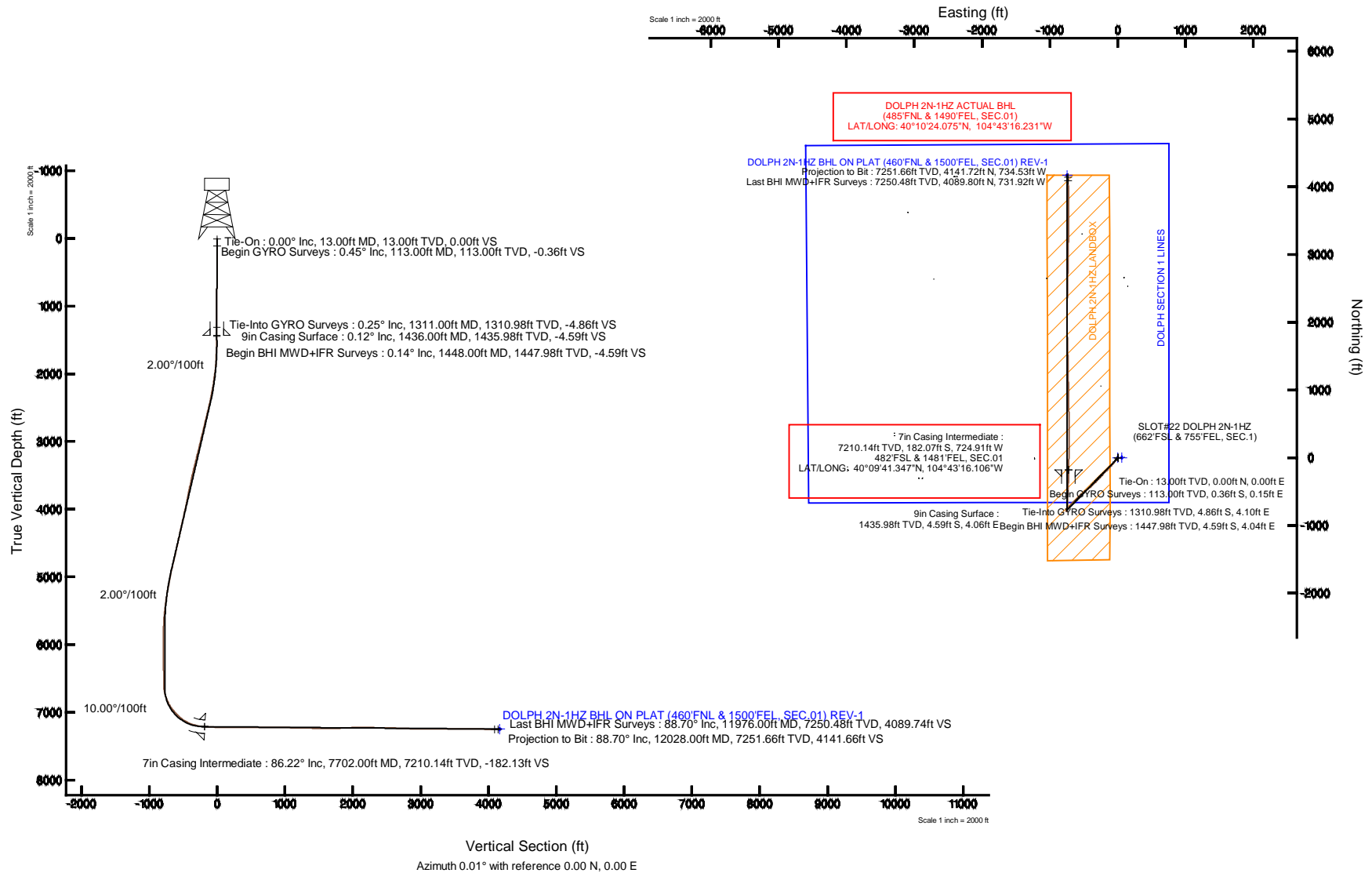

REFERENCE WELLPATH IDENTIFICATION			
Operator	<b>KERR-MCGEE OIL &amp; GAS ONSHORE LP</b>	Slot	<b>SLOT#22 DOLPH 2N-1HZ (662'FSL &amp; 755'FEL, SEC.1)</b>
Area	<b>COLORADO</b>	Well	<b>DOLPH 2N-1HZ</b>
Field	<b>WELD COUNTY (KERR MCGEE)</b>	Wellbore	<b>DOLPH 2N-1HZ AWB</b>
Facility	<b>SEC.01-T2N-R66W</b>		

REPORT SETUP INFORMATION			
Projection System	<b>NAD83 / Lambert Colorado SP, Northern Zone (501), US feet</b>	Software System	<b>WellArchitect® 4.0.0</b>
North Reference	<b>True</b>	User	<b>Precain</b>
Scale	<b>0.999958</b>	Report Generated	<b>13/Oct/2014 at 15:07</b>
Convergence at slot	<b>n/a</b>	Database/Source file	<b>WellArchitectDB/DOLPH_2N-1HZ_AWB.xml</b>

WELLPATH LOCATION						
	Local coordinates		Grid coordinates		Geographic coordinates	
	North[ft]	East[ft]	Easting[US ft]	Northing[US ft]	Latitude	Longitude
Slot Location	-362.26	3290.57	3218404.05	1302816.63	<b>40°09'43.146"N</b>	<b>104°43'06.769"W</b>
Facility Reference Pt			3215110.60	1303150.30	<b>40°09'46.728"N</b>	<b>104°43'49.152"W</b>
Field Reference Pt			<b>3197771.84</b>	<b>1268891.29</b>	40°04'09.600"N	104°47'36.000"W

WELLPATH DATUM			
Calculation method	<b>Minimum curvature</b>	ENSIGN 145 (13'KB) (RKB) to Facility Vertical Datum	<b>5001.00ft</b>
Horizontal Reference Pt	<b>Slot</b>	ENSIGN 145 (13'KB) (RKB) to Mean Sea Level	<b>5001.00ft</b>
Vertical Reference Pt	<b>ENSIGN 145 (13'KB) (RKB)</b>	ENSIGN 145 (13'KB) (RKB) to Mud Line at Slot (SLOT#22 DOLPH 2N-1HZ (662'FSL & 755'FEL, SEC.1))	<b>5001.00ft</b>
MD Reference Pt	<b>ENSIGN 145 (13'KB) (RKB)</b>	Section Origin	<b>N 0.00, E 0.00 ft</b>
Field Vertical Reference	<b>Mean Sea Level</b>	Section Azimuth	<b>0.01°</b>

REFERENCE WELLPATH IDENTIFICATION				
Operator	KERR-MCGEE OIL & GAS ONSHORE LP		Slot	SLOT#22 DOLPH 2N-1HZ (662'FSL & 755'FEL, SEC.1)
Area	COLORADO		Well	DOLPH 2N-1HZ
Field	WELD COUNTY (KERR MCGEE)		Wellbore	DOLPH 2N-1HZ AWB
Facility	SEC.01-T2N-R66W			

WELLPATH DATA (145 stations) † = interpolated/extrapolated station										
MD [ft]	Inclination [°]	Azimuth [°]	TVD [ft]	Vert Sect [ft]	North [ft]	East [ft]	Latitude	Longitude	DLS [°/100ft]	Comments
0.00†	0.000	158.080	0.00	0.00	0.00	0.00	40°09'43.146"N	104°43'06.769"W	0.00	
13.00	0.000	158.080	13.00	0.00	0.00	0.00	40°09'43.146"N	104°43'06.769"W	0.00	Tie-On
113.00	0.450	158.080	113.00	-0.36	-0.36	0.15	40°09'43.142"N	104°43'06.767"W	0.45	Begin GYRO Surveys
213.00	0.330	152.420	213.00	-0.98	-0.98	0.43	40°09'43.136"N	104°43'06.764"W	0.13	
313.00	0.400	128.300	312.99	-1.46	-1.46	0.83	40°09'43.132"N	104°43'06.758"W	0.17	
413.00	0.510	138.410	412.99	-2.00	-2.00	1.40	40°09'43.126"N	104°43'06.751"W	0.14	
513.00	0.350	151.010	512.99	-2.60	-2.60	1.85	40°09'43.120"N	104°43'06.745"W	0.18	
613.00	0.490	150.990	612.99	-3.25	-3.25	2.20	40°09'43.114"N	104°43'06.741"W	0.14	
713.00	0.360	168.970	712.98	-3.93	-3.93	2.47	40°09'43.107"N	104°43'06.737"W	0.18	
813.00	0.390	161.250	812.98	-4.56	-4.56	2.64	40°09'43.101"N	104°43'06.735"W	0.06	
913.00	0.250	154.320	912.98	-5.08	-5.08	2.84	40°09'43.096"N	104°43'06.732"W	0.14	
1013.00	0.180	99.380	1012.98	-5.30	-5.30	3.09	40°09'43.094"N	104°43'06.729"W	0.21	
1113.00	0.240	87.280	1112.98	-5.32	-5.32	3.46	40°09'43.093"N	104°43'06.724"W	0.07	
1213.00	0.250	54.630	1212.98	-5.18	-5.18	3.84	40°09'43.095"N	104°43'06.719"W	0.14	
1311.00	0.250	21.170	1310.98	-4.86	-4.86	4.10	40°09'43.098"N	104°43'06.716"W	0.15	Tie-Into GYRO Surveys
1448.00	0.140	266.500	1447.98	-4.59	-4.59	4.04	40°09'43.101"N	104°43'06.717"W	0.24	Begin BHI MWD+IFR Surveys
1541.00	2.410	228.030	1540.95	-5.90	-5.90	2.47	40°09'43.088"N	104°43'06.737"W	2.48	
1634.00	3.860	237.150	1633.81	-8.91	-8.91	-1.62	40°09'43.058"N	104°43'06.790"W	1.64	
1728.00	3.510	236.030	1727.61	-12.23	-12.23	-6.66	40°09'43.025"N	104°43'06.855"W	0.38	
1821.00	5.570	232.300	1820.32	-16.58	-16.58	-12.59	40°09'42.982"N	104°43'06.931"W	2.24	
1915.00	7.530	216.790	1913.70	-24.31	-24.31	-19.89	40°09'42.906"N	104°43'07.025"W	2.79	
2008.00	9.030	214.290	2005.73	-35.22	-35.22	-27.65	40°09'42.798"N	104°43'07.125"W	1.66	
2102.00	10.230	220.480	2098.41	-47.67	-47.66	-37.23	40°09'42.675"N	104°43'07.249"W	1.68	
2195.00	11.990	217.400	2189.66	-61.62	-61.62	-48.46	40°09'42.537"N	104°43'07.393"W	2.00	
2289.00	14.040	217.700	2281.24	-78.40	-78.40	-61.36	40°09'42.371"N	104°43'07.559"W	2.18	
2383.00	15.450	220.460	2372.15	-96.95	-96.95	-76.46	40°09'42.188"N	104°43'07.754"W	1.68	
2476.00	17.350	224.370	2461.36	-116.30	-116.29	-94.20	40°09'41.997"N	104°43'07.982"W	2.36	
2566.00	18.370	223.250	2547.02	-136.22	-136.21	-113.30	40°09'41.800"N	104°43'08.228"W	1.20	
2656.00	18.430	221.180	2632.42	-157.26	-157.25	-132.38	40°09'41.592"N	104°43'08.474"W	0.73	
2746.00	18.130	223.400	2717.88	-178.14	-178.13	-151.37	40°09'41.386"N	104°43'08.719"W	0.84	
2836.00	18.160	225.780	2803.41	-198.10	-198.09	-171.05	40°09'41.188"N	104°43'08.972"W	0.82	
2926.00	19.020	225.500	2888.71	-218.16	-218.15	-191.56	40°09'40.990"N	104°43'09.236"W	0.96	
3016.00	18.690	223.830	2973.88	-238.85	-238.83	-212.00	40°09'40.786"N	104°43'09.500"W	0.70	
3106.00	18.040	222.650	3059.30	-259.50	-259.48	-231.43	40°09'40.582"N	104°43'09.750"W	0.83	
3195.00	19.170	225.360	3143.65	-279.91	-279.89	-251.17	40°09'40.380"N	104°43'10.004"W	1.60	
3286.00	18.270	223.200	3229.83	-300.81	-300.78	-271.56	40°09'40.174"N	104°43'10.267"W	1.25	
3376.00	18.450	221.050	3315.25	-321.83	-321.81	-290.57	40°09'39.966"N	104°43'10.512"W	0.78	
3466.00	18.630	223.120	3400.58	-343.07	-343.04	-309.75	40°09'39.756"N	104°43'10.759"W	0.76	
3556.00	17.870	223.970	3486.06	-363.50	-363.47	-329.17	40°09'39.554"N	104°43'11.009"W	0.89	
3646.00	17.040	226.870	3571.91	-382.46	-382.43	-348.38	40°09'39.367"N	104°43'11.256"W	1.34	
3736.00	17.130	224.400	3657.94	-400.94	-400.91	-367.28	40°09'39.184"N	104°43'11.499"W	0.81	
3826.00	16.980	228.230	3743.99	-419.17	-419.14	-386.35	40°09'39.004"N	104°43'11.745"W	1.26	
3916.00	17.090	230.470	3830.04	-436.34	-436.31	-406.35	40°09'38.834"N	104°43'12.003"W	0.74	
4006.00	17.620	230.820	3915.94	-453.37	-453.33	-427.11	40°09'38.666"N	104°43'12.270"W	0.60	
4096.00	17.960	232.220	4001.64	-470.48	-470.44	-448.64	40°09'38.497"N	104°43'12.547"W	0.61	

REFERENCE WELLPATH IDENTIFICATION				
Operator	KERR-MCGEE OIL & GAS ONSHORE LP		Slot	SLOT#22 DOLPH 2N-1HZ (662'FSL & 755'FEL, SEC.1)
Area	COLORADO		Well	DOLPH 2N-1HZ
Field	WELD COUNTY (KERR MCGEE)		Wellbore	DOLPH 2N-1HZ AWB
Facility	SEC.01-T2N-R66W			

WELLPATH DATA (145 stations)										
MD [ft]	Inclination [°]	Azimuth [°]	TVD [ft]	Vert Sect [ft]	North [ft]	East [ft]	Latitude	Longitude	DLS [°/100ft]	Comments
4186.00	19.480	230.690	4086.87	-488.49	-488.45	-471.22	40°09'38.319"N	104°43'12.838"W	1.77	
4276.00	19.470	229.020	4171.73	-507.83	-507.79	-494.15	40°09'38.128"N	104°43'13.134"W	0.62	
4366.00	18.840	228.020	4256.74	-527.39	-527.35	-516.28	40°09'37.935"N	104°43'13.419"W	0.79	
4456.00	17.850	227.090	4342.17	-546.50	-546.46	-537.18	40°09'37.746"N	104°43'13.688"W	1.15	
4546.00	18.230	227.250	4427.74	-565.45	-565.40	-557.62	40°09'37.559"N	104°43'13.951"W	0.43	
4636.00	17.940	226.240	4513.30	-584.60	-584.55	-577.97	40°09'37.369"N	104°43'14.213"W	0.47	
4726.00	16.810	226.360	4599.19	-603.17	-603.12	-597.40	40°09'37.186"N	104°43'14.463"W	1.26	
4816.00	18.370	223.790	4684.98	-622.39	-622.34	-616.64	40°09'36.996"N	104°43'14.711"W	1.94	
4906.00	18.040	222.520	4770.48	-642.90	-642.84	-635.87	40°09'36.793"N	104°43'14.959"W	0.57	
4996.00	16.660	224.400	4856.38	-662.39	-662.33	-654.31	40°09'36.601"N	104°43'15.196"W	1.65	
5085.00	15.920	223.830	4941.81	-680.31	-680.26	-671.69	40°09'36.424"N	104°43'15.420"W	0.85	
5175.00	14.730	223.330	5028.60	-697.54	-697.48	-688.09	40°09'36.253"N	104°43'15.631"W	1.33	
5265.00	13.960	221.680	5115.80	-713.98	-713.91	-703.16	40°09'36.091"N	104°43'15.826"W	0.97	
5355.00	13.510	217.970	5203.23	-730.37	-730.31	-716.85	40°09'35.929"N	104°43'16.002"W	1.10	
5445.00	11.600	218.780	5291.07	-745.72	-745.65	-728.99	40°09'35.777"N	104°43'16.158"W	2.13	
5536.00	9.650	222.630	5380.51	-758.46	-758.40	-739.88	40°09'35.651"N	104°43'16.299"W	2.28	
5626.00	8.530	218.560	5469.38	-769.23	-769.17	-749.15	40°09'35.545"N	104°43'16.418"W	1.43	
5716.00	6.820	219.310	5558.57	-778.59	-778.52	-756.70	40°09'35.452"N	104°43'16.515"W	1.90	
5806.00	4.460	227.750	5648.13	-785.08	-785.01	-762.68	40°09'35.388"N	104°43'16.592"W	2.77	
5896.00	2.190	234.490	5737.97	-788.43	-788.36	-766.67	40°09'35.355"N	104°43'16.643"W	2.56	
5986.00	0.590	273.500	5827.94	-789.40	-789.33	-768.53	40°09'35.346"N	104°43'16.667"W	1.97	
6076.00	1.510	78.730	5917.93	-789.14	-789.07	-767.83	40°09'35.348"N	104°43'16.658"W	2.32	
6166.00	1.200	86.660	6007.91	-788.85	-788.79	-765.73	40°09'35.351"N	104°43'16.631"W	0.40	
6256.00	1.060	105.680	6097.89	-789.02	-788.96	-763.98	40°09'35.349"N	104°43'16.609"W	0.44	
6346.00	1.150	93.360	6187.87	-789.30	-789.24	-762.28	40°09'35.347"N	104°43'16.587"W	0.28	
6436.00	1.800	74.700	6277.84	-788.98	-788.92	-760.02	40°09'35.350"N	104°43'16.558"W	0.89	
6526.00	1.590	77.560	6367.80	-788.34	-788.27	-757.43	40°09'35.356"N	104°43'16.525"W	0.25	
6617.00	1.370	78.260	6458.77	-787.85	-787.78	-755.14	40°09'35.361"N	104°43'16.495"W	0.24	
6707.00	1.540	73.080	6548.74	-787.28	-787.21	-752.93	40°09'35.367"N	104°43'16.466"W	0.24	
6752.00	1.320	66.450	6593.73	-786.89	-786.83	-751.87	40°09'35.370"N	104°43'16.453"W	0.61	
6797.00	4.740	11.870	6638.67	-784.86	-784.80	-751.01	40°09'35.390"N	104°43'16.442"W	9.15	
6842.00	10.950	10.180	6683.22	-778.83	-778.77	-749.87	40°09'35.450"N	104°43'16.427"W	13.81	
6887.00	14.540	10.880	6727.11	-769.07	-769.01	-748.05	40°09'35.546"N	104°43'16.404"W	7.99	
6932.00	18.750	7.390	6770.21	-756.35	-756.28	-746.05	40°09'35.672"N	104°43'16.378"W	9.61	
6977.00	22.810	2.840	6812.28	-740.46	-740.39	-744.69	40°09'35.829"N	104°43'16.360"W	9.70	
7022.00	26.660	2.280	6853.14	-721.65	-721.59	-743.86	40°09'36.015"N	104°43'16.350"W	8.57	
7067.00	30.850	2.560	6892.59	-700.03	-699.96	-742.94	40°09'36.229"N	104°43'16.338"W	9.32	
7112.00	35.020	1.670	6930.35	-675.58	-675.52	-742.05	40°09'36.470"N	104°43'16.326"W	9.33	
7157.00	38.690	1.400	6966.35	-648.61	-648.54	-741.33	40°09'36.737"N	104°43'16.317"W	8.16	
7202.00	41.870	2.920	7000.67	-619.54	-619.47	-740.22	40°09'37.024"N	104°43'16.303"W	7.40	
7247.00	43.810	3.430	7033.67	-588.99	-588.93	-738.52	40°09'37.326"N	104°43'16.281"W	4.38	
7292.00	48.350	3.400	7064.87	-556.64	-556.58	-736.59	40°09'37.646"N	104°43'16.256"W	10.09	
7337.00	52.860	3.290	7093.43	-521.93	-521.87	-734.56	40°09'37.989"N	104°43'16.230"W	10.02	
7382.00	57.510	2.860	7119.11	-485.05	-484.99	-732.59	40°09'38.353"N	104°43'16.205"W	10.36	
7427.00	62.470	2.510	7141.61	-446.14	-446.08	-730.77	40°09'38.738"N	104°43'16.181"W	11.04	

REFERENCE WELLPATH IDENTIFICATION				
Operator	KERR-MCGEE OIL & GAS ONSHORE LP		Slot	SLOT#22 DOLPH 2N-1HZ (662'FSL & 755'FEL, SEC.1)
Area	COLORADO		Well	DOLPH 2N-1HZ
Field	WELD COUNTY (KERR MCGEE)		Wellbore	DOLPH 2N-1HZ AWP
Facility	SEC.01-T2N-R66W			

WELLPATH DATA (145 stations) † = interpolated/extrapolated station										
MD [ft]	Inclination [°]	Azimuth [°]	TVD [ft]	Vert Sect [ft]	North [ft]	East [ft]	Latitude	Longitude	DLS [°/100ft]	Comments
7472.00	67.250	1.660	7160.72	-405.44	-405.38	-729.29	40°09'39.140"N	104°43'16.162"W	10.76	
7517.00	71.070	0.820	7176.73	-363.40	-363.34	-728.38	40°09'39.555"N	104°43'16.151"W	8.67	
7562.00	75.150	0.930	7189.80	-320.36	-320.30	-727.73	40°09'39.981"N	104°43'16.142"W	9.07	
7607.00	79.590	1.580	7199.64	-276.47	-276.41	-726.76	40°09'40.414"N	104°43'16.130"W	9.97	
7671.00	85.550	1.000	7207.91	-213.05	-212.99	-725.34	40°09'41.041"N	104°43'16.111"W	9.36	
7702.00†	86.222	0.572	7210.14	-182.13	-182.07	-724.91	40°09'41.347"N	104°43'16.106"W	2.57	7" Casing Point
7713.00	86.460	0.420	7210.84	-171.16	-171.09	-724.82	40°09'41.455"N	104°43'16.105"W	2.57	
7803.00	87.520	1.780	7215.56	-81.30	-81.24	-723.09	40°09'42.343"N	104°43'16.082"W	1.91	
7893.00	87.830	1.770	7219.21	8.58	8.64	-720.31	40°09'43.231"N	104°43'16.047"W	0.34	
7984.00	88.610	1.460	7222.04	99.50	99.56	-717.74	40°09'44.130"N	104°43'16.014"W	0.92	
8074.00	89.250	0.700	7223.72	189.47	189.53	-716.05	40°09'45.019"N	104°43'15.992"W	1.10	
8164.00	89.870	0.120	7224.41	279.46	279.52	-715.40	40°09'45.908"N	104°43'15.984"W	0.94	
8254.00	90.460	359.780	7224.15	369.46	369.52	-715.48	40°09'46.798"N	104°43'15.985"W	0.76	
8344.00	90.330	1.070	7223.53	459.45	459.52	-714.81	40°09'47.687"N	104°43'15.976"W	1.44	
8434.00	90.090	359.310	7223.20	549.45	549.51	-714.52	40°09'48.576"N	104°43'15.972"W	1.97	
8524.00	89.130	355.680	7223.82	639.35	639.41	-718.45	40°09'49.465"N	104°43'16.023"W	4.17	
8613.00	89.620	356.920	7224.79	728.15	728.22	-724.19	40°09'50.342"N	104°43'16.097"W	1.50	
8704.00	90.760	359.310	7224.49	819.09	819.16	-727.18	40°09'51.241"N	104°43'16.136"W	2.91	
8794.00	90.550	359.640	7223.46	909.08	909.15	-728.01	40°09'52.130"N	104°43'16.146"W	0.43	
8884.00	89.000	0.240	7223.81	999.08	999.14	-728.10	40°09'53.019"N	104°43'16.147"W	1.85	
8974.00	89.380	359.420	7225.08	1089.07	1089.13	-728.37	40°09'53.909"N	104°43'16.151"W	1.00	
9064.00	89.250	359.940	7226.16	1179.06	1179.13	-728.87	40°09'54.798"N	104°43'16.157"W	0.60	
9154.00	88.290	359.000	7228.09	1269.04	1269.10	-729.70	40°09'55.687"N	104°43'16.168"W	1.49	
9244.00	87.810	358.860	7231.15	1358.97	1359.03	-731.38	40°09'56.576"N	104°43'16.190"W	0.56	
9334.00	88.300	358.200	7234.21	1448.88	1448.95	-733.69	40°09'57.464"N	104°43'16.220"W	0.91	
9424.00	89.340	358.060	7236.06	1538.82	1538.88	-736.63	40°09'58.353"N	104°43'16.257"W	1.17	
9514.00	90.550	358.320	7236.15	1628.77	1628.83	-739.47	40°09'59.242"N	104°43'16.294"W	1.38	
9605.00	91.080	358.920	7234.85	1719.73	1719.80	-741.66	40°10'00.141"N	104°43'16.322"W	0.88	
9694.00	91.860	357.940	7232.57	1808.67	1808.73	-744.10	40°10'01.020"N	104°43'16.354"W	1.41	
9785.00	92.800	358.490	7228.87	1899.55	1899.61	-746.93	40°10'01.918"N	104°43'16.390"W	1.20	
9875.00	92.520	359.720	7224.69	1989.44	1989.50	-748.34	40°10'02.806"N	104°43'16.408"W	1.40	
9965.00	90.120	1.160	7222.62	2079.40	2079.47	-747.64	40°10'03.695"N	104°43'16.400"W	3.11	
10055.00	89.160	0.750	7223.19	2169.39	2169.45	-746.14	40°10'04.584"N	104°43'16.380"W	1.16	
10145.00	89.560	0.930	7224.19	2259.37	2259.44	-744.82	40°10'05.474"N	104°43'16.363"W	0.49	
10235.00	88.980	0.930	7225.34	2349.35	2349.42	-743.36	40°10'06.363"N	104°43'16.345"W	0.64	
10325.00	88.910	1.420	7226.99	2439.32	2439.38	-741.52	40°10'07.252"N	104°43'16.321"W	0.55	
10415.00	88.140	1.130	7229.31	2529.26	2529.33	-739.52	40°10'08.141"N	104°43'16.295"W	0.91	
10505.00	88.310	0.890	7232.10	2619.21	2619.27	-737.93	40°10'09.030"N	104°43'16.275"W	0.33	
10595.00	87.520	1.220	7235.37	2709.13	2709.20	-736.28	40°10'09.918"N	104°43'16.253"W	0.95	
10685.00	88.300	0.590	7238.66	2799.06	2799.12	-734.86	40°10'10.807"N	104°43'16.235"W	1.11	
10775.00	89.620	0.620	7240.29	2889.04	2889.10	-733.90	40°10'11.696"N	104°43'16.223"W	1.47	
10865.00	89.320	0.890	7241.12	2979.03	2979.09	-732.72	40°10'12.585"N	104°43'16.208"W	0.45	
10955.00	89.690	1.420	7241.90	3069.00	3069.07	-730.90	40°10'13.475"N	104°43'16.184"W	0.72	
11045.00	88.970	1.240	7242.95	3158.97	3159.04	-728.82	40°10'14.364"N	104°43'16.157"W	0.82	
11136.00	89.650	0.830	7244.05	3249.95	3250.01	-727.17	40°10'15.263"N	104°43'16.136"W	0.87	

REFERENCE WELLPATH IDENTIFICATION				
Operator	KERR-MCGEE OIL & GAS ONSHORE LP		Slot	SLOT#22 DOLPH 2N-1HZ (662'FSL & 755'FEL, SEC.1)
Area	COLORADO		Well	DOLPH 2N-1HZ
Field	WELD COUNTY (KERR MCGEE)		Wellbore	DOLPH 2N-1HZ AWB
Facility	SEC.01-T2N-R66W			

WELLPATH DATA (145 stations)										
MD [ft]	Inclination [°]	Azimuth [°]	TVD [ft]	Vert Sect [ft]	North [ft]	East [ft]	Latitude	Longitude	DLS [°/100ft]	Comments
11226.00	89.720	0.260	7244.54	3339.95	3340.01	-726.32	40°10'16.152"N	104°43'16.125"W	0.64	
11316.00	89.410	359.600	7245.23	3429.94	3430.01	-726.43	40°10'17.041"N	104°43'16.127"W	0.81	
11406.00	89.780	0.780	7245.86	3519.94	3520.00	-726.13	40°10'17.931"N	104°43'16.123"W	1.37	
11496.00	90.830	0.040	7245.38	3609.93	3610.00	-725.48	40°10'18.820"N	104°43'16.115"W	1.43	
11586.00	89.370	0.090	7245.23	3699.93	3699.99	-725.38	40°10'19.709"N	104°43'16.113"W	1.62	
11676.00	89.750	0.550	7245.92	3789.93	3789.99	-724.88	40°10'20.599"N	104°43'16.107"W	0.66	
11766.00	89.500	359.710	7246.51	3879.92	3879.99	-724.67	40°10'21.488"N	104°43'16.104"W	0.97	
11856.00	88.790	357.810	7247.85	3969.89	3969.95	-726.62	40°10'22.377"N	104°43'16.129"W	2.25	
11976.00	88.700	357.130	7250.48	4089.74	4089.80	-731.92	40°10'23.561"N	104°43'16.198"W	0.57	Last BHI MWD+IFR Surveys
12028.00	88.700	357.120	7251.66	4141.66	4141.72	-734.53	40°10'24.075"N	104°43'16.231"W	0.02	Projection to Bit

HOLE & CASING SECTIONS - Ref Wellbore: DOLPH 2N-1HZ AWB Ref Wellpath: DOLPH 2N-1HZ AWP										
String/Diameter	Start MD [ft]	End MD [ft]	Interval [ft]	Start TVD [ft]	End TVD [ft]	Start N/S [ft]	Start E/W [ft]	End N/S [ft]	End E/W [ft]	
13.5in Open Hole	13.00	1446.00	1433.00	13.00	1445.98	0.00	0.00	-4.59	4.04	
9in Casing Surface	13.00	1436.00	1423.00	13.00	1435.98	0.00	0.00	-4.59	4.06	
8.75in Open Hole	1446.00	7712.00	6266.00	1445.98	7210.78	-4.59	4.04	-172.09	-724.82	
7in Casing Intermediate	13.00	7702.00	7689.00	13.00	7210.14	0.00	0.00	-182.07	-724.91	
6.125in Open Hole	7712.00	12028.00	4316.00	7210.78	7251.66	-172.09	-724.82	4141.72	-734.53	

TARGETS										
Name	MD [ft]	TVD [ft]	North [ft]	East [ft]	Grid East [US ft]	Grid North [US ft]	Latitude	Longitude	Shape	
DOLPH SECTION 1 LINES		6996.00	0.40	60.09	3218464.13	1302817.57	40°09'43.150"N	104°43'05.995"W	polygon	
DOLPH 2N-1HZ BHL ON PLAT (460'FNL & 1500'FEL, SEC.01) REV-1		7246.00	4167.57	-745.29	3217622.10	1306977.29	40°10'24.330"N	104°43'16.370"W	point	
DOLPH 2N-1HZ LANDBOX		7246.00	0.00	0.00	3218404.05	1302816.63	40°09'43.146"N	104°43'06.769"W	polygon	

WELLPATH COMPOSITION - Ref Wellbore: DOLPH 2N-1HZ AWB Ref Wellpath: DOLPH 2N-1HZ AWP				
Start MD [ft]	End MD [ft]	Positional Uncertainty Model	Log Name/Comment	Wellbore
13.00	1311.00	Generic gyro - continuous (Standard)	MS ENERGY GYRO SURVEYS <113-1311>	DOLPH 2N-1HZ AWB
1311.00	7671.00	NaviTrak (MAGCORR,IFR)	BHI MWD+IFR SURVEYS 8 3/4" HOLE <1448-7671>	DOLPH 2N-1HZ AWB
7671.00	11976.00	NaviTrak (MAGCORR,IFR)	BHI MWD+IFR SURVEYS 6 1/8" HOLE <7713-11976>	DOLPH 2N-1HZ AWB
11976.00	12028.00	Blind Drilling (std)	Projection to bit	DOLPH 2N-1HZ AWB

# Actual Wellpath Report

DOLPH 2N-1HZ AWP

Page 6 of 6

REFERENCE WELLPATH IDENTIFICATION			
Operator	KERR-MCGEE OIL & GAS ONSHORE LP	Slot	SLOT#22 DOLPH 2N-1HZ (662'FSL & 755'FEL, SEC.1)
Area	COLORADO	Well	DOLPH 2N-1HZ
Field	WELD COUNTY (KERR MCGEE)	Wellbore	DOLPH 2N-1HZ AWP
Facility	SEC.01-T2N-R66W		

WELLPATH COMMENTS				
MD [ft]	Inclination [°]	Azimuth [°]	TVD [ft]	Comment
13.00	0.000	158.080	13.00	Tie-On
113.00	0.450	158.080	113.00	Begin GYRO Surveys
1311.00	0.250	21.170	1310.98	Tie-Into GYRO Surveys
1448.00	0.140	266.500	1447.98	Begin BHI MWD+IFR Surveys
7702.00	86.222	0.572	7210.14	7" Casing Point
11976.00	88.700	357.130	7250.48	Last BHI MWD+IFR Surveys
12028.00	88.700	357.120	7251.66	Projection to Bit