

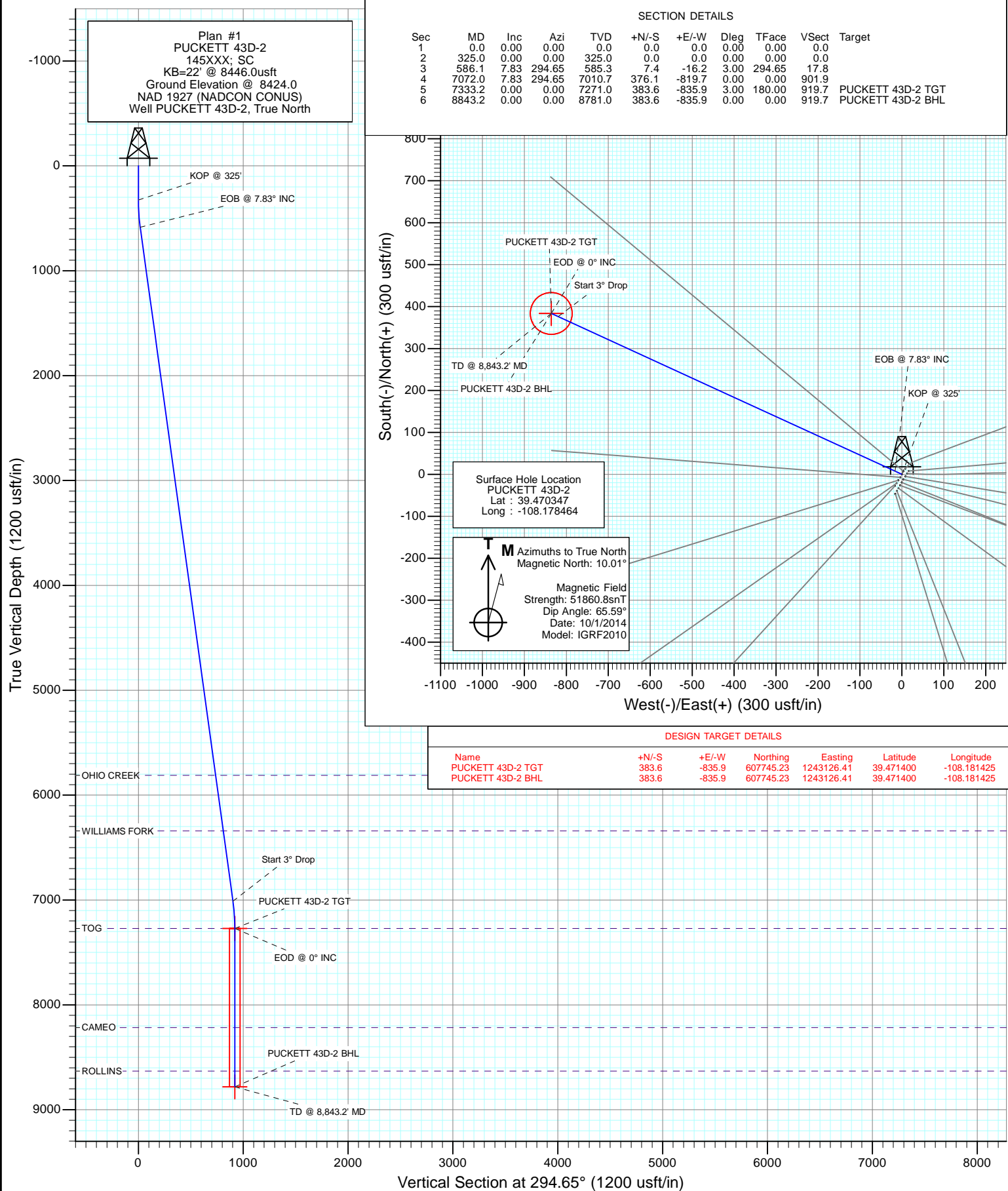

Project: Garfield County, CO
Site: S2-T7S-R97W (Puckett Pad P2)
Well: PUCKETT 43D-2
Wellbore: DD
Design: Plan #1

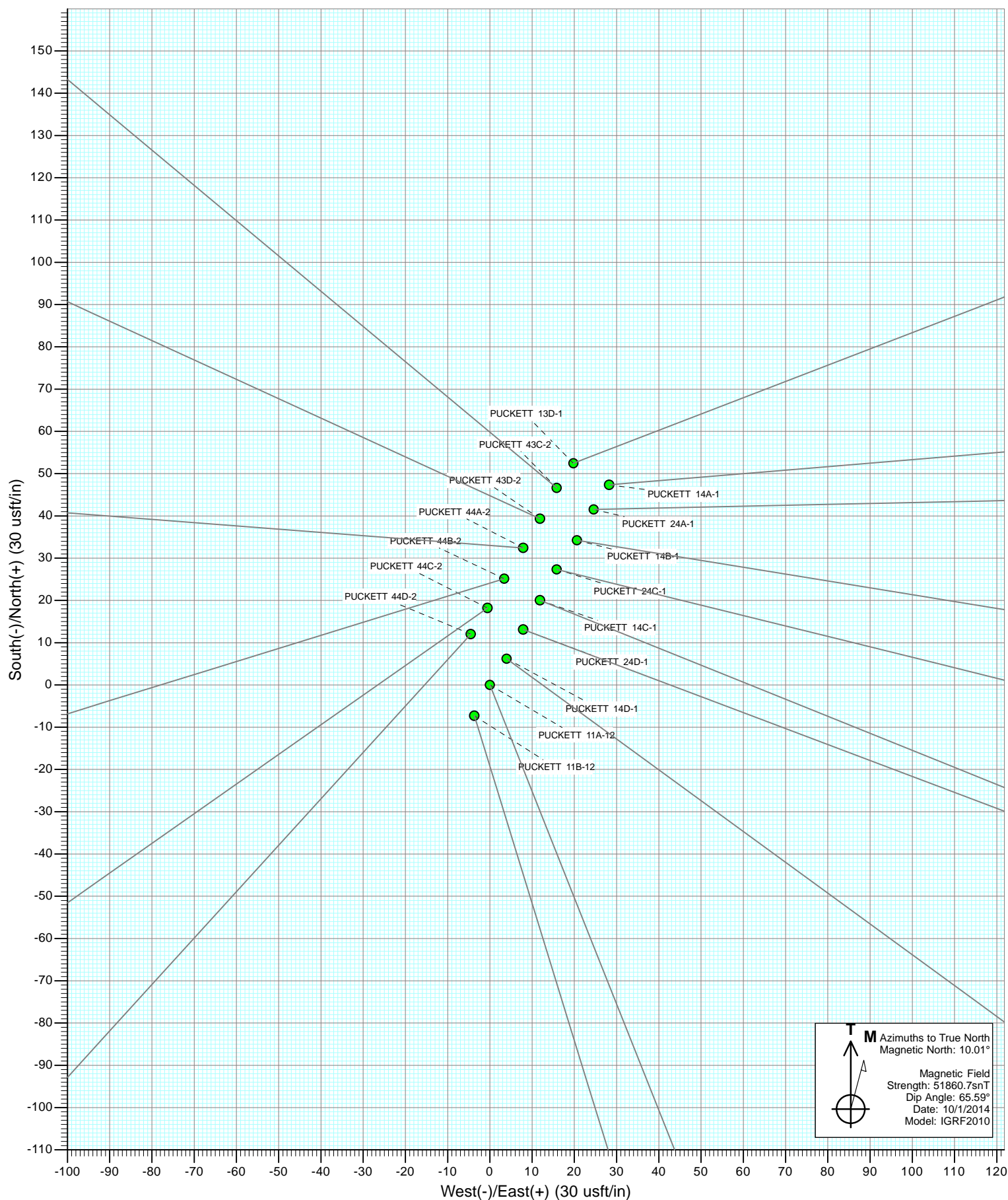

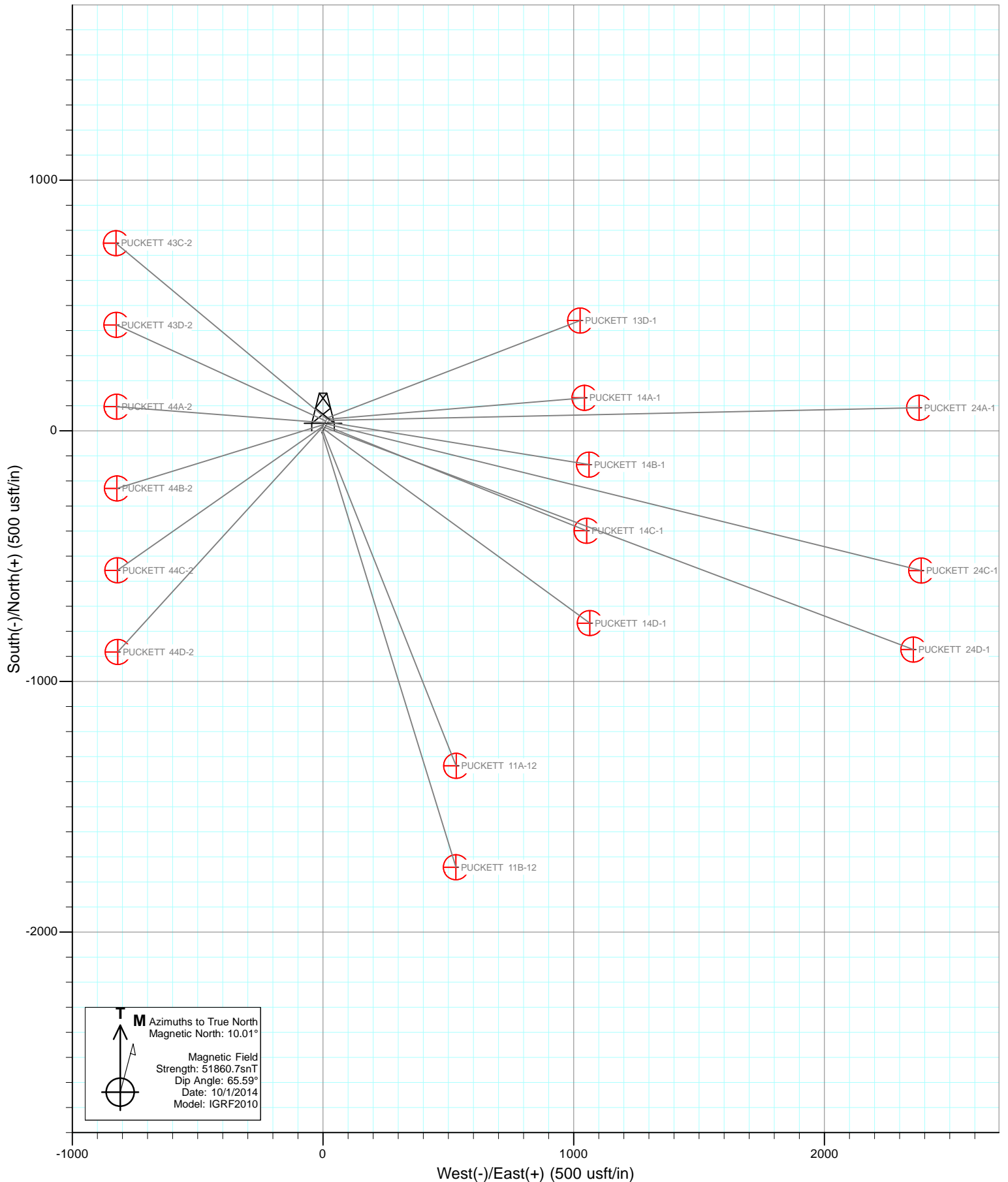



Cathedral Energy Services

Planning Report

Database:	USA EDM 5000 Multi Users DB	Local Co-ordinate Reference:	Well PUCKETT 43D-2
Company:	Caerus Oil & Gas (NAD 27)	TVD Reference:	KB=22' @ 8446.0usft
Project:	Garfield County, CO	MD Reference:	KB=22' @ 8446.0usft
Site:	S2-T7S-R97W (Puckett Pad P2)	North Reference:	True
Well:	PUCKETT 43D-2	Survey Calculation Method:	Minimum Curvature
Wellbore:	DD		
Design:	Plan #1		

Project	Garfield County, CO		
Map System:	US State Plane 1927 (Exact solution)	System Datum:	Mean Sea Level
Geo Datum:	NAD 1927 (NADCON CONUS)		
Map Zone:	Colorado Central 502		

Site		S2-T7S-R97W (Puckett Pad P2)			
Site Position:		Northing:	607,291.06 usft	Latitude:	39.470219
From:	Lat/Long	Easting:	1,243,933.75 usft	Longitude:	-108.178519
Position Uncertainty:	0.0 usft	Slot Radius:	13-3/16"	Grid Convergence:	-1.69 °

Well	PUCKETT 43D-2					
Well Position	+N/-S	0.0 usft	Northing:	607,337.20 usft	Latitude:	39.470347
	+E/-W	0.0 usft	Easting:	1,243,950.65 usft	Longitude:	-108.178464
Position Uncertainty		0.0 usft	Wellhead Elevation:	0.0 usft	Ground Level:	8,424.0 usft

Wellbore	DD				
Magnetics	Model Name	Sample Date	Declination (°)	Dip Angle (°)	Field Strength (nT)
	IGRF2010	10/1/2014	10.00	65.59	51,861

Design	Plan #1			
Audit Notes:				
Version:	Phase:	PLAN	Tie On Depth:	0.0
Vertical Section:	Depth From (TVD) (usft)	+N/-S (usft)	+E/-W (usft)	Direction (°)
	0.0	0.0	0.0	294.65

Plan Sections										
Measured Depth (usft)	Inclination (°)	Azimuth (°)	Vertical Depth (usft)	+N/-S (usft)	+E/-W (usft)	Dogleg Rate (°/100usft)	Build Rate (°/100usft)	Turn Rate (°/100usft)	TFO (°)	Target
0.0	0.00	0.00	0.0	0.0	0.0	0.00	0.00	0.00	0.00	
325.0	0.00	0.00	325.0	0.0	0.0	0.00	0.00	0.00	0.00	
586.1	7.83	294.65	585.3	7.4	-16.2	3.00	3.00	0.00	294.65	
7,072.0	7.83	294.65	7,010.7	376.1	-819.7	0.00	0.00	0.00	0.00	
7,333.2	0.00	0.00	7,271.0	383.6	-835.9	3.00	-3.00	0.00	180.00	PUCKETT 43D-2 TG1
8,843.2	0.00	0.00	8,781.0	383.6	-835.9	0.00	0.00	0.00	0.00	PUCKETT 43D-2 BHL

Cathedral Energy Services

Planning Report

Database:	USA EDM 5000 Multi Users DB	Local Co-ordinate Reference:	Well PUCKETT 43D-2
Company:	Caerus Oil & Gas (NAD 27)	TVD Reference:	KB=22' @ 8446.0usft
Project:	Garfield County, CO	MD Reference:	KB=22' @ 8446.0usft
Site:	S2-T7S-R97W (Puckett Pad P2)	North Reference:	True
Well:	PUCKETT 43D-2	Survey Calculation Method:	Minimum Curvature
Wellbore:	DD		
Design:	Plan #1		

Planned Survey

Measured Depth (usft)	Inclination (°)	Azimuth (°)	Vertical Depth (usft)	+N/-S (usft)	+E/-W (usft)	Vertical Section (usft)	Dogleg Rate (°/100usft)	Build Rate (°/100u)	Comments / Formations
0.0	0.00	0.00	0.0	0.0	0.0	0.0	0.00	0.00	
100.0	0.00	0.00	100.0	0.0	0.0	0.0	0.00	0.00	
200.0	0.00	0.00	200.0	0.0	0.0	0.0	0.00	0.00	
300.0	0.00	0.00	300.0	0.0	0.0	0.0	0.00	0.00	
325.0	0.00	0.00	325.0	0.0	0.0	0.0	0.00	0.00	KOP @ 325'
400.0	2.25	294.65	400.0	0.6	-1.3	1.5	3.00	3.00	
500.0	5.25	294.65	499.8	3.3	-7.3	8.0	3.00	3.00	
586.1	7.83	294.65	585.3	7.4	-16.2	17.8	3.00	3.00	EOB @ 7.83° INC
600.0	7.83	294.65	599.1	8.2	-17.9	19.7	0.00	0.00	
700.0	7.83	294.65	698.1	13.9	-30.3	33.3	0.00	0.00	
800.0	7.83	294.65	797.2	19.6	-42.7	47.0	0.00	0.00	
900.0	7.83	294.65	896.3	25.3	-55.1	60.6	0.00	0.00	
1,000.0	7.83	294.65	995.3	31.0	-67.5	74.2	0.00	0.00	
1,100.0	7.83	294.65	1,094.4	36.6	-79.9	87.9	0.00	0.00	
1,200.0	7.83	294.65	1,193.5	42.3	-92.2	101.5	0.00	0.00	
1,300.0	7.83	294.65	1,292.5	48.0	-104.6	115.1	0.00	0.00	
1,400.0	7.83	294.65	1,391.6	53.7	-117.0	128.8	0.00	0.00	
1,500.0	7.83	294.65	1,490.7	59.4	-129.4	142.4	0.00	0.00	
1,600.0	7.83	294.65	1,589.7	65.1	-141.8	156.0	0.00	0.00	
1,700.0	7.83	294.65	1,688.8	70.8	-154.2	169.6	0.00	0.00	
1,800.0	7.83	294.65	1,787.9	76.4	-166.6	183.3	0.00	0.00	
1,900.0	7.83	294.65	1,886.9	82.1	-179.0	196.9	0.00	0.00	
2,000.0	7.83	294.65	1,986.0	87.8	-191.4	210.5	0.00	0.00	
2,100.0	7.83	294.65	2,085.1	93.5	-203.7	224.2	0.00	0.00	
2,200.0	7.83	294.65	2,184.1	99.2	-216.1	237.8	0.00	0.00	
2,300.0	7.83	294.65	2,283.2	104.9	-228.5	251.4	0.00	0.00	
2,400.0	7.83	294.65	2,382.3	110.5	-240.9	265.1	0.00	0.00	
2,500.0	7.83	294.65	2,481.3	116.2	-253.3	278.7	0.00	0.00	
2,600.0	7.83	294.65	2,580.4	121.9	-265.7	292.3	0.00	0.00	
2,700.0	7.83	294.65	2,679.5	127.6	-278.1	306.0	0.00	0.00	
2,800.0	7.83	294.65	2,778.5	133.3	-290.5	319.6	0.00	0.00	
2,900.0	7.83	294.65	2,877.6	139.0	-302.9	333.2	0.00	0.00	
3,000.0	7.83	294.65	2,976.7	144.6	-315.2	346.8	0.00	0.00	
3,100.0	7.83	294.65	3,075.7	150.3	-327.6	360.5	0.00	0.00	
3,200.0	7.83	294.65	3,174.8	156.0	-340.0	374.1	0.00	0.00	
3,300.0	7.83	294.65	3,273.9	161.7	-352.4	387.7	0.00	0.00	
3,400.0	7.83	294.65	3,372.9	167.4	-364.8	401.4	0.00	0.00	
3,500.0	7.83	294.65	3,472.0	173.1	-377.2	415.0	0.00	0.00	
3,600.0	7.83	294.65	3,571.1	178.8	-389.6	428.6	0.00	0.00	
3,700.0	7.83	294.65	3,670.1	184.4	-402.0	442.3	0.00	0.00	
3,800.0	7.83	294.65	3,769.2	190.1	-414.4	455.9	0.00	0.00	
3,900.0	7.83	294.65	3,868.3	195.8	-426.7	469.5	0.00	0.00	
4,000.0	7.83	294.65	3,967.3	201.5	-439.1	483.2	0.00	0.00	
4,100.0	7.83	294.65	4,066.4	207.2	-451.5	496.8	0.00	0.00	
4,200.0	7.83	294.65	4,165.5	212.9	-463.9	510.4	0.00	0.00	
4,300.0	7.83	294.65	4,264.5	218.5	-476.3	524.0	0.00	0.00	
4,400.0	7.83	294.65	4,363.6	224.2	-488.7	537.7	0.00	0.00	
4,500.0	7.83	294.65	4,462.7	229.9	-501.1	551.3	0.00	0.00	
4,600.0	7.83	294.65	4,561.7	235.6	-513.5	564.9	0.00	0.00	
4,700.0	7.83	294.65	4,660.8	241.3	-525.8	578.6	0.00	0.00	
4,800.0	7.83	294.65	4,759.9	247.0	-538.2	592.2	0.00	0.00	
4,900.0	7.83	294.65	4,858.9	252.7	-550.6	605.8	0.00	0.00	

Cathedral Energy Services

Planning Report

Database:	USA EDM 5000 Multi Users DB	Local Co-ordinate Reference:	Well PUCKETT 43D-2
Company:	Caerus Oil & Gas (NAD 27)	TVD Reference:	KB=22' @ 8446.0usft
Project:	Garfield County, CO	MD Reference:	KB=22' @ 8446.0usft
Site:	S2-T7S-R97W (Puckett Pad P2)	North Reference:	True
Well:	PUCKETT 43D-2	Survey Calculation Method:	Minimum Curvature
Wellbore:	DD		
Design:	Plan #1		

Planned Survey

Measured Depth (usft)	Inclination (°)	Azimuth (°)	Vertical Depth (usft)	+N/-S (usft)	+E/-W (usft)	Vertical Section (usft)	Dogleg Rate (°/100usft)	Build Rate (°/100u)	Comments / Formations
5,000.0	7.83	294.65	4,958.0	258.3	-563.0	619.5	0.00	0.00	
5,100.0	7.83	294.65	5,057.1	264.0	-575.4	633.1	0.00	0.00	
5,200.0	7.83	294.65	5,156.1	269.7	-587.8	646.7	0.00	0.00	
5,300.0	7.83	294.65	5,255.2	275.4	-600.2	660.3	0.00	0.00	
5,400.0	7.83	294.65	5,354.3	281.1	-612.6	674.0	0.00	0.00	
5,500.0	7.83	294.65	5,453.3	286.8	-625.0	687.6	0.00	0.00	
5,600.0	7.83	294.65	5,552.4	292.4	-637.3	701.2	0.00	0.00	
5,700.0	7.83	294.65	5,651.5	298.1	-649.7	714.9	0.00	0.00	
5,800.0	7.83	294.65	5,750.5	303.8	-662.1	728.5	0.00	0.00	
5,861.0	7.83	294.65	5,811.0	307.3	-669.7	736.8	0.00	0.00	OHIO CREEK
5,900.0	7.83	294.65	5,849.6	309.5	-674.5	742.1	0.00	0.00	
6,000.0	7.83	294.65	5,948.7	315.2	-686.9	755.8	0.00	0.00	
6,100.0	7.83	294.65	6,047.7	320.9	-699.3	769.4	0.00	0.00	
6,200.0	7.83	294.65	6,146.8	326.6	-711.7	783.0	0.00	0.00	
6,300.0	7.83	294.65	6,245.9	332.2	-724.1	796.7	0.00	0.00	
6,396.0	7.83	294.65	6,341.0	337.7	-736.0	809.7	0.00	0.00	WILLIAMS FORK
6,400.0	7.83	294.65	6,344.9	337.9	-736.5	810.3	0.00	0.00	
6,500.0	7.83	294.65	6,444.0	343.6	-748.8	823.9	0.00	0.00	
6,600.0	7.83	294.65	6,543.1	349.3	-761.2	837.5	0.00	0.00	
6,700.0	7.83	294.65	6,642.1	355.0	-773.6	851.2	0.00	0.00	
6,800.0	7.83	294.65	6,741.2	360.7	-786.0	864.8	0.00	0.00	
6,900.0	7.83	294.65	6,840.3	366.3	-798.4	878.4	0.00	0.00	
7,000.0	7.83	294.65	6,939.3	372.0	-810.8	892.1	0.00	0.00	
7,072.0	7.83	294.65	7,010.7	376.1	-819.7	901.9	0.00	0.00	Start 3° Drop
7,100.0	6.99	294.65	7,038.4	377.6	-823.0	905.5	3.00	-3.00	
7,200.0	3.99	294.65	7,137.9	381.6	-831.7	915.1	3.00	-3.00	
7,300.0	0.99	294.65	7,237.8	383.4	-835.6	919.4	3.00	-3.00	
7,333.2	0.00	0.00	7,271.0	383.6	-835.9	919.7	3.00	-3.00	EOD @ 0° INC - TOG
7,400.0	0.00	0.00	7,337.8	383.6	-835.9	919.7	0.00	0.00	
7,500.0	0.00	0.00	7,437.8	383.6	-835.9	919.7	0.00	0.00	
7,600.0	0.00	0.00	7,537.8	383.6	-835.9	919.7	0.00	0.00	
7,700.0	0.00	0.00	7,637.8	383.6	-835.9	919.7	0.00	0.00	
7,800.0	0.00	0.00	7,737.8	383.6	-835.9	919.7	0.00	0.00	
7,900.0	0.00	0.00	7,837.8	383.6	-835.9	919.7	0.00	0.00	
8,000.0	0.00	0.00	7,937.8	383.6	-835.9	919.7	0.00	0.00	
8,100.0	0.00	0.00	8,037.8	383.6	-835.9	919.7	0.00	0.00	
8,200.0	0.00	0.00	8,137.8	383.6	-835.9	919.7	0.00	0.00	
8,278.2	0.00	0.00	8,216.0	383.6	-835.9	919.7	0.00	0.00	CAMEO
8,300.0	0.00	0.00	8,237.8	383.6	-835.9	919.7	0.00	0.00	
8,400.0	0.00	0.00	8,337.8	383.6	-835.9	919.7	0.00	0.00	
8,500.0	0.00	0.00	8,437.8	383.6	-835.9	919.7	0.00	0.00	
8,600.0	0.00	0.00	8,537.8	383.6	-835.9	919.7	0.00	0.00	
8,693.2	0.00	0.00	8,631.0	383.6	-835.9	919.7	0.00	0.00	ROLLINS
8,700.0	0.00	0.00	8,637.8	383.6	-835.9	919.7	0.00	0.00	
8,800.0	0.00	0.00	8,737.8	383.6	-835.9	919.7	0.00	0.00	
8,843.2	0.00	0.00	8,781.0	383.6	-835.9	919.7	0.00	0.00	TD @ 8,843.2' MD

Cathedral Energy Services

Planning Report

Database:	USA EDM 5000 Multi Users DB	Local Co-ordinate Reference:	Well PUCKETT 43D-2
Company:	Caerus Oil & Gas (NAD 27)	TVD Reference:	KB=22' @ 8446.0usft
Project:	Garfield County, CO	MD Reference:	KB=22' @ 8446.0usft
Site:	S2-T7S-R97W (Puckett Pad P2)	North Reference:	True
Well:	PUCKETT 43D-2	Survey Calculation Method:	Minimum Curvature
Wellbore:	DD		
Design:	Plan #1		

Targets									
Target Name									
- hit/miss target	Dip Angle	Dip Dir.	TVD	+N/-S	+E/-W	Northing	Easting	Latitude	Longitude
- Shape	(°)	(°)	(usft)	(usft)	(usft)	(usft)	(usft)		
PUCKETT 43D-2 BHL	0.00	0.00	8,781.0	383.6	-835.9	607,745.23	1,243,126.41	39.471400	-108.181425
- plan hits target center									
- Circle (radius 50.0)									
PUCKETT 43D-2 TGT	0.00	0.00	7,271.0	383.6	-835.9	607,745.23	1,243,126.41	39.471400	-108.181425
- plan hits target center									
- Point									

Formations						
Measured Depth	Vertical Depth	Name	Lithology	Dip	Dip Direction	
(usft)	(usft)			(°)	(°)	
5,861.0	5,811.0	OHIO CREEK				
6,396.0	6,341.0	WILLIAMS FORK				
7,333.2	7,271.0	TOG				
8,278.2	8,216.0	CAMEO				
8,693.2	8,631.0	ROLLINS				

Plan Annotations					
Measured Depth	Vertical Depth	Local Coordinates			
(usft)	(usft)	+N/-S	+E/-W	Comment	
(usft)	(usft)	(usft)	(usft)		
325.0	325.0	0.0	0.0	KOP @ 325'	
586.1	585.3	7.4	-16.2	EOB @ 7.83° INC	
7,072.0	7,010.7	376.1	-819.7	Start 3° Drop	
7,333.2	7,271.0	383.6	-835.9	EOD @ 0° INC	
8,843.2	8,781.0	383.6	-835.9	TD @ 8,843.2' MD	

Cathedral Energy Services

Planning Report

Database:	USA EDM 5000 Multi Users DB	Local Co-ordinate Reference:	Well PUCKETT 43D-2
Company:	Caerus Oil & Gas (NAD 27)	TVD Reference:	KB=22' @ 8446.0usft
Project:	Garfield County, CO	MD Reference:	KB=22' @ 8446.0usft
Site:	S2-T7S-R97W (Puckett Pad P2)	North Reference:	True
Well:	PUCKETT 43D-2	Survey Calculation Method:	Minimum Curvature
Wellbore:	DD		
Design:	Plan #1		

Project	Garfield County, CO		
Map System:	US State Plane 1927 (Exact solution)	System Datum:	Mean Sea Level
Geo Datum:	NAD 1927 (NADCON CONUS)		
Map Zone:	Colorado Central 502		

Site		S2-T7S-R97W (Puckett Pad P2)			
Site Position:		Northing:	607,291.06 usft	Latitude:	39.470219
From:	Lat/Long	Easting:	1,243,933.75 usft	Longitude:	-108.178519
Position Uncertainty:	0.0 usft	Slot Radius:	13-3/16 "	Grid Convergence:	-1.69 °

Well	PUCKETT 43D-2					
Well Position	+N/-S	0.0 usft	Northing:	607,337.20 usft	Latitude:	39.470347
	+E/-W	0.0 usft	Easting:	1,243,950.65 usft	Longitude:	-108.178464
Position Uncertainty		0.0 usft	Wellhead Elevation:	0.0 usft	Ground Level:	8,424.0 usft

Wellbore	DD				
Magnetics	Model Name	Sample Date	Declination (°)	Dip Angle (°)	Field Strength (nT)
	IGRF2010	10/1/2014	10.00	65.59	51,861

Design	Plan #1				
Audit Notes:					
Version:	Phase:	PLAN	Tie On Depth:	0.0	
Vertical Section:	Depth From (TVD) (usft)	+N/-S (usft)	+E/-W (usft)	Direction (°)	
	0.0	0.0	0.0	294.65	

Plan Sections										
Measured Depth (usft)	Inclination (°)	Azimuth (°)	Vertical Depth (usft)	+N/-S (usft)	+E/-W (usft)	Dogleg Rate (°/100usft)	Build Rate (°/100usft)	Turn Rate (°/100usft)	TFO (°)	Target
0.0	0.00	0.00	0.0	0.0	0.0	0.00	0.00	0.00	0.00	
325.0	0.00	0.00	325.0	0.0	0.0	0.00	0.00	0.00	0.00	
586.1	7.83	294.65	585.3	7.4	-16.2	3.00	3.00	0.00	294.65	
7,072.0	7.83	294.65	7,010.7	376.1	-819.7	0.00	0.00	0.00	0.00	
7,333.2	0.00	0.00	7,271.0	383.6	-835.9	3.00	-3.00	0.00	180.00	PUCKETT 43D-2 TG1
8,843.2	0.00	0.00	8,781.0	383.6	-835.9	0.00	0.00	0.00	0.00	PUCKETT 43D-2 BHL

Cathedral Energy Services

Planning Report

Database:	USA EDM 5000 Multi Users DB	Local Co-ordinate Reference:	Well PUCKETT 43D-2
Company:	Caerus Oil & Gas (NAD 27)	TVD Reference:	KB=22' @ 8446.0usft
Project:	Garfield County, CO	MD Reference:	KB=22' @ 8446.0usft
Site:	S2-T7S-R97W (Puckett Pad P2)	North Reference:	True
Well:	PUCKETT 43D-2	Survey Calculation Method:	Minimum Curvature
Wellbore:	DD		
Design:	Plan #1		

Planned Survey

Measured Depth (usft)	Inclination (°)	Azimuth (°)	Vertical Depth (usft)	+N/-S (usft)	+E/-W (usft)	Vertical Section (usft)	Dogleg Rate (°/100usft)	Build Rate (°/100u)	Comments / Formations
0.0	0.00	0.00	0.0	0.0	0.0	0.0	0.00	0.00	
100.0	0.00	0.00	100.0	0.0	0.0	0.0	0.00	0.00	
200.0	0.00	0.00	200.0	0.0	0.0	0.0	0.00	0.00	
300.0	0.00	0.00	300.0	0.0	0.0	0.0	0.00	0.00	
325.0	0.00	0.00	325.0	0.0	0.0	0.0	0.00	0.00	KOP @ 325'
400.0	2.25	294.65	400.0	0.6	-1.3	1.5	3.00	3.00	
500.0	5.25	294.65	499.8	3.3	-7.3	8.0	3.00	3.00	
586.1	7.83	294.65	585.3	7.4	-16.2	17.8	3.00	3.00	EOB @ 7.83° INC
600.0	7.83	294.65	599.1	8.2	-17.9	19.7	0.00	0.00	
700.0	7.83	294.65	698.1	13.9	-30.3	33.3	0.00	0.00	
800.0	7.83	294.65	797.2	19.6	-42.7	47.0	0.00	0.00	
900.0	7.83	294.65	896.3	25.3	-55.1	60.6	0.00	0.00	
1,000.0	7.83	294.65	995.3	31.0	-67.5	74.2	0.00	0.00	
1,100.0	7.83	294.65	1,094.4	36.6	-79.9	87.9	0.00	0.00	
1,200.0	7.83	294.65	1,193.5	42.3	-92.2	101.5	0.00	0.00	
1,300.0	7.83	294.65	1,292.5	48.0	-104.6	115.1	0.00	0.00	
1,400.0	7.83	294.65	1,391.6	53.7	-117.0	128.8	0.00	0.00	
1,500.0	7.83	294.65	1,490.7	59.4	-129.4	142.4	0.00	0.00	
1,600.0	7.83	294.65	1,589.7	65.1	-141.8	156.0	0.00	0.00	
1,700.0	7.83	294.65	1,688.8	70.8	-154.2	169.6	0.00	0.00	
1,800.0	7.83	294.65	1,787.9	76.4	-166.6	183.3	0.00	0.00	
1,900.0	7.83	294.65	1,886.9	82.1	-179.0	196.9	0.00	0.00	
2,000.0	7.83	294.65	1,986.0	87.8	-191.4	210.5	0.00	0.00	
2,100.0	7.83	294.65	2,085.1	93.5	-203.7	224.2	0.00	0.00	
2,200.0	7.83	294.65	2,184.1	99.2	-216.1	237.8	0.00	0.00	
2,300.0	7.83	294.65	2,283.2	104.9	-228.5	251.4	0.00	0.00	
2,400.0	7.83	294.65	2,382.3	110.5	-240.9	265.1	0.00	0.00	
2,500.0	7.83	294.65	2,481.3	116.2	-253.3	278.7	0.00	0.00	
2,600.0	7.83	294.65	2,580.4	121.9	-265.7	292.3	0.00	0.00	
2,700.0	7.83	294.65	2,679.5	127.6	-278.1	306.0	0.00	0.00	
2,800.0	7.83	294.65	2,778.5	133.3	-290.5	319.6	0.00	0.00	
2,900.0	7.83	294.65	2,877.6	139.0	-302.9	333.2	0.00	0.00	
3,000.0	7.83	294.65	2,976.7	144.6	-315.2	346.8	0.00	0.00	
3,100.0	7.83	294.65	3,075.7	150.3	-327.6	360.5	0.00	0.00	
3,200.0	7.83	294.65	3,174.8	156.0	-340.0	374.1	0.00	0.00	
3,300.0	7.83	294.65	3,273.9	161.7	-352.4	387.7	0.00	0.00	
3,400.0	7.83	294.65	3,372.9	167.4	-364.8	401.4	0.00	0.00	
3,500.0	7.83	294.65	3,472.0	173.1	-377.2	415.0	0.00	0.00	
3,600.0	7.83	294.65	3,571.1	178.8	-389.6	428.6	0.00	0.00	
3,700.0	7.83	294.65	3,670.1	184.4	-402.0	442.3	0.00	0.00	
3,800.0	7.83	294.65	3,769.2	190.1	-414.4	455.9	0.00	0.00	
3,900.0	7.83	294.65	3,868.3	195.8	-426.7	469.5	0.00	0.00	
4,000.0	7.83	294.65	3,967.3	201.5	-439.1	483.2	0.00	0.00	
4,100.0	7.83	294.65	4,066.4	207.2	-451.5	496.8	0.00	0.00	
4,200.0	7.83	294.65	4,165.5	212.9	-463.9	510.4	0.00	0.00	
4,300.0	7.83	294.65	4,264.5	218.5	-476.3	524.0	0.00	0.00	
4,400.0	7.83	294.65	4,363.6	224.2	-488.7	537.7	0.00	0.00	
4,500.0	7.83	294.65	4,462.7	229.9	-501.1	551.3	0.00	0.00	
4,600.0	7.83	294.65	4,561.7	235.6	-513.5	564.9	0.00	0.00	
4,700.0	7.83	294.65	4,660.8	241.3	-525.8	578.6	0.00	0.00	
4,800.0	7.83	294.65	4,759.9	247.0	-538.2	592.2	0.00	0.00	
4,900.0	7.83	294.65	4,858.9	252.7	-550.6	605.8	0.00	0.00	

Cathedral Energy Services

Planning Report

Database:	USA EDM 5000 Multi Users DB	Local Co-ordinate Reference:	Well PUCKETT 43D-2
Company:	Caerus Oil & Gas (NAD 27)	TVD Reference:	KB=22' @ 8446.0usft
Project:	Garfield County, CO	MD Reference:	KB=22' @ 8446.0usft
Site:	S2-T7S-R97W (Puckett Pad P2)	North Reference:	True
Well:	PUCKETT 43D-2	Survey Calculation Method:	Minimum Curvature
Wellbore:	DD		
Design:	Plan #1		

Planned Survey

Measured Depth (usft)	Inclination (°)	Azimuth (°)	Vertical Depth (usft)	+N/-S (usft)	+E/-W (usft)	Vertical Section (usft)	Dogleg Rate (°/100usft)	Build Rate (°/100u)	Comments / Formations
5,000.0	7.83	294.65	4,958.0	258.3	-563.0	619.5	0.00	0.00	
5,100.0	7.83	294.65	5,057.1	264.0	-575.4	633.1	0.00	0.00	
5,200.0	7.83	294.65	5,156.1	269.7	-587.8	646.7	0.00	0.00	
5,300.0	7.83	294.65	5,255.2	275.4	-600.2	660.3	0.00	0.00	
5,400.0	7.83	294.65	5,354.3	281.1	-612.6	674.0	0.00	0.00	
5,500.0	7.83	294.65	5,453.3	286.8	-625.0	687.6	0.00	0.00	
5,600.0	7.83	294.65	5,552.4	292.4	-637.3	701.2	0.00	0.00	
5,700.0	7.83	294.65	5,651.5	298.1	-649.7	714.9	0.00	0.00	
5,800.0	7.83	294.65	5,750.5	303.8	-662.1	728.5	0.00	0.00	
5,861.0	7.83	294.65	5,811.0	307.3	-669.7	736.8	0.00	0.00	OHIO CREEK
5,900.0	7.83	294.65	5,849.6	309.5	-674.5	742.1	0.00	0.00	
6,000.0	7.83	294.65	5,948.7	315.2	-686.9	755.8	0.00	0.00	
6,100.0	7.83	294.65	6,047.7	320.9	-699.3	769.4	0.00	0.00	
6,200.0	7.83	294.65	6,146.8	326.6	-711.7	783.0	0.00	0.00	
6,300.0	7.83	294.65	6,245.9	332.2	-724.1	796.7	0.00	0.00	
6,396.0	7.83	294.65	6,341.0	337.7	-736.0	809.7	0.00	0.00	WILLIAMS FORK
6,400.0	7.83	294.65	6,344.9	337.9	-736.5	810.3	0.00	0.00	
6,500.0	7.83	294.65	6,444.0	343.6	-748.8	823.9	0.00	0.00	
6,600.0	7.83	294.65	6,543.1	349.3	-761.2	837.5	0.00	0.00	
6,700.0	7.83	294.65	6,642.1	355.0	-773.6	851.2	0.00	0.00	
6,800.0	7.83	294.65	6,741.2	360.7	-786.0	864.8	0.00	0.00	
6,900.0	7.83	294.65	6,840.3	366.3	-798.4	878.4	0.00	0.00	
7,000.0	7.83	294.65	6,939.3	372.0	-810.8	892.1	0.00	0.00	
7,072.0	7.83	294.65	7,010.7	376.1	-819.7	901.9	0.00	0.00	Start 3° Drop
7,100.0	6.99	294.65	7,038.4	377.6	-823.0	905.5	3.00	-3.00	
7,200.0	3.99	294.65	7,137.9	381.6	-831.7	915.1	3.00	-3.00	
7,300.0	0.99	294.65	7,237.8	383.4	-835.6	919.4	3.00	-3.00	
7,333.2	0.00	0.00	7,271.0	383.6	-835.9	919.7	3.00	-3.00	EOD @ 0° INC - TOG
7,400.0	0.00	0.00	7,337.8	383.6	-835.9	919.7	0.00	0.00	
7,500.0	0.00	0.00	7,437.8	383.6	-835.9	919.7	0.00	0.00	
7,600.0	0.00	0.00	7,537.8	383.6	-835.9	919.7	0.00	0.00	
7,700.0	0.00	0.00	7,637.8	383.6	-835.9	919.7	0.00	0.00	
7,800.0	0.00	0.00	7,737.8	383.6	-835.9	919.7	0.00	0.00	
7,900.0	0.00	0.00	7,837.8	383.6	-835.9	919.7	0.00	0.00	
8,000.0	0.00	0.00	7,937.8	383.6	-835.9	919.7	0.00	0.00	
8,100.0	0.00	0.00	8,037.8	383.6	-835.9	919.7	0.00	0.00	
8,200.0	0.00	0.00	8,137.8	383.6	-835.9	919.7	0.00	0.00	
8,278.2	0.00	0.00	8,216.0	383.6	-835.9	919.7	0.00	0.00	CAMEO
8,300.0	0.00	0.00	8,237.8	383.6	-835.9	919.7	0.00	0.00	
8,400.0	0.00	0.00	8,337.8	383.6	-835.9	919.7	0.00	0.00	
8,500.0	0.00	0.00	8,437.8	383.6	-835.9	919.7	0.00	0.00	
8,600.0	0.00	0.00	8,537.8	383.6	-835.9	919.7	0.00	0.00	
8,693.2	0.00	0.00	8,631.0	383.6	-835.9	919.7	0.00	0.00	ROLLINS
8,700.0	0.00	0.00	8,637.8	383.6	-835.9	919.7	0.00	0.00	
8,800.0	0.00	0.00	8,737.8	383.6	-835.9	919.7	0.00	0.00	
8,843.2	0.00	0.00	8,781.0	383.6	-835.9	919.7	0.00	0.00	TD @ 8,843.2' MD

Cathedral Energy Services

Planning Report

Database:	USA EDM 5000 Multi Users DB	Local Co-ordinate Reference:	Well PUCKETT 43D-2
Company:	Caerus Oil & Gas (NAD 27)	TVD Reference:	KB=22' @ 8446.0usft
Project:	Garfield County, CO	MD Reference:	KB=22' @ 8446.0usft
Site:	S2-T7S-R97W (Puckett Pad P2)	North Reference:	True
Well:	PUCKETT 43D-2	Survey Calculation Method:	Minimum Curvature
Wellbore:	DD		
Design:	Plan #1		

Targets									
Target Name									
- hit/miss target	Dip Angle	Dip Dir.	TVD	+N/-S	+E/-W	Northing	Easting	Latitude	Longitude
- Shape	(°)	(°)	(usft)	(usft)	(usft)	(usft)	(usft)		
PUCKETT 43D-2 BHL	0.00	0.00	8,781.0	383.6	-835.9	607,745.23	1,243,126.41	39.471400	-108.181425
- plan hits target center									
- Circle (radius 50.0)									
PUCKETT 43D-2 TGT	0.00	0.00	7,271.0	383.6	-835.9	607,745.23	1,243,126.41	39.471400	-108.181425
- plan hits target center									
- Point									

Formations						
Measured Depth	Vertical Depth	Name	Lithology	Dip	Dip Direction	
(usft)	(usft)			(°)	(°)	
5,861.0	5,811.0	OHIO CREEK				
6,396.0	6,341.0	WILLIAMS FORK				
7,333.2	7,271.0	TOG				
8,278.2	8,216.0	CAMEO				
8,693.2	8,631.0	ROLLINS				

Plan Annotations					
Measured Depth	Vertical Depth	Local Coordinates			
(usft)	(usft)	+N/-S	+E/-W	Comment	
(usft)	(usft)	(usft)	(usft)		
325.0	325.0	0.0	0.0	KOP @ 325'	
586.1	585.3	7.4	-16.2	EOB @ 7.83° INC	
7,072.0	7,010.7	376.1	-819.7	Start 3° Drop	
7,333.2	7,271.0	383.6	-835.9	EOD @ 0° INC	
8,843.2	8,781.0	383.6	-835.9	TD @ 8,843.2' MD	