

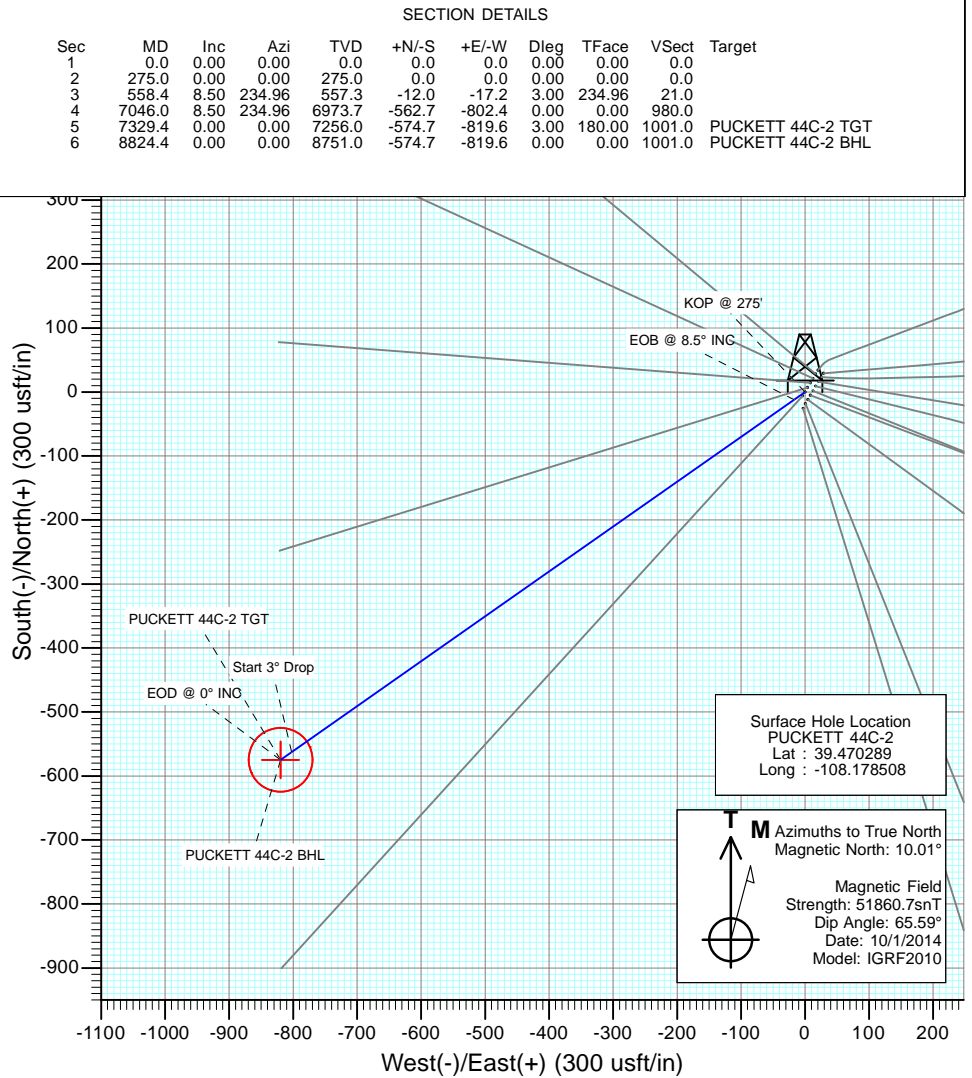

Project: Garfield County, CO
Site: S2-T7S-R97W (Puckett Pad P2)
Well: PUCKETT 44C-2
Wellbore: DD
Design: Plan #1

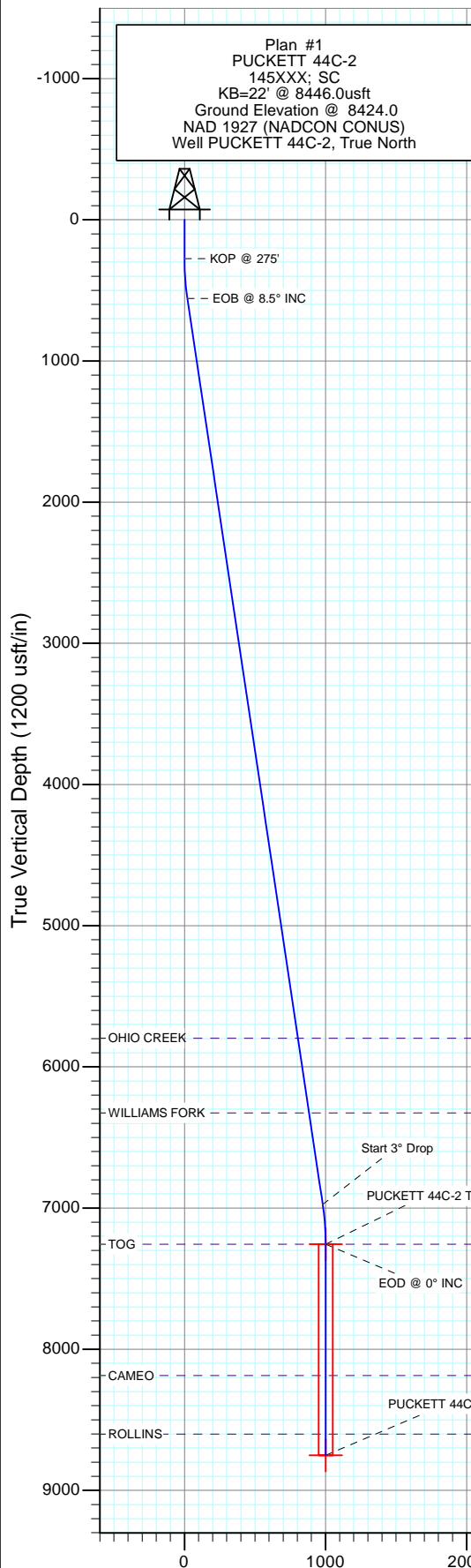

DESIGN TARGET DETAILS							
Name	+N/-S	+E/-W	Northing	Easting	Latitude	Longitude	
PUCKETT 44C-2 TGT	-574.7	-819.6	606766.13	1243101.46	39.468711	-108.181411	
PUCKETT 44C-2 BHL	-574.7	-819.6	606766.13	1243101.46	39.468711	-108.181411	

Vertical Section at 234.96° (1200 usft/in)

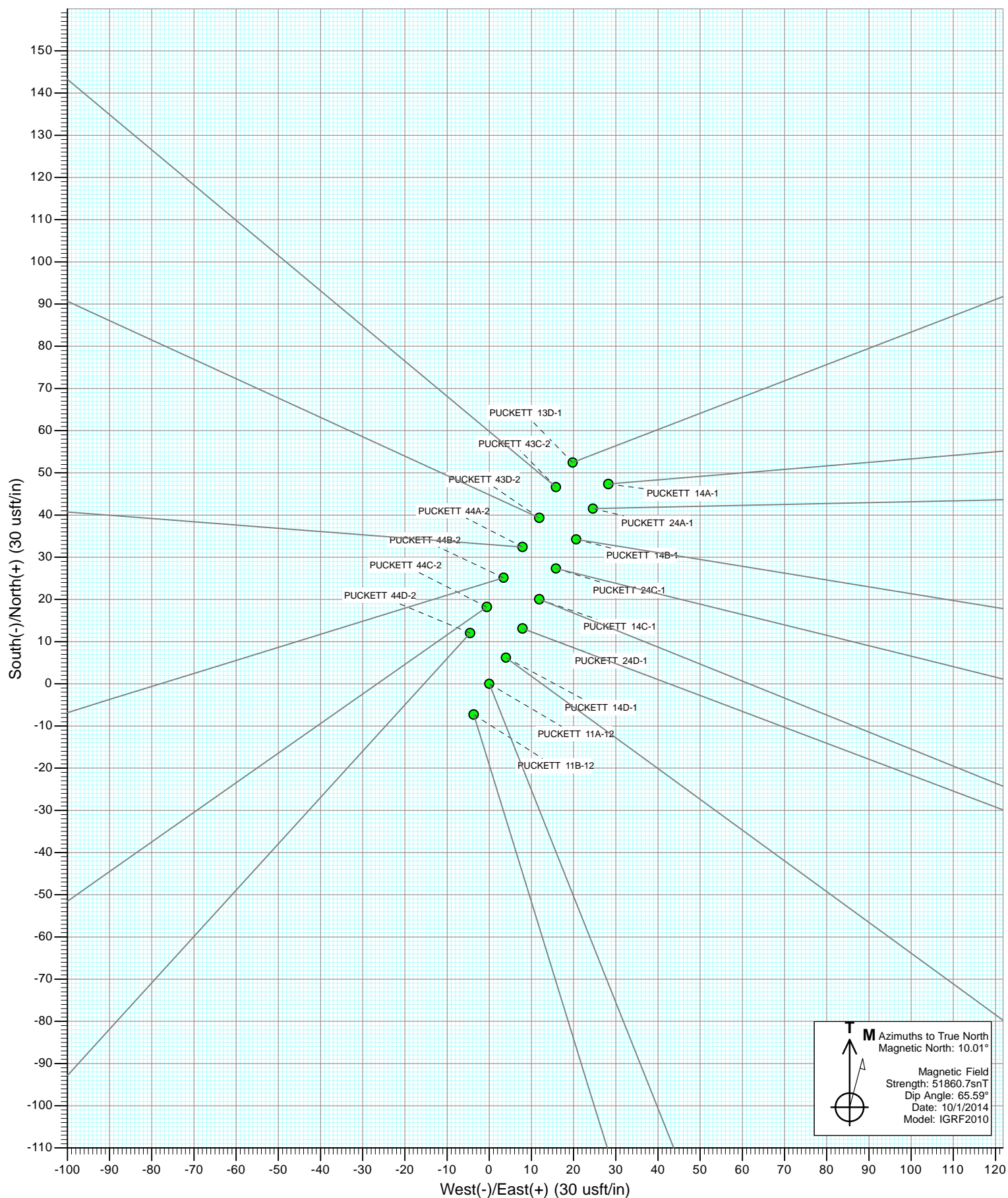

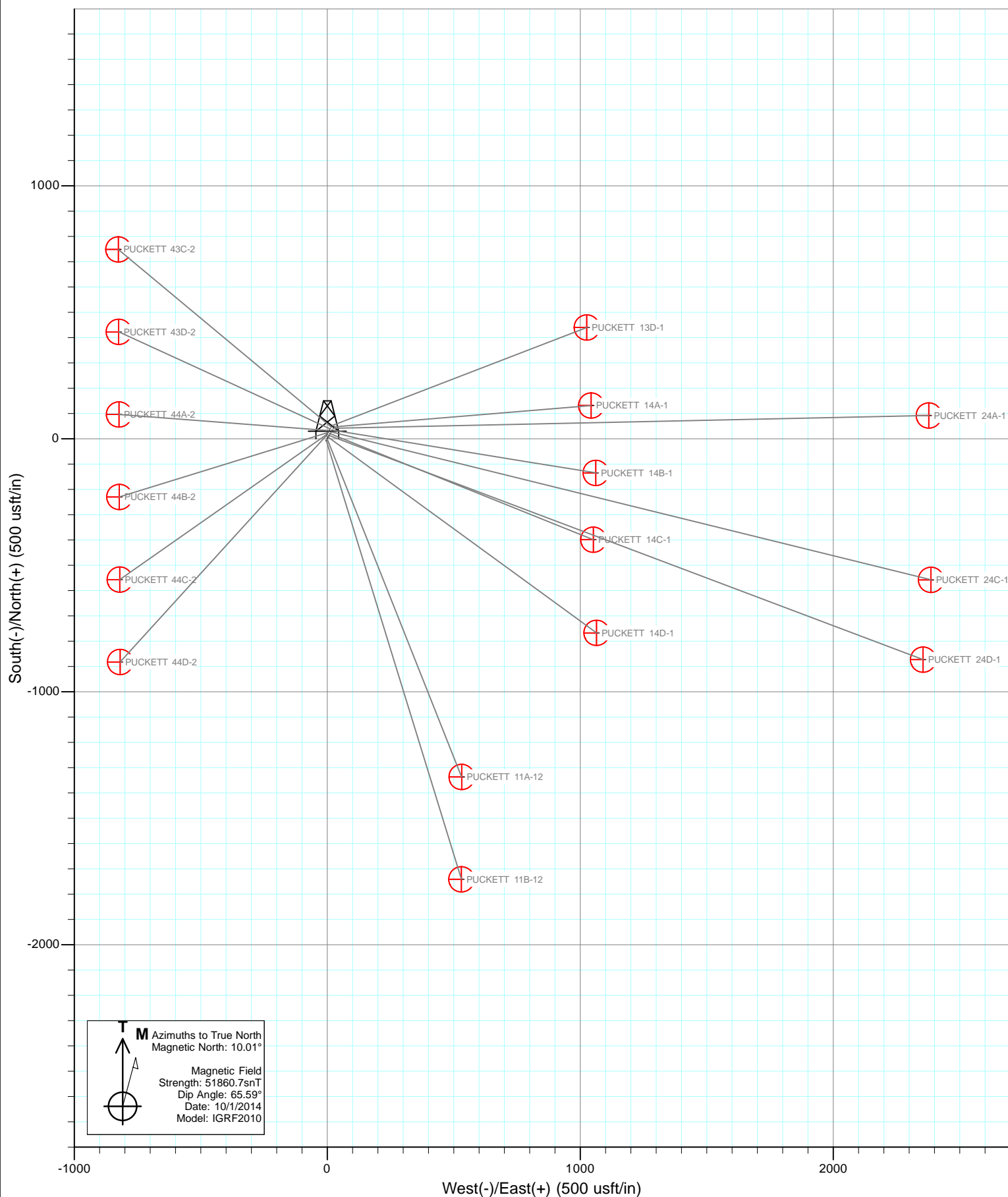

Cathedral Energy Services

Planning Report

Database:	USA EDM 5000 Multi Users DB	Local Co-ordinate Reference:	Well PUCKETT 44C-2
Company:	Caerus Oil & Gas (NAD 27)	TVD Reference:	KB=22' @ 8446.0usft
Project:	Garfield County, CO	MD Reference:	KB=22' @ 8446.0usft
Site:	S2-T7S-R97W (Puckett Pad P2)	North Reference:	True
Well:	PUCKETT 44C-2	Survey Calculation Method:	Minimum Curvature
Wellbore:	DD		
Design:	Plan #1		

Project	Garfield County, CO		
Map System:	US State Plane 1927 (Exact solution)	System Datum:	Mean Sea Level
Geo Datum:	NAD 1927 (NADCON CONUS)		
Map Zone:	Colorado Central 502		

Site		S2-T7S-R97W (Puckett Pad P2)			
Site Position:		Northing:	607,291.06 usft	Latitude:	39.470219
From:	Lat/Long	Easting:	1,243,933.75 usft	Longitude:	-108.178519
Position Uncertainty:	0.0 usft	Slot Radius:	13-3/16 "	Grid Convergence:	-1.69 °

Well	PUCKETT 44C-2					
Well Position	+N/-S	0.0 usft	Northing:	607,316.44 usft	Latitude:	39.470289
	+E/-W	0.0 usft	Easting:	1,243,937.61 usft	Longitude:	-108.178508
Position Uncertainty		0.0 usft	Wellhead Elevation:	0.0 usft	Ground Level:	8,424.0 usft

Wellbore	DD				
Magnetics	Model Name	Sample Date	Declination (°)	Dip Angle (°)	Field Strength (nT)
	IGRF2010	10/1/2014	10.00	65.59	51,861

Design	Plan #1				
Audit Notes:					
Version:	Phase:	PLAN	Tie On Depth:	0.0	
Vertical Section:	Depth From (TVD) (usft)	+N/-S (usft)	+E/-W (usft)	Direction (°)	
	0.0	0.0	0.0	234.96	

Plan Sections										
Measured Depth (usft)	Inclination (°)	Azimuth (°)	Vertical Depth (usft)	+N/-S (usft)	+E/-W (usft)	Dogleg Rate (°/100usft)	Build Rate (°/100usft)	Turn Rate (°/100usft)	TFO (°)	Target
0.0	0.00	0.00	0.0	0.0	0.0	0.00	0.00	0.00	0.00	
275.0	0.00	0.00	275.0	0.0	0.0	0.00	0.00	0.00	0.00	
558.4	8.50	234.96	557.3	-12.0	-17.2	3.00	3.00	0.00	234.96	
7,046.0	8.50	234.96	6,973.7	-562.7	-802.4	0.00	0.00	0.00	0.00	
7,329.4	0.00	0.00	7,256.0	-574.7	-819.6	3.00	-3.00	0.00	180.00	PUCKETT 44C-2 TG1
8,824.4	0.00	0.00	8,751.0	-574.7	-819.6	0.00	0.00	0.00	0.00	PUCKETT 44C-2 BHL

Cathedral Energy Services

Planning Report

Database:	USA EDM 5000 Multi Users DB	Local Co-ordinate Reference:	Well PUCKETT 44C-2
Company:	Caerus Oil & Gas (NAD 27)	TVD Reference:	KB=22' @ 8446.0usft
Project:	Garfield County, CO	MD Reference:	KB=22' @ 8446.0usft
Site:	S2-T7S-R97W (Puckett Pad P2)	North Reference:	True
Well:	PUCKETT 44C-2	Survey Calculation Method:	Minimum Curvature
Wellbore:	DD		
Design:	Plan #1		

Planned Survey

Measured Depth (usft)	Inclination (°)	Azimuth (°)	Vertical Depth (usft)	+N/-S (usft)	+E/-W (usft)	Vertical Section (usft)	Dogleg Rate (°/100usft)	Build Rate (°/100u)	Comments / Formations
0.0	0.00	0.00	0.0	0.0	0.0	0.0	0.00	0.00	
100.0	0.00	0.00	100.0	0.0	0.0	0.0	0.00	0.00	
200.0	0.00	0.00	200.0	0.0	0.0	0.0	0.00	0.00	
275.0	0.00	0.00	275.0	0.0	0.0	0.0	0.00	0.00	KOP @ 275'
300.0	0.75	234.96	300.0	-0.1	-0.1	0.2	3.00	3.00	
400.0	3.75	234.96	399.9	-2.3	-3.3	4.1	3.00	3.00	
500.0	6.75	234.96	499.5	-7.6	-10.8	13.2	3.00	3.00	
558.4	8.50	234.96	557.3	-12.0	-17.2	21.0	3.00	3.00	EOB @ 8.5° INC
600.0	8.50	234.96	598.5	-15.6	-22.2	27.1	0.00	0.00	
700.0	8.50	234.96	697.4	-24.1	-34.3	41.9	0.00	0.00	
800.0	8.50	234.96	796.3	-32.6	-46.4	56.7	0.00	0.00	
900.0	8.50	234.96	895.2	-41.0	-58.5	71.5	0.00	0.00	
1,000.0	8.50	234.96	994.1	-49.5	-70.6	86.3	0.00	0.00	
1,100.0	8.50	234.96	1,093.0	-58.0	-82.7	101.1	0.00	0.00	
1,200.0	8.50	234.96	1,191.9	-66.5	-94.8	115.8	0.00	0.00	
1,300.0	8.50	234.96	1,290.8	-75.0	-106.9	130.6	0.00	0.00	
1,400.0	8.50	234.96	1,389.7	-83.5	-119.0	145.4	0.00	0.00	
1,500.0	8.50	234.96	1,488.6	-92.0	-131.1	160.2	0.00	0.00	
1,600.0	8.50	234.96	1,587.5	-100.5	-143.3	175.0	0.00	0.00	
1,700.0	8.50	234.96	1,686.4	-108.9	-155.4	189.7	0.00	0.00	
1,800.0	8.50	234.96	1,785.3	-117.4	-167.5	204.5	0.00	0.00	
1,900.0	8.50	234.96	1,884.2	-125.9	-179.6	219.3	0.00	0.00	
2,000.0	8.50	234.96	1,983.1	-134.4	-191.7	234.1	0.00	0.00	
2,100.0	8.50	234.96	2,082.0	-142.9	-203.8	248.9	0.00	0.00	
2,200.0	8.50	234.96	2,180.9	-151.4	-215.9	263.7	0.00	0.00	
2,300.0	8.50	234.96	2,279.8	-159.9	-228.0	278.4	0.00	0.00	
2,400.0	8.50	234.96	2,378.7	-168.4	-240.1	293.2	0.00	0.00	
2,500.0	8.50	234.96	2,477.6	-176.8	-252.2	308.0	0.00	0.00	
2,600.0	8.50	234.96	2,576.5	-185.3	-264.3	322.8	0.00	0.00	
2,700.0	8.50	234.96	2,675.4	-193.8	-276.4	337.6	0.00	0.00	
2,800.0	8.50	234.96	2,774.3	-202.3	-288.5	352.4	0.00	0.00	
2,900.0	8.50	234.96	2,873.2	-210.8	-300.6	367.1	0.00	0.00	
3,000.0	8.50	234.96	2,972.1	-219.3	-312.7	381.9	0.00	0.00	
3,100.0	8.50	234.96	3,071.0	-227.8	-324.8	396.7	0.00	0.00	
3,200.0	8.50	234.96	3,169.9	-236.3	-336.9	411.5	0.00	0.00	
3,300.0	8.50	234.96	3,268.8	-244.7	-349.0	426.3	0.00	0.00	
3,400.0	8.50	234.96	3,367.7	-253.2	-361.1	441.0	0.00	0.00	
3,500.0	8.50	234.96	3,466.6	-261.7	-373.2	455.8	0.00	0.00	
3,600.0	8.50	234.96	3,565.5	-270.2	-385.3	470.6	0.00	0.00	
3,700.0	8.50	234.96	3,664.4	-278.7	-397.4	485.4	0.00	0.00	
3,800.0	8.50	234.96	3,763.3	-287.2	-409.5	500.2	0.00	0.00	
3,900.0	8.50	234.96	3,862.2	-295.7	-421.6	515.0	0.00	0.00	
4,000.0	8.50	234.96	3,961.1	-304.2	-433.7	529.7	0.00	0.00	
4,100.0	8.50	234.96	4,060.1	-312.6	-445.8	544.5	0.00	0.00	
4,200.0	8.50	234.96	4,159.0	-321.1	-457.9	559.3	0.00	0.00	
4,300.0	8.50	234.96	4,257.9	-329.6	-470.0	574.1	0.00	0.00	
4,400.0	8.50	234.96	4,356.8	-338.1	-482.1	588.9	0.00	0.00	
4,500.0	8.50	234.96	4,455.7	-346.6	-494.2	603.7	0.00	0.00	
4,600.0	8.50	234.96	4,554.6	-355.1	-506.3	618.4	0.00	0.00	
4,700.0	8.50	234.96	4,653.5	-363.6	-518.4	633.2	0.00	0.00	
4,800.0	8.50	234.96	4,752.4	-372.1	-530.6	648.0	0.00	0.00	
4,900.0	8.50	234.96	4,851.3	-380.5	-542.7	662.8	0.00	0.00	

Cathedral Energy Services

Planning Report

Database:	USA EDM 5000 Multi Users DB	Local Co-ordinate Reference:	Well PUCKETT 44C-2
Company:	Caerus Oil & Gas (NAD 27)	TVD Reference:	KB=22' @ 8446.0usft
Project:	Garfield County, CO	MD Reference:	KB=22' @ 8446.0usft
Site:	S2-T7S-R97W (Puckett Pad P2)	North Reference:	True
Well:	PUCKETT 44C-2	Survey Calculation Method:	Minimum Curvature
Wellbore:	DD		
Design:	Plan #1		

Planned Survey

Measured Depth (usft)	Inclination (°)	Azimuth (°)	Vertical Depth (usft)	+N/-S (usft)	+E/-W (usft)	Vertical Section (usft)	Dogleg Rate (°/100usft)	Build Rate (°/100u)	Comments / Formations
5,000.0	8.50	234.96	4,950.2	-389.0	-554.8	677.6	0.00	0.00	
5,100.0	8.50	234.96	5,049.1	-397.5	-566.9	692.4	0.00	0.00	
5,200.0	8.50	234.96	5,148.0	-406.0	-579.0	707.1	0.00	0.00	
5,300.0	8.50	234.96	5,246.9	-414.5	-591.1	721.9	0.00	0.00	
5,400.0	8.50	234.96	5,345.8	-423.0	-603.2	736.7	0.00	0.00	
5,500.0	8.50	234.96	5,444.7	-431.5	-615.3	751.5	0.00	0.00	
5,600.0	8.50	234.96	5,543.6	-440.0	-627.4	766.3	0.00	0.00	
5,700.0	8.50	234.96	5,642.5	-448.4	-639.5	781.0	0.00	0.00	
5,800.0	8.50	234.96	5,741.4	-456.9	-651.6	795.8	0.00	0.00	
5,855.2	8.50	234.96	5,796.0	-461.6	-658.3	804.0	0.00	0.00	OHIO CREEK
5,900.0	8.50	234.96	5,840.3	-465.4	-663.7	810.6	0.00	0.00	
6,000.0	8.50	234.96	5,939.2	-473.9	-675.8	825.4	0.00	0.00	
6,100.0	8.50	234.96	6,038.1	-482.4	-687.9	840.2	0.00	0.00	
6,200.0	8.50	234.96	6,137.0	-490.9	-700.0	855.0	0.00	0.00	
6,300.0	8.50	234.96	6,235.9	-499.4	-712.1	869.7	0.00	0.00	
6,391.1	8.50	234.96	6,326.0	-507.1	-723.1	883.2	0.00	0.00	WILLIAMS FORK
6,400.0	8.50	234.96	6,334.8	-507.9	-724.2	884.5	0.00	0.00	
6,500.0	8.50	234.96	6,433.7	-516.3	-736.3	899.3	0.00	0.00	
6,600.0	8.50	234.96	6,532.6	-524.8	-748.4	914.1	0.00	0.00	
6,700.0	8.50	234.96	6,631.5	-533.3	-760.5	928.9	0.00	0.00	
6,800.0	8.50	234.96	6,730.4	-541.8	-772.6	943.7	0.00	0.00	
6,900.0	8.50	234.96	6,829.3	-550.3	-784.7	958.4	0.00	0.00	
7,000.0	8.50	234.96	6,928.2	-558.8	-796.8	973.2	0.00	0.00	
7,046.0	8.50	234.96	6,973.7	-562.7	-802.4	980.0	0.00	0.00	Start 3° Drop
7,100.0	6.88	234.96	7,027.2	-566.8	-808.3	987.2	3.00	-3.00	
7,200.0	3.88	234.96	7,126.7	-572.2	-816.0	996.6	3.00	-3.00	
7,300.0	0.88	234.96	7,226.6	-574.6	-819.4	1,000.8	3.00	-3.00	
7,329.4	0.00	0.00	7,256.0	-574.7	-819.6	1,001.0	3.00	-3.00	EOD @ 0° INC - TOG
7,400.0	0.00	0.00	7,326.6	-574.7	-819.6	1,001.0	0.00	0.00	
7,500.0	0.00	0.00	7,426.6	-574.7	-819.6	1,001.0	0.00	0.00	
7,600.0	0.00	0.00	7,526.6	-574.7	-819.6	1,001.0	0.00	0.00	
7,700.0	0.00	0.00	7,626.6	-574.7	-819.6	1,001.0	0.00	0.00	
7,800.0	0.00	0.00	7,726.6	-574.7	-819.6	1,001.0	0.00	0.00	
7,900.0	0.00	0.00	7,826.6	-574.7	-819.6	1,001.0	0.00	0.00	
8,000.0	0.00	0.00	7,926.6	-574.7	-819.6	1,001.0	0.00	0.00	
8,100.0	0.00	0.00	8,026.6	-574.7	-819.6	1,001.0	0.00	0.00	
8,200.0	0.00	0.00	8,126.6	-574.7	-819.6	1,001.0	0.00	0.00	
8,259.4	0.00	0.00	8,186.0	-574.7	-819.6	1,001.0	0.00	0.00	CAMEO
8,300.0	0.00	0.00	8,226.6	-574.7	-819.6	1,001.0	0.00	0.00	
8,400.0	0.00	0.00	8,326.6	-574.7	-819.6	1,001.0	0.00	0.00	
8,500.0	0.00	0.00	8,426.6	-574.7	-819.6	1,001.0	0.00	0.00	
8,600.0	0.00	0.00	8,526.6	-574.7	-819.6	1,001.0	0.00	0.00	
8,674.4	0.00	0.00	8,601.0	-574.7	-819.6	1,001.0	0.00	0.00	ROLLINS
8,700.0	0.00	0.00	8,626.6	-574.7	-819.6	1,001.0	0.00	0.00	
8,800.0	0.00	0.00	8,726.6	-574.7	-819.6	1,001.0	0.00	0.00	
8,824.4	0.00	0.00	8,751.0	-574.7	-819.6	1,001.0	0.00	0.00	TD @ 8,824.4' MD

Cathedral Energy Services

Planning Report

Database:	USA EDM 5000 Multi Users DB	Local Co-ordinate Reference:	Well PUCKETT 44C-2
Company:	Caerus Oil & Gas (NAD 27)	TVD Reference:	KB=22' @ 8446.0usft
Project:	Garfield County, CO	MD Reference:	KB=22' @ 8446.0usft
Site:	S2-T7S-R97W (Puckett Pad P2)	North Reference:	True
Well:	PUCKETT 44C-2	Survey Calculation Method:	Minimum Curvature
Wellbore:	DD		
Design:	Plan #1		

Targets									
Target Name									
- hit/miss target	Dip Angle	Dip Dir.	TVD	+N/-S	+E/-W	Northing	Easting	Latitude	Longitude
- Shape	(°)	(°)	(usft)	(usft)	(usft)	(usft)	(usft)		
PUCKETT 44C-2 TGT	0.00	0.00	7,256.0	-574.7	-819.6	606,766.13	1,243,101.46	39.468711	-108.181411
- plan hits target center									
- Point									
PUCKETT 44C-2 BHL	0.00	0.00	8,751.0	-574.7	-819.6	606,766.13	1,243,101.46	39.468711	-108.181411
- plan hits target center									
- Circle (radius 50.0)									

Formations						
Measured Depth	Vertical Depth	Name	Lithology	Dip	Dip Direction	
(usft)	(usft)			(°)	(°)	
5,855.2	5,796.0	OHIO CREEK				
6,391.1	6,326.0	WILLIAMS FORK				
7,329.4	7,256.0	TOG				
8,259.4	8,186.0	CAMEO				
8,674.4	8,601.0	ROLLINS				

Plan Annotations					
Measured Depth	Vertical Depth	Local Coordinates			
(usft)	(usft)	+N/-S	+E/-W	Comment	
(usft)	(usft)	(usft)	(usft)		
275.0	275.0	0.0	0.0	KOP @ 275'	
558.4	557.3	-12.0	-17.2	EOB @ 8.5° INC	
7,046.0	6,973.7	-562.7	-802.4	Start 3° Drop	
7,329.4	7,256.0	-574.7	-819.6	EOD @ 0° INC	
8,824.4	8,751.0	-574.7	-819.6	TD @ 8,824.4' MD	

Caerus Oil & Gas (NAD 27)

Garfield County, CO

S2-T7S-R97W (Puckett Pad P2)

PUCKETT 44C-2

DD

Plan #1

Anticollision Report

01 October, 2014

Cathedral Energy Services

Anticollision Report

Company:	Caerus Oil & Gas (NAD 27)	Local Co-ordinate Reference:	Well PUCKETT 44C-2
Project:	Garfield County, CO	TVD Reference:	KB=22' @ 8446.0usft
Reference Site:	S2-T7S-R97W (Puckett Pad P2)	MD Reference:	KB=22' @ 8446.0usft
Site Error:	0.0usft	North Reference:	True
Reference Well:	PUCKETT 44C-2	Survey Calculation Method:	Minimum Curvature
Well Error:	0.0usft	Output errors are at	2.00 sigma
Reference Wellbore	DD	Database:	USA EDM 5000 Multi Users DB
Reference Design:	Plan #1	Offset TVD Reference:	Offset Datum

Reference	Plan #1		
Filter type:	NO GLOBAL FILTER: Using user defined selection & filtering criteria		
Interpolation Method:	MD Interval 100.0usft	Error Model:	ISCWSA
Depth Range:	Unlimited	Scan Method:	Closest Approach 3D
Results Limited by:	Maximum center-center distance of 200.0usft	Error Surface:	Elliptical Conic
Warning Levels Evaluated at:	2.00 Sigma		

Survey Tool Program		Date	10/1/2014		
From (usft)	To (usft)	Survey (Wellbore)	Tool Name	Description	
0.0	8,823.5	Plan #1 (DD)	ISCWSA MWD	MWD - Standard	

Cathedral Energy Services

Anticollision Report

Company:	Caerus Oil & Gas (NAD 27)	Local Co-ordinate Reference:	Well PUCKETT 44C-2
Project:	Garfield County, CO	TVD Reference:	KB=22' @ 8446.0usft
Reference Site:	S2-T7S-R97W (Puckett Pad P2)	MD Reference:	KB=22' @ 8446.0usft
Site Error:	0.0usft	North Reference:	True
Reference Well:	PUCKETT 44C-2	Survey Calculation Method:	Minimum Curvature
Well Error:	0.0usft	Output errors are at	2.00 sigma
Reference Wellbore	DD	Database:	USA EDM 5000 Multi Users DB
Reference Design:	Plan #1	Offset TVD Reference:	Offset Datum

Summary

Site Name	Reference	Offset	Distance		Separation	Warning
	Measured Depth (usft)	Measured Depth (usft)	Between Centres (usft)	Between Ellipses (usft)		
Offset Well - Wellbore - Design						
S2-T7S-R97W (Puckett Pad P2)						
PUCKETT 11A-12 - DD - Plan #1	222.7	222.7	18.2	17.5	25.076	CC, ES
PUCKETT 11A-12 - DD - Plan #1	400.0	398.4	22.1	20.7	15.053	SF
PUCKETT 11B-12 - DD - Plan #1	200.0	200.0	25.7	25.1	41.112	CC, ES
PUCKETT 11B-12 - DD - Plan #1	500.0	494.1	42.5	40.6	21.546	SF
PUCKETT 13D-1 - DD - Plan #1	200.0	200.0	39.8	39.2	63.716	CC
PUCKETT 13D-1 - DD - Plan #1	204.4	204.4	39.8	39.2	61.778	ES
PUCKETT 13D-1 - DD - Plan #1	500.0	492.0	70.5	68.3	31.506	SF
PUCKETT 14A-1 - DD - Plan #1	200.0	200.0	41.0	40.3	65.562	CC
PUCKETT 14A-1 - DD - Plan #1	300.0	300.0	41.1	40.1	38.262	ES
PUCKETT 14A-1 - DD - Plan #1	500.0	498.4	54.5	52.4	25.153	SF
PUCKETT 14B-1 - DD - Plan #1	200.0	200.0	26.6	25.9	42.502	CC
PUCKETT 14B-1 - DD - Plan #1	300.0	300.0	26.7	25.6	24.855	ES
PUCKETT 14B-1 - DD - Plan #1	500.0	498.0	41.6	39.4	19.162	SF
PUCKETT 14C-1 - DD - Plan #1	200.0	200.0	12.6	11.9	20.093	CC
PUCKETT 14C-1 - DD - Plan #1	300.0	300.0	12.7	11.6	11.828	ES
PUCKETT 14C-1 - DD - Plan #1	400.0	399.6	16.8	15.3	10.678	SF
PUCKETT 14D-1 - DD - Plan #1	309.1	309.1	12.8	11.7	11.545	CC, ES
PUCKETT 14D-1 - DD - Plan #1	400.0	399.2	15.0	13.5	10.112	SF
PUCKETT 24A-1 - DD - Plan #1	200.0	200.0	34.3	33.6	54.851	CC
PUCKETT 24A-1 - DD - Plan #1	300.0	300.0	34.4	33.4	32.034	ES
PUCKETT 24A-1 - DD - Plan #1	500.0	495.4	55.0	52.8	25.021	SF
PUCKETT 24C-1 - DD - Plan #1	200.0	200.0	18.7	18.1	29.988	CC
PUCKETT 24C-1 - DD - Plan #1	239.2	239.2	18.8	18.0	23.543	ES
PUCKETT 24C-1 - DD - Plan #1	400.0	398.3	27.3	25.7	17.128	SF
PUCKETT 24D-1 - DD - Plan #1	200.0	200.0	9.9	9.3	15.817	CC, ES
PUCKETT 24D-1 - DD - Plan #1	300.0	299.4	12.5	11.5	11.774	SF
PUCKETT 43C-2 - DD - Plan #1	200.0	200.0	32.8	32.2	52.478	CC
PUCKETT 43C-2 - DD - Plan #1	300.0	299.9	33.0	31.9	30.730	ES
PUCKETT 43C-2 - DD - Plan #1	500.0	498.2	47.6	45.5	22.203	SF
PUCKETT 43D-2 - DD - Plan #1	200.0	200.0	24.5	23.9	39.226	CC
PUCKETT 43D-2 - DD - Plan #1	300.0	300.0	24.7	23.6	22.959	ES
PUCKETT 43D-2 - DD - Plan #1	500.0	499.8	35.8	33.7	16.865	SF
PUCKETT 44A-2 - DD - Plan #1	200.0	200.0	16.5	15.9	26.467	CC
PUCKETT 44A-2 - DD - Plan #1	300.0	300.0	16.7	15.6	15.536	ES
PUCKETT 44A-2 - DD - Plan #1	500.0	500.5	26.9	24.7	12.652	SF
PUCKETT 44B-2 - DD - Plan #1	200.0	200.0	8.0	7.3	12.754	CC
PUCKETT 44B-2 - DD - Plan #1	300.0	300.0	8.1	7.0	7.558	ES
PUCKETT 44B-2 - DD - Plan #1	500.0	500.7	14.1	12.0	6.723	SF
PUCKETT 44D-2 - DD - Plan #1	200.0	200.0	7.3	6.7	11.750	CC, ES
PUCKETT 44D-2 - DD - Plan #1	500.0	498.4	14.6	12.5	7.041	SF

Cathedral Energy Services

Anticollision Report

Company:	Caerus Oil & Gas (NAD 27)	Local Co-ordinate Reference:	Well PUCKETT 44C-2
Project:	Garfield County, CO	TVD Reference:	KB=22' @ 8446.0usft
Reference Site:	S2-T7S-R97W (Puckett Pad P2)	MD Reference:	KB=22' @ 8446.0usft
Site Error:	0.0usft	North Reference:	True
Reference Well:	PUCKETT 44C-2	Survey Calculation Method:	Minimum Curvature
Well Error:	0.0usft	Output errors are at	2.00 sigma
Reference Wellbore	DD	Database:	USA EDM 5000 Multi Users DB
Reference Design:	Plan #1	Offset TVD Reference:	Offset Datum

Offset Design S2-T7S-R97W (Puckett Pad P2) - PUCKETT 11A-12 - DD - Plan #1													Offset Site Error:	0.0 usft
Survey Program: 0-ISCSWA MWD													Offset Well Error:	0.0 usft
Reference		Offset		Semi Major Axis			Distance						Warning	
Measured Depth (usft)	Vertical Depth (usft)	Measured Depth (usft)	Vertical Depth (usft)	Reference (usft)	Offset (usft)	Highside Toolface (°)	Offset Wellbore Centre +N/-S (usft)	+E/-W (usft)	Between Centres (usft)	Between Ellipses (usft)	Total Uncertainty Axis	Separation Factor		
0.0	0.0	0.0	0.0	0.0	0.0	178.22	-18.2	0.6	18.2					
100.0	100.0	100.0	100.0	0.1	0.1	178.22	-18.2	0.6	18.2	18.0	0.18	103.901		
200.0	200.0	200.0	200.0	0.3	0.3	178.22	-18.2	0.6	18.2	17.6	0.62	29.152		
222.7	222.7	222.7	222.7	0.4	0.4	-56.82	-18.2	0.6	18.2	17.5	0.73	25.076 CC, ES		
300.0	300.0	299.5	299.5	0.5	0.5	-57.81	-18.8	0.8	18.7	17.7	1.06	17.710		
400.0	399.9	398.4	398.2	0.7	0.7	-70.62	-23.6	2.7	22.1	20.7	1.47	15.053 SF		
500.0	499.5	496.3	495.6	1.0	1.0	-88.37	-32.9	6.4	30.9	29.0	1.95	15.848		
600.0	598.5	592.8	591.0	1.3	1.3	-101.08	-46.7	11.9	46.8	44.2	2.55	18.353		
700.0	697.4	688.7	684.9	1.6	1.6	-106.00	-64.6	19.0	68.2	65.0	3.20	21.282		
800.0	796.3	786.1	780.0	1.9	2.0	-108.20	-83.9	26.7	90.8	86.9	3.85	23.551		
900.0	895.2	883.4	875.2	2.3	2.5	-109.53	-103.2	34.3	113.5	109.0	4.52	25.083		
1,000.0	994.1	980.8	970.3	2.6	2.9	-110.41	-122.4	42.0	136.2	131.0	5.21	26.154		
1,100.0	1,093.0	1,078.1	1,065.4	3.0	3.4	-111.04	-141.7	49.6	159.0	153.1	5.90	26.938		
1,200.0	1,191.9	1,175.5	1,160.5	3.3	3.8	-111.51	-161.0	57.3	181.8	175.2	6.60	27.527		

Cathedral Energy Services

Anticollision Report

Company:	Caerus Oil & Gas (NAD 27)	Local Co-ordinate Reference:	Well PUCKETT 44C-2
Project:	Garfield County, CO	TVD Reference:	KB=22' @ 8446.0usft
Reference Site:	S2-T7S-R97W (Puckett Pad P2)	MD Reference:	KB=22' @ 8446.0usft
Site Error:	0.0usft	North Reference:	True
Reference Well:	PUCKETT 44C-2	Survey Calculation Method:	Minimum Curvature
Well Error:	0.0usft	Output errors are at	2.00 sigma
Reference Wellbore	DD	Database:	USA EDM 5000 Multi Users DB
Reference Design:	Plan #1	Offset TVD Reference:	Offset Datum

Offset Design S2-T7S-R97W (Puckett Pad P2) - PUCKETT 11B-12 - DD - Plan #1													Offset Site Error:	0.0 usft
Survey Program: 0-ISCSWA MWD													Offset Well Error:	0.0 usft
Reference		Offset		Semi Major Axis			Distance							
Measured Depth (usft)	Vertical Depth (usft)	Measured Depth (usft)	Vertical Depth (usft)	Reference (usft)	Offset (usft)	Highside Toolface (°)	Offset Wellbore Centre +N/-S (usft)	+E/-W (usft)	Between Centres (usft)	Between Ellipses (usft)	Total Uncertainty Axis	Separation Factor	Warning	
0.0	0.0	0.0	0.0	0.0	0.0	-173.06	-25.5	-3.1	25.7					
100.0	100.0	100.0	100.0	0.1	0.1	-173.06	-25.5	-3.1	25.7	25.5	0.18	146.529		
200.0	200.0	200.0	200.0	0.3	0.3	-173.06	-25.5	-3.1	25.7	25.1	0.62	41.112	CC, ES	
300.0	300.0	298.7	298.7	0.5	0.5	-50.37	-27.9	-2.4	28.0	26.9	1.05	26.573		
400.0	399.9	396.9	396.6	0.7	0.7	-60.29	-35.2	-0.1	33.2	31.7	1.49	22.246		
500.0	499.5	494.1	493.0	1.0	1.0	-74.06	-47.1	3.5	42.5	40.6	1.97	21.546	SF	
600.0	598.5	589.9	587.2	1.3	1.3	-86.07	-63.4	8.6	58.0	55.4	2.55	22.725		
700.0	697.4	684.0	678.9	1.6	1.8	-92.34	-83.8	14.8	79.6	76.4	3.21	24.800		
800.0	796.3	779.3	770.7	1.9	2.2	-95.12	-107.9	22.3	105.1	101.2	3.90	26.941		
900.0	895.2	875.8	863.7	2.3	2.8	-96.78	-132.6	29.9	131.1	126.5	4.60	28.517		
1,000.0	994.1	972.3	956.7	2.6	3.3	-97.89	-157.2	37.5	157.1	151.8	5.31	29.597		
1,100.0	1,093.0	1,068.8	1,049.7	3.0	3.8	-98.69	-181.9	45.1	183.2	177.1	6.03	30.368		

Cathedral Energy Services

Anticollision Report

Company:	Caerus Oil & Gas (NAD 27)	Local Co-ordinate Reference:	Well PUCKETT 44C-2
Project:	Garfield County, CO	TVD Reference:	KB=22' @ 8446.0usft
Reference Site:	S2-T7S-R97W (Puckett Pad P2)	MD Reference:	KB=22' @ 8446.0usft
Site Error:	0.0usft	North Reference:	True
Reference Well:	PUCKETT 44C-2	Survey Calculation Method:	Minimum Curvature
Well Error:	0.0usft	Output errors are at	2.00 sigma
Reference Wellbore	DD	Database:	USA EDM 5000 Multi Users DB
Reference Design:	Plan #1	Offset TVD Reference:	Offset Datum

Offset Design S2-T7S-R97W (Puckett Pad P2) - PUCKETT 13D-1 - DD - Plan #1													Offset Site Error:	0.0 usft
Survey Program: 0-ISCSWA MWD													Offset Well Error:	0.0 usft
Reference		Offset		Semi Major Axis			Distance					Separation Factor	Warning	
Measured Depth (usft)	Vertical Depth (usft)	Measured Depth (usft)	Vertical Depth (usft)	Reference (usft)	Offset (usft)	Highside Toolface (°)	Offset Wellbore Centre +N/-S (usft)	+E/-W (usft)	Between Centres (usft)	Between Ellipses (usft)	Total Uncertainty Axis			
0.0	0.0	0.0	0.0	0.0	0.0	30.70	34.2	20.3	39.8					
100.0	100.0	100.0	100.0	0.1	0.1	30.70	34.2	20.3	39.8	39.6	0.18	227.090		
200.0	200.0	200.0	200.0	0.3	0.3	30.70	34.2	20.3	39.8	39.2	0.62	63.716 CC		
204.4	204.4	204.4	204.4	0.3	0.3	155.74	34.2	20.3	39.8	39.2	0.64	61.778 ES		
300.0	300.0	298.4	298.4	0.5	0.5	156.14	35.3	21.2	41.4	40.3	1.08	38.471		
400.0	399.9	395.6	395.4	0.7	0.8	158.84	40.1	25.2	51.3	49.7	1.62	31.705		
500.0	499.5	492.0	491.2	1.0	1.0	163.11	47.3	32.7	70.5	68.3	2.24	31.506 SF		
600.0	598.5	586.4	584.7	1.3	1.3	168.77	53.2	44.4	96.7	94.0	2.77	34.879		
700.0	697.4	681.8	678.9	1.6	1.6	173.17	58.5	58.5	125.6	122.4	3.21	39.066		
800.0	796.3	777.2	773.1	1.9	1.9	175.92	63.8	72.6	154.8	151.2	3.66	42.331		
900.0	895.2	872.6	867.3	2.3	2.3	177.79	69.0	86.7	184.3	180.2	4.11	44.811		

Cathedral Energy Services

Anticollision Report

Company:	Caerus Oil & Gas (NAD 27)	Local Co-ordinate Reference:	Well PUCKETT 44C-2
Project:	Garfield County, CO	TVD Reference:	KB=22' @ 8446.0usft
Reference Site:	S2-T7S-R97W (Puckett Pad P2)	MD Reference:	KB=22' @ 8446.0usft
Site Error:	0.0usft	North Reference:	True
Reference Well:	PUCKETT 44C-2	Survey Calculation Method:	Minimum Curvature
Well Error:	0.0usft	Output errors are at	2.00 sigma
Reference Wellbore	DD	Database:	USA EDM 5000 Multi Users DB
Reference Design:	Plan #1	Offset TVD Reference:	Offset Datum

Offset Design S2-T7S-R97W (Puckett Pad P2) - PUCKETT 14A-1 - DD - Plan #1													Offset Site Error:	0.0 usft
Survey Program: 0-ISWWSA MWD													Offset Well Error:	0.0 usft
Reference		Offset		Semi Major Axis			Distance							Warning
Measured Depth (usft)	Vertical Depth (usft)	Measured Depth (usft)	Vertical Depth (usft)	Reference (usft)	Offset (usft)	Highside Toolface (°)	Offset Wellbore Centre +N/-S (usft)	+E/-W (usft)	Between Centres (usft)	Between Ellipses (usft)	Total Uncertainty Axis	Separation Factor		
0.0	0.0	0.0	0.0	0.0	0.0	44.66	29.1	28.8	41.0					
100.0	100.0	100.0	100.0	0.1	0.1	44.66	29.1	28.8	41.0	40.8	0.18	233.669		
200.0	200.0	200.0	200.0	0.3	0.3	44.66	29.1	28.8	41.0	40.3	0.62	65.562 CC		
255.6	255.6	255.6	255.6	0.4	0.4	169.75	29.1	28.8	41.2	40.3	0.87	47.102		
300.0	300.0	300.0	300.0	0.5	0.5	169.74	29.1	28.8	41.1	40.1	1.07	38.262 ES		
400.0	399.9	399.9	399.9	0.7	0.8	170.61	29.1	28.8	45.0	43.4	1.59	28.273		
500.0	499.5	498.4	498.4	1.0	1.0	172.54	29.2	29.4	54.5	52.4	2.17	25.153 SF		
600.0	598.5	594.1	594.0	1.3	1.2	176.29	29.6	34.2	72.4	69.7	2.69	26.916		
700.0	697.4	687.7	687.1	1.6	1.4	-179.92	30.4	43.5	95.5	92.4	3.13	30.499		
800.0	796.3	781.1	779.5	1.9	1.7	-176.62	31.5	57.0	122.8	119.2	3.61	34.057		
900.0	895.2	876.8	874.1	2.3	2.0	-174.31	32.7	71.6	151.1	147.0	4.07	37.132		
1,000.0	994.1	972.6	968.7	2.6	2.3	-172.73	33.9	86.3	179.5	175.0	4.54	39.531		

Cathedral Energy Services

Anticollision Report

Company:	Caerus Oil & Gas (NAD 27)	Local Co-ordinate Reference:	Well PUCKETT 44C-2
Project:	Garfield County, CO	TVD Reference:	KB=22' @ 8446.0usft
Reference Site:	S2-T7S-R97W (Puckett Pad P2)	MD Reference:	KB=22' @ 8446.0usft
Site Error:	0.0usft	North Reference:	True
Reference Well:	PUCKETT 44C-2	Survey Calculation Method:	Minimum Curvature
Well Error:	0.0usft	Output errors are at	2.00 sigma
Reference Wellbore	DD	Database:	USA EDM 5000 Multi Users DB
Reference Design:	Plan #1	Offset TVD Reference:	Offset Datum

Offset Design S2-T7S-R97W (Puckett Pad P2) - PUCKETT 14B-1 - DD - Plan #1													Offset Site Error:	0.0 usft
Survey Program: 0-ISCSWA MWD													Offset Well Error:	0.0 usft
Reference		Offset		Semi Major Axis			Distance						Warning	
Measured Depth (usft)	Vertical Depth (usft)	Measured Depth (usft)	Vertical Depth (usft)	Reference (usft)	Offset (usft)	Highside Toolface (°)	Offset Wellbore Centre +N/-S (usft)	+E/-W (usft)	Between Centres (usft)	Between Ellipses (usft)	Total Uncertainty Axis	Separation Factor		
0.0	0.0	0.0	0.0	0.0	0.0	52.87	16.0	21.2	26.6					
100.0	100.0	100.0	100.0	0.1	0.1	52.87	16.0	21.2	26.6	26.4	0.18	151.481		
200.0	200.0	200.0	200.0	0.3	0.3	52.87	16.0	21.2	26.6	25.9	0.62	42.502 CC		
255.6	255.6	255.6	255.6	0.4	0.4	177.93	16.0	21.2	26.8	25.9	0.87	30.616		
300.0	300.0	300.0	300.0	0.5	0.5	177.92	16.0	21.2	26.7	25.6	1.08	24.855 ES		
400.0	399.9	399.9	399.9	0.7	0.8	178.19	16.0	21.2	30.6	29.1	1.59	19.226		
500.0	499.5	498.0	497.9	1.0	1.0	-178.91	15.6	23.7	41.6	39.4	2.17	19.162 SF		
600.0	598.5	594.0	593.7	1.3	1.2	-174.32	14.5	30.9	61.2	58.5	2.70	22.630		
700.0	697.4	687.9	686.8	1.6	1.4	-170.15	12.6	42.5	85.8	82.7	3.16	27.173		
800.0	796.3	783.3	781.0	1.9	1.7	-166.93	10.2	57.4	113.3	109.6	3.64	31.142		
900.0	895.2	879.3	875.8	2.3	2.0	-164.94	7.7	72.3	141.0	136.9	4.12	34.198		
1,000.0	994.1	975.3	970.6	2.6	2.4	-163.60	5.3	87.3	168.8	164.2	4.62	36.534		
1,100.0	1,093.0	1,071.3	1,065.4	3.0	2.7	-162.64	2.9	102.2	196.7	191.6	5.13	38.346		

Cathedral Energy Services

Anticollision Report

Company:	Caerus Oil & Gas (NAD 27)	Local Co-ordinate Reference:	Well PUCKETT 44C-2
Project:	Garfield County, CO	TVD Reference:	KB=22' @ 8446.0usft
Reference Site:	S2-T7S-R97W (Puckett Pad P2)	MD Reference:	KB=22' @ 8446.0usft
Site Error:	0.0usft	North Reference:	True
Reference Well:	PUCKETT 44C-2	Survey Calculation Method:	Minimum Curvature
Well Error:	0.0usft	Output errors are at	2.00 sigma
Reference Wellbore	DD	Database:	USA EDM 5000 Multi Users DB
Reference Design:	Plan #1	Offset TVD Reference:	Offset Datum

Offset Design S2-T7S-R97W (Puckett Pad P2) - PUCKETT 14C-1 - DD - Plan #1												Offset Site Error:	0.0 usft
Survey Program: 0-ISWWSA MWD												Offset Well Error:	0.0 usft
Reference		Offset		Semi Major Axis		Distance							
Measured Depth (usft)	Vertical Depth (usft)	Measured Depth (usft)	Vertical Depth (usft)	Reference (usft)	Offset (usft)	Highside Toolface (°)	Offset Wellbore Centre +N/-S (usft)	+E/-W (usft)	Between Centres (usft)	Between Ellipses (usft)	Total Uncertainty Axis	Separation Factor	Warning
0.0	0.0	0.0	0.0	0.0	0.0	81.64	1.8	12.4	12.6				
100.0	100.0	100.0	100.0	0.1	0.1	81.64	1.8	12.4	12.6	12.4	0.18	71.614	
200.0	200.0	200.0	200.0	0.3	0.3	81.64	1.8	12.4	12.6	11.9	0.62	20.093 CC	
255.6	255.6	255.6	255.6	0.4	0.4	-153.73	1.8	12.4	12.7	11.9	0.87	14.579	
300.0	300.0	300.0	300.0	0.5	0.5	-153.65	1.8	12.4	12.7	11.6	1.07	11.828 ES	
400.0	399.9	399.6	399.6	0.7	0.8	-158.40	1.6	13.0	16.8	15.3	1.58	10.678 SF	
500.0	499.5	497.8	497.6	1.0	1.0	-159.00	-0.3	17.7	29.5	27.4	2.15	13.748	
600.0	598.5	593.9	593.2	1.3	1.2	-157.70	-4.0	26.8	50.7	48.0	2.70	18.792	
700.0	697.4	688.4	686.7	1.6	1.5	-155.44	-9.3	40.1	76.6	73.4	3.19	24.008	
800.0	796.3	784.6	781.5	1.9	1.8	-153.82	-15.3	55.0	103.9	100.2	3.69	28.169	
900.0	895.2	880.7	876.3	2.3	2.1	-152.88	-21.3	69.9	131.3	127.1	4.21	31.212	
1,000.0	994.1	976.9	971.1	2.6	2.5	-152.26	-27.3	84.8	158.6	153.9	4.74	33.480	
1,100.0	1,093.0	1,073.1	1,065.9	3.0	2.8	-151.82	-33.3	99.7	186.0	180.8	5.28	35.219	

Cathedral Energy Services

Anticollision Report

Company:	Caerus Oil & Gas (NAD 27)	Local Co-ordinate Reference:	Well PUCKETT 44C-2
Project:	Garfield County, CO	TVD Reference:	KB=22' @ 8446.0usft
Reference Site:	S2-T7S-R97W (Puckett Pad P2)	MD Reference:	KB=22' @ 8446.0usft
Site Error:	0.0usft	North Reference:	True
Reference Well:	PUCKETT 44C-2	Survey Calculation Method:	Minimum Curvature
Well Error:	0.0usft	Output errors are at	2.00 sigma
Reference Wellbore	DD	Database:	USA EDM 5000 Multi Users DB
Reference Design:	Plan #1	Offset TVD Reference:	Offset Datum

Offset Design S2-T7S-R97W (Puckett Pad P2) - PUCKETT 14D-1 - DD - Plan #1												Offset Site Error:	0.0 usft
Survey Program: 0-ISWWSA MWD												Offset Well Error:	0.0 usft
Reference		Offset		Semi Major Axis			Distance						Warning
Measured Depth (usft)	Vertical Depth (usft)	Measured Depth (usft)	Vertical Depth (usft)	Reference (usft)	Offset (usft)	Highside Toolface (°)	Offset Wellbore Centre +N/-S (usft)	+E/-W (usft)	Between Centres (usft)	Between Ellipses (usft)	Total Uncertainty Axis	Separation Factor	
0.0	0.0	0.0	0.0	0.0	0.0	159.40	-12.0	4.5	12.8				
100.0	100.0	100.0	100.0	0.1	0.1	159.40	-12.0	4.5	12.8	12.7	0.18	73.216	
200.0	200.0	200.0	200.0	0.3	0.3	159.40	-12.0	4.5	12.8	12.2	0.62	20.543	
300.0	300.0	300.0	300.0	0.5	0.5	-76.27	-12.0	4.5	12.8	11.7	1.07	11.968	
309.1	309.1	309.1	309.1	0.6	0.6	-76.94	-12.0	4.5	12.8	11.7	1.11	11.545 CC, ES	
400.0	399.9	399.2	399.2	0.7	0.7	-96.40	-13.5	6.6	15.0	13.5	1.48	10.112 SF	
500.0	499.5	497.2	496.9	1.0	1.0	-120.37	-18.0	12.7	25.9	23.9	2.03	12.775	
600.0	598.5	593.2	592.0	1.3	1.2	-131.59	-25.2	22.7	46.4	43.7	2.64	17.588	
700.0	697.4	687.5	684.8	1.6	1.5	-134.70	-35.1	36.1	72.4	69.2	3.20	22.608	
800.0	796.3	783.5	779.1	1.9	1.9	-135.71	-46.1	51.2	100.1	96.3	3.76	26.622	
900.0	895.2	879.6	873.3	2.3	2.3	-136.29	-57.1	66.4	127.8	123.5	4.33	29.511	
1,000.0	994.1	975.7	967.5	2.6	2.7	-136.66	-68.1	81.5	155.5	150.6	4.92	31.626	
1,100.0	1,093.0	1,071.8	1,061.8	3.0	3.1	-136.91	-79.2	96.6	183.3	177.7	5.52	33.226	

Cathedral Energy Services

Anticollision Report

Company:	Caerus Oil & Gas (NAD 27)	Local Co-ordinate Reference:	Well PUCKETT 44C-2
Project:	Garfield County, CO	TVD Reference:	KB=22' @ 8446.0usft
Reference Site:	S2-T7S-R97W (Puckett Pad P2)	MD Reference:	KB=22' @ 8446.0usft
Site Error:	0.0usft	North Reference:	True
Reference Well:	PUCKETT 44C-2	Survey Calculation Method:	Minimum Curvature
Well Error:	0.0usft	Output errors are at	2.00 sigma
Reference Wellbore	DD	Database:	USA EDM 5000 Multi Users DB
Reference Design:	Plan #1	Offset TVD Reference:	Offset Datum

Offset Design S2-T7S-R97W (Puckett Pad P2) - PUCKETT 24A-1 - DD - Plan #1													Offset Site Error:	0.0 usft
Survey Program: 0-ISCSWA MWD													Offset Well Error:	0.0 usft
Reference		Offset		Semi Major Axis			Distance						Warning	
Measured Depth (usft)	Vertical Depth (usft)	Measured Depth (usft)	Vertical Depth (usft)	Reference (usft)	Offset (usft)	Highside Toolface (°)	Offset Wellbore Centre +N/-S (usft)	+E/-W (usft)	Between Centres (usft)	Between Ellipses (usft)	Total Uncertainty Axis	Separation Factor		
0.0	0.0	0.0	0.0	0.0	0.0	47.15	23.3	25.1	34.3					
100.0	100.0	100.0	100.0	0.1	0.1	47.15	23.3	25.1	34.3	34.1	0.18	195.495		
200.0	200.0	200.0	200.0	0.3	0.3	47.15	23.3	25.1	34.3	33.6	0.62	54.851 CC		
255.6	255.6	255.6	255.6	0.4	0.4	172.23	23.3	25.1	34.5	33.6	0.87	39.445		
300.0	300.0	300.0	300.0	0.5	0.5	172.22	23.3	25.1	34.4	33.4	1.07	32.034 ES		
400.0	399.9	398.5	398.4	0.7	0.7	175.65	23.1	27.7	40.1	38.5	1.59	25.224		
500.0	499.5	495.4	495.1	1.0	1.0	-178.13	22.4	35.1	55.0	52.8	2.20	25.021 SF		
600.0	598.5	589.3	588.2	1.3	1.2	-173.10	21.7	46.9	79.2	76.5	2.76	28.682		
700.0	697.4	680.5	678.0	1.6	1.5	-169.63	21.3	62.8	108.9	105.7	3.24	33.647		
800.0	796.3	768.8	764.2	1.9	1.9	-167.08	21.2	82.2	143.1	139.3	3.74	38.272		
900.0	895.2	854.1	846.4	2.3	2.3	-165.13	21.4	104.7	181.4	177.2	4.26	42.632		

Cathedral Energy Services

Anticollision Report

Company:	Caerus Oil & Gas (NAD 27)	Local Co-ordinate Reference:	Well PUCKETT 44C-2
Project:	Garfield County, CO	TVD Reference:	KB=22' @ 8446.0usft
Reference Site:	S2-T7S-R97W (Puckett Pad P2)	MD Reference:	KB=22' @ 8446.0usft
Site Error:	0.0usft	North Reference:	True
Reference Well:	PUCKETT 44C-2	Survey Calculation Method:	Minimum Curvature
Well Error:	0.0usft	Output errors are at	2.00 sigma
Reference Wellbore	DD	Database:	USA EDM 5000 Multi Users DB
Reference Design:	Plan #1	Offset TVD Reference:	Offset Datum

Offset Design													S2-T7S-R97W (Puckett Pad P2) - PUCKETT 24C-1 - DD - Plan #1		Offset Site Error:		0.0 usft
Survey Program:													0-ISCSWA MWD		Offset Well Error:		0.0 usft
Reference		Offset		Semi Major Axis			Distance										
Measured Depth (usft)	Vertical Depth (usft)	Measured Depth (usft)	Vertical Depth (usft)	Reference (usft)	Offset (usft)	Highside Toolface (°)	Offset Wellbore Centre +N/-S (usft)	Offset Wellbore Centre +E/-W (usft)	Between Centres (usft)	Between Ellipses (usft)	Total Uncertainty Axis	Separation Factor	Warning				
0.0	0.0	0.0	0.0	0.0	0.0	60.91	9.1	16.4	18.7								
100.0	100.0	100.0	100.0	0.1	0.1	60.91	9.1	16.4	18.7	18.6	0.18	106.879					
200.0	200.0	200.0	200.0	0.3	0.3	60.91	9.1	16.4	18.7	18.1	0.62	29.988	CC				
239.2	239.2	239.2	239.2	0.4	0.4	-174.08	9.1	16.4	18.8	18.0	0.80	23.543	ES				
300.0	300.0	299.6	299.6	0.5	0.5	-172.80	9.0	17.0	19.4	18.3	1.07	18.132					
400.0	399.9	398.3	398.2	0.7	0.7	-166.59	7.7	22.0	27.3	25.7	1.59	17.128	SF				
500.0	499.5	495.2	494.6	1.0	1.0	-161.55	5.3	31.6	44.7	42.5	2.21	20.221					
600.0	598.5	589.2	587.4	1.3	1.3	-158.74	1.9	45.5	70.9	68.1	2.78	25.464					
700.0	697.4	680.5	676.9	1.6	1.6	-156.52	-2.5	63.3	102.1	98.8	3.29	31.055					
800.0	796.3	768.9	762.6	1.9	2.0	-154.56	-7.7	84.4	137.4	133.6	3.82	35.931					
900.0	895.2	854.3	844.3	2.3	2.5	-152.87	-13.6	108.4	176.7	172.3	4.38	40.305					

Cathedral Energy Services

Anticollision Report

Company:	Caerus Oil & Gas (NAD 27)	Local Co-ordinate Reference:	Well PUCKETT 44C-2
Project:	Garfield County, CO	TVD Reference:	KB=22' @ 8446.0usft
Reference Site:	S2-T7S-R97W (Puckett Pad P2)	MD Reference:	KB=22' @ 8446.0usft
Site Error:	0.0usft	North Reference:	True
Reference Well:	PUCKETT 44C-2	Survey Calculation Method:	Minimum Curvature
Well Error:	0.0usft	Output errors are at	2.00 sigma
Reference Wellbore	DD	Database:	USA EDM 5000 Multi Users DB
Reference Design:	Plan #1	Offset TVD Reference:	Offset Datum

Offset Design S2-T7S-R97W (Puckett Pad P2) - PUCKETT 24D-1 - DD - Plan #1												Offset Site Error:	0.0 usft
Survey Program: 0-ISCSWA MWD												Offset Well Error:	0.0 usft
Reference		Offset		Semi Major Axis		Distance							
Measured Depth (usft)	Vertical Depth (usft)	Measured Depth (usft)	Vertical Depth (usft)	Reference (usft)	Offset (usft)	Highside Toolface (°)	Offset Wellbore Centre +N/-S (usft)	+E/-W (usft)	Between Centres (usft)	Between Ellipses (usft)	Total Uncertainty Axis	Separation Factor	Warning
0.0	0.0	0.0	0.0	0.0	0.0	121.03	-5.1	8.5	9.9				
100.0	100.0	100.0	100.0	0.1	0.1	121.03	-5.1	8.5	9.9	9.7	0.18	56.375	
200.0	200.0	200.0	200.0	0.3	0.3	121.03	-5.1	8.5	9.9	9.3	0.62	15.817 CC, ES	
300.0	300.0	299.4	299.4	0.5	0.5	-116.71	-6.0	10.9	12.5	11.5	1.06	11.774 SF	
400.0	399.9	397.9	397.6	0.7	0.8	-128.03	-8.7	18.1	22.5	20.9	1.56	14.391	
500.0	499.5	494.5	493.3	1.0	1.0	-136.33	-13.1	29.7	41.3	39.2	2.16	19.116	
600.0	598.5	587.9	585.3	1.3	1.4	-140.72	-19.0	45.2	68.8	66.0	2.77	24.872	
700.0	697.4	678.6	673.6	1.6	1.8	-142.18	-26.2	64.3	101.5	98.1	3.31	30.613	
800.0	796.3	766.4	758.1	1.9	2.2	-142.31	-34.5	86.5	138.3	134.4	3.88	35.602	
900.0	895.2	851.0	838.5	2.3	2.7	-141.94	-43.9	111.3	179.1	174.6	4.47	40.039	

Cathedral Energy Services

Anticollision Report

Company:	Caerus Oil & Gas (NAD 27)	Local Co-ordinate Reference:	Well PUCKETT 44C-2
Project:	Garfield County, CO	TVD Reference:	KB=22' @ 8446.0usft
Reference Site:	S2-T7S-R97W (Puckett Pad P2)	MD Reference:	KB=22' @ 8446.0usft
Site Error:	0.0usft	North Reference:	True
Reference Well:	PUCKETT 44C-2	Survey Calculation Method:	Minimum Curvature
Well Error:	0.0usft	Output errors are at	2.00 sigma
Reference Wellbore	DD	Database:	USA EDM 5000 Multi Users DB
Reference Design:	Plan #1	Offset TVD Reference:	Offset Datum

Offset Design S2-T7S-R97W (Puckett Pad P2) - PUCKETT 43C-2 - DD - Plan #1													Offset Site Error:	0.0 usft
Survey Program: 0-ISCSWA MWD													Offset Well Error:	0.0 usft
Reference		Offset		Semi Major Axis			Distance							Warning
Measured Depth (usft)	Vertical Depth (usft)	Measured Depth (usft)	Vertical Depth (usft)	Reference (usft)	Offset (usft)	Highside Toolface (°)	Offset Wellbore Centre +N/-S (usft)	+E/-W (usft)	Between Centres (usft)	Between Ellipses (usft)	Total Uncertainty Axis	Separation Factor		
0.0	0.0	0.0	0.0	0.0	0.0	29.96	28.4	16.4	32.8					
100.0	100.0	100.0	100.0	0.1	0.1	29.96	28.4	16.4	32.8	32.6	0.18	187.036		
200.0	200.0	200.0	200.0	0.3	0.3	29.96	28.4	16.4	32.8	32.2	0.62	52.478 CC		
250.0	250.0	250.0	250.0	0.4	0.4	155.12	28.4	16.4	32.9	32.1	0.85	38.813		
300.0	300.0	299.9	299.9	0.5	0.5	154.84	28.5	16.2	33.0	31.9	1.07	30.730 ES		
400.0	399.9	399.4	399.3	0.7	0.8	151.44	31.0	13.3	37.3	35.7	1.57	23.692		
500.0	499.5	498.2	497.7	1.0	1.0	145.92	36.8	6.4	47.6	45.5	2.14	22.203 SF		
600.0	598.5	595.8	594.3	1.3	1.3	140.74	45.6	-4.3	63.9	61.2	2.72	23.487		
700.0	697.4	694.1	691.3	1.6	1.6	136.91	55.8	-16.4	82.1	78.8	3.28	25.031		
800.0	796.3	792.3	788.2	1.9	2.0	134.47	66.0	-28.6	100.4	96.6	3.87	25.928		
900.0	895.2	890.5	885.1	2.3	2.3	132.78	76.1	-40.8	118.9	114.4	4.49	26.480		
1,000.0	994.1	988.7	982.1	2.6	2.7	131.55	86.3	-53.0	137.5	132.4	5.12	26.841		
1,100.0	1,093.0	1,087.0	1,079.0	3.0	3.0	130.61	96.5	-65.2	156.1	150.3	5.76	27.091		
1,200.0	1,191.9	1,185.2	1,175.9	3.3	3.4	129.88	106.6	-77.4	174.7	168.3	6.41	27.270		
1,300.0	1,290.8	1,283.4	1,272.9	3.7	3.7	129.28	116.8	-89.6	193.4	186.4	7.06	27.406		

Cathedral Energy Services

Anticollision Report

Company:	Caerus Oil & Gas (NAD 27)	Local Co-ordinate Reference:	Well PUCKETT 44C-2
Project:	Garfield County, CO	TVD Reference:	KB=22' @ 8446.0usft
Reference Site:	S2-T7S-R97W (Puckett Pad P2)	MD Reference:	KB=22' @ 8446.0usft
Site Error:	0.0usft	North Reference:	True
Reference Well:	PUCKETT 44C-2	Survey Calculation Method:	Minimum Curvature
Well Error:	0.0usft	Output errors are at	2.00 sigma
Reference Wellbore	DD	Database:	USA EDM 5000 Multi Users DB
Reference Design:	Plan #1	Offset TVD Reference:	Offset Datum

Offset Design S2-T7S-R97W (Puckett Pad P2) - PUCKETT 43D-2 - DD - Plan #1												Offset Site Error: 0.0 usft		
Survey Program: 0-ISCSWA MWD												Offset Well Error: 0.0 usft		
Reference		Offset		Semi Major Axis			Distance							Warning
Measured Depth (usft)	Vertical Depth (usft)	Measured Depth (usft)	Vertical Depth (usft)	Reference (usft)	Offset (usft)	Highside Toolface (°)	Offset Wellbore Centre +N/-S (usft)	+E/-W (usft)	Between Centres (usft)	Between Ellipses (usft)	Total Uncertainty Axis	Separation Factor		
0.0	0.0	0.0	0.0	0.0	0.0	30.45	21.1	12.4	24.5					
100.0	100.0	100.0	100.0	0.1	0.1	30.45	21.1	12.4	24.5	24.3	0.18	139.807		
200.0	200.0	200.0	200.0	0.3	0.3	30.45	21.1	12.4	24.5	23.9	0.62	39.226 CC		
255.6	255.6	255.6	255.6	0.4	0.4	155.68	21.1	12.4	24.7	23.8	0.87	28.266		
300.0	300.0	300.0	300.0	0.5	0.5	155.65	21.1	12.4	24.7	23.6	1.07	22.959 ES		
400.0	399.9	400.1	400.0	0.7	0.8	155.92	21.7	11.1	28.1	26.5	1.57	17.853		
500.0	499.5	499.8	499.6	1.0	1.0	151.39	24.5	5.2	35.8	33.7	2.12	16.865 SF		
600.0	598.5	599.0	598.0	1.3	1.2	145.28	29.3	-5.4	47.9	45.3	2.67	17.979		
700.0	697.4	698.0	696.1	1.6	1.5	140.41	34.9	-17.6	61.3	58.1	3.20	19.176		
800.0	796.3	797.0	794.2	1.9	1.8	137.30	40.5	-29.9	75.0	71.2	3.78	19.855		
900.0	895.2	896.0	892.3	2.3	2.2	135.15	46.2	-42.2	88.8	84.4	4.38	20.265		
1,000.0	994.1	994.9	990.3	2.6	2.5	133.58	51.8	-54.4	102.7	97.7	5.00	20.527		
1,100.0	1,093.0	1,093.9	1,088.4	3.0	2.8	132.39	57.4	-66.7	116.6	111.0	5.63	20.704		
1,200.0	1,191.9	1,192.9	1,186.5	3.3	3.1	131.45	63.1	-79.0	130.6	124.4	6.27	20.829		
1,300.0	1,290.8	1,291.9	1,284.5	3.7	3.5	130.69	68.7	-91.2	144.7	137.8	6.92	20.921		
1,400.0	1,389.7	1,390.9	1,382.6	4.0	3.8	130.07	74.3	-103.5	158.7	151.2	7.56	20.991		
1,500.0	1,488.6	1,489.9	1,480.7	4.4	4.1	129.55	79.9	-115.7	172.8	164.6	8.21	21.046		
1,600.0	1,587.5	1,588.9	1,578.7	4.8	4.5	129.10	85.6	-128.0	186.9	178.0	8.86	21.090		

Cathedral Energy Services

Anticollision Report

Company:	Caerus Oil & Gas (NAD 27)	Local Co-ordinate Reference:	Well PUCKETT 44C-2
Project:	Garfield County, CO	TVD Reference:	KB=22' @ 8446.0usft
Reference Site:	S2-T7S-R97W (Puckett Pad P2)	MD Reference:	KB=22' @ 8446.0usft
Site Error:	0.0usft	North Reference:	True
Reference Well:	PUCKETT 44C-2	Survey Calculation Method:	Minimum Curvature
Well Error:	0.0usft	Output errors are at	2.00 sigma
Reference Wellbore	DD	Database:	USA EDM 5000 Multi Users DB
Reference Design:	Plan #1	Offset TVD Reference:	Offset Datum

Offset Design S2-T7S-R97W (Puckett Pad P2) - PUCKETT 44A-2 - DD - Plan #1													Offset Site Error: 0.0 usft	
Survey Program: 0-ISCSWA MWD													Offset Well Error: 0.0 usft	
Reference		Offset		Semi Major Axis			Distance						Warning	
Measured Depth (usft)	Vertical Depth (usft)	Measured Depth (usft)	Vertical Depth (usft)	Reference (usft)	Offset (usft)	Highside Toolface (°)	Offset Wellbore Centre +N/-S (usft)	+E/-W (usft)	Between Centres (usft)	Between Ellipses (usft)	Total Uncertainty Axis	Separation Factor		
0.0	0.0	0.0	0.0	0.0	0.0	30.80	14.2	8.5	16.5					
100.0	100.0	100.0	100.0	0.1	0.1	30.80	14.2	8.5	16.5	16.4	0.18	94.333		
200.0	200.0	200.0	200.0	0.3	0.3	30.80	14.2	8.5	16.5	15.9	0.62	26.467 CC		
255.6	255.6	255.6	255.6	0.4	0.4	156.13	14.2	8.5	16.7	15.8	0.87	19.140		
300.0	300.0	300.0	300.0	0.5	0.5	156.07	14.2	8.5	16.7	15.6	1.07	15.536 ES		
400.0	399.9	400.0	400.0	0.7	0.8	160.14	14.2	8.3	20.3	18.7	1.58	12.829		
500.0	499.5	500.5	500.4	1.0	1.0	159.48	14.5	4.4	26.9	24.7	2.12	12.652 SF		
600.0	598.5	600.8	600.3	1.3	1.2	154.43	15.2	-4.8	35.4	32.8	2.63	13.482		
700.0	697.4	700.5	699.2	1.6	1.5	148.06	16.2	-17.1	43.8	40.7	3.11	14.078		
800.0	796.3	800.0	797.9	1.9	1.8	143.73	17.1	-29.5	52.5	48.9	3.66	14.363		
900.0	895.2	899.6	896.7	2.3	2.1	140.65	18.1	-41.8	61.4	57.2	4.24	14.500		
1,000.0	994.1	999.1	995.5	2.6	2.4	138.35	19.0	-54.2	70.5	65.7	4.84	14.563		
1,100.0	1,093.0	1,098.7	1,094.3	3.0	2.7	136.58	20.0	-66.5	79.7	74.2	5.46	14.589		
1,200.0	1,191.9	1,198.2	1,193.1	3.3	3.0	135.17	20.9	-78.8	88.9	82.8	6.09	14.596		
1,300.0	1,290.8	1,297.8	1,291.9	3.7	3.3	134.03	21.9	-91.2	98.1	91.4	6.72	14.594		
1,400.0	1,389.7	1,397.3	1,390.6	4.0	3.6	133.09	22.8	-103.5	107.4	100.0	7.36	14.586		
1,500.0	1,488.6	1,496.9	1,489.4	4.4	3.9	132.29	23.7	-115.9	116.7	108.7	8.01	14.577		
1,600.0	1,587.5	1,596.4	1,588.2	4.8	4.3	131.61	24.7	-128.2	126.0	117.4	8.65	14.567		
1,700.0	1,686.4	1,696.0	1,687.0	5.1	4.6	131.03	25.6	-140.5	135.4	126.1	9.30	14.557		
1,800.0	1,785.3	1,795.6	1,785.8	5.5	4.9	130.52	26.6	-152.9	144.8	134.8	9.95	14.548		
1,900.0	1,884.2	1,895.1	1,884.5	5.8	5.2	130.08	27.5	-165.2	154.1	143.5	10.60	14.539		
2,000.0	1,983.1	1,994.7	1,983.3	6.2	5.5	129.68	28.5	-177.6	163.5	152.2	11.25	14.530		
2,100.0	2,082.0	2,094.2	2,082.1	6.6	5.9	129.33	29.4	-189.9	172.9	161.0	11.90	14.523		
2,200.0	2,180.9	2,193.8	2,180.9	6.9	6.2	129.01	30.4	-202.3	182.3	169.7	12.56	14.516		
2,300.0	2,279.8	2,293.3	2,279.7	7.3	6.5	128.73	31.3	-214.6	191.7	178.4	13.21	14.509		

Cathedral Energy Services

Anticollision Report

Company:	Caerus Oil & Gas (NAD 27)	Local Co-ordinate Reference:	Well PUCKETT 44C-2
Project:	Garfield County, CO	TVD Reference:	KB=22' @ 8446.0usft
Reference Site:	S2-T7S-R97W (Puckett Pad P2)	MD Reference:	KB=22' @ 8446.0usft
Site Error:	0.0usft	North Reference:	True
Reference Well:	PUCKETT 44C-2	Survey Calculation Method:	Minimum Curvature
Well Error:	0.0usft	Output errors are at	2.00 sigma
Reference Wellbore	DD	Database:	USA EDM 5000 Multi Users DB
Reference Design:	Plan #1	Offset TVD Reference:	Offset Datum

Offset Design S2-T7S-R97W (Puckett Pad P2) - PUCKETT 44B-2 - DD - Plan #1													Offset Site Error:	0.0 usft
Survey Program: 0-ISCWSA MWD													Offset Well Error:	0.0 usft
Reference		Offset		Semi Major Axis		Highside Toolface (°)	Distance		Total Uncertainty Axis	Separation Factor	Warning			
Measured Depth (usft)	Vertical Depth (usft)	Measured Depth (usft)	Vertical Depth (usft)	Reference (usft)	Offset (usft)		Offset Wellbore Centre +N/-S (usft)	+E/-W (usft)						
0.0	0.0	0.0	0.0	0.0	0.0	29.73	6.9	4.0	8.0					
100.0	100.0	100.0	100.0	0.1	0.1	29.73	6.9	4.0	8.0	7.8	0.18	45.457		
200.0	200.0	200.0	200.0	0.3	0.3	29.73	6.9	4.0	8.0	7.3	0.62	12.754 CC		
255.6	255.6	255.6	255.6	0.4	0.4	155.38	6.9	4.0	8.2	7.3	0.87	9.331		
300.0	300.0	300.0	300.0	0.5	0.5	155.26	6.9	4.0	8.1	7.0	1.07	7.558 ES		
400.0	399.9	400.3	400.2	0.7	0.8	158.72	6.5	2.5	10.6	9.1	1.57	6.783		
500.0	499.5	500.7	500.4	1.0	1.0	155.32	4.5	-3.8	14.1	12.0	2.09	6.723 SF		
600.0	598.5	601.0	600.1	1.3	1.2	149.00	1.1	-14.8	18.3	15.7	2.60	7.053		
700.0	697.4	700.9	699.1	1.6	1.5	143.88	-2.7	-27.0	22.7	19.6	3.09	7.328		
800.0	796.3	800.8	798.2	1.9	1.8	140.43	-6.4	-39.3	27.2	23.5	3.64	7.450		
900.0	895.2	900.6	897.3	2.3	2.1	137.96	-10.2	-51.5	31.7	27.5	4.23	7.498		
1,000.0	994.1	1,000.5	996.3	2.6	2.5	136.11	-14.0	-63.7	36.3	31.5	4.83	7.512		
1,100.0	1,093.0	1,100.4	1,095.4	3.0	2.8	134.68	-17.8	-75.9	40.9	35.5	5.45	7.509		
1,200.0	1,191.9	1,200.3	1,194.5	3.3	3.1	133.53	-21.5	-88.1	45.5	39.5	6.07	7.498		
1,300.0	1,290.8	1,300.2	1,293.5	3.7	3.4	132.60	-25.3	-100.4	50.2	43.5	6.71	7.484		
1,400.0	1,389.7	1,400.1	1,392.6	4.0	3.7	131.83	-29.1	-112.6	54.9	47.5	7.34	7.470		
1,500.0	1,488.6	1,500.0	1,491.7	4.4	4.1	131.18	-32.9	-124.8	59.5	51.5	7.98	7.455		
1,600.0	1,587.5	1,599.9	1,590.7	4.8	4.4	130.63	-36.6	-137.0	64.2	55.6	8.63	7.441		
1,700.0	1,686.4	1,699.8	1,689.8	5.1	4.7	130.15	-40.4	-149.2	68.9	59.6	9.27	7.428		
1,800.0	1,785.3	1,799.6	1,788.9	5.5	5.1	129.73	-44.2	-161.5	73.6	63.7	9.92	7.416		
1,900.0	1,884.2	1,899.5	1,887.9	5.8	5.4	129.36	-48.0	-173.7	78.3	67.7	10.57	7.405		
2,000.0	1,983.1	1,999.4	1,987.0	6.2	5.7	129.03	-51.7	-185.9	83.0	71.7	11.22	7.395		
2,100.0	2,082.0	2,099.3	2,086.1	6.6	6.1	128.74	-55.5	-198.1	87.7	75.8	11.87	7.385		
2,200.0	2,180.9	2,199.2	2,185.1	6.9	6.4	128.48	-59.3	-210.3	92.4	79.8	12.52	7.376		
2,300.0	2,279.8	2,299.1	2,284.2	7.3	6.7	128.24	-63.1	-222.6	97.1	83.9	13.17	7.368		
2,400.0	2,378.7	2,399.0	2,383.3	7.7	7.0	128.02	-66.8	-234.8	101.8	87.9	13.83	7.361		
2,500.0	2,477.6	2,498.9	2,482.3	8.0	7.4	127.83	-70.6	-247.0	106.5	92.0	14.48	7.354		
2,600.0	2,576.5	2,598.8	2,581.4	8.4	7.7	127.65	-74.4	-259.2	111.2	96.0	15.13	7.348		
2,700.0	2,675.4	2,698.6	2,680.5	8.7	8.0	127.48	-78.2	-271.4	115.9	100.1	15.78	7.342		
2,800.0	2,774.3	2,798.5	2,779.5	9.1	8.4	127.33	-81.9	-283.6	120.6	104.1	16.44	7.336		
2,900.0	2,873.2	2,898.4	2,878.6	9.5	8.7	127.19	-85.7	-295.9	125.3	108.2	17.09	7.331		
3,000.0	2,972.1	2,998.3	2,977.7	9.8	9.0	127.06	-89.5	-308.1	130.0	112.3	17.74	7.327		
3,100.0	3,071.0	3,098.2	3,076.7	10.2	9.4	126.94	-93.3	-320.3	134.7	116.3	18.40	7.322		
3,200.0	3,169.9	3,198.1	3,175.8	10.6	9.7	126.82	-97.0	-332.5	139.4	120.4	19.05	7.318		
3,300.0	3,268.8	3,298.0	3,274.9	10.9	10.0	126.72	-100.8	-344.7	144.1	124.4	19.70	7.314		
3,400.0	3,367.7	3,397.9	3,373.9	11.3	10.4	126.62	-104.6	-357.0	148.8	128.5	20.36	7.311		
3,500.0	3,466.6	3,497.7	3,473.0	11.6	10.7	126.53	-108.4	-369.2	153.5	132.5	21.01	7.308		
3,600.0	3,565.5	3,597.6	3,572.1	12.0	11.0	126.44	-112.1	-381.4	158.3	136.6	21.67	7.305		
3,700.0	3,664.4	3,697.5	3,671.1	12.4	11.4	126.36	-115.9	-393.6	163.0	140.7	22.32	7.302		
3,800.0	3,763.3	3,797.4	3,770.2	12.7	11.7	126.28	-119.7	-405.8	167.7	144.7	22.97	7.299		
3,900.0	3,862.2	3,897.3	3,869.3	13.1	12.0	126.21	-123.5	-418.1	172.4	148.8	23.63	7.296		
4,000.0	3,961.1	3,997.2	3,968.3	13.5	12.3	126.14	-127.2	-430.3	177.1	152.8	24.28	7.294		
4,100.0	4,060.1	4,097.1	4,067.4	13.8	12.7	126.07	-131.0	-442.5	181.8	156.9	24.93	7.292		
4,200.0	4,159.0	4,197.0	4,166.5	14.2	13.0	126.01	-134.8	-454.7	186.5	160.9	25.59	7.290		
4,300.0	4,257.9	4,296.9	4,265.5	14.5	13.3	125.95	-138.6	-466.9	191.2	165.0	26.24	7.288		
4,400.0	4,356.8	4,396.7	4,364.6	14.9	13.7	125.89	-142.3	-479.1	196.0	169.1	26.90	7.286		

Cathedral Energy Services

Anticollision Report

Company:	Caerus Oil & Gas (NAD 27)	Local Co-ordinate Reference:	Well PUCKETT 44C-2
Project:	Garfield County, CO	TVD Reference:	KB=22' @ 8446.0usft
Reference Site:	S2-T7S-R97W (Puckett Pad P2)	MD Reference:	KB=22' @ 8446.0usft
Site Error:	0.0usft	North Reference:	True
Reference Well:	PUCKETT 44C-2	Survey Calculation Method:	Minimum Curvature
Well Error:	0.0usft	Output errors are at	2.00 sigma
Reference Wellbore	DD	Database:	USA EDM 5000 Multi Users DB
Reference Design:	Plan #1	Offset TVD Reference:	Offset Datum

Offset Design S2-T7S-R97W (Puckett Pad P2) - PUCKETT 44D-2 - DD - Plan #1													Offset Site Error: 0.0 usft	
Survey Program: 0-ISCSWA MWD													Offset Well Error: 0.0 usft	
Reference		Offset		Semi Major Axis			Distance						Warning	
Measured Depth (usft)	Vertical Depth (usft)	Measured Depth (usft)	Vertical Depth (usft)	Reference (usft)	Offset (usft)	Highside Toolface (°)	Offset Wellbore Centre +N/-S (usft)	+E/-W (usft)	Between Centres (usft)	Between Ellipses (usft)	Total Uncertainty Axis	Separation Factor		
0.0	0.0	0.0	0.0	0.0	0.0	-147.43	-6.2	-4.0	7.3					
100.0	100.0	100.0	100.0	0.1	0.1	-147.43	-6.2	-4.0	7.3	7.2	0.18	41.878		
200.0	200.0	200.0	200.0	0.3	0.3	-147.43	-6.2	-4.0	7.3	6.7	0.62	11.750	CC, ES	
300.0	300.0	299.7	299.7	0.5	0.5	-21.15	-7.3	-4.9	8.6	7.6	1.06	8.149		
400.0	399.9	399.1	398.9	0.7	0.7	-23.38	-12.1	-9.3	11.4	9.9	1.54	7.432		
500.0	499.5	498.4	497.5	1.0	1.0	-28.99	-20.6	-17.1	14.6	12.5	2.07	7.041	SF	
600.0	598.5	597.8	595.5	1.3	1.3	-35.29	-32.8	-28.2	18.5	15.9	2.60	7.125		
700.0	697.4	697.7	693.8	1.6	1.7	-39.43	-46.0	-40.2	23.0	19.9	3.11	7.384		
800.0	796.3	797.6	792.1	1.9	2.1	-42.21	-59.1	-52.2	27.5	23.8	3.67	7.491		
900.0	895.2	897.5	890.3	2.3	2.5	-44.20	-72.3	-64.1	32.1	27.8	4.27	7.525		
1,000.0	994.1	997.3	988.6	2.6	2.9	-45.69	-85.4	-76.1	36.7	31.8	4.88	7.526		
1,100.0	1,093.0	1,097.2	1,086.9	3.0	3.3	-46.84	-98.6	-88.1	41.4	35.9	5.50	7.513		
1,200.0	1,191.9	1,197.1	1,185.2	3.3	3.7	-47.77	-111.7	-100.1	46.0	39.9	6.14	7.494		
1,300.0	1,290.8	1,297.0	1,283.5	3.7	4.1	-48.52	-124.9	-112.0	50.7	43.9	6.78	7.473		
1,400.0	1,389.7	1,396.9	1,381.8	4.0	4.5	-49.15	-138.0	-124.0	55.3	47.9	7.43	7.451		
1,500.0	1,488.6	1,496.8	1,480.1	4.4	4.9	-49.68	-151.2	-136.0	60.0	51.9	8.08	7.431		
1,600.0	1,587.5	1,596.7	1,578.4	4.8	5.3	-50.13	-164.3	-148.0	64.7	56.0	8.73	7.411		
1,700.0	1,686.4	1,696.6	1,676.7	5.1	5.7	-50.52	-177.5	-159.9	69.4	60.0	9.38	7.393		
1,800.0	1,785.3	1,796.5	1,775.0	5.5	6.1	-50.86	-190.6	-171.9	74.1	64.0	10.04	7.377		
1,900.0	1,884.2	1,896.3	1,873.3	5.8	6.5	-51.16	-203.8	-183.9	78.7	68.1	10.70	7.362		
2,000.0	1,983.1	1,996.2	1,971.6	6.2	6.9	-51.43	-216.9	-195.9	83.4	72.1	11.36	7.348		
2,100.0	2,082.0	2,096.1	2,069.9	6.6	7.3	-51.67	-230.1	-207.8	88.1	76.1	12.01	7.335		
2,200.0	2,180.9	2,196.0	2,168.2	6.9	7.7	-51.88	-243.2	-219.8	92.8	80.1	12.67	7.323		
2,300.0	2,279.8	2,295.9	2,266.4	7.3	8.2	-52.08	-256.4	-231.8	97.5	84.2	13.34	7.312		
2,400.0	2,378.7	2,395.8	2,364.7	7.7	8.6	-52.25	-269.5	-243.8	102.2	88.2	14.00	7.302		
2,500.0	2,477.6	2,495.7	2,463.0	8.0	9.0	-52.41	-282.7	-255.7	106.9	92.2	14.66	7.293		
2,600.0	2,576.5	2,595.6	2,561.3	8.4	9.4	-52.56	-295.8	-267.7	111.6	96.3	15.32	7.285		
2,700.0	2,675.4	2,695.5	2,659.6	8.7	9.8	-52.70	-309.0	-279.7	116.3	100.3	15.98	7.277		
2,800.0	2,774.3	2,795.3	2,757.9	9.1	10.2	-52.82	-322.1	-291.7	121.0	104.4	16.64	7.269		
2,900.0	2,873.2	2,895.2	2,856.2	9.5	10.6	-52.94	-335.3	-303.6	125.7	108.4	17.31	7.262		
3,000.0	2,972.1	2,995.1	2,954.5	9.8	11.0	-53.04	-348.4	-315.6	130.4	112.4	17.97	7.256		
3,100.0	3,071.0	3,095.0	3,052.8	10.2	11.4	-53.14	-361.6	-327.6	135.1	116.5	18.63	7.250		
3,200.0	3,169.9	3,194.9	3,151.1	10.6	11.8	-53.24	-374.7	-339.6	139.8	120.5	19.30	7.245		
3,300.0	3,268.8	3,294.8	3,249.4	10.9	12.2	-53.32	-387.9	-351.5	144.5	124.5	19.96	7.239		
3,400.0	3,367.7	3,394.7	3,347.7	11.3	12.6	-53.40	-401.0	-363.5	149.2	128.6	20.62	7.235		
3,500.0	3,466.6	3,494.6	3,446.0	11.6	13.1	-53.48	-414.2	-375.5	153.9	132.6	21.29	7.230		
3,600.0	3,565.5	3,594.5	3,544.3	12.0	13.5	-53.55	-427.3	-387.5	158.6	136.6	21.95	7.226		
3,700.0	3,664.4	3,694.4	3,642.6	12.4	13.9	-53.62	-440.5	-399.4	163.3	140.7	22.61	7.222		
3,800.0	3,763.3	3,794.2	3,740.8	12.7	14.3	-53.68	-453.6	-411.4	168.0	144.7	23.27	7.218		
3,900.0	3,862.2	3,894.1	3,839.1	13.1	14.7	-53.74	-466.8	-423.4	172.7	148.8	23.94	7.214		
4,000.0	3,961.1	3,994.0	3,937.4	13.5	15.1	-53.80	-480.0	-435.4	177.4	152.8	24.60	7.211		
4,100.0	4,060.1	4,093.9	4,035.7	13.8	15.5	-53.86	-493.1	-447.3	182.1	156.8	25.26	7.208		
4,200.0	4,159.0	4,193.8	4,134.0	14.2	15.9	-53.91	-506.3	-459.3	186.8	160.9	25.93	7.205		
4,300.0	4,257.9	4,293.7	4,232.3	14.5	16.3	-53.96	-519.4	-471.3	191.5	164.9	26.59	7.202		
4,400.0	4,356.8	4,393.6	4,330.6	14.9	16.7	-54.00	-532.6	-483.3	196.2	169.0	27.25	7.199		

Cathedral Energy Services

Anticollision Report

Company:	Caerus Oil & Gas (NAD 27)	Local Co-ordinate Reference:	Well PUCKETT 44C-2
Project:	Garfield County, CO	TVD Reference:	KB=22' @ 8446.0usft
Reference Site:	S2-T7S-R97W (Puckett Pad P2)	MD Reference:	KB=22' @ 8446.0usft
Site Error:	0.0usft	North Reference:	True
Reference Well:	PUCKETT 44C-2	Survey Calculation Method:	Minimum Curvature
Well Error:	0.0usft	Output errors are at	2.00 sigma
Reference Wellbore	DD	Database:	USA EDM 5000 Multi Users DB
Reference Design:	Plan #1	Offset TVD Reference:	Offset Datum

Reference Depths are relative to KB=22' @ 8446.0usft
Offset Depths are relative to Offset Datum
Central Meridian is -105.500000 °

Coordinates are relative to: PUCKETT 44C-2
Coordinate System is US State Plane 1927 (Exact solution), Colorado Central 502
Grid Convergence at Surface is: -1.69°

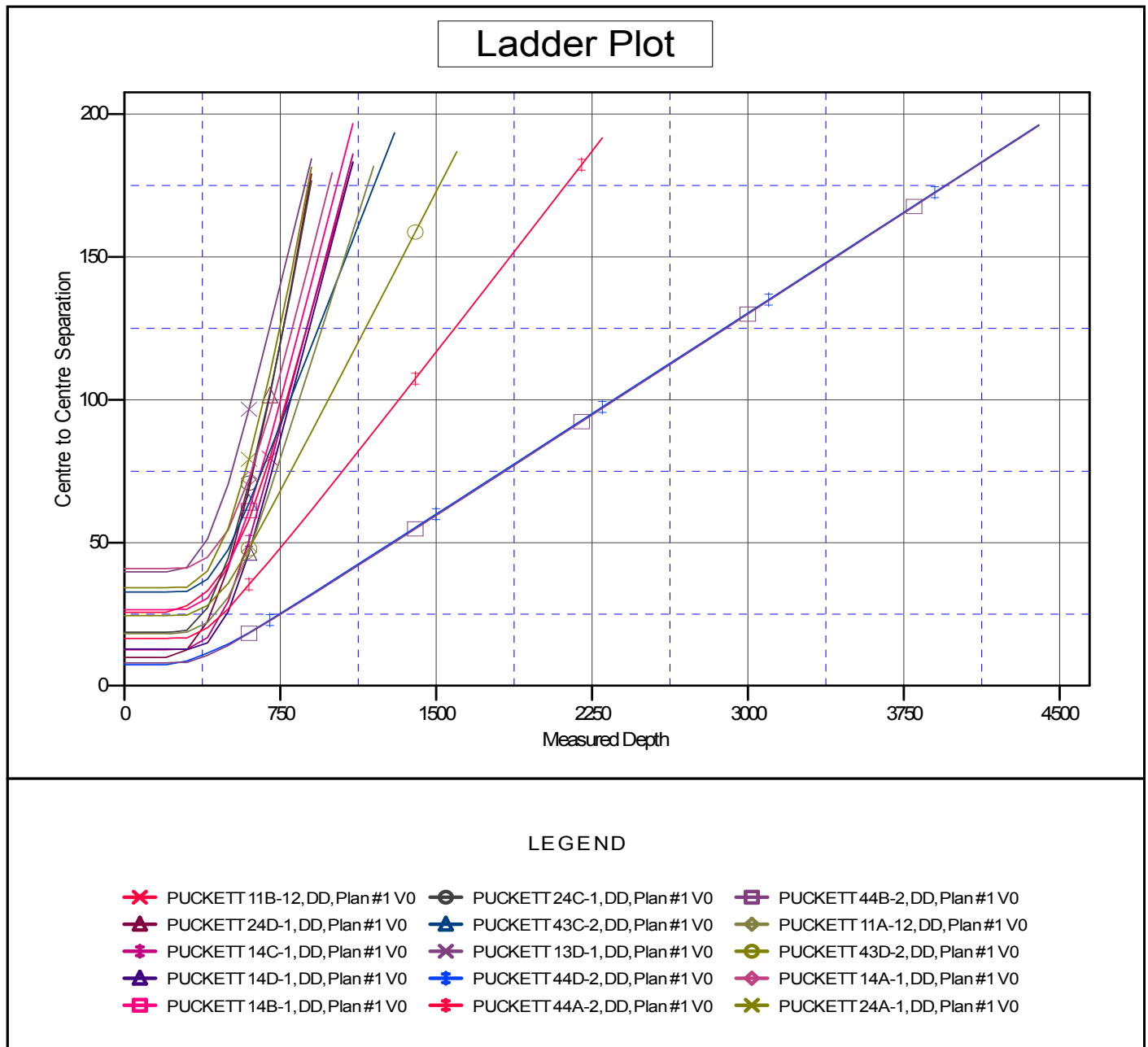

CC - Min centre to center distance or convergent point, SF - min separation factor, ES - min ellipse separation