



Project: Garfield County, CO
Site: S2-T7S-R97W (Puckett Pad P2)
Well: PUCKETT 24A-1
Wellbore: DD
Design: Plan #1



Plan #1
PUCKETT 24A-1
145XXX; SC
KB=22' @ 8446.0usft
Ground Elevation @ 8424.0
NAD 1927 (NADCON CONUS)
Well PUCKETT 24A-1, True North

SECTION DETAILS

Sec	MD	Inc	Azi	TVD	+N/-S	+E/-W	Dleg	TFace	VSect	Target
1	0.0	0.00	0.00	0.0	0.0	0.0	0.00	0.00	0.0	
2	300.0	0.00	0.00	300.0	0.0	0.0	0.00	0.00	0.0	
3	500.0	6.00	95.00	499.6	-0.9	10.4	3.00	95.00	10.4	
4	985.8	20.52	88.67	971.2	-1.1	121.4	3.00	-8.84	121.4	
5	7008.2	20.52	88.67	6611.5	47.9	2232.2	0.00	0.00	2232.7	
6	7692.3	0.00	0.00	7281.0	50.7	2353.3	3.00	180.00	2353.9	PUCKETT 24A-1 TGT
7	9292.3	0.00	0.00	8881.0	50.7	2353.3	0.00	0.00	2353.9	PUCKETT 24A-1 BHL

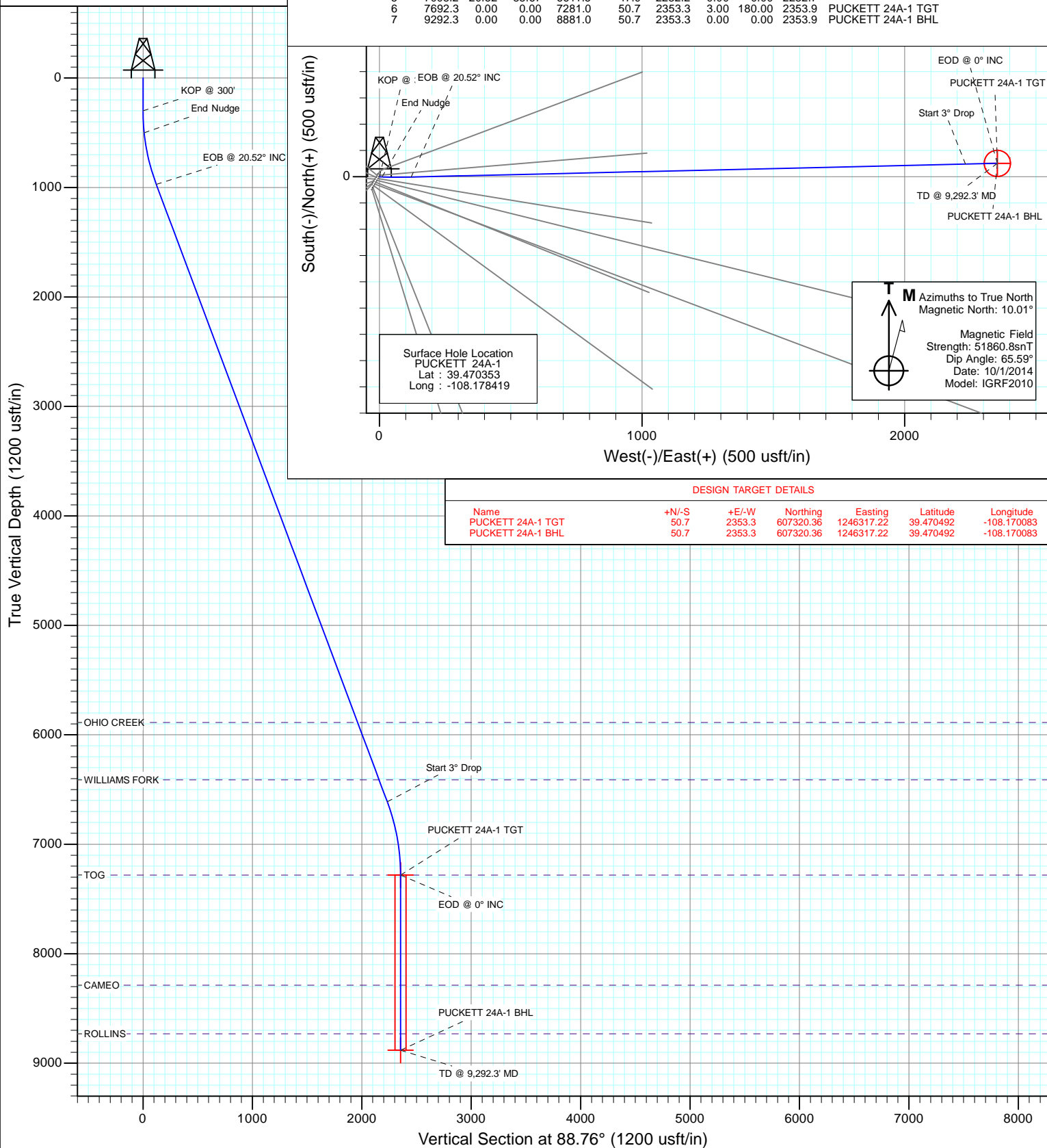

DESIGN TARGET DETAILS

Name	+N/-S	+E/-W	Northing	Easting	Latitude	Longitude
PUCKETT 24A-1 TGT	50.7	2353.3	607320.36	1246317.22	39.470492	-108.170083
PUCKETT 24A-1 BHL	50.7	2353.3	607320.36	1246317.22	39.470492	-108.170083

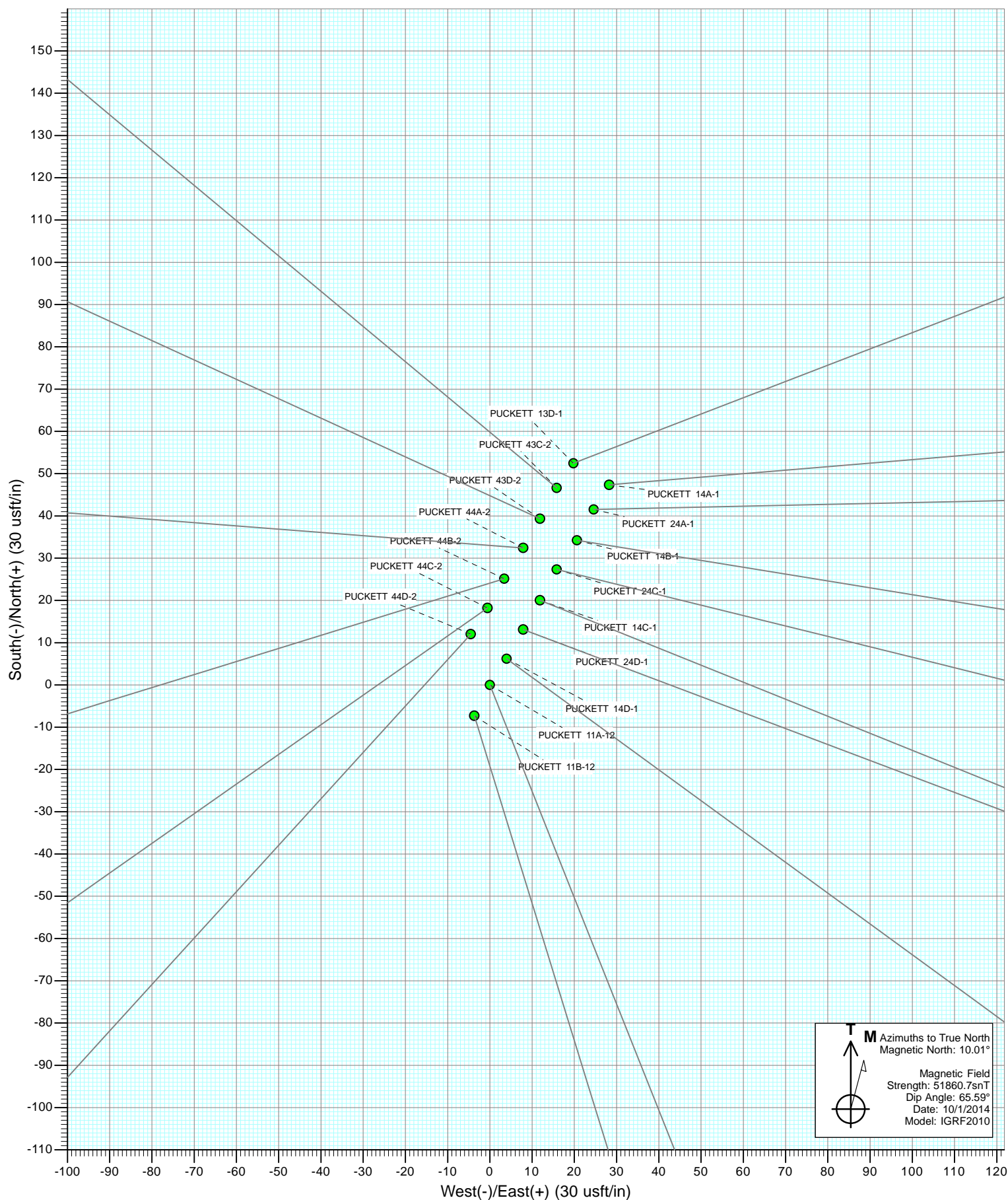

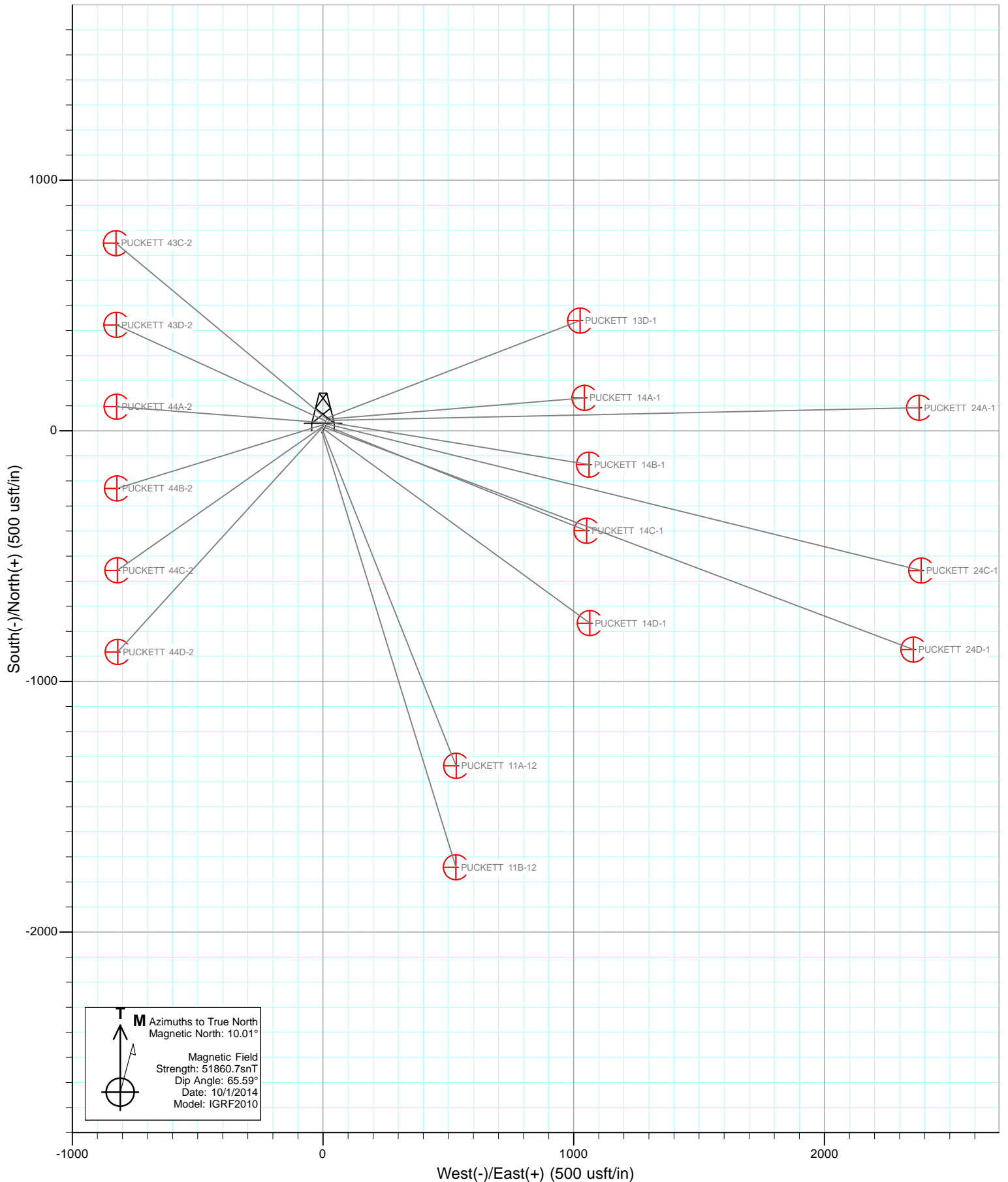

Cathedral Energy Services

Planning Report

Database:	USA EDM 5000 Multi Users DB	Local Co-ordinate Reference:	Well PUCKETT 24A-1
Company:	Caerus Oil & Gas (NAD 27)	TVD Reference:	KB=22' @ 8446.0usft
Project:	Garfield County, CO	MD Reference:	KB=22' @ 8446.0usft
Site:	S2-T7S-R97W (Puckett Pad P2)	North Reference:	True
Well:	PUCKETT 24A-1	Survey Calculation Method:	Minimum Curvature
Wellbore:	DD		
Design:	Plan #1		

Project	Garfield County, CO		
Map System:	US State Plane 1927 (Exact solution)	System Datum:	Mean Sea Level
Geo Datum:	NAD 1927 (NADCON CONUS)		
Map Zone:	Colorado Central 502		

Site		S2-T7S-R97W (Puckett Pad P2)			
Site Position:		Northing:	607,291.06 usft	Latitude:	39.470219
From:	Lat/Long	Easting:	1,243,933.75 usft	Longitude:	-108.178519
Position Uncertainty:	0.0 usft	Slot Radius:	13-3/16 "	Grid Convergence:	-1.69 °

Well	PUCKETT 24A-1					
Well Position	+N/-S	0.0 usft	Northing:	607,339.00 usft	Latitude:	39.470353
	+E/-W	0.0 usft	Easting:	1,243,963.41 usft	Longitude:	-108.178419
Position Uncertainty		0.0 usft	Wellhead Elevation:	0.0 usft	Ground Level:	8,424.0 usft

Wellbore	DD				
Magnetics	Model Name	Sample Date	Declination (°)	Dip Angle (°)	Field Strength (nT)
	IGRF2010	10/1/2014	10.00	65.59	51,861

Design	Plan #1				
Audit Notes:					
Version:	Phase:	PLAN	Tie On Depth:	0.0	
Vertical Section:	Depth From (TVD) (usft)	+N/-S (usft)	+E/-W (usft)	Direction (°)	
	0.0	0.0	0.0	88.76	

Plan Sections										
Measured Depth (usft)	Inclination (°)	Azimuth (°)	Vertical Depth (usft)	+N/-S (usft)	+E/-W (usft)	Dogleg Rate (°/100usft)	Build Rate (°/100usft)	Turn Rate (°/100usft)	TFO (°)	Target
0.0	0.00	0.00	0.0	0.0	0.0	0.00	0.00	0.00	0.00	
300.0	0.00	0.00	300.0	0.0	0.0	0.00	0.00	0.00	0.00	
500.0	6.00	95.00	499.6	-0.9	10.4	3.00	3.00	0.00	95.00	
985.8	20.52	88.67	971.2	-1.1	121.4	3.00	2.99	-1.30	-8.84	
7,008.2	20.52	88.67	6,611.5	47.9	2,232.2	0.00	0.00	0.00	0.00	
7,692.3	0.00	0.00	7,281.0	50.7	2,353.3	3.00	-3.00	0.00	180.00	PUCKETT 24A-1 TG1
9,292.3	0.00	0.00	8,881.0	50.7	2,353.3	0.00	0.00	0.00	0.00	PUCKETT 24A-1 BHL

Cathedral Energy Services

Planning Report

Database:	USA EDM 5000 Multi Users DB	Local Co-ordinate Reference:	Well PUCKETT 24A-1
Company:	Caerus Oil & Gas (NAD 27)	TVD Reference:	KB=22' @ 8446.0usft
Project:	Garfield County, CO	MD Reference:	KB=22' @ 8446.0usft
Site:	S2-T7S-R97W (Puckett Pad P2)	North Reference:	True
Well:	PUCKETT 24A-1	Survey Calculation Method:	Minimum Curvature
Wellbore:	DD		
Design:	Plan #1		

Planned Survey

Measured Depth (usft)	Inclination (°)	Azimuth (°)	Vertical Depth (usft)	+N/-S (usft)	+E/-W (usft)	Vertical Section (usft)	Dogleg Rate (°/100usft)	Build Rate (°/100u)	Comments / Formations
0.0	0.00	0.00	0.0	0.0	0.0	0.0	0.00	0.00	
100.0	0.00	0.00	100.0	0.0	0.0	0.0	0.00	0.00	
200.0	0.00	0.00	200.0	0.0	0.0	0.0	0.00	0.00	
300.0	0.00	0.00	300.0	0.0	0.0	0.0	0.00	0.00	KOP @ 300'
400.0	3.00	95.00	400.0	-0.2	2.6	2.6	3.00	3.00	
500.0	6.00	95.00	499.6	-0.9	10.4	10.4	3.00	3.00	End Nudge
600.0	8.98	92.05	598.8	-1.6	23.4	23.4	3.00	2.98	
700.0	11.96	90.56	697.1	-2.0	41.6	41.5	3.00	2.99	
800.0	14.96	89.66	794.3	-2.0	64.9	64.8	3.00	2.99	
900.0	17.95	89.05	890.2	-1.7	93.2	93.1	3.00	3.00	
985.8	20.52	88.67	971.2	-1.1	121.4	121.4	3.00	3.00	EOB @ 20.52° INC
1,000.0	20.52	88.67	984.5	-1.0	126.4	126.4	0.00	0.00	
1,100.0	20.52	88.67	1,078.2	-0.2	161.5	161.4	0.00	0.00	
1,200.0	20.52	88.67	1,171.8	0.6	196.5	196.5	0.00	0.00	
1,300.0	20.52	88.67	1,265.5	1.4	231.6	231.5	0.00	0.00	
1,400.0	20.52	88.67	1,359.1	2.2	266.6	266.6	0.00	0.00	
1,500.0	20.52	88.67	1,452.8	3.0	301.7	301.7	0.00	0.00	
1,600.0	20.52	88.67	1,546.5	3.9	336.7	336.7	0.00	0.00	
1,700.0	20.52	88.67	1,640.1	4.7	371.8	371.8	0.00	0.00	
1,800.0	20.52	88.67	1,733.8	5.5	406.8	406.8	0.00	0.00	
1,900.0	20.52	88.67	1,827.4	6.3	441.9	441.9	0.00	0.00	
2,000.0	20.52	88.67	1,921.1	7.1	476.9	476.9	0.00	0.00	
2,100.0	20.52	88.67	2,014.7	7.9	511.9	512.0	0.00	0.00	
2,200.0	20.52	88.67	2,108.4	8.7	547.0	547.1	0.00	0.00	
2,300.0	20.52	88.67	2,202.0	9.6	582.0	582.1	0.00	0.00	
2,400.0	20.52	88.67	2,295.7	10.4	617.1	617.2	0.00	0.00	
2,500.0	20.52	88.67	2,389.3	11.2	652.1	652.2	0.00	0.00	
2,600.0	20.52	88.67	2,483.0	12.0	687.2	687.3	0.00	0.00	
2,700.0	20.52	88.67	2,576.6	12.8	722.2	722.3	0.00	0.00	
2,800.0	20.52	88.67	2,670.3	13.6	757.3	757.4	0.00	0.00	
2,900.0	20.52	88.67	2,764.0	14.5	792.3	792.5	0.00	0.00	
3,000.0	20.52	88.67	2,857.6	15.3	827.4	827.5	0.00	0.00	
3,100.0	20.52	88.67	2,951.3	16.1	862.4	862.6	0.00	0.00	
3,200.0	20.52	88.67	3,044.9	16.9	897.5	897.6	0.00	0.00	
3,300.0	20.52	88.67	3,138.6	17.7	932.5	932.7	0.00	0.00	
3,400.0	20.52	88.67	3,232.2	18.5	967.6	967.7	0.00	0.00	
3,500.0	20.52	88.67	3,325.9	19.3	1,002.6	1,002.8	0.00	0.00	
3,600.0	20.52	88.67	3,419.5	20.2	1,037.7	1,037.9	0.00	0.00	
3,700.0	20.52	88.67	3,513.2	21.0	1,072.7	1,072.9	0.00	0.00	
3,800.0	20.52	88.67	3,606.8	21.8	1,107.8	1,108.0	0.00	0.00	
3,900.0	20.52	88.67	3,700.5	22.6	1,142.8	1,143.0	0.00	0.00	
4,000.0	20.52	88.67	3,794.1	23.4	1,177.9	1,178.1	0.00	0.00	
4,100.0	20.52	88.67	3,887.8	24.2	1,212.9	1,213.1	0.00	0.00	
4,200.0	20.52	88.67	3,981.4	25.0	1,247.9	1,248.2	0.00	0.00	
4,300.0	20.52	88.67	4,075.1	25.9	1,283.0	1,283.3	0.00	0.00	
4,400.0	20.52	88.67	4,168.8	26.7	1,318.0	1,318.3	0.00	0.00	
4,500.0	20.52	88.67	4,262.4	27.5	1,353.1	1,353.4	0.00	0.00	
4,600.0	20.52	88.67	4,356.1	28.3	1,388.1	1,388.4	0.00	0.00	
4,700.0	20.52	88.67	4,449.7	29.1	1,423.2	1,423.5	0.00	0.00	
4,800.0	20.52	88.67	4,543.4	29.9	1,458.2	1,458.5	0.00	0.00	
4,900.0	20.52	88.67	4,637.0	30.8	1,493.3	1,493.6	0.00	0.00	
5,000.0	20.52	88.67	4,730.7	31.6	1,528.3	1,528.7	0.00	0.00	

Cathedral Energy Services

Planning Report

Database:	USA EDM 5000 Multi Users DB	Local Co-ordinate Reference:	Well PUCKETT 24A-1
Company:	Caerus Oil & Gas (NAD 27)	TVD Reference:	KB=22' @ 8446.0usft
Project:	Garfield County, CO	MD Reference:	KB=22' @ 8446.0usft
Site:	S2-T7S-R97W (Puckett Pad P2)	North Reference:	True
Well:	PUCKETT 24A-1	Survey Calculation Method:	Minimum Curvature
Wellbore:	DD		
Design:	Plan #1		

Planned Survey

Measured Depth (usft)	Inclination (°)	Azimuth (°)	Vertical Depth (usft)	+N/-S (usft)	+E/-W (usft)	Vertical Section (usft)	Dogleg Rate (°/100usft)	Build Rate (°/100u)	Comments / Formations
5,100.0	20.52	88.67	4,824.3	32.4	1,563.4	1,563.7	0.00	0.00	
5,200.0	20.52	88.67	4,918.0	33.2	1,598.4	1,598.8	0.00	0.00	
5,300.0	20.52	88.67	5,011.6	34.0	1,633.5	1,633.8	0.00	0.00	
5,400.0	20.52	88.67	5,105.3	34.8	1,668.5	1,668.9	0.00	0.00	
5,500.0	20.52	88.67	5,198.9	35.6	1,703.6	1,703.9	0.00	0.00	
5,600.0	20.52	88.67	5,292.6	36.5	1,738.6	1,739.0	0.00	0.00	
5,700.0	20.52	88.67	5,386.3	37.3	1,773.7	1,774.1	0.00	0.00	
5,800.0	20.52	88.67	5,479.9	38.1	1,808.7	1,809.1	0.00	0.00	
5,900.0	20.52	88.67	5,573.6	38.9	1,843.8	1,844.2	0.00	0.00	
6,000.0	20.52	88.67	5,667.2	39.7	1,878.8	1,879.2	0.00	0.00	
6,100.0	20.52	88.67	5,760.9	40.5	1,913.9	1,914.3	0.00	0.00	
6,200.0	20.52	88.67	5,854.5	41.3	1,948.9	1,949.3	0.00	0.00	
6,233.6	20.52	88.67	5,886.0	41.6	1,960.7	1,961.1	0.00	0.00	OHIO CREEK
6,300.0	20.52	88.67	5,948.2	42.2	1,983.9	1,984.4	0.00	0.00	
6,400.0	20.52	88.67	6,041.8	43.0	2,019.0	2,019.4	0.00	0.00	
6,500.0	20.52	88.67	6,135.5	43.8	2,054.0	2,054.5	0.00	0.00	
6,600.0	20.52	88.67	6,229.1	44.6	2,089.1	2,089.6	0.00	0.00	
6,700.0	20.52	88.67	6,322.8	45.4	2,124.1	2,124.6	0.00	0.00	
6,794.2	20.52	88.67	6,411.0	46.2	2,157.1	2,157.6	0.00	0.00	WILLIAMS FORK
6,800.0	20.52	88.67	6,416.4	46.2	2,159.2	2,159.7	0.00	0.00	
6,900.0	20.52	88.67	6,510.1	47.1	2,194.2	2,194.7	0.00	0.00	
7,008.2	20.52	88.67	6,611.5	47.9	2,232.2	2,232.7	0.00	0.00	Start 3° Drop
7,100.0	17.77	88.67	6,698.1	48.6	2,262.2	2,262.8	3.00	-3.00	
7,200.0	14.77	88.67	6,794.1	49.3	2,290.3	2,290.8	3.00	-3.00	
7,300.0	11.77	88.67	6,891.4	49.8	2,313.2	2,313.7	3.00	-3.00	
7,400.0	8.77	88.67	6,989.8	50.2	2,331.0	2,331.6	3.00	-3.00	
7,500.0	5.77	88.67	7,089.0	50.5	2,343.7	2,344.2	3.00	-3.00	
7,600.0	2.77	88.67	7,188.7	50.7	2,351.1	2,351.7	3.00	-3.00	
7,692.3	0.00	0.00	7,281.0	50.7	2,353.3	2,353.9	3.00	-3.00	EOD @ 0° INC - TOG
7,700.0	0.00	0.00	7,288.7	50.7	2,353.3	2,353.9	0.00	0.00	
7,800.0	0.00	0.00	7,388.7	50.7	2,353.3	2,353.9	0.00	0.00	
7,900.0	0.00	0.00	7,488.7	50.7	2,353.3	2,353.9	0.00	0.00	
8,000.0	0.00	0.00	7,588.7	50.7	2,353.3	2,353.9	0.00	0.00	
8,100.0	0.00	0.00	7,688.7	50.7	2,353.3	2,353.9	0.00	0.00	
8,200.0	0.00	0.00	7,788.7	50.7	2,353.3	2,353.9	0.00	0.00	
8,300.0	0.00	0.00	7,888.7	50.7	2,353.3	2,353.9	0.00	0.00	
8,400.0	0.00	0.00	7,988.7	50.7	2,353.3	2,353.9	0.00	0.00	
8,500.0	0.00	0.00	8,088.7	50.7	2,353.3	2,353.9	0.00	0.00	
8,600.0	0.00	0.00	8,188.7	50.7	2,353.3	2,353.9	0.00	0.00	
8,697.3	0.00	0.00	8,286.0	50.7	2,353.3	2,353.9	0.00	0.00	CAMEO
8,700.0	0.00	0.00	8,288.7	50.7	2,353.3	2,353.9	0.00	0.00	
8,800.0	0.00	0.00	8,388.7	50.7	2,353.3	2,353.9	0.00	0.00	
8,900.0	0.00	0.00	8,488.7	50.7	2,353.3	2,353.9	0.00	0.00	
9,000.0	0.00	0.00	8,588.7	50.7	2,353.3	2,353.9	0.00	0.00	
9,100.0	0.00	0.00	8,688.7	50.7	2,353.3	2,353.9	0.00	0.00	
9,142.3	0.00	0.00	8,731.0	50.7	2,353.3	2,353.9	0.00	0.00	ROLLINS
9,200.0	0.00	0.00	8,788.7	50.7	2,353.3	2,353.9	0.00	0.00	
9,292.3	0.00	0.00	8,881.0	50.7	2,353.3	2,353.9	0.00	0.00	TD @ 9,292.3' MD

Cathedral Energy Services

Planning Report

Database:	USA EDM 5000 Multi Users DB	Local Co-ordinate Reference:	Well PUCKETT 24A-1
Company:	Caerus Oil & Gas (NAD 27)	TVD Reference:	KB=22' @ 8446.0usft
Project:	Garfield County, CO	MD Reference:	KB=22' @ 8446.0usft
Site:	S2-T7S-R97W (Puckett Pad P2)	North Reference:	True
Well:	PUCKETT 24A-1	Survey Calculation Method:	Minimum Curvature
Wellbore:	DD		
Design:	Plan #1		

Targets									
Target Name									
- hit/miss target	Dip Angle	Dip Dir.	TVD	+N/-S	+E/-W	Northing	Easting	Latitude	Longitude
- Shape	(°)	(°)	(usft)	(usft)	(usft)	(usft)	(usft)		
PUCKETT 24A-1 TGT	0.00	0.00	7,281.0	50.7	2,353.3	607,320.36	1,246,317.22	39.470492	-108.170083
- plan hits target center									
- Point									
PUCKETT 24A-1 BHL	0.00	0.00	8,881.0	50.7	2,353.3	607,320.36	1,246,317.22	39.470492	-108.170083
- plan hits target center									
- Circle (radius 50.0)									

Formations						
Measured Depth	Vertical Depth	Name	Lithology	Dip	Dip Direction	
(usft)	(usft)			(°)	(°)	
6,233.6	5,886.0	OHIO CREEK				
6,794.2	6,411.0	WILLIAMS FORK				
7,692.3	7,281.0	TOG				
8,697.3	8,286.0	CAMEO				
9,142.3	8,731.0	ROLLINS				

Plan Annotations					
Measured Depth	Vertical Depth	Local Coordinates			
(usft)	(usft)	+N/-S	+E/-W	Comment	
(usft)	(usft)	(usft)	(usft)		
300.0	300.0	0.0	0.0	KOP @ 300'	
500.0	499.6	-0.9	10.4	End Nudge	
985.8	971.2	-1.1	121.4	EOB @ 20.52° INC	
7,008.2	6,611.5	47.9	2,232.2	Start 3° Drop	
7,692.3	7,281.0	50.7	2,353.3	EOD @ 0° INC	
9,292.3	8,881.0	50.7	2,353.3	TD @ 9,292.3' MD	

Caerus Oil & Gas (NAD 27)

Garfield County, CO

S2-T7S-R97W (Puckett Pad P2)

PUCKETT 24A-1

DD

Plan #1

Anticollision Report

01 October, 2014

Cathedral Energy Services

Anticollision Report

Company:	Caerus Oil & Gas (NAD 27)	Local Co-ordinate Reference:	Well PUCKETT 24A-1
Project:	Garfield County, CO	TVD Reference:	KB=22' @ 8446.0usft
Reference Site:	S2-T7S-R97W (Puckett Pad P2)	MD Reference:	KB=22' @ 8446.0usft
Site Error:	0.0usft	North Reference:	True
Reference Well:	PUCKETT 24A-1	Survey Calculation Method:	Minimum Curvature
Well Error:	0.0usft	Output errors are at	2.00 sigma
Reference Wellbore	DD	Database:	USA EDM 5000 Multi Users DB
Reference Design:	Plan #1	Offset TVD Reference:	Offset Datum

Reference	Plan #1		
Filter type:	NO GLOBAL FILTER: Using user defined selection & filtering criteria		
Interpolation Method:	MD Interval 100.0usft	Error Model:	ISCWSA
Depth Range:	Unlimited	Scan Method:	Closest Approach 3D
Results Limited by:	Maximum center-center distance of 200.0usft	Error Surface:	Elliptical Conic
Warning Levels Evaluated at:	2.00 Sigma		

Survey Tool Program		Date	10/1/2014		
From (usft)	To (usft)	Survey (Wellbore)	Tool Name	Description	
0.0	9,292.2	Plan #1 (DD)	ISCWSA MWD	MWD - Standard	

Summary						
Site Name	Reference Measured Depth (usft)	Offset Measured Depth (usft)	Distance Between Centres (usft)	Distance Between Ellipses (usft)	Separation Factor	Warning
S2-T7S-R97W (Puckett Pad P2)						
PUCKETT 11A-12 - DD - Plan #1	233.8	233.8	48.2	47.5	62.113	CC, ES
PUCKETT 11A-12 - DD - Plan #1	700.0	687.4	99.0	95.7	29.961	SF
PUCKETT 11B-12 - DD - Plan #1	200.0	200.0	56.4	55.8	90.242	CC, ES
PUCKETT 11B-12 - DD - Plan #1	900.0	868.9	179.6	174.5	35.261	SF
PUCKETT 13D-1 - DD - Plan #1	200.0	200.0	11.9	11.3	19.093	CC, ES
PUCKETT 13D-1 - DD - Plan #1	400.0	399.1	17.4	15.9	11.329	SF
PUCKETT 14A-1 - DD - Plan #1	409.7	409.6	6.1	4.6	3.935	CC, ES, SF
PUCKETT 14B-1 - DD - Plan #1	300.0	300.0	8.3	7.2	7.710	CC, ES
PUCKETT 14B-1 - DD - Plan #1	400.0	400.0	9.6	8.1	6.257	SF
PUCKETT 14C-1 - DD - Plan #1	300.0	300.0	25.0	23.9	23.232	CC, ES
PUCKETT 14C-1 - DD - Plan #1	700.0	700.9	40.0	36.8	12.434	SF
PUCKETT 14D-1 - DD - Plan #1	300.0	300.0	40.9	39.8	38.066	CC, ES
PUCKETT 14D-1 - DD - Plan #1	900.0	895.4	94.5	89.5	18.917	SF
PUCKETT 24C-1 - DD - Plan #1	359.3	359.5	16.3	15.0	12.305	CC
PUCKETT 24C-1 - DD - Plan #1	400.0	400.2	16.4	14.9	10.932	ES
PUCKETT 24C-1 - DD - Plan #1	2,600.0	2,590.0	199.6	170.2	6.781	SF
PUCKETT 24D-1 - DD - Plan #1	321.0	321.2	32.5	31.4	28.145	CC, ES
PUCKETT 24D-1 - DD - Plan #1	1,800.0	1,784.8	193.8	175.8	10.784	SF
PUCKETT 43C-2 - DD - Plan #1	255.6	255.6	10.1	9.3	11.581	CC
PUCKETT 43C-2 - DD - Plan #1	300.0	299.9	10.3	9.2	9.590	ES, SF
PUCKETT 43D-2 - DD - Plan #1	300.0	300.0	12.9	11.8	11.997	CC, ES
PUCKETT 43D-2 - DD - Plan #1	400.0	399.4	16.7	15.1	10.575	SF
PUCKETT 44A-2 - DD - Plan #1	300.0	300.0	19.0	17.9	17.669	CC, ES
PUCKETT 44A-2 - DD - Plan #1	400.0	399.7	21.4	19.8	13.672	SF
PUCKETT 44B-2 - DD - Plan #1	300.0	300.0	26.8	25.7	24.922	CC, ES
PUCKETT 44B-2 - DD - Plan #1	400.0	398.9	30.1	28.6	19.468	SF
PUCKETT 44C-2 - DD - Plan #1	255.6	255.6	34.3	33.4	39.188	CC
PUCKETT 44C-2 - DD - Plan #1	300.0	299.6	34.4	33.4	32.241	ES
PUCKETT 44C-2 - DD - Plan #1	500.0	493.8	54.9	52.8	26.171	SF
PUCKETT 44D-2 - DD - Plan #1	200.0	200.0	41.4	40.8	66.289	CC, ES
PUCKETT 44D-2 - DD - Plan #1	500.0	491.2	67.6	65.5	32.220	SF

Cathedral Energy Services

Anticollision Report

Company:	Caerus Oil & Gas (NAD 27)	Local Co-ordinate Reference:	Well PUCKETT 24A-1
Project:	Garfield County, CO	TVD Reference:	KB=22' @ 8446.0usft
Reference Site:	S2-T7S-R97W (Puckett Pad P2)	MD Reference:	KB=22' @ 8446.0usft
Site Error:	0.0usft	North Reference:	True
Reference Well:	PUCKETT 24A-1	Survey Calculation Method:	Minimum Curvature
Well Error:	0.0usft	Output errors are at	2.00 sigma
Reference Wellbore	DD	Database:	USA EDM 5000 Multi Users DB
Reference Design:	Plan #1	Offset TVD Reference:	Offset Datum

Offset Design S2-T7S-R97W (Puckett Pad P2) - PUCKETT 11A-12 - DD - Plan #1													Offset Site Error:	0.0 usft
Survey Program: 0-ISCWSA MWD													Offset Well Error:	0.0 usft
Reference		Offset		Semi Major Axis			Distance						Warning	
Measured Depth (usft)	Vertical Depth (usft)	Measured Depth (usft)	Vertical Depth (usft)	Reference (usft)	Offset (usft)	Highside Toolface (°)	Offset Wellbore Centre +N/-S (usft)	Offset Wellbore Centre +E/-W (usft)	Between Centres (usft)	Between Ellipses (usft)	Total Uncertainty Axis	Separation Factor		
0.0	0.0	0.0	0.0	0.0	0.0	-149.39	-41.5	-24.6	48.2					
100.0	100.0	100.0	100.0	0.1	0.1	-149.39	-41.5	-24.6	48.2	48.1	0.18	275.149		
200.0	200.0	200.0	200.0	0.3	0.3	-149.39	-41.5	-24.6	48.2	47.6	0.62	77.200		
233.8	233.8	233.8	233.8	0.4	0.4	-149.39	-41.5	-24.6	48.2	47.5	0.78	62.113 CC, ES		
300.0	300.0	299.2	299.2	0.5	0.5	-149.98	-42.1	-24.3	48.6	47.6	1.06	45.833		
400.0	400.0	397.5	397.3	0.8	0.7	113.12	-46.8	-22.5	53.0	51.5	1.49	35.467		
500.0	499.6	495.1	494.4	1.0	1.0	112.29	-56.1	-18.8	62.7	60.7	1.99	31.460		
600.0	598.8	591.6	589.8	1.3	1.3	115.05	-69.8	-13.3	78.0	75.4	2.59	30.064		
700.0	697.1	687.4	683.6	1.6	1.6	116.62	-87.7	-6.2	99.0	95.7	3.30	29.961 SF		
800.0	794.3	784.2	778.2	2.0	2.0	118.96	-106.8	1.4	123.6	119.5	4.11	30.099		
900.0	890.2	880.1	871.9	2.6	2.5	121.93	-125.8	8.9	151.1	146.1	5.00	30.207		
1,000.0	984.5	974.7	964.3	3.2	2.9	125.11	-144.5	16.4	182.0	176.0	5.97	30.456		

Cathedral Energy Services

Anticollision Report

Company:	Caerus Oil & Gas (NAD 27)	Local Co-ordinate Reference:	Well PUCKETT 24A-1
Project:	Garfield County, CO	TVD Reference:	KB=22' @ 8446.0usft
Reference Site:	S2-T7S-R97W (Puckett Pad P2)	MD Reference:	KB=22' @ 8446.0usft
Site Error:	0.0usft	North Reference:	True
Reference Well:	PUCKETT 24A-1	Survey Calculation Method:	Minimum Curvature
Well Error:	0.0usft	Output errors are at	2.00 sigma
Reference Wellbore	DD	Database:	USA EDM 5000 Multi Users DB
Reference Design:	Plan #1	Offset TVD Reference:	Offset Datum

Offset Design S2-T7S-R97W (Puckett Pad P2) - PUCKETT 11B-12 - DD - Plan #1													Offset Site Error:	0.0 usft
Survey Program: 0-ISCSWA MWD													Offset Well Error:	0.0 usft
Reference		Offset		Semi Major Axis			Distance						Warning	
Measured Depth (usft)	Vertical Depth (usft)	Measured Depth (usft)	Vertical Depth (usft)	Reference (usft)	Offset (usft)	Highside Toolface (°)	Offset Wellbore Centre +N/-S (usft)	+E/-W (usft)	Between Centres (usft)	Between Ellipses (usft)	Total Uncertainty Axis	Separation Factor		
0.0	0.0	0.0	0.0	0.0	0.0	-149.96	-48.8	-28.2	56.4					
100.0	100.0	100.0	100.0	0.1	0.1	-149.96	-48.8	-28.2	56.4	56.2	0.18	321.630		
200.0	200.0	200.0	200.0	0.3	0.3	-149.96	-48.8	-28.2	56.4	55.8	0.62	90.242 CC, ES		
300.0	300.0	297.9	297.9	0.5	0.5	-151.77	-51.2	-27.5	58.2	57.1	1.05	55.272		
400.0	400.0	395.4	395.1	0.8	0.7	110.40	-58.4	-25.3	64.7	63.2	1.51	42.885		
500.0	499.6	492.0	490.9	1.0	1.0	109.14	-70.1	-21.7	76.8	74.8	2.02	38.015		
600.0	598.8	587.2	584.6	1.3	1.3	111.84	-86.2	-16.7	94.7	92.0	2.63	35.975		
700.0	697.1	680.5	675.4	1.6	1.7	113.49	-106.3	-10.5	118.6	115.2	3.35	35.435		
800.0	794.3	774.3	766.0	2.0	2.2	114.92	-129.9	-3.3	147.7	143.5	4.17	35.389		
900.0	890.2	868.9	857.1	2.6	2.7	116.98	-154.1	4.2	179.6	174.5	5.09	35.261 SF		

Cathedral Energy Services

Anticollision Report

Company:	Caerus Oil & Gas (NAD 27)	Local Co-ordinate Reference:	Well PUCKETT 24A-1
Project:	Garfield County, CO	TVD Reference:	KB=22' @ 8446.0usft
Reference Site:	S2-T7S-R97W (Puckett Pad P2)	MD Reference:	KB=22' @ 8446.0usft
Site Error:	0.0usft	North Reference:	True
Reference Well:	PUCKETT 24A-1	Survey Calculation Method:	Minimum Curvature
Well Error:	0.0usft	Output errors are at	2.00 sigma
Reference Wellbore	DD	Database:	USA EDM 5000 Multi Users DB
Reference Design:	Plan #1	Offset TVD Reference:	Offset Datum

Offset Design S2-T7S-R97W (Puckett Pad P2) - PUCKETT 13D-1 - DD - Plan #1													Offset Site Error:	0.0 usft
Survey Program: 0-ISCSWA MWD													Offset Well Error:	0.0 usft
Reference		Offset		Semi Major Axis			Distance						Warning	
Measured Depth (usft)	Vertical Depth (usft)	Measured Depth (usft)	Vertical Depth (usft)	Reference (usft)	Offset (usft)	Highside Toolface (°)	Offset Wellbore Centre +N/-S (usft)	+E/-W (usft)	Between Centres (usft)	Between Ellipses (usft)	Total Uncertainty Axis	Separation Factor		
0.0	0.0	0.0	0.0	0.0	0.0	-23.72	10.9	-4.8	11.9					
100.0	100.0	100.0	100.0	0.1	0.1	-23.72	10.9	-4.8	11.9	11.8	0.18	68.049		
200.0	200.0	200.0	200.0	0.3	0.3	-23.72	10.9	-4.8	11.9	11.3	0.62	19.093 CC, ES		
300.0	300.0	299.8	299.7	0.5	0.5	-17.77	12.0	-3.9	12.6	11.6	1.07	11.774		
400.0	400.0	399.1	398.9	0.8	0.8	-102.43	17.0	0.3	17.4	15.9	1.54	11.329 SF		
500.0	499.6	499.0	498.1	1.0	1.0	-99.46	24.4	8.3	25.5	23.5	2.02	12.592		
600.0	598.8	599.2	597.3	1.3	1.3	-95.59	30.6	21.2	32.3	29.8	2.57	12.578		
700.0	697.1	698.9	695.8	1.6	1.7	-98.48	36.1	35.9	38.6	35.3	3.25	11.888		
800.0	794.3	798.4	794.0	2.0	2.0	-107.12	41.6	50.6	46.0	41.9	4.02	11.434		
900.0	890.2	897.3	891.7	2.6	2.3	-118.12	47.1	65.2	56.3	51.5	4.84	11.626		
1,000.0	984.5	995.4	988.5	3.2	2.7	-128.87	52.5	79.6	71.2	65.6	5.64	12.621		
1,100.0	1,078.2	1,093.1	1,085.0	3.9	3.0	-137.09	57.9	94.1	89.3	83.0	6.32	14.132		
1,200.0	1,171.8	1,190.8	1,181.5	4.5	3.4	-142.50	63.4	108.5	108.5	101.6	6.94	15.638		
1,300.0	1,265.5	1,288.5	1,278.0	5.2	3.8	-146.27	68.8	122.9	128.5	120.9	7.55	17.018		
1,400.0	1,359.1	1,386.2	1,374.4	6.0	4.1	-149.02	74.2	137.3	148.8	140.6	8.15	18.256		
1,500.0	1,452.8	1,483.9	1,470.9	6.7	4.5	-151.11	79.6	151.8	169.3	160.6	8.75	19.352		
1,600.0	1,546.5	1,581.6	1,567.4	7.4	4.8	-152.75	85.0	166.2	190.0	180.7	9.35	20.321		

Cathedral Energy Services

Anticollision Report

Company:	Caerus Oil & Gas (NAD 27)	Local Co-ordinate Reference:	Well PUCKETT 24A-1
Project:	Garfield County, CO	TVD Reference:	KB=22' @ 8446.0usft
Reference Site:	S2-T7S-R97W (Puckett Pad P2)	MD Reference:	KB=22' @ 8446.0usft
Site Error:	0.0usft	North Reference:	True
Reference Well:	PUCKETT 24A-1	Survey Calculation Method:	Minimum Curvature
Well Error:	0.0usft	Output errors are at	2.00 sigma
Reference Wellbore	DD	Database:	USA EDM 5000 Multi Users DB
Reference Design:	Plan #1	Offset TVD Reference:	Offset Datum

Offset Design S2-T7S-R97W (Puckett Pad P2) - PUCKETT 14A-1 - DD - Plan #1													Offset Site Error:	0.0 usft
Survey Program: 0-ISCSWA MWD													Offset Well Error:	0.0 usft
Reference		Offset		Semi Major Axis			Distance						Warning	
Measured Depth (usft)	Vertical Depth (usft)	Measured Depth (usft)	Vertical Depth (usft)	Reference (usft)	Offset (usft)	Highside Toolface (°)	Offset Wellbore Centre +N/-S (usft)	+E/-W (usft)	Between Centres (usft)	Between Ellipses (usft)	Total Uncertainty Axis	Separation Factor		
0.0	0.0	0.0	0.0	0.0	0.0	32.20	5.8	3.7	6.9					
100.0	100.0	100.0	100.0	0.1	0.1	32.20	5.8	3.7	6.9	6.7	0.18	39.283		
200.0	200.0	200.0	200.0	0.3	0.3	32.20	5.8	3.7	6.9	6.3	0.62	11.022		
300.0	300.0	300.0	300.0	0.5	0.5	32.20	5.8	3.7	6.9	5.8	1.07	6.410		
400.0	400.0	400.0	400.0	0.8	0.8	-85.05	5.8	3.7	6.1	4.6	1.51	4.063		
409.7	409.6	409.6	409.6	0.8	0.8	-90.00	5.8	3.7	6.1	4.6	1.56	3.935 CC, ES, SF		
500.0	499.6	499.8	499.8	1.0	1.0	-136.86	5.9	4.3	9.1	7.1	2.05	4.458		
600.0	598.8	600.0	599.8	1.3	1.2	-152.22	6.3	9.5	16.0	13.4	2.63	6.109		
700.0	697.1	700.5	699.8	1.6	1.4	-157.53	7.2	20.0	23.6	20.4	3.21	7.361		
800.0	794.3	800.7	798.9	2.0	1.7	-160.53	8.4	34.8	32.1	28.3	3.80	8.443		
900.0	890.2	899.8	896.8	2.6	2.0	-164.25	9.7	50.0	45.1	40.7	4.42	10.211		
1,000.0	984.5	998.1	993.9	3.2	2.4	-167.54	10.9	65.0	63.2	58.2	5.02	12.605		
1,100.0	1,078.2	1,096.0	1,090.6	3.9	2.7	-169.93	12.2	80.0	83.3	77.8	5.49	15.178		
1,200.0	1,171.8	1,193.9	1,187.4	4.5	3.0	-171.40	13.4	95.0	103.5	97.5	5.98	17.307		
1,300.0	1,265.5	1,291.8	1,284.1	5.2	3.4	-172.39	14.6	110.0	123.7	117.2	6.48	19.081		
1,400.0	1,359.1	1,389.7	1,380.9	6.0	3.7	-173.10	15.9	125.0	144.0	137.0	7.00	20.560		
1,500.0	1,452.8	1,487.6	1,477.7	6.7	4.0	-173.63	17.1	139.9	164.2	156.7	7.53	21.810		
1,600.0	1,546.5	1,585.5	1,574.4	7.4	4.4	-174.05	18.4	154.9	184.5	176.4	8.07	22.877		

Cathedral Energy Services

Anticollision Report

Company:	Caerus Oil & Gas (NAD 27)	Local Co-ordinate Reference:	Well PUCKETT 24A-1
Project:	Garfield County, CO	TVD Reference:	KB=22' @ 8446.0usft
Reference Site:	S2-T7S-R97W (Puckett Pad P2)	MD Reference:	KB=22' @ 8446.0usft
Site Error:	0.0usft	North Reference:	True
Reference Well:	PUCKETT 24A-1	Survey Calculation Method:	Minimum Curvature
Well Error:	0.0usft	Output errors are at	2.00 sigma
Reference Wellbore	DD	Database:	USA EDM 5000 Multi Users DB
Reference Design:	Plan #1	Offset TVD Reference:	Offset Datum

Offset Design S2-T7S-R97W (Puckett Pad P2) - PUCKETT 14B-1 - DD - Plan #1													Offset Site Error:	0.0 usft
Survey Program: 0-ISCSWA MWD													Offset Well Error:	0.0 usft
Reference		Offset		Semi Major Axis			Distance							
Measured Depth (usft)	Vertical Depth (usft)	Measured Depth (usft)	Vertical Depth (usft)	Reference (usft)	Offset (usft)	Highside Toolface (°)	Offset Wellbore Centre +N/-S (usft)	+E/-W (usft)	Between Centres (usft)	Between Ellipses (usft)	Total Uncertainty Axis	Separation Factor	Warning	
0.0	0.0	0.0	0.0	0.0	0.0	-151.50	-7.3	-4.0	8.3					
100.0	100.0	100.0	100.0	0.1	0.1	-151.50	-7.3	-4.0	8.3	8.1	0.18	47.250		
200.0	200.0	200.0	200.0	0.3	0.3	-151.50	-7.3	-4.0	8.3	7.7	0.62	13.257		
300.0	300.0	300.0	300.0	0.5	0.5	-151.50	-7.3	-4.0	8.3	7.2	1.07	7.710 CC, ES		
400.0	400.0	400.0	400.0	0.8	0.8	127.89	-7.3	-4.0	9.6	8.1	1.54	6.257 SF		
500.0	499.6	500.2	500.2	1.0	1.0	145.03	-7.7	-1.4	13.6	11.5	2.07	6.576		
600.0	598.8	600.8	600.4	1.3	1.2	154.68	-9.0	6.5	18.6	15.9	2.64	7.024		
700.0	697.1	701.6	700.3	1.6	1.5	157.32	-11.1	19.5	24.1	20.9	3.24	7.431		
800.0	794.3	801.3	798.7	2.0	1.8	159.24	-13.6	35.0	32.3	28.4	3.88	8.328		
900.0	890.2	900.3	896.6	2.6	2.1	162.26	-16.1	50.5	45.5	41.0	4.54	10.035		
1,000.0	984.5	998.6	993.7	3.2	2.4	165.01	-18.6	65.8	63.8	58.6	5.17	12.326		
1,100.0	1,078.2	1,096.5	1,090.3	3.9	2.8	166.64	-21.1	81.1	84.0	78.3	5.69	14.750		
1,200.0	1,171.8	1,194.5	1,187.0	4.5	3.1	167.65	-23.6	96.3	104.2	98.0	6.23	16.729		
1,300.0	1,265.5	1,292.4	1,283.7	5.2	3.5	168.32	-26.0	111.6	124.4	117.6	6.77	18.367		
1,400.0	1,359.1	1,390.3	1,380.4	6.0	3.8	168.81	-28.5	126.9	144.7	137.3	7.34	19.720		
1,500.0	1,452.8	1,488.2	1,477.1	6.7	4.2	169.18	-31.0	142.1	164.9	157.0	7.91	20.860		
1,600.0	1,546.5	1,586.2	1,573.8	7.4	4.5	169.47	-33.5	157.4	185.2	176.7	8.48	21.828		

Cathedral Energy Services

Anticollision Report

Company:	Caerus Oil & Gas (NAD 27)	Local Co-ordinate Reference:	Well PUCKETT 24A-1
Project:	Garfield County, CO	TVD Reference:	KB=22' @ 8446.0usft
Reference Site:	S2-T7S-R97W (Puckett Pad P2)	MD Reference:	KB=22' @ 8446.0usft
Site Error:	0.0usft	North Reference:	True
Reference Well:	PUCKETT 24A-1	Survey Calculation Method:	Minimum Curvature
Well Error:	0.0usft	Output errors are at	2.00 sigma
Reference Wellbore	DD	Database:	USA EDM 5000 Multi Users DB
Reference Design:	Plan #1	Offset TVD Reference:	Offset Datum

Offset Design S2-T7S-R97W (Puckett Pad P2) - PUCKETT 14C-1 - DD - Plan #1													Offset Site Error:	0.0 usft
Survey Program: 0-ISCSWA MWD													Offset Well Error:	0.0 usft
Reference		Offset		Semi Major Axis			Distance					Separation Factor	Warning	
Measured Depth (usft)	Vertical Depth (usft)	Measured Depth (usft)	Vertical Depth (usft)	Reference (usft)	Offset (usft)	Highside Toolface (°)	Offset Wellbore Centre +N/-S (usft)	+E/-W (usft)	Between Centres (usft)	Between Ellipses (usft)	Total Uncertainty Axis			
0.0	0.0	0.0	0.0	0.0	0.0	-149.40	-21.5	-12.7	25.0					
100.0	100.0	100.0	100.0	0.1	0.1	-149.40	-21.5	-12.7	25.0	24.8	0.18	142.369		
200.0	200.0	200.0	200.0	0.3	0.3	-149.40	-21.5	-12.7	25.0	24.3	0.62	39.945		
300.0	300.0	300.0	300.0	0.5	0.5	-149.40	-21.5	-12.7	25.0	23.9	1.07	23.232 CC, ES		
400.0	400.0	400.1	400.1	0.8	0.8	119.34	-21.7	-12.1	26.0	24.5	1.52	17.126		
500.0	499.6	500.4	500.3	1.0	1.0	122.71	-23.7	-7.2	28.8	26.8	1.99	14.469		
600.0	598.8	600.8	600.0	1.3	1.2	126.68	-27.6	2.5	33.4	30.8	2.56	13.050		
700.0	697.1	700.9	699.0	1.6	1.5	127.49	-33.4	16.9	40.0	36.8	3.22	12.434 SF		
800.0	794.3	800.4	797.1	2.0	1.8	130.92	-39.6	32.3	49.8	45.8	3.98	12.524		
900.0	890.2	899.3	894.6	2.6	2.2	136.34	-45.8	47.6	63.5	58.8	4.79	13.268		
1,000.0	984.5	997.4	991.3	3.2	2.6	141.93	-51.9	62.8	81.7	76.1	5.60	14.604		
1,100.0	1,078.2	1,095.1	1,087.7	3.9	2.9	146.01	-58.0	77.9	102.0	95.7	6.30	16.189		
1,200.0	1,171.8	1,192.8	1,184.0	4.5	3.3	148.73	-64.1	93.1	122.6	115.6	6.99	17.533		
1,300.0	1,265.5	1,290.5	1,280.3	5.2	3.7	150.66	-70.2	108.2	143.4	135.7	7.68	18.662		
1,400.0	1,359.1	1,388.3	1,376.7	6.0	4.0	152.11	-76.3	123.3	164.3	155.9	8.38	19.615		
1,500.0	1,452.8	1,486.0	1,473.0	6.7	4.4	153.23	-82.4	138.5	185.3	176.2	9.07	20.425		

Cathedral Energy Services

Anticollision Report

Company:	Caerus Oil & Gas (NAD 27)	Local Co-ordinate Reference:	Well PUCKETT 24A-1
Project:	Garfield County, CO	TVD Reference:	KB=22' @ 8446.0usft
Reference Site:	S2-T7S-R97W (Puckett Pad P2)	MD Reference:	KB=22' @ 8446.0usft
Site Error:	0.0usft	North Reference:	True
Reference Well:	PUCKETT 24A-1	Survey Calculation Method:	Minimum Curvature
Well Error:	0.0usft	Output errors are at	2.00 sigma
Reference Wellbore	DD	Database:	USA EDM 5000 Multi Users DB
Reference Design:	Plan #1	Offset TVD Reference:	Offset Datum

Offset Design S2-T7S-R97W (Puckett Pad P2) - PUCKETT 14D-1 - DD - Plan #1													Offset Site Error:	0.0 usft
Survey Program: 0-ISCSWA MWD													Offset Well Error:	0.0 usft
Reference		Offset		Semi Major Axis			Distance					Warning		
Measured Depth (usft)	Vertical Depth (usft)	Measured Depth (usft)	Vertical Depth (usft)	Reference (usft)	Offset (usft)	Highside Toolface (°)	Offset Wellbore Centre +N/-S (usft)	+E/-W (usft)	Between Centres (usft)	Between Ellipses (usft)	Total Uncertainty Axis	Separation Factor		
0.0	0.0	0.0	0.0	0.0	0.0	-149.74	-35.3	-20.6	40.9					
100.0	100.0	100.0	100.0	0.1	0.1	-149.74	-35.3	-20.6	40.9	40.7	0.18	233.278		
200.0	200.0	200.0	200.0	0.3	0.3	-149.74	-35.3	-20.6	40.9	40.3	0.62	65.452		
300.0	300.0	300.0	300.0	0.5	0.5	-149.74	-35.3	-20.6	40.9	39.8	1.07	38.066	CC, ES	
400.0	400.0	399.8	399.7	0.8	0.7	114.91	-36.9	-18.5	42.3	40.8	1.51	28.036		
500.0	499.6	499.4	499.0	1.0	1.0	113.98	-41.5	-12.2	46.4	44.5	1.98	23.489		
600.0	598.8	598.8	597.6	1.3	1.2	115.47	-49.1	-1.8	53.7	51.2	2.55	21.035		
700.0	697.1	697.9	695.0	1.6	1.6	115.31	-59.6	12.6	64.5	61.2	3.25	19.810		
800.0	794.3	796.9	792.2	2.0	2.0	117.17	-70.9	28.2	78.1	74.0	4.07	19.157		
900.0	890.2	895.4	888.7	2.6	2.4	120.99	-82.2	43.7	94.5	89.5	5.00	18.917	SF	
1,000.0	984.5	993.0	984.5	3.2	2.8	125.62	-93.4	59.1	114.3	108.4	5.98	19.128		
1,100.0	1,078.2	1,090.3	1,079.9	3.9	3.2	129.53	-104.6	74.4	135.9	129.0	6.92	19.648		
1,200.0	1,171.8	1,187.6	1,175.4	4.5	3.6	132.36	-115.8	89.7	158.0	150.2	7.84	20.146		
1,300.0	1,265.5	1,284.9	1,270.8	5.2	4.0	134.49	-126.9	105.0	180.3	171.6	8.76	20.590		

Cathedral Energy Services

Anticollision Report

Company:	Caerus Oil & Gas (NAD 27)	Local Co-ordinate Reference:	Well PUCKETT 24A-1
Project:	Garfield County, CO	TVD Reference:	KB=22' @ 8446.0usft
Reference Site:	S2-T7S-R97W (Puckett Pad P2)	MD Reference:	KB=22' @ 8446.0usft
Site Error:	0.0usft	North Reference:	True
Reference Well:	PUCKETT 24A-1	Survey Calculation Method:	Minimum Curvature
Well Error:	0.0usft	Output errors are at	2.00 sigma
Reference Wellbore	DD	Database:	USA EDM 5000 Multi Users DB
Reference Design:	Plan #1	Offset TVD Reference:	Offset Datum

Offset Design S2-T7S-R97W (Puckett Pad P2) - PUCKETT 24C-1 - DD - Plan #1													Offset Site Error:	0.0 usft
Survey Program: 0-ISCSWA MWD													Offset Well Error:	0.0 usft
Reference		Offset		Semi Major Axis			Distance							Warning
Measured Depth (usft)	Vertical Depth (usft)	Measured Depth (usft)	Vertical Depth (usft)	Reference (usft)	Offset (usft)	Highside Toolface (°)	Offset Wellbore Centre +N/-S (usft)	+E/-W (usft)	Between Centres (usft)	Between Ellipses (usft)	Total Uncertainty Axis	Separation Factor		
0.0	0.0	0.0	0.0	0.0	0.0	-148.35	-14.2	-8.8	16.7					
100.0	100.0	100.0	100.0	0.1	0.1	-148.35	-14.2	-8.8	16.7	16.5	0.18	95.145		
200.0	200.0	200.0	200.0	0.3	0.3	-148.35	-14.2	-8.8	16.7	16.1	0.62	26.695		
300.0	300.0	300.1	300.1	0.5	0.5	-150.53	-14.4	-8.1	16.5	15.4	1.07	15.432		
359.3	359.3	359.5	359.4	0.7	0.7	109.01	-15.0	-5.7	16.3	15.0	1.32	12.305 CC		
400.0	400.0	400.2	400.1	0.8	0.7	105.08	-15.6	-3.0	16.4	14.9	1.50	10.932 ES		
500.0	499.6	500.2	499.5	1.0	1.0	95.72	-18.1	7.1	17.5	15.5	1.98	8.854		
600.0	598.8	600.0	598.0	1.3	1.3	90.82	-21.9	22.3	20.3	17.7	2.57	7.898		
700.0	697.1	699.6	695.5	1.6	1.7	86.87	-26.8	42.4	24.9	21.6	3.29	7.565		
800.0	794.3	799.0	791.4	2.0	2.2	84.57	-33.0	67.3	31.2	27.0	4.16	7.482		
900.0	890.2	898.0	885.7	2.6	2.8	83.51	-40.3	97.0	39.0	33.8	5.22	7.473		
1,000.0	984.5	997.2	978.4	3.2	3.5	83.61	-48.7	131.0	48.2	41.8	6.48	7.450		
1,100.0	1,078.2	1,096.7	1,071.2	3.9	4.2	84.66	-57.3	165.9	57.7	49.8	7.84	7.355		
1,200.0	1,171.8	1,196.3	1,164.0	4.5	4.9	85.42	-65.9	200.8	67.1	57.9	9.24	7.266		
1,300.0	1,265.5	1,295.8	1,256.8	5.2	5.6	85.99	-74.5	235.8	76.6	65.9	10.65	7.188		
1,400.0	1,359.1	1,395.4	1,349.7	6.0	6.4	86.44	-83.2	270.7	86.0	73.9	12.07	7.123		
1,500.0	1,452.8	1,494.9	1,442.5	6.7	7.1	86.79	-91.8	305.7	95.5	82.0	13.51	7.068		
1,600.0	1,546.5	1,594.5	1,535.3	7.4	7.8	87.09	-100.4	340.6	104.9	90.0	14.94	7.021		
1,700.0	1,640.1	1,694.0	1,628.1	8.1	8.6	87.33	-109.0	375.6	114.4	98.0	16.39	6.981		
1,800.0	1,733.8	1,793.6	1,720.9	8.8	9.3	87.54	-117.6	410.5	123.8	106.0	17.83	6.946		
1,900.0	1,827.4	1,893.1	1,813.7	9.5	10.1	87.72	-126.3	445.5	133.3	114.0	19.28	6.916		
2,000.0	1,921.1	1,992.7	1,906.6	10.3	10.8	87.87	-134.9	480.4	142.8	122.1	20.73	6.889		
2,100.0	2,014.7	2,092.2	1,999.4	11.0	11.6	88.01	-143.5	515.4	152.2	130.1	22.18	6.866		
2,200.0	2,108.4	2,191.8	2,092.2	11.7	12.3	88.12	-152.1	550.3	161.7	138.1	23.63	6.845		
2,300.0	2,202.0	2,291.3	2,185.0	12.4	13.1	88.23	-160.7	585.2	171.2	146.1	25.08	6.826		
2,400.0	2,295.7	2,390.9	2,277.8	13.2	13.8	88.33	-169.4	620.2	180.7	154.1	26.53	6.810		
2,500.0	2,389.3	2,490.4	2,370.6	13.9	14.6	88.41	-178.0	655.1	190.1	162.1	27.98	6.794		
2,600.0	2,483.0	2,590.0	2,463.4	14.6	15.3	88.49	-186.6	690.1	199.6	170.2	29.43	6.781 SF		

Cathedral Energy Services

Anticollision Report

Company:	Caerus Oil & Gas (NAD 27)	Local Co-ordinate Reference:	Well PUCKETT 24A-1
Project:	Garfield County, CO	TVD Reference:	KB=22' @ 8446.0usft
Reference Site:	S2-T7S-R97W (Puckett Pad P2)	MD Reference:	KB=22' @ 8446.0usft
Site Error:	0.0usft	North Reference:	True
Reference Well:	PUCKETT 24A-1	Survey Calculation Method:	Minimum Curvature
Well Error:	0.0usft	Output errors are at	2.00 sigma
Reference Wellbore	DD	Database:	USA EDM 5000 Multi Users DB
Reference Design:	Plan #1	Offset TVD Reference:	Offset Datum

Offset Design S2-T7S-R97W (Puckett Pad P2) - PUCKETT 24D-1 - DD - Plan #1													Offset Site Error: 0.0 usft	
Survey Program: 0-ISCSWA MWD													Offset Well Error: 0.0 usft	
Reference		Offset		Semi Major Axis			Distance							Warning
Measured Depth (usft)	Vertical Depth (usft)	Measured Depth (usft)	Vertical Depth (usft)	Reference (usft)	Offset (usft)	Highside Toolface (°)	Offset Wellbore Centre +N/-S (usft)	+E/-W (usft)	Between Centres (usft)	Between Ellipses (usft)	Total Uncertainty Axis	Separation Factor		
0.0	0.0	0.0	0.0	0.0	0.0	-149.61	-28.4	-16.7	32.9					
100.0	100.0	100.0	100.0	0.1	0.1	-149.61	-28.4	-16.7	32.9	32.8	0.18	187.823		
200.0	200.0	200.0	200.0	0.3	0.3	-149.61	-28.4	-16.7	32.9	32.3	0.62	52.699		
300.0	300.0	300.2	300.2	0.5	0.5	-154.17	-29.3	-14.2	32.6	31.5	1.07	30.498		
321.0	321.0	321.2	321.1	0.6	0.6	108.89	-29.8	-13.1	32.5	31.4	1.16	28.145 CC, ES		
400.0	400.0	400.1	399.7	0.8	0.8	101.51	-32.1	-6.9	33.3	31.7	1.51	22.006		
500.0	499.6	499.6	498.4	1.0	1.0	92.95	-36.7	5.3	36.2	34.1	2.02	17.887		
600.0	598.8	598.8	595.9	1.3	1.4	89.10	-43.1	22.2	41.5	38.9	2.64	15.722		
700.0	697.1	697.6	692.0	1.6	1.9	85.89	-51.2	43.6	49.5	46.1	3.39	14.587		
800.0	794.3	795.8	786.2	2.0	2.4	83.88	-61.0	69.6	59.7	55.4	4.29	13.913		
900.0	890.2	893.5	878.4	2.6	3.0	82.85	-72.4	99.9	72.0	66.6	5.36	13.427		
1,000.0	984.5	992.3	970.4	3.2	3.7	83.49	-85.0	133.4	85.5	78.8	6.62	12.913		
1,100.0	1,078.2	1,091.4	1,062.7	3.9	4.4	85.04	-97.7	167.0	98.9	90.9	7.99	12.383		
1,200.0	1,171.8	1,190.4	1,155.0	4.5	5.2	86.22	-110.4	200.7	112.4	103.0	9.38	11.977		
1,300.0	1,265.5	1,289.5	1,247.3	5.2	5.9	87.14	-123.1	234.3	125.9	115.1	10.80	11.661		
1,400.0	1,359.1	1,388.6	1,339.7	6.0	6.7	87.89	-135.8	268.0	139.5	127.2	12.22	11.410		
1,500.0	1,452.8	1,487.6	1,432.0	6.7	7.4	88.50	-148.6	301.6	153.0	139.4	13.65	11.208		
1,600.0	1,546.5	1,586.7	1,524.3	7.4	8.2	89.02	-161.3	335.3	166.6	151.5	15.09	11.041		
1,700.0	1,640.1	1,685.7	1,616.6	8.1	8.9	89.45	-174.0	368.9	180.2	163.7	16.53	10.902		
1,800.0	1,733.8	1,784.8	1,708.9	8.8	9.6	89.83	-186.7	402.6	193.8	175.8	17.97	10.784 SF		

Cathedral Energy Services

Anticollision Report

Company:	Caerus Oil & Gas (NAD 27)	Local Co-ordinate Reference:	Well PUCKETT 24A-1
Project:	Garfield County, CO	TVD Reference:	KB=22' @ 8446.0usft
Reference Site:	S2-T7S-R97W (Puckett Pad P2)	MD Reference:	KB=22' @ 8446.0usft
Site Error:	0.0usft	North Reference:	True
Reference Well:	PUCKETT 24A-1	Survey Calculation Method:	Minimum Curvature
Well Error:	0.0usft	Output errors are at	2.00 sigma
Reference Wellbore	DD	Database:	USA EDM 5000 Multi Users DB
Reference Design:	Plan #1	Offset TVD Reference:	Offset Datum

Offset Design												Offset Site Error:	0.0 usft
S2-T7S-R97W (Puckett Pad P2) - PUCKETT 43C-2 - DD - Plan #1												Offset Well Error:	0.0 usft
Survey Program: 0-ISCSWA MWD													
Reference		Offset		Semi Major Axis		Distance							
Measured Depth (usft)	Vertical Depth (usft)	Measured Depth (usft)	Vertical Depth (usft)	Reference (usft)	Offset (usft)	Highside Toolface (°)	Offset Wellbore Centre +N/-S (usft)	+E/-W (usft)	Between Centres (usft)	Between Ellipses (usft)	Total Uncertainty Axis	Separation Factor	Warning
0.0	0.0	0.0	0.0	0.0	0.0	-59.77	5.1	-8.8	10.1				
100.0	100.0	100.0	100.0	0.1	0.1	-59.77	5.1	-8.8	10.1	10.0	0.18	57.774	
200.0	200.0	200.0	200.0	0.3	0.3	-59.77	5.1	-8.8	10.1	9.5	0.62	16.210	
255.6	255.6	255.6	255.6	0.4	0.4	-59.77	5.1	-8.8	10.1	9.3	0.87	11.581 CC	
300.0	300.0	299.9	299.9	0.5	0.5	-59.62	5.2	-8.9	10.3	9.2	1.07	9.590 ES, SF	
400.0	400.0	399.0	398.9	0.8	0.8	-156.21	7.7	-11.8	16.5	14.9	1.58	10.437	
500.0	499.6	496.5	496.0	1.0	1.0	-158.53	13.3	-18.6	32.5	30.4	2.18	14.955	
600.0	598.8	591.2	589.7	1.3	1.3	-157.05	21.8	-28.8	58.0	55.2	2.80	20.710	
700.0	697.1	685.9	683.2	1.6	1.6	-157.11	31.6	-40.6	89.9	86.5	3.40	26.434	
800.0	794.3	779.0	775.1	2.0	1.9	-157.79	41.3	-52.1	126.2	122.2	4.00	31.590	
900.0	890.2	870.1	865.0	2.6	2.2	-158.60	50.7	-63.4	167.1	162.5	4.60	36.328	

Cathedral Energy Services

Anticollision Report

Company:	Caerus Oil & Gas (NAD 27)	Local Co-ordinate Reference:	Well PUCKETT 24A-1
Project:	Garfield County, CO	TVD Reference:	KB=22' @ 8446.0usft
Reference Site:	S2-T7S-R97W (Puckett Pad P2)	MD Reference:	KB=22' @ 8446.0usft
Site Error:	0.0usft	North Reference:	True
Reference Well:	PUCKETT 24A-1	Survey Calculation Method:	Minimum Curvature
Well Error:	0.0usft	Output errors are at	2.00 sigma
Reference Wellbore	DD	Database:	USA EDM 5000 Multi Users DB
Reference Design:	Plan #1	Offset TVD Reference:	Offset Datum

Offset Design S2-T7S-R97W (Puckett Pad P2) - PUCKETT 43D-2 - DD - Plan #1												Offset Site Error:	0.0 usft
Survey Program: 0-ISCSWA MWD												Offset Well Error:	0.0 usft
Reference		Offset		Semi Major Axis		Distance							
Measured Depth (usft)	Vertical Depth (usft)	Measured Depth (usft)	Vertical Depth (usft)	Reference (usft)	Offset (usft)	Highside Toolface (°)	Offset Wellbore Centre +N/-S (usft)	+E/-W (usft)	Between Centres (usft)	Between Ellipses (usft)	Total Uncertainty Axis	Separation Factor	Warning
0.0	0.0	0.0	0.0	0.0	0.0	-99.74	-2.2	-12.7	12.9				
100.0	100.0	100.0	100.0	0.1	0.1	-99.74	-2.2	-12.7	12.9	12.7	0.18	73.522	
200.0	200.0	200.0	200.0	0.3	0.3	-99.74	-2.2	-12.7	12.9	12.3	0.62	20.629	
300.0	300.0	300.0	300.0	0.5	0.5	-99.74	-2.2	-12.7	12.9	11.8	1.07	11.997 CC, ES	
400.0	400.0	399.4	399.4	0.8	0.8	170.33	-1.6	-14.0	16.7	15.1	1.58	10.575 SF	
500.0	499.6	497.3	497.1	1.0	1.0	178.72	1.1	-19.8	30.4	28.2	2.17	13.990	
600.0	598.8	592.6	591.7	1.3	1.2	-174.06	5.6	-29.7	54.1	51.3	2.81	19.279	
700.0	697.1	687.7	686.0	1.6	1.5	-171.20	11.0	-41.5	84.8	81.4	3.41	24.900	
800.0	794.3	781.2	778.5	2.0	1.8	-170.13	16.3	-53.1	120.4	116.4	4.00	30.124	
900.0	890.2	872.7	869.2	2.6	2.1	-169.75	21.5	-64.4	160.7	156.1	4.59	35.035	

Cathedral Energy Services

Anticollision Report

Company:	Caerus Oil & Gas (NAD 27)	Local Co-ordinate Reference:	Well PUCKETT 24A-1
Project:	Garfield County, CO	TVD Reference:	KB=22' @ 8446.0usft
Reference Site:	S2-T7S-R97W (Puckett Pad P2)	MD Reference:	KB=22' @ 8446.0usft
Site Error:	0.0usft	North Reference:	True
Reference Well:	PUCKETT 24A-1	Survey Calculation Method:	Minimum Curvature
Well Error:	0.0usft	Output errors are at	2.00 sigma
Reference Wellbore	DD	Database:	USA EDM 5000 Multi Users DB
Reference Design:	Plan #1	Offset TVD Reference:	Offset Datum

Offset Design S2-T7S-R97W (Puckett Pad P2) - PUCKETT 44A-2 - DD - Plan #1													Offset Site Error:	0.0 usft
Survey Program: 0-ISCSWA MWD													Offset Well Error:	0.0 usft
Reference		Offset		Semi Major Axis			Distance						Warning	
Measured Depth (usft)	Vertical Depth (usft)	Measured Depth (usft)	Vertical Depth (usft)	Reference (usft)	Offset (usft)	Highside Toolface (°)	Offset Wellbore Centre +N/-S (usft)	+E/-W (usft)	Between Centres (usft)	Between Ellipses (usft)	Total Uncertainty Axis	Separation Factor		
0.0	0.0	0.0	0.0	0.0	0.0	-118.66	-9.1	-16.7	19.0					
100.0	100.0	100.0	100.0	0.1	0.1	-118.66	-9.1	-16.7	19.0	18.8	0.18	108.277		
200.0	200.0	200.0	200.0	0.3	0.3	-118.66	-9.1	-16.7	19.0	18.4	0.62	30.380		
300.0	300.0	300.0	300.0	0.5	0.5	-118.66	-9.1	-16.7	19.0	17.9	1.07	17.669 CC, ES		
400.0	400.0	399.7	399.7	0.8	0.8	150.42	-9.1	-16.8	21.4	19.8	1.56	13.672 SF		
500.0	499.6	497.8	497.7	1.0	1.0	160.50	-8.8	-20.6	32.1	29.9	2.13	15.079		
600.0	598.8	593.3	592.8	1.3	1.2	170.61	-8.2	-29.1	53.2	50.5	2.76	19.268		
700.0	697.1	688.1	686.9	1.6	1.4	175.60	-7.3	-40.7	83.1	79.7	3.40	24.460		
800.0	794.3	781.7	779.7	2.0	1.7	178.11	-6.4	-52.3	118.2	114.2	4.00	29.568		
900.0	890.2	873.3	870.7	2.6	2.0	179.53	-5.5	-63.7	158.1	153.5	4.59	34.444		

Cathedral Energy Services

Anticollision Report

Company:	Caerus Oil & Gas (NAD 27)	Local Co-ordinate Reference:	Well PUCKETT 24A-1
Project:	Garfield County, CO	TVD Reference:	KB=22' @ 8446.0usft
Reference Site:	S2-T7S-R97W (Puckett Pad P2)	MD Reference:	KB=22' @ 8446.0usft
Site Error:	0.0usft	North Reference:	True
Reference Well:	PUCKETT 24A-1	Survey Calculation Method:	Minimum Curvature
Well Error:	0.0usft	Output errors are at	2.00 sigma
Reference Wellbore	DD	Database:	USA EDM 5000 Multi Users DB
Reference Design:	Plan #1	Offset TVD Reference:	Offset Datum

Offset Design S2-T7S-R97W (Puckett Pad P2) - PUCKETT 44B-2 - DD - Plan #1													Offset Site Error:	0.0 usft
Survey Program: 0-ISCSWA MWD													Offset Well Error:	0.0 usft
Reference		Offset		Semi Major Axis			Distance						Warning	
Measured Depth (usft)	Vertical Depth (usft)	Measured Depth (usft)	Vertical Depth (usft)	Reference (usft)	Offset (usft)	Highside Toolface (°)	Offset Wellbore Centre +N/-S (usft)	+E/-W (usft)	Between Centres (usft)	Between Ellipses (usft)	Total Uncertainty Axis	Separation Factor		
0.0	0.0	0.0	0.0	0.0	0.0	-127.74	-16.4	-21.2	26.8					
100.0	100.0	100.0	100.0	0.1	0.1	-127.74	-16.4	-21.2	26.8	26.6	0.18	152.728		
200.0	200.0	200.0	200.0	0.3	0.3	-127.74	-16.4	-21.2	26.8	26.2	0.62	42.852		
300.0	300.0	300.0	300.0	0.5	0.5	-127.74	-16.4	-21.2	26.8	25.7	1.07	24.922 CC, ES		
400.0	400.0	398.9	398.8	0.8	0.7	141.49	-16.8	-22.5	30.1	28.6	1.55	19.468 SF		
500.0	499.6	496.1	495.8	1.0	1.0	150.09	-18.6	-28.5	42.9	40.8	2.11	20.322		
600.0	598.8	591.2	590.3	1.3	1.2	159.34	-21.8	-38.8	65.9	63.2	2.77	23.822		
700.0	697.1	686.5	684.9	1.6	1.5	164.44	-25.4	-50.4	95.7	92.3	3.39	28.248		
800.0	794.3	780.1	777.7	2.0	1.8	167.53	-29.0	-61.9	130.6	126.6	4.01	32.603		
900.0	890.2	871.7	868.6	2.6	2.0	169.58	-32.4	-73.1	170.5	165.8	4.62	36.870		

Cathedral Energy Services

Anticollision Report

Company:	Caerus Oil & Gas (NAD 27)	Local Co-ordinate Reference:	Well PUCKETT 24A-1
Project:	Garfield County, CO	TVD Reference:	KB=22' @ 8446.0usft
Reference Site:	S2-T7S-R97W (Puckett Pad P2)	MD Reference:	KB=22' @ 8446.0usft
Site Error:	0.0usft	North Reference:	True
Reference Well:	PUCKETT 24A-1	Survey Calculation Method:	Minimum Curvature
Well Error:	0.0usft	Output errors are at	2.00 sigma
Reference Wellbore	DD	Database:	USA EDM 5000 Multi Users DB
Reference Design:	Plan #1	Offset TVD Reference:	Offset Datum

Offset Design S2-T7S-R97W (Puckett Pad P2) - PUCKETT 44C-2 - DD - Plan #1													Offset Site Error:	0.0 usft
Survey Program: 0-ISCSWA MWD													Offset Well Error:	0.0 usft
Reference		Offset		Semi Major Axis			Distance							Warning
Measured Depth (usft)	Vertical Depth (usft)	Measured Depth (usft)	Vertical Depth (usft)	Reference (usft)	Offset (usft)	Highside Toolface (°)	Offset Wellbore Centre +N/-S (usft)	+E/-W (usft)	Between Centres (usft)	Between Ellipses (usft)	Total Uncertainty Axis	Separation Factor		
0.0	0.0	0.0	0.0	0.0	0.0	-132.85	-23.3	-25.1	34.3					
100.0	100.0	100.0	100.0	0.1	0.1	-132.85	-23.3	-25.1	34.3	34.1	0.18	195.495		
200.0	200.0	200.0	200.0	0.3	0.3	-132.85	-23.3	-25.1	34.3	33.6	0.62	54.851		
255.6	255.6	255.6	255.6	0.4	0.4	-132.85	-23.3	-25.1	34.3	33.4	0.87	39.188 CC		
300.0	300.0	299.6	299.6	0.5	0.5	-132.82	-23.4	-25.3	34.4	33.4	1.07	32.241 ES		
400.0	400.0	397.5	397.4	0.8	0.7	135.52	-25.6	-28.3	40.1	38.5	1.53	26.185		
500.0	499.6	493.8	493.4	1.0	1.0	141.55	-30.5	-35.4	54.9	52.8	2.10	26.171 SF		
600.0	598.8	588.5	587.2	1.3	1.2	149.37	-37.9	-46.0	79.1	76.4	2.75	28.764		
700.0	697.1	683.6	681.2	1.6	1.5	154.26	-46.0	-57.5	109.5	106.1	3.39	32.330		
800.0	794.3	777.0	773.5	2.0	1.8	157.62	-53.9	-68.8	144.8	140.8	4.03	35.909		
900.0	890.2	868.4	863.9	2.6	2.2	160.07	-61.7	-79.8	185.0	180.3	4.69	39.467		

Cathedral Energy Services

Anticollision Report

Company:	Caerus Oil & Gas (NAD 27)	Local Co-ordinate Reference:	Well PUCKETT 24A-1
Project:	Garfield County, CO	TVD Reference:	KB=22' @ 8446.0usft
Reference Site:	S2-T7S-R97W (Puckett Pad P2)	MD Reference:	KB=22' @ 8446.0usft
Site Error:	0.0usft	North Reference:	True
Reference Well:	PUCKETT 24A-1	Survey Calculation Method:	Minimum Curvature
Well Error:	0.0usft	Output errors are at	2.00 sigma
Reference Wellbore	DD	Database:	USA EDM 5000 Multi Users DB
Reference Design:	Plan #1	Offset TVD Reference:	Offset Datum

Offset Design S2-T7S-R97W (Puckett Pad P2) - PUCKETT 44D-2 - DD - Plan #1													Offset Site Error:	0.0 usft
Survey Program: 0-ISWWSA MWD													Offset Well Error:	0.0 usft
Reference		Offset		Semi Major Axis			Distance							Warning
Measured Depth (usft)	Vertical Depth (usft)	Measured Depth (usft)	Vertical Depth (usft)	Reference (usft)	Offset (usft)	Highside Toolface (°)	Offset Wellbore Centre +N/-S (usft)	Offset Wellbore Centre +E/-W (usft)	Between Centres (usft)	Between Ellipses (usft)	Total Uncertainty Axis	Separation Factor		
0.0	0.0	0.0	0.0	0.0	0.0	-135.41	-29.5	-29.1	41.4					
100.0	100.0	100.0	100.0	0.1	0.1	-135.41	-29.5	-29.1	41.4	41.2	0.18	236.260		
200.0	200.0	200.0	200.0	0.3	0.3	-135.41	-29.5	-29.1	41.4	40.8	0.62	66.289 CC, ES		
300.0	300.0	298.4	298.4	0.5	0.5	-135.49	-30.5	-30.0	42.9	41.8	1.06	40.621		
400.0	400.0	395.6	395.4	0.8	0.7	131.29	-35.1	-34.2	50.9	49.4	1.54	33.114		
500.0	499.6	491.2	490.3	1.0	1.0	135.12	-43.2	-41.5	67.6	65.5	2.10	32.220 SF		
600.0	598.8	584.7	582.6	1.3	1.3	141.57	-54.4	-51.8	93.3	90.5	2.75	33.912		
700.0	697.1	679.3	675.7	1.6	1.6	145.93	-66.9	-63.1	125.0	121.6	3.40	36.738		
800.0	794.3	772.2	767.1	2.0	2.0	149.19	-79.1	-74.2	161.3	157.3	4.07	39.603		

Cathedral Energy Services

Anticollision Report

Company:	Caerus Oil & Gas (NAD 27)	Local Co-ordinate Reference:	Well PUCKETT 24A-1
Project:	Garfield County, CO	TVD Reference:	KB=22' @ 8446.0usft
Reference Site:	S2-T7S-R97W (Puckett Pad P2)	MD Reference:	KB=22' @ 8446.0usft
Site Error:	0.0usft	North Reference:	True
Reference Well:	PUCKETT 24A-1	Survey Calculation Method:	Minimum Curvature
Well Error:	0.0usft	Output errors are at	2.00 sigma
Reference Wellbore	DD	Database:	USA EDM 5000 Multi Users DB
Reference Design:	Plan #1	Offset TVD Reference:	Offset Datum

Reference Depths are relative to KB=22' @ 8446.0usft
Offset Depths are relative to Offset Datum
Central Meridian is -105.500000 °

Coordinates are relative to: PUCKETT 24A-1
Coordinate System is US State Plane 1927 (Exact solution), Colorado Central 502
Grid Convergence at Surface is: -1.69°

Ladder Plot

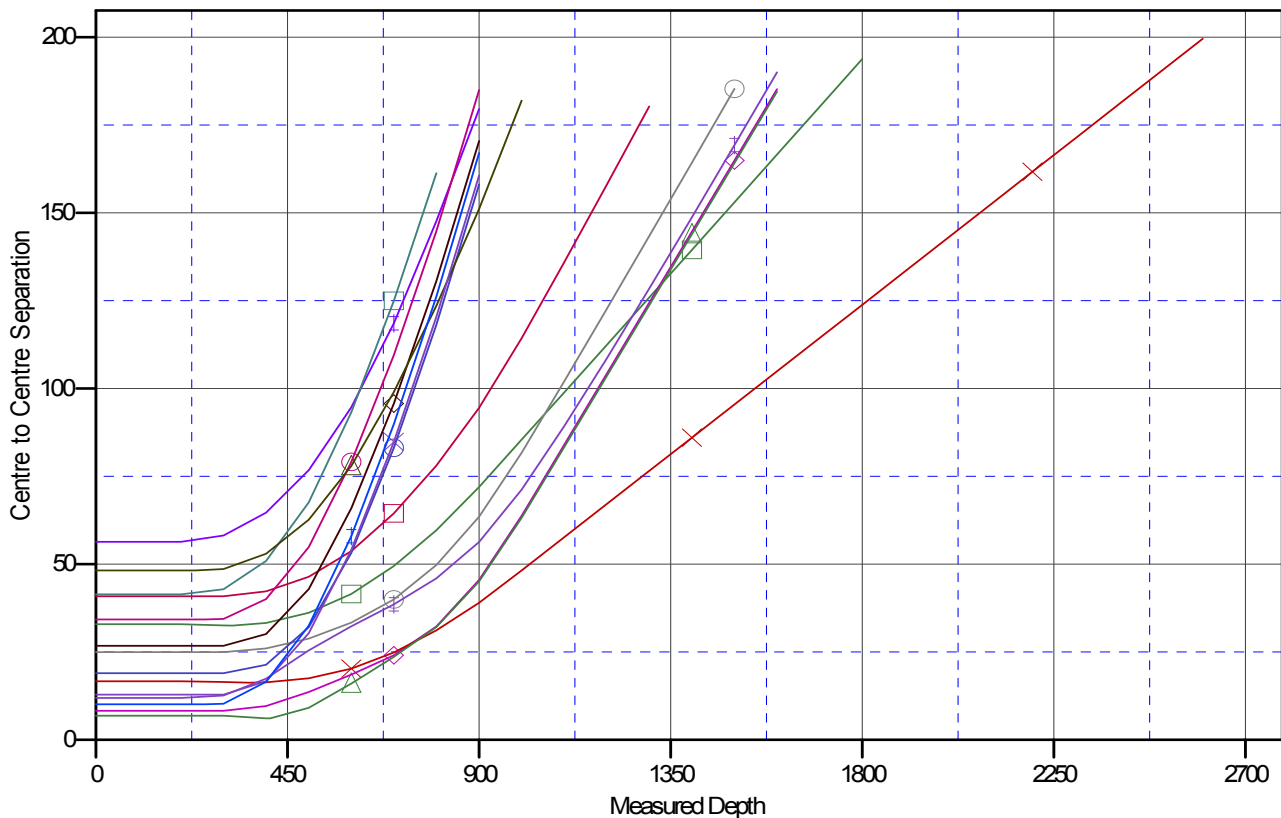

LEGEND

PUCKETT 11B-12,DD,Plan#1 V0	PUCKETT 24C-1,DD,Plan#1 V0	PUCKETT 44B-2,DD,Plan#1 V0
PUCKETT 24D-1,DD,Plan#1 V0	PUCKETT 13D-1,DD,Plan#1 V0	PUCKETT 11A-12,DD,Plan#1 V0
PUCKETT 14C-1,DD,Plan#1 V0	PUCKETT 44D-2,DD,Plan#1 V0	PUCKETT 43D-2,DD,Plan#1 V0
PUCKETT 14D-1,DD,Plan#1 V0	PUCKETT 44C-2,DD,Plan#1 V0	PUCKETT 14A-1,DD,Plan#1 V0
PUCKETT 14B-1,DD,Plan#1 V0	PUCKETT 44A-2,DD,Plan#1 V0	PUCKETT 43C-2,DD,Plan#1 V0