

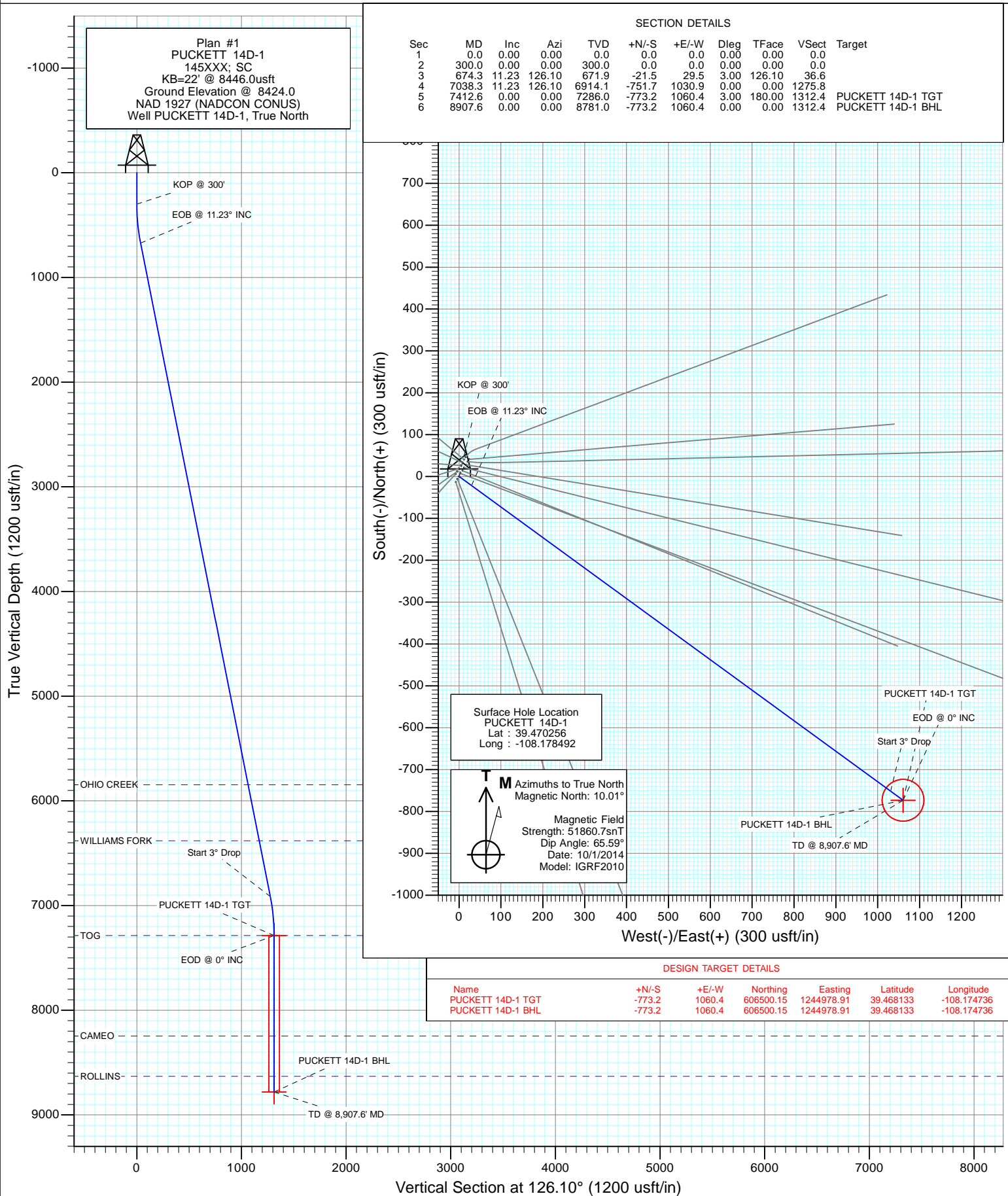

Project: Garfield County, CO
Site: S2-T7S-R97W (Puckett Pad P2)
Well: PUCKETT 14D-1
Wellbore: DD
Design: Plan #1

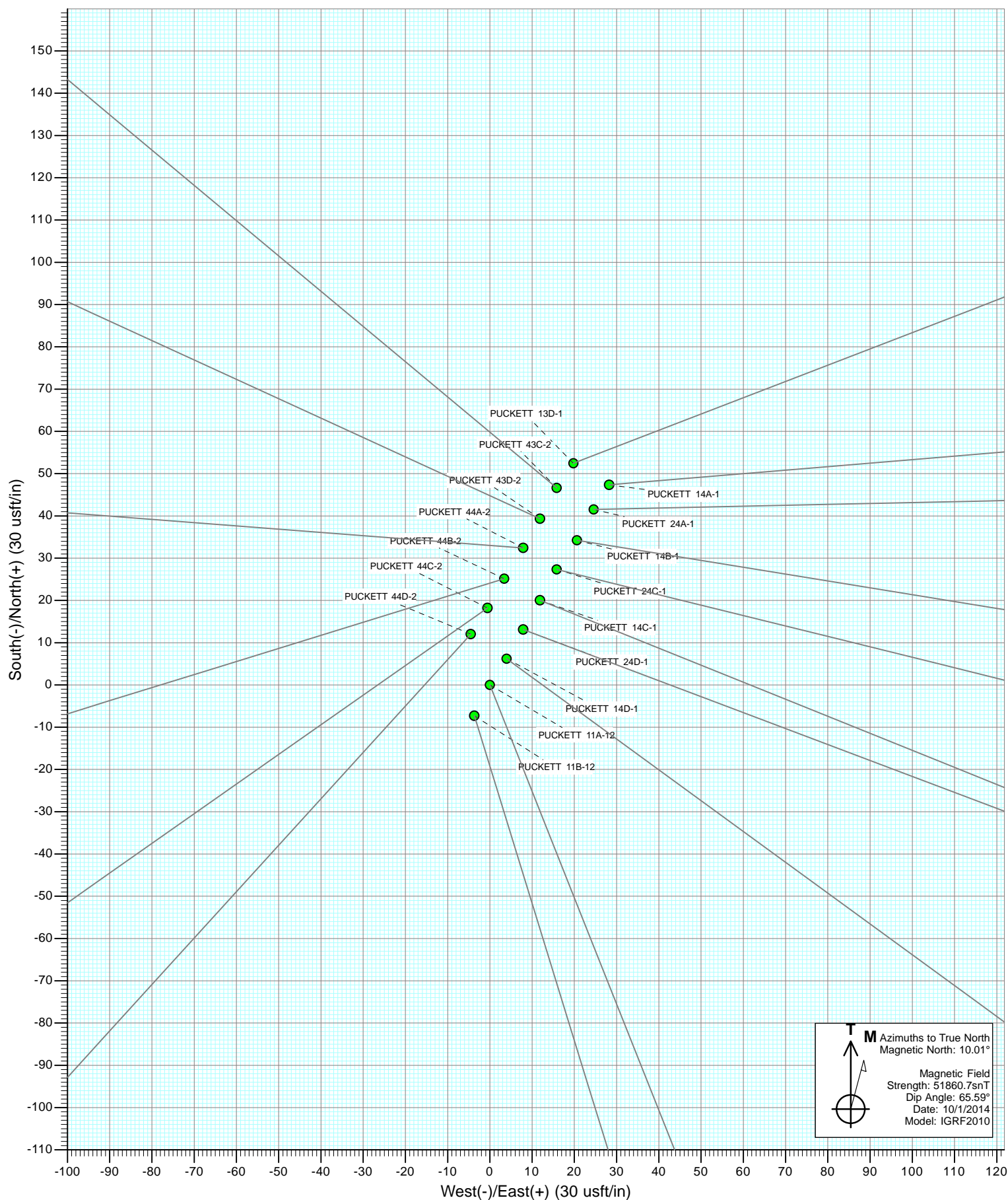

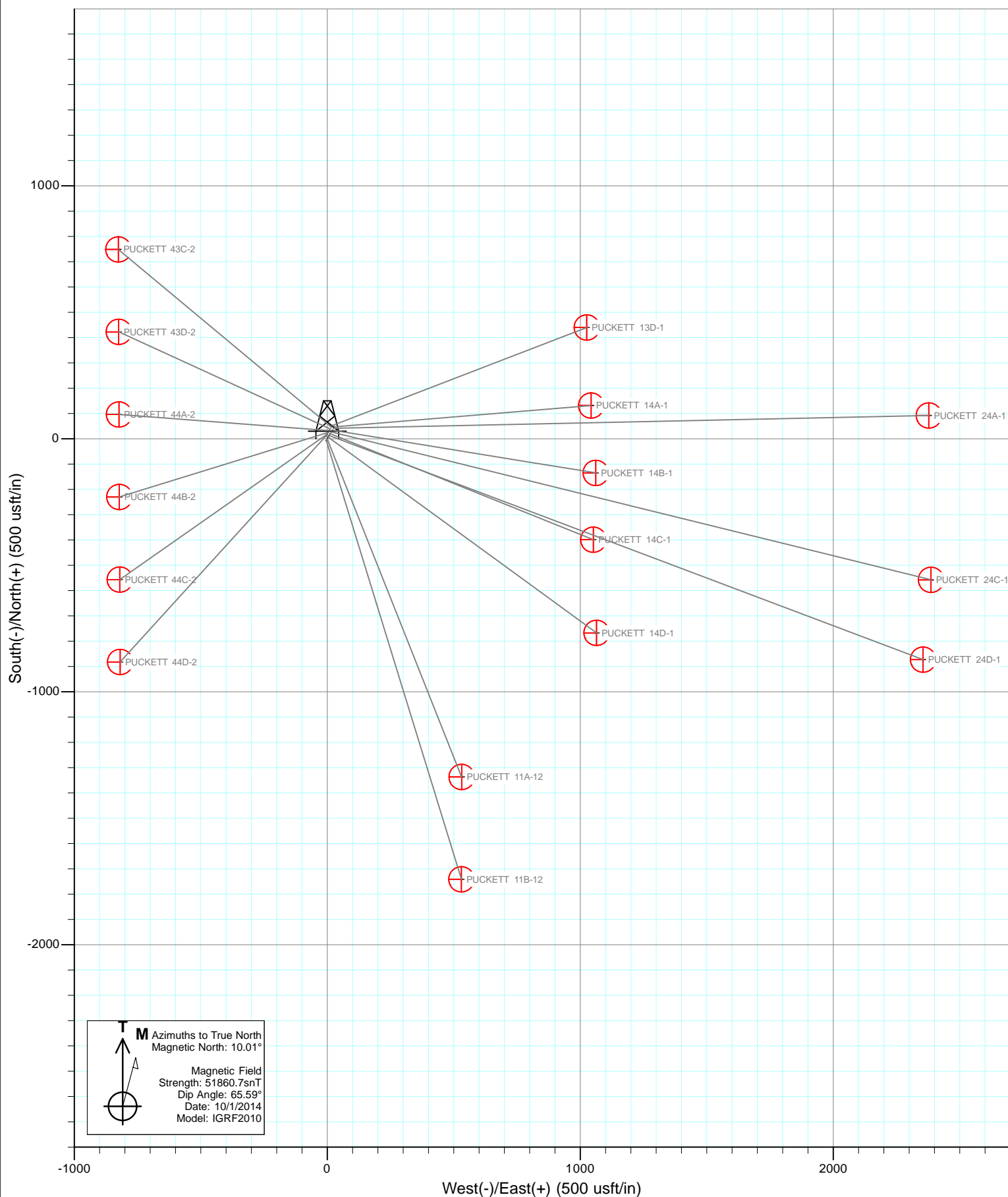



Cathedral Energy Services

Planning Report

Database:	USA EDM 5000 Multi Users DB	Local Co-ordinate Reference:	Well PUCKETT 14D-1
Company:	Caerus Oil & Gas (NAD 27)	TVD Reference:	KB=22' @ 8446.0usft
Project:	Garfield County, CO	MD Reference:	KB=22' @ 8446.0usft
Site:	S2-T7S-R97W (Puckett Pad P2)	North Reference:	True
Well:	PUCKETT 14D-1	Survey Calculation Method:	Minimum Curvature
Wellbore:	DD		
Design:	Plan #1		

Project	Garfield County, CO		
Map System:	US State Plane 1927 (Exact solution)	System Datum:	Mean Sea Level
Geo Datum:	NAD 1927 (NADCON CONUS)		
Map Zone:	Colorado Central 502		

Site		S2-T7S-R97W (Puckett Pad P2)			
Site Position:		Northing:	607,291.06 usft	Latitude:	39.470219
From:	Lat/Long	Easting:	1,243,933.75 usft	Longitude:	-108.178519
Position Uncertainty:	0.0 usft	Slot Radius:	13-3/16"	Grid Convergence:	-1.69 °

Well	PUCKETT 14D-1					
Well Position	+N/-S	0.0 usft	Northing:	607,304.30 usft	Latitude:	39.470256
	+E/-W	0.0 usft	Easting:	1,243,941.77 usft	Longitude:	-108.178492
Position Uncertainty		0.0 usft	Wellhead Elevation:	0.0 usft	Ground Level:	8,424.0 usft

Wellbore	DD				
Magnetics	Model Name	Sample Date	Declination (°)	Dip Angle (°)	Field Strength (nT)
	IGRF2010	10/1/2014	10.00	65.59	51,861

Design	Plan #1			
Audit Notes:				
Version:	Phase:	PLAN	Tie On Depth:	0.0
Vertical Section:	Depth From (TVD) (usft)	+N/-S (usft)	+E/-W (usft)	Direction (°)
	0.0	0.0	0.0	126.10

Plan Sections										
Measured Depth (usft)	Inclination (°)	Azimuth (°)	Vertical Depth (usft)	+N/-S (usft)	+E/-W (usft)	Dogleg Rate (°/100usft)	Build Rate (°/100usft)	Turn Rate (°/100usft)	TFO (°)	Target
0.0	0.00	0.00	0.0	0.0	0.0	0.00	0.00	0.00	0.00	
300.0	0.00	0.00	300.0	0.0	0.0	0.00	0.00	0.00	0.00	
674.3	11.23	126.10	671.9	-21.5	29.5	3.00	3.00	0.00	126.10	
7,038.3	11.23	126.10	6,914.1	-751.7	1,030.9	0.00	0.00	0.00	0.00	
7,412.6	0.00	0.00	7,286.0	-773.2	1,060.4	3.00	-3.00	0.00	180.00	PUCKETT 14D-1 TG1
8,907.6	0.00	0.00	8,781.0	-773.2	1,060.4	0.00	0.00	0.00	0.00	PUCKETT 14D-1 BHL

Cathedral Energy Services

Planning Report

Database:	USA EDM 5000 Multi Users DB	Local Co-ordinate Reference:	Well PUCKETT 14D-1
Company:	Caerus Oil & Gas (NAD 27)	TVD Reference:	KB=22' @ 8446.0usft
Project:	Garfield County, CO	MD Reference:	KB=22' @ 8446.0usft
Site:	S2-T7S-R97W (Puckett Pad P2)	North Reference:	True
Well:	PUCKETT 14D-1	Survey Calculation Method:	Minimum Curvature
Wellbore:	DD		
Design:	Plan #1		

Planned Survey

Measured Depth (usft)	Inclination (°)	Azimuth (°)	Vertical Depth (usft)	+N/-S (usft)	+E/-W (usft)	Vertical Section (usft)	Dogleg Rate (°/100usft)	Build Rate (°/100u)	Comments / Formations
0.0	0.00	0.00	0.0	0.0	0.0	0.0	0.00	0.00	
100.0	0.00	0.00	100.0	0.0	0.0	0.0	0.00	0.00	
200.0	0.00	0.00	200.0	0.0	0.0	0.0	0.00	0.00	
300.0	0.00	0.00	300.0	0.0	0.0	0.0	0.00	0.00	KOP @ 300'
400.0	3.00	126.10	400.0	-1.5	2.1	2.6	3.00	3.00	
500.0	6.00	126.10	499.6	-6.2	8.5	10.5	3.00	3.00	
600.0	9.00	126.10	598.8	-13.9	19.0	23.5	3.00	3.00	
674.3	11.23	126.10	671.9	-21.5	29.5	36.6	3.00	3.00	EOB @ 11.23° INC
700.0	11.23	126.10	697.1	-24.5	33.6	41.6	0.00	0.00	
800.0	11.23	126.10	795.2	-36.0	49.3	61.0	0.00	0.00	
900.0	11.23	126.10	893.3	-47.4	65.1	80.5	0.00	0.00	
1,000.0	11.23	126.10	991.4	-58.9	80.8	100.0	0.00	0.00	
1,100.0	11.23	126.10	1,089.5	-70.4	96.5	119.5	0.00	0.00	
1,200.0	11.23	126.10	1,187.5	-81.9	112.3	138.9	0.00	0.00	
1,300.0	11.23	126.10	1,285.6	-93.3	128.0	158.4	0.00	0.00	
1,400.0	11.23	126.10	1,383.7	-104.8	143.7	177.9	0.00	0.00	
1,500.0	11.23	126.10	1,481.8	-116.3	159.5	197.3	0.00	0.00	
1,600.0	11.23	126.10	1,579.9	-127.7	175.2	216.8	0.00	0.00	
1,700.0	11.23	126.10	1,678.0	-139.2	190.9	236.3	0.00	0.00	
1,800.0	11.23	126.10	1,776.1	-150.7	206.7	255.8	0.00	0.00	
1,900.0	11.23	126.10	1,874.1	-162.2	222.4	275.2	0.00	0.00	
2,000.0	11.23	126.10	1,972.2	-173.6	238.1	294.7	0.00	0.00	
2,100.0	11.23	126.10	2,070.3	-185.1	253.9	314.2	0.00	0.00	
2,200.0	11.23	126.10	2,168.4	-196.6	269.6	333.7	0.00	0.00	
2,300.0	11.23	126.10	2,266.5	-208.1	285.3	353.1	0.00	0.00	
2,400.0	11.23	126.10	2,364.6	-219.5	301.1	372.6	0.00	0.00	
2,500.0	11.23	126.10	2,462.7	-231.0	316.8	392.1	0.00	0.00	
2,600.0	11.23	126.10	2,560.7	-242.5	332.5	411.5	0.00	0.00	
2,700.0	11.23	126.10	2,658.8	-254.0	348.3	431.0	0.00	0.00	
2,800.0	11.23	126.10	2,756.9	-265.4	364.0	450.5	0.00	0.00	
2,900.0	11.23	126.10	2,855.0	-276.9	379.7	470.0	0.00	0.00	
3,000.0	11.23	126.10	2,953.1	-288.4	395.5	489.4	0.00	0.00	
3,100.0	11.23	126.10	3,051.2	-299.8	411.2	508.9	0.00	0.00	
3,200.0	11.23	126.10	3,149.3	-311.3	426.9	528.4	0.00	0.00	
3,300.0	11.23	126.10	3,247.3	-322.8	442.7	547.9	0.00	0.00	
3,400.0	11.23	126.10	3,345.4	-334.3	458.4	567.3	0.00	0.00	
3,500.0	11.23	126.10	3,443.5	-345.7	474.1	586.8	0.00	0.00	
3,600.0	11.23	126.10	3,541.6	-357.2	489.9	606.3	0.00	0.00	
3,700.0	11.23	126.10	3,639.7	-368.7	505.6	625.7	0.00	0.00	
3,800.0	11.23	126.10	3,737.8	-380.2	521.3	645.2	0.00	0.00	
3,900.0	11.23	126.10	3,835.9	-391.6	537.1	664.7	0.00	0.00	
4,000.0	11.23	126.10	3,933.9	-403.1	552.8	684.2	0.00	0.00	
4,100.0	11.23	126.10	4,032.0	-414.6	568.5	703.6	0.00	0.00	
4,200.0	11.23	126.10	4,130.1	-426.0	584.3	723.1	0.00	0.00	
4,300.0	11.23	126.10	4,228.2	-437.5	600.0	742.6	0.00	0.00	
4,400.0	11.23	126.10	4,326.3	-449.0	615.7	762.1	0.00	0.00	
4,500.0	11.23	126.10	4,424.4	-460.5	631.5	781.5	0.00	0.00	
4,600.0	11.23	126.10	4,522.5	-471.9	647.2	801.0	0.00	0.00	
4,700.0	11.23	126.10	4,620.5	-483.4	662.9	820.5	0.00	0.00	
4,800.0	11.23	126.10	4,718.6	-494.9	678.7	839.9	0.00	0.00	
4,900.0	11.23	126.10	4,816.7	-506.4	694.4	859.4	0.00	0.00	
5,000.0	11.23	126.10	4,914.8	-517.8	710.1	878.9	0.00	0.00	

Cathedral Energy Services

Planning Report

Database:	USA EDM 5000 Multi Users DB	Local Co-ordinate Reference:	Well PUCKETT 14D-1
Company:	Caerus Oil & Gas (NAD 27)	TVD Reference:	KB=22' @ 8446.0usft
Project:	Garfield County, CO	MD Reference:	KB=22' @ 8446.0usft
Site:	S2-T7S-R97W (Puckett Pad P2)	North Reference:	True
Well:	PUCKETT 14D-1	Survey Calculation Method:	Minimum Curvature
Wellbore:	DD		
Design:	Plan #1		

Planned Survey

Measured Depth (usft)	Inclination (°)	Azimuth (°)	Vertical Depth (usft)	+N/-S (usft)	+E/-W (usft)	Vertical Section (usft)	Dogleg Rate (°/100usft)	Build Rate (°/100u)	Comments / Formations
5,100.0	11.23	126.10	5,012.9	-529.3	725.9	898.4	0.00	0.00	
5,200.0	11.23	126.10	5,111.0	-540.8	741.6	917.8	0.00	0.00	
5,300.0	11.23	126.10	5,209.1	-552.3	757.3	937.3	0.00	0.00	
5,400.0	11.23	126.10	5,307.1	-563.7	773.1	956.8	0.00	0.00	
5,500.0	11.23	126.10	5,405.2	-575.2	788.8	976.3	0.00	0.00	
5,600.0	11.23	126.10	5,503.3	-586.7	804.5	995.7	0.00	0.00	
5,700.0	11.23	126.10	5,601.4	-598.1	820.3	1,015.2	0.00	0.00	
5,800.0	11.23	126.10	5,699.5	-609.6	836.0	1,034.7	0.00	0.00	
5,900.0	11.23	126.10	5,797.6	-621.1	851.8	1,054.1	0.00	0.00	
5,949.4	11.23	126.10	5,846.0	-626.8	859.5	1,063.8	0.00	0.00	OHIO CREEK
6,000.0	11.23	126.10	5,895.7	-632.6	867.5	1,073.6	0.00	0.00	
6,100.0	11.23	126.10	5,993.7	-644.0	883.2	1,093.1	0.00	0.00	
6,200.0	11.23	126.10	6,091.8	-655.5	899.0	1,112.6	0.00	0.00	
6,300.0	11.23	126.10	6,189.9	-667.0	914.7	1,132.0	0.00	0.00	
6,400.0	11.23	126.10	6,288.0	-678.5	930.4	1,151.5	0.00	0.00	
6,494.8	11.23	126.10	6,381.0	-689.3	945.3	1,170.0	0.00	0.00	WILLIAMS FORK
6,500.0	11.23	126.10	6,386.1	-689.9	946.2	1,171.0	0.00	0.00	
6,600.0	11.23	126.10	6,484.2	-701.4	961.9	1,190.5	0.00	0.00	
6,700.0	11.23	126.10	6,582.3	-712.9	977.6	1,209.9	0.00	0.00	
6,800.0	11.23	126.10	6,680.3	-724.3	993.4	1,229.4	0.00	0.00	
6,900.0	11.23	126.10	6,778.4	-735.8	1,009.1	1,248.9	0.00	0.00	
7,000.0	11.23	126.10	6,876.5	-747.3	1,024.8	1,268.3	0.00	0.00	
7,038.3	11.23	126.10	6,914.1	-751.7	1,030.9	1,275.8	0.00	0.00	Start 3° Drop
7,100.0	9.38	126.10	6,974.8	-758.2	1,039.8	1,286.8	3.00	-3.00	
7,200.0	6.38	126.10	7,073.8	-766.3	1,050.8	1,300.5	3.00	-3.00	
7,300.0	3.38	126.10	7,173.5	-771.3	1,057.7	1,309.1	3.00	-3.00	
7,400.0	0.38	126.10	7,273.4	-773.2	1,060.4	1,312.3	3.00	-3.00	
7,412.6	0.00	0.00	7,286.0	-773.2	1,060.4	1,312.4	3.00	-3.00	EOD @ 0° INC - TOG
7,500.0	0.00	0.00	7,373.4	-773.2	1,060.4	1,312.4	0.00	0.00	
7,600.0	0.00	0.00	7,473.4	-773.2	1,060.4	1,312.4	0.00	0.00	
7,700.0	0.00	0.00	7,573.4	-773.2	1,060.4	1,312.4	0.00	0.00	
7,800.0	0.00	0.00	7,673.4	-773.2	1,060.4	1,312.4	0.00	0.00	
7,900.0	0.00	0.00	7,773.4	-773.2	1,060.4	1,312.4	0.00	0.00	
8,000.0	0.00	0.00	7,873.4	-773.2	1,060.4	1,312.4	0.00	0.00	
8,100.0	0.00	0.00	7,973.4	-773.2	1,060.4	1,312.4	0.00	0.00	
8,200.0	0.00	0.00	8,073.4	-773.2	1,060.4	1,312.4	0.00	0.00	
8,300.0	0.00	0.00	8,173.4	-773.2	1,060.4	1,312.4	0.00	0.00	
8,372.6	0.00	0.00	8,246.0	-773.2	1,060.4	1,312.4	0.00	0.00	CAMEO
8,400.0	0.00	0.00	8,273.4	-773.2	1,060.4	1,312.4	0.00	0.00	
8,500.0	0.00	0.00	8,373.4	-773.2	1,060.4	1,312.4	0.00	0.00	
8,600.0	0.00	0.00	8,473.4	-773.2	1,060.4	1,312.4	0.00	0.00	
8,700.0	0.00	0.00	8,573.4	-773.2	1,060.4	1,312.4	0.00	0.00	
8,757.6	0.00	0.00	8,631.0	-773.2	1,060.4	1,312.4	0.00	0.00	ROLLINS
8,800.0	0.00	0.00	8,673.4	-773.2	1,060.4	1,312.4	0.00	0.00	
8,907.6	0.00	0.00	8,781.0	-773.2	1,060.4	1,312.4	0.00	0.00	TD @ 8,907.6' MD

Cathedral Energy Services

Planning Report

Database:	USA EDM 5000 Multi Users DB	Local Co-ordinate Reference:	Well PUCKETT 14D-1
Company:	Caerus Oil & Gas (NAD 27)	TVD Reference:	KB=22' @ 8446.0usft
Project:	Garfield County, CO	MD Reference:	KB=22' @ 8446.0usft
Site:	S2-T7S-R97W (Puckett Pad P2)	North Reference:	True
Well:	PUCKETT 14D-1	Survey Calculation Method:	Minimum Curvature
Wellbore:	DD		
Design:	Plan #1		

Targets									
Target Name									
- hit/miss target	Dip Angle	Dip Dir.	TVD	+N/-S	+E/-W	Northing	Easting	Latitude	Longitude
- Shape	(°)	(°)	(usft)	(usft)	(usft)	(usft)	(usft)		
PUCKETT 14D-1 BHL	0.00	0.00	8,781.0	-773.2	1,060.4	606,500.15	1,244,978.91	39.468133	-108.174736
- plan hits target center									
- Circle (radius 50.0)									
PUCKETT 14D-1 TGT	0.00	0.00	7,286.0	-773.2	1,060.4	606,500.15	1,244,978.91	39.468133	-108.174736
- plan hits target center									
- Point									

Formations						
Measured Depth	Vertical Depth	Name	Lithology	Dip	Dip Direction	
(usft)	(usft)			(°)	(°)	
5,949.4	5,846.0	OHIO CREEK				
6,494.8	6,381.0	WILLIAMS FORK				
7,412.6	7,286.0	TOG				
8,372.6	8,246.0	CAMEO				
8,757.6	8,631.0	ROLLINS				

Plan Annotations					
Measured Depth	Vertical Depth	Local Coordinates			
(usft)	(usft)	+N/-S	+E/-W	Comment	
(usft)	(usft)	(usft)	(usft)		
300.0	300.0	0.0	0.0	KOP @ 300'	
674.3	671.9	-21.5	29.5	EOB @ 11.23° INC	
7,038.3	6,914.1	-751.7	1,030.9	Start 3° Drop	
7,412.6	7,286.0	-773.2	1,060.4	EOD @ 0° INC	
8,907.6	8,781.0	-773.2	1,060.4	TD @ 8,907.6' MD	

Caerus Oil & Gas (NAD 27)

Garfield County, CO

S2-T7S-R97W (Puckett Pad P2)

PUCKETT 14D-1

DD

Plan #1

Anticollision Report

01 October, 2014

Cathedral Energy Services

Anticollision Report

Company:	Caerus Oil & Gas (NAD 27)	Local Co-ordinate Reference:	Well PUCKETT 14D-1
Project:	Garfield County, CO	TVD Reference:	KB=22' @ 8446.0usft
Reference Site:	S2-T7S-R97W (Puckett Pad P2)	MD Reference:	KB=22' @ 8446.0usft
Site Error:	0.0usft	North Reference:	True
Reference Well:	PUCKETT 14D-1	Survey Calculation Method:	Minimum Curvature
Well Error:	0.0usft	Output errors are at	2.00 sigma
Reference Wellbore	DD	Database:	USA EDM 5000 Multi Users DB
Reference Design:	Plan #1	Offset TVD Reference:	Offset Datum

Reference	Plan #1		
Filter type:	NO GLOBAL FILTER: Using user defined selection & filtering criteria		
Interpolation Method:	MD Interval 100.0usft	Error Model:	ISCWSA
Depth Range:	Unlimited	Scan Method:	Closest Approach 3D
Results Limited by:	Maximum center-center distance of 200.0usft	Error Surface:	Elliptical Conic
Warning Levels Evaluated at:	2.00 Sigma		

Survey Tool Program		Date	10/1/2014		
From (usft)	To (usft)	Survey (Wellbore)	Tool Name	Description	
0.0	8,907.6	Plan #1 (DD)	ISCWSA MWD	MWD - Standard	

Summary						
Site Name	Reference Measured Depth (usft)	Offset Measured Depth (usft)	Distance Between Centres (usft)	Distance Between Ellipses (usft)	Separation Factor	Warning
S2-T7S-R97W (Puckett Pad P2)						
PUCKETT 11A-12 - DD - Plan #1	236.0	236.0	7.3	6.6	9.340	CC, ES
PUCKETT 11A-12 - DD - Plan #1	300.0	299.9	7.7	6.7	7.298	SF
PUCKETT 11B-12 - DD - Plan #1	200.0	200.0	15.5	14.9	24.791	CC, ES
PUCKETT 11B-12 - DD - Plan #1	400.0	398.3	22.9	21.4	15.308	SF
PUCKETT 13D-1 - DD - Plan #1	200.0	200.0	48.9	48.3	78.220	CC, ES
PUCKETT 13D-1 - DD - Plan #1	1,300.0	1,282.8	198.1	190.7	26.632	SF
PUCKETT 14A-1 - DD - Plan #1	300.0	300.0	47.8	46.7	44.473	CC
PUCKETT 14A-1 - DD - Plan #1	400.0	400.0	48.1	46.6	31.912	ES
PUCKETT 14A-1 - DD - Plan #1	1,700.0	1,687.8	194.2	184.2	19.347	SF
PUCKETT 14B-1 - DD - Plan #1	300.0	300.0	32.6	31.5	30.361	CC
PUCKETT 14B-1 - DD - Plan #1	400.0	400.0	33.0	31.5	21.864	ES
PUCKETT 14B-1 - DD - Plan #1	2,300.0	2,292.2	192.1	177.4	13.090	SF
PUCKETT 14C-1 - DD - Plan #1	300.0	300.0	15.9	14.9	14.835	CC, ES
PUCKETT 14C-1 - DD - Plan #1	3,900.0	3,895.7	194.8	168.2	7.346	SF
PUCKETT 24A-1 - DD - Plan #1	300.0	300.0	40.9	39.8	38.066	CC, ES
PUCKETT 24A-1 - DD - Plan #1	900.0	887.8	93.8	89.0	19.419	SF
PUCKETT 24C-1 - DD - Plan #1	236.0	236.0	24.2	23.4	30.789	CC
PUCKETT 24C-1 - DD - Plan #1	300.0	299.8	24.4	23.3	22.869	ES
PUCKETT 24C-1 - DD - Plan #1	800.0	794.6	54.4	50.3	13.267	SF
PUCKETT 24D-1 - DD - Plan #1	200.0	200.0	8.0	7.3	12.754	CC, ES
PUCKETT 24D-1 - DD - Plan #1	300.0	299.8	8.8	7.7	8.236	SF
PUCKETT 43C-2 - DD - Plan #1	255.6	255.6	42.1	41.3	48.154	CC
PUCKETT 43C-2 - DD - Plan #1	300.0	299.8	42.2	41.1	39.329	ES
PUCKETT 43C-2 - DD - Plan #1	500.0	495.5	55.3	53.2	26.631	SF
PUCKETT 43D-2 - DD - Plan #1	300.0	300.0	34.1	33.0	31.715	CC, ES
PUCKETT 43D-2 - DD - Plan #1	500.0	497.6	43.3	41.2	21.044	SF
PUCKETT 44A-2 - DD - Plan #1	300.0	300.0	26.5	25.4	24.680	CC, ES
PUCKETT 44A-2 - DD - Plan #1	500.0	499.0	33.8	31.7	16.518	SF
PUCKETT 44B-2 - DD - Plan #1	300.0	300.0	18.9	17.9	17.632	CC, ES
PUCKETT 44B-2 - DD - Plan #1	400.0	400.1	20.5	18.9	13.358	SF
PUCKETT 44C-2 - DD - Plan #1	309.1	309.1	12.8	11.7	11.534	CC, ES
PUCKETT 44C-2 - DD - Plan #1	400.0	399.9	15.0	13.5	9.731	SF
PUCKETT 44D-2 - DD - Plan #1	218.3	218.3	10.3	9.6	14.543	CC
PUCKETT 44D-2 - DD - Plan #1	300.0	299.9	10.6	9.5	9.975	ES, SF

CC - Min centre to center distance or convergent point, SF - min separation factor, ES - min ellipse separation

Cathedral Energy Services

Anticollision Report

Company:	Caerus Oil & Gas (NAD 27)	Local Co-ordinate Reference:	Well PUCKETT 14D-1
Project:	Garfield County, CO	TVD Reference:	KB=22' @ 8446.0usft
Reference Site:	S2-T7S-R97W (Puckett Pad P2)	MD Reference:	KB=22' @ 8446.0usft
Site Error:	0.0usft	North Reference:	True
Reference Well:	PUCKETT 14D-1	Survey Calculation Method:	Minimum Curvature
Well Error:	0.0usft	Output errors are at	2.00 sigma
Reference Wellbore	DD	Database:	USA EDM 5000 Multi Users DB
Reference Design:	Plan #1	Offset TVD Reference:	Offset Datum

Offset Design S2-T7S-R97W (Puckett Pad P2) - PUCKETT 11A-12 - DD - Plan #1													Offset Site Error:	0.0 usft
Survey Program: 0-ISCWSA MWD													Offset Well Error:	0.0 usft
Reference		Offset		Semi Major Axis		Highside Toolface (°)	Distance		Total Uncertainty Axis	Separation Factor	Warning			
Measured Depth (usft)	Vertical Depth (usft)	Measured Depth (usft)	Vertical Depth (usft)	Reference (usft)	Offset (usft)		Between Centres (usft)	Between Ellipses (usft)						
0.0	0.0	0.0	0.0	0.0	0.0	-147.45	-6.2	-4.0	7.3					
100.0	100.0	100.0	100.0	0.1	0.1	-147.45	-6.2	-4.0	7.3	7.2	0.18	41.900		
200.0	200.0	200.0	200.0	0.3	0.3	-147.45	-6.2	-4.0	7.3	6.7	0.62	11.756		
236.0	236.0	236.0	236.0	0.4	0.4	-147.45	-6.2	-4.0	7.3	6.6	0.79	9.340 CC, ES		
300.0	300.0	299.9	299.9	0.5	0.5	-151.36	-6.8	-3.7	7.7	6.7	1.06	7.298 SF		
400.0	400.0	399.5	399.3	0.7	0.7	74.94	-11.6	-1.8	10.8	9.4	1.48	7.335		
500.0	499.6	498.8	498.1	1.0	1.0	76.54	-21.2	2.0	16.5	14.5	1.94	8.471		
600.0	598.8	597.7	595.8	1.2	1.3	80.46	-35.5	7.7	24.6	22.1	2.51	9.824		
700.0	697.1	696.6	692.6	1.6	1.7	84.44	-54.2	15.1	35.3	32.0	3.21	10.982		
800.0	795.2	795.9	789.7	2.0	2.1	87.47	-73.8	22.9	46.5	42.5	3.99	11.644		
900.0	893.3	895.3	886.7	2.4	2.5	89.31	-93.5	30.7	57.8	53.0	4.81	12.013		
1,000.0	991.4	994.6	983.8	2.8	3.0	90.55	-113.2	38.5	69.2	63.5	5.65	12.239		
1,100.0	1,089.5	1,093.9	1,080.9	3.2	3.4	91.44	-132.8	46.4	80.6	74.0	6.50	12.387		
1,200.0	1,187.5	1,193.3	1,177.9	3.6	3.9	92.10	-152.5	54.2	91.9	84.6	7.36	12.491		
1,300.0	1,285.6	1,292.6	1,275.0	4.1	4.3	92.63	-172.1	62.0	103.4	95.1	8.22	12.566		
1,400.0	1,383.7	1,392.0	1,372.0	4.5	4.8	93.04	-191.8	69.8	114.8	105.7	9.09	12.623		
1,500.0	1,481.8	1,491.3	1,469.1	4.9	5.2	93.39	-211.5	77.6	126.2	116.2	9.96	12.667		
1,600.0	1,579.9	1,590.7	1,566.2	5.3	5.7	93.67	-231.1	85.4	137.6	126.8	10.83	12.702		
1,700.0	1,678.0	1,690.0	1,663.2	5.8	6.2	93.91	-250.8	93.2	149.0	137.3	11.71	12.731		
1,800.0	1,776.1	1,789.4	1,760.3	6.2	6.6	94.12	-270.4	101.0	160.4	147.9	12.58	12.755		
1,900.0	1,874.1	1,888.7	1,857.4	6.6	7.1	94.30	-290.1	108.8	171.9	158.4	13.45	12.776		
2,000.0	1,972.2	1,988.0	1,954.4	7.1	7.5	94.46	-309.8	116.6	183.3	169.0	14.33	12.793		
2,100.0	2,070.3	2,087.4	2,051.5	7.5	8.0	94.60	-329.4	124.5	194.7	179.5	15.20	12.808		

Cathedral Energy Services

Anticollision Report

Company:	Caerus Oil & Gas (NAD 27)	Local Co-ordinate Reference:	Well PUCKETT 14D-1
Project:	Garfield County, CO	TVD Reference:	KB=22' @ 8446.0usft
Reference Site:	S2-T7S-R97W (Puckett Pad P2)	MD Reference:	KB=22' @ 8446.0usft
Site Error:	0.0usft	North Reference:	True
Reference Well:	PUCKETT 14D-1	Survey Calculation Method:	Minimum Curvature
Well Error:	0.0usft	Output errors are at	2.00 sigma
Reference Wellbore	DD	Database:	USA EDM 5000 Multi Users DB
Reference Design:	Plan #1	Offset TVD Reference:	Offset Datum

Offset Design S2-T7S-R97W (Puckett Pad P2) - PUCKETT 11B-12 - DD - Plan #1												Offset Site Error:	0.0 usft
Survey Program: 0-ISCSWA MWD												Offset Well Error:	0.0 usft
Reference		Offset		Semi Major Axis		Distance							
Measured Depth (usft)	Vertical Depth (usft)	Measured Depth (usft)	Vertical Depth (usft)	Reference (usft)	Offset (usft)	Highside Toolface (°)	Offset Wellbore Centre +N/-S (usft)	+E/-W (usft)	Between Centres (usft)	Between Ellipses (usft)	Total Uncertainty Axis	Separation Factor	Warning
0.0	0.0	0.0	0.0	0.0	0.0	-150.52	-13.5	-7.6	15.5				
100.0	100.0	100.0	100.0	0.1	0.1	-150.52	-13.5	-7.6	15.5	15.3	0.18	88.359	
200.0	200.0	200.0	200.0	0.3	0.3	-150.52	-13.5	-7.6	15.5	14.9	0.62	24.791 CC, ES	
300.0	300.0	299.4	299.3	0.5	0.5	-156.73	-16.0	-6.9	17.4	16.3	1.05	16.526	
400.0	400.0	398.3	398.0	0.7	0.7	70.80	-23.3	-4.6	22.9	21.4	1.49	15.308 SF	
500.0	499.6	496.9	495.7	1.0	1.0	70.86	-35.5	-0.8	31.0	29.0	1.98	15.679	
600.0	598.8	594.8	592.0	1.2	1.4	73.51	-52.3	4.3	41.7	39.2	2.55	16.348	
700.0	697.1	691.9	686.5	1.6	1.8	76.72	-73.7	10.9	55.2	52.0	3.25	16.964	
800.0	795.2	790.0	781.1	2.0	2.3	78.00	-98.6	18.6	71.2	67.2	4.04	17.621	
900.0	893.3	888.7	876.2	2.4	2.8	78.74	-123.9	26.4	87.4	82.5	4.86	17.986	
1,000.0	991.4	987.4	971.3	2.8	3.4	79.25	-149.1	34.1	103.5	97.8	5.69	18.176	
1,100.0	1,089.5	1,086.1	1,066.3	3.2	3.9	79.62	-174.3	41.9	119.7	113.1	6.55	18.281	
1,200.0	1,187.5	1,184.8	1,161.4	3.6	4.4	79.91	-199.5	49.7	135.8	128.4	7.41	18.340	
1,300.0	1,285.6	1,283.5	1,256.5	4.1	5.0	80.13	-224.8	57.4	152.0	143.7	8.27	18.374	
1,400.0	1,383.7	1,382.1	1,351.6	4.5	5.5	80.31	-250.0	65.2	168.2	159.0	9.14	18.393	
1,500.0	1,481.8	1,480.8	1,446.7	4.9	6.1	80.46	-275.2	73.0	184.3	174.3	10.02	18.404	

Cathedral Energy Services

Anticollision Report

Company:	Caerus Oil & Gas (NAD 27)	Local Co-ordinate Reference:	Well PUCKETT 14D-1
Project:	Garfield County, CO	TVD Reference:	KB=22' @ 8446.0usft
Reference Site:	S2-T7S-R97W (Puckett Pad P2)	MD Reference:	KB=22' @ 8446.0usft
Site Error:	0.0usft	North Reference:	True
Reference Well:	PUCKETT 14D-1	Survey Calculation Method:	Minimum Curvature
Well Error:	0.0usft	Output errors are at	2.00 sigma
Reference Wellbore	DD	Database:	USA EDM 5000 Multi Users DB
Reference Design:	Plan #1	Offset TVD Reference:	Offset Datum

Offset Design S2-T7S-R97W (Puckett Pad P2) - PUCKETT 13D-1 - DD - Plan #1													Offset Site Error: 0.0 usft	
Survey Program: 0-ISCSWA MWD													Offset Well Error: 0.0 usft	
Reference		Offset		Semi Major Axis			Distance							Warning
Measured Depth (usft)	Vertical Depth (usft)	Measured Depth (usft)	Vertical Depth (usft)	Reference (usft)	Offset (usft)	Highside Toolface (°)	Offset Wellbore Centre +N/-S (usft)	+E/-W (usft)	Between Centres (usft)	Between Ellipses (usft)	Total Uncertainty Axis	Separation Factor		
0.0	0.0	0.0	0.0	0.0	0.0	18.87	46.2	15.8	48.9					
100.0	100.0	100.0	100.0	0.1	0.1	18.87	46.2	15.8	48.9	48.7	0.18	278.783		
200.0	200.0	200.0	200.0	0.3	0.3	18.87	46.2	15.8	48.9	48.3	0.62	78.220	CC, ES	
300.0	300.0	298.2	298.2	0.5	0.5	19.45	47.3	16.7	50.2	49.1	1.07	46.913		
400.0	400.0	395.4	395.2	0.7	0.8	-106.72	52.1	20.7	56.9	55.4	1.53	37.157		
500.0	499.6	493.8	493.0	1.0	1.0	-108.58	59.4	28.3	68.8	66.8	2.02	34.050		
600.0	598.8	592.9	591.0	1.2	1.3	-109.70	65.6	40.8	82.7	80.2	2.56	32.298		
700.0	697.1	691.5	688.5	1.6	1.6	-111.92	71.0	55.4	98.4	95.2	3.20	30.705		
800.0	795.2	790.1	785.8	2.0	2.0	-114.43	76.5	70.0	114.7	110.8	3.88	29.585		
900.0	893.3	888.6	883.1	2.4	2.3	-116.32	81.9	84.5	131.2	126.7	4.57	28.697		
1,000.0	991.4	987.2	980.4	2.8	2.7	-117.78	87.4	99.0	147.9	142.6	5.28	27.998		
1,100.0	1,089.5	1,085.7	1,077.7	3.2	3.0	-118.95	92.9	113.6	164.6	158.6	6.00	27.445		
1,200.0	1,187.5	1,184.3	1,175.1	3.6	3.4	-119.90	98.3	128.1	181.3	174.6	6.72	26.998		
1,300.0	1,285.6	1,282.8	1,272.4	4.1	3.7	-120.70	103.8	142.7	198.1	190.7	7.44	26.632	SF	

Cathedral Energy Services

Anticollision Report

Company:	Caerus Oil & Gas (NAD 27)	Local Co-ordinate Reference:	Well PUCKETT 14D-1
Project:	Garfield County, CO	TVD Reference:	KB=22' @ 8446.0usft
Reference Site:	S2-T7S-R97W (Puckett Pad P2)	MD Reference:	KB=22' @ 8446.0usft
Site Error:	0.0usft	North Reference:	True
Reference Well:	PUCKETT 14D-1	Survey Calculation Method:	Minimum Curvature
Well Error:	0.0usft	Output errors are at	2.00 sigma
Reference Wellbore	DD	Database:	USA EDM 5000 Multi Users DB
Reference Design:	Plan #1	Offset TVD Reference:	Offset Datum

Offset Design S2-T7S-R97W (Puckett Pad P2) - PUCKETT 14A-1 - DD - Plan #1													Offset Site Error: 0.0 usft	
Survey Program: 0-ISCSWA MWD													Offset Well Error: 0.0 usft	
Reference		Offset		Semi Major Axis			Distance							Warning
Measured Depth (usft)	Vertical Depth (usft)	Measured Depth (usft)	Vertical Depth (usft)	Reference (usft)	Offset (usft)	Highside Toolface (°)	Offset Wellbore Centre +N/-S (usft)	+E/-W (usft)	Between Centres (usft)	Between Ellipses (usft)	Total Uncertainty Axis	Separation Factor		
0.0	0.0	0.0	0.0	0.0	0.0	30.54	41.2	24.3	47.8					
100.0	100.0	100.0	100.0	0.1	0.1	30.54	41.2	24.3	47.8	47.6	0.18	272.542		
200.0	200.0	200.0	200.0	0.3	0.3	30.54	41.2	24.3	47.8	47.2	0.62	76.469		
300.0	300.0	300.0	300.0	0.5	0.5	30.54	41.2	24.3	47.8	46.7	1.07	44.473 CC		
400.0	400.0	400.0	400.0	0.7	0.8	-98.65	41.2	24.3	48.1	46.6	1.51	31.912 ES		
500.0	499.6	499.1	499.1	1.0	1.0	-106.80	41.2	24.9	50.1	48.2	1.96	25.625		
600.0	598.8	597.7	597.6	1.2	1.2	-114.47	41.6	30.0	56.6	54.1	2.47	22.881		
700.0	697.1	696.2	695.6	1.6	1.4	-119.85	42.5	40.1	67.3	64.2	3.07	21.937		
800.0	795.2	795.1	793.4	2.0	1.7	-121.58	43.7	54.6	79.8	76.1	3.69	21.654		
900.0	893.3	894.3	891.4	2.4	2.0	-122.47	44.9	69.8	92.5	88.2	4.34	21.295		
1,000.0	991.4	993.5	989.4	2.8	2.3	-123.14	46.2	85.0	105.2	100.2	5.03	20.934		
1,100.0	1,089.5	1,092.7	1,087.4	3.2	2.7	-123.67	47.4	100.1	117.9	112.2	5.72	20.605		
1,200.0	1,187.5	1,191.9	1,185.4	3.6	3.0	-124.10	48.7	115.3	130.6	124.2	6.43	20.316		
1,300.0	1,285.6	1,291.1	1,283.4	4.1	3.4	-124.45	50.0	130.5	143.3	136.2	7.14	20.065		
1,400.0	1,383.7	1,390.2	1,381.4	4.5	3.7	-124.74	51.2	145.6	156.0	148.2	7.86	19.847		
1,500.0	1,481.8	1,489.4	1,479.4	4.9	4.1	-124.99	52.5	160.8	168.8	160.2	8.59	19.658		
1,600.0	1,579.9	1,588.6	1,577.4	5.3	4.4	-125.20	53.7	176.0	181.5	172.2	9.31	19.492		
1,700.0	1,678.0	1,687.8	1,675.4	5.8	4.8	-125.39	55.0	191.2	194.2	184.2	10.04	19.347 SF		

Cathedral Energy Services

Anticollision Report

Company:	Caerus Oil & Gas (NAD 27)	Local Co-ordinate Reference:	Well PUCKETT 14D-1
Project:	Garfield County, CO	TVD Reference:	KB=22' @ 8446.0usft
Reference Site:	S2-T7S-R97W (Puckett Pad P2)	MD Reference:	KB=22' @ 8446.0usft
Site Error:	0.0usft	North Reference:	True
Reference Well:	PUCKETT 14D-1	Survey Calculation Method:	Minimum Curvature
Well Error:	0.0usft	Output errors are at	2.00 sigma
Reference Wellbore	DD	Database:	USA EDM 5000 Multi Users DB
Reference Design:	Plan #1	Offset TVD Reference:	Offset Datum

Offset Design S2-T7S-R97W (Puckett Pad P2) - PUCKETT 14B-1 - DD - Plan #1													Offset Site Error: 0.0 usft	
Survey Program: 0-ISCSWA MWD													Offset Well Error: 0.0 usft	
Reference		Offset		Semi Major Axis			Distance							Warning
Measured Depth (usft)	Vertical Depth (usft)	Measured Depth (usft)	Vertical Depth (usft)	Reference (usft)	Offset (usft)	Highside Toolface (°)	Offset Wellbore Centre +N/-S (usft)	+E/-W (usft)	Between Centres (usft)	Between Ellipses (usft)	Total Uncertainty Axis	Separation Factor		
0.0	0.0	0.0	0.0	0.0	0.0	30.71	28.0	16.7	32.6					
100.0	100.0	100.0	100.0	0.1	0.1	30.71	28.0	16.7	32.6	32.4	0.18	186.056		
200.0	200.0	200.0	200.0	0.3	0.3	30.71	28.0	16.7	32.6	32.0	0.62	52.203		
300.0	300.0	300.0	300.0	0.5	0.5	30.71	28.0	16.7	32.6	31.5	1.07	30.361 CC		
400.0	400.0	400.0	400.0	0.7	0.8	-99.91	28.0	16.7	33.0	31.5	1.51	21.864 ES		
500.0	499.6	499.4	499.4	1.0	1.0	-108.31	27.6	19.2	35.5	33.5	1.95	18.152		
600.0	598.8	599.0	598.6	1.2	1.2	-114.72	26.4	26.9	41.0	38.5	2.48	16.566		
700.0	697.1	698.6	697.4	1.6	1.5	-118.60	24.3	39.7	49.2	46.1	3.09	15.927		
800.0	795.2	798.2	795.8	2.0	1.8	-119.92	21.8	55.2	58.1	54.3	3.73	15.546		
900.0	893.3	897.8	894.1	2.4	2.1	-120.89	19.3	70.7	66.9	62.5	4.42	15.161		
1,000.0	991.4	997.4	992.5	2.8	2.4	-121.63	16.7	86.2	75.9	70.7	5.12	14.824		
1,100.0	1,089.5	1,097.0	1,090.8	3.2	2.8	-122.22	14.2	101.7	84.8	79.0	5.83	14.538		
1,200.0	1,187.5	1,196.6	1,189.2	3.6	3.1	-122.69	11.7	117.3	93.7	87.2	6.55	14.298		
1,300.0	1,285.6	1,296.2	1,287.5	4.1	3.5	-123.08	9.2	132.8	102.6	95.4	7.28	14.095		
1,400.0	1,383.7	1,395.8	1,385.8	4.5	3.9	-123.41	6.7	148.3	111.6	103.6	8.01	13.923		
1,500.0	1,481.8	1,495.4	1,484.2	4.9	4.2	-123.69	4.1	163.8	120.5	111.8	8.75	13.775		
1,600.0	1,579.9	1,595.0	1,582.5	5.3	4.6	-123.93	1.6	179.4	129.5	120.0	9.49	13.647		
1,700.0	1,678.0	1,694.6	1,680.9	5.8	4.9	-124.14	-0.9	194.9	138.4	128.2	10.23	13.536		
1,800.0	1,776.1	1,794.2	1,779.2	6.2	5.3	-124.32	-3.4	210.4	147.4	136.4	10.97	13.438		
1,900.0	1,874.1	1,893.8	1,877.6	6.6	5.7	-124.49	-5.9	225.9	156.3	144.6	11.71	13.352		
2,000.0	1,972.2	1,993.4	1,975.9	7.1	6.0	-124.63	-8.5	241.5	165.3	152.8	12.45	13.275		
2,100.0	2,070.3	2,093.0	2,074.3	7.5	6.4	-124.76	-11.0	257.0	174.2	161.0	13.19	13.207		
2,200.0	2,168.4	2,192.6	2,172.6	8.0	6.8	-124.88	-13.5	272.5	183.2	169.2	13.93	13.145		
2,300.0	2,266.5	2,292.2	2,271.0	8.4	7.2	-124.99	-16.0	288.0	192.1	177.4	14.68	13.090 SF		

Cathedral Energy Services

Anticollision Report

Company:	Caerus Oil & Gas (NAD 27)	Local Co-ordinate Reference:	Well PUCKETT 14D-1
Project:	Garfield County, CO	TVD Reference:	KB=22' @ 8446.0usft
Reference Site:	S2-T7S-R97W (Puckett Pad P2)	MD Reference:	KB=22' @ 8446.0usft
Site Error:	0.0usft	North Reference:	True
Reference Well:	PUCKETT 14D-1	Survey Calculation Method:	Minimum Curvature
Well Error:	0.0usft	Output errors are at	2.00 sigma
Reference Wellbore	DD	Database:	USA EDM 5000 Multi Users DB
Reference Design:	Plan #1	Offset TVD Reference:	Offset Datum

Offset Design S2-T7S-R97W (Puckett Pad P2) - PUCKETT 14C-1 - DD - Plan #1													Offset Site Error: 0.0 usft	
Survey Program: 0-ISCSWA MWD													Offset Well Error: 0.0 usft	
Reference		Offset		Semi Major Axis			Distance							Warning
Measured Depth (usft)	Vertical Depth (usft)	Measured Depth (usft)	Vertical Depth (usft)	Reference (usft)	Offset (usft)	Highside Toolface (°)	Offset Wellbore Centre +N/-S (usft)	+E/-W (usft)	Between Centres (usft)	Between Ellipses (usft)	Total Uncertainty Axis	Separation Factor		
0.0	0.0	0.0	0.0	0.0	0.0	29.73	13.8	7.9	15.9					
100.0	100.0	100.0	100.0	0.1	0.1	29.73	13.8	7.9	15.9	15.8	0.18	90.915		
200.0	200.0	200.0	200.0	0.3	0.3	29.73	13.8	7.9	15.9	15.3	0.62	25.508		
300.0	300.0	300.0	300.0	0.5	0.5	29.73	13.8	7.9	15.9	14.9	1.07	14.835 CC, ES		
400.0	400.0	400.0	399.9	0.7	0.8	-103.18	13.6	8.5	16.4	14.9	1.50	10.953		
500.0	499.6	500.0	499.8	1.0	1.0	-110.63	11.6	13.4	18.5	16.5	1.94	9.506		
600.0	598.8	600.0	599.3	1.2	1.2	-115.36	7.7	23.1	22.0	19.5	2.48	8.855		
700.0	697.1	700.1	698.2	1.6	1.5	-117.89	2.0	37.4	26.8	23.6	3.12	8.582		
800.0	795.2	800.0	796.7	2.0	1.8	-119.73	-4.3	52.8	31.9	28.1	3.79	8.432		
900.0	893.3	899.8	895.1	2.4	2.2	-121.05	-10.5	68.3	37.1	32.7	4.48	8.286		
1,000.0	991.4	999.7	993.6	2.8	2.6	-122.05	-16.7	83.8	42.4	37.2	5.19	8.160		
1,100.0	1,089.5	1,099.6	1,092.0	3.2	2.9	-122.83	-22.9	99.2	47.6	41.7	5.91	8.054		
1,200.0	1,187.5	1,199.4	1,190.5	3.6	3.3	-123.46	-29.2	114.7	52.8	46.2	6.63	7.965		
1,300.0	1,285.6	1,299.3	1,289.0	4.1	3.7	-123.97	-35.4	130.2	58.1	50.7	7.36	7.890		
1,400.0	1,383.7	1,399.1	1,387.4	4.5	4.1	-124.40	-41.6	145.6	63.3	55.2	8.09	7.827		
1,500.0	1,481.8	1,499.0	1,485.9	4.9	4.4	-124.76	-47.9	161.1	68.5	59.7	8.82	7.772		
1,600.0	1,579.9	1,598.9	1,584.3	5.3	4.8	-125.07	-54.1	176.6	73.8	64.2	9.55	7.725		
1,700.0	1,678.0	1,698.7	1,682.8	5.8	5.2	-125.34	-60.3	192.0	79.0	68.8	10.29	7.684		
1,800.0	1,776.1	1,798.6	1,781.3	6.2	5.6	-125.57	-66.6	207.5	84.3	73.3	11.02	7.648		
1,900.0	1,874.1	1,898.4	1,879.7	6.6	6.0	-125.78	-72.8	223.0	89.6	77.8	11.76	7.616		
2,000.0	1,972.2	1,998.3	1,978.2	7.1	6.4	-125.97	-79.0	238.4	94.8	82.3	12.49	7.588		
2,100.0	2,070.3	2,098.2	2,076.6	7.5	6.8	-126.13	-85.2	253.9	100.1	86.8	13.23	7.563		
2,200.0	2,168.4	2,198.0	2,175.1	8.0	7.1	-126.28	-91.5	269.3	105.3	91.4	13.97	7.540		
2,300.0	2,266.5	2,297.9	2,273.6	8.4	7.5	-126.42	-97.7	284.8	110.6	95.9	14.71	7.520		
2,400.0	2,364.6	2,397.8	2,372.0	8.8	7.9	-126.54	-103.9	300.3	115.8	100.4	15.44	7.501		
2,500.0	2,462.7	2,497.6	2,470.5	9.3	8.3	-126.65	-110.2	315.7	121.1	104.9	16.18	7.484		
2,600.0	2,560.7	2,597.5	2,568.9	9.7	8.7	-126.75	-116.4	331.2	126.4	109.4	16.92	7.468		
2,700.0	2,658.8	2,697.3	2,667.4	10.1	9.1	-126.85	-122.6	346.7	131.6	114.0	17.66	7.454		
2,800.0	2,756.9	2,797.2	2,765.9	10.6	9.5	-126.94	-128.8	362.1	136.9	118.5	18.39	7.441		
2,900.0	2,855.0	2,897.1	2,864.3	11.0	9.8	-127.02	-135.1	377.6	142.1	123.0	19.13	7.429		
3,000.0	2,953.1	2,996.9	2,962.8	11.4	10.2	-127.09	-141.3	393.1	147.4	127.5	19.87	7.418		
3,100.0	3,051.2	3,096.8	3,061.2	11.9	10.6	-127.16	-147.5	408.5	152.7	132.1	20.61	7.408		
3,200.0	3,149.3	3,196.6	3,159.7	12.3	11.0	-127.23	-153.8	424.0	157.9	136.6	21.35	7.398		
3,300.0	3,247.3	3,296.5	3,258.1	12.7	11.4	-127.29	-160.0	439.5	163.2	141.1	22.08	7.389		
3,400.0	3,345.4	3,396.4	3,356.6	13.2	11.8	-127.35	-166.2	454.9	168.4	145.6	22.82	7.381		
3,500.0	3,443.5	3,496.2	3,455.1	13.6	12.2	-127.40	-172.5	470.4	173.7	150.1	23.56	7.373		
3,600.0	3,541.6	3,596.1	3,553.5	14.1	12.6	-127.45	-178.7	485.9	179.0	154.7	24.30	7.366		
3,700.0	3,639.7	3,696.0	3,652.0	14.5	12.9	-127.50	-184.9	501.3	184.2	159.2	25.04	7.359		
3,800.0	3,737.8	3,795.8	3,750.4	14.9	13.3	-127.54	-191.1	516.8	189.5	163.7	25.77	7.352		
3,900.0	3,835.9	3,895.7	3,848.9	15.4	13.7	-127.59	-197.4	532.3	194.8	168.2	26.51	7.346 SF		

Cathedral Energy Services

Anticollision Report

Company:	Caerus Oil & Gas (NAD 27)	Local Co-ordinate Reference:	Well PUCKETT 14D-1
Project:	Garfield County, CO	TVD Reference:	KB=22' @ 8446.0usft
Reference Site:	S2-T7S-R97W (Puckett Pad P2)	MD Reference:	KB=22' @ 8446.0usft
Site Error:	0.0usft	North Reference:	True
Reference Well:	PUCKETT 14D-1	Survey Calculation Method:	Minimum Curvature
Well Error:	0.0usft	Output errors are at	2.00 sigma
Reference Wellbore	DD	Database:	USA EDM 5000 Multi Users DB
Reference Design:	Plan #1	Offset TVD Reference:	Offset Datum

Offset Design S2-T7S-R97W (Puckett Pad P2) - PUCKETT 24A-1 - DD - Plan #1													Offset Site Error:	0.0 usft
Survey Program: 0-ISCSWA MWD													Offset Well Error:	0.0 usft
Reference		Offset		Semi Major Axis			Distance						Warning	
Measured Depth (usft)	Vertical Depth (usft)	Measured Depth (usft)	Vertical Depth (usft)	Reference (usft)	Offset (usft)	Highside Toolface (°)	Offset Wellbore Centre +N/-S (usft)	+E/-W (usft)	Between Centres (usft)	Between Ellipses (usft)	Total Uncertainty Axis	Separation Factor		
0.0	0.0	0.0	0.0	0.0	0.0	30.26	35.3	20.6	40.9					
100.0	100.0	100.0	100.0	0.1	0.1	30.26	35.3	20.6	40.9	40.7	0.18	233.278		
200.0	200.0	200.0	200.0	0.3	0.3	30.26	35.3	20.6	40.9	40.3	0.62	65.452		
300.0	300.0	300.0	300.0	0.5	0.5	30.26	35.3	20.6	40.9	39.8	1.07	38.066	CC, ES	
400.0	400.0	399.1	399.0	0.7	0.8	-96.15	35.1	23.2	42.3	40.8	1.50	28.254		
500.0	499.6	498.0	497.7	1.0	1.0	-96.95	34.4	30.8	46.4	44.4	1.95	23.825		
600.0	598.8	596.4	595.2	1.2	1.2	-98.16	33.7	43.5	53.6	51.1	2.50	21.448		
700.0	697.1	694.3	691.5	1.6	1.6	-99.54	33.3	61.0	64.2	61.1	3.18	20.196		
800.0	795.2	791.6	786.2	2.0	2.0	-98.47	33.3	83.3	77.7	73.7	3.97	19.583		
900.0	893.3	887.8	878.6	2.4	2.5	-95.14	33.6	110.1	93.8	89.0	4.83	19.419	SF	
1,000.0	991.4	982.5	968.2	2.8	3.1	-90.83	34.2	140.9	113.2	107.5	5.75	19.704		
1,100.0	1,089.5	1,079.7	1,059.2	3.2	3.7	-86.86	34.9	175.0	134.8	128.1	6.69	20.159		
1,200.0	1,187.5	1,177.0	1,150.3	3.6	4.4	-83.98	35.7	209.1	156.8	149.2	7.61	20.602		
1,300.0	1,285.6	1,274.3	1,241.4	4.1	5.1	-81.82	36.5	243.2	179.1	170.6	8.53	21.000		

Cathedral Energy Services

Anticollision Report

Company:	Caerus Oil & Gas (NAD 27)	Local Co-ordinate Reference:	Well PUCKETT 14D-1
Project:	Garfield County, CO	TVD Reference:	KB=22' @ 8446.0usft
Reference Site:	S2-T7S-R97W (Puckett Pad P2)	MD Reference:	KB=22' @ 8446.0usft
Site Error:	0.0usft	North Reference:	True
Reference Well:	PUCKETT 14D-1	Survey Calculation Method:	Minimum Curvature
Well Error:	0.0usft	Output errors are at	2.00 sigma
Reference Wellbore	DD	Database:	USA EDM 5000 Multi Users DB
Reference Design:	Plan #1	Offset TVD Reference:	Offset Datum

Offset Design S2-T7S-R97W (Puckett Pad P2) - PUCKETT 24C-1 - DD - Plan #1													Offset Site Error: 0.0 usft	
Survey Program: 0-ISCWSA MWD													Offset Well Error: 0.0 usft	
Reference		Offset		Semi Major Axis			Distance							Warning
Measured Depth (usft)	Vertical Depth (usft)	Measured Depth (usft)	Vertical Depth (usft)	Reference (usft)	Offset (usft)	Highside Toolface (°)	Offset Wellbore Centre +N/-S (usft)	+E/-W (usft)	Between Centres (usft)	Between Ellipses (usft)	Total Uncertainty Axis	Separation Factor		
0.0	0.0	0.0	0.0	0.0	0.0	29.30	21.1	11.9	24.2					
100.0	100.0	100.0	100.0	0.1	0.1	29.30	21.1	11.9	24.2	24.1	0.18	138.180		
200.0	200.0	200.0	200.0	0.3	0.3	29.30	21.1	11.9	24.2	23.6	0.62	38.770		
236.0	236.0	236.0	236.0	0.4	0.4	29.30	21.1	11.9	24.2	23.4	0.79	30.789 CC		
300.0	300.0	299.8	299.8	0.5	0.5	30.77	21.0	12.5	24.4	23.3	1.07	22.869 ES		
400.0	400.0	399.3	399.2	0.7	0.7	-90.09	19.7	17.5	26.3	24.8	1.49	17.635		
500.0	499.6	498.6	497.9	1.0	1.0	-86.59	17.3	27.5	30.3	28.3	1.97	15.392		
600.0	598.8	597.7	595.8	1.2	1.3	-84.81	13.6	42.5	36.2	33.7	2.55	14.209		
700.0	697.1	696.4	692.4	1.6	1.7	-84.13	8.7	62.3	44.1	40.8	3.27	13.486		
800.0	795.2	794.6	787.3	2.0	2.2	-80.53	2.7	86.7	54.4	50.3	4.10	13.267 SF		
900.0	893.3	891.8	879.8	2.4	2.7	-74.54	-4.5	115.6	67.7	62.7	4.96	13.646		
1,000.0	991.4	988.4	970.2	2.8	3.4	-68.16	-12.6	148.5	84.7	78.9	5.81	14.574		
1,100.0	1,089.5	1,086.3	1,061.5	3.2	4.1	-63.43	-21.1	182.9	103.3	96.6	6.64	15.560		
1,200.0	1,187.5	1,184.3	1,152.9	3.6	4.8	-60.16	-29.5	217.2	122.3	114.9	7.44	16.439		
1,300.0	1,285.6	1,282.3	1,244.2	4.1	5.5	-57.77	-38.0	251.6	141.6	133.4	8.24	17.188		
1,400.0	1,383.7	1,380.2	1,335.6	4.5	6.3	-55.95	-46.5	286.0	161.1	152.1	9.03	17.837		
1,500.0	1,481.8	1,478.2	1,426.9	4.9	7.0	-54.53	-55.0	320.4	180.8	170.9	9.83	18.398		

Cathedral Energy Services

Anticollision Report

Company:	Caerus Oil & Gas (NAD 27)	Local Co-ordinate Reference:	Well PUCKETT 14D-1
Project:	Garfield County, CO	TVD Reference:	KB=22' @ 8446.0usft
Reference Site:	S2-T7S-R97W (Puckett Pad P2)	MD Reference:	KB=22' @ 8446.0usft
Site Error:	0.0usft	North Reference:	True
Reference Well:	PUCKETT 14D-1	Survey Calculation Method:	Minimum Curvature
Well Error:	0.0usft	Output errors are at	2.00 sigma
Reference Wellbore	DD	Database:	USA EDM 5000 Multi Users DB
Reference Design:	Plan #1	Offset TVD Reference:	Offset Datum

Offset Design S2-T7S-R97W (Puckett Pad P2) - PUCKETT 24D-1 - DD - Plan #1													Offset Site Error:	0.0 usft
Survey Program: 0-ISCSWA MWD													Offset Well Error:	0.0 usft
Reference		Offset		Semi Major Axis			Distance						Warning	
Measured Depth (usft)	Vertical Depth (usft)	Measured Depth (usft)	Vertical Depth (usft)	Reference (usft)	Offset (usft)	Highside Toolface (°)	Offset Wellbore Centre +N/-S (usft)	+E/-W (usft)	Between Centres (usft)	Between Ellipses (usft)	Total Uncertainty Axis	Separation Factor		
0.0	0.0	0.0	0.0	0.0	0.0	29.73	6.9	4.0	8.0					
100.0	100.0	100.0	100.0	0.1	0.1	29.73	6.9	4.0	8.0	7.8	0.18	45.457		
200.0	200.0	200.0	200.0	0.3	0.3	29.73	6.9	4.0	8.0	7.3	0.62	12.754 CC, ES		
300.0	300.0	299.8	299.8	0.5	0.5	46.82	6.0	6.4	8.8	7.7	1.06	8.236 SF		
400.0	400.0	399.4	399.0	0.7	0.8	-58.45	3.2	13.7	12.6	11.0	1.52	8.258		
500.0	499.6	498.6	497.4	1.0	1.0	-51.36	-1.3	25.7	18.1	16.1	2.04	8.871		
600.0	598.8	597.5	594.6	1.2	1.4	-50.08	-7.6	42.5	24.7	22.0	2.64	9.358		
700.0	697.1	696.0	690.4	1.6	1.8	-50.97	-15.7	63.9	32.2	28.9	3.31	9.749		
800.0	795.2	793.8	784.3	2.0	2.4	-49.07	-25.4	89.6	43.1	39.1	4.00	10.765		
900.0	893.3	890.4	875.5	2.4	3.0	-45.27	-36.7	119.4	58.2	53.5	4.70	12.382		
1,000.0	991.4	988.1	966.6	2.8	3.7	-41.80	-49.2	152.5	76.6	71.2	5.39	14.201		
1,100.0	1,089.5	1,086.3	1,058.1	3.2	4.4	-39.64	-61.8	185.9	95.1	89.1	6.08	15.653		
1,200.0	1,187.5	1,184.5	1,149.6	3.6	5.1	-38.18	-74.4	219.3	113.8	107.0	6.77	16.813		
1,300.0	1,285.6	1,282.7	1,241.1	4.1	5.9	-37.14	-87.0	252.6	132.5	125.1	7.47	17.750		
1,400.0	1,383.7	1,381.0	1,332.6	4.5	6.6	-36.35	-99.5	286.0	151.3	143.1	8.17	18.523		
1,500.0	1,481.8	1,479.2	1,424.1	4.9	7.3	-35.74	-112.1	319.4	170.0	161.2	8.87	19.169		
1,600.0	1,579.9	1,577.4	1,515.6	5.3	8.1	-35.24	-124.7	352.7	188.8	179.3	9.58	19.717		

Cathedral Energy Services

Anticollision Report

Company:	Caerus Oil & Gas (NAD 27)	Local Co-ordinate Reference:	Well PUCKETT 14D-1
Project:	Garfield County, CO	TVD Reference:	KB=22' @ 8446.0usft
Reference Site:	S2-T7S-R97W (Puckett Pad P2)	MD Reference:	KB=22' @ 8446.0usft
Site Error:	0.0usft	North Reference:	True
Reference Well:	PUCKETT 14D-1	Survey Calculation Method:	Minimum Curvature
Well Error:	0.0usft	Output errors are at	2.00 sigma
Reference Wellbore	DD	Database:	USA EDM 5000 Multi Users DB
Reference Design:	Plan #1	Offset TVD Reference:	Offset Datum

Offset Design S2-T7S-R97W (Puckett Pad P2) - PUCKETT 43C-2 - DD - Plan #1													Offset Site Error:	0.0 usft
Survey Program: 0-ISCSWA MWD													Offset Well Error:	0.0 usft
Reference		Offset		Semi Major Axis			Distance							Warning
Measured Depth (usft)	Vertical Depth (usft)	Measured Depth (usft)	Vertical Depth (usft)	Reference (usft)	Offset (usft)	Highside Toolface (°)	Offset Wellbore Centre +N/-S (usft)	+E/-W (usft)	Between Centres (usft)	Between Ellipses (usft)	Total Uncertainty Axis	Separation Factor		
0.0	0.0	0.0	0.0	0.0	0.0	16.35	40.4	11.9	42.1					
100.0	100.0	100.0	100.0	0.1	0.1	16.35	40.4	11.9	42.1	42.0	0.18	240.295		
200.0	200.0	200.0	200.0	0.3	0.3	16.35	40.4	11.9	42.1	41.5	0.62	67.421		
255.6	255.6	255.6	255.6	0.4	0.4	16.35	40.4	11.9	42.1	41.3	0.87	48.154 CC		
300.0	300.0	299.8	299.8	0.5	0.5	16.15	40.5	11.7	42.2	41.1	1.07	39.329 ES		
400.0	400.0	398.5	398.4	0.7	0.8	-117.45	43.0	8.8	45.0	43.5	1.52	29.599		
500.0	499.6	495.5	495.0	1.0	1.0	-132.20	48.6	2.1	55.3	53.2	2.08	26.631 SF		
600.0	598.8	589.4	587.9	1.2	1.3	-145.90	57.0	-8.0	76.5	73.8	2.75	27.873		
700.0	697.1	683.5	680.9	1.6	1.6	-155.23	66.7	-19.6	106.8	103.5	3.36	31.791		
800.0	795.2	777.2	773.3	2.0	1.9	-160.83	76.4	-31.3	140.0	136.2	3.81	36.748		
900.0	893.3	870.8	865.7	2.4	2.2	-164.28	86.1	-42.9	173.9	169.7	4.26	40.858		

Cathedral Energy Services

Anticollision Report

Company:	Caerus Oil & Gas (NAD 27)	Local Co-ordinate Reference:	Well PUCKETT 14D-1
Project:	Garfield County, CO	TVD Reference:	KB=22' @ 8446.0usft
Reference Site:	S2-T7S-R97W (Puckett Pad P2)	MD Reference:	KB=22' @ 8446.0usft
Site Error:	0.0usft	North Reference:	True
Reference Well:	PUCKETT 14D-1	Survey Calculation Method:	Minimum Curvature
Well Error:	0.0usft	Output errors are at	2.00 sigma
Reference Wellbore	DD	Database:	USA EDM 5000 Multi Users DB
Reference Design:	Plan #1	Offset TVD Reference:	Offset Datum

Offset Design S2-T7S-R97W (Puckett Pad P2) - PUCKETT 43D-2 - DD - Plan #1													Offset Site Error:	0.0 usft
Survey Program: 0-ISCSWA MWD													Offset Well Error:	0.0 usft
Reference		Offset		Semi Major Axis			Distance							Warning
Measured Depth (usft)	Vertical Depth (usft)	Measured Depth (usft)	Vertical Depth (usft)	Reference (usft)	Offset (usft)	Highside Toolface (°)	Offset Wellbore Centre +N/-S (usft)	+E/-W (usft)	Between Centres (usft)	Between Ellipses (usft)	Total Uncertainty Axis	Separation Factor		
0.0	0.0	0.0	0.0	0.0	0.0	13.41	33.1	7.9	34.1					
100.0	100.0	100.0	100.0	0.1	0.1	13.41	33.1	7.9	34.1	33.9	0.18	194.359		
200.0	200.0	200.0	200.0	0.3	0.3	13.41	33.1	7.9	34.1	33.4	0.62	54.532		
300.0	300.0	300.0	300.0	0.5	0.5	13.41	33.1	7.9	34.1	33.0	1.07	31.715 CC, ES		
400.0	400.0	399.6	399.5	0.7	0.8	-118.82	33.8	6.6	35.6	34.1	1.52	23.431		
500.0	499.6	497.6	497.4	1.0	1.0	-135.90	36.4	0.8	43.3	41.2	2.06	21.044 SF		
600.0	598.8	593.0	592.1	1.2	1.2	-152.54	41.0	-9.1	62.0	59.2	2.73	22.673		
700.0	697.1	688.0	686.2	1.6	1.5	-162.96	46.4	-20.9	90.1	86.7	3.34	26.924		
800.0	795.2	782.6	779.9	2.0	1.8	-168.66	51.7	-32.6	121.0	117.2	3.78	31.994		
900.0	893.3	877.1	873.6	2.4	2.1	-172.04	57.1	-44.3	152.6	148.4	4.22	36.122		
1,000.0	991.4	971.7	967.3	2.8	2.4	-174.27	62.5	-56.1	184.5	179.8	4.68	39.454		

Cathedral Energy Services

Anticollision Report

Company:	Caerus Oil & Gas (NAD 27)	Local Co-ordinate Reference:	Well PUCKETT 14D-1
Project:	Garfield County, CO	TVD Reference:	KB=22' @ 8446.0usft
Reference Site:	S2-T7S-R97W (Puckett Pad P2)	MD Reference:	KB=22' @ 8446.0usft
Site Error:	0.0usft	North Reference:	True
Reference Well:	PUCKETT 14D-1	Survey Calculation Method:	Minimum Curvature
Well Error:	0.0usft	Output errors are at	2.00 sigma
Reference Wellbore	DD	Database:	USA EDM 5000 Multi Users DB
Reference Design:	Plan #1	Offset TVD Reference:	Offset Datum

Offset Design S2-T7S-R97W (Puckett Pad P2) - PUCKETT 44A-2 - DD - Plan #1												Offset Site Error:	0.0 usft
Survey Program: 0-ISWWSA MWD												Offset Well Error:	0.0 usft
Reference		Offset		Semi Major Axis			Distance						Warning
Measured Depth (usft)	Vertical Depth (usft)	Measured Depth (usft)	Vertical Depth (usft)	Reference (usft)	Offset (usft)	Highside Toolface (°)	Offset Wellbore Centre +N/-S (usft)	+E/-W (usft)	Between Centres (usft)	Between Ellipses (usft)	Total Uncertainty Axis	Separation Factor	
0.0	0.0	0.0	0.0	0.0	0.0	8.57	26.2	4.0	26.5				
100.0	100.0	100.0	100.0	0.1	0.1	8.57	26.2	4.0	26.5	26.3	0.18	151.246	
200.0	200.0	200.0	200.0	0.3	0.3	8.57	26.2	4.0	26.5	25.9	0.62	42.436	
300.0	300.0	300.0	300.0	0.5	0.5	8.57	26.2	4.0	26.5	25.4	1.07	24.680 CC, ES	
400.0	400.0	399.9	399.9	0.7	0.8	-122.61	26.2	3.8	27.8	26.3	1.52	18.273	
500.0	499.6	499.0	498.9	1.0	1.0	-140.46	26.5	-0.1	33.8	31.7	2.05	16.518 SF	
600.0	598.8	595.7	595.2	1.2	1.2	-159.70	27.2	-8.7	49.7	47.0	2.71	18.359	
700.0	697.1	691.1	689.9	1.6	1.5	-171.58	28.1	-20.5	75.8	72.5	3.32	22.798	
800.0	795.2	786.3	784.4	2.0	1.7	-177.48	29.0	-32.3	104.9	101.1	3.76	27.868	
900.0	893.3	881.6	878.9	2.4	2.0	179.19	29.9	-44.1	134.6	130.3	4.22	31.923	
1,000.0	991.4	976.9	973.4	2.8	2.3	177.06	30.8	-55.9	164.5	159.8	4.68	35.136	
1,100.0	1,089.5	1,072.1	1,068.0	3.2	2.6	175.59	31.7	-67.7	194.6	189.4	5.16	37.702	

Cathedral Energy Services

Anticollision Report

Company:	Caerus Oil & Gas (NAD 27)	Local Co-ordinate Reference:	Well PUCKETT 14D-1
Project:	Garfield County, CO	TVD Reference:	KB=22' @ 8446.0usft
Reference Site:	S2-T7S-R97W (Puckett Pad P2)	MD Reference:	KB=22' @ 8446.0usft
Site Error:	0.0usft	North Reference:	True
Reference Well:	PUCKETT 14D-1	Survey Calculation Method:	Minimum Curvature
Well Error:	0.0usft	Output errors are at	2.00 sigma
Reference Wellbore	DD	Database:	USA EDM 5000 Multi Users DB
Reference Design:	Plan #1	Offset TVD Reference:	Offset Datum

Offset Design S2-T7S-R97W (Puckett Pad P2) - PUCKETT 44B-2 - DD - Plan #1													Offset Site Error:	0.0 usft
Survey Program: 0-ISWWSA MWD													Offset Well Error:	0.0 usft
Reference		Offset		Semi Major Axis			Distance						Warning	
Measured Depth (usft)	Vertical Depth (usft)	Measured Depth (usft)	Vertical Depth (usft)	Reference (usft)	Offset (usft)	Highside Toolface (°)	Offset Wellbore Centre +N/-S (usft)	+E/-W (usft)	Between Centres (usft)	Between Ellipses (usft)	Total Uncertainty Axis	Separation Factor		
0.0	0.0	0.0	0.0	0.0	0.0	-1.71	18.9	-0.6	18.9					
100.0	100.0	100.0	100.0	0.1	0.1	-1.71	18.9	-0.6	18.9	18.8	0.18	108.054		
200.0	200.0	200.0	200.0	0.3	0.3	-1.71	18.9	-0.6	18.9	18.3	0.62	30.317		
300.0	300.0	300.0	300.0	0.5	0.5	-1.71	18.9	-0.6	18.9	17.9	1.07	17.632 CC, ES		
400.0	400.0	400.1	400.0	0.7	0.8	-137.60	18.5	-2.0	20.5	18.9	1.53	13.358 SF		
500.0	499.6	499.0	498.8	1.0	1.0	-162.04	16.6	-8.1	28.2	26.1	2.10	13.393		
600.0	598.8	596.0	595.1	1.2	1.2	179.65	13.3	-18.7	46.6	43.9	2.77	16.861		
700.0	697.1	692.2	690.5	1.6	1.5	171.66	9.7	-30.5	72.9	69.6	3.35	21.786		
800.0	795.2	788.0	785.5	2.0	1.8	168.12	6.1	-42.2	101.2	97.4	3.80	26.607		
900.0	893.3	883.8	880.5	2.4	2.1	166.12	2.4	-53.9	129.7	125.4	4.29	30.232		
1,000.0	991.4	979.6	975.5	2.8	2.4	164.85	-1.2	-65.7	158.2	153.4	4.80	32.993		
1,100.0	1,089.5	1,075.3	1,070.5	3.2	2.7	163.96	-4.8	-77.4	186.8	181.5	5.32	35.138		

Cathedral Energy Services

Anticollision Report

Company:	Caerus Oil & Gas (NAD 27)	Local Co-ordinate Reference:	Well PUCKETT 14D-1
Project:	Garfield County, CO	TVD Reference:	KB=22' @ 8446.0usft
Reference Site:	S2-T7S-R97W (Puckett Pad P2)	MD Reference:	KB=22' @ 8446.0usft
Site Error:	0.0usft	North Reference:	True
Reference Well:	PUCKETT 14D-1	Survey Calculation Method:	Minimum Curvature
Well Error:	0.0usft	Output errors are at	2.00 sigma
Reference Wellbore	DD	Database:	USA EDM 5000 Multi Users DB
Reference Design:	Plan #1	Offset TVD Reference:	Offset Datum

Offset Design S2-T7S-R97W (Puckett Pad P2) - PUCKETT 44C-2 - DD - Plan #1													Offset Site Error:	0.0 usft
Survey Program: 0-ISCSWA MWD													Offset Well Error:	0.0 usft
Reference		Offset		Semi Major Axis			Distance						Warning	
Measured Depth (usft)	Vertical Depth (usft)	Measured Depth (usft)	Vertical Depth (usft)	Reference (usft)	Offset (usft)	Highside Toolface (°)	Offset Wellbore Centre +N/-S (usft)	+E/-W (usft)	Between Centres (usft)	Between Ellipses (usft)	Total Uncertainty Axis	Separation Factor		
0.0	0.0	0.0	0.0	0.0	0.0	-20.60	12.0	-4.5	12.8					
100.0	100.0	100.0	100.0	0.1	0.1	-20.60	12.0	-4.5	12.8	12.7	0.18	73.216		
200.0	200.0	200.0	200.0	0.3	0.3	-20.60	12.0	-4.5	12.8	12.2	0.62	20.543		
300.0	300.0	300.0	300.0	0.5	0.5	-21.32	11.9	-4.7	12.8	11.7	1.07	11.965		
309.1	309.1	309.1	309.1	0.6	0.6	-148.08	11.8	-4.8	12.8	11.7	1.11	11.534 CC, ES		
400.0	400.0	399.9	399.8	0.7	0.7	-167.74	9.7	-7.9	15.0	13.5	1.54	9.731 SF		
500.0	499.6	498.6	498.1	1.0	1.0	168.03	4.5	-15.2	26.0	23.9	2.13	12.192		
600.0	598.8	595.6	594.2	1.2	1.3	156.56	-3.2	-26.2	46.7	43.9	2.77	16.864		
700.0	697.1	692.0	689.5	1.6	1.6	153.33	-11.4	-37.9	73.0	69.7	3.37	21.705		
800.0	795.2	788.1	784.5	2.0	1.9	152.34	-19.5	-49.5	100.7	96.9	3.89	25.931		
900.0	893.3	884.2	879.5	2.4	2.2	151.77	-27.7	-61.1	128.5	124.0	4.44	28.949		
1,000.0	991.4	980.2	974.6	2.8	2.6	151.40	-35.8	-72.8	156.2	151.2	5.01	31.168		
1,100.0	1,089.5	1,076.3	1,069.6	3.2	2.9	151.15	-44.0	-84.4	183.9	178.3	5.60	32.850		

Cathedral Energy Services

Anticollision Report

Company:	Caerus Oil & Gas (NAD 27)	Local Co-ordinate Reference:	Well PUCKETT 14D-1
Project:	Garfield County, CO	TVD Reference:	KB=22' @ 8446.0usft
Reference Site:	S2-T7S-R97W (Puckett Pad P2)	MD Reference:	KB=22' @ 8446.0usft
Site Error:	0.0usft	North Reference:	True
Reference Well:	PUCKETT 14D-1	Survey Calculation Method:	Minimum Curvature
Well Error:	0.0usft	Output errors are at	2.00 sigma
Reference Wellbore	DD	Database:	USA EDM 5000 Multi Users DB
Reference Design:	Plan #1	Offset TVD Reference:	Offset Datum

Offset Design S2-T7S-R97W (Puckett Pad P2) - PUCKETT 44D-2 - DD - Plan #1													Offset Site Error: 0.0 usft	
Survey Program: 0-ISCSWA MWD													Offset Well Error: 0.0 usft	
Offset				Semi Major Axis				Distance					Warning	
Reference		Offset		Reference (usft)	Offset (usft)	Highside Toolface (°)	Offset Wellbore Centre		Between Centres (usft)	Between Ellipses (usft)	Total Uncertainty Axis	Separation Factor		
Measured Depth (usft)	Vertical Depth (usft)	Measured Depth (usft)	Vertical Depth (usft)				+N/-S (usft)	+E/-W (usft)						
0.0	0.0	0.0	0.0	0.0	0.0	-55.47	5.8	-8.5	10.3					
100.0	100.0	100.0	100.0	0.1	0.1	-55.47	5.8	-8.5	10.3	10.1	0.18	58.640		
200.0	200.0	200.0	200.0	0.3	0.3	-55.47	5.8	-8.5	10.3	9.7	0.62	16.453		
218.3	218.3	218.3	218.3	0.4	0.4	-55.47	5.8	-8.5	10.3	9.6	0.71	14.543 CC		
300.0	300.0	299.9	299.9	0.5	0.5	-63.37	4.7	-9.5	10.6	9.5	1.06	9.975 ES, SF		
400.0	400.0	399.3	399.1	0.7	0.7	149.13	-0.1	-13.8	16.0	14.5	1.55	10.360		
500.0	499.6	497.4	496.5	1.0	1.0	138.85	-8.5	-21.5	30.2	28.1	2.10	14.370		
600.0	598.8	593.9	591.7	1.2	1.3	135.51	-20.3	-32.3	52.1	49.4	2.73	19.074		
700.0	697.1	690.3	686.5	1.6	1.7	136.02	-33.0	-43.8	78.6	75.2	3.37	23.288		
800.0	795.2	786.5	781.2	2.0	2.0	137.04	-45.6	-55.3	106.0	102.1	3.98	26.641		
900.0	893.3	882.6	875.8	2.4	2.4	137.63	-58.3	-66.9	133.5	128.9	4.61	28.941		
1,000.0	991.4	978.8	970.4	2.8	2.8	138.03	-71.0	-78.4	161.0	155.7	5.26	30.584		
1,100.0	1,089.5	1,074.9	1,065.0	3.2	3.2	138.31	-83.6	-89.9	188.5	182.6	5.93	31.798		

Cathedral Energy Services

Anticollision Report

Company:	Caerus Oil & Gas (NAD 27)	Local Co-ordinate Reference:	Well PUCKETT 14D-1
Project:	Garfield County, CO	TVD Reference:	KB=22' @ 8446.0usft
Reference Site:	S2-T7S-R97W (Puckett Pad P2)	MD Reference:	KB=22' @ 8446.0usft
Site Error:	0.0usft	North Reference:	True
Reference Well:	PUCKETT 14D-1	Survey Calculation Method:	Minimum Curvature
Well Error:	0.0usft	Output errors are at	2.00 sigma
Reference Wellbore	DD	Database:	USA EDM 5000 Multi Users DB
Reference Design:	Plan #1	Offset TVD Reference:	Offset Datum

Reference Depths are relative to KB=22' @ 8446.0usft
Offset Depths are relative to Offset Datum
Central Meridian is -105.500000 °

Coordinates are relative to: PUCKETT 14D-1
Coordinate System is US State Plane 1927 (Exact solution), Colorado Central 502
Grid Convergence at Surface is: -1.69°

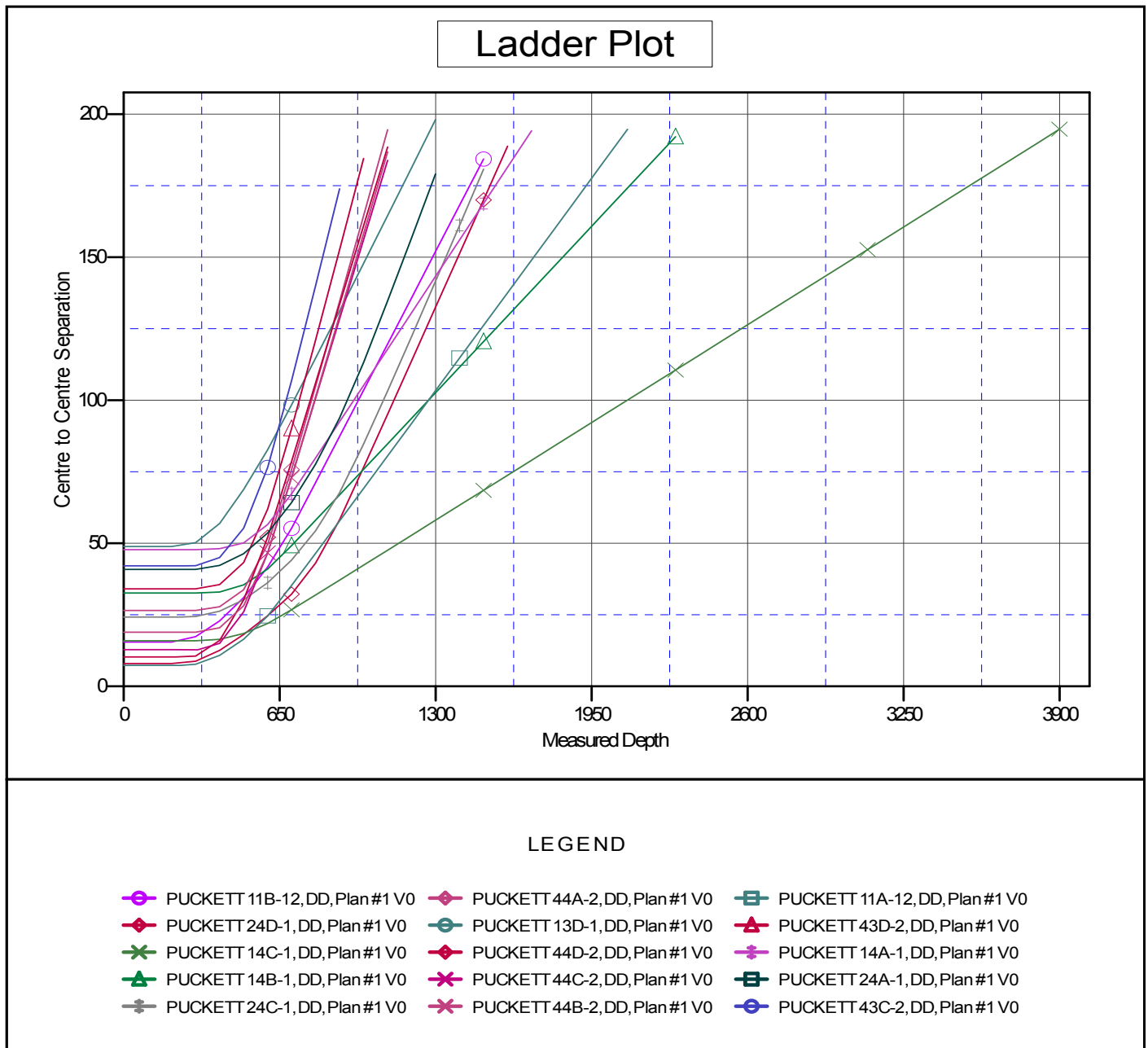

CC - Min centre to center distance or convergent point, SF - min separation factor, ES - min ellipse separation