

SECTION 29, TOWNSHIP 6 NORTH, RANGE 65 WEST, 6TH P.M.

N ¼ COR. SEC. 29
2½" ALUM. CAP
PLS 23501

NOTES:

BH LOCATION PROVIDED BY CLIENT.
LAND SURFACE USE-INDUSTRIAL
EXISTING WELL MATRIX 24-29-17 IS 149' NW
AT 491' FSL & 2168' FWL
EXISTING WELL MATRIX 23-29 IS 162' NW
AT 476' FSL & 2147' FWL
EXISTING WELL MATRIX 24-29 IS 178' NW
AT 462' FSL & 2126' FWL
EXISTING WELL MATRIX 14-29 IS 233' NW
AT 489' FSL & 2078' FWL
EXISTING WELL MATRIX 13-29 IS 262' NW
AT 490' FSL & 2049' FWL
SEE ATTACHED MAP FOR ADDITIONAL
IMPROVEMENTS WITHIN 500'.

PDOP= 1.7
GPS OPERATOR: ALAN HNIZDO

SURFACE LOCATION

GROUND ELEVATION= 4708
NAD83
LATITUDE= 40.452602°
LONGITUDE= 104.688464°

LANDING POINT LOCATION

NAD83
LATITUDE= 40.453203°
LONGITUDE= 104.696217°

BOTTOM HOLE LOCATION

NAD83
LATITUDE= 40.465165°
LONGITUDE= 104.696311°

W 1/4 COR. SEC. 29
3 1/4" ALUM. CAP
PLS 12374

C ¼ COR. SEC. 29
3¼" ALUM. CAP
PLS 22098

NE COR. SEC. 29
2½" ALUM. CAP
PLS 23501

(BASIS OF BEARINGS) SEE NOTE 2

E ¼ COR. SEC. 29
3¼" ALUM. CAP
PLS 22098

LP- 465' FSL z
140' FWL

-MATRIX A-29HN

SW COR. SEC. 29
3 1/4" ALUM. CAP
PLS 22098







EX. MATRIX 13-29
EX. MATRIX 14-29
EX. MATRIX 24-29
EX. MATRIX 23-29
EX. MATRIX 24-29-17

S 1/4 COR. SEC. 29
3 1/4" ALUM. CAP
PLS 25953

SE COR. SEC. 29
3 1/4" ALUM. CAP
NO LS #

WELL MATRIX A-29HN TO BE LOCATED 427' FSL AND 2297' FWL

LEGEND

-  = EXISTING MONUMENT  = BOTTOM HOLE
 = CALCULATED POSITION  = LANDING POINT
 = PROPOSED WELL LP = LANDING POINT
 = EXISTING WELL BH = BOTTOM HOLE

NOTES:

1. THIS FIELD SURVEY CONFORMS TO THE MINIMUM STANDARDS SET BY THE C.O.G.C.C., RULE NO. 215
2. BEARINGS AND DISTANCE SHOWN HEREON ARE GRID AND BASED ON THE COLORADO STATE PLANE COORDINATE SYSTEM, NAD 83/2011 BETWEEN MONUMENTS AS LABELED HEREON AND ELEVATIONS SHOWN ARE NAVD 88, AS DERIVED BY GPS OBSERVATIONS.
3. GRID DISTANCES ARE SHOWN, AS MEASURED IN THE FIELD, WITH TIES TO WELLS MEASURED PERPENDICULAR TO SECTION LINES.

I, DANIEL J. CORRIELL, A LICENSED PROFESSIONAL LAND SURVEYOR IN THE STATE OF COLORADO DO HEREBY CERTIFY TO BAYSWATER EXPLORATION & PRODUCTION, LLC, THAT THE SURVEY AND WELL LOCATION CERTIFICATE SHOWN HEREON WERE DONE BY ME OR UNDER MY DIRECT SUPERVISION AND THAT THE DRAWING SHOWN HEREON ACCURATELY DEPICTS THE PROPOSED LOCATION OF THE WELL. THIS CERTIFICATE DOES NOT REPRESENT A LAND SURVEY PLAT OR IMPROVEMENT SURVEY PLAT AS DEFINED BY C.R.S. 38-51-102 AND CANNOT BE RELIED UPON TO DETERMINE OWNERSHIP.

DANIEL J. CORRIELL, PLS 38065
COLORADO LICENSED PROFESSIONAL LAND SURVEYOR
FOR AND ON BEHALF OF P.F.S., LLC

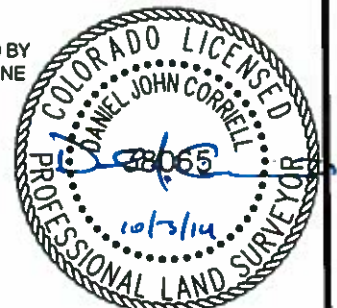

NOTICE: ACCORDING TO COLORADO LAW YOU MUST COMMENCE ANY LEGAL ACTION BASED UPON ANY DEFECT IN THIS SURVEY WITHIN THREE YEARS AFTER YOU FIRST DISCOVER SUCH DEFECT. IN NO EVENT MAY ANY ACTION BASED UPON ANY DEFECT IN THIS SURVEY BE COMMENCED MORE THAN TEN YEARS FROM THIS SAID DATE OF THIS CERTIFICATION SHOWN HEREON.

PREPARED BY:

PFS 
Petroleum Field Services, LLC
7535 Hilltop Circle
Denver, CO 80221

FIELD DATE: 07-10-14		SURFACE LOCATION: SE 1/4 SW 1/4, SEC. 29, T6N, R65W, 6TH P.M.
DRAWING DATE: 10-02-14		
BY: WDW	CHECKED: KAD	WELD COUNTY, COLORADO