

# LOCATION DRAWING

EWS 1A

SECTION: 26  
TOWNSHIP: 8N  
RANGE: 60W

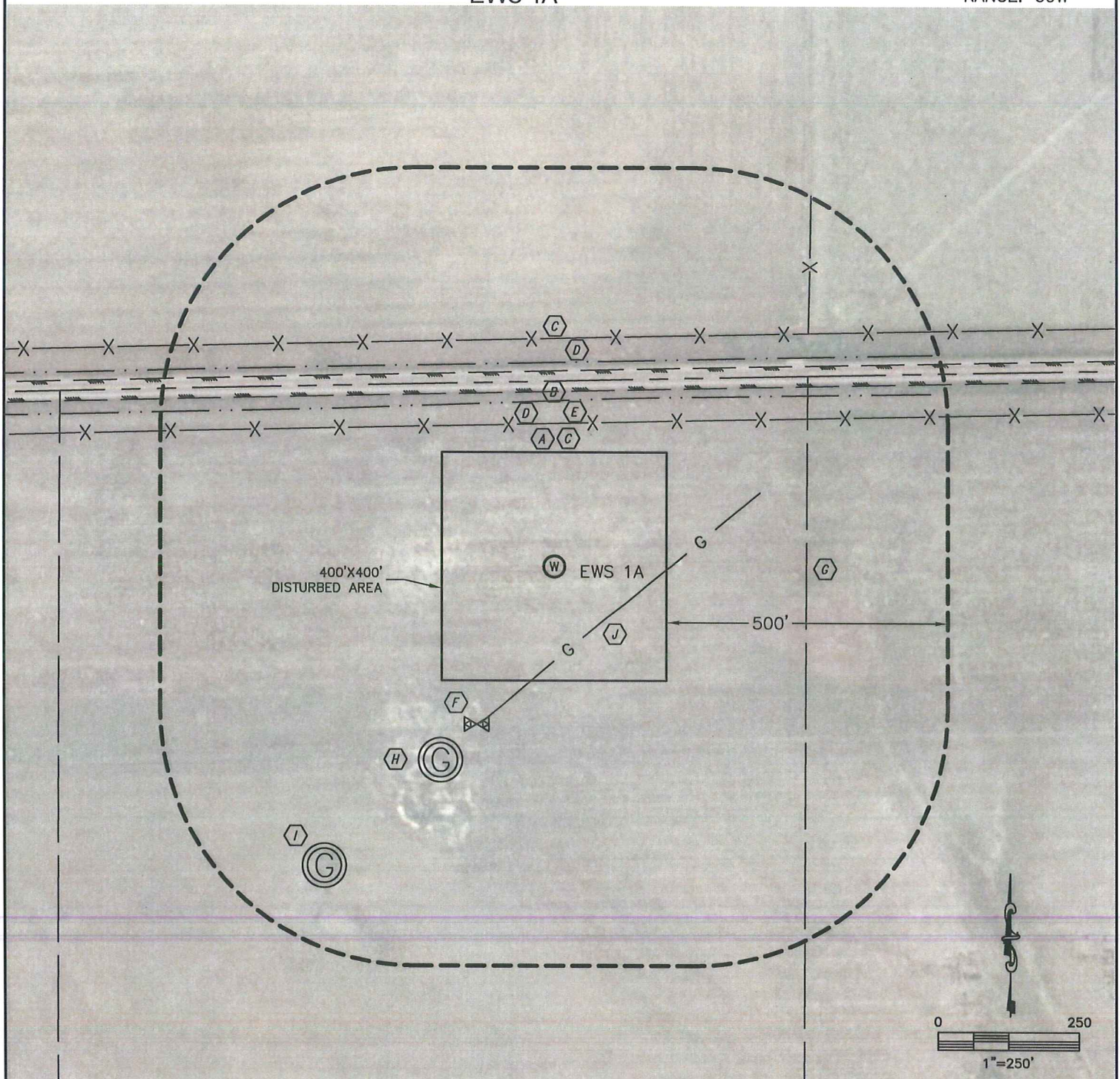

- A PROPERTY/RIGHT-OF-WAY LINE 250'N
- B SECTION LINE 325'N
- C FENCE LINE 251'N, 400'N
- D BORROW DITCH 290'N, 358'N
- E SOUTH EDGE OF ASPHALT ROAD (HWY14) 307'N
- F GAS VALVE 309'SW
- G QUARTER-SECTION LINE 449'E
- H TAYLOR #1 RE-ENTRY (PLUGGED AND ABANDONED LOCATION) 395'SW
- I TAYLOR 1-A (DRILLED AND ABANDONED LOCATION) 665'SW
- J UNDERGROUND OIL/GAS LINE 129'SE

## LEGEND

GAS VALVE  
ABOVE GROUND

