



410 17th Street, Suite 1400
Denver, CO 80202
(720) 440-6100 phone
(720) 305-0804 fax

Bonanzacrk.com

October 1, 2014

Colorado Oil and Gas Conservation Commission
The Chancery Building
1120 Lincoln Street, Suite 801
Denver, CO 80203

Attn: Director Matt Lepore

Re: Notice of 318A.a.(4)D. Horizontal Wellbore Spacing Unit Proposal
Pronghorn F11-J14-22HNC
SHL: NWNW (359' FNL and 1,199' FWL) Sec 22-5N-61W, 6TH PM
Top of Production: (631' FNL and 1,000' FWL) Sec 22-5N-61W, 6TH PM
Bottom of Production: (470' FSL and 1,000' FWL) Sec 22-5N-61W, 6TH PM
Weld County, Colorado

Director Lepore:

Bonanza Creek Energy, Inc. (Bonanza) intends to permit, drill and operate the referenced Niobrara horizontal well. As defined by Colorado Oil and Gas Conservation Commission (COGCC) Rule 318A.a.(4)D., Bonanza proposes the following wellbore spacing unit:

5N-61W-Section 22 W/2, containing 320 acres more or less

Bonanza has notified the other owners in the unit and no objections were received. Copies of the notifications are maintained in Bonanza's files.

Bonanza respectfully requests that you review the enclosed wellbore spacing unit documentation and approve the referenced APD.

Please do not hesitate to call or email me at (720) 440-6100 or REdelen@BonanzaCrk.com, should you have any questions pertaining to this matter.

Thank you for your cooperation.

Sincerely,

Randy Edelen, P. E.
Regulatory Specialist
BONANZA CREEK ENERGY, INC.
BONANZA CREEK ENERGY OPERATING COMPANY, LLC

2.5" AC LS13895
LAT 40.39358°N
LONG 104.20443°W

N87°46'56"E - 5332.48'

2.5" AC LS37897
LAT 40.39394°N
LONG 104.18530°W

1199'

S47°43'48"W - 266.69'

TARGET 1
531'FNL; 1000'FWL

N00°23'48"W - 5369.15'

S00°23'48"E - 4353.26'
FROM TARGET TO BH

T5N R61W
22

S00°30'13"E - 2650.73

NOTE: Under Colorado law,
you must commence any legal
action based upon any defect
in this certificate within three
years after defect is
discovered. In no event, may
any action based upon any
defect in this survey be
commenced more than ten
years after date of this
certificate shown hereon.
(13-80105 C.R.S)

3" AC LS37897
LAT 40.38666°N
LONG 104.18536°W

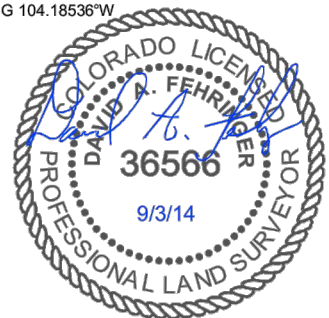

S00°30'46"E - 2650.57'

3" AC LS37897
LAT 40.37939°N
LONG 104.18541°W

S87°03'31"W - 5345.38'

2.5" AC LS13895
LAT 40.37885°N
LONG 104.20458°W

CERTIFICATE OF SURVEYOR

I, David A. Fehring of Lander, Wyoming hereby certify that this well location certificate was prepared from notes taken during an actual survey on AUGUST 27, 2014; and that it correctly shows the drilling location of BONANZA CREEK ENERGY, INC., PRONGHORN F11-J14-22HNC as staked during said survey. This map does not represent a boundary survey or an improvement location plat and should not be used for the establishment of boundary lines.

NOTES:

- All bearings are GRID based upon the Colorado State Plane Coordinate System, North Zone, NAD83(2011) derived from post-processed static GPS observations.
- Distances are at GROUND
- Vertical Datum is NAVD88 based upon GPS observations
- PDOP value equals 2.1.
- GPS operator: John Stoddard.
- Undisturbed ground elevation at wellhead = 4661.7'



**BONANZA
CREEK**

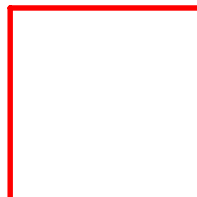

Wellbore Spacing Unit Outline



Wellbore Spacing Unit Map

12 September 2014 ksc

Pronghorn F11-J14-22HNC
W/2 Sec 22-T5N-R61W 6th PM
Weld County, Colorado