



Lat40°, Inc. 1635 Foxtrail Drive, Suite 325 Loveland, CO 970-776-3321

NOTIFICATION ZONE DRAWING

YOUNG 01N-65W-28 PAD

SECTION: 28
TOWNSHIP: 1N
RANGE: 65W

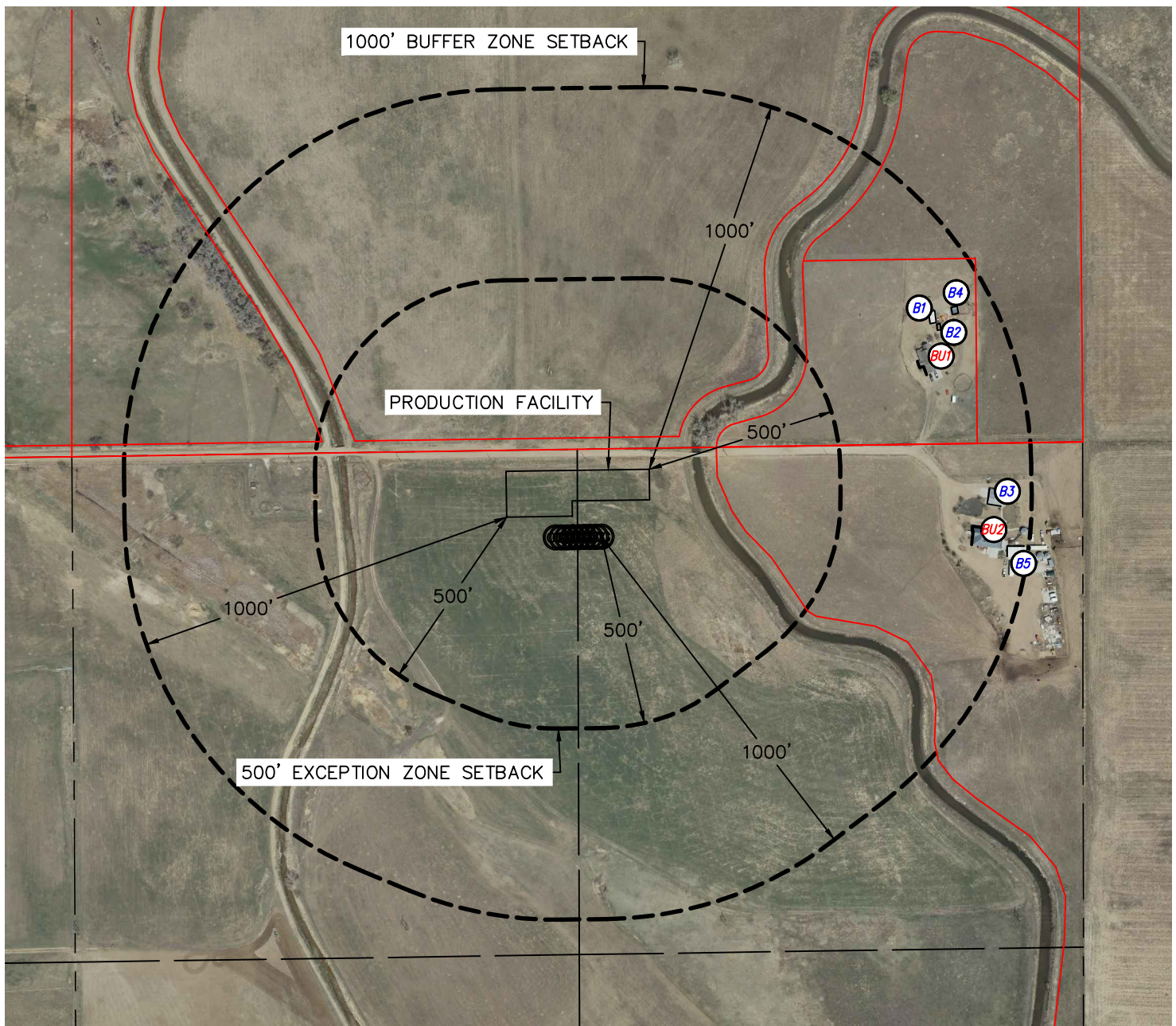

EXCEPTION ZONE:

NO EXISTING BUILDING UNITS WITHIN EXCEPTION ZONE

BUFFER ZONE:

- BU1 BUILDING UNIT BU1 ±755' NE
- BU2 BUILDING UNIT BU2 ±848' SE

LEGEND

- PROPERTY LINE
- BUILDING
- BUILDING UNIT

NEAREST CULTURAL ITEM:

BUILDING ±755' NE, BUILDING UNIT ±755' NE, HIGH OCCUPANCY BUILDING UNIT +5280',
DESIGNATED OUTSIDE ACTIVITY AREA +5280', PUBLIC ROAD 136' N (CR 6),
ABOVE GROUND UTILITY 25' N, RAILROAD ±4389' NW, PROPERTY LINE 55' N

(DISTANCES MEASURED FROM THE CENTER OF THE PROPOSED WELL HEAD OR LIMITS OF THE
PROPOSED PRODUCTION FACILITY, MLVT CLOSEST TO THE REFERENCED CULTURAL ITEM)

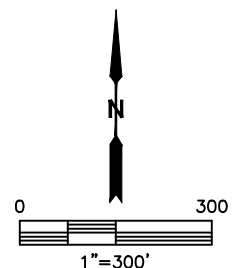

DATE: 7/7/2014
PROJECT#: 2014106