

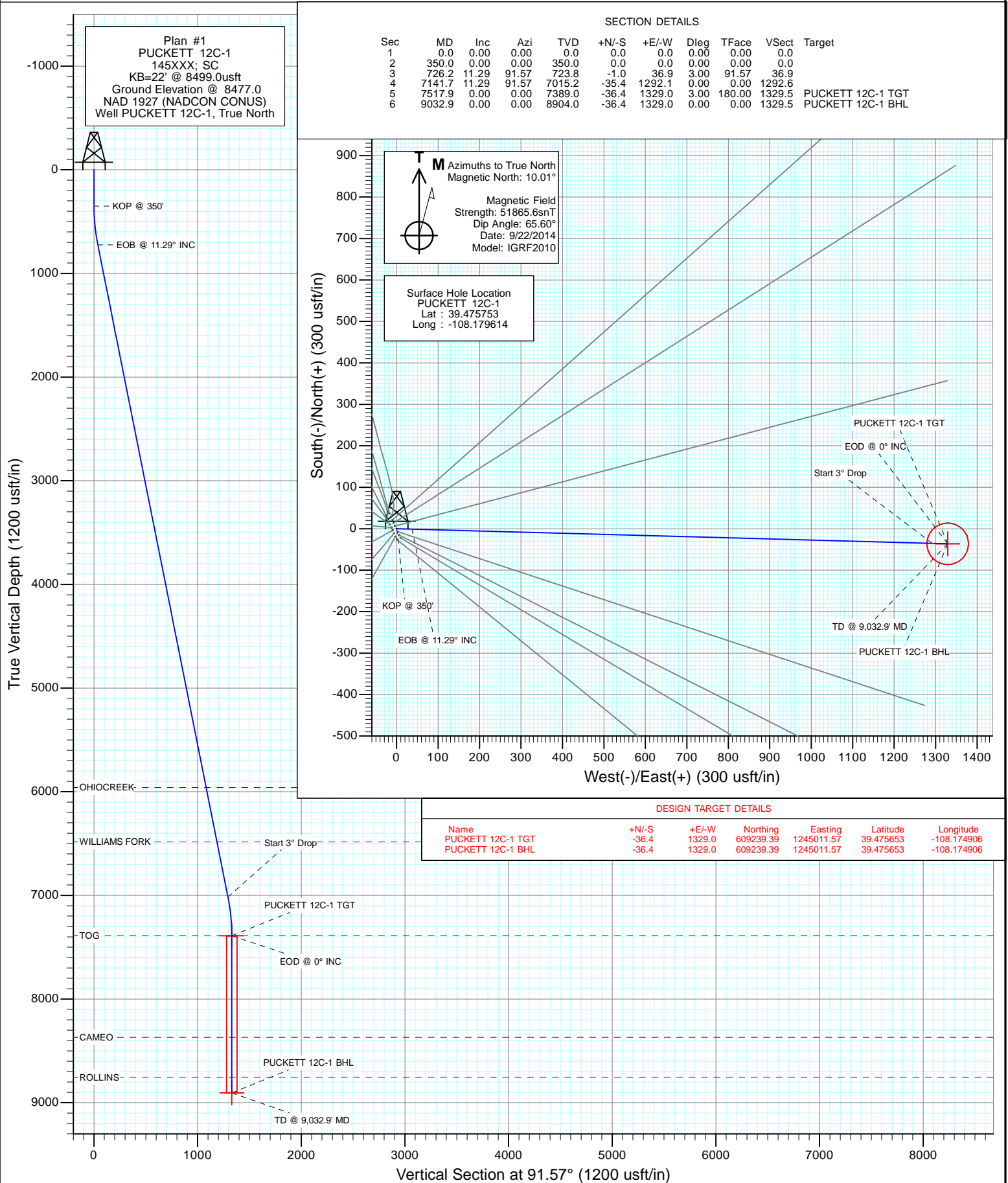

Project: Garfield County, CO
Site: S2-T7S-R97W (Puckett Pad)
Well: PUCKETT 12C-1
Wellbore: DD
Design: Plan #1

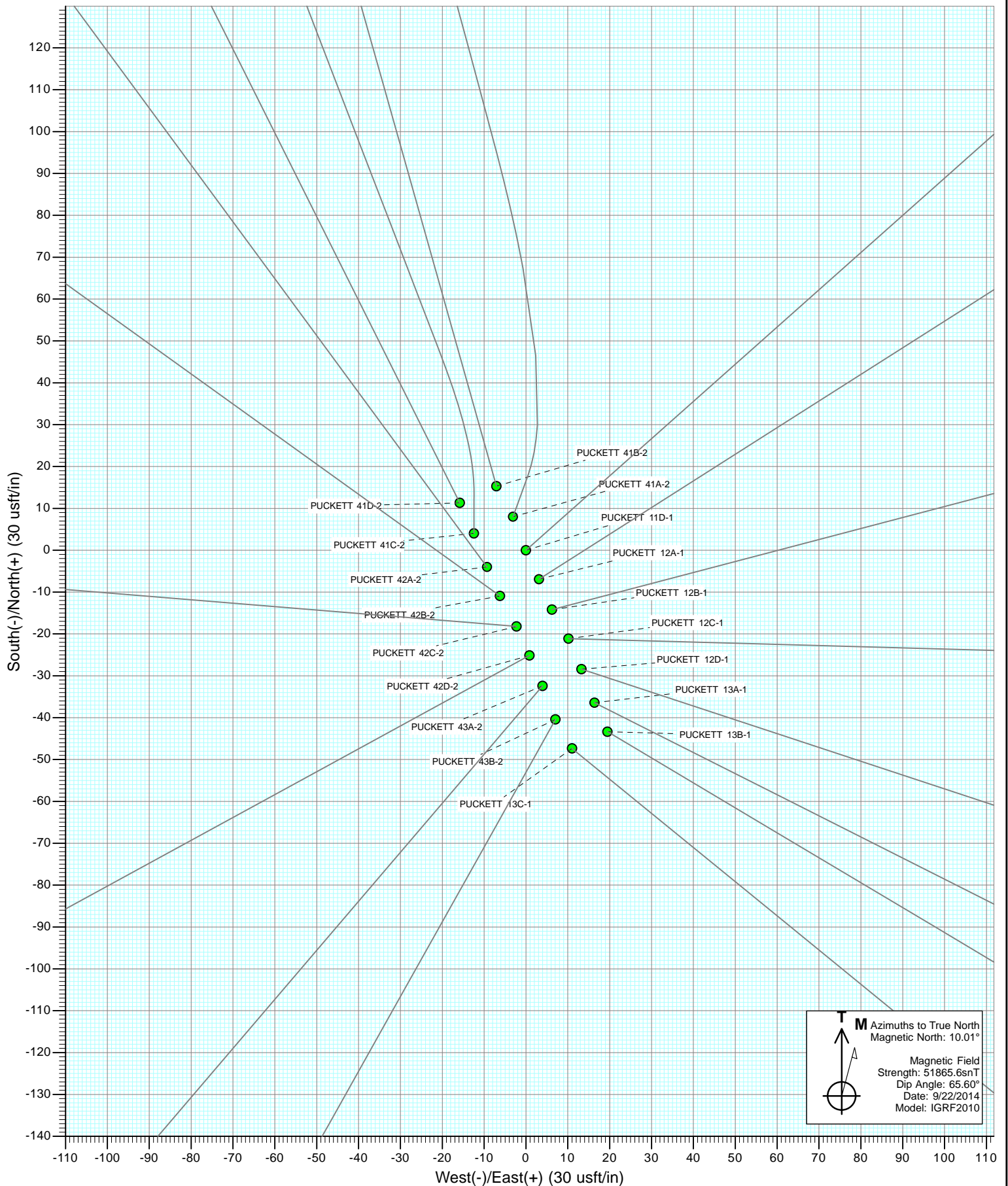

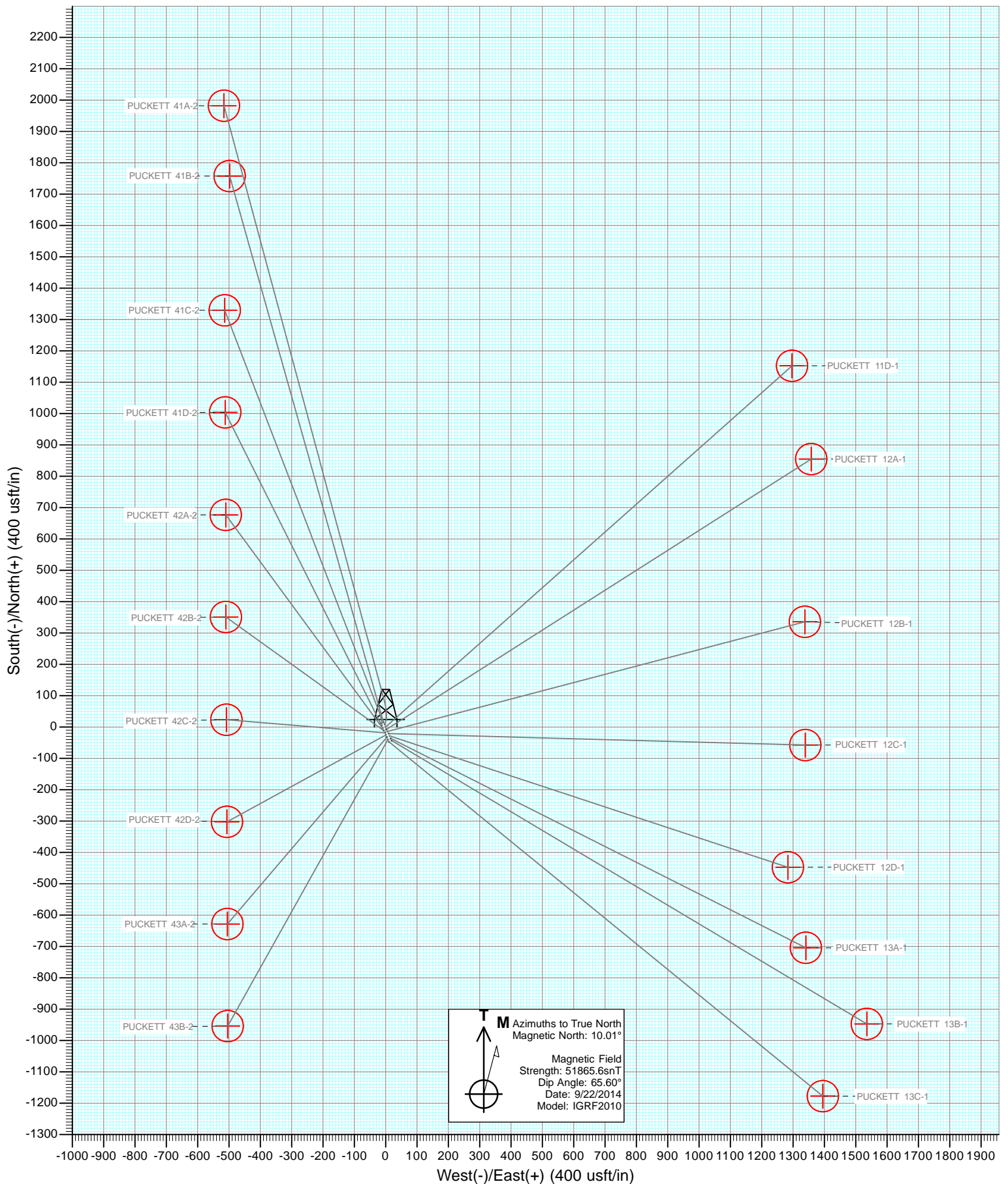



Cathedral Energy Services

Planning Report

Database:	USA EDM 5000 Multi Users DB	Local Co-ordinate Reference:	Well PUCKETT 12C-1
Company:	Caerus Oil & Gas (NAD 27)	TVD Reference:	KB=22' @ 8499.0usft
Project:	Garfield County, CO	MD Reference:	KB=22' @ 8499.0usft
Site:	S2-T7S-R97W (Puckett Pad)	North Reference:	True
Well:	PUCKETT 12C-1	Survey Calculation Method:	Minimum Curvature
Wellbore:	DD		
Design:	Plan #1		

Project	Garfield County, CO		
Map System:	US State Plane 1927 (Exact solution)	System Datum:	Mean Sea Level
Geo Datum:	NAD 1927 (NADCON CONUS)		
Map Zone:	Colorado Central 502		

Site		S2-T7S-R97W (Puckett Pad)			
Site Position:		Northing:	609,295.75 usft	Latitude:	39.475700
From:	Lat/Long	Easting:	1,243,680.53 usft	Longitude:	-108.179625
Position Uncertainty:	0.0 usft	Slot Radius:	13-3/16 "	Grid Convergence:	-1.69 °

Well	PUCKETT 12C-1					
Well Position	+N/-S	0.0 usft	Northing:	609,314.94 usft	Latitude:	39.475753
	+E/-W	0.0 usft	Easting:	1,243,684.20 usft	Longitude:	-108.179614
Position Uncertainty		0.0 usft	Wellhead Elevation:	0.0 usft	Ground Level:	8,477.0 usft

Wellbore	DD				
Magnetics	Model Name	Sample Date	Declination (°)	Dip Angle (°)	Field Strength (nT)
	IGRF2010	9/22/2014	10.01	65.60	51,866

Design	Plan #1				
Audit Notes:					
Version:	Phase:	PLAN	Tie On Depth:	0.0	
Vertical Section:	Depth From (TVD) (usft)	+N/-S (usft)	+E/-W (usft)	Direction (°)	
	0.0	0.0	0.0	91.57	

Plan Sections										
Measured Depth (usft)	Inclination (°)	Azimuth (°)	Vertical Depth (usft)	+N/-S (usft)	+E/-W (usft)	Dogleg Rate (°/100usft)	Build Rate (°/100usft)	Turn Rate (°/100usft)	TFO (°)	Target
0.0	0.00	0.00	0.0	0.0	0.0	0.00	0.00	0.00	0.00	
350.0	0.00	0.00	350.0	0.0	0.0	0.00	0.00	0.00	0.00	
726.2	11.29	91.57	723.8	-1.0	36.9	3.00	3.00	0.00	91.57	
7,141.7	11.29	91.57	7,015.2	-35.4	1,292.1	0.00	0.00	0.00	0.00	
7,517.9	0.00	0.00	7,389.0	-36.4	1,329.0	3.00	-3.00	0.00	180.00	PUCKETT 12C-1 TG1
9,032.9	0.00	0.00	8,904.0	-36.4	1,329.0	0.00	0.00	0.00	0.00	PUCKETT 12C-1 BHL

Cathedral Energy Services

Planning Report

Database:	USA EDM 5000 Multi Users DB	Local Co-ordinate Reference:	Well PUCKETT 12C-1
Company:	Caerus Oil & Gas (NAD 27)	TVD Reference:	KB=22' @ 8499.0usft
Project:	Garfield County, CO	MD Reference:	KB=22' @ 8499.0usft
Site:	S2-T7S-R97W (Puckett Pad)	North Reference:	True
Well:	PUCKETT 12C-1	Survey Calculation Method:	Minimum Curvature
Wellbore:	DD		
Design:	Plan #1		

Planned Survey

Measured Depth (usft)	Inclination (°)	Azimuth (°)	Vertical Depth (usft)	+N/-S (usft)	+E/-W (usft)	Vertical Section (usft)	Dogleg Rate (°/100usft)	Build Rate (°/100u)	Comments / Formations
0.0	0.00	0.00	0.0	0.0	0.0	0.0	0.00	0.00	
100.0	0.00	0.00	100.0	0.0	0.0	0.0	0.00	0.00	
200.0	0.00	0.00	200.0	0.0	0.0	0.0	0.00	0.00	
300.0	0.00	0.00	300.0	0.0	0.0	0.0	0.00	0.00	
350.0	0.00	0.00	350.0	0.0	0.0	0.0	0.00	0.00	KOP @ 350'
400.0	1.50	91.57	400.0	0.0	0.7	0.7	3.00	3.00	
500.0	4.50	91.57	499.8	-0.2	5.9	5.9	3.00	3.00	
600.0	7.50	91.57	599.3	-0.4	16.3	16.3	3.00	3.00	
700.0	10.50	91.57	698.0	-0.9	32.0	32.0	3.00	3.00	
726.2	11.29	91.57	723.8	-1.0	36.9	36.9	3.00	3.00	EOB @ 11.29° INC
800.0	11.29	91.57	796.1	-1.4	51.4	51.4	0.00	0.00	
900.0	11.29	91.57	894.2	-1.9	70.9	70.9	0.00	0.00	
1,000.0	11.29	91.57	992.3	-2.5	90.5	90.5	0.00	0.00	
1,100.0	11.29	91.57	1,090.3	-3.0	110.1	110.1	0.00	0.00	
1,200.0	11.29	91.57	1,188.4	-3.5	129.6	129.7	0.00	0.00	
1,300.0	11.29	91.57	1,286.5	-4.1	149.2	149.2	0.00	0.00	
1,400.0	11.29	91.57	1,384.5	-4.6	168.7	168.8	0.00	0.00	
1,500.0	11.29	91.57	1,482.6	-5.2	188.3	188.4	0.00	0.00	
1,600.0	11.29	91.57	1,580.7	-5.7	207.9	208.0	0.00	0.00	
1,700.0	11.29	91.57	1,678.7	-6.2	227.4	227.5	0.00	0.00	
1,800.0	11.29	91.57	1,776.8	-6.8	247.0	247.1	0.00	0.00	
1,900.0	11.29	91.57	1,874.9	-7.3	266.6	266.7	0.00	0.00	
2,000.0	11.29	91.57	1,972.9	-7.8	286.1	286.2	0.00	0.00	
2,100.0	11.29	91.57	2,071.0	-8.4	305.7	305.8	0.00	0.00	
2,200.0	11.29	91.57	2,169.1	-8.9	325.3	325.4	0.00	0.00	
2,300.0	11.29	91.57	2,267.1	-9.4	344.8	345.0	0.00	0.00	
2,400.0	11.29	91.57	2,365.2	-10.0	364.4	364.5	0.00	0.00	
2,500.0	11.29	91.57	2,463.3	-10.5	384.0	384.1	0.00	0.00	
2,600.0	11.29	91.57	2,561.3	-11.0	403.5	403.7	0.00	0.00	
2,700.0	11.29	91.57	2,659.4	-11.6	423.1	423.2	0.00	0.00	
2,800.0	11.29	91.57	2,757.5	-12.1	442.7	442.8	0.00	0.00	
2,900.0	11.29	91.57	2,855.5	-12.7	462.2	462.4	0.00	0.00	
3,000.0	11.29	91.57	2,953.6	-13.2	481.8	482.0	0.00	0.00	
3,100.0	11.29	91.57	3,051.7	-13.7	501.3	501.5	0.00	0.00	
3,200.0	11.29	91.57	3,149.7	-14.3	520.9	521.1	0.00	0.00	
3,300.0	11.29	91.57	3,247.8	-14.8	540.5	540.7	0.00	0.00	
3,400.0	11.29	91.57	3,345.9	-15.3	560.0	560.2	0.00	0.00	
3,500.0	11.29	91.57	3,443.9	-15.9	579.6	579.8	0.00	0.00	
3,600.0	11.29	91.57	3,542.0	-16.4	599.2	599.4	0.00	0.00	
3,700.0	11.29	91.57	3,640.1	-16.9	618.7	619.0	0.00	0.00	
3,800.0	11.29	91.57	3,738.1	-17.5	638.3	638.5	0.00	0.00	
3,900.0	11.29	91.57	3,836.2	-18.0	657.9	658.1	0.00	0.00	
4,000.0	11.29	91.57	3,934.3	-18.5	677.4	677.7	0.00	0.00	
4,100.0	11.29	91.57	4,032.3	-19.1	697.0	697.3	0.00	0.00	
4,200.0	11.29	91.57	4,130.4	-19.6	716.6	716.8	0.00	0.00	
4,300.0	11.29	91.57	4,228.5	-20.1	736.1	736.4	0.00	0.00	
4,400.0	11.29	91.57	4,326.5	-20.7	755.7	756.0	0.00	0.00	
4,500.0	11.29	91.57	4,424.6	-21.2	775.3	775.5	0.00	0.00	
4,600.0	11.29	91.57	4,522.7	-21.8	794.8	795.1	0.00	0.00	
4,700.0	11.29	91.57	4,620.7	-22.3	814.4	814.7	0.00	0.00	
4,800.0	11.29	91.57	4,718.8	-22.8	833.9	834.3	0.00	0.00	
4,900.0	11.29	91.57	4,816.8	-23.4	853.5	853.8	0.00	0.00	

Cathedral Energy Services

Planning Report

Database:	USA EDM 5000 Multi Users DB	Local Co-ordinate Reference:	Well PUCKETT 12C-1
Company:	Caerus Oil & Gas (NAD 27)	TVD Reference:	KB=22' @ 8499.0usft
Project:	Garfield County, CO	MD Reference:	KB=22' @ 8499.0usft
Site:	S2-T7S-R97W (Puckett Pad)	North Reference:	True
Well:	PUCKETT 12C-1	Survey Calculation Method:	Minimum Curvature
Wellbore:	DD		
Design:	Plan #1		

Planned Survey									
Measured Depth (usft)	Inclination (°)	Azimuth (°)	Vertical Depth (usft)	+N/-S (usft)	+E/-W (usft)	Vertical Section (usft)	Dogleg Rate (°/100usft)	Build Rate (°/100u)	Comments / Formations
5,000.0	11.29	91.57	4,914.9	-23.9	873.1	873.4	0.00	0.00	
5,100.0	11.29	91.57	5,013.0	-24.4	892.6	893.0	0.00	0.00	
5,200.0	11.29	91.57	5,111.0	-25.0	912.2	912.5	0.00	0.00	
5,300.0	11.29	91.57	5,209.1	-25.5	931.8	932.1	0.00	0.00	
5,400.0	11.29	91.57	5,307.2	-26.0	951.3	951.7	0.00	0.00	
5,500.0	11.29	91.57	5,405.2	-26.6	970.9	971.3	0.00	0.00	
5,600.0	11.29	91.57	5,503.3	-27.1	990.5	990.8	0.00	0.00	
5,700.0	11.29	91.57	5,601.4	-27.6	1,010.0	1,010.4	0.00	0.00	
5,800.0	11.29	91.57	5,699.4	-28.2	1,029.6	1,030.0	0.00	0.00	
5,900.0	11.29	91.57	5,797.5	-28.7	1,049.2	1,049.6	0.00	0.00	
6,000.0	11.29	91.57	5,895.6	-29.3	1,068.7	1,069.1	0.00	0.00	
6,064.7	11.29	91.57	5,959.0	-29.6	1,081.4	1,081.8	0.00	0.00	OHIOCREEK
6,100.0	11.29	91.57	5,993.6	-29.8	1,088.3	1,088.7	0.00	0.00	
6,200.0	11.29	91.57	6,091.7	-30.3	1,107.9	1,108.3	0.00	0.00	
6,300.0	11.29	91.57	6,189.8	-30.9	1,127.4	1,127.8	0.00	0.00	
6,400.0	11.29	91.57	6,287.8	-31.4	1,147.0	1,147.4	0.00	0.00	
6,500.0	11.29	91.57	6,385.9	-31.9	1,166.5	1,167.0	0.00	0.00	
6,600.0	11.29	91.57	6,484.0	-32.5	1,186.1	1,186.6	0.00	0.00	WILLIAMS FORK
6,700.0	11.29	91.57	6,582.0	-33.0	1,205.7	1,206.1	0.00	0.00	
6,800.0	11.29	91.57	6,680.1	-33.5	1,225.2	1,225.7	0.00	0.00	
6,900.0	11.29	91.57	6,778.2	-34.1	1,244.8	1,245.3	0.00	0.00	
7,000.0	11.29	91.57	6,876.2	-34.6	1,264.4	1,264.8	0.00	0.00	
7,100.0	11.29	91.57	6,974.3	-35.1	1,283.9	1,284.4	0.00	0.00	
7,141.7	11.29	91.57	7,015.2	-35.4	1,292.1	1,292.6	0.00	0.00	Start 3° Drop
7,200.0	9.54	91.57	7,072.5	-35.7	1,302.6	1,303.1	3.00	-3.00	
7,300.0	6.54	91.57	7,171.5	-36.0	1,316.6	1,317.1	3.00	-3.00	
7,400.0	3.54	91.57	7,271.1	-36.3	1,325.4	1,325.9	3.00	-3.00	
7,500.0	0.54	91.57	7,371.1	-36.4	1,328.9	1,329.4	3.00	-3.00	
7,517.9	0.00	0.00	7,389.0	-36.4	1,329.0	1,329.5	3.00	-3.00	EOD @ 0° INC - TOG
7,600.0	0.00	0.00	7,471.1	-36.4	1,329.0	1,329.5	0.00	0.00	
7,700.0	0.00	0.00	7,571.1	-36.4	1,329.0	1,329.5	0.00	0.00	
7,800.0	0.00	0.00	7,671.1	-36.4	1,329.0	1,329.5	0.00	0.00	
7,900.0	0.00	0.00	7,771.1	-36.4	1,329.0	1,329.5	0.00	0.00	
8,000.0	0.00	0.00	7,871.1	-36.4	1,329.0	1,329.5	0.00	0.00	
8,100.0	0.00	0.00	7,971.1	-36.4	1,329.0	1,329.5	0.00	0.00	
8,200.0	0.00	0.00	8,071.1	-36.4	1,329.0	1,329.5	0.00	0.00	
8,300.0	0.00	0.00	8,171.1	-36.4	1,329.0	1,329.5	0.00	0.00	
8,400.0	0.00	0.00	8,271.1	-36.4	1,329.0	1,329.5	0.00	0.00	
8,497.9	0.00	0.00	8,369.0	-36.4	1,329.0	1,329.5	0.00	0.00	CAMEO
8,500.0	0.00	0.00	8,371.1	-36.4	1,329.0	1,329.5	0.00	0.00	
8,600.0	0.00	0.00	8,471.1	-36.4	1,329.0	1,329.5	0.00	0.00	
8,700.0	0.00	0.00	8,571.1	-36.4	1,329.0	1,329.5	0.00	0.00	
8,800.0	0.00	0.00	8,671.1	-36.4	1,329.0	1,329.5	0.00	0.00	
8,882.9	0.00	0.00	8,754.0	-36.4	1,329.0	1,329.5	0.00	0.00	ROLLINS
8,900.0	0.00	0.00	8,771.1	-36.4	1,329.0	1,329.5	0.00	0.00	
9,000.0	0.00	0.00	8,871.1	-36.4	1,329.0	1,329.5	0.00	0.00	
9,032.9	0.00	0.00	8,904.0	-36.4	1,329.0	1,329.5	0.00	0.00	TD @ 9,032.9' MD

Cathedral Energy Services

Planning Report

Database:	USA EDM 5000 Multi Users DB	Local Co-ordinate Reference:	Well PUCKETT 12C-1
Company:	Caerus Oil & Gas (NAD 27)	TVD Reference:	KB=22' @ 8499.0usft
Project:	Garfield County, CO	MD Reference:	KB=22' @ 8499.0usft
Site:	S2-T7S-R97W (Puckett Pad)	North Reference:	True
Well:	PUCKETT 12C-1	Survey Calculation Method:	Minimum Curvature
Wellbore:	DD		
Design:	Plan #1		

Targets									
Target Name									
- hit/miss target	Dip Angle	Dip Dir.	TVD	+N/-S	+E/-W	Northing	Easting	Latitude	Longitude
- Shape	(°)	(°)	(usft)	(usft)	(usft)	(usft)	(usft)		
PUCKETT 12C-1 BHL	0.00	0.00	8,904.0	-36.4	1,329.0	609,239.39	1,245,011.57	39.475653	-108.174906
- plan hits target center									
- Circle (radius 50.0)									
PUCKETT 12C-1 TGT	0.00	0.00	7,389.0	-36.4	1,329.0	609,239.39	1,245,011.57	39.475653	-108.174906
- plan hits target center									
- Point									

Formations						
Measured Depth	Vertical Depth	Name	Lithology	Dip	Dip Direction	
(usft)	(usft)			(°)	(°)	
6,064.7	5,959.0	OHIOCREEK				
6,600.0	6,484.0	WILLIAMS FORK				
7,517.9	7,389.0	TOG				
8,497.9	8,369.0	CAMEO				
8,882.9	8,754.0	ROLLINS				

Plan Annotations					
Measured Depth	Vertical Depth	Local Coordinates			
(usft)	(usft)	+N/-S	+E/-W	Comment	
(usft)	(usft)	(usft)	(usft)		
350.0	350.0	0.0	0.0	KOP @ 350'	
726.2	723.8	-1.0	36.9	EOB @ 11.29° INC	
7,141.7	7,015.2	-35.4	1,292.1	Start 3° Drop	
7,517.9	7,389.0	-36.4	1,329.0	EOD @ 0° INC	
9,032.9	8,904.0	-36.4	1,329.0	TD @ 9,032.9' MD	

Caerus Oil & Gas (NAD 27)

Garfield County, CO

S2-T7S-R97W (Puckett Pad)

PUCKETT 12C-1

DD

Plan #1

Anticollision Report

22 September, 2014

Cathedral Energy Services

Anticollision Report

Company:	Caerus Oil & Gas (NAD 27)	Local Co-ordinate Reference:	Well PUCKETT 12C-1
Project:	Garfield County, CO	TVD Reference:	KB=22' @ 8499.0usft
Reference Site:	S2-T7S-R97W (Puckett Pad)	MD Reference:	KB=22' @ 8499.0usft
Site Error:	0.0usft	North Reference:	True
Reference Well:	PUCKETT 12C-1	Survey Calculation Method:	Minimum Curvature
Well Error:	0.0usft	Output errors are at	2.00 sigma
Reference Wellbore	DD	Database:	USA EDM 5000 Multi Users DB
Reference Design:	Plan #1	Offset TVD Reference:	Offset Datum

Reference	Plan #1		
Filter type:	NO GLOBAL FILTER: Using user defined selection & filtering criteria		
Interpolation Method:	MD Interval 100.0usft	Error Model:	ISCWSA
Depth Range:	Unlimited	Scan Method:	Closest Approach 3D
Results Limited by:	Maximum center-center distance of 200.0usft	Error Surface:	Elliptical Conic
Warning Levels Evaluated at:	2.00 Sigma		

Survey Tool Program	Date	9/22/2014		
From (usft)	To (usft)	Survey (Wellbore)	Tool Name	Description
0.0	9,032.9	Plan #1 (DD)	ISCWSA MWD	MWD - Standard

Cathedral Energy Services

Anticollision Report

Company:	Caerus Oil & Gas (NAD 27)	Local Co-ordinate Reference:	Well PUCKETT 12C-1
Project:	Garfield County, CO	TVD Reference:	KB=22' @ 8499.0usft
Reference Site:	S2-T7S-R97W (Puckett Pad)	MD Reference:	KB=22' @ 8499.0usft
Site Error:	0.0usft	North Reference:	True
Reference Well:	PUCKETT 12C-1	Survey Calculation Method:	Minimum Curvature
Well Error:	0.0usft	Output errors are at	2.00 sigma
Reference Wellbore	DD	Database:	USA EDM 5000 Multi Users DB
Reference Design:	Plan #1	Offset TVD Reference:	Offset Datum

Summary

Site Name Offset Well - Wellbore - Design	Reference Measured Depth (usft)	Offset Measured Depth (usft)	Distance		Separation Factor	Warning
			Between Centres (usft)	Between Ellipses (usft)		
S2-T7S-R97W (Puckett Pad)						
PUCKETT 11D-1 - DD - Plan #1	200.0	200.0	23.4	22.8	37.517	CC, ES
PUCKETT 11D-1 - DD - Plan #1	500.0	497.1	36.8	34.8	18.053	SF
PUCKETT 12A-1 - DD - Plan #1	241.4	241.4	15.9	15.1	19.555	CC
PUCKETT 12A-1 - DD - Plan #1	300.0	299.9	15.9	14.9	14.862	ES
PUCKETT 12A-1 - DD - Plan #1	400.0	399.6	17.6	16.1	11.571	SF
PUCKETT 12B-1 - DD - Plan #1	400.0	400.0	7.9	6.4	5.211	CC, ES
PUCKETT 12B-1 - DD - Plan #1	500.0	499.9	9.7	7.8	4.972	SF
PUCKETT 12D-1 - DD - Plan #1	300.0	300.0	7.9	6.8	7.371	CC, ES
PUCKETT 12D-1 - DD - Plan #1	400.0	399.7	9.5	8.0	6.277	SF
PUCKETT 13A-1 - DD - Plan #1	234.0	234.0	16.5	15.7	21.228	CC, ES
PUCKETT 13A-1 - DD - Plan #1	2,400.0	2,387.1	194.7	177.4	11.260	SF
PUCKETT 13B-1 - DD - Plan #1	200.0	200.0	24.1	23.5	38.556	CC, ES
PUCKETT 13B-1 - DD - Plan #1	1,700.0	1,680.9	188.9	177.8	17.019	SF
PUCKETT 13C-1 - DD - Plan #1	155.6	155.6	26.2	25.8	61.704	CC
PUCKETT 13C-1 - DD - Plan #1	200.0	199.8	26.3	25.7	42.536	ES
PUCKETT 13C-1 - DD - Plan #1	1,500.0	1,478.0	198.2	188.5	20.391	SF
PUCKETT 41A-2 - DD - Plan #1	200.0	200.0	32.0	31.4	51.239	CC, ES
PUCKETT 41A-2 - DD - Plan #1	500.0	493.9	52.6	50.5	25.776	SF
PUCKETT 41B-2 - DD - Plan #1	144.4	144.4	40.3	39.9	107.399	CC, ES
PUCKETT 41B-2 - DD - Plan #1	500.0	489.3	71.9	69.8	34.474	SF
PUCKETT 41C-2 - DD - Plan #1	200.0	200.0	33.8	33.2	54.073	CC, ES
PUCKETT 41C-2 - DD - Plan #1	500.0	494.2	53.2	51.1	25.815	SF
PUCKETT 41D-2 - DD - Plan #1	155.6	155.6	41.5	41.1	97.719	CC
PUCKETT 41D-2 - DD - Plan #1	200.0	199.5	41.7	41.1	66.885	ES
PUCKETT 41D-2 - DD - Plan #1	500.0	490.1	71.6	69.4	33.940	SF
PUCKETT 42A-2 - DD - Plan #1	255.6	255.6	25.9	25.1	29.650	CC
PUCKETT 42A-2 - DD - Plan #1	300.0	299.7	26.1	25.0	24.314	ES
PUCKETT 42A-2 - DD - Plan #1	400.0	398.2	30.4	28.8	19.780	SF
PUCKETT 42B-2 - DD - Plan #1	300.0	300.0	19.3	18.2	17.954	CC
PUCKETT 42B-2 - DD - Plan #1	300.2	300.2	19.3	18.2	17.932	ES
PUCKETT 42B-2 - DD - Plan #1	400.0	399.2	21.3	19.8	13.918	SF
PUCKETT 42C-2 - DD - Plan #1	300.0	300.0	12.8	11.7	11.875	CC, ES
PUCKETT 42C-2 - DD - Plan #1	400.0	399.8	13.6	12.0	8.854	SF
PUCKETT 42D-2 - DD - Plan #1	300.0	300.0	10.1	9.1	9.439	CC
PUCKETT 42D-2 - DD - Plan #1	300.0	300.0	10.1	9.1	9.437	ES
PUCKETT 42D-2 - DD - Plan #1	400.0	399.5	12.2	10.7	8.005	SF
PUCKETT 43A-2 - DD - Plan #1	255.6	255.6	12.9	12.0	14.734	CC
PUCKETT 43A-2 - DD - Plan #1	300.0	299.8	13.0	12.0	12.217	ES
PUCKETT 43A-2 - DD - Plan #1	400.0	399.0	17.2	15.7	11.496	SF
PUCKETT 43B-2 - DD - Plan #1	200.0	200.0	19.5	18.9	31.284	CC, ES
PUCKETT 43B-2 - DD - Plan #1	400.0	397.8	27.3	25.8	18.150	SF

Cathedral Energy Services

Anticollision Report

Company:	Caerus Oil & Gas (NAD 27)	Local Co-ordinate Reference:	Well PUCKETT 12C-1
Project:	Garfield County, CO	TVD Reference:	KB=22' @ 8499.0usft
Reference Site:	S2-T7S-R97W (Puckett Pad)	MD Reference:	KB=22' @ 8499.0usft
Site Error:	0.0usft	North Reference:	True
Reference Well:	PUCKETT 12C-1	Survey Calculation Method:	Minimum Curvature
Well Error:	0.0usft	Output errors are at	2.00 sigma
Reference Wellbore	DD	Database:	USA EDM 5000 Multi Users DB
Reference Design:	Plan #1	Offset TVD Reference:	Offset Datum

Offset Design S2-T7S-R97W (Puckett Pad) - PUCKETT 11D-1 - DD - Plan #1													Offset Site Error: 0.0 usft	
Survey Program: 0-ISWWSA MWD													Offset Well Error: 0.0 usft	
Reference		Offset		Semi Major Axis			Distance							Warning
Measured Depth (usft)	Vertical Depth (usft)	Measured Depth (usft)	Vertical Depth (usft)	Reference (usft)	Offset (usft)	Highside Toolface (°)	Offset Wellbore Centre +N/-S (usft)	+E/-W (usft)	Between Centres (usft)	Between Ellipses (usft)	Total Uncertainty Axis	Separation Factor		
0.0	0.0	0.0	0.0	0.0	0.0	-25.69	21.1	-10.2	23.4					
100.0	100.0	100.0	100.0	0.1	0.1	-25.69	21.1	-10.2	23.4	23.3	0.18	133.715		
200.0	200.0	200.0	200.0	0.3	0.3	-25.69	21.1	-10.2	23.4	22.8	0.62	37.517	CC, ES	
300.0	300.0	299.6	299.5	0.5	0.5	-19.79	22.8	-8.2	24.3	23.2	1.08	22.591		
400.0	400.0	398.7	398.3	0.8	0.8	-97.80	28.0	-2.4	28.2	26.7	1.54	18.273		
500.0	499.8	497.1	495.9	1.0	1.1	-89.22	36.4	7.1	36.8	34.8	2.04	18.053	SF	
600.0	599.3	594.7	591.9	1.2	1.4	-85.89	48.1	20.2	49.3	46.7	2.60	18.945		
700.0	698.0	691.6	686.2	1.5	1.8	-85.31	62.9	36.8	65.1	61.8	3.26	19.959		
800.0	796.1	790.1	781.6	1.9	2.3	-86.81	79.3	55.2	82.1	78.1	4.01	20.478		
900.0	894.2	888.6	877.0	2.3	2.8	-87.99	95.6	73.6	99.1	94.3	4.80	20.660		
1,000.0	992.3	987.1	972.4	2.7	3.3	-88.82	112.0	92.0	116.2	110.6	5.61	20.703		
1,100.0	1,090.3	1,085.7	1,067.8	3.1	3.8	-89.44	128.3	110.4	133.2	126.8	6.44	20.688		
1,200.0	1,188.4	1,184.2	1,163.2	3.5	4.3	-89.92	144.7	128.8	150.3	143.1	7.28	20.650		
1,300.0	1,286.5	1,282.7	1,258.6	3.9	4.8	-90.30	161.0	147.2	167.4	159.3	8.13	20.603		
1,400.0	1,384.5	1,381.2	1,354.0	4.3	5.3	-90.61	177.4	165.6	184.6	175.6	8.98	20.556		

Cathedral Energy Services

Anticollision Report

Company:	Caerus Oil & Gas (NAD 27)	Local Co-ordinate Reference:	Well PUCKETT 12C-1
Project:	Garfield County, CO	TVD Reference:	KB=22' @ 8499.0usft
Reference Site:	S2-T7S-R97W (Puckett Pad)	MD Reference:	KB=22' @ 8499.0usft
Site Error:	0.0usft	North Reference:	True
Reference Well:	PUCKETT 12C-1	Survey Calculation Method:	Minimum Curvature
Well Error:	0.0usft	Output errors are at	2.00 sigma
Reference Wellbore	DD	Database:	USA EDM 5000 Multi Users DB
Reference Design:	Plan #1	Offset TVD Reference:	Offset Datum

Offset Design S2-T7S-R97W (Puckett Pad) - PUCKETT 12A-1 - DD - Plan #1													Offset Site Error: 0.0 usft	
Survey Program: 0-ISCSWA MWD													Offset Well Error: 0.0 usft	
Reference		Offset		Semi Major Axis			Distance							Warning
Measured Depth (usft)	Vertical Depth (usft)	Measured Depth (usft)	Vertical Depth (usft)	Reference (usft)	Offset (usft)	Highside Toolface (°)	Offset Wellbore Centre +N/-S (usft)	+E/-W (usft)	Between Centres (usft)	Between Ellipses (usft)	Total Uncertainty Axis	Separation Factor		
0.0	0.0	0.0	0.0	0.0	0.0	-26.42	14.2	-7.1	15.9					
100.0	100.0	100.0	100.0	0.1	0.1	-26.42	14.2	-7.1	15.9	15.7	0.18	90.473		
200.0	200.0	200.0	200.0	0.3	0.3	-26.42	14.2	-7.1	15.9	15.2	0.62	25.384		
241.4	241.4	241.4	241.4	0.4	0.4	-26.42	14.2	-7.1	15.9	15.1	0.81	19.555 CC		
300.0	300.0	299.9	299.9	0.5	0.5	-24.08	14.6	-6.5	15.9	14.9	1.07	14.862 ES		
400.0	400.0	399.6	399.4	0.8	0.8	-100.58	17.3	-2.1	17.6	16.1	1.52	11.571 SF		
500.0	499.8	498.8	498.1	1.0	1.0	-89.45	22.9	6.6	23.1	21.1	2.00	11.581		
600.0	599.3	597.6	595.7	1.2	1.3	-84.93	31.1	19.6	32.0	29.4	2.54	12.558		
700.0	698.0	695.7	691.6	1.5	1.7	-83.91	42.0	36.6	43.6	40.4	3.19	13.655		
800.0	796.1	794.8	788.0	1.9	2.1	-85.15	54.4	56.1	56.6	52.6	3.94	14.351		
900.0	894.2	893.9	884.4	2.3	2.6	-86.14	66.8	75.6	69.6	64.8	4.73	14.697		
1,000.0	992.3	993.1	980.9	2.7	3.1	-86.81	79.2	95.1	82.6	77.0	5.55	14.878		
1,100.0	1,090.3	1,092.2	1,077.3	3.1	3.5	-87.31	91.6	114.6	95.6	89.2	6.38	14.977		
1,200.0	1,188.4	1,191.4	1,173.7	3.5	4.0	-87.68	104.0	134.1	108.6	101.4	7.22	15.032		
1,300.0	1,286.5	1,290.5	1,270.1	3.9	4.5	-87.98	116.4	153.6	121.6	113.6	8.07	15.064		
1,400.0	1,384.5	1,389.7	1,366.5	4.3	5.0	-88.21	128.8	173.0	134.7	125.7	8.93	15.082		
1,500.0	1,482.6	1,488.8	1,462.9	4.8	5.4	-88.41	141.2	192.5	147.7	137.9	9.79	15.092		
1,600.0	1,580.7	1,587.9	1,559.4	5.2	5.9	-88.57	153.6	212.0	160.7	150.1	10.65	15.097		
1,700.0	1,678.7	1,687.1	1,655.8	5.6	6.4	-88.71	165.9	231.5	173.7	162.2	11.51	15.099		
1,800.0	1,776.8	1,786.2	1,752.2	6.0	6.9	-88.83	178.3	251.0	186.8	174.4	12.37	15.099		
1,900.0	1,874.9	1,885.4	1,848.6	6.5	7.4	-88.94	190.7	270.5	199.8	186.6	13.23	15.097		

Cathedral Energy Services

Anticollision Report

Company:	Caerus Oil & Gas (NAD 27)	Local Co-ordinate Reference:	Well PUCKETT 12C-1
Project:	Garfield County, CO	TVD Reference:	KB=22' @ 8499.0usft
Reference Site:	S2-T7S-R97W (Puckett Pad)	MD Reference:	KB=22' @ 8499.0usft
Site Error:	0.0usft	North Reference:	True
Reference Well:	PUCKETT 12C-1	Survey Calculation Method:	Minimum Curvature
Well Error:	0.0usft	Output errors are at	2.00 sigma
Reference Wellbore	DD	Database:	USA EDM 5000 Multi Users DB
Reference Design:	Plan #1	Offset TVD Reference:	Offset Datum

Offset Design S2-T7S-R97W (Puckett Pad) - PUCKETT 12B-1 - DD - Plan #1													Offset Site Error: 0.0 usft	
Survey Program: 0-ISCSWA MWD													Offset Well Error: 0.0 usft	
Reference		Offset		Semi Major Axis			Distance						Warning	
Measured Depth (usft)	Vertical Depth (usft)	Measured Depth (usft)	Vertical Depth (usft)	Reference (usft)	Offset (usft)	Highside Toolface (°)	Offset Wellbore Centre +N/-S (usft)	+E/-W (usft)	Between Centres (usft)	Between Ellipses (usft)	Total Uncertainty Axis	Separation Factor		
0.0	0.0	0.0	0.0	0.0	0.0	-29.73	6.9	-4.0	8.0					
100.0	100.0	100.0	100.0	0.1	0.1	-29.73	6.9	-4.0	8.0	7.8	0.18	45.457		
200.0	200.0	200.0	200.0	0.3	0.3	-29.73	6.9	-4.0	8.0	7.3	0.62	12.754		
300.0	300.0	300.0	300.0	0.5	0.5	-29.73	6.9	-4.0	8.0	6.9	1.07	7.418		
373.3	373.3	373.3	373.3	0.7	0.7	-115.86	7.3	-2.6	8.0	6.6	1.40	5.736		
400.0	400.0	400.0	400.0	0.8	0.8	-106.81	7.6	-1.4	7.9	6.4	1.51	5.211	CC, ES	
500.0	499.8	499.9	499.6	1.0	1.0	-89.83	9.6	6.2	9.7	7.8	1.96	4.972	SF	
600.0	599.3	599.6	598.4	1.2	1.3	-80.96	12.9	18.7	13.6	11.1	2.49	5.454		
700.0	698.0	699.1	696.2	1.5	1.6	-77.80	17.5	36.2	18.9	15.8	3.13	6.051		
800.0	796.1	799.0	794.0	1.9	2.0	-80.70	22.6	55.6	24.5	20.6	3.86	6.339		
900.0	894.2	898.8	891.8	2.3	2.4	-82.90	27.7	75.0	30.0	25.4	4.64	6.467		
1,000.0	992.3	998.7	989.6	2.7	2.8	-84.41	32.8	94.5	35.6	30.1	5.45	6.530		
1,100.0	1,090.3	1,098.5	1,087.4	3.1	3.2	-85.51	37.9	113.9	41.2	34.9	6.28	6.562		
1,200.0	1,188.4	1,198.3	1,185.2	3.5	3.7	-86.35	43.0	133.3	46.8	39.7	7.11	6.579		
1,300.0	1,286.5	1,298.2	1,283.0	3.9	4.1	-87.00	48.1	152.7	52.4	44.5	7.96	6.588		
1,400.0	1,384.5	1,398.0	1,380.8	4.3	4.5	-87.53	53.2	172.1	58.1	49.2	8.81	6.592		
1,500.0	1,482.6	1,497.9	1,478.6	4.8	5.0	-87.97	58.3	191.6	63.7	54.0	9.66	6.594		
1,600.0	1,580.7	1,597.7	1,576.4	5.2	5.4	-88.34	63.4	211.0	69.3	58.8	10.51	6.594		
1,700.0	1,678.7	1,697.5	1,674.2	5.6	5.8	-88.65	68.5	230.4	74.9	63.6	11.37	6.593		
1,800.0	1,776.8	1,797.4	1,772.0	6.0	6.3	-88.91	73.6	249.8	80.6	68.4	12.23	6.591		
1,900.0	1,874.9	1,897.2	1,869.9	6.5	6.7	-89.15	78.7	269.2	86.2	73.1	13.09	6.589		
2,000.0	1,972.9	1,997.1	1,967.7	6.9	7.1	-89.35	83.8	288.7	91.9	77.9	13.95	6.588		
2,100.0	2,071.0	2,096.9	2,065.5	7.3	7.6	-89.53	89.0	308.1	97.5	82.7	14.81	6.586		
2,200.0	2,169.1	2,196.7	2,163.3	7.8	8.0	-89.69	94.1	327.5	103.2	87.5	15.67	6.584		
2,300.0	2,267.1	2,296.6	2,261.1	8.2	8.4	-89.83	99.2	346.9	108.8	92.3	16.53	6.582		
2,400.0	2,365.2	2,396.4	2,358.9	8.6	8.9	-89.96	104.3	366.3	114.4	97.0	17.39	6.580		
2,500.0	2,463.3	2,496.3	2,456.7	9.1	9.3	-90.08	109.4	385.7	120.1	101.8	18.25	6.579		
2,600.0	2,561.3	2,596.1	2,554.5	9.5	9.7	-90.19	114.5	405.2	125.7	106.6	19.12	6.577		
2,700.0	2,659.4	2,695.9	2,652.3	9.9	10.2	-90.28	119.6	424.6	131.4	111.4	19.98	6.576		
2,800.0	2,757.5	2,795.8	2,750.1	10.4	10.6	-90.37	124.7	444.0	137.0	116.2	20.84	6.574		
2,900.0	2,855.5	2,895.6	2,847.9	10.8	11.1	-90.46	129.8	463.4	142.7	121.0	21.70	6.573		
3,000.0	2,953.6	2,995.5	2,945.7	11.2	11.5	-90.53	134.9	482.8	148.3	125.7	22.57	6.572		
3,100.0	3,051.7	3,095.3	3,043.5	11.6	11.9	-90.60	140.0	502.3	154.0	130.5	23.43	6.571		
3,200.0	3,149.7	3,195.1	3,141.3	12.1	12.4	-90.67	145.1	521.7	159.6	135.3	24.29	6.570		
3,300.0	3,247.8	3,295.0	3,239.1	12.5	12.8	-90.73	150.2	541.1	165.2	140.1	25.16	6.569		
3,400.0	3,345.9	3,394.8	3,336.9	12.9	13.3	-90.79	155.3	560.5	170.9	144.9	26.02	6.568		
3,500.0	3,443.9	3,494.7	3,434.7	13.4	13.7	-90.84	160.4	579.9	176.5	149.7	26.88	6.567		
3,600.0	3,542.0	3,594.5	3,532.5	13.8	14.1	-90.89	165.5	599.4	182.2	154.4	27.75	6.566		
3,700.0	3,640.1	3,694.3	3,630.3	14.2	14.6	-90.94	170.6	618.8	187.8	159.2	28.61	6.565		
3,800.0	3,738.1	3,794.2	3,728.1	14.7	15.0	-90.98	175.7	638.2	193.5	164.0	29.47	6.565		
3,900.0	3,836.2	3,894.0	3,825.9	15.1	15.4	-91.02	180.9	657.6	199.1	168.8	30.34	6.564		

Cathedral Energy Services

Anticollision Report

Company:	Caerus Oil & Gas (NAD 27)	Local Co-ordinate Reference:	Well PUCKETT 12C-1
Project:	Garfield County, CO	TVD Reference:	KB=22' @ 8499.0usft
Reference Site:	S2-T7S-R97W (Puckett Pad)	MD Reference:	KB=22' @ 8499.0usft
Site Error:	0.0usft	North Reference:	True
Reference Well:	PUCKETT 12C-1	Survey Calculation Method:	Minimum Curvature
Well Error:	0.0usft	Output errors are at	2.00 sigma
Reference Wellbore	DD	Database:	USA EDM 5000 Multi Users DB
Reference Design:	Plan #1	Offset TVD Reference:	Offset Datum

Offset Design S2-T7S-R97W (Puckett Pad) - PUCKETT 12D-1 - DD - Plan #1													Offset Site Error:	0.0 usft
Survey Program: 0-ISCSWA MWD													Offset Well Error:	0.0 usft
Reference		Offset		Semi Major Axis			Distance							
Measured Depth (usft)	Vertical Depth (usft)	Measured Depth (usft)	Vertical Depth (usft)	Reference (usft)	Offset (usft)	Highside Toolface (°)	Offset Wellbore Centre +N/-S (usft)	+E/-W (usft)	Between Centres (usft)	Between Ellipses (usft)	Total Uncertainty Axis	Separation Factor	Warning	
0.0	0.0	0.0	0.0	0.0	0.0	156.91	-7.3	3.1	7.9					
100.0	100.0	100.0	100.0	0.1	0.1	156.91	-7.3	3.1	7.9	7.7	0.18	45.168		
200.0	200.0	200.0	200.0	0.3	0.3	156.91	-7.3	3.1	7.9	7.3	0.62	12.673		
300.0	300.0	300.0	300.0	0.5	0.5	156.91	-7.3	3.1	7.9	6.8	1.07	7.371 CC, ES		
400.0	400.0	399.7	399.6	0.8	0.7	57.06	-8.1	5.6	9.5	8.0	1.51	6.277 SF		
500.0	499.8	499.2	498.8	1.0	1.0	53.92	-10.5	13.0	12.6	10.6	1.96	6.412		
600.0	599.3	598.5	597.3	1.2	1.2	55.76	-14.6	25.2	16.8	14.3	2.48	6.783		
700.0	698.0	697.7	694.9	1.5	1.6	59.64	-20.2	42.2	22.1	19.0	3.07	7.187		
800.0	796.1	797.6	792.8	1.9	2.0	66.85	-26.3	60.7	26.8	23.1	3.74	7.163		
900.0	894.2	897.4	890.7	2.3	2.4	72.18	-32.4	79.3	31.8	27.3	4.50	7.070		
1,000.0	992.3	997.3	988.6	2.7	2.8	76.03	-38.5	97.9	37.0	31.7	5.30	6.978		
1,100.0	1,090.3	1,097.1	1,086.5	3.1	3.2	78.93	-44.6	116.4	42.3	36.2	6.13	6.903		
1,200.0	1,188.4	1,196.9	1,184.4	3.5	3.6	81.18	-50.8	135.0	47.7	40.7	6.97	6.845		
1,300.0	1,286.5	1,296.8	1,282.3	3.9	4.1	82.97	-56.9	153.5	53.1	45.3	7.82	6.799		
1,400.0	1,384.5	1,396.6	1,380.3	4.3	4.5	84.42	-63.0	172.1	58.6	50.0	8.67	6.763		
1,500.0	1,482.6	1,496.5	1,478.2	4.8	4.9	85.62	-69.1	190.7	64.2	54.6	9.53	6.735		
1,600.0	1,580.7	1,596.3	1,576.1	5.2	5.3	86.64	-75.2	209.2	69.7	59.3	10.39	6.712		
1,700.0	1,678.7	1,696.1	1,674.0	5.6	5.8	87.50	-81.4	227.8	75.3	64.0	11.25	6.694		
1,800.0	1,776.8	1,796.0	1,771.9	6.0	6.2	88.25	-87.5	246.3	80.9	68.8	12.11	6.678		
1,900.0	1,874.9	1,895.8	1,869.8	6.5	6.6	88.89	-93.6	264.9	86.5	73.5	12.97	6.666		
2,000.0	1,972.9	1,995.7	1,967.7	6.9	7.1	89.46	-99.7	283.5	92.1	78.2	13.83	6.655		
2,100.0	2,071.0	2,095.5	2,065.6	7.3	7.5	89.97	-105.8	302.0	97.7	83.0	14.70	6.646		
2,200.0	2,169.1	2,195.3	2,163.5	7.8	7.9	90.42	-112.0	320.6	103.3	87.7	15.56	6.638		
2,300.0	2,267.1	2,295.2	2,261.4	8.2	8.4	90.82	-118.1	339.1	108.9	92.5	16.43	6.632		
2,400.0	2,365.2	2,395.0	2,359.3	8.6	8.8	91.18	-124.2	357.7	114.6	97.3	17.29	6.626		
2,500.0	2,463.3	2,494.8	2,457.2	9.1	9.2	91.51	-130.3	376.2	120.2	102.0	18.15	6.621		
2,600.0	2,561.3	2,594.7	2,555.1	9.5	9.7	91.81	-136.4	394.8	125.8	106.8	19.02	6.617		
2,700.0	2,659.4	2,694.5	2,653.1	9.9	10.1	92.08	-142.5	413.4	131.5	111.6	19.88	6.613		
2,800.0	2,757.5	2,794.4	2,751.0	10.4	10.5	92.33	-148.7	431.9	137.1	116.4	20.75	6.610		
2,900.0	2,855.5	2,894.2	2,848.9	10.8	11.0	92.57	-154.8	450.5	142.8	121.2	21.61	6.607		
3,000.0	2,953.6	2,994.0	2,946.8	11.2	11.4	92.78	-160.9	469.0	148.4	125.9	22.47	6.604		
3,100.0	3,051.7	3,093.9	3,044.7	11.6	11.8	92.98	-167.0	487.6	154.1	130.7	23.34	6.602		
3,200.0	3,149.7	3,193.7	3,142.6	12.1	12.3	93.16	-173.1	506.2	159.7	135.5	24.20	6.600		
3,300.0	3,247.8	3,293.6	3,240.5	12.5	12.7	93.33	-179.3	524.7	165.4	140.3	25.06	6.598		
3,400.0	3,345.9	3,393.4	3,338.4	12.9	13.1	93.49	-185.4	543.3	171.0	145.1	25.93	6.597		
3,500.0	3,443.9	3,493.2	3,436.3	13.4	13.6	93.64	-191.5	561.8	176.7	149.9	26.79	6.595		
3,600.0	3,542.0	3,593.1	3,534.2	13.8	14.0	93.78	-197.6	580.4	182.4	154.7	27.65	6.594		
3,700.0	3,640.1	3,692.9	3,632.1	14.2	14.4	93.92	-203.7	599.0	188.0	159.5	28.52	6.593		
3,800.0	3,738.1	3,792.8	3,730.0	14.7	14.9	94.04	-209.9	617.5	193.7	164.3	29.38	6.592		
3,900.0	3,836.2	3,892.6	3,827.9	15.1	15.3	94.16	-216.0	636.1	199.3	169.1	30.24	6.591		

Cathedral Energy Services

Anticollision Report

Company:	Caerus Oil & Gas (NAD 27)	Local Co-ordinate Reference:	Well PUCKETT 12C-1
Project:	Garfield County, CO	TVD Reference:	KB=22' @ 8499.0usft
Reference Site:	S2-T7S-R97W (Puckett Pad)	MD Reference:	KB=22' @ 8499.0usft
Site Error:	0.0usft	North Reference:	True
Reference Well:	PUCKETT 12C-1	Survey Calculation Method:	Minimum Curvature
Well Error:	0.0usft	Output errors are at	2.00 sigma
Reference Wellbore	DD	Database:	USA EDM 5000 Multi Users DB
Reference Design:	Plan #1	Offset TVD Reference:	Offset Datum

Offset Design S2-T7S-R97W (Puckett Pad) - PUCKETT 13A-1 - DD - Plan #1													Offset Site Error: 0.0 usft	
Survey Program: 0-ISCSWA MWD													Offset Well Error: 0.0 usft	
Reference		Offset		Semi Major Axis			Distance							Warning
Measured Depth (usft)	Vertical Depth (usft)	Measured Depth (usft)	Vertical Depth (usft)	Reference (usft)	Offset (usft)	Highside Toolface (°)	Offset Wellbore Centre +N/-S (usft)	+E/-W (usft)	Between Centres (usft)	Between Ellipses (usft)	Total Uncertainty Axis	Separation Factor		
0.0	0.0	0.0	0.0	0.0	0.0	157.90	-15.3	6.2	16.5					
100.0	100.0	100.0	100.0	0.1	0.1	157.90	-15.3	6.2	16.5	16.3	0.18	94.173		
200.0	200.0	200.0	200.0	0.3	0.3	157.90	-15.3	6.2	16.5	15.9	0.62	26.423		
234.0	234.0	234.0	234.0	0.4	0.4	157.90	-15.3	6.2	16.5	15.7	0.78	21.228	CC, ES	
300.0	300.0	299.7	299.7	0.5	0.5	156.47	-15.6	6.8	17.0	15.9	1.07	15.963		
400.0	400.0	398.8	398.6	0.8	0.7	57.40	-17.9	11.4	20.9	19.4	1.50	13.940		
500.0	499.8	497.5	496.8	1.0	1.0	54.89	-22.5	20.5	26.9	24.9	1.97	13.638		
600.0	599.3	595.9	594.0	1.2	1.3	56.11	-29.4	34.1	34.3	31.8	2.50	13.747		
700.0	698.0	694.3	690.4	1.5	1.7	59.14	-38.4	52.0	43.2	40.1	3.10	13.915		
800.0	796.1	793.9	787.6	1.9	2.1	64.12	-48.0	71.2	51.4	47.6	3.77	13.612		
900.0	894.2	893.5	884.8	2.3	2.6	67.92	-57.7	90.4	59.8	55.3	4.52	13.245		
1,000.0	992.3	993.0	982.0	2.7	3.0	70.77	-67.4	109.6	68.4	63.1	5.30	12.905		
1,100.0	1,090.3	1,092.6	1,079.3	3.1	3.5	72.98	-77.1	128.8	77.2	71.1	6.12	12.617		
1,200.0	1,188.4	1,192.2	1,176.5	3.5	3.9	74.73	-86.8	148.0	86.0	79.1	6.95	12.380		
1,300.0	1,286.5	1,291.8	1,273.7	3.9	4.4	76.16	-96.4	167.2	94.9	87.2	7.79	12.184		
1,400.0	1,384.5	1,391.4	1,371.0	4.3	4.9	77.34	-106.1	186.4	103.9	95.3	8.64	12.022		
1,500.0	1,482.6	1,490.9	1,468.2	4.8	5.3	78.34	-115.8	205.6	112.9	103.4	9.50	11.886		
1,600.0	1,580.7	1,590.5	1,565.4	5.2	5.8	79.19	-125.5	224.8	121.9	111.6	10.36	11.771		
1,700.0	1,678.7	1,690.1	1,662.6	5.6	6.2	79.92	-135.1	244.0	131.0	119.7	11.22	11.673		
1,800.0	1,776.8	1,789.7	1,759.9	6.0	6.7	80.55	-144.8	263.2	140.0	127.9	12.08	11.589		
1,900.0	1,874.9	1,889.2	1,857.1	6.5	7.2	81.11	-154.5	282.4	149.1	136.2	12.95	11.516		
2,000.0	1,972.9	1,988.8	1,954.3	6.9	7.7	81.61	-164.2	301.6	158.2	144.4	13.82	11.452		
2,100.0	2,071.0	2,088.4	2,051.5	7.3	8.1	82.05	-173.9	320.8	167.3	152.6	14.68	11.395		
2,200.0	2,169.1	2,188.0	2,148.8	7.8	8.6	82.44	-183.5	340.0	176.4	160.9	15.55	11.345		
2,300.0	2,267.1	2,287.5	2,246.0	8.2	9.1	82.80	-193.2	359.2	185.5	169.1	16.42	11.300		
2,400.0	2,365.2	2,387.1	2,343.2	8.6	9.5	83.12	-202.9	378.4	194.7	177.4	17.29	11.260	SF	

Cathedral Energy Services

Anticollision Report

Company:	Caerus Oil & Gas (NAD 27)	Local Co-ordinate Reference:	Well PUCKETT 12C-1
Project:	Garfield County, CO	TVD Reference:	KB=22' @ 8499.0usft
Reference Site:	S2-T7S-R97W (Puckett Pad)	MD Reference:	KB=22' @ 8499.0usft
Site Error:	0.0usft	North Reference:	True
Reference Well:	PUCKETT 12C-1	Survey Calculation Method:	Minimum Curvature
Well Error:	0.0usft	Output errors are at	2.00 sigma
Reference Wellbore	DD	Database:	USA EDM 5000 Multi Users DB
Reference Design:	Plan #1	Offset TVD Reference:	Offset Datum

Offset Design S2-T7S-R97W (Puckett Pad) - PUCKETT 13B-1 - DD - Plan #1													Offset Site Error:	0.0 usft
Survey Program: 0-ISCSWA MWD													Offset Well Error:	0.0 usft
Reference		Offset		Semi Major Axis			Distance							Warning
Measured Depth (usft)	Vertical Depth (usft)	Measured Depth (usft)	Vertical Depth (usft)	Reference (usft)	Offset (usft)	Highside Toolface (°)	Offset Wellbore Centre +N/-S (usft)	+E/-W (usft)	Between Centres (usft)	Between Ellipses (usft)	Total Uncertainty Axis	Separation Factor		
0.0	0.0	0.0	0.0	0.0	0.0	157.25	-22.2	9.3	24.1					
100.0	100.0	100.0	100.0	0.1	0.1	157.25	-22.2	9.3	24.1	23.9	0.18	137.419		
200.0	200.0	200.0	200.0	0.3	0.3	157.25	-22.2	9.3	24.1	23.5	0.62	38.556	CC, ES	
300.0	300.0	298.9	298.9	0.5	0.5	153.92	-23.5	11.5	26.2	25.2	1.06	24.735		
400.0	400.0	397.3	397.0	0.8	0.8	55.91	-27.4	18.1	32.6	31.1	1.51	21.544		
500.0	499.8	495.3	494.1	1.0	1.0	53.71	-33.9	28.9	41.2	39.2	2.00	20.650		
600.0	599.3	592.6	589.8	1.2	1.4	54.51	-42.8	43.9	51.4	48.9	2.53	20.283		
700.0	698.0	689.3	684.0	1.5	1.8	56.74	-54.1	62.9	63.2	60.0	3.14	20.087		
800.0	796.1	788.3	779.7	1.9	2.3	59.88	-67.1	84.6	75.4	71.6	3.82	19.741		
900.0	894.2	887.5	875.6	2.3	2.8	62.31	-80.1	106.4	87.8	83.2	4.55	19.313		
1,000.0	992.3	986.7	971.5	2.7	3.3	64.13	-93.0	128.1	100.3	94.9	5.31	18.873		
1,100.0	1,090.3	1,085.9	1,067.4	3.1	3.9	65.55	-106.0	149.9	112.8	106.7	6.11	18.476		
1,200.0	1,188.4	1,185.0	1,163.2	3.5	4.4	66.68	-119.0	171.7	125.4	118.5	6.92	18.133		
1,300.0	1,286.5	1,284.2	1,259.1	3.9	4.9	67.61	-132.0	193.4	138.1	130.3	7.74	17.837		
1,400.0	1,384.5	1,383.4	1,355.0	4.3	5.5	68.38	-144.9	215.2	150.7	142.2	8.57	17.585		
1,500.0	1,482.6	1,482.6	1,450.9	4.8	6.0	69.04	-157.9	237.0	163.4	154.0	9.41	17.368		
1,600.0	1,580.7	1,581.7	1,546.8	5.2	6.5	69.59	-170.9	258.7	176.1	165.9	10.25	17.181		
1,700.0	1,678.7	1,680.9	1,642.7	5.6	7.1	70.08	-183.9	280.5	188.9	177.8	11.10	17.019	SF	

Cathedral Energy Services

Anticollision Report

Company:	Caerus Oil & Gas (NAD 27)	Local Co-ordinate Reference:	Well PUCKETT 12C-1
Project:	Garfield County, CO	TVD Reference:	KB=22' @ 8499.0usft
Reference Site:	S2-T7S-R97W (Puckett Pad)	MD Reference:	KB=22' @ 8499.0usft
Site Error:	0.0usft	North Reference:	True
Reference Well:	PUCKETT 12C-1	Survey Calculation Method:	Minimum Curvature
Well Error:	0.0usft	Output errors are at	2.00 sigma
Reference Wellbore	DD	Database:	USA EDM 5000 Multi Users DB
Reference Design:	Plan #1	Offset TVD Reference:	Offset Datum

Offset Design S2-T7S-R97W (Puckett Pad) - PUCKETT 13C-1 - DD - Plan #1													Offset Site Error:	0.0 usft
Survey Program: 0-ISCSWA MWD													Offset Well Error:	0.0 usft
Reference		Offset		Semi Major Axis			Distance						Warning	
Measured Depth (usft)	Vertical Depth (usft)	Measured Depth (usft)	Vertical Depth (usft)	Reference (usft)	Offset (usft)	Highside Toolface (°)	Offset Wellbore Centre +N/-S (usft)	+E/-W (usft)	Between Centres (usft)	Between Ellipses (usft)	Total Uncertainty Axis	Separation Factor		
0.0	0.0	0.0	0.0	0.0	0.0	178.15	-26.2	0.8	26.2					
100.0	100.0	100.0	100.0	0.1	0.1	178.15	-26.2	0.8	26.2	26.1	0.18	149.661		
155.6	155.6	155.6	155.6	0.2	0.2	178.15	-26.2	0.8	26.2	25.8	0.43	61.704 CC		
200.0	200.0	199.8	199.8	0.3	0.3	177.89	-26.3	1.0	26.3	25.7	0.62	42.536 ES		
300.0	300.0	298.7	298.6	0.5	0.5	172.18	-28.8	3.9	29.1	28.0	1.06	27.529		
400.0	400.0	397.0	396.5	0.8	0.8	71.80	-34.4	10.8	36.0	34.5	1.52	23.653		
500.0	499.8	494.7	493.2	1.0	1.1	67.88	-43.1	21.5	46.2	44.2	2.01	22.995		
600.0	599.3	591.6	588.3	1.2	1.4	67.50	-54.8	35.9	58.8	56.3	2.55	23.038		
700.0	698.0	688.1	681.9	1.5	1.9	68.86	-69.5	53.9	73.8	70.6	3.19	23.130		
800.0	796.1	786.8	777.3	1.9	2.4	71.64	-85.6	73.6	89.1	85.2	3.91	22.780		
900.0	894.2	885.5	872.7	2.3	2.9	73.78	-101.7	93.3	104.5	99.8	4.68	22.316		
1,000.0	992.3	984.3	968.1	2.7	3.5	75.37	-117.8	113.1	120.0	114.5	5.49	21.864		
1,100.0	1,090.3	1,083.0	1,063.5	3.1	4.0	76.60	-134.0	132.8	135.6	129.3	6.31	21.469		
1,200.0	1,188.4	1,181.8	1,158.9	3.5	4.5	77.57	-150.1	152.5	151.2	144.0	7.16	21.130		
1,300.0	1,286.5	1,280.5	1,254.3	3.9	5.1	78.36	-166.2	172.2	166.8	158.8	8.00	20.843		
1,400.0	1,384.5	1,379.3	1,349.7	4.3	5.6	79.02	-182.3	192.0	182.5	173.7	8.86	20.599		
1,500.0	1,482.6	1,478.0	1,445.1	4.8	6.1	79.57	-198.4	211.7	198.2	188.5	9.72	20.391 SF		

Cathedral Energy Services

Anticollision Report

Company:	Caerus Oil & Gas (NAD 27)	Local Co-ordinate Reference:	Well PUCKETT 12C-1
Project:	Garfield County, CO	TVD Reference:	KB=22' @ 8499.0usft
Reference Site:	S2-T7S-R97W (Puckett Pad)	MD Reference:	KB=22' @ 8499.0usft
Site Error:	0.0usft	North Reference:	True
Reference Well:	PUCKETT 12C-1	Survey Calculation Method:	Minimum Curvature
Well Error:	0.0usft	Output errors are at	2.00 sigma
Reference Wellbore	DD	Database:	USA EDM 5000 Multi Users DB
Reference Design:	Plan #1	Offset TVD Reference:	Offset Datum

Offset Design S2-T7S-R97W (Puckett Pad) - PUCKETT 41A-2 - DD - Plan #1												Offset Site Error:	0.0 usft
Survey Program: 0-ISCSWA MWD												Offset Well Error:	0.0 usft
Reference		Offset		Semi Major Axis		Distance							
Measured Depth (usft)	Vertical Depth (usft)	Measured Depth (usft)	Vertical Depth (usft)	Reference (usft)	Offset (usft)	Highside Toolface (°)	Offset Wellbore Centre +N/-S (usft)	+E/-W (usft)	Between Centres (usft)	Between Ellipses (usft)	Total Uncertainty Axis	Separation Factor	Warning
0.0	0.0	0.0	0.0	0.0	0.0	-24.48	29.1	-13.3	32.0				
100.0	100.0	100.0	100.0	0.1	0.1	-24.48	29.1	-13.3	32.0	31.8	0.18	182.622	
200.0	200.0	200.0	200.0	0.3	0.3	-24.48	29.1	-13.3	32.0	31.4	0.62	51.239 CC, ES	
300.0	300.0	298.7	298.7	0.5	0.5	-21.46	31.5	-12.4	33.9	32.8	1.07	31.577	
400.0	400.0	397.0	396.6	0.8	0.8	-106.56	38.7	-9.8	40.2	38.7	1.55	25.917	
500.0	499.8	493.9	492.9	1.0	1.0	-105.83	50.2	-7.5	52.6	50.5	2.04	25.776 SF	
600.0	599.3	589.0	586.7	1.2	1.3	-110.12	65.5	-7.7	71.3	68.8	2.58	27.679	
700.0	698.0	681.1	676.8	1.5	1.7	-115.36	84.3	-10.1	97.3	94.1	3.18	30.553	
800.0	796.1	769.8	762.7	1.9	2.1	-120.07	105.8	-14.6	130.2	126.4	3.81	34.158	
900.0	894.2	857.9	847.1	2.3	2.6	-123.05	130.3	-21.0	167.8	163.3	4.45	37.717	

Cathedral Energy Services

Anticollision Report

Company:	Caerus Oil & Gas (NAD 27)	Local Co-ordinate Reference:	Well PUCKETT 12C-1
Project:	Garfield County, CO	TVD Reference:	KB=22' @ 8499.0usft
Reference Site:	S2-T7S-R97W (Puckett Pad)	MD Reference:	KB=22' @ 8499.0usft
Site Error:	0.0usft	North Reference:	True
Reference Well:	PUCKETT 12C-1	Survey Calculation Method:	Minimum Curvature
Well Error:	0.0usft	Output errors are at	2.00 sigma
Reference Wellbore	DD	Database:	USA EDM 5000 Multi Users DB
Reference Design:	Plan #1	Offset TVD Reference:	Offset Datum

Offset Design S2-T7S-R97W (Puckett Pad) - PUCKETT 41B-2 - DD - Plan #1													Offset Site Error:	0.0 usft
Survey Program: 0-ISWWSA MWD													Offset Well Error:	0.0 usft
Reference		Offset		Semi Major Axis			Distance							Warning
Measured Depth (usft)	Vertical Depth (usft)	Measured Depth (usft)	Vertical Depth (usft)	Reference (usft)	Offset (usft)	Highside Toolface (°)	Offset Wellbore Centre +N/-S (usft)	+E/-W (usft)	Between Centres (usft)	Between Ellipses (usft)	Total Uncertainty Axis	Separation Factor		
0.0	0.0	0.0	0.0	0.0	0.0	-25.30	36.4	-17.2	40.3					
100.0	100.0	100.0	100.0	0.1	0.1	-25.30	36.4	-17.2	40.3	40.1	0.18	229.802		
144.4	144.4	144.4	144.4	0.2	0.2	-25.30	36.4	-17.2	40.3	39.9	0.38	107.399	CC, ES	
200.0	200.0	199.2	199.2	0.3	0.3	-25.21	36.8	-17.3	40.7	40.1	0.62	65.338		
300.0	300.0	296.9	296.8	0.5	0.5	-24.27	41.1	-18.5	45.2	44.2	1.07	42.174		
400.0	400.0	393.9	393.3	0.8	0.8	-114.82	50.2	-21.1	55.1	53.5	1.58	34.986		
500.0	499.8	489.3	487.7	1.0	1.1	-116.55	63.7	-24.9	71.9	69.8	2.09	34.474	SF	
600.0	599.3	582.2	578.8	1.2	1.4	-119.42	81.2	-29.8	96.0	93.3	2.64	36.335		
700.0	698.0	672.4	666.3	1.5	1.8	-122.13	102.2	-35.7	127.3	124.1	3.25	39.124		
800.0	796.1	765.6	756.3	1.9	2.3	-125.11	125.6	-42.3	162.8	158.9	3.84	42.340		
900.0	894.2	858.8	846.2	2.3	2.8	-127.23	148.9	-48.9	198.6	194.2	4.43	44.824		

Cathedral Energy Services

Anticollision Report

Company:	Caerus Oil & Gas (NAD 27)	Local Co-ordinate Reference:	Well PUCKETT 12C-1
Project:	Garfield County, CO	TVD Reference:	KB=22' @ 8499.0usft
Reference Site:	S2-T7S-R97W (Puckett Pad)	MD Reference:	KB=22' @ 8499.0usft
Site Error:	0.0usft	North Reference:	True
Reference Well:	PUCKETT 12C-1	Survey Calculation Method:	Minimum Curvature
Well Error:	0.0usft	Output errors are at	2.00 sigma
Reference Wellbore	DD	Database:	USA EDM 5000 Multi Users DB
Reference Design:	Plan #1	Offset TVD Reference:	Offset Datum

Offset Design S2-T7S-R97W (Puckett Pad) - PUCKETT 41C-2 - DD - Plan #1													Offset Site Error:	0.0 usft
Survey Program: 0-ISCSWA MWD													Offset Well Error:	0.0 usft
Reference		Offset		Semi Major Axis			Distance						Warning	
Measured Depth (usft)	Vertical Depth (usft)	Measured Depth (usft)	Vertical Depth (usft)	Reference (usft)	Offset (usft)	Highside Toolface (°)	Offset Wellbore Centre +N/-S (usft)	+E/-W (usft)	Between Centres (usft)	Between Ellipses (usft)	Total Uncertainty Axis	Separation Factor		
0.0	0.0	0.0	0.0	0.0	0.0	-41.94	25.1	-22.6	33.8					
100.0	100.0	100.0	100.0	0.1	0.1	-41.94	25.1	-22.6	33.8	33.6	0.18	192.723		
200.0	200.0	200.0	200.0	0.3	0.3	-41.94	25.1	-22.6	33.8	33.2	0.62	54.073 CC, ES		
300.0	300.0	299.0	299.0	0.5	0.5	-40.37	26.6	-22.6	34.9	33.8	1.07	32.488		
400.0	400.0	397.3	397.0	0.8	0.8	-126.69	32.9	-22.6	40.4	38.9	1.55	26.117		
500.0	499.8	494.2	493.3	1.0	1.0	-124.69	43.8	-23.4	53.2	51.1	2.06	25.815 SF		
600.0	599.3	588.8	586.8	1.2	1.3	-126.86	58.1	-27.1	73.9	71.3	2.62	28.235		
700.0	698.0	682.0	678.1	1.5	1.7	-130.11	75.3	-33.4	102.4	99.1	3.24	31.621		
800.0	796.1	776.4	770.6	1.9	2.0	-133.44	93.5	-40.4	134.5	130.7	3.80	35.409		
900.0	894.2	870.9	862.9	2.3	2.4	-135.66	111.7	-47.4	167.0	162.6	4.35	38.399		
1,000.0	992.3	965.3	955.3	2.7	2.8	-137.15	129.8	-54.4	199.6	194.7	4.91	40.630		

Cathedral Energy Services

Anticollision Report

Company:	Caerus Oil & Gas (NAD 27)	Local Co-ordinate Reference:	Well PUCKETT 12C-1
Project:	Garfield County, CO	TVD Reference:	KB=22' @ 8499.0usft
Reference Site:	S2-T7S-R97W (Puckett Pad)	MD Reference:	KB=22' @ 8499.0usft
Site Error:	0.0usft	North Reference:	True
Reference Well:	PUCKETT 12C-1	Survey Calculation Method:	Minimum Curvature
Well Error:	0.0usft	Output errors are at	2.00 sigma
Reference Wellbore	DD	Database:	USA EDM 5000 Multi Users DB
Reference Design:	Plan #1	Offset TVD Reference:	Offset Datum

Offset Design S2-T7S-R97W (Puckett Pad) - PUCKETT 41D-2 - DD - Plan #1													Offset Site Error:	0.0 usft
Survey Program: 0-ISWWSA MWD													Offset Well Error:	0.0 usft
Reference		Offset		Semi Major Axis			Distance							Warning
Measured Depth (usft)	Vertical Depth (usft)	Measured Depth (usft)	Vertical Depth (usft)	Reference (usft)	Offset (usft)	Highside Toolface (°)	Offset Wellbore Centre +N/-S (usft)	+E/-W (usft)	Between Centres (usft)	Between Ellipses (usft)	Total Uncertainty Axis	Separation Factor		
0.0	0.0	0.0	0.0	0.0	0.0	-38.70	32.4	-26.0	41.5					
100.0	100.0	100.0	100.0	0.1	0.1	-38.70	32.4	-26.0	41.5	41.4	0.18	236.923		
155.6	155.6	155.6	155.6	0.2	0.2	-38.70	32.4	-26.0	41.5	41.1	0.43	97.719 CC		
200.0	200.0	199.5	199.5	0.3	0.3	-38.65	32.6	-26.0	41.7	41.1	0.62	66.885 ES		
300.0	300.0	297.2	297.1	0.5	0.5	-37.66	35.9	-27.7	45.5	44.4	1.07	42.453		
400.0	400.0	394.3	393.8	0.8	0.8	-127.86	43.7	-31.6	54.6	53.1	1.57	34.786		
500.0	499.8	490.1	488.7	1.0	1.1	-128.85	55.6	-37.6	71.6	69.4	2.11	33.940 SF		
600.0	599.3	587.5	584.8	1.2	1.4	-131.47	69.5	-44.5	93.8	91.1	2.65	35.364		
700.0	698.0	683.8	679.9	1.5	1.7	-134.68	83.2	-51.4	119.7	116.5	3.23	37.109		
800.0	796.1	779.2	774.1	1.9	2.1	-138.00	96.8	-58.1	148.7	145.0	3.76	39.517		
900.0	894.2	874.5	868.2	2.3	2.4	-140.38	110.4	-64.9	178.2	173.9	4.29	41.549		

Cathedral Energy Services

Anticollision Report

Company:	Caerus Oil & Gas (NAD 27)	Local Co-ordinate Reference:	Well PUCKETT 12C-1
Project:	Garfield County, CO	TVD Reference:	KB=22' @ 8499.0usft
Reference Site:	S2-T7S-R97W (Puckett Pad)	MD Reference:	KB=22' @ 8499.0usft
Site Error:	0.0usft	North Reference:	True
Reference Well:	PUCKETT 12C-1	Survey Calculation Method:	Minimum Curvature
Well Error:	0.0usft	Output errors are at	2.00 sigma
Reference Wellbore	DD	Database:	USA EDM 5000 Multi Users DB
Reference Design:	Plan #1	Offset TVD Reference:	Offset Datum

Offset Design S2-T7S-R97W (Puckett Pad) - PUCKETT 42A-2 - DD - Plan #1													Offset Site Error:	0.0 usft
Survey Program: 0-ISWWSA MWD													Offset Well Error:	0.0 usft
Reference		Offset		Semi Major Axis			Distance							Warning
Measured Depth (usft)	Vertical Depth (usft)	Measured Depth (usft)	Vertical Depth (usft)	Reference (usft)	Offset (usft)	Highside Toolface (°)	Offset Wellbore Centre +N/-S (usft)	+E/-W (usft)	Between Centres (usft)	Between Ellipses (usft)	Total Uncertainty Axis	Separation Factor		
0.0	0.0	0.0	0.0	0.0	0.0	-48.69	17.1	-19.5	25.9					
100.0	100.0	100.0	100.0	0.1	0.1	-48.69	17.1	-19.5	25.9	25.8	0.18	147.912		
200.0	200.0	200.0	200.0	0.3	0.3	-48.69	17.1	-19.5	25.9	25.3	0.62	41.500		
255.6	255.6	255.6	255.6	0.4	0.4	-48.69	17.1	-19.5	25.9	25.1	0.87	29.650 CC		
300.0	300.0	299.7	299.7	0.5	0.5	-48.61	17.2	-19.6	26.1	25.0	1.07	24.314 ES		
400.0	400.0	398.2	398.1	0.8	0.8	-139.37	20.3	-21.8	30.4	28.8	1.54	19.780 SF		
500.0	499.8	495.5	495.0	1.0	1.0	-141.25	27.4	-27.0	43.2	41.1	2.07	20.881		
600.0	599.3	593.1	591.9	1.2	1.3	-144.25	37.0	-34.1	63.2	60.6	2.64	23.915		
700.0	698.0	689.9	688.0	1.5	1.6	-147.52	46.5	-41.1	87.7	84.5	3.22	27.194		
800.0	796.1	785.8	783.2	1.9	1.8	-150.47	56.0	-48.1	115.5	111.8	3.72	31.039		
900.0	894.2	881.7	878.3	2.3	2.1	-152.39	65.4	-55.0	143.7	139.5	4.20	34.244		
1,000.0	992.3	977.5	973.4	2.7	2.4	-153.67	74.9	-62.0	172.0	167.4	4.68	36.730		

Cathedral Energy Services

Anticollision Report

Company:	Caerus Oil & Gas (NAD 27)	Local Co-ordinate Reference:	Well PUCKETT 12C-1
Project:	Garfield County, CO	TVD Reference:	KB=22' @ 8499.0usft
Reference Site:	S2-T7S-R97W (Puckett Pad)	MD Reference:	KB=22' @ 8499.0usft
Site Error:	0.0usft	North Reference:	True
Reference Well:	PUCKETT 12C-1	Survey Calculation Method:	Minimum Curvature
Well Error:	0.0usft	Output errors are at	2.00 sigma
Reference Wellbore	DD	Database:	USA EDM 5000 Multi Users DB
Reference Design:	Plan #1	Offset TVD Reference:	Offset Datum

Offset Design S2-T7S-R97W (Puckett Pad) - PUCKETT 42B-2 - DD - Plan #1												Offset Site Error:	0.0 usft
Survey Program: 0-ISWWSA MWD												Offset Well Error:	0.0 usft
Reference		Offset		Semi Major Axis		Distance							
Measured Depth (usft)	Vertical Depth (usft)	Measured Depth (usft)	Vertical Depth (usft)	Reference (usft)	Offset (usft)	Highside Toolface (°)	Offset Wellbore Centre +N/-S (usft)	+E/-W (usft)	Between Centres (usft)	Between Ellipses (usft)	Total Uncertainty Axis	Separation Factor	Warning
0.0	0.0	0.0	0.0	0.0	0.0	-58.08	10.2	-16.4	19.3				
100.0	100.0	100.0	100.0	0.1	0.1	-58.08	10.2	-16.4	19.3	19.1	0.18	110.025	
200.0	200.0	200.0	200.0	0.3	0.3	-58.08	10.2	-16.4	19.3	18.7	0.62	30.870	
300.0	300.0	300.0	300.0	0.5	0.5	-58.08	10.2	-16.4	19.3	18.2	1.07	17.954 CC	
300.2	300.2	300.2	300.2	0.5	0.5	-58.08	10.2	-16.4	19.3	18.2	1.08	17.932 ES	
400.0	400.0	399.2	399.2	0.8	0.8	-150.25	11.0	-17.5	21.3	19.8	1.53	13.918 SF	
500.0	499.8	497.4	497.2	1.0	1.0	-153.79	14.7	-22.7	32.3	30.3	2.07	15.635	
600.0	599.3	595.4	594.8	1.2	1.2	-157.37	19.9	-29.9	50.7	48.0	2.65	19.135	
700.0	698.0	692.6	691.6	1.5	1.5	-160.38	25.0	-37.0	73.9	70.7	3.23	22.880	
800.0	796.1	788.9	787.5	1.9	1.7	-162.70	30.1	-44.0	100.8	97.1	3.70	27.247	
900.0	894.2	885.1	883.3	2.3	2.0	-164.10	35.1	-51.1	128.0	123.8	4.14	30.912	
1,000.0	992.3	981.3	979.1	2.7	2.3	-165.02	40.2	-58.1	155.2	150.6	4.59	33.792	
1,100.0	1,090.3	1,077.5	1,074.9	3.1	2.5	-165.66	45.3	-65.2	182.4	177.3	5.05	36.094	

Cathedral Energy Services

Anticollision Report

Company:	Caerus Oil & Gas (NAD 27)	Local Co-ordinate Reference:	Well PUCKETT 12C-1
Project:	Garfield County, CO	TVD Reference:	KB=22' @ 8499.0usft
Reference Site:	S2-T7S-R97W (Puckett Pad)	MD Reference:	KB=22' @ 8499.0usft
Site Error:	0.0usft	North Reference:	True
Reference Well:	PUCKETT 12C-1	Survey Calculation Method:	Minimum Curvature
Well Error:	0.0usft	Output errors are at	2.00 sigma
Reference Wellbore	DD	Database:	USA EDM 5000 Multi Users DB
Reference Design:	Plan #1	Offset TVD Reference:	Offset Datum

Offset Design S2-T7S-R97W (Puckett Pad) - PUCKETT 42C-2 - DD - Plan #1													Offset Site Error:	0.0 usft
Survey Program: 0-ISWWSA MWD													Offset Well Error:	0.0 usft
Reference		Offset		Semi Major Axis			Distance						Warning	
Measured Depth (usft)	Vertical Depth (usft)	Measured Depth (usft)	Vertical Depth (usft)	Reference (usft)	Offset (usft)	Highside Toolface (°)	Offset Wellbore Centre +N/-S (usft)	+E/-W (usft)	Between Centres (usft)	Between Ellipses (usft)	Total Uncertainty Axis	Separation Factor		
0.0	0.0	0.0	0.0	0.0	0.0	-76.80	2.9	-12.4	12.8					
100.0	100.0	100.0	100.0	0.1	0.1	-76.80	2.9	-12.4	12.8	12.6	0.18	72.770		
200.0	200.0	200.0	200.0	0.3	0.3	-76.80	2.9	-12.4	12.8	12.1	0.62	20.418		
300.0	300.0	300.0	300.0	0.5	0.5	-76.80	2.9	-12.4	12.8	11.7	1.07	11.875 CC, ES		
337.4	337.4	337.4	337.4	0.6	0.6	-168.53	2.9	-12.4	12.9	11.7	1.24	10.408		
400.0	400.0	399.8	399.8	0.8	0.8	-169.02	2.9	-12.6	13.6	12.0	1.53	8.854 SF		
500.0	499.8	498.5	498.4	1.0	1.0	-172.83	3.2	-16.4	22.6	20.5	2.06	10.967		
600.0	599.3	596.7	596.3	1.2	1.2	-175.37	3.8	-23.6	40.2	37.6	2.65	15.173		
700.0	698.0	694.0	693.4	1.5	1.4	-176.64	4.4	-30.8	63.1	59.9	3.24	19.509		
800.0	796.1	790.4	789.5	1.9	1.7	-177.37	5.0	-37.9	89.7	86.0	3.69	24.313		
900.0	894.2	886.7	885.6	2.3	1.9	-177.78	5.6	-45.0	116.5	112.4	4.11	28.312		
1,000.0	992.3	983.1	981.7	2.7	2.2	-178.03	6.2	-52.1	143.3	138.7	4.55	31.462		
1,100.0	1,090.3	1,079.4	1,077.7	3.1	2.4	-178.20	6.8	-59.2	170.0	165.0	5.00	33.986		
1,200.0	1,188.4	1,175.8	1,173.8	3.5	2.7	-178.33	7.3	-66.4	196.8	191.4	5.46	36.038		

Cathedral Energy Services

Anticollision Report

Company:	Caerus Oil & Gas (NAD 27)	Local Co-ordinate Reference:	Well PUCKETT 12C-1
Project:	Garfield County, CO	TVD Reference:	KB=22' @ 8499.0usft
Reference Site:	S2-T7S-R97W (Puckett Pad)	MD Reference:	KB=22' @ 8499.0usft
Site Error:	0.0usft	North Reference:	True
Reference Well:	PUCKETT 12C-1	Survey Calculation Method:	Minimum Curvature
Well Error:	0.0usft	Output errors are at	2.00 sigma
Reference Wellbore	DD	Database:	USA EDM 5000 Multi Users DB
Reference Design:	Plan #1	Offset TVD Reference:	Offset Datum

Offset Design S2-T7S-R97W (Puckett Pad) - PUCKETT 42D-2 - DD - Plan #1													Offset Site Error:	0.0 usft
Survey Program: 0-ISWWSA MWD													Offset Well Error:	0.0 usft
Reference		Offset		Semi Major Axis			Distance						Warning	
Measured Depth (usft)	Vertical Depth (usft)	Measured Depth (usft)	Vertical Depth (usft)	Reference (usft)	Offset (usft)	Highside Toolface (°)	Offset Wellbore Centre +N/-S (usft)	+E/-W (usft)	Between Centres (usft)	Between Ellipses (usft)	Total Uncertainty Axis	Separation Factor		
0.0	0.0	0.0	0.0	0.0	0.0	-113.27	-4.0	-9.3	10.1					
100.0	100.0	100.0	100.0	0.1	0.1	-113.27	-4.0	-9.3	10.1	10.0	0.18	57.841		
200.0	200.0	200.0	200.0	0.3	0.3	-113.27	-4.0	-9.3	10.1	9.5	0.62	16.229		
300.0	300.0	300.0	300.0	0.5	0.5	-113.27	-4.0	-9.3	10.1	9.1	1.07	9.439 CC		
300.0	300.0	300.0	300.0	0.5	0.5	-113.27	-4.0	-9.3	10.1	9.1	1.07	9.437 ES		
400.0	400.0	399.5	399.5	0.8	0.7	155.78	-4.7	-10.6	12.2	10.7	1.52	8.005 SF		
500.0	499.8	498.1	497.9	1.0	1.0	159.25	-7.7	-16.2	23.4	21.3	2.07	11.325		
600.0	599.3	596.5	595.9	1.2	1.2	162.28	-11.7	-23.4	41.5	38.8	2.63	15.744		
700.0	698.0	693.7	692.8	1.5	1.4	164.69	-15.6	-30.6	64.5	61.3	3.22	19.999		
800.0	796.1	790.1	788.8	1.9	1.7	166.47	-19.5	-37.7	91.2	87.5	3.70	24.644		
900.0	894.2	886.4	884.8	2.3	1.9	167.50	-23.4	-44.8	118.1	113.9	4.15	28.484		
1,000.0	992.3	982.7	980.7	2.7	2.2	168.15	-27.3	-51.9	145.0	140.4	4.60	31.487		
1,100.0	1,090.3	1,079.0	1,076.7	3.1	2.5	168.59	-31.2	-59.0	171.9	166.8	5.08	33.876		
1,200.0	1,188.4	1,175.3	1,172.6	3.5	2.7	168.91	-35.0	-66.1	198.9	193.3	5.56	35.798		

Cathedral Energy Services

Anticollision Report

Company:	Caerus Oil & Gas (NAD 27)	Local Co-ordinate Reference:	Well PUCKETT 12C-1
Project:	Garfield County, CO	TVD Reference:	KB=22' @ 8499.0usft
Reference Site:	S2-T7S-R97W (Puckett Pad)	MD Reference:	KB=22' @ 8499.0usft
Site Error:	0.0usft	North Reference:	True
Reference Well:	PUCKETT 12C-1	Survey Calculation Method:	Minimum Curvature
Well Error:	0.0usft	Output errors are at	2.00 sigma
Reference Wellbore	DD	Database:	USA EDM 5000 Multi Users DB
Reference Design:	Plan #1	Offset TVD Reference:	Offset Datum

Offset Design S2-T7S-R97W (Puckett Pad) - PUCKETT 43A-2 - DD - Plan #1													Offset Site Error:	0.0 usft
Survey Program: 0-ISCSWA MWD													Offset Well Error:	0.0 usft
Reference		Offset		Semi Major Axis			Distance						Warning	
Measured Depth (usft)	Vertical Depth (usft)	Measured Depth (usft)	Vertical Depth (usft)	Reference (usft)	Offset (usft)	Highside Toolface (°)	Offset Wellbore Centre +N/-S (usft)	+E/-W (usft)	Between Centres (usft)	Between Ellipses (usft)	Total Uncertainty Axis	Separation Factor		
0.0	0.0	0.0	0.0	0.0	0.0	-151.19	-11.3	-6.2	12.9					
100.0	100.0	100.0	100.0	0.1	0.1	-151.19	-11.3	-6.2	12.9	12.7	0.18	73.503		
200.0	200.0	200.0	200.0	0.3	0.3	-151.19	-11.3	-6.2	12.9	12.3	0.62	20.623		
255.6	255.6	255.6	255.6	0.4	0.4	-151.19	-11.3	-6.2	12.9	12.0	0.87	14.734 CC		
300.0	300.0	299.8	299.8	0.5	0.5	-151.04	-11.4	-6.3	13.0	12.0	1.07	12.217 ES		
400.0	400.0	399.0	398.9	0.8	0.7	121.82	-14.3	-8.8	17.2	15.7	1.50	11.496 SF		
500.0	499.8	497.0	496.5	1.0	1.0	132.32	-21.1	-14.6	29.5	27.4	2.02	14.548		
600.0	599.3	595.0	593.9	1.2	1.2	140.30	-29.6	-21.8	48.3	45.7	2.59	18.615		
700.0	698.0	692.0	690.3	1.5	1.5	146.03	-38.0	-29.0	71.8	68.6	3.20	22.403		
800.0	796.1	788.1	785.7	1.9	1.8	150.20	-46.3	-36.1	98.8	95.1	3.74	26.446		
900.0	894.2	884.1	881.1	2.3	2.1	152.67	-54.6	-43.2	126.4	122.1	4.24	29.789		
1,000.0	992.3	980.2	976.5	2.7	2.4	154.27	-62.9	-50.3	154.0	149.3	4.75	32.391		
1,100.0	1,090.3	1,076.2	1,071.9	3.1	2.7	155.37	-71.2	-57.4	181.7	176.5	5.27	34.453		

Cathedral Energy Services

Anticollision Report

Company:	Caerus Oil & Gas (NAD 27)	Local Co-ordinate Reference:	Well PUCKETT 12C-1
Project:	Garfield County, CO	TVD Reference:	KB=22' @ 8499.0usft
Reference Site:	S2-T7S-R97W (Puckett Pad)	MD Reference:	KB=22' @ 8499.0usft
Site Error:	0.0usft	North Reference:	True
Reference Well:	PUCKETT 12C-1	Survey Calculation Method:	Minimum Curvature
Well Error:	0.0usft	Output errors are at	2.00 sigma
Reference Wellbore	DD	Database:	USA EDM 5000 Multi Users DB
Reference Design:	Plan #1	Offset TVD Reference:	Offset Datum

Offset Design S2-T7S-R97W (Puckett Pad) - PUCKETT 43B-2 - DD - Plan #1													Offset Site Error:	0.0 usft
Survey Program: 0-ISCSWA MWD													Offset Well Error:	0.0 usft
Reference		Offset		Semi Major Axis			Distance					Separation Factor	Warning	
Measured Depth (usft)	Vertical Depth (usft)	Measured Depth (usft)	Vertical Depth (usft)	Reference (usft)	Offset (usft)	Highside Toolface (°)	Offset Wellbore Centre +N/-S (usft)	+E/-W (usft)	Between Centres (usft)	Between Ellipses (usft)	Total Uncertainty Axis			
0.0	0.0	0.0	0.0	0.0	0.0	-170.86	-19.3	-3.1	19.5					
100.0	100.0	100.0	100.0	0.1	0.1	-170.86	-19.3	-3.1	19.5	19.4	0.18	111.499		
200.0	200.0	200.0	200.0	0.3	0.3	-170.86	-19.3	-3.1	19.5	18.9	0.62	31.284 CC, ES		
300.0	300.0	299.2	299.2	0.5	0.5	-169.50	-20.6	-3.8	20.9	19.9	1.06	19.822		
400.0	400.0	397.8	397.6	0.8	0.7	104.48	-26.1	-6.9	27.3	25.8	1.50	18.150 SF		
500.0	499.8	495.0	494.1	1.0	1.0	114.88	-35.9	-12.4	40.6	38.6	2.00	20.289		
600.0	599.3	592.1	590.1	1.2	1.3	123.90	-48.7	-19.6	60.8	58.3	2.57	23.641		
700.0	698.0	688.6	685.5	1.5	1.6	130.84	-61.5	-26.7	85.3	82.1	3.19	26.774		
800.0	796.1	784.2	780.0	1.9	2.0	136.24	-74.2	-33.8	113.2	109.4	3.78	29.970		
900.0	894.2	879.8	874.4	2.3	2.3	139.65	-86.8	-40.9	141.8	137.4	4.35	32.626		
1,000.0	992.3	975.3	968.9	2.7	2.6	141.91	-99.5	-48.0	170.7	165.8	4.92	34.692		
1,100.0	1,090.3	1,070.9	1,063.3	3.1	3.0	143.52	-112.2	-55.1	199.8	194.3	5.50	36.319		

Cathedral Energy Services

Anticollision Report

Company:	Caerus Oil & Gas (NAD 27)	Local Co-ordinate Reference:	Well PUCKETT 12C-1
Project:	Garfield County, CO	TVD Reference:	KB=22' @ 8499.0usft
Reference Site:	S2-T7S-R97W (Puckett Pad)	MD Reference:	KB=22' @ 8499.0usft
Site Error:	0.0usft	North Reference:	True
Reference Well:	PUCKETT 12C-1	Survey Calculation Method:	Minimum Curvature
Well Error:	0.0usft	Output errors are at	2.00 sigma
Reference Wellbore	DD	Database:	USA EDM 5000 Multi Users DB
Reference Design:	Plan #1	Offset TVD Reference:	Offset Datum

Reference Depths are relative to KB=22' @ 8499.0usft
Offset Depths are relative to Offset Datum
Central Meridian is -105.500000 °

Coordinates are relative to: PUCKETT 12C-1
Coordinate System is US State Plane 1927 (Exact solution), Colorado Central 502
Grid Convergence at Surface is: -1.69°

