

Section 4
T. 7 S., R. 96 W.

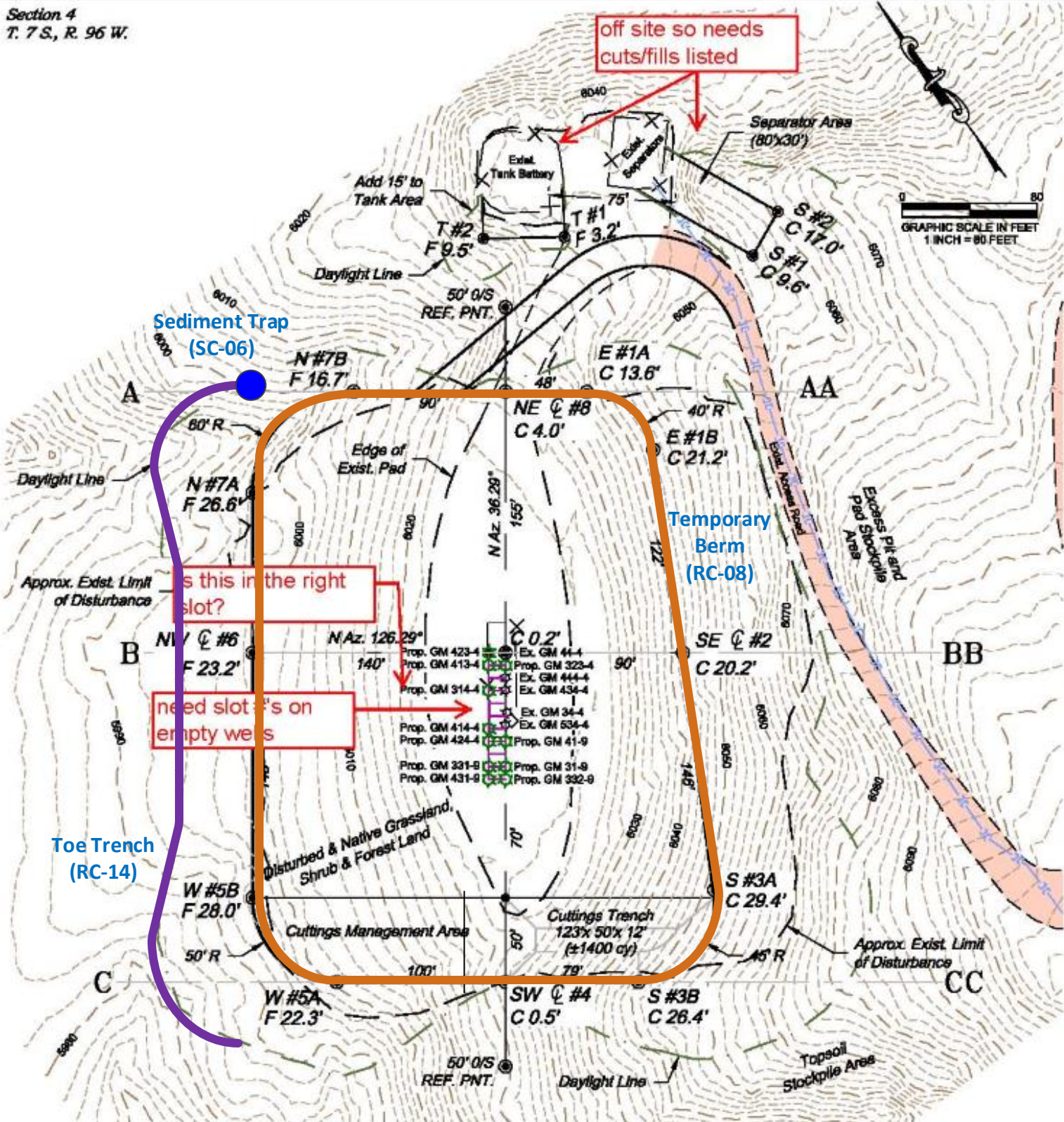

ESTIMATED EARTHWORK QUANTITIES (cy)				
ITEM	CUT	FILL	TOPSOIL	EXCESS
PAD	28040	32060	4790	-8810
PIT	1570			1570
TOTALS	29610	32060	4790	-7240

*NOTE:
 1.) 10% Swell Factor Applied to Earthwork Cut Volume.
 2.) Topsoil Volume Based on 12" Soil Depth.
 3.) Total Disturbed Area = ±4.94 ac.
 4.) Use Excess Pit Material to Complete Pad Surface.

REVISED: 9/12/14

136 East Third Street
 Rifle, Colorado 81650
 Ph. (970) 625-2720
 Fax (970) 625-2779



SCALE: 1" = 80'
 DATE: 9/10/14
 PLAT: 2 of 7
 PROJECT: Valley
 DFT: CS

Construction Plan Prepared for:
WPXENERGY
 WPX Energy Rocky Mountain, LLC
 GM 34-4 Drill Pad - Plat 2
 Construction SW BMP's

K:\2014\1000 Valley\GM 34-4\Plat 2.dwg, 9/12/2014 9:28:24 AM