



CARRIZO OIL & GAS, INC.

Field: Niobrara CONZ'83
Site: Shull 1-25-9-60 Pad
Well: 6-25-9-60
Wellpath: Original Hole
Plan: Plan #1a



Precision
Directional Services

CASING DETAILS

No.	TVD	MD	Name	Size
1	1400.00	1404.70	9 5/8"	9.625
2	6050.34	6285.14	7"	7.000

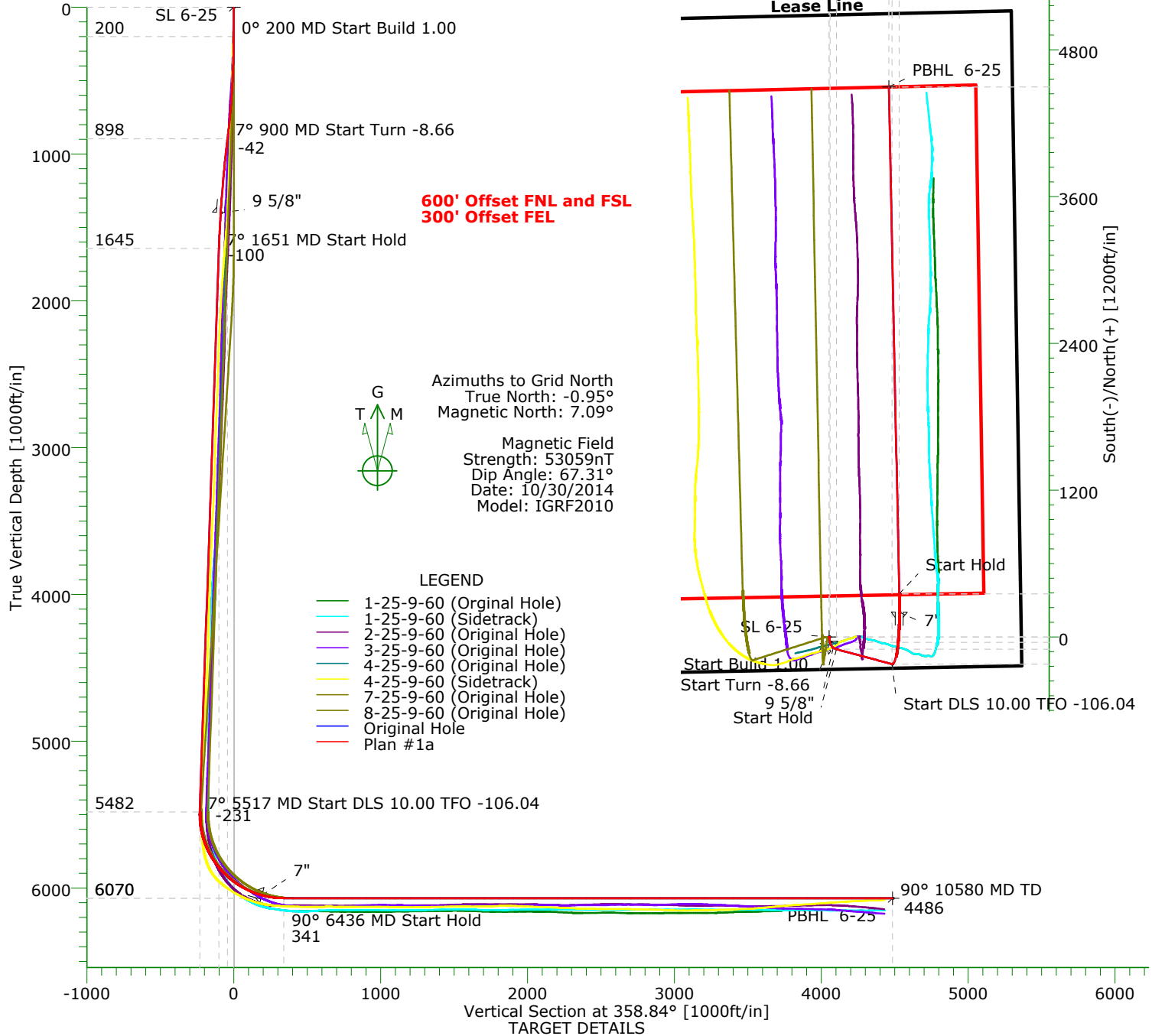

Name	TVD	+N/-S	+E/-W	Northing	Easting	Latitude	Longitude	Shape
SL 6-25	0.00	0.00	0.00	1506554.51	3405829.01	40°42'52.844N	104°02'09.676W	Point
PBHL 6-25	6070.00	4496.36	488.74	1511050.87	3406317.75	40°43'37.187N	104°02'02.364W	Point

SECTION DETAILS

Sec	MD	Inc	Azi	TVD	+N/-S	+E/-W	DLeg	TFace	VSec	Target
1	0.00	0.00	170.00	0.00	0.00	0.00	0.00	0.00	0.00	
2	200.00	0.00	170.00	200.00	0.00	0.00	0.00	170.00	0.00	
3	900.00	7.00	170.00	898.26	-42.06	7.42	1.00	170.00	-42.20	
4	1650.89	7.00	105.00	1644.62	-99.04	59.63	1.00	237.69	-100.23	
5	5516.77	7.00	105.00	5481.69	-220.98	514.71	0.00	0.00	-231.36	
6	6436.21	90.00	358.84	6070.00	352.93	572.51	10.00	-106.04	341.27	
7	10580.48	90.00	358.84	6070.00	4496.36	488.74	0.00	0.00	4485.54	PBHL 6-25

Plan: Plan #1a (6-25-9-60/Original Hole)

Created By: Shane Nelson

Date: 10/01/2014

PRECISION DIRECTIONAL SERVICES, INC.

713.435.6250

Precision Directional Services, Inc.

Planning Report

Company: CARRIZO OIL & GAS, INC. Field: Niobrara CONZ'83 Site: Shull 1-25-9-60 Pad Well: 6-25-9-60 Wellpath: Original Hole	Date: 10/01/2014 Co-ordinate(NE) Reference: Well: 6-25-9-60, Grid North Vertical (TVD) Reference: 4887'GL+17'KB 4904.0 Section (VS) Reference: Well (0.00N,0.00E,358.84Azi) Plan: Plan #1a	Time: 13:43:58 Page: 1
---	---	---

Field: Niobrara CONZ'83 Map System: US State Plane Coordinate System 1983 Geo Datum: GRS 1980 Sys Datum: Mean Sea Level	Map Zone: Colorado, Northern Zone Coordinate System: Well Centre Geomagnetic Model: IGRF2010
--	---

Site: Shull 1-25-9-60 Pad Weld County, CO Site Position: From: Map Position Uncertainty: 0.00 ft Ground Level: 4943.00 ft	Northing: 1511404.05 ft Easting: 3406027.06 ft Latitude: 40 43 40.724 N Longitude: 104 2 6.064 W North Reference: Grid Grid Convergence: 0.95 deg
---	--

Well: 6-25-9-60 Well Position: +N/-S -4849.54 ft +E/-W -198.05 ft Position Uncertainty: 0.00 ft	Slot Name: Well Position: +N/-S -4849.54 ft +E/-W -198.05 ft Position Uncertainty: 0.00 ft
---	--

Wellpath: Original Hole Current Datum: 4887'GL+17'KB Magnetic Data: 10/30/2014 Field Strength: 53059 nT Vertical Section: Depth From (TVD) ft	Drilled From: Surface Tie-on Depth: 0.00 ft Above System Datum: Mean Sea Level Declination: 8.04 deg Mag Dip Angle: 67.31 deg +E/-W ft Direction deg
0.00	0.00

Plan: Plan #1a adj FSL to 600' Principal: Yes	Date Composed: 10/01/2014 Version: 1 Tied-to: From Surface
---	---

Plan Section Information										
MD ft	Incl deg	Azim deg	TVD ft	+N/-S ft	+E/-W ft	DLS deg/100ft	Build deg/100ft	Turn deg/100ft	TFO deg	Target
0.00	0.00	0.00	0.00	0.00	0.00	0.00	0.00	0.00	0.00	
200.00	0.00	0.00	200.00	0.00	0.00	0.00	0.00	0.00	0.00	
900.00	7.00	170.00	898.26	-42.06	7.42	1.00	1.00	0.00	170.00	
1650.89	7.00	105.00	1644.62	-99.04	59.63	1.00	0.00	-8.66	237.69	
5516.77	7.00	105.00	5481.69	-220.98	514.71	0.00	0.00	0.00	0.00	
6436.21	90.00	358.84	6070.00	352.93	572.51	10.00	9.03	-11.55	-106.04	
10580.48	90.00	358.84	6070.00	4496.36	488.74	0.00	0.00	0.00	0.00	PBHL 6-25

Survey										
MD ft	Incl deg	Azim deg	TVD ft	+N/-S ft	+E/-W ft	VS ft	DLS deg/100ft	Build deg/100ft	Turn deg/100ft	Tool/Comment
0.00	0.00	0.00	0.00	0.00	0.00	0.00	0.00	0.00	0.00	
100.00	0.00	0.00	100.00	0.00	0.00	0.00	0.00	0.00	0.00	
200.00	0.00	0.00	200.00	0.00	0.00	0.00	0.00	0.00	0.00	
300.00	1.00	170.00	299.99	-0.86	0.15	-0.86	1.00	1.00	0.00	
400.00	2.00	170.00	399.96	-3.44	0.61	-3.45	1.00	1.00	0.00	
500.00	3.00	170.00	499.86	-7.73	1.36	-7.76	1.00	1.00	0.00	
600.00	4.00	170.00	599.68	-13.74	2.42	-13.79	1.00	1.00	0.00	
700.00	5.00	170.00	699.37	-21.47	3.79	-21.54	1.00	1.00	0.00	
800.00	6.00	170.00	798.90	-30.91	5.45	-31.01	1.00	1.00	0.00	
900.00	7.00	170.00	898.26	-42.06	7.42	-42.20	1.00	1.00	0.00	
1000.00	6.52	162.54	997.57	-53.48	10.18	-53.67	1.00	-0.48	-7.46	
1100.00	6.17	154.06	1096.96	-63.72	14.23	-64.00	1.00	-0.35	-8.48	
1200.00	5.96	144.79	1196.40	-72.79	19.57	-73.17	1.00	-0.21	-9.28	
1300.00	5.92	135.12	1295.86	-80.69	26.21	-81.20	1.00	-0.04	-9.67	
1400.00	6.04	125.58	1395.32	-87.40	34.12	-88.07	1.00	0.12	-9.54	

Precision Directional Services, Inc.

Planning Report

Company: CARRIZO OIL & GAS, INC.
Field: Niobrara CONZ'83
Site: Shull 1-25-9-60 Pad
Well: 6-25-9-60
Wellpath: Original Hole

Date: 10/01/2014
Co-ordinate(NE) Reference: Well: 6-25-9-60, Grid North
Vertical (TVD) Reference: 4887'GL+17'KB 4904.0
Section (VS) Reference: Well (0.00N,0.00E,358.84Azi)
Plan: Plan #1a

Page: 2

Survey

MD ft	Incl deg	Azim deg	TVD ft	+N/-S ft	+E/-W ft	VS ft	DLS deg/100ft	Build deg/100ft	Turn deg/100ft	Tool/Comment
1404.70	6.05	125.14	1400.00	-87.69	34.53	-88.37	1.00	0.21	-9.28	9 5/8"
1500.00	6.32	116.66	1494.74	-92.93	43.32	-93.79	1.00	0.28	-8.90	
1600.00	6.74	108.67	1594.10	-97.28	53.81	-98.35	1.00	0.42	-7.99	
1650.89	7.00	105.00	1644.62	-99.04	59.63	-100.23	1.00	0.51	-7.20	
1700.00	7.00	105.00	1693.37	-100.59	65.41	-101.90	0.00	0.00	0.00	
1800.00	7.00	105.00	1792.62	-103.75	77.19	-105.29	0.00	0.00	0.00	
1900.00	7.00	105.00	1891.87	-106.90	88.96	-108.68	0.00	0.00	0.00	
2000.00	7.00	105.00	1991.13	-110.05	100.73	-112.07	0.00	0.00	0.00	
2100.00	7.00	105.00	2090.38	-113.21	112.50	-115.46	0.00	0.00	0.00	
2200.00	7.00	105.00	2189.64	-116.36	124.27	-118.85	0.00	0.00	0.00	
2300.00	7.00	105.00	2288.89	-119.52	136.04	-122.25	0.00	0.00	0.00	
2400.00	7.00	105.00	2388.15	-122.67	147.82	-125.64	0.00	0.00	0.00	
2500.00	7.00	105.00	2487.40	-125.83	159.59	-129.03	0.00	0.00	0.00	
2600.00	7.00	105.00	2586.66	-128.98	171.36	-132.42	0.00	0.00	0.00	
2700.00	7.00	105.00	2685.91	-132.13	183.13	-135.81	0.00	0.00	0.00	
2800.00	7.00	105.00	2785.17	-135.29	194.90	-139.21	0.00	0.00	0.00	
2900.00	7.00	105.00	2884.42	-138.44	206.67	-142.60	0.00	0.00	0.00	
3000.00	7.00	105.00	2983.68	-141.60	218.45	-145.99	0.00	0.00	0.00	
3100.00	7.00	105.00	3082.93	-144.75	230.22	-149.38	0.00	0.00	0.00	
3200.00	7.00	105.00	3182.18	-147.90	241.99	-152.77	0.00	0.00	0.00	
3300.00	7.00	105.00	3281.44	-151.06	253.76	-156.17	0.00	0.00	0.00	
3400.00	7.00	105.00	3380.69	-154.21	265.53	-159.56	0.00	0.00	0.00	
3500.00	7.00	105.00	3479.95	-157.37	277.30	-162.95	0.00	0.00	0.00	
3600.00	7.00	105.00	3579.20	-160.52	289.08	-166.34	0.00	0.00	0.00	
3700.00	7.00	105.00	3678.46	-163.68	300.85	-169.73	0.00	0.00	0.00	
3800.00	7.00	105.00	3777.71	-166.83	312.62	-173.12	0.00	0.00	0.00	
3900.00	7.00	105.00	3876.97	-169.98	324.39	-176.52	0.00	0.00	0.00	
4000.00	7.00	105.00	3976.22	-173.14	336.16	-179.91	0.00	0.00	0.00	
4100.00	7.00	105.00	4075.48	-176.29	347.93	-183.30	0.00	0.00	0.00	
4200.00	7.00	105.00	4174.73	-179.45	359.71	-186.69	0.00	0.00	0.00	
4300.00	7.00	105.00	4273.99	-182.60	371.48	-190.08	0.00	0.00	0.00	
4400.00	7.00	105.00	4373.24	-185.76	383.25	-193.48	0.00	0.00	0.00	
4500.00	7.00	105.00	4472.49	-188.91	395.02	-196.87	0.00	0.00	0.00	
4600.00	7.00	105.00	4571.75	-192.06	406.79	-200.26	0.00	0.00	0.00	
4700.00	7.00	105.00	4671.00	-195.22	418.56	-203.65	0.00	0.00	0.00	
4800.00	7.00	105.00	4770.26	-198.37	430.34	-207.04	0.00	0.00	0.00	
4900.00	7.00	105.00	4869.51	-201.53	442.11	-210.44	0.00	0.00	0.00	
5000.00	7.00	105.00	4968.77	-204.68	453.88	-213.83	0.00	0.00	0.00	
5100.00	7.00	105.00	5068.02	-207.83	465.65	-217.22	0.00	0.00	0.00	
5200.00	7.00	105.00	5167.28	-210.99	477.42	-220.61	0.00	0.00	0.00	
5300.00	7.00	105.00	5266.53	-214.14	489.19	-224.00	0.00	0.00	0.00	
5400.00	7.00	105.00	5365.79	-217.30	500.97	-227.39	0.00	0.00	0.00	
5500.00	7.00	105.00	5465.04	-220.45	512.74	-230.79	0.00	0.00	0.00	
5516.77	7.00	105.00	5481.69	-220.98	514.71	-231.36	0.00	0.00	0.00	
5600.00	9.26	45.17	5564.21	-217.57	524.38	-228.14	10.00	2.72	-71.88	
5700.00	17.67	20.57	5661.44	-197.63	535.44	-208.43	10.00	8.41	-24.61	
5800.00	27.16	12.13	5753.81	-161.01	545.60	-172.03	10.00	9.49	-8.44	
5900.00	36.91	7.88	5838.48	-108.82	554.53	-120.02	10.00	9.75	-4.25	
6000.00	46.75	5.21	5912.91	-42.64	561.97	-54.00	10.00	9.84	-2.66	
6100.00	56.64	3.29	5974.82	35.53	567.69	24.03	10.00	9.89	-1.92	
6200.00	66.55	1.77	6022.33	123.29	571.52	111.70	10.00	9.91	-1.52	
6285.14	75.00	0.65	6050.34	203.59	573.21	191.95	10.00	9.92	-1.32	7"
6300.00	76.47	0.47	6054.00	217.99	573.35	206.34	10.00	9.93	-1.25	

Precision Directional Services, Inc.

Planning Report

Company: CARRIZO OIL & GAS, INC.
Field: Niobrara CONZ'83
Site: Shull 1-25-9-60 Pad
Well: 6-25-9-60
Wellpath: Original Hole

Date: 10/01/2014
Co-ordinate(NE) Reference: Well: 6-25-9-60, Grid North
Vertical (TVD) Reference: 4887'GL+17'KB 4904.0
Section (VS) Reference: Well (0.00N,0.00E,358.84Azi)
Plan: Plan #1a

Page: 3

Survey

MD ft	Incl deg	Azim deg	TVD ft	+N/-S ft	+E/-W ft	VS ft	DLS deg/100ft	Build deg/100ft	Turn deg/100ft	Tool/Comment
6400.00	86.40	359.27	6068.87	316.75	573.10	305.08	10.00	9.93	-1.20	
6436.21	90.00	358.84	6070.00	352.93	572.51	341.27	10.00	9.93	-1.17	
6500.00	90.00	358.84	6070.00	416.71	571.22	405.06	0.00	0.00	0.00	
6600.00	90.00	358.84	6070.00	516.69	569.20	505.06	0.00	0.00	0.00	
6700.00	90.00	358.84	6070.00	616.67	567.17	605.06	0.00	0.00	0.00	
6800.00	90.00	358.84	6070.00	716.65	565.15	705.06	0.00	0.00	0.00	
6900.00	90.00	358.84	6070.00	816.63	563.13	805.06	0.00	0.00	0.00	
7000.00	90.00	358.84	6070.00	916.61	561.11	905.06	0.00	0.00	0.00	
7100.00	90.00	358.84	6070.00	1016.59	559.09	1005.06	0.00	0.00	0.00	
7200.00	90.00	358.84	6070.00	1116.57	557.07	1105.06	0.00	0.00	0.00	
7300.00	90.00	358.84	6070.00	1216.55	555.05	1205.06	0.00	0.00	0.00	
7400.00	90.00	358.84	6070.00	1316.53	553.03	1305.06	0.00	0.00	0.00	
7500.00	90.00	358.84	6070.00	1416.51	551.00	1405.06	0.00	0.00	0.00	
7600.00	90.00	358.84	6070.00	1516.49	548.98	1505.06	0.00	0.00	0.00	
7700.00	90.00	358.84	6070.00	1616.46	546.96	1605.06	0.00	0.00	0.00	
7800.00	90.00	358.84	6070.00	1716.44	544.94	1705.06	0.00	0.00	0.00	
7900.00	90.00	358.84	6070.00	1816.42	542.92	1805.06	0.00	0.00	0.00	
8000.00	90.00	358.84	6070.00	1916.40	540.90	1905.06	0.00	0.00	0.00	
8100.00	90.00	358.84	6070.00	2016.38	538.88	2005.06	0.00	0.00	0.00	
8200.00	90.00	358.84	6070.00	2116.36	536.86	2105.06	0.00	0.00	0.00	
8300.00	90.00	358.84	6070.00	2216.34	534.83	2205.06	0.00	0.00	0.00	
8400.00	90.00	358.84	6070.00	2316.32	532.81	2305.06	0.00	0.00	0.00	
8500.00	90.00	358.84	6070.00	2416.30	530.79	2405.06	0.00	0.00	0.00	
8600.00	90.00	358.84	6070.00	2516.28	528.77	2505.06	0.00	0.00	0.00	
8700.00	90.00	358.84	6070.00	2616.26	526.75	2605.06	0.00	0.00	0.00	
8800.00	90.00	358.84	6070.00	2716.24	524.73	2705.06	0.00	0.00	0.00	
8900.00	90.00	358.84	6070.00	2816.22	522.71	2805.06	0.00	0.00	0.00	
9000.00	90.00	358.84	6070.00	2916.20	520.69	2905.06	0.00	0.00	0.00	
9100.00	90.00	358.84	6070.00	3016.18	518.66	3005.06	0.00	0.00	0.00	
9200.00	90.00	358.84	6070.00	3116.16	516.64	3105.06	0.00	0.00	0.00	
9300.00	90.00	358.84	6070.00	3216.14	514.62	3205.06	0.00	0.00	0.00	
9400.00	90.00	358.84	6070.00	3316.12	512.60	3305.06	0.00	0.00	0.00	
9500.00	90.00	358.84	6070.00	3416.10	510.58	3405.06	0.00	0.00	0.00	
9600.00	90.00	358.84	6070.00	3516.08	508.56	3505.06	0.00	0.00	0.00	
9700.00	90.00	358.84	6070.00	3616.06	506.54	3605.06	0.00	0.00	0.00	
9800.00	90.00	358.84	6070.00	3716.04	504.52	3705.06	0.00	0.00	0.00	
9900.00	90.00	358.84	6070.00	3816.02	502.49	3805.06	0.00	0.00	0.00	
10000.00	90.00	358.84	6070.00	3916.00	500.47	3905.06	0.00	0.00	0.00	
10100.00	90.00	358.84	6070.00	4015.97	498.45	4005.06	0.00	0.00	0.00	
10200.00	90.00	358.84	6070.00	4115.95	496.43	4105.06	0.00	0.00	0.00	
10300.00	90.00	358.84	6070.00	4215.93	494.41	4205.06	0.00	0.00	0.00	
10400.00	90.00	358.84	6070.00	4315.91	492.39	4305.06	0.00	0.00	0.00	
10500.00	90.00	358.84	6070.00	4415.89	490.37	4405.06	0.00	0.00	0.00	
10580.48	90.00	358.84	6070.00	4496.36	488.74	4485.54	0.00	0.00	0.00	PBHL 6-25

Targets

Name	Description	Dir.	TVD ft	+N/-S ft	+E/-W ft	Map Northing ft	Map Easting ft	<---- Latitude ---->			<--- Longitude --->				
	Dip.							Deg	Min	Sec	Deg	Min	Sec		
SL 6-25			0.00	0.00	0.00	1506554.51	3405829.01	40	42	52.844	N	104	2	9.676	W
PBHL 6-25			6070.00	4496.36	488.74	1511050.87	3406317.75	40	43	37.187	N	104	2	2.364	W

Precision Directional Services, Inc.

Planning Report

Company: CARRIZO OIL & GAS, INC.

Field: Niobrara CONZ'83

Site: Shull 1-25-9-60 Pad

Well: 6-25-9-60

Wellpath: Original Hole

Date: 10/01/2014

Time: 13:43:58

Page: 4

Co-ordinate(NE) Reference: Well: 6-25-9-60, Grid North

Vertical (TVD) Reference: 4887'GL+17'KB 4904.0

Section (VS) Reference: Well (0.00N,0.00E,358.84Azi)

Plan: Plan #1a

Casing Points

MD ft	TVD ft	Diameter in	Hole Size in	Name
1404.70	1400.00	9.625	12.250	9 5/8"
6285.14	6050.34	7.000	8.500	7"