

Location Drawing

THOMSEN 4N-31HZ

Horizontal Multi Well Pad

SE¼ NW¼ SECTION 7, TOWNSHIP 2 NORTH, RANGE 65 WEST OF THE 6TH PRINCIPAL MERIDIAN

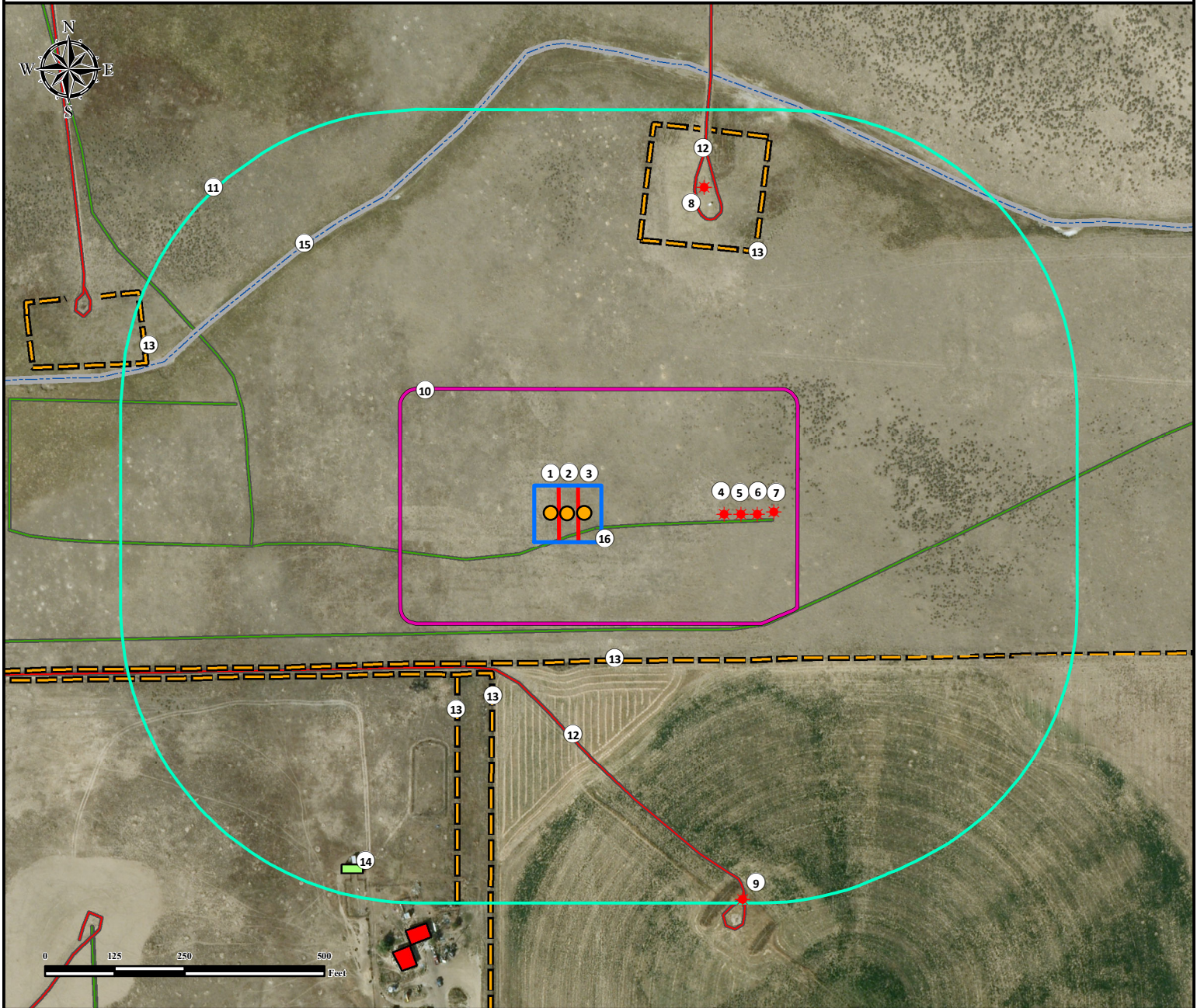

- | | | |
|---|---|---|
| 1. Proposed Well THOMSEN 2N-31HZ.
2. Proposed Well THOMSEN 4N-31HZ.
3. Proposed Well THOMSEN 5N-31HZ.
4. Existing Well THOMSEN 13C-18HZ is ±280' E.
5. Existing Well THOMSEN 14N-18HZ is ±310' E.
6. Existing Well THOMSEN 36C-18HZ is ±342' E.
7. Existing Well THOMSEN 36N-18HZ is ±370' E.
8. Existing Well THOMSEN USXX 7-6 is ±633' NE. | 9. Existing Well BUUM 11-7 is ±756' SE.
10. Operational Disturbance Area.
11. 500' Radius.
12. Private Roads are ±308' SW and ±583' NE.
13. Fences are ±266' S, ±316' SW, ±350' SW, ±506' NE, and ±800' NW. | 14. Building is ±726' SW.
15. Concrete Ditch is ±656' N.
16. Pump Jack Operations Area. |
|---|---|---|

Legend <div style="display: flex; justify-content: space-between;"> <div> ● Proposed Well ★ Existing Well </div> <div> Disturbance Area 500' Radius Pump Jack Operations Area Building Unit Building </div> <div> — Private Road Fence — Pipeline Concrete Ditch </div> </div>		Reference Location ** All measurements are made from Reference Well THOMSEN 4N-31HZ** Lat: 40.153757° Long:-104.710540° Elevation: 4949 Feet Surface Use: Rangeland
		Nearest Building Unit: ±774' SW Prepared for: Anadarko KERR-MCGEE OIL & GAS ONSHORE LP



Use our resources to find yours!
www.petro-fs.com
 (303) 928-7128

Field Date: 06/24/2014
 Drafting Date: 09/23/2014
 Drafter: SMG
 Revision: 1

Data Source:
 - Aerial courtesy of Anadarko Petroleum Corporation (2010)