



U , 201

Noble Energy
1625 Broadway, Suite 2200
Denver, CO 80202

..... Client - Noble Energy
Well - \ ' =V
Rig - H&P 277
County - Weld Co. #\

Please find enclosed a copy of the End of Well Report (EOW). This report consists of color planned vs. actual well drawings, proposed and actual surveys, morning reports, BHAs, drilling parameters, and post well graphs.

If your office requires further information, please feel free to contact me.

Sincerely,

Kelly Dorow
Operations Support Assistant



Steve Boyd

President

6701 Corporation Parkway, Ste 150

Fort Worth, TX 76126

sboyd@integritydirectional.com

Charlie Hodges

V.P. Operations

1685 Hwy 578

Winnsboro, LA 71295

chodges@integritydirectional.com

Table of Contents

Plan vs. Actual

Final Survey Report

Daily Drilling Reports

Bottom Hole Assembly Reports

End of Well BHA Summary

Drilling Parameters

Activity Graph

Days vs. Depth

Performance Charts



Plan vs. Actual



Noble Energy, Inc

Weld County, CO (NAD 83)
Sec 10, T02N-R64W (Oscar Y10 Pad)
Oscar Y10-79-1HN
Wellbore #1

Design: OH

Final Survey Report

14 March, 2014





IDS

Final Survey Report



Company: Noble Energy, Inc	Local Co-ordinate Reference: Well Oscar Y10-79-1HN
Project: Weld County, CO (NAD 83)	TVD Reference: Well @ 4973.0usft (HP330)
Site: Sec 10, T02N-R64W (Oscar Y10 Pad)	MD Reference: Well @ 4973.0usft (HP330)
Well: Oscar Y10-79-1HN	North Reference: Grid
Wellbore: Wellbore #1	Survey Calculation Method: Minimum Curvature
Design: OH	Database: EDM 5000.1 Single User Db

Project Weld County, CO (NAD 83)			
Map System: US State Plane 1983	System Datum: Mean Sea Level		
Geo Datum: North American Datum 1983			
Map Zone: Colorado Northern Zone			

Site Sec 10, T02N-R64W (Oscar Y10 Pad)			
Site Position:	Northing: 1,299,747.16 usft	Latitude: 40° 9' 8.100 N	
From: Lat/Long	Easting: 3,267,100.75 usft	Longitude: 104° 32' 39.984 W	
Position Uncertainty: 0.0 usft	Slot Radius: 13-3/16"	Grid Convergence: 0.62 °	

Well Oscar Y10-79-1HN			
Well Position	+N-S 0.0 usft	Northing: 1,299,745.94 usft	Latitude: 40° 9' 8.100 N
	+E-W 0.0 usft	Easting: 3,266,988.94 usft	Longitude: 104° 32' 41.424 W
Position Uncertainty	0.0 usft	Wellhead Elevation: 0.0 usft	Ground Level: 4,943.0 usft

Wellbore Wellbore #1					
Magnetics	Model Name	Sample Date	Declination (°)	Dip Angle (°)	Field Strength (nT)
	IGRF2010	12/16/2013	8.39	66.80	52,759

Design OH					
Audit Notes:					
Version: 1.0	Phase: ACTUAL	Tie On Depth: 0.0			
Vertical Section:	Depth From (TVD) (usft)	+N-S (usft)	+E-W (usft)	Direction (°)	
	0.0	0.0	0.0	357.54	

Survey Program		Date 3/14/2014			
From (usft)	To (usft)	Survey (Wellbore)	Tool Name	Description	
387.0	1,162.0	Survey #1 (Wellbore #1)	EMS	EMS - Standard	
1,194.0	14,437.0	Survey #2 (Wellbore #1)	MWD	MWD - Standard	

Survey								
MD (usft)	Inc (°)	Azi (azimuth) (°)	TVD (usft)	N/S (usft)	E/W (usft)	V. Sec (usft)	DLeg (°/100usft)	
0.0	0.00	0.00	0.0	0.0	0.0	0.0	0.0	0.00
387.0	0.70	279.80	387.0	0.4	-2.3	0.5	0.18	
765.0	0.50	339.70	765.0	2.3	-5.2	2.6	0.16	
1,162.0	0.50	164.10	1,162.0	2.3	-5.3	2.5	0.25	
1,194.0	0.30	149.00	1,194.0	2.1	-5.2	2.3	0.70	
First MWD								
1,286.0	0.40	134.50	1,286.0	1.7	-4.9	1.9	0.14	
1,379.0	0.30	57.00	1,379.0	1.6	-4.4	1.8	0.48	
1,473.0	1.80	329.80	1,472.9	3.0	-5.0	3.2	1.93	
1,565.0	1.70	331.40	1,564.9	5.4	-6.3	5.7	0.12	
1,660.0	3.60	313.80	1,659.8	8.7	-9.2	9.1	2.15	

Company:	Noble Energy, Inc	Local Co-ordinate Reference:	Well Oscar Y10-79-1HN
Project:	Weld County, CO (NAD 83)	TVD Reference:	Well @ 4973.0usft (HP330)
Site:	Sec 10, T02N-R64W (Oscar Y10 Pad)	MD Reference:	Well @ 4973.0usft (HP330)
Well:	Oscar Y10-79-1HN	North Reference:	Grid
Wellbore:	Wellbore #1	Survey Calculation Method:	Minimum Curvature
Design:	OH	Database:	EDM 5000.1 Single User Db

Survey								
MD (usft)	Inc (°)	Azi (azimuth) (°)	TVD (usft)	N/S (usft)	E/W (usft)	V. Sec (usft)	DLeg (°/100usft)	
1,752.0	5.50	315.80	1,751.5	13.9	-14.3	14.5	2.07	
1,844.0	8.20	310.50	1,842.8	21.3	-22.4	22.3	3.01	
1,937.0	8.10	312.20	1,934.9	30.0	-32.3	31.4	0.28	
2,030.0	10.80	314.80	2,026.6	40.6	-43.3	42.4	2.94	
2,125.0	12.10	308.60	2,119.7	53.0	-57.4	55.5	1.88	
2,220.0	10.90	307.00	2,212.8	64.7	-72.4	67.7	1.31	
2,316.0	12.40	307.40	2,306.9	76.4	-87.8	80.1	1.56	
2,411.0	11.00	307.50	2,399.9	88.1	-103.1	92.4	1.47	
2,506.0	13.20	306.70	2,492.8	100.1	-119.0	105.1	2.32	
2,601.0	11.30	306.60	2,585.6	112.1	-135.2	117.8	2.00	
2,696.0	12.70	306.40	2,678.5	123.9	-151.1	130.3	1.47	
2,791.0	13.30	310.10	2,771.1	137.1	-167.8	144.2	1.08	
2,886.0	12.40	309.80	2,863.7	150.7	-184.0	158.4	0.95	
2,982.0	11.90	311.20	2,957.6	163.8	-199.4	172.2	0.60	
3,077.0	12.90	302.70	3,050.3	176.0	-215.7	185.1	2.19	
3,172.0	11.40	302.70	3,143.2	186.8	-232.5	196.6	1.58	
3,267.0	11.80	299.90	3,236.3	196.7	-248.8	207.2	0.73	
3,362.0	11.70	311.70	3,329.3	208.0	-264.4	219.1	2.53	
3,457.0	9.90	310.20	3,422.6	219.6	-277.9	231.4	1.92	
3,552.0	8.40	305.90	3,516.4	229.0	-289.7	241.2	1.73	
3,647.0	6.90	304.70	3,610.6	236.3	-300.0	249.0	1.59	
3,742.0	5.30	302.70	3,705.0	241.9	-308.4	254.9	1.70	
3,837.0	4.00	299.10	3,799.7	245.9	-315.0	259.2	1.40	
3,932.0	1.90	319.20	3,894.6	248.7	-318.9	262.2	2.43	
4,028.0	1.40	326.20	3,990.5	250.9	-320.6	264.4	0.56	
4,123.0	1.10	314.60	4,085.5	252.5	-321.9	266.1	0.41	
4,218.0	1.00	178.40	4,180.5	252.3	-322.6	265.9	2.05	
4,313.0	1.10	180.40	4,275.5	250.6	-322.5	264.2	0.11	
4,408.0	1.10	178.40	4,370.5	248.7	-322.5	262.3	0.04	
4,504.0	1.60	184.90	4,466.4	246.5	-322.6	260.1	0.54	
4,599.0	1.10	188.00	4,561.4	244.2	-322.8	257.9	0.53	
4,694.0	1.50	142.90	4,656.4	242.4	-322.2	256.0	1.12	
4,789.0	1.60	107.80	4,751.4	241.0	-320.2	254.5	0.99	
4,883.0	1.70	102.90	4,845.3	240.2	-317.6	253.7	0.18	
4,978.0	1.80	112.60	4,940.3	239.4	-314.9	252.6	0.33	
5,074.0	2.20	64.70	5,036.2	239.6	-311.8	252.7	1.73	
5,169.0	1.30	59.60	5,131.2	240.9	-309.2	253.9	0.96	
5,264.0	1.80	24.50	5,226.1	242.8	-307.7	255.8	1.10	
5,359.0	2.60	2.20	5,321.1	246.3	-307.0	259.2	1.22	
5,454.0	2.90	359.20	5,416.0	250.9	-306.9	263.8	0.35	
5,549.0	2.00	0.80	5,510.9	254.9	-306.9	267.9	0.95	
5,644.0	1.20	354.00	5,605.8	257.6	-307.0	270.5	0.86	
5,740.0	1.30	359.40	5,701.8	259.7	-307.1	272.6	0.16	
5,835.0	1.40	4.20	5,796.8	261.9	-307.1	274.8	0.16	
5,930.0	1.60	2.50	5,891.8	264.4	-306.9	277.3	0.22	



IDS

Final Survey Report



Company:	Noble Energy, Inc	Local Co-ordinate Reference:	Well Oscar Y10-79-1HN
Project:	Weld County, CO (NAD 83)	TVD Reference:	Well @ 4973.0usft (HP330)
Site:	Sec 10, T02N-R64W (Oscar Y10 Pad)	MD Reference:	Well @ 4973.0usft (HP330)
Well:	Oscar Y10-79-1HN	North Reference:	Grid
Wellbore:	Wellbore #1	Survey Calculation Method:	Minimum Curvature
Design:	OH	Database:	EDM 5000.1 Single User Db

Survey

MD (usft)	Inc (°)	Azi (azimuth) (°)	TVD (usft)	N/S (usft)	E/W (usft)	V. Sec (usft)	DLeg (°/100usft)
6,025.0	1.80	352.30	5,986.7	267.2	-307.1	280.1	0.38
6,119.0	0.80	346.50	6,080.7	269.3	-307.4	282.2	1.07
6,208.0	1.10	332.30	6,169.7	270.6	-307.9	283.6	0.43
6,256.0	1.80	345.20	6,217.7	271.8	-308.4	284.8	1.60
6,303.0	5.60	13.80	6,264.6	274.7	-308.0	287.7	8.75
6,351.0	7.80	9.10	6,312.2	280.2	-306.9	293.1	4.72
6,398.0	11.40	5.30	6,358.6	288.0	-306.0	300.9	7.77
6,446.0	16.20	0.80	6,405.2	299.4	-305.5	312.2	10.24
6,493.0	20.80	0.00	6,449.7	314.3	-305.4	327.1	9.80
6,541.0	24.90	0.10	6,493.9	333.0	-305.3	345.8	8.54
6,588.0	29.30	356.00	6,535.8	354.3	-306.1	367.1	10.17
6,636.0	34.40	353.50	6,576.5	379.5	-308.5	392.4	10.97
6,683.0	37.60	356.00	6,614.6	407.0	-311.0	420.0	7.49
6,730.0	41.70	355.90	6,650.7	437.0	-313.1	450.0	8.72
6,778.0	46.60	359.10	6,685.2	470.3	-314.5	483.4	11.21
6,825.0	50.60	358.60	6,716.3	505.6	-315.2	518.6	8.55
6,874.0	54.40	0.00	6,746.1	544.4	-315.7	557.5	8.08
6,921.0	58.60	0.00	6,772.0	583.6	-315.7	596.6	8.94
6,969.0	62.20	0.20	6,795.7	625.4	-315.6	638.3	7.51
7,016.0	65.50	0.00	6,816.4	667.5	-315.6	680.5	7.03
7,064.0	69.80	1.60	6,834.7	711.9	-314.9	724.8	9.47
7,111.0	73.70	0.80	6,849.4	756.5	-314.0	769.3	8.45
7,158.0	77.60	0.40	6,861.0	802.1	-313.5	814.8	8.34
7,178.0	79.70	359.50	6,865.0	821.7	-313.5	834.4	11.39
7,225.0	83.08	359.70	6,872.0	868.1	-313.9	880.8	7.20
Actual 7" Csg @ 7225' MD / 6872' TVD / 2046' FNL & 329' FWL Sec 10							
7,249.0	84.80	359.80	6,874.5	892.0	-314.0	904.6	7.20
7,344.0	90.50	359.70	6,878.4	986.9	-314.4	999.5	6.00
7,439.0	91.40	0.40	6,876.9	1,081.9	-314.3	1,094.3	1.20
7,534.0	90.90	0.70	6,875.0	1,176.8	-313.4	1,189.2	0.61
7,629.0	90.30	2.20	6,874.0	1,271.8	-311.0	1,284.0	1.70
7,725.0	89.20	0.40	6,874.4	1,367.8	-308.8	1,379.8	2.20
7,820.0	89.30	0.10	6,875.6	1,462.7	-308.4	1,474.6	0.33
7,915.0	90.50	1.00	6,875.8	1,557.7	-307.5	1,569.5	1.58
8,010.0	89.50	0.30	6,875.8	1,652.7	-306.4	1,664.4	1.28
8,105.0	89.90	1.40	6,876.3	1,747.7	-305.0	1,759.2	1.23
8,200.0	88.40	357.80	6,877.7	1,842.7	-305.6	1,854.1	4.10
8,296.0	89.70	358.20	6,879.3	1,938.6	-309.0	1,950.1	1.42
8,391.0	90.50	358.10	6,879.1	2,033.6	-312.1	2,045.1	0.85
8,486.0	88.30	358.90	6,880.1	2,128.5	-314.6	2,140.1	2.46
8,578.0	89.30	358.60	6,882.0	2,220.5	-316.6	2,232.0	1.13
8,670.0	89.50	359.10	6,883.0	2,312.5	-318.4	2,324.0	0.59
8,762.0	89.60	359.20	6,883.7	2,404.4	-319.8	2,415.9	0.15
8,856.0	90.80	359.30	6,883.4	2,498.4	-321.0	2,509.9	1.28



IDS

Final Survey Report



Company:	Noble Energy, Inc	Local Co-ordinate Reference:	Well Oscar Y10-79-1HN
Project:	Weld County, CO (NAD 83)	TVD Reference:	Well @ 4973.0usft (HP330)
Site:	Sec 10, T02N-R64W (Oscar Y10 Pad)	MD Reference:	Well @ 4973.0usft (HP330)
Well:	Oscar Y10-79-1HN	North Reference:	Grid
Wellbore:	Wellbore #1	Survey Calculation Method:	Minimum Curvature
Design:	OH	Database:	EDM 5000.1 Single User Db

Survey							
MD (usft)	Inc (°)	Azi (azimuth) (°)	TVD (usft)	N/S (usft)	E/W (usft)	V. Sec (usft)	DLeg (°/100usft)
8,951.0	89.30	358.60	6,883.3	2,593.4	-322.7	2,604.9	1.74
9,044.0	90.00	358.60	6,883.9	2,686.4	-325.0	2,697.9	0.75
9,138.0	91.10	359.30	6,883.0	2,780.4	-326.7	2,791.8	1.39
9,230.0	89.40	0.90	6,882.6	2,872.4	-326.6	2,883.7	2.54
9,325.0	90.70	0.90	6,882.5	2,967.3	-325.1	2,978.6	1.37
9,418.0	88.50	1.10	6,883.2	3,060.3	-323.5	3,071.4	2.38
9,512.0	89.10	1.20	6,885.1	3,154.3	-321.6	3,165.2	0.65
9,606.0	89.70	1.10	6,886.1	3,248.3	-319.7	3,259.0	0.65
9,699.0	90.70	0.90	6,885.8	3,341.2	-318.1	3,351.8	1.10
9,793.0	89.80	0.70	6,885.4	3,435.2	-316.8	3,445.7	0.98
9,886.0	90.00	358.00	6,885.5	3,528.2	-317.8	3,538.6	2.91
9,979.0	90.90	358.20	6,884.8	3,621.2	-320.9	3,631.6	0.99
10,072.0	92.40	358.50	6,882.1	3,714.1	-323.6	3,724.5	1.64
10,165.0	91.40	358.60	6,879.0	3,807.0	-325.9	3,817.5	1.08
10,259.0	89.80	358.40	6,878.1	3,901.0	-328.4	3,911.5	1.72
10,353.0	91.20	358.80	6,877.2	3,994.9	-330.7	4,005.4	1.55
10,448.0	88.90	359.70	6,877.2	4,089.9	-331.9	4,100.4	2.60
10,544.0	89.00	359.50	6,878.9	4,185.9	-332.6	4,196.3	0.23
10,639.0	90.40	359.10	6,879.4	4,280.9	-333.8	4,291.3	1.53
10,734.0	90.40	358.50	6,878.7	4,375.8	-335.7	4,386.2	0.63
10,829.0	90.40	1.80	6,878.1	4,470.8	-335.5	4,481.1	3.47
10,924.0	89.10	0.70	6,878.5	4,565.8	-333.4	4,575.9	1.79
11,019.0	90.00	0.20	6,879.2	4,660.8	-332.7	4,670.8	1.08
11,114.0	89.40	2.20	6,879.7	4,755.8	-330.7	4,765.6	2.20
11,209.0	90.00	1.40	6,880.2	4,850.7	-327.7	4,860.3	1.05
11,304.0	88.10	1.90	6,881.8	4,945.7	-325.0	4,955.1	2.07
11,399.0	89.90	2.40	6,883.5	5,040.6	-321.4	5,049.7	1.97
11,495.0	89.10	0.90	6,884.3	5,136.5	-318.6	5,145.5	1.77
11,590.0	90.80	1.50	6,884.4	5,231.5	-316.6	5,240.3	1.90
11,685.0	89.00	358.60	6,884.6	5,326.5	-316.6	5,335.2	3.59
11,780.0	89.80	358.10	6,885.6	5,421.4	-319.3	5,430.2	0.99
11,875.0	91.40	357.10	6,884.6	5,516.4	-323.3	5,525.1	1.99
11,970.0	90.70	358.60	6,882.8	5,611.3	-326.8	5,620.1	1.74
12,066.0	91.70	358.50	6,880.8	5,707.2	-329.3	5,716.1	1.05
12,161.0	90.20	356.60	6,879.2	5,802.1	-333.3	5,811.1	2.55
12,256.0	91.20	357.40	6,878.1	5,897.0	-338.3	5,906.1	1.35
12,351.0	90.40	358.40	6,876.7	5,991.9	-341.8	6,001.0	1.35
12,446.0	88.90	0.00	6,877.3	6,086.9	-343.1	6,096.0	2.31
12,541.0	90.00	0.80	6,878.2	6,181.9	-342.4	6,190.9	1.43
12,637.0	89.50	357.90	6,878.7	6,277.9	-343.5	6,286.8	3.07
12,730.0	90.80	357.80	6,878.4	6,370.8	-347.0	6,379.8	1.40
12,823.0	90.30	358.10	6,877.5	6,463.7	-350.3	6,472.8	0.63
12,914.0	89.90	359.80	6,877.4	6,554.7	-352.0	6,563.8	1.92
13,006.0	88.50	1.10	6,878.6	6,646.7	-351.3	6,655.6	2.08



IDS
Final Survey Report



Company: Noble Energy, Inc	Local Co-ordinate Reference: Well Oscar Y10-79-1HN
Project: Weld County, CO (NAD 83)	TVD Reference: Well @ 4973.0usft (HP330)
Site: Sec 10, T02N-R64W (Oscar Y10 Pad)	MD Reference: Well @ 4973.0usft (HP330)
Well: Oscar Y10-79-1HN	North Reference: Grid
Wellbore: Wellbore #1	Survey Calculation Method: Minimum Curvature
Design: OH	Database: EDM 5000.1 Single User Db

MD (usft)	Inc (°)	Azi (azimuth) (°)	TVD (usft)	N/S (usft)	E/W (usft)	V. Sec (usft)	DLeg (°/100usft)
13,099.0	89.60	1.40	6,880.2	6,739.6	-349.3	6,748.4	1.23
13,193.0	88.50	0.60	6,881.7	6,833.6	-347.6	6,842.2	1.45
13,284.0	89.40	0.80	6,883.4	6,924.6	-346.5	6,933.1	1.01
13,377.0	90.80	0.50	6,883.3	7,017.6	-345.5	7,025.9	1.54
13,471.0	89.70	359.40	6,882.8	7,111.6	-345.5	7,119.9	1.65
13,565.0	88.70	358.80	6,884.2	7,205.6	-347.0	7,213.8	1.24
13,657.0	90.00	359.00	6,885.2	7,297.5	-348.8	7,305.8	1.43
13,749.0	89.40	358.70	6,885.7	7,389.5	-350.6	7,397.8	0.73
13,843.0	91.40	359.10	6,885.0	7,483.5	-352.4	7,491.7	2.17
13,946.0	90.10	0.60	6,883.7	7,586.5	-352.7	7,594.6	1.93
14,041.0	88.50	0.20	6,884.8	7,681.5	-352.0	7,689.5	1.74
14,136.0	89.10	0.60	6,886.8	7,776.4	-351.4	7,784.4	0.76
14,231.0	89.90	359.80	6,887.7	7,871.4	-351.0	7,879.2	1.19
14,327.0	90.70	0.40	6,887.2	7,967.4	-350.9	7,975.1	1.04
14,378.0	90.90	359.80	6,886.4	8,018.4	-350.8	8,026.1	1.24
Last MWD @ 14378' MD / 6886' TVD							
14,437.0	90.90	359.80	6,885.5	8,077.4	-351.0	8,085.0	0.00
PTD @ 14437' MD / 6886' TVD / 75' FNL & 327' FWL Sec 3							

Measured Depth (usft)	Vertical Depth (usft)	Local Coordinates		Comment
		+N/-S (usft)	+E/-W (usft)	
1,194.0	1,194.0	2.1	-5.2	First MWD
7,225.0	6,872.0	868.1	-313.9	Actual 7" Csg @ 7225' MD / 6872' TVD / 2046' FNL & 329' FWL Sec 10
14,378.0	6,886.4	8,018.4	-350.8	Last MWD @ 14378' MD / 6886' TVD
14,437.0	6,885.5	8,077.4	-351.0	PTD @ 14437' MD / 6886' TVD / 75' FNL & 327' FWL Sec 3

Checked By: _____ Approved By: _____ Date: _____



Weld County, CO (NAD 83) Sec 10, T02N-R64W (Oscar Y10 Pad) Oscar Y10-79-1HN HP330 Plan #2



T G M
 Azimuths to Grid North
 Convergence: 0.62°
 Total Correction: 7.77°
 Magnetic Field
 Strength: 52759.5snT
 Dip Angle: 66.80°
 Date: 12/16/2013
 Model: IGRF2010

WELL DETAILS: Oscar Y10-79-1HN						
		Ground Level: 4943.0				
+N/-S	+E/-W	Northing	Easting	Latitude	Longitude	
0.0	0.0	1299745.94	3266988.94	40° 9' 8.100 N	104° 32' 41.424 W	

SECTION DETAILS									
MD	Inc	Azi	TVD	+N/-S	+E/-W	Dleg	TFace	VSect	Target
0.0	0.00	0.00	0.0	0.0	0.0	0.00	0.00	0.0	
1500.0	0.00	0.00	1500.0	0.0	0.0	0.00	0.00	0.0	
2146.2	12.92	308.66	2140.7	45.3	-56.7	2.00	308.66	47.7	
3272.3	12.92	308.66	3238.3	202.7	-253.3	0.00	0.00	213.4	
3918.5	0.00	0.00	3879.0	248.0	-310.0	2.00	180.00	261.1	
6281.5	0.00	0.00	6242.0	248.0	-310.0	0.00	0.00	261.1	KOP Pln2 Oscar Y10-79-1HN
7225.9	85.00	359.73	6876.2	829.1	-312.7	9.00	359.73	841.8	
7275.9	85.00	359.73	6880.6	878.9	-313.0	0.00	0.00	891.6	
7331.5	90.00	359.73	6883.0	934.4	-313.2	9.00	0.00	947.0	
14473.6	90.00	359.73	6883.0	8076.5	-346.9	0.00	0.00	8083.9	PBHL Pln2 Oscar Y10-79-1HN

CASING DETAILS			
MD	TVD	Name	Size
7225.9	6876.2	7"	7"

SITE DETAILS: Sec 10, T02N-R64W (Oscar Y10 Pad)	
Site Centre Northing:	1299747.16
Easting:	3267100.75
Positional Uncertainty:	0.0
Convergence:	0.62
Local North:	Grid

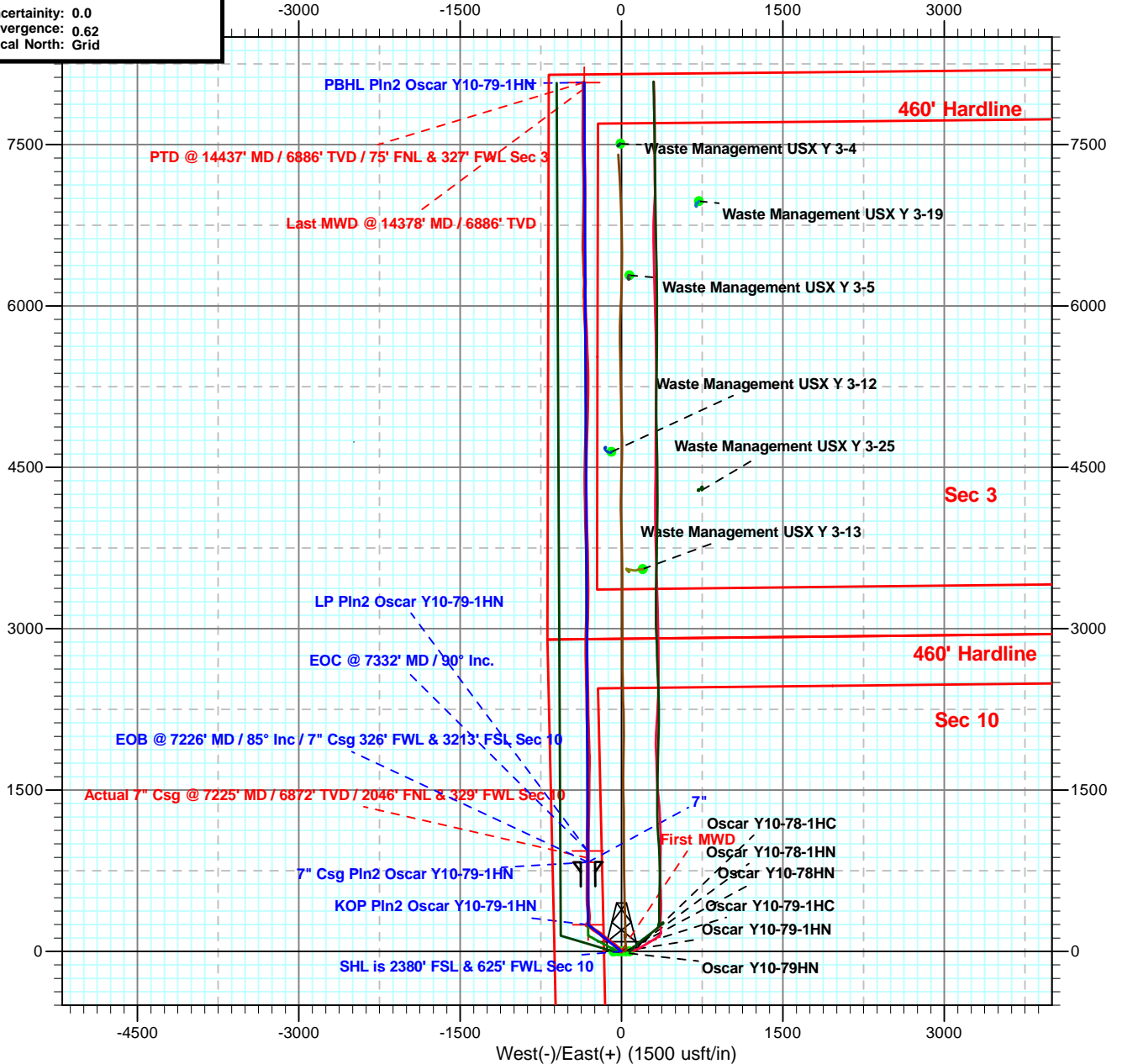



Weld County, CO (NAD 83) Sec 10, T02N-R64W (Oscar Y10 Pad) Oscar Y10-79-1HN HP330 Plan #2



Azimuths to Grid North
 Convergence: 0.62°
 Total Correction: 7.77°

Magnetic Field
 Strength: 52759.5snT
 Dip Angle: 66.80°
 Date: 12/16/2013
 Model: IGRF2010

WELL DETAILS: Oscar Y10-79-1HN						
Ground Level: 4943.0						
+N/-S	+E/-W	Northing	Easting	Latitude	Longitude	
0.0	0.0	1299745.94	3266988.94	40° 9' 8.100 N	104° 32' 41.424 W	

SECTION DETAILS									
MD	Inc	Azi	TVD	+N/-S	+E/-W	Dleg	TFace	VSect	Target
0.0	0.00	0.00	0.0	0.0	0.0	0.00	0.00	0.0	
1500.0	0.00	0.00	1500.0	0.0	0.0	0.00	0.00	0.0	
2146.2	12.92	308.66	2140.7	45.3	-56.7	2.00	308.66	47.7	
3272.3	12.92	308.66	3238.3	202.7	-253.3	0.00	0.00	213.4	
3918.5	0.00	0.00	3879.0	248.0	-310.0	2.00	180.00	261.1	
6281.5	0.00	0.00	6242.0	248.0	-310.0	0.00	0.00	261.1	KOP Pln2 Oscar Y10-79-1HN
7225.9	85.00	359.73	6876.2	829.1	-312.7	9.00	359.73	841.8	
7275.9	85.00	359.73	6880.6	878.9	-313.0	0.00	0.00	891.6	
7331.5	90.00	359.73	6883.0	934.4	-313.2	9.00	0.00	947.0	
14473.6	90.00	359.73	6883.0	8076.5	-346.9	0.00	0.00	8083.9	PBHL Pln2 Oscar Y10-79-1HN

CASING DETAILS			
MD	TVD	Name	Size
7225.9	6876.2	7"	7"

SITE DETAILS: Sec 10, T02N-R64W (Oscar Y10 Pad)	
Site Centre Northing:	1299747.16
Easting:	3267100.75
Positional Uncertainty:	0.0
Convergence:	0.62
Local North:	Grid

