

# CONSTRUCTION LAYOUT DRAWING

1 of 2

PIT= 400'X640'		ELEV= 4946.0'	
DISTURBED AREA= 10.6± ACRES			
ESTIMATED DIRT QUANTITIES			
CUTx10%	FILL	TOPSOIL	EXCESS
34,800	27,700	6,380	720
NOTE: VOLUMES IN CUBIC YARDS. TOPSOIL INCLUDED IN VOLUMES AT A DEPTH OF 6".			

VEGETATION:  
GRASSLAND PASTURE

SURFACE USE:  
GRAZING

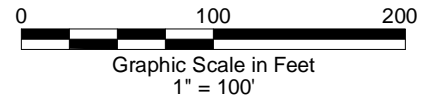
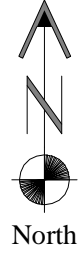
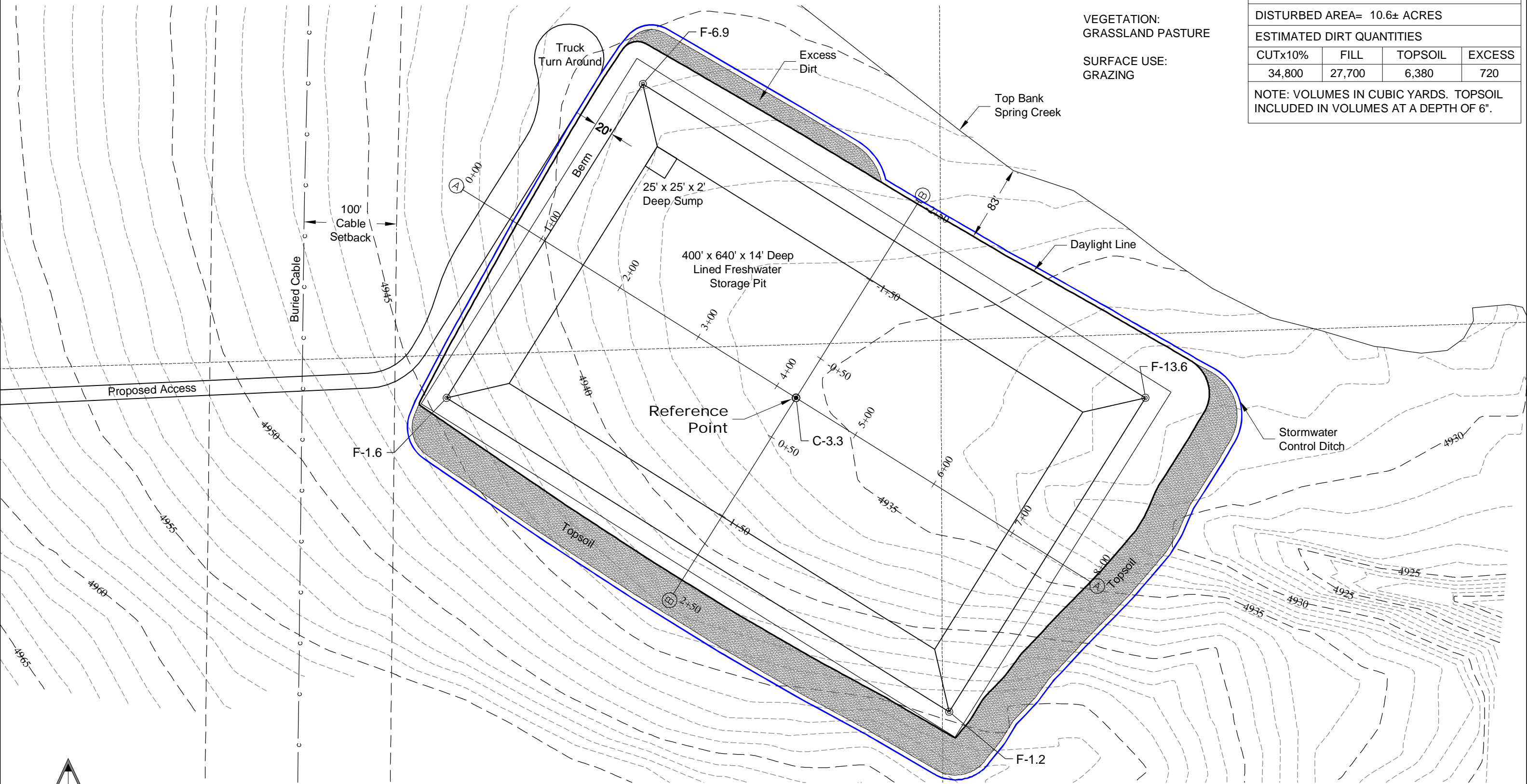

9/9/14

NOTE:  
10% ALLOWANCE IS MADE FOR SOIL EXPANSION.

**GEO SURV**  
LAND SURVEYING AND MAPPING  
LAFAYETTE - WINTER PARK  
Ph 303 666 0379 Fx 303 665 6320

**CARRIZO NIOBRARA LLC**  
**OHARE 1-29-11-57 FRESHWATER PIT**  
**SW1/4 SW1/4 SECTION 29 T11N R57W**  
**6th PM WELD COUNTY COLORADO**

# CONSTRUCTION LAYOUT DRAWING

2 of 2

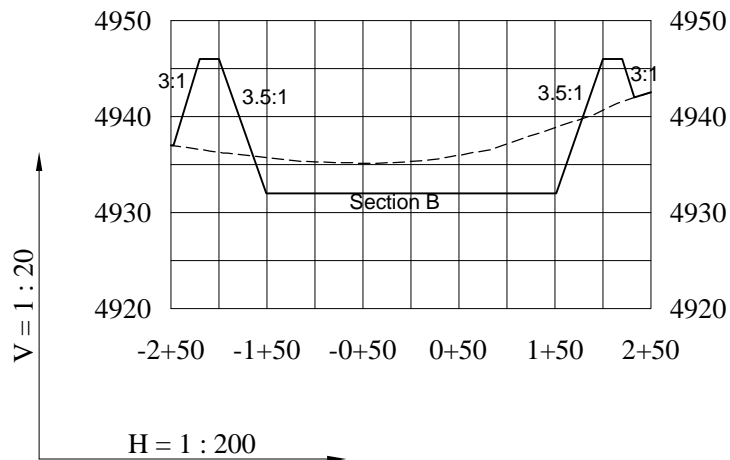
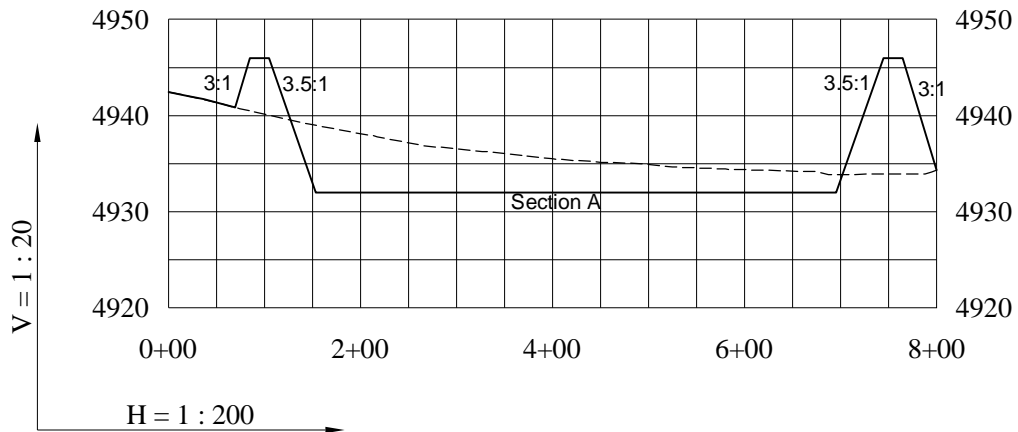

9/9/14

- Existing Ground
- \_\_\_\_\_ Proposed Grade



LAND SURVEYING AND MAPPING  
LAFAYETTE - WINTER PARK  
Ph 303 666 0379 Fx 303 665 6320

**CARRIZO NIobrara LLC**  
**OHARE 1-29-11-57 FRESHWATER PIT**  
**SW1/4 SW1/4 SECTION 29 T11N R57W**  
**6th PM WELD COUNTY COLORADO**