

Hydrology Map

BRENIMAN 16-B PAD

MULTI WELL PAD

NE1/4 NW1/4 SECTION 16, TOWNSHIP 6 NORTH, RANGE 67 WEST OF THE 6TH PRINCIPAL MERIDIAN

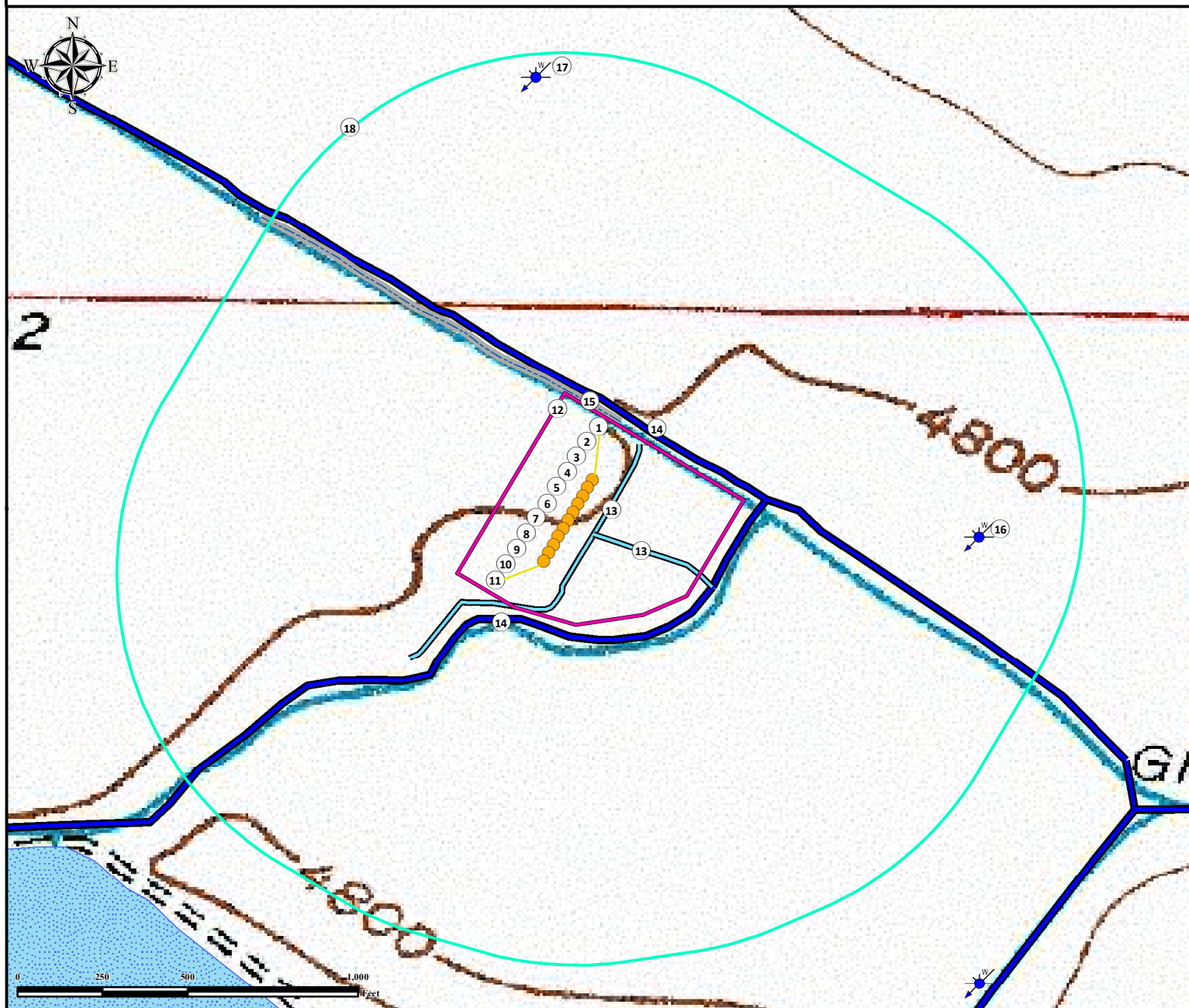

1. Proposed Well BRENIMAN 1.
2. Proposed Well BRENIMAN 2.
3. Proposed Well BRENIMAN 3.
4. Proposed Well BRENIMAN 4.
5. Proposed Well BRENIMAN 5.
6. Proposed Well BRENIMAN 6.
7. Proposed Well BRENIMAN 7.
8. Proposed Well BRENIMAN 8.
9. Proposed Well BRENIMAN 9.
10. Proposed Well BRENIMAN 10.
11. Proposed Well BRENIMAN 11.

12. Operational Disturbance Area.
13. Ditches are $\pm 85'$ SE, and $\pm 85'$ SE.
14. Canals are $\pm 318'$ SW, and $\pm 351'$ NE.
15. Concrete Ditch is $\pm 328'$ NE.
16. Water Well (Permit #42533) is $\pm 1207'$ E.
17. Water Well (Permit #24228) is $\pm 1307'$ N.
18. 1000' Radius.

Legend



Proposed Well

Water Well

Canal

Ditch

Concrete Ditch

Lake/Pond

Disturbance Area

1000' Radius

Reference Location

** BRENIMAN 6 **

Lat: 40.49251° Long: -104.900208° (NAD83)
Elevation: 4796 Feet



Use our resources to find yours!
www.petro-fs.com
(303) 928-7128

Field Date: 7/8/2014
Drafting Date: 8/22/2014
Drafted By: SMG
Checked By: CSG
Revision: 1

Data Sources:

- Topo courtesy USGS
- Water features courtesy of NHD

Prepared for:

