

LOCATION DRAWING

AVILA WEST FEDERAL 32-29-20-3-1CH

SECTION 32, TOWNSHIP 12 NORTH, RANGE 65 WEST OF THE 6TH P.M.

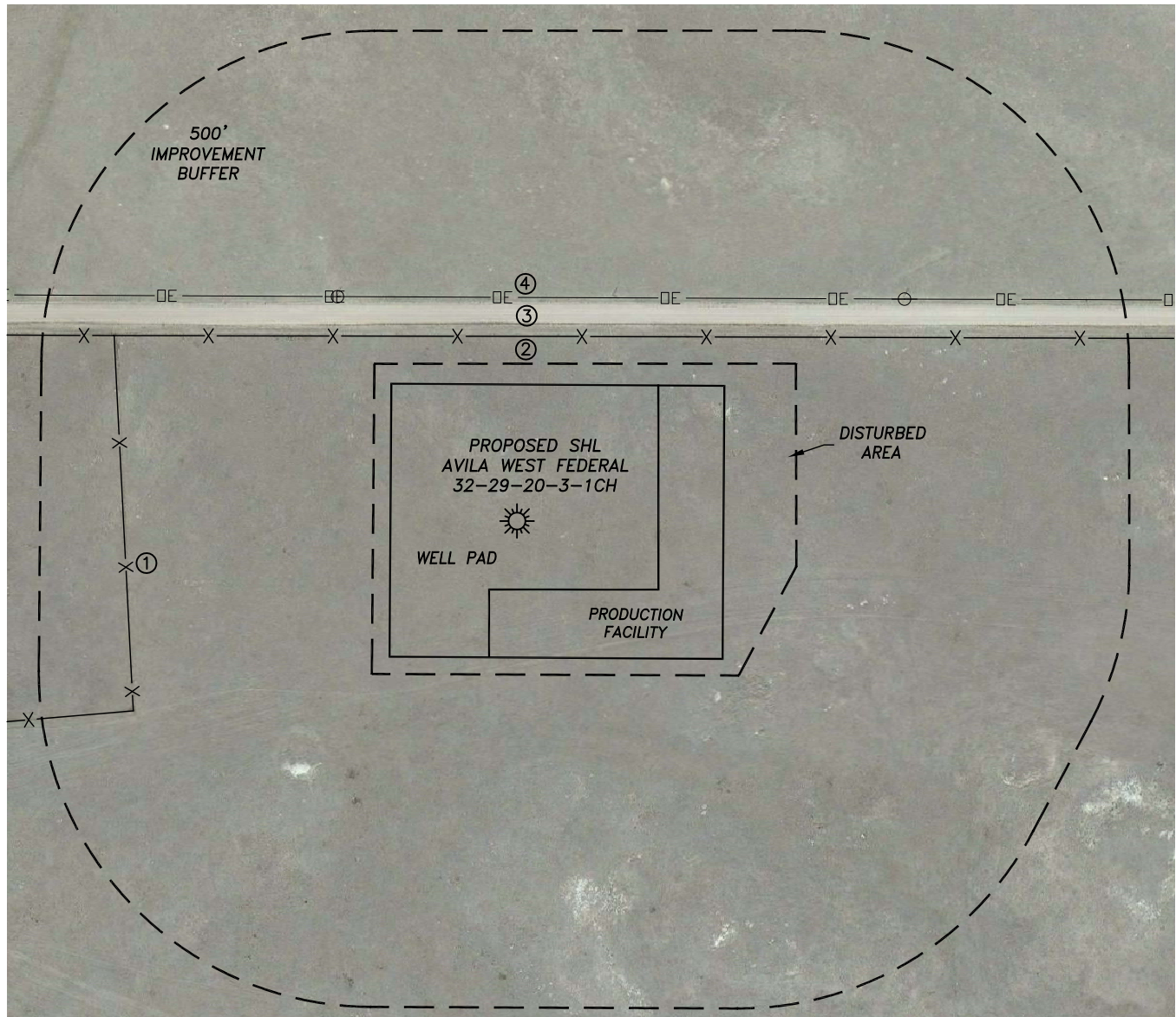

IMPROVEMENTS

(AS MEASURED FROM THE PROPOSED WELLHEAD)

1. WIRE FENCE: 590'± W
2. WIRE FENCE: 277'± N
3. WCR 136: 296'± N
4. O.H. UTILITY: 336'± N

NEAREST CULTURAL ITEMS:

(AS MEASURED FROM THE NEAREST PROPOSED WELLHEAD OR LIMITS OF THE PROPOSED PRODUCTION FACILITY CLOSEST TO THE REFERENCED CULTURAL ITEM).

- | | |
|--------------------------------|-----------|
| 1. BUILDING: | 1528'± SW |
| 2. BUILDING UNIT: | 1703'± SW |
| 3. HIGH OCC. BLD. UNIT: | 5280'± |
| 4. DES. OUTSIDE ACTIVITY AREA: | 5280'± |
| 5. PUBLIC ROAD: | 91'± N |
| 6. ABOVE GROUND UTILITY: | 130'± N |
| 7. RAILROAD: | 5280'± |
| 8. PROPERTY LINE: | 213'± N |

