



Lat40°, Inc. 1635 Foxtrail Drive, Suite 325 Loveland, CO 970-776-3321

HYDROLOGY MAP

WAAG NORTH PAD

SECTION: 19
TOWNSHIP: 7N
RANGE: 65W

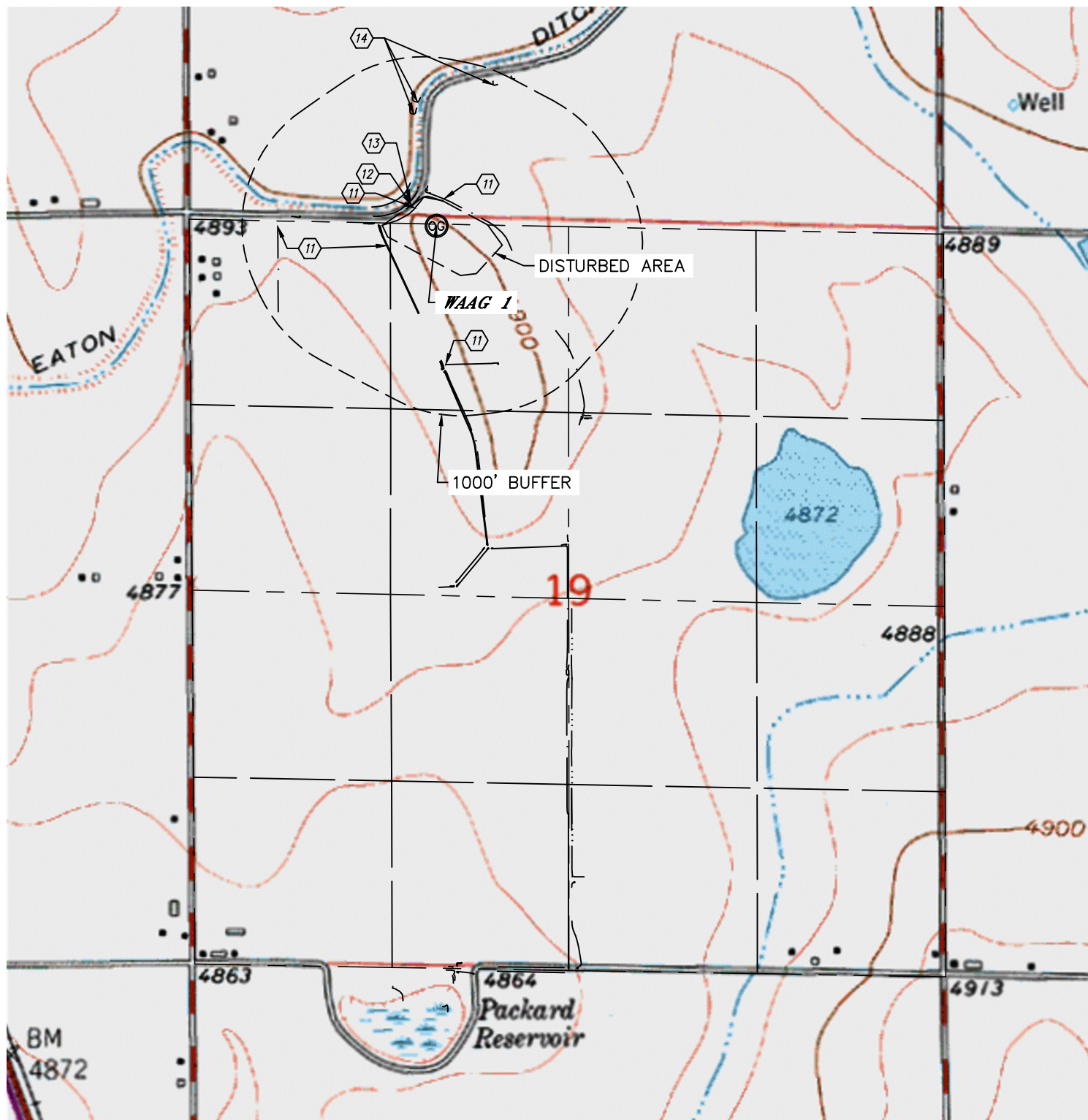

- ⑪ DITCH 199' NW, 182' & 199' NE, 376' SW, 990' SE, 1130' W
- ⑫ BARROW DITCH 227' NW
- ⑬ EATON DITCH 256' NW
- ⑭ POND 815' & 894' NW, 1084' NE

DATE: rev7/16/2014
PROJECT#: 2014064