

PHOTO: VIEW FROM CORNER #1 TO LOCATION STAKE

CAMERA ANGLE: WESTERLY



PHOTO: VIEW FROM BEGINNING OF PROPOSED ACCESS

CAMERA ANGLE: WESTERLY

ConocoPhillips Company

PARACHUTE #4-65 5-6 3H
SECTION 5, T4S, R65W, 6th P.M.
1500' FSL 450' FEL



UELS, LLC
Corporate Office * 85 South 200 East
Vernal, UT 84078 * (435) 789-1017

DRAWN BY: T.W.	DATE DRAWN: 06-25-14
TAKEN BY: D.N.	REVISED: 08-08-14 J.L.G.
LOCATION PHOTOS	PHOTO 1

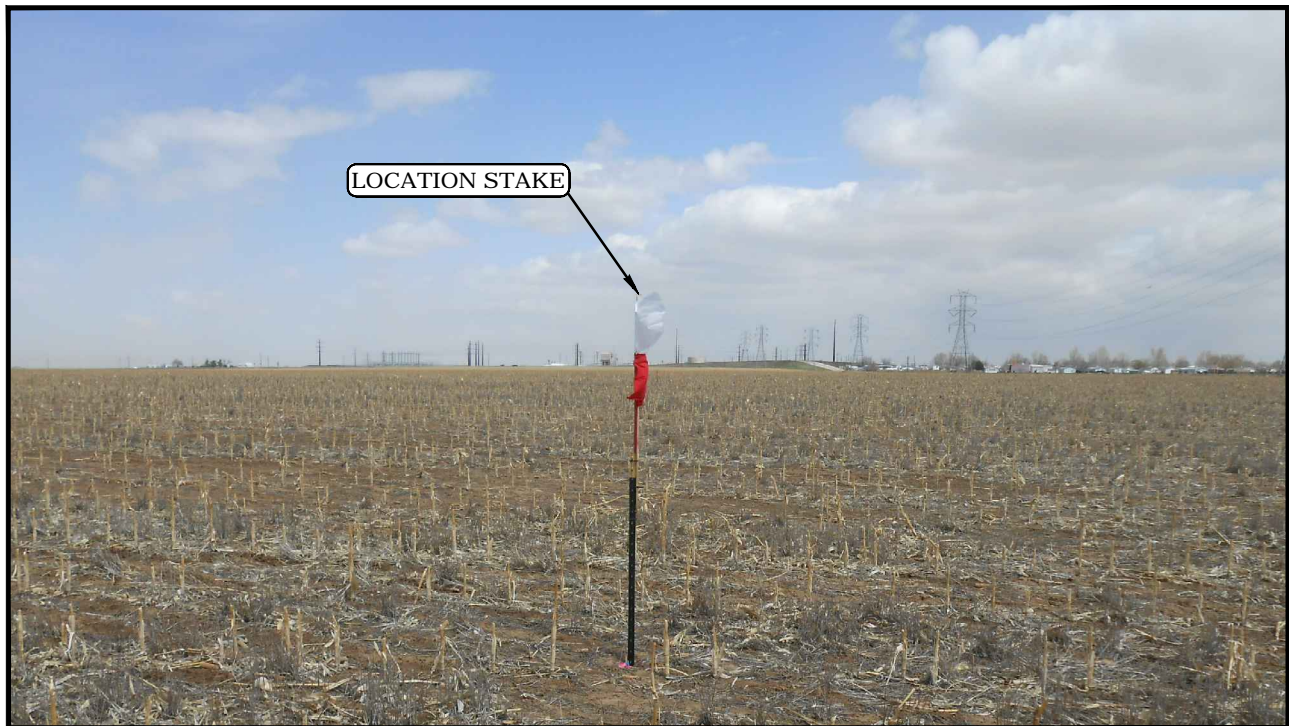

PHOTO: VIEW OF LOCATION STAKE

CAMERA ANGLE: NORTHERLY



PHOTO: VIEW OF LOCATION STAKE

CAMERA ANGLE: EASTERLY

ConocoPhillips Company

PARACHUTE #4-65 5-6 3H
SECTION 5, T4S, R65W, 6th P.M.
1500' FSL 450' FEL



UELS, LLC
Corporate Office * 85 South 200 East
Vernal, UT 84078 * (435) 789-1017

DRAWN BY: T.W.	DATE DRAWN: 06-25-14
TAKEN BY: D.N.	REVISED: 08-08-14 J.L.G.
LOCATION PHOTOS	PHOTO 2

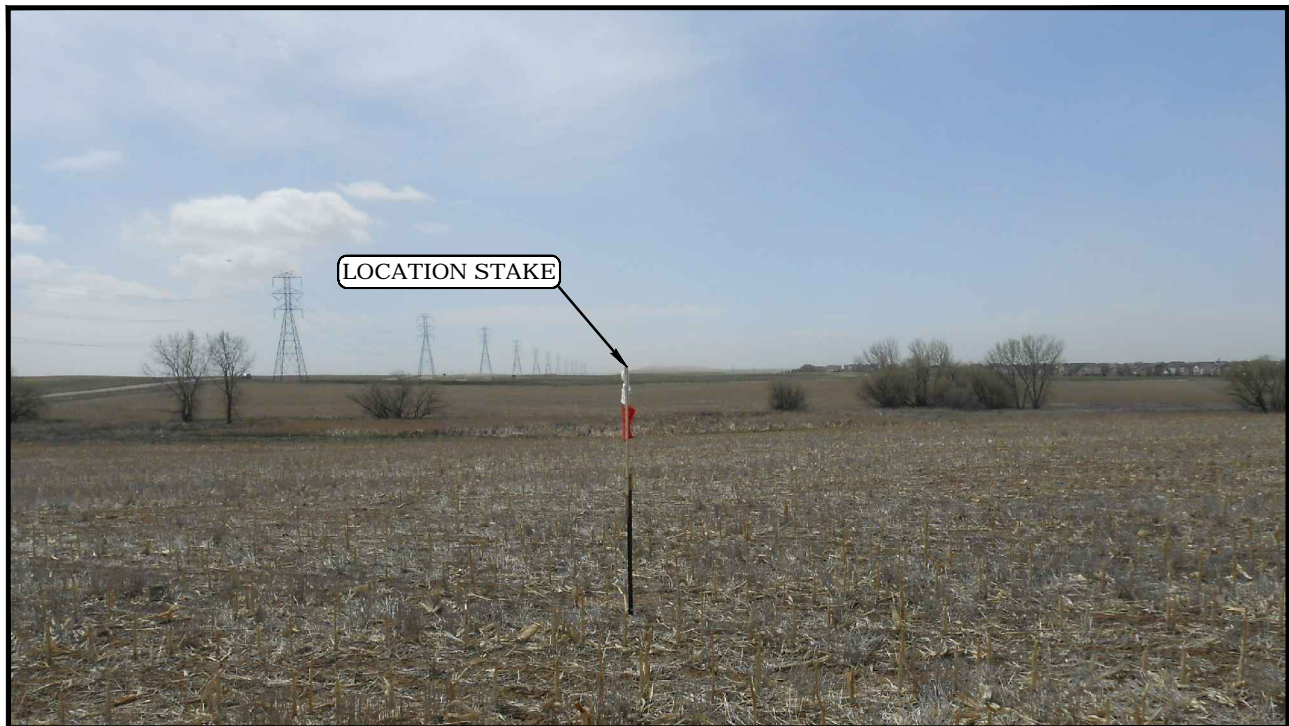

PHOTO: VIEW OF LOCATION STAKE

CAMERA ANGLE: SOUTHERLY



PHOTO: VIEW OF LOCATION STAKE

CAMERA ANGLE: WESTERLY

ConocoPhillips Company

PARACHUTE #4-65 5-6 3H
SECTION 5, T4S, R65W, 6th P.M.
1500' FSL 450' FEL



UELS, LLC
Corporate Office * 85 South 200 East
Vernal, UT 84078 * (435) 789-1017

DRAWN BY: T.W.	DATE DRAWN: 06-25-14
TAKEN BY: D.N.	REVISED: 08-08-14 J.L.G.
LOCATION PHOTOS	PHOTO 3