

LEGEND:

 **PROPOSED LOCATION**

ConocoPhillips Company

PARACHUTE #4-65 5-6 3H
SECTION 5, T4S, R65W, 6th P.M.
1500' FSL 450' FEL



UELS, LLC
 Corporate Office * 85 South 200 East
 Vernal, UT 84078 * (435) 789-1017

DRAWN BY: T.W.	DATE DRAWN: 06-25-14
SCALE: 1:100,000	REVISED: 08-08-14 J.L.G.
ACCESS ROAD MAP	TOPO A

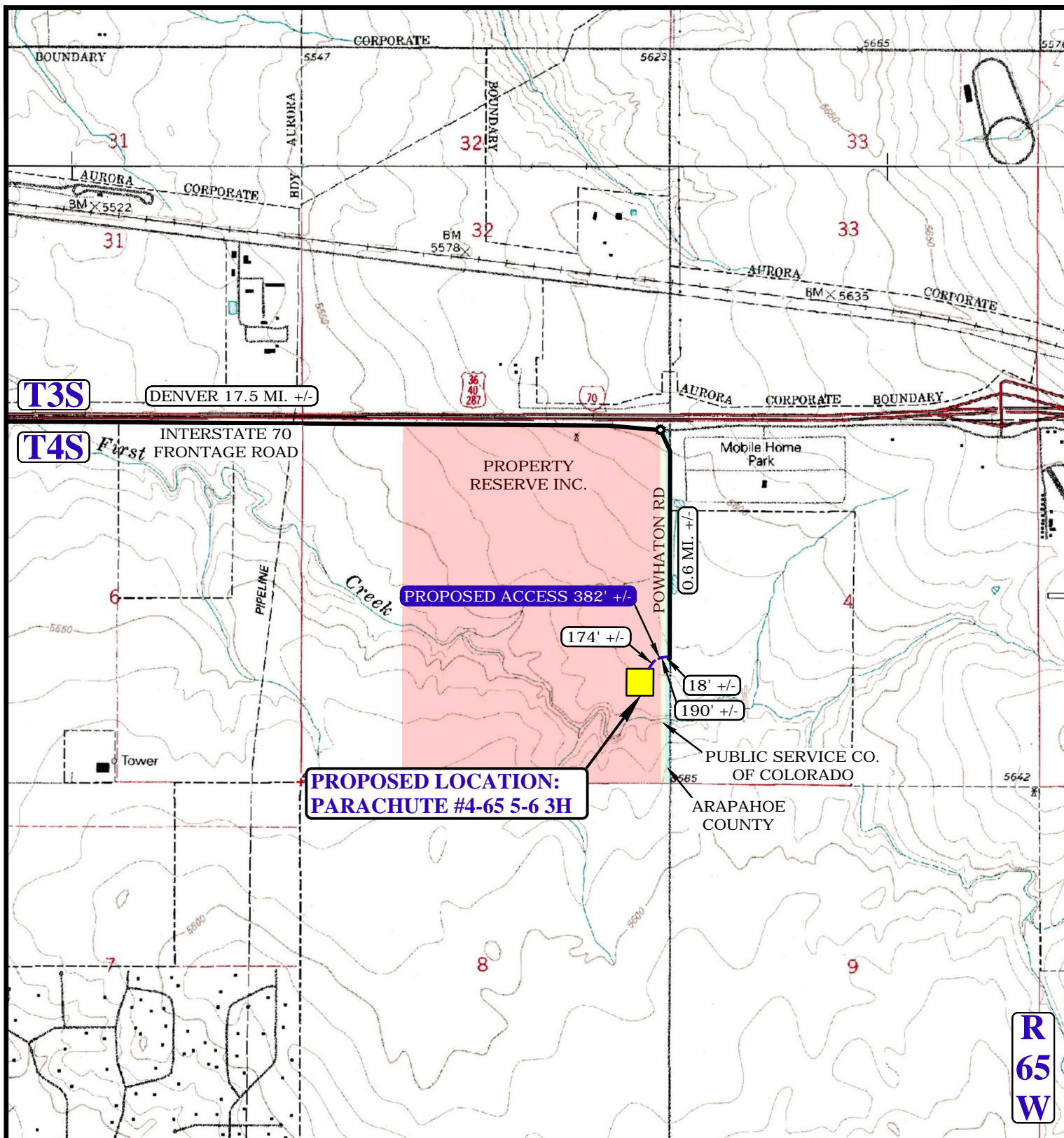

NOTE: PARCEL DATA SHOWN HAS BEEN OBTAINED FROM VARIOUS SOURCES AND SHOULD BE USED FOR MAPPING, GRAPHIC AND PLANNING PURPOSES ONLY. NO WARRANTY IS MADE BY UTAH ENGINEERING AND LAND SURVEYING (UELS) FOR ACCURACY OF THE PARCEL DATA.

LEGEND:

— EXISTING ROAD
 - - - PROPOSED ROAD

ConocoPhillips Company

PARACHUTE #4-65 5-6 3H
SECTION 5, T4S, R65W, 6th P.M.
1500' FSL 450' FEL

DRAWN BY: T.W.

DATE DRAWN: 06-25-14

SCALE: 1" = 2000'

REVISED: 08-08-14 J.L.G.

ACCESS ROAD MAP

TOPO B



UELS, LLC
 Corporate Office * 85 South 200 East
 Vernal, UT 84078 * (435) 789-1017

