

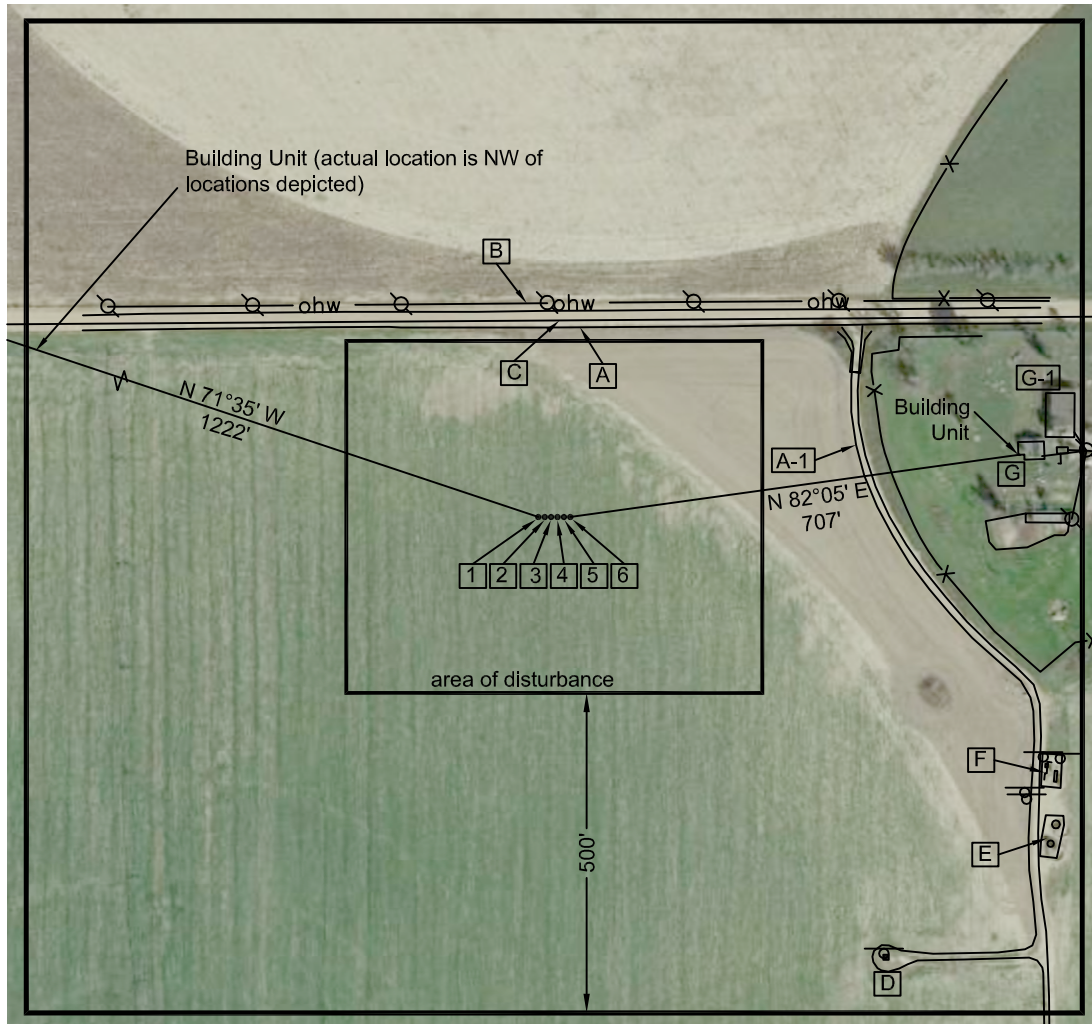

Washburn Land Surveying
www.WashburnSurveying.com
970-232-9645

Location Drawing



Distances listed below are measured from the proposed Ruhl 1I-32H-B264 well

- [1] proposed Ruhl 1G-32H-B264; 20' west
- [2] proposed Ruhl 1H-32H-B264; 10' west
- [3] proposed Ruhl 1I-32H-B264
- [4] proposed Ruhl 1J-32H-B264; 10' east
- [5] proposed Ruhl 1K-32H-B264; 20' east
- [6] proposed Ruhl 1L-32H-B264; 30' east
- [A] access (WCR 16) 296' north
- [A-1] access 489' northeast
- [B] overhead power line 334' north
- [C] property line 307' north
- [D] existing Ruhl #1; 864' southeast
- [E] fenced in tanks 902' southeast
- [F] fenced in above ground gas line with separator and meter hut 852' southeast
- [G] building unit 737' northeast
- [G-1] building unit 783' northeast

Existing Well Data:

Ruhl #1
Latitude: N 40.099546°
Longitude: W 104.568989°
FNL: 998'
FEL: 987'
ELEV: 4999'
PDOP: 1.7

Proposed Well Data:

Ruhl 1I-32H-B264
Latitude: N 40.101448°
Longitude: W 104.570837°
FNL: 307'
FEL: 1508'
ELEV: 4,997'
PDOP: 1.1

Nearest: (from proposed Ruhl 1I-32H-B264 well)

Building: 737' northeast
Building Unit: 737' northeast
Above Ground Utility: 334' north
Railroad: 2,925' northwest
Public Road: 296' north
Property Line: 307' north

Legend:

- ⊗ - power pole
- ⊕ - utility/gas sign
- X— - fence line
- ohw— - overhead power line

Ruhl 32H-B264 Location Drawing

Improvements extending
500' from disturbance

Township 2 North, Range 64 West,
Section 32: NW $\frac{1}{4}$ NE $\frac{1}{4}$
Weld County, Colorado

July 21, 2014

Field observations taken
on 6/20/14 by operator
Ryan Christi