

Exist. Limit of Disturbance

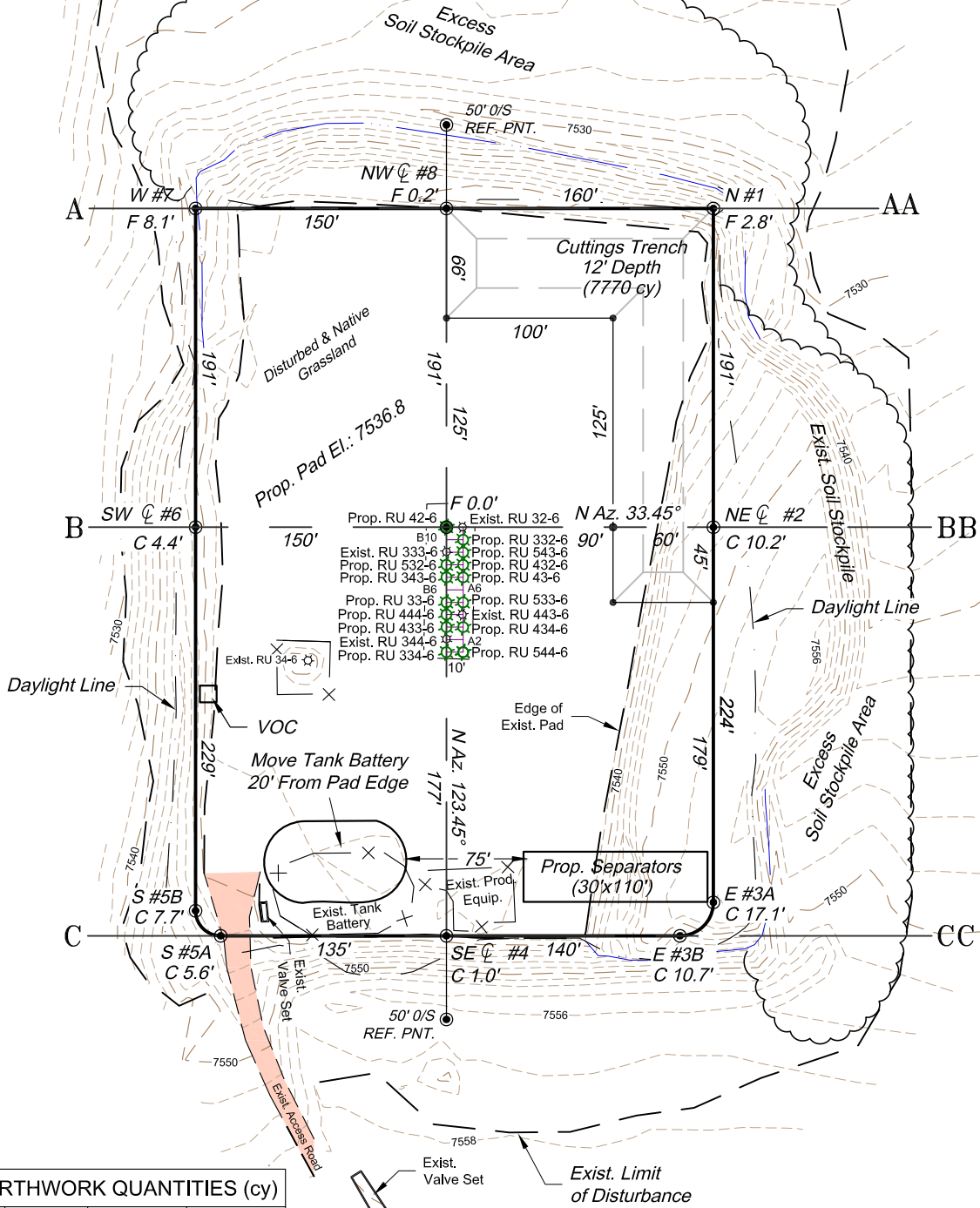
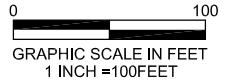

ESTIMATED EARTHWORK QUANTITIES (cy)

ITEM	CUT	FILL	TOPSOIL	EXCESS
PAD	11520	700	0	10820
PIT	8550			8550
TOTALS	20070	700	0	19370

- *NOTE:**
 1.) 10% Swell Factor Applied to Earthwork Cut Volume.
 2.) Topsoil Volume Based on 12" Soil Depth.
 3.) Total Disturbed Area = ±7.44 ac.

REVISED: 8/15/14

136 East Third Street
Rifle, Colorado 81650
Ph. (970) 625-2720
Fax (970) 625-2773



SCALE: 1" = 100'
 DATE: 7/30/14
 PLAT: 2 of 7
 PROJECT: Valley
 DFT: cs

Construction Plan Prepared for:
WPXENERGY WPX Energy Rocky Mountain, LLC

RU 34-6 Drill Pad - Plat 2
CONSTRUCTION LAYOUT

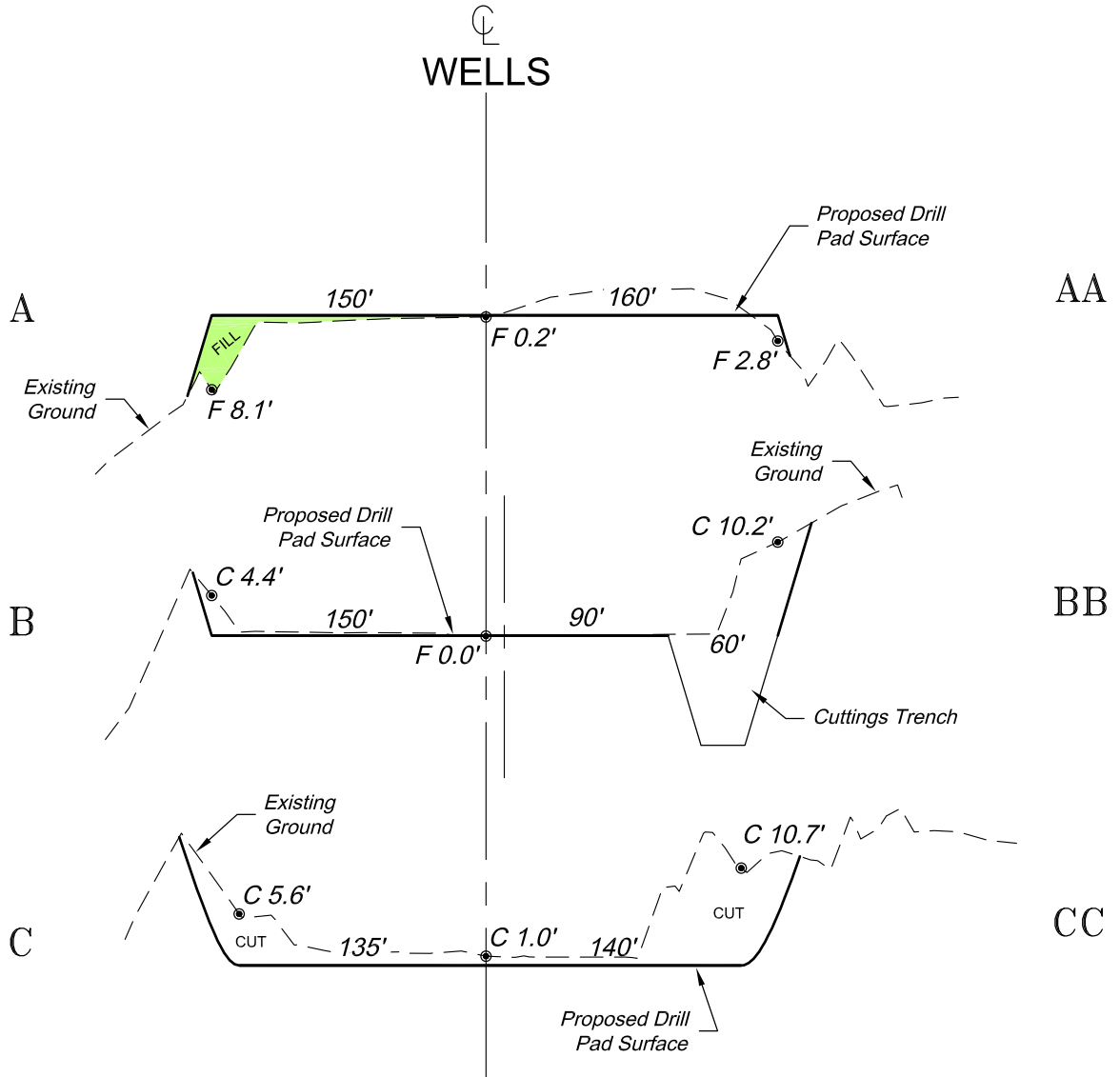

SCALE: Horiz.: 1" = 100'
Vert. : 1" = 20'

*NOTE:
CUT SLOPES: 1.5:1
FILL SLOPES: 1.5:1,
UNLESS OTHERWISE NOTED.

136 East Third Street
Rifle, Colorado 81650
Ph. (970) 625-2720
Fax (970) 625-2773



SCALE: As Noted
DATE: 7/30/14
PLAT: 3 of 7
PROJECT: Valley
DFT: cs

Construction Plan Prepared for:
WPXENERGY WPX Energy Rocky Mountain, LLC

*RU 34-6 Drill Pad - Plat 3
CONSTRUCTION LAYOUT
CROSS SECTIONS*