



**Bill Barrett Corporation**

## **Bill Barrett Corp.**

Weld Co., CO

Sec.26-T5N-R62W

Anschutz State 5-62-26-3340BH2

Wellbore #1

Plan: Design #1

## **Standard Planning Report**

05 August, 2014

# **Archer**



Bill Barrett Corp.  
Project: Weld Co., CO  
Site: Sec.26-T5N-R62W  
Well: Anschutz State 5-62-26-3340BH2  
Wellbore: Wellbore #1  
Design: Design #1  
Lat: 40° 22' 11.168 N  
Long: 104° 17' 56.119 W  
Pad GL: 4640.00  
KB: WELL @ 4656.00usft (Original Well Elev)

# Archer

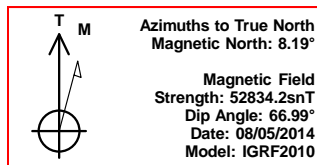
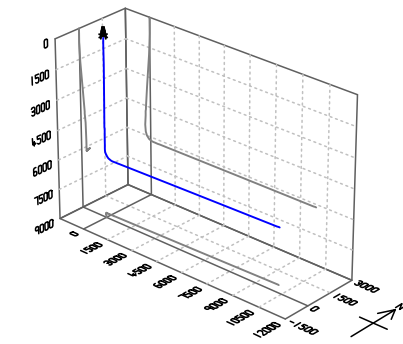

SECTION DETAILS										
MD	Inc	Azi	TVD	+N/-S	+E/-W	Dleg	TFace	VSec	Annotation	
0.00	0.00	0.00	0.00	0.00	0.00	0.00	0.00	0.00		
900.00	0.00	0.00	900.00	0.00	0.00	0.00	0.00	0.00	Start Build 2.00	
1218.30	6.37	313.06	1217.65	12.06	-12.91	2.00	313.06	-12.63	Start 3716.15 hold at 1218.30 MD	
4934.46	6.37	313.06	4910.89	293.41	-313.95	0.00	0.00	-307.11	Start Drop -2.00	
5252.76	0.00	0.00	5228.54	305.47	-326.86	2.00	180.00	-319.74	Start 500.00 hold at 5252.76 MD	
5752.76	0.00	0.00	5728.54	305.47	-326.86	0.00	0.00	-319.74	Start Build 12.00	
6505.56	90.34	88.68	6206.00	316.51	153.27	12.00	88.68	160.52	Start 9742.17 hold at 6505.56 MD	
16247.73	90.34	88.68	6149.00	540.42	9892.70	0.00	0.00	9902.53	TD at 16247.73	

WELL DETAILS: Anschutz State 5-62-26-3340BH2							
+N/-S	+E/-W	Northing	Ground Level: Easting	4640.00 Latitude	40° 22' 11.168 N	104° 17' 56.119 W Longitude	Slot
0.00	0.00	1379813.780	3334651.598				

PROJECT DETAILS: Weld Co., CO	
Geodetic System:	US State Plane 1983
Datum:	North American Datum 1983
Ellipsoid:	GRS 1980
Zone:	Colorado Northern Zone
System Datum:	Mean Sea Level

CASING DETAILS		
TVD	MD	Name
6206.00	6505.56	7" Csg.

WELLBORE TARGET DETAILS (LAT/LONG)						
Name	TVD	+N/-S	+E/-W	Latitude	Longitude	Shape Point
Anschutz State 5-62-26-3340BH2 tgt	6206.00	540.42	9892.70	40° 22' 16.489 N	104° 15' 48.301 W	

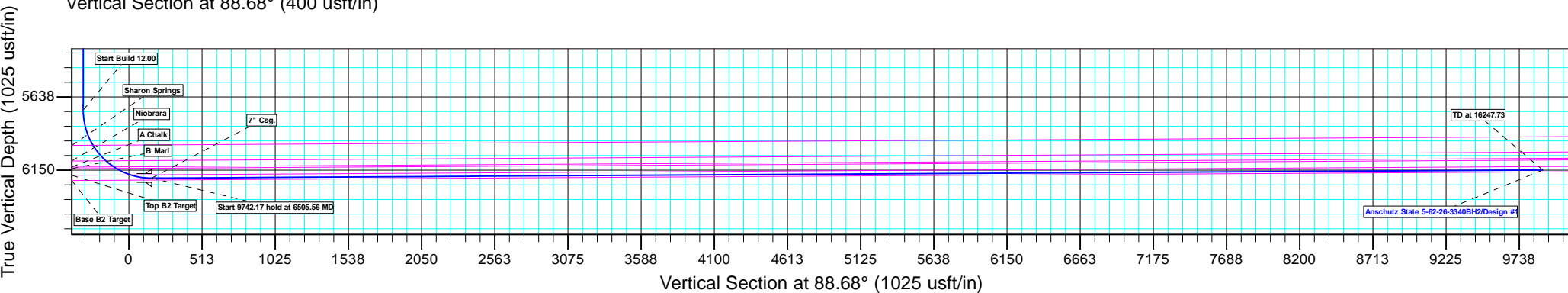
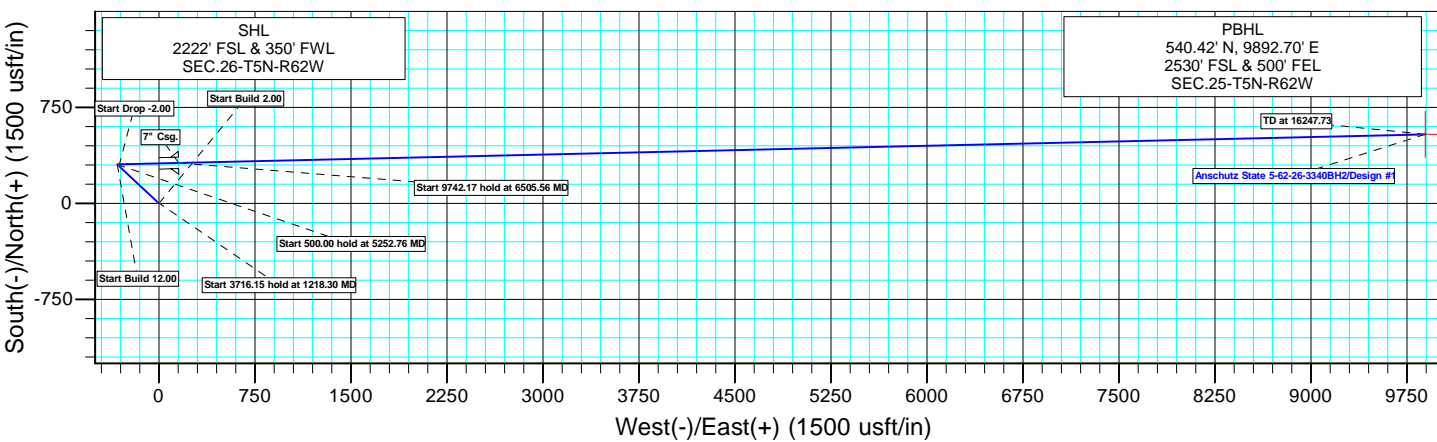
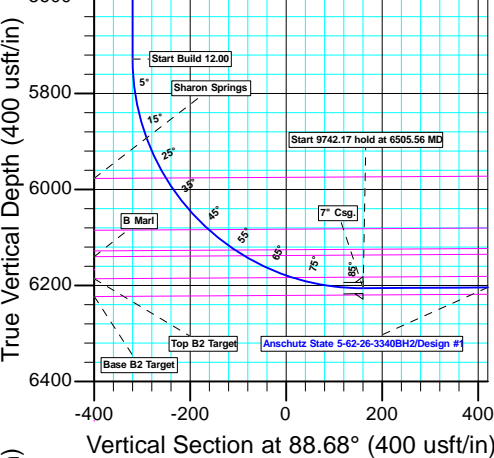

<b>Database:</b>	EDMDBBW	<b>Local Co-ordinate Reference:</b>	Well Anschutz State 5-62-26-3340BH2
<b>Company:</b>	Bill Barrett Corp.	<b>TVD Reference:</b>	WELL @ 4656.00usft (Original Well Elev)
<b>Project:</b>	Weld Co., CO	<b>MD Reference:</b>	WELL @ 4656.00usft (Original Well Elev)
<b>Site:</b>	Sec.26-T5N-R62W	<b>North Reference:</b>	True
<b>Well:</b>	Anschutz State 5-62-26-3340BH2	<b>Survey Calculation Method:</b>	Minimum Curvature
<b>Wellbore:</b>	Wellbore #1		
<b>Design:</b>	Design #1		

<b>Project</b>	Weld Co., CO		
<b>Map System:</b>	US State Plane 1983	<b>System Datum:</b>	Mean Sea Level
<b>Geo Datum:</b>	North American Datum 1983		
<b>Map Zone:</b>	Colorado Northern Zone		

Site		Sec.26-T5N-R62W			
Site Position:		Northing:	1,382,286.736 usft	Latitude:	40° 22' 35.580 N
From:	Lat/Long	Easting:	3,334,831.533 usft	Longitude:	104° 17' 53.362 W
Position Uncertainty:	0.00 usft	Slot Radius:	13-3/16"	Grid Convergence:	0.78 °

Well	Anschutz State 5-62-26-3340BH2					
Well Position	+N/-S	-2,470.29 usft	Northing:	1,379,813.780 usft	Latitude:	40° 22' 11.168 N
	+E/-W	-213.43 usft	Easting:	3,334,651.598 usft	Longitude:	104° 17' 56.119 W
Position Uncertainty		0.00 usft	Wellhead Elevation:	usft	Ground Level:	4,640.00 usft

<b>Wellbore</b>	Wellbore #1				
<b>Magnetics</b>	<b>Model Name</b>	<b>Sample Date</b>	<b>Declination (°)</b>	<b>Dip Angle (°)</b>	<b>Field Strength (nT)</b>
	IGRF2010	2014/08/05	8.19	66.99	52,834

<b>Design</b>	Design #1			
<b>Audit Notes:</b>				
<b>Version:</b>	<b>Phase:</b>	PLAN	<b>Tie On Depth:</b>	0.00
<b>Vertical Section:</b>	<b>Depth From (TVD) (usft)</b>	<b>+N/-S (usft)</b>	<b>+E/-W (usft)</b>	<b>Direction (°)</b>
	0.00	0.00	0.00	88.68

<b>Plan Sections</b>										
Measured Depth (usft)	Inclination (°)	Azimuth (°)	Vertical Depth (usft)	+N/-S (usft)	+E/-W (usft)	Dogleg Rate (°/100usft)	Build Rate (°/100usft)	Turn Rate (°/100usft)	TFO (°)	Target
0.00	0.00	0.00	0.00	0.00	0.00	0.00	0.00	0.00	0.00	
900.00	0.00	0.00	900.00	0.00	0.00	0.00	0.00	0.00	0.00	
1,218.30	6.37	313.06	1,217.65	12.06	-12.91	2.00	2.00	0.00	313.06	
4,934.46	6.37	313.06	4,910.89	293.41	-313.95	0.00	0.00	0.00	0.00	
5,252.76	0.00	0.00	5,228.54	305.47	-326.86	2.00	-2.00	0.00	180.00	
5,752.76	0.00	0.00	5,728.54	305.47	-326.86	0.00	0.00	0.00	0.00	
6,505.56	90.34	88.68	6,206.00	316.51	153.27	12.00	12.00	0.00	88.68	Anschutz State 5-62-2
16,247.73	90.34	88.68	6,149.00	540.42	9,892.70	0.00	0.00	0.00	0.00	Anschutz State 5-62-2

<b>Database:</b>	EDMDBBW	<b>Local Co-ordinate Reference:</b>	Well Anschutz State 5-62-26-3340BH2
<b>Company:</b>	Bill Barrett Corp.	<b>TVD Reference:</b>	WELL @ 4656.00usft (Original Well Elev)
<b>Project:</b>	Weld Co., CO	<b>MD Reference:</b>	WELL @ 4656.00usft (Original Well Elev)
<b>Site:</b>	Sec.26-T5N-R62W	<b>North Reference:</b>	True
<b>Well:</b>	Anschutz State 5-62-26-3340BH2	<b>Survey Calculation Method:</b>	Minimum Curvature
<b>Wellbore:</b>	Wellbore #1		
<b>Design:</b>	Design #1		

Planned Survey									
Measured Depth (usft)	Inclination (°)	Azimuth (°)	Vertical Depth (usft)	+N/-S (usft)	+E/-W (usft)	Vertical Section (usft)	Dogleg Rate (°/100usft)	Build Rate (°/100usft)	Turn Rate (°/100usft)
0.00	0.00	0.00	0.00	0.00	0.00	0.00	0.00	0.00	0.00
100.00	0.00	0.00	100.00	0.00	0.00	0.00	0.00	0.00	0.00
200.00	0.00	0.00	200.00	0.00	0.00	0.00	0.00	0.00	0.00
300.00	0.00	0.00	300.00	0.00	0.00	0.00	0.00	0.00	0.00
400.00	0.00	0.00	400.00	0.00	0.00	0.00	0.00	0.00	0.00
500.00	0.00	0.00	500.00	0.00	0.00	0.00	0.00	0.00	0.00
600.00	0.00	0.00	600.00	0.00	0.00	0.00	0.00	0.00	0.00
700.00	0.00	0.00	700.00	0.00	0.00	0.00	0.00	0.00	0.00
800.00	0.00	0.00	800.00	0.00	0.00	0.00	0.00	0.00	0.00
<b>Start Build 2.00</b>									
900.00	0.00	0.00	900.00	0.00	0.00	0.00	0.00	0.00	0.00
1,000.00	2.00	313.06	999.98	1.19	-1.28	-1.25	2.00	2.00	0.00
1,100.00	4.00	313.06	1,099.84	4.76	-5.10	-4.99	2.00	2.00	0.00
1,200.00	6.00	313.06	1,199.45	10.72	-11.47	-11.22	2.00	2.00	0.00
<b>Start 3716.15 hold at 1218.30 MD</b>									
1,218.30	6.37	313.06	1,217.65	12.06	-12.91	-12.63	2.00	2.00	0.00
1,300.00	6.37	313.06	1,298.84	18.25	-19.52	-19.10	0.00	0.00	0.00
1,400.00	6.37	313.06	1,398.23	25.82	-27.63	-27.02	0.00	0.00	0.00
1,500.00	6.37	313.06	1,497.61	33.39	-35.73	-34.95	0.00	0.00	0.00
1,600.00	6.37	313.06	1,596.99	40.96	-43.83	-42.87	0.00	0.00	0.00
1,700.00	6.37	313.06	1,696.38	48.53	-51.93	-50.80	0.00	0.00	0.00
1,800.00	6.37	313.06	1,795.76	56.10	-60.03	-58.72	0.00	0.00	0.00
1,900.00	6.37	313.06	1,895.14	63.67	-68.13	-66.65	0.00	0.00	0.00
2,000.00	6.37	313.06	1,994.53	71.24	-76.23	-74.57	0.00	0.00	0.00
2,100.00	6.37	313.06	2,093.91	78.81	-84.33	-82.49	0.00	0.00	0.00
2,200.00	6.37	313.06	2,193.29	86.38	-92.43	-90.42	0.00	0.00	0.00
2,300.00	6.37	313.06	2,292.68	93.96	-100.53	-98.34	0.00	0.00	0.00
2,400.00	6.37	313.06	2,392.06	101.53	-108.64	-106.27	0.00	0.00	0.00
2,500.00	6.37	313.06	2,491.44	109.10	-116.74	-114.19	0.00	0.00	0.00
2,600.00	6.37	313.06	2,590.83	116.67	-124.84	-122.12	0.00	0.00	0.00
2,700.00	6.37	313.06	2,690.21	124.24	-132.94	-130.04	0.00	0.00	0.00
2,800.00	6.37	313.06	2,789.59	131.81	-141.04	-137.97	0.00	0.00	0.00
2,900.00	6.37	313.06	2,888.98	139.38	-149.14	-145.89	0.00	0.00	0.00
3,000.00	6.37	313.06	2,988.36	146.95	-157.24	-153.82	0.00	0.00	0.00
3,100.00	6.37	313.06	3,087.74	154.52	-165.34	-161.74	0.00	0.00	0.00
3,200.00	6.37	313.06	3,187.13	162.09	-173.44	-169.66	0.00	0.00	0.00
3,300.00	6.37	313.06	3,286.51	169.66	-181.55	-177.59	0.00	0.00	0.00
3,400.00	6.37	313.06	3,385.89	177.24	-189.65	-185.51	0.00	0.00	0.00
3,500.00	6.37	313.06	3,485.28	184.81	-197.75	-193.44	0.00	0.00	0.00
3,600.00	6.37	313.06	3,584.66	192.38	-205.85	-201.36	0.00	0.00	0.00
3,700.00	6.37	313.06	3,684.04	199.95	-213.95	-209.29	0.00	0.00	0.00
3,800.00	6.37	313.06	3,783.43	207.52	-222.05	-217.21	0.00	0.00	0.00
3,900.00	6.37	313.06	3,882.81	215.09	-230.15	-225.14	0.00	0.00	0.00
4,000.00	6.37	313.06	3,982.19	222.66	-238.25	-233.06	0.00	0.00	0.00
<b>Sussex</b>									
4,056.57	6.37	313.06	4,038.41	226.94	-242.84	-237.54	0.00	0.00	0.00
4,100.00	6.37	313.06	4,081.58	230.23	-246.35	-240.98	0.00	0.00	0.00
4,200.00	6.37	313.06	4,180.96	237.80	-254.45	-248.91	0.00	0.00	0.00
4,300.00	6.37	313.06	4,280.34	245.37	-262.56	-256.83	0.00	0.00	0.00
4,400.00	6.37	313.06	4,379.73	252.94	-270.66	-264.76	0.00	0.00	0.00
4,500.00	6.37	313.06	4,479.11	260.52	-278.76	-272.68	0.00	0.00	0.00
4,600.00	6.37	313.06	4,578.49	268.09	-286.86	-280.61	0.00	0.00	0.00
4,700.00	6.37	313.06	4,677.88	275.66	-294.96	-288.53	0.00	0.00	0.00

<b>Database:</b>	EDMDBBW	<b>Local Co-ordinate Reference:</b>	Well Anschutz State 5-62-26-3340BH2
<b>Company:</b>	Bill Barrett Corp.	<b>TVD Reference:</b>	WELL @ 4656.00usft (Original Well Elev)
<b>Project:</b>	Weld Co., CO	<b>MD Reference:</b>	WELL @ 4656.00usft (Original Well Elev)
<b>Site:</b>	Sec.26-T5N-R62W	<b>North Reference:</b>	True
<b>Well:</b>	Anschutz State 5-62-26-3340BH2	<b>Survey Calculation Method:</b>	Minimum Curvature
<b>Wellbore:</b>	Wellbore #1		
<b>Design:</b>	Design #1		

Planned Survey									
Measured Depth (usft)	Inclination (°)	Azimuth (°)	Vertical Depth (usft)	+N/-S (usft)	+E/-W (usft)	Vertical Section (usft)	Dogleg Rate (°/100usft)	Build Rate (°/100usft)	Turn Rate (°/100usft)
4,800.00	6.37	313.06	4,777.26	283.23	-303.06	-296.46	0.00	0.00	0.00
<b>Shannon</b>									
4,869.96	6.37	313.06	4,846.79	288.53	-308.73	-302.00	0.00	0.00	0.00
4,900.00	6.37	313.06	4,876.64	290.80	-311.16	-304.38	0.00	0.00	0.00
<b>Start Drop -2.00</b>									
4,934.46	6.37	313.06	4,910.89	293.41	-313.95	-307.11	0.00	0.00	0.00
5,000.00	5.06	313.06	4,976.10	297.86	-318.72	-311.77	2.00	-2.00	0.00
5,100.00	3.06	313.06	5,075.85	302.69	-323.88	-316.83	2.00	-2.00	0.00
5,200.00	1.06	313.06	5,175.78	305.14	-326.51	-319.39	2.00	-2.00	0.00
<b>Start 500.00 hold at 5252.76 MD</b>									
5,252.76	0.00	0.00	5,228.54	305.47	-326.86	-319.74	2.00	-2.00	0.00
5,300.00	0.00	0.00	5,275.78	305.47	-326.86	-319.74	0.00	0.00	0.00
5,400.00	0.00	0.00	5,375.78	305.47	-326.86	-319.74	0.00	0.00	0.00
5,500.00	0.00	0.00	5,475.78	305.47	-326.86	-319.74	0.00	0.00	0.00
5,600.00	0.00	0.00	5,575.78	305.47	-326.86	-319.74	0.00	0.00	0.00
5,700.00	0.00	0.00	5,675.78	305.47	-326.86	-319.74	0.00	0.00	0.00
<b>Start Build 12.00</b>									
5,752.76	0.00	0.00	5,728.54	305.47	-326.86	-319.74	0.00	0.00	0.00
5,775.00	2.67	88.68	5,750.77	305.48	-326.34	-319.22	12.00	12.00	0.00
5,800.00	5.67	88.68	5,775.70	305.52	-324.53	-317.40	12.00	12.00	0.00
5,825.00	8.67	88.68	5,800.50	305.60	-321.41	-314.28	12.00	12.00	0.00
5,850.00	11.67	88.68	5,825.11	305.70	-317.00	-309.87	12.00	12.00	0.00
5,875.00	14.67	88.68	5,849.45	305.83	-311.30	-304.17	12.00	12.00	0.00
5,900.00	17.67	88.68	5,873.45	305.99	-304.34	-297.21	12.00	12.00	0.00
5,925.00	20.67	88.68	5,897.06	306.18	-296.14	-289.01	12.00	12.00	0.00
5,950.00	23.67	88.68	5,920.21	306.39	-286.71	-279.57	12.00	12.00	0.00
5,975.00	26.67	88.68	5,942.84	306.64	-276.08	-268.94	12.00	12.00	0.00
6,000.00	29.67	88.68	5,964.87	306.91	-264.28	-257.14	12.00	12.00	0.00
<b>Sharon Springs</b>									
6,013.47	31.29	88.68	5,976.49	307.07	-257.45	-250.31	12.00	12.00	0.00
6,025.00	32.67	88.68	5,986.26	307.21	-251.35	-244.21	12.00	12.00	0.00
6,050.00	35.67	88.68	6,006.95	307.53	-237.31	-230.17	12.00	12.00	0.00
6,075.00	38.67	88.68	6,026.87	307.88	-222.22	-215.06	12.00	12.00	0.00
6,100.00	41.67	88.68	6,045.97	308.25	-206.10	-198.94	12.00	12.00	0.00
6,125.00	44.67	88.68	6,064.20	308.64	-189.00	-181.84	12.00	12.00	0.00
6,150.00	47.67	88.68	6,081.51	309.05	-170.97	-163.81	12.00	12.00	0.00
<b>Niobrara</b>									
6,153.65	48.11	88.68	6,083.96	309.12	-168.27	-161.10	12.00	12.00	0.00
6,175.00	50.67	88.68	6,097.85	309.49	-152.06	-144.89	12.00	12.00	0.00
6,200.00	53.67	88.68	6,113.19	309.94	-132.32	-125.15	12.00	12.00	0.00
<b>A Chalk</b>									
6,223.48	56.49	88.68	6,126.63	310.38	-113.08	-105.90	12.00	12.00	0.00
6,225.00	56.67	88.68	6,127.46	310.41	-111.81	-104.63	12.00	12.00	0.00
<b>B Marl</b>									
6,245.81	59.17	88.68	6,138.52	310.82	-94.19	-87.00	12.00	12.00	0.00
6,250.00	59.67	88.68	6,140.65	310.90	-90.58	-83.39	12.00	12.00	0.00
6,275.00	62.67	88.68	6,152.70	311.41	-68.69	-61.50	12.00	12.00	0.00
6,300.00	65.67	88.68	6,163.59	311.92	-46.19	-39.00	12.00	12.00	0.00
6,325.00	68.67	88.68	6,173.29	312.45	-23.16	-15.96	12.00	12.00	0.00
6,350.00	71.67	88.68	6,181.77	312.99	0.35	7.56	12.00	12.00	0.00
<b>Top B2 Target</b>									
6,356.96	72.50	88.68	6,183.92	313.14	6.97	14.18	12.00	12.00	0.00
6,375.00	74.67	88.68	6,189.01	313.54	24.27	31.48	12.00	12.00	0.00

<b>Database:</b>	EDMDBBW	<b>Local Co-ordinate Reference:</b>	Well Anschutz State 5-62-26-3340BH2
<b>Company:</b>	Bill Barrett Corp.	<b>TVD Reference:</b>	WELL @ 4656.00usft (Original Well Elev)
<b>Project:</b>	Weld Co., CO	<b>MD Reference:</b>	WELL @ 4656.00usft (Original Well Elev)
<b>Site:</b>	Sec.26-T5N-R62W	<b>North Reference:</b>	True
<b>Well:</b>	Anschutz State 5-62-26-3340BH2	<b>Survey Calculation Method:</b>	Minimum Curvature
<b>Wellbore:</b>	Wellbore #1		
<b>Design:</b>	Design #1		

Planned Survey									
Measured Depth (usft)	Inclination (°)	Azimuth (°)	Vertical Depth (usft)	+N/-S (usft)	+E/-W (usft)	Vertical Section (usft)	Dogleg Rate (°/100usft)	Build Rate (°/100usft)	Turn Rate (°/100usft)
6,400.00	77.67	88.68	6,194.99	314.10	48.53	55.76	12.00	12.00	0.00
6,425.00	80.67	88.68	6,199.69	314.66	73.08	80.31	12.00	12.00	0.00
6,450.00	83.67	88.68	6,203.09	315.23	97.84	105.07	12.00	12.00	0.00
6,475.00	86.67	88.68	6,205.20	315.81	122.74	129.98	12.00	12.00	0.00
6,500.00	89.67	88.68	6,206.00	316.38	147.72	154.96	12.00	12.00	0.00
<b>Start 9742.17 hold at 6505.56 MD - 7" Csg.</b>									
6,505.56	90.34	88.68	6,206.00	316.51	153.27	160.52	11.99	11.99	0.00
6,600.00	90.34	88.68	6,205.44	318.68	247.69	254.96	0.00	0.00	0.00
6,700.00	90.34	88.68	6,204.86	320.98	347.66	354.96	0.00	0.00	0.00
6,800.00	90.34	88.68	6,204.27	323.28	447.63	454.96	0.00	0.00	0.00
6,900.00	90.34	88.68	6,203.69	325.57	547.60	554.96	0.00	0.00	0.00
7,000.00	90.34	88.68	6,203.10	327.87	647.57	654.96	0.00	0.00	0.00
7,100.00	90.34	88.68	6,202.52	330.17	747.55	754.95	0.00	0.00	0.00
7,200.00	90.34	88.68	6,201.93	332.47	847.52	854.95	0.00	0.00	0.00
7,300.00	90.34	88.68	6,201.35	334.77	947.49	954.95	0.00	0.00	0.00
7,400.00	90.34	88.68	6,200.76	337.07	1,047.46	1,054.95	0.00	0.00	0.00
7,500.00	90.34	88.68	6,200.18	339.36	1,147.43	1,154.95	0.00	0.00	0.00
7,600.00	90.34	88.68	6,199.59	341.66	1,247.41	1,254.95	0.00	0.00	0.00
7,700.00	90.34	88.68	6,199.01	343.96	1,347.38	1,354.94	0.00	0.00	0.00
7,800.00	90.34	88.68	6,198.42	346.26	1,447.35	1,454.94	0.00	0.00	0.00
7,900.00	90.34	88.68	6,197.84	348.56	1,547.32	1,554.94	0.00	0.00	0.00
8,000.00	90.34	88.68	6,197.25	350.86	1,647.29	1,654.94	0.00	0.00	0.00
8,100.00	90.34	88.68	6,196.67	353.15	1,747.27	1,754.94	0.00	0.00	0.00
8,200.00	90.34	88.68	6,196.08	355.45	1,847.24	1,854.94	0.00	0.00	0.00
8,300.00	90.34	88.68	6,195.50	357.75	1,947.21	1,954.93	0.00	0.00	0.00
8,400.00	90.34	88.68	6,194.91	360.05	2,047.18	2,054.93	0.00	0.00	0.00
8,500.00	90.34	88.68	6,194.33	362.35	2,147.15	2,154.93	0.00	0.00	0.00
8,600.00	90.34	88.68	6,193.74	364.65	2,247.12	2,254.93	0.00	0.00	0.00
8,700.00	90.34	88.68	6,193.16	366.94	2,347.10	2,354.93	0.00	0.00	0.00
8,800.00	90.34	88.68	6,192.57	369.24	2,447.07	2,454.93	0.00	0.00	0.00
8,900.00	90.34	88.68	6,191.99	371.54	2,547.04	2,554.92	0.00	0.00	0.00
9,000.00	90.34	88.68	6,191.40	373.84	2,647.01	2,654.92	0.00	0.00	0.00
9,100.00	90.34	88.68	6,190.82	376.14	2,746.98	2,754.92	0.00	0.00	0.00
9,200.00	90.34	88.68	6,190.23	378.44	2,846.96	2,854.92	0.00	0.00	0.00
9,300.00	90.34	88.68	6,189.65	380.73	2,946.93	2,954.92	0.00	0.00	0.00
9,400.00	90.34	88.68	6,189.06	383.03	3,046.90	3,054.91	0.00	0.00	0.00
9,500.00	90.34	88.68	6,188.48	385.33	3,146.87	3,154.91	0.00	0.00	0.00
9,600.00	90.34	88.68	6,187.89	387.63	3,246.84	3,254.91	0.00	0.00	0.00
9,700.00	90.34	88.68	6,187.31	389.93	3,346.82	3,354.91	0.00	0.00	0.00
9,800.00	90.34	88.68	6,186.72	392.23	3,446.79	3,454.91	0.00	0.00	0.00
9,900.00	90.34	88.68	6,186.14	394.52	3,546.76	3,554.91	0.00	0.00	0.00
10,000.00	90.34	88.68	6,185.55	396.82	3,646.73	3,654.90	0.00	0.00	0.00
10,100.00	90.34	88.68	6,184.97	399.12	3,746.70	3,754.90	0.00	0.00	0.00
10,200.00	90.34	88.68	6,184.38	401.42	3,846.67	3,854.90	0.00	0.00	0.00
10,300.00	90.34	88.68	6,183.80	403.72	3,946.65	3,954.90	0.00	0.00	0.00
10,400.00	90.34	88.68	6,183.21	406.02	4,046.62	4,054.90	0.00	0.00	0.00
10,500.00	90.34	88.68	6,182.63	408.31	4,146.59	4,154.90	0.00	0.00	0.00
10,600.00	90.34	88.68	6,182.04	410.61	4,246.56	4,254.89	0.00	0.00	0.00
10,700.00	90.34	88.68	6,181.46	412.91	4,346.53	4,354.89	0.00	0.00	0.00
10,800.00	90.34	88.68	6,180.87	415.21	4,446.51	4,454.89	0.00	0.00	0.00
10,900.00	90.34	88.68	6,180.29	417.51	4,546.48	4,554.89	0.00	0.00	0.00
11,000.00	90.34	88.68	6,179.70	419.81	4,646.45	4,654.89	0.00	0.00	0.00
11,100.00	90.34	88.68	6,179.12	422.10	4,746.42	4,754.89	0.00	0.00	0.00

<b>Database:</b>	EDMDBBW	<b>Local Co-ordinate Reference:</b>	Well Anschutz State 5-62-26-3340BH2
<b>Company:</b>	Bill Barrett Corp.	<b>TVD Reference:</b>	WELL @ 4656.00usft (Original Well Elev)
<b>Project:</b>	Weld Co., CO	<b>MD Reference:</b>	WELL @ 4656.00usft (Original Well Elev)
<b>Site:</b>	Sec.26-T5N-R62W	<b>North Reference:</b>	True
<b>Well:</b>	Anschutz State 5-62-26-3340BH2	<b>Survey Calculation Method:</b>	Minimum Curvature
<b>Wellbore:</b>	Wellbore #1		
<b>Design:</b>	Design #1		

Planned Survey									
Measured Depth (usft)	Inclination (°)	Azimuth (°)	Vertical Depth (usft)	+N/-S (usft)	+E/-W (usft)	Vertical Section (usft)	Dogleg Rate (°/100usft)	Build Rate (°/100usft)	Turn Rate (°/100usft)
11,200.00	90.34	88.68	6,178.53	424.40	4,846.39	4,854.88	0.00	0.00	0.00
11,300.00	90.34	88.68	6,177.95	426.70	4,946.37	4,954.88	0.00	0.00	0.00
11,400.00	90.34	88.68	6,177.36	429.00	5,046.34	5,054.88	0.00	0.00	0.00
11,500.00	90.34	88.68	6,176.78	431.30	5,146.31	5,154.88	0.00	0.00	0.00
11,600.00	90.34	88.68	6,176.19	433.60	5,246.28	5,254.88	0.00	0.00	0.00
11,700.00	90.34	88.68	6,175.61	435.89	5,346.25	5,354.88	0.00	0.00	0.00
11,800.00	90.34	88.68	6,175.02	438.19	5,446.22	5,454.87	0.00	0.00	0.00
11,900.00	90.34	88.68	6,174.44	440.49	5,546.20	5,554.87	0.00	0.00	0.00
12,000.00	90.34	88.68	6,173.85	442.79	5,646.17	5,654.87	0.00	0.00	0.00
12,100.00	90.34	88.68	6,173.27	445.09	5,746.14	5,754.87	0.00	0.00	0.00
12,200.00	90.34	88.68	6,172.68	447.39	5,846.11	5,854.87	0.00	0.00	0.00
12,300.00	90.34	88.68	6,172.10	449.68	5,946.08	5,954.87	0.00	0.00	0.00
12,400.00	90.34	88.68	6,171.51	451.98	6,046.06	6,054.86	0.00	0.00	0.00
12,500.00	90.34	88.68	6,170.93	454.28	6,146.03	6,154.86	0.00	0.00	0.00
12,600.00	90.34	88.68	6,170.34	456.58	6,246.00	6,254.86	0.00	0.00	0.00
12,700.00	90.34	88.68	6,169.76	458.88	6,345.97	6,354.86	0.00	0.00	0.00
12,800.00	90.34	88.68	6,169.17	461.18	6,445.94	6,454.86	0.00	0.00	0.00
12,900.00	90.34	88.68	6,168.59	463.47	6,545.92	6,554.86	0.00	0.00	0.00
13,000.00	90.34	88.68	6,168.00	465.77	6,645.89	6,654.85	0.00	0.00	0.00
13,100.00	90.34	88.68	6,167.42	468.07	6,745.86	6,754.85	0.00	0.00	0.00
13,200.00	90.34	88.68	6,166.83	470.37	6,845.83	6,854.85	0.00	0.00	0.00
13,300.00	90.34	88.68	6,166.25	472.67	6,945.80	6,954.85	0.00	0.00	0.00
13,400.00	90.34	88.68	6,165.66	474.97	7,045.77	7,054.85	0.00	0.00	0.00
13,500.00	90.34	88.68	6,165.08	477.26	7,145.75	7,154.84	0.00	0.00	0.00
13,600.00	90.34	88.68	6,164.49	479.56	7,245.72	7,254.84	0.00	0.00	0.00
13,700.00	90.34	88.68	6,163.91	481.86	7,345.69	7,354.84	0.00	0.00	0.00
13,800.00	90.34	88.68	6,163.32	484.16	7,445.66	7,454.84	0.00	0.00	0.00
13,900.00	90.34	88.68	6,162.74	486.46	7,545.63	7,554.84	0.00	0.00	0.00
14,000.00	90.34	88.68	6,162.15	488.76	7,645.61	7,654.84	0.00	0.00	0.00
14,100.00	90.34	88.68	6,161.57	491.05	7,745.58	7,754.83	0.00	0.00	0.00
14,200.00	90.34	88.68	6,160.98	493.35	7,845.55	7,854.83	0.00	0.00	0.00
14,300.00	90.34	88.68	6,160.40	495.65	7,945.52	7,954.83	0.00	0.00	0.00
14,400.00	90.34	88.68	6,159.81	497.95	8,045.49	8,054.83	0.00	0.00	0.00
14,500.00	90.34	88.68	6,159.23	500.25	8,145.47	8,154.83	0.00	0.00	0.00
14,600.00	90.34	88.68	6,158.64	502.55	8,245.44	8,254.83	0.00	0.00	0.00
14,700.00	90.34	88.68	6,158.06	504.84	8,345.41	8,354.82	0.00	0.00	0.00
14,800.00	90.34	88.68	6,157.47	507.14	8,445.38	8,454.82	0.00	0.00	0.00
14,900.00	90.34	88.68	6,156.89	509.44	8,545.35	8,554.82	0.00	0.00	0.00
15,000.00	90.34	88.68	6,156.30	511.74	8,645.32	8,654.82	0.00	0.00	0.00
15,100.00	90.34	88.68	6,155.72	514.04	8,745.30	8,754.82	0.00	0.00	0.00
15,200.00	90.34	88.68	6,155.13	516.34	8,845.27	8,854.82	0.00	0.00	0.00
15,300.00	90.34	88.68	6,154.55	518.63	8,945.24	8,954.81	0.00	0.00	0.00
15,400.00	90.34	88.68	6,153.96	520.93	9,045.21	9,054.81	0.00	0.00	0.00
15,500.00	90.34	88.68	6,153.38	523.23	9,145.18	9,154.81	0.00	0.00	0.00
15,600.00	90.34	88.68	6,152.79	525.53	9,245.16	9,254.81	0.00	0.00	0.00
15,700.00	90.34	88.68	6,152.21	527.83	9,345.13	9,354.81	0.00	0.00	0.00
15,800.00	90.34	88.68	6,151.62	530.13	9,445.10	9,454.81	0.00	0.00	0.00
15,900.00	90.34	88.68	6,151.04	532.42	9,545.07	9,554.80	0.00	0.00	0.00
16,000.00	90.34	88.68	6,150.45	534.72	9,645.04	9,654.80	0.00	0.00	0.00
16,100.00	90.34	88.68	6,149.87	537.02	9,745.02	9,754.80	0.00	0.00	0.00
16,200.00	90.34	88.68	6,149.28	539.32	9,844.99	9,854.80	0.00	0.00	0.00
TD at 16247.73									
16,247.73	90.34	88.68	6,149.00	540.42	9,892.70	9,902.53	0.00	0.00	0.00



<b>Database:</b>	EDMDBBW	<b>Local Co-ordinate Reference:</b>	Well Anschutz State 5-62-26-3340BH2
<b>Company:</b>	Bill Barrett Corp.	<b>TVD Reference:</b>	WELL @ 4656.00usft (Original Well Elev)
<b>Project:</b>	Weld Co., CO	<b>MD Reference:</b>	WELL @ 4656.00usft (Original Well Elev)
<b>Site:</b>	Sec.26-T5N-R62W	<b>North Reference:</b>	True
<b>Well:</b>	Anschutz State 5-62-26-3340BH2	<b>Survey Calculation Method:</b>	Minimum Curvature
<b>Wellbore:</b>	Wellbore #1		
<b>Design:</b>	Design #1		

Design Targets									
Target Name									
- hit/miss target	Dip Angle	Dip Dir.	TVD	+N/-S	+E/-W	Northing	Easting	Latitude	Longitude
- Shape	(°)	(°)	(usft)	(usft)	(usft)	(usft)	(usft)		
Anschutz State 5-62-26-	0.00	0.00	6,206.00	540.42	9,892.70	1,380,488.136	3,344,536.075	40° 22' 16.489 N	104° 15' 48.301 W
- plan misses target center by 57.00usft at 16247.40usft MD (6149.00 TVD, 540.41 N, 9892.37 E)									
- Point									

Casing Points				
Measured Depth	Vertical Depth		Casing Diameter	Hole Diameter
(usft)	(usft)	Name	(")	(")
6,505.56	6,206.00	7" Csg.	7	8-3/4

Formations						
Measured Depth	Vertical Depth			Dip	Dip	
(usft)	(usft)	Name	Lithology	(°)	Direction	(°)
4,056.57	4,037.00	Sussex		-0.34	88.68	
4,869.96	4,845.00	Shannon		-0.34	88.68	
6,013.47	5,975.00	Sharon Springs		-0.34	88.68	
6,153.65	6,083.00	Niobrara		-0.34	88.68	
6,223.48	6,126.00	A Chalk		-0.34	88.68	
6,245.81	6,138.00	B Marl		-0.34	88.68	
6,356.96	6,184.00	Top B2 Target		-0.34	88.68	

Plan Annotations				
Measured Depth	Vertical Depth	Local Coordinates		
(usft)	(usft)	+N/-S (usft)	+E/-W (usft)	Comment
900.00	900.00	0.00	0.00	Start Build 2.00
1,218.30	1,217.65	12.06	-12.91	Start 3716.15 hold at 1218.30 MD
4,934.46	4,910.89	293.41	-313.95	Start Drop -2.00
5,252.76	5,228.54	305.47	-326.86	Start 500.00 hold at 5252.76 MD
5,752.76	5,728.54	305.47	-326.86	Start Build 12.00
6,505.56	6,206.00	316.51	153.27	Start 9742.17 hold at 6505.56 MD
16,247.73	6,149.00	540.42	9,892.70	TD at 16247.73