



Bill Barrett Corporation

Bill Barrett Corp.

Weld Co., CO

Sec.26-T5N-R62W

Anschutz State 5-62-26-1609BH2

Wellbore #1

Plan: Design #1

Standard Planning Report

11 August, 2014

Archer



Bill Barrett Corp.
Project: Weld Co., CO
Site: Sec.26-T5N-R62W
Well: Anschutz State 5-62-26-1609BH2
Wellbore: Wellbore #1
Design: Design #1
Lat: 40° 22' 26.681 N
Long: 104° 17' 56.422 W
Pad GL: 4640.00
KB: WELL @ 4656.00usft (Original Well Elev)

Archer

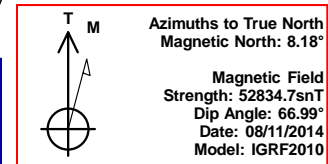
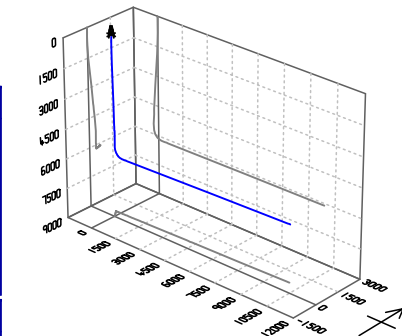

SECTION DETAILS										
MD	Inc	Azi	TVD	+N/-S	+E/-W	Dleg	TFace	V Sect	Annotation	
0.00	0.00	0.00	0.00	0.00	0.00	0.00	0.00	0.00		
900.00	0.00	0.00	900.00	0.00	0.00	0.00	0.00	0.00	Start Build 2.00	
1268.59	7.37	323.31	1267.57	18.99	-14.15	2.00	323.31	-13.60	Start 3605.19 hold at 1268.59 MD	
4873.78	7.37	323.31	4842.97	389.92	-290.52	0.00	0.00	-279.31	Start Drop -2.00	
5242.37	0.00	0.00	5210.54	408.91	-304.67	2.00	180.00	-292.92	Start 500.01 hold at 5242.37 MD	
5742.38	0.00	0.00	5710.55	408.91	-304.67	0.00	0.00	-292.92	Start Build 12.00	
6496.31	90.47	88.37	6188.00	422.59	176.52	12.00	88.37	188.47	Start 9733.96 hold at 6496.31 MD	
16230.26	90.47	88.37	6108.00	699.25	9906.22	0.00	0.00	9922.10	TD at 16230.26	

WELL DETAILS: Anschutz State 5-62-26-1609BH2							
+N/-S	+E/-W	Northing	Ground Level: Easting	Latitude	Longitude	Slot	
0.00	0.00	1381383.065	4640.00	40° 22' 26.681 N	104° 17' 56.422 W		

PROJECT DETAILS: Weld Co., CO			
Geodetic System:	US State Plane 1983		
Datum:	North American Datum 1983		
Ellipsoid:	GRS 1980		
Zone:	Colorado Northern Zone		
System Datum:	Mean Sea Level		

CASING DETAILS			
TVD	MD	Name	
6188.00	6496.31	7" Csg.	

WELLBORE TARGET DETAILS (LAT/LONG)							
Name	TVD	+N/-S	+E/-W	Latitude	Longitude	Shape	Point
Anschutz State 5-62-26-1609BH2 tgt	6108.00	699.25	9906.22	40° 22' 33.571 N	104° 15' 48.420 W		

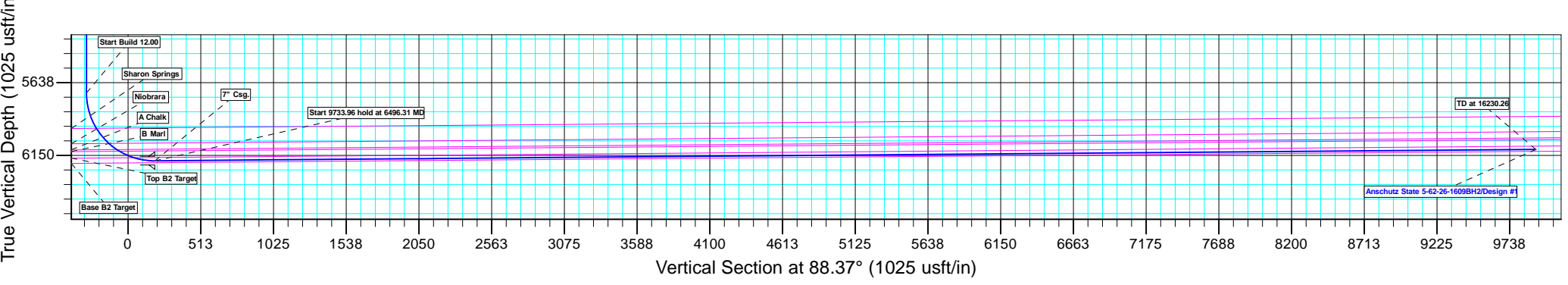
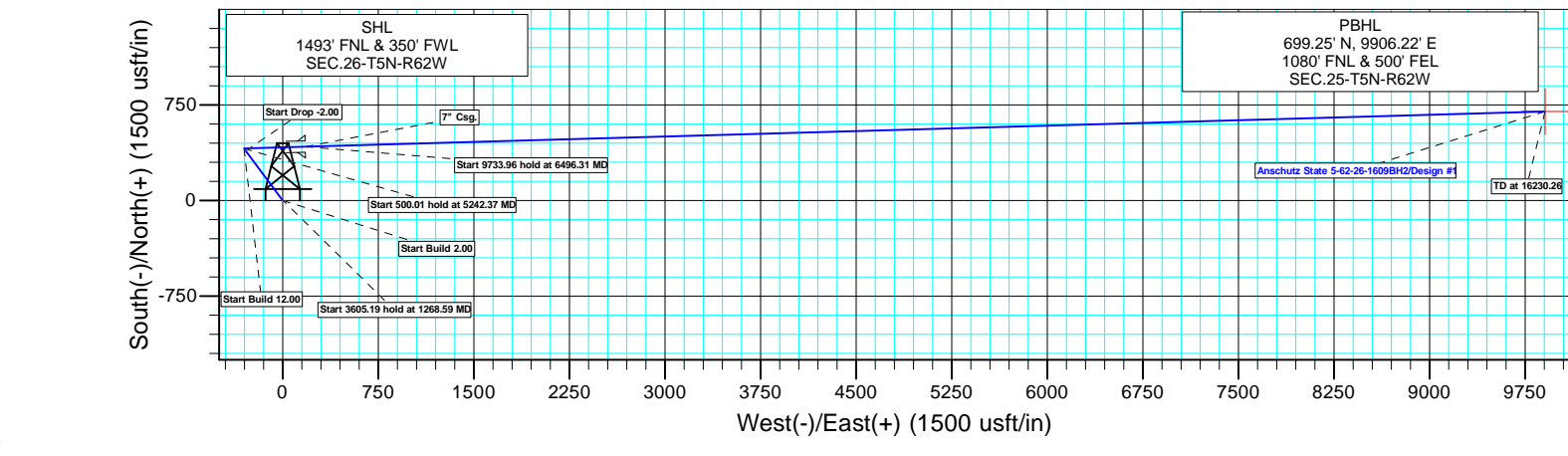
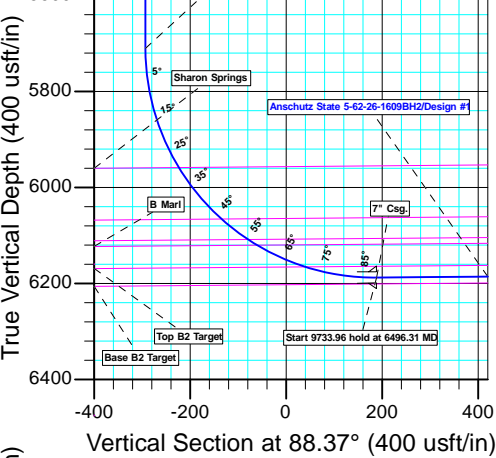

Database:	EDMDBBW	Local Co-ordinate Reference:	Well Anschutz State 5-62-26-1609BH2
Company:	Bill Barrett Corp.	TVD Reference:	WELL @ 4656.00usft (Original Well Elev)
Project:	Weld Co., CO	MD Reference:	WELL @ 4656.00usft (Original Well Elev)
Site:	Sec.26-T5N-R62W	North Reference:	True
Well:	Anschutz State 5-62-26-1609BH2	Survey Calculation Method:	Minimum Curvature
Wellbore:	Wellbore #1		
Design:	Design #1		

Project	Weld Co., CO		
Map System:	US State Plane 1983	System Datum:	Mean Sea Level
Geo Datum:	North American Datum 1983		
Map Zone:	Colorado Northern Zone		

Site		Sec.26-T5N-R62W			
Site Position:		Northing:	1,382,286.736 usft	Latitude:	40° 22' 35.580 N
From:	Lat/Long	Easting:	3,334,831.533 usft	Longitude:	104° 17' 53.362 W
Position Uncertainty:	0.00 usft	Slot Radius:	13-3/16"	Grid Convergence:	0.78 °

Well	Anschutz State 5-62-26-1609BH2					
Well Position	+N/-S	-900.54 usft	Northing:	1,381,383.065 usft	Latitude:	40° 22' 26.681 N
	+E/-W	-236.82 usft	Easting:	3,334,606.935 usft	Longitude:	104° 17' 56.422 W
Position Uncertainty		0.00 usft	Wellhead Elevation:	usft	Ground Level:	4,640.00 usft

Wellbore	Wellbore #1				
Magnetics	Model Name	Sample Date	Declination (°)	Dip Angle (°)	Field Strength (nT)
	IGRF2010	2014/08/11	8.18	66.99	52,835

Design	Design #1			
Audit Notes:				
Version:	Phase:	PLAN	Tie On Depth:	0.00
Vertical Section:	Depth From (TVD) (usft)	+N/-S (usft)	+E/-W (usft)	Direction (°)
	0.00	0.00	0.00	88.37

Plan Sections										
Measured Depth (usft)	Inclination (°)	Azimuth (°)	Vertical Depth (usft)	+N/-S (usft)	+E/-W (usft)	Dogleg Rate (°/100usft)	Build Rate (°/100usft)	Turn Rate (°/100usft)	TFO (°)	Target
0.00	0.00	0.00	0.00	0.00	0.00	0.00	0.00	0.00	0.00	
900.00	0.00	0.00	900.00	0.00	0.00	0.00	0.00	0.00	0.00	
1,268.59	7.37	323.31	1,267.57	18.99	-14.15	2.00	2.00	0.00	323.31	
4,873.78	7.37	323.31	4,842.97	389.92	-290.52	0.00	0.00	0.00	0.00	
5,242.37	0.00	0.00	5,210.54	408.91	-304.67	2.00	-2.00	0.00	180.00	
5,742.38	0.00	0.00	5,710.55	408.91	-304.67	0.00	0.00	0.00	0.00	
6,496.31	90.47	88.37	6,188.00	422.59	176.52	12.00	12.00	0.00	88.37	Anschutz State 5-62-2
16,230.26	90.47	88.37	6,108.00	699.25	9,906.22	0.00	0.00	0.00	0.00	Anschutz State 5-62-2

Database:	EDMDBBW	Local Co-ordinate Reference:	Well Anschutz State 5-62-26-1609BH2
Company:	Bill Barrett Corp.	TVD Reference:	WELL @ 4656.00usft (Original Well Elev)
Project:	Weld Co., CO	MD Reference:	WELL @ 4656.00usft (Original Well Elev)
Site:	Sec.26-T5N-R62W	North Reference:	True
Well:	Anschutz State 5-62-26-1609BH2	Survey Calculation Method:	Minimum Curvature
Wellbore:	Wellbore #1		
Design:	Design #1		

Planned Survey									
Measured Depth (usft)	Inclination (°)	Azimuth (°)	Vertical Depth (usft)	+N/-S (usft)	+E/-W (usft)	Vertical Section (usft)	Dogleg Rate (°/100usft)	Build Rate (°/100usft)	Turn Rate (°/100usft)
0.00	0.00	0.00	0.00	0.00	0.00	0.00	0.00	0.00	0.00
100.00	0.00	0.00	100.00	0.00	0.00	0.00	0.00	0.00	0.00
200.00	0.00	0.00	200.00	0.00	0.00	0.00	0.00	0.00	0.00
300.00	0.00	0.00	300.00	0.00	0.00	0.00	0.00	0.00	0.00
400.00	0.00	0.00	400.00	0.00	0.00	0.00	0.00	0.00	0.00
500.00	0.00	0.00	500.00	0.00	0.00	0.00	0.00	0.00	0.00
600.00	0.00	0.00	600.00	0.00	0.00	0.00	0.00	0.00	0.00
700.00	0.00	0.00	700.00	0.00	0.00	0.00	0.00	0.00	0.00
800.00	0.00	0.00	800.00	0.00	0.00	0.00	0.00	0.00	0.00
Start Build 2.00									
900.00	0.00	0.00	900.00	0.00	0.00	0.00	0.00	0.00	0.00
1,000.00	2.00	323.31	999.98	1.40	-1.04	-1.00	2.00	2.00	0.00
1,100.00	4.00	323.31	1,099.84	5.60	-4.17	-4.01	2.00	2.00	0.00
1,200.00	6.00	323.31	1,199.45	12.58	-9.38	-9.01	2.00	2.00	0.00
Start 3605.19 hold at 1268.59 MD									
1,268.59	7.37	323.31	1,267.57	18.99	-14.15	-13.60	2.00	2.00	0.00
1,300.00	7.37	323.31	1,298.72	22.22	-16.56	-15.92	0.00	0.00	0.00
1,400.00	7.37	323.31	1,397.90	32.51	-24.22	-23.29	0.00	0.00	0.00
1,500.00	7.37	323.31	1,497.07	42.80	-31.89	-30.66	0.00	0.00	0.00
1,600.00	7.37	323.31	1,596.24	53.09	-39.55	-38.03	0.00	0.00	0.00
1,700.00	7.37	323.31	1,695.42	63.38	-47.22	-45.40	0.00	0.00	0.00
1,800.00	7.37	323.31	1,794.59	73.66	-54.89	-52.77	0.00	0.00	0.00
1,900.00	7.37	323.31	1,893.76	83.95	-62.55	-60.14	0.00	0.00	0.00
2,000.00	7.37	323.31	1,992.94	94.24	-70.22	-67.51	0.00	0.00	0.00
2,100.00	7.37	323.31	2,092.11	104.53	-77.88	-74.88	0.00	0.00	0.00
2,200.00	7.37	323.31	2,191.29	114.82	-85.55	-82.25	0.00	0.00	0.00
2,300.00	7.37	323.31	2,290.46	125.11	-93.22	-89.62	0.00	0.00	0.00
2,400.00	7.37	323.31	2,389.63	135.40	-100.88	-96.99	0.00	0.00	0.00
2,500.00	7.37	323.31	2,488.81	145.69	-108.55	-104.36	0.00	0.00	0.00
2,600.00	7.37	323.31	2,587.98	155.98	-116.21	-111.73	0.00	0.00	0.00
2,700.00	7.37	323.31	2,687.15	166.26	-123.88	-119.10	0.00	0.00	0.00
2,800.00	7.37	323.31	2,786.33	176.55	-131.55	-126.47	0.00	0.00	0.00
2,900.00	7.37	323.31	2,885.50	186.84	-139.21	-133.84	0.00	0.00	0.00
3,000.00	7.37	323.31	2,984.67	197.13	-146.88	-141.21	0.00	0.00	0.00
3,100.00	7.37	323.31	3,083.85	207.42	-154.54	-148.58	0.00	0.00	0.00
3,200.00	7.37	323.31	3,183.02	217.71	-162.21	-155.95	0.00	0.00	0.00
3,300.00	7.37	323.31	3,282.19	228.00	-169.88	-163.32	0.00	0.00	0.00
3,400.00	7.37	323.31	3,381.37	238.29	-177.54	-170.69	0.00	0.00	0.00
3,500.00	7.37	323.31	3,480.54	248.58	-185.21	-178.06	0.00	0.00	0.00
3,600.00	7.37	323.31	3,579.71	258.86	-192.87	-185.43	0.00	0.00	0.00
3,700.00	7.37	323.31	3,678.89	269.15	-200.54	-192.80	0.00	0.00	0.00
3,800.00	7.37	323.31	3,778.06	279.44	-208.21	-200.17	0.00	0.00	0.00
3,900.00	7.37	323.31	3,877.23	289.73	-215.87	-207.54	0.00	0.00	0.00
4,000.00	7.37	323.31	3,976.41	300.02	-223.54	-214.91	0.00	0.00	0.00
Sussex									
4,044.75	7.37	323.31	4,020.79	304.62	-226.97	-218.21	0.00	0.00	0.00
4,100.00	7.37	323.31	4,075.58	310.31	-231.20	-222.28	0.00	0.00	0.00
4,200.00	7.37	323.31	4,174.75	320.60	-238.87	-229.65	0.00	0.00	0.00
4,300.00	7.37	323.31	4,273.93	330.89	-246.54	-237.02	0.00	0.00	0.00
4,400.00	7.37	323.31	4,373.10	341.18	-254.20	-244.39	0.00	0.00	0.00
4,500.00	7.37	323.31	4,472.27	351.46	-261.87	-251.76	0.00	0.00	0.00
4,600.00	7.37	323.31	4,571.45	361.75	-269.53	-259.14	0.00	0.00	0.00
4,700.00	7.37	323.31	4,670.62	372.04	-277.20	-266.51	0.00	0.00	0.00

Database:	EDMDBBW	Local Co-ordinate Reference:	Well Anschutz State 5-62-26-1609BH2
Company:	Bill Barrett Corp.	TVD Reference:	WELL @ 4656.00usft (Original Well Elev)
Project:	Weld Co., CO	MD Reference:	WELL @ 4656.00usft (Original Well Elev)
Site:	Sec.26-T5N-R62W	North Reference:	True
Well:	Anschutz State 5-62-26-1609BH2	Survey Calculation Method:	Minimum Curvature
Wellbore:	Wellbore #1		
Design:	Design #1		

Planned Survey										
Measured Depth (usft)	Inclination (°)	Azimuth (°)	Vertical Depth (usft)	+N/-S (usft)	+E/-W (usft)	Vertical Section (usft)	Dogleg Rate (°/100usft)	Build Rate (°/100usft)	Turn Rate (°/100usft)	
4,800.00	7.37	323.31	4,769.79	382.33	-284.87	-273.88	0.00	0.00	0.00	
Shannon										
4,859.98	7.37	323.31	4,829.28	388.50	-289.46	-278.30	0.00	0.00	0.00	
Start Drop -2.00										
4,873.78	7.37	323.31	4,842.97	389.92	-290.52	-279.31	0.00	0.00	0.00	
4,900.00	6.85	323.31	4,868.98	392.52	-292.46	-281.18	2.00	-2.00	0.00	
5,000.00	4.85	323.31	4,968.46	400.69	-298.55	-287.03	2.00	-2.00	0.00	
5,100.00	2.85	323.31	5,068.23	406.07	-302.56	-290.88	2.00	-2.00	0.00	
5,200.00	0.85	323.31	5,168.17	408.66	-304.48	-292.74	2.00	-2.00	0.00	
Start 500.01 hold at 5242.37 MD										
5,242.37	0.00	0.00	5,210.54	408.91	-304.67	-292.92	2.00	-2.00	0.00	
5,300.00	0.00	0.00	5,268.17	408.91	-304.67	-292.92	0.00	0.00	0.00	
5,400.00	0.00	0.00	5,368.17	408.91	-304.67	-292.92	0.00	0.00	0.00	
5,500.00	0.00	0.00	5,468.17	408.91	-304.67	-292.92	0.00	0.00	0.00	
5,600.00	0.00	0.00	5,568.17	408.91	-304.67	-292.92	0.00	0.00	0.00	
5,700.00	0.00	0.00	5,668.17	408.91	-304.67	-292.92	0.00	0.00	0.00	
Start Build 12.00										
5,742.38	0.00	0.00	5,710.55	408.91	-304.67	-292.92	0.00	0.00	0.00	
5,750.00	0.91	88.37	5,718.17	408.91	-304.61	-292.85	12.00	12.00	0.00	
5,775.00	3.91	88.37	5,743.14	408.94	-303.56	-291.80	12.00	12.00	0.00	
5,800.00	6.91	88.37	5,768.03	409.01	-301.20	-289.44	12.00	12.00	0.00	
5,825.00	9.91	88.37	5,792.76	409.11	-297.54	-285.79	12.00	12.00	0.00	
5,850.00	12.91	88.37	5,817.26	409.25	-292.60	-280.84	12.00	12.00	0.00	
5,875.00	15.91	88.37	5,841.47	409.43	-286.38	-274.62	12.00	12.00	0.00	
5,900.00	18.91	88.37	5,865.32	409.64	-278.90	-267.13	12.00	12.00	0.00	
5,925.00	21.91	88.37	5,888.75	409.89	-270.18	-258.42	12.00	12.00	0.00	
5,950.00	24.91	88.37	5,911.69	410.17	-260.25	-248.48	12.00	12.00	0.00	
5,975.00	27.91	88.37	5,934.07	410.49	-249.14	-237.36	12.00	12.00	0.00	
6,000.00	30.91	88.37	5,955.85	410.84	-236.87	-225.09	12.00	12.00	0.00	
Sharon Springs										
6,003.48	31.33	88.37	5,958.83	410.89	-235.07	-223.28	12.00	12.00	0.00	
6,025.00	33.91	88.37	5,976.95	411.22	-223.47	-211.69	12.00	12.00	0.00	
6,050.00	36.91	88.37	5,997.32	411.63	-208.99	-197.20	12.00	12.00	0.00	
6,075.00	39.91	88.37	6,016.91	412.07	-193.47	-181.67	12.00	12.00	0.00	
6,100.00	42.91	88.37	6,035.66	412.54	-176.94	-165.13	12.00	12.00	0.00	
6,125.00	45.91	88.37	6,053.51	413.04	-159.45	-147.64	12.00	12.00	0.00	
Niobrara										
6,143.47	48.13	88.37	6,066.10	413.42	-145.95	-134.13	12.00	12.00	0.00	
6,150.00	48.91	88.37	6,070.43	413.56	-141.06	-129.23	12.00	12.00	0.00	
6,175.00	51.91	88.37	6,086.36	414.11	-121.80	-109.97	12.00	12.00	0.00	
6,200.00	54.91	88.37	6,101.26	414.68	-101.73	-89.90	12.00	12.00	0.00	
A Chalk										
6,213.12	56.49	88.37	6,108.65	414.99	-90.90	-79.06	12.00	12.00	0.00	
6,225.00	57.91	88.37	6,115.08	415.27	-80.92	-69.07	12.00	12.00	0.00	
B Marl										
6,235.37	59.16	88.37	6,120.49	415.52	-72.08	-60.23	12.00	12.00	0.00	
6,250.00	60.91	88.37	6,127.80	415.88	-59.41	-47.55	12.00	12.00	0.00	
6,275.00	63.91	88.37	6,139.38	416.51	-37.26	-25.40	12.00	12.00	0.00	
6,300.00	66.91	88.37	6,149.78	417.16	-14.54	-2.67	12.00	12.00	0.00	
6,325.00	69.91	88.37	6,158.98	417.82	8.69	20.58	12.00	12.00	0.00	
Top B2 Target										
6,345.73	72.40	88.37	6,165.67	418.38	28.31	40.20	12.00	12.00	0.00	
6,350.00	72.91	88.37	6,166.94	418.49	32.38	44.27	12.00	12.00	0.00	

Database:	EDMDBBW	Local Co-ordinate Reference:	Well Anschutz State 5-62-26-1609BH2
Company:	Bill Barrett Corp.	TVD Reference:	WELL @ 4656.00usft (Original Well Elev)
Project:	Weld Co., CO	MD Reference:	WELL @ 4656.00usft (Original Well Elev)
Site:	Sec.26-T5N-R62W	North Reference:	True
Well:	Anschutz State 5-62-26-1609BH2	Survey Calculation Method:	Minimum Curvature
Wellbore:	Wellbore #1		
Design:	Design #1		

Planned Survey									
Measured Depth (usft)	Inclination (°)	Azimuth (°)	Vertical Depth (usft)	+N/-S (usft)	+E/-W (usft)	Vertical Section (usft)	Dogleg Rate (°/100usft)	Build Rate (°/100usft)	Turn Rate (°/100usft)
6,375.00	75.91	88.37	6,173.66	419.18	56.45	68.35	12.00	12.00	0.00
6,400.00	78.91	88.37	6,179.11	419.87	80.83	92.74	12.00	12.00	0.00
6,425.00	81.91	88.37	6,183.27	420.57	105.47	117.39	12.00	12.00	0.00
6,450.00	84.91	88.37	6,186.14	421.28	130.29	142.22	12.00	12.00	0.00
6,475.00	87.91	88.37	6,187.70	421.99	155.23	167.17	12.00	12.00	0.00
Start 9733.96 hold at 6496.31 MD - 7" Csg.									
6,496.31	90.47	88.37	6,188.00	422.59	176.53	188.48	12.00	12.00	0.00
6,500.00	90.47	88.37	6,187.97	422.70	180.22	192.17	0.00	0.00	0.00
6,600.00	90.47	88.37	6,187.15	425.54	280.17	292.16	0.00	0.00	0.00
6,700.00	90.47	88.37	6,186.32	428.38	380.13	392.16	0.00	0.00	0.00
6,800.00	90.47	88.37	6,185.50	431.22	480.09	492.16	0.00	0.00	0.00
6,900.00	90.47	88.37	6,184.68	434.07	580.04	592.15	0.00	0.00	0.00
7,000.00	90.47	88.37	6,183.86	436.91	680.00	692.15	0.00	0.00	0.00
7,100.00	90.47	88.37	6,183.04	439.75	779.95	792.15	0.00	0.00	0.00
7,200.00	90.47	88.37	6,182.22	442.59	879.91	892.14	0.00	0.00	0.00
7,300.00	90.47	88.37	6,181.39	445.44	979.87	992.14	0.00	0.00	0.00
7,400.00	90.47	88.37	6,180.57	448.28	1,079.82	1,092.14	0.00	0.00	0.00
7,500.00	90.47	88.37	6,179.75	451.12	1,179.78	1,192.13	0.00	0.00	0.00
7,600.00	90.47	88.37	6,178.93	453.96	1,279.74	1,292.13	0.00	0.00	0.00
7,700.00	90.47	88.37	6,178.11	456.80	1,379.69	1,392.13	0.00	0.00	0.00
7,800.00	90.47	88.37	6,177.28	459.65	1,479.65	1,492.12	0.00	0.00	0.00
7,900.00	90.47	88.37	6,176.46	462.49	1,579.60	1,592.12	0.00	0.00	0.00
8,000.00	90.47	88.37	6,175.64	465.33	1,679.56	1,692.12	0.00	0.00	0.00
8,100.00	90.47	88.37	6,174.82	468.17	1,779.52	1,792.11	0.00	0.00	0.00
8,200.00	90.47	88.37	6,174.00	471.02	1,879.47	1,892.11	0.00	0.00	0.00
8,300.00	90.47	88.37	6,173.17	473.86	1,979.43	1,992.11	0.00	0.00	0.00
8,400.00	90.47	88.37	6,172.35	476.70	2,079.39	2,092.10	0.00	0.00	0.00
8,500.00	90.47	88.37	6,171.53	479.54	2,179.34	2,192.10	0.00	0.00	0.00
8,600.00	90.47	88.37	6,170.71	482.38	2,279.30	2,292.10	0.00	0.00	0.00
8,700.00	90.47	88.37	6,169.89	485.23	2,379.25	2,392.09	0.00	0.00	0.00
8,800.00	90.47	88.37	6,169.07	488.07	2,479.21	2,492.09	0.00	0.00	0.00
8,900.00	90.47	88.37	6,168.24	490.91	2,579.17	2,592.09	0.00	0.00	0.00
9,000.00	90.47	88.37	6,167.42	493.75	2,679.12	2,692.08	0.00	0.00	0.00
9,100.00	90.47	88.37	6,166.60	496.60	2,779.08	2,792.08	0.00	0.00	0.00
9,200.00	90.47	88.37	6,165.78	499.44	2,879.04	2,892.08	0.00	0.00	0.00
9,300.00	90.47	88.37	6,164.96	502.28	2,978.99	2,992.07	0.00	0.00	0.00
9,400.00	90.47	88.37	6,164.13	505.12	3,078.95	3,092.07	0.00	0.00	0.00
9,500.00	90.47	88.37	6,163.31	507.96	3,178.90	3,192.07	0.00	0.00	0.00
9,600.00	90.47	88.37	6,162.49	510.81	3,278.86	3,292.06	0.00	0.00	0.00
9,700.00	90.47	88.37	6,161.67	513.65	3,378.82	3,392.06	0.00	0.00	0.00
9,800.00	90.47	88.37	6,160.85	516.49	3,478.77	3,492.06	0.00	0.00	0.00
9,900.00	90.47	88.37	6,160.02	519.33	3,578.73	3,592.05	0.00	0.00	0.00
10,000.00	90.47	88.37	6,159.20	522.18	3,678.69	3,692.05	0.00	0.00	0.00
10,100.00	90.47	88.37	6,158.38	525.02	3,778.64	3,792.05	0.00	0.00	0.00
10,200.00	90.47	88.37	6,157.56	527.86	3,878.60	3,892.04	0.00	0.00	0.00
10,300.00	90.47	88.37	6,156.74	530.70	3,978.55	3,992.04	0.00	0.00	0.00
10,400.00	90.47	88.37	6,155.92	533.54	4,078.51	4,092.04	0.00	0.00	0.00
10,500.00	90.47	88.37	6,155.09	536.39	4,178.47	4,192.03	0.00	0.00	0.00
10,600.00	90.47	88.37	6,154.27	539.23	4,278.42	4,292.03	0.00	0.00	0.00
10,700.00	90.47	88.37	6,153.45	542.07	4,378.38	4,392.03	0.00	0.00	0.00
10,800.00	90.47	88.37	6,152.63	544.91	4,478.33	4,492.02	0.00	0.00	0.00
10,900.00	90.47	88.37	6,151.81	547.76	4,578.29	4,592.02	0.00	0.00	0.00
11,000.00	90.47	88.37	6,150.98	550.60	4,678.25	4,692.02	0.00	0.00	0.00

Database:	EDMDBBW	Local Co-ordinate Reference:	Well Anschutz State 5-62-26-1609BH2
Company:	Bill Barrett Corp.	TVD Reference:	WELL @ 4656.00usft (Original Well Elev)
Project:	Weld Co., CO	MD Reference:	WELL @ 4656.00usft (Original Well Elev)
Site:	Sec.26-T5N-R62W	North Reference:	True
Well:	Anschutz State 5-62-26-1609BH2	Survey Calculation Method:	Minimum Curvature
Wellbore:	Wellbore #1		
Design:	Design #1		

Planned Survey										
Measured Depth (usft)	Inclination (°)	Azimuth (°)	Vertical Depth (usft)	+N/-S (usft)	+E/-W (usft)	Vertical Section (usft)	Dogleg Rate (°/100usft)	Build Rate (°/100usft)	Turn Rate (°/100usft)	
11,100.00	90.47	88.37	6,150.16	553.44	4,778.20	4,792.01	0.00	0.00	0.00	
11,200.00	90.47	88.37	6,149.34	556.28	4,878.16	4,892.01	0.00	0.00	0.00	
11,300.00	90.47	88.37	6,148.52	559.13	4,978.12	4,992.01	0.00	0.00	0.00	
11,400.00	90.47	88.37	6,147.70	561.97	5,078.07	5,092.00	0.00	0.00	0.00	
11,500.00	90.47	88.37	6,146.88	564.81	5,178.03	5,192.00	0.00	0.00	0.00	
11,600.00	90.47	88.37	6,146.05	567.65	5,277.98	5,292.00	0.00	0.00	0.00	
11,700.00	90.47	88.37	6,145.23	570.49	5,377.94	5,391.99	0.00	0.00	0.00	
11,800.00	90.47	88.37	6,144.41	573.34	5,477.90	5,491.99	0.00	0.00	0.00	
11,900.00	90.47	88.37	6,143.59	576.18	5,577.85	5,591.99	0.00	0.00	0.00	
12,000.00	90.47	88.37	6,142.77	579.02	5,677.81	5,691.98	0.00	0.00	0.00	
12,100.00	90.47	88.37	6,141.94	581.86	5,777.77	5,791.98	0.00	0.00	0.00	
12,200.00	90.47	88.37	6,141.12	584.71	5,877.72	5,891.98	0.00	0.00	0.00	
12,300.00	90.47	88.37	6,140.30	587.55	5,977.68	5,991.97	0.00	0.00	0.00	
12,400.00	90.47	88.37	6,139.48	590.39	6,077.63	6,091.97	0.00	0.00	0.00	
12,500.00	90.47	88.37	6,138.66	593.23	6,177.59	6,191.97	0.00	0.00	0.00	
12,600.00	90.47	88.37	6,137.83	596.07	6,277.55	6,291.96	0.00	0.00	0.00	
12,700.00	90.47	88.37	6,137.01	598.92	6,377.50	6,391.96	0.00	0.00	0.00	
12,800.00	90.47	88.37	6,136.19	601.76	6,477.46	6,491.96	0.00	0.00	0.00	
12,900.00	90.47	88.37	6,135.37	604.60	6,577.42	6,591.95	0.00	0.00	0.00	
13,000.00	90.47	88.37	6,134.55	607.44	6,677.37	6,691.95	0.00	0.00	0.00	
13,100.00	90.47	88.37	6,133.73	610.29	6,777.33	6,791.95	0.00	0.00	0.00	
13,200.00	90.47	88.37	6,132.90	613.13	6,877.28	6,891.94	0.00	0.00	0.00	
13,300.00	90.47	88.37	6,132.08	615.97	6,977.24	6,991.94	0.00	0.00	0.00	
13,400.00	90.47	88.37	6,131.26	618.81	7,077.20	7,091.94	0.00	0.00	0.00	
13,500.00	90.47	88.37	6,130.44	621.65	7,177.15	7,191.93	0.00	0.00	0.00	
13,600.00	90.47	88.37	6,129.62	624.50	7,277.11	7,291.93	0.00	0.00	0.00	
13,700.00	90.47	88.37	6,128.79	627.34	7,377.07	7,391.92	0.00	0.00	0.00	
13,800.00	90.47	88.37	6,127.97	630.18	7,477.02	7,491.92	0.00	0.00	0.00	
13,900.00	90.47	88.37	6,127.15	633.02	7,576.98	7,591.92	0.00	0.00	0.00	
14,000.00	90.47	88.37	6,126.33	635.87	7,676.93	7,691.91	0.00	0.00	0.00	
14,100.00	90.47	88.37	6,125.51	638.71	7,776.89	7,791.91	0.00	0.00	0.00	
14,200.00	90.47	88.37	6,124.68	641.55	7,876.85	7,891.91	0.00	0.00	0.00	
14,300.00	90.47	88.37	6,123.86	644.39	7,976.80	7,991.90	0.00	0.00	0.00	
14,400.00	90.47	88.37	6,123.04	647.23	8,076.76	8,091.90	0.00	0.00	0.00	
14,500.00	90.47	88.37	6,122.22	650.08	8,176.72	8,191.90	0.00	0.00	0.00	
14,600.00	90.47	88.37	6,121.40	652.92	8,276.67	8,291.89	0.00	0.00	0.00	
14,700.00	90.47	88.37	6,120.58	655.76	8,376.63	8,391.89	0.00	0.00	0.00	
14,800.00	90.47	88.37	6,119.75	658.60	8,476.58	8,491.89	0.00	0.00	0.00	
14,900.00	90.47	88.37	6,118.93	661.45	8,576.54	8,591.88	0.00	0.00	0.00	
15,000.00	90.47	88.37	6,118.11	664.29	8,676.50	8,691.88	0.00	0.00	0.00	
15,100.00	90.47	88.37	6,117.29	667.13	8,776.45	8,791.88	0.00	0.00	0.00	
15,200.00	90.47	88.37	6,116.47	669.97	8,876.41	8,891.87	0.00	0.00	0.00	
15,300.00	90.47	88.37	6,115.64	672.81	8,976.36	8,991.87	0.00	0.00	0.00	
15,400.00	90.47	88.37	6,114.82	675.66	9,076.32	9,091.87	0.00	0.00	0.00	
15,500.00	90.47	88.37	6,114.00	678.50	9,176.28	9,191.86	0.00	0.00	0.00	
15,600.00	90.47	88.37	6,113.18	681.34	9,276.23	9,291.86	0.00	0.00	0.00	
15,700.00	90.47	88.37	6,112.36	684.18	9,376.19	9,391.86	0.00	0.00	0.00	
15,800.00	90.47	88.37	6,111.53	687.03	9,476.15	9,491.85	0.00	0.00	0.00	
15,900.00	90.47	88.37	6,110.71	689.87	9,576.10	9,591.85	0.00	0.00	0.00	
16,000.00	90.47	88.37	6,109.89	692.71	9,676.06	9,691.85	0.00	0.00	0.00	
16,100.00	90.47	88.37	6,109.07	695.55	9,776.01	9,791.84	0.00	0.00	0.00	
16,200.00	90.47	88.37	6,108.25	698.39	9,875.97	9,891.84	0.00	0.00	0.00	
TD at 16230.26										
16,230.26	90.47	88.37	6,108.00	699.25	9,906.22	9,922.10	0.00	0.00	0.00	

Database:	EDMDBBW	Local Co-ordinate Reference:	Well Anschutz State 5-62-26-1609BH2
Company:	Bill Barrett Corp.	TVD Reference:	WELL @ 4656.00usft (Original Well Elev)
Project:	Weld Co., CO	MD Reference:	WELL @ 4656.00usft (Original Well Elev)
Site:	Sec.26-T5N-R62W	North Reference:	True
Well:	Anschutz State 5-62-26-1609BH2	Survey Calculation Method:	Minimum Curvature
Wellbore:	Wellbore #1		
Design:	Design #1		

Planned Survey									
Measured Depth (usft)	Inclination (°)	Azimuth (°)	Vertical Depth (usft)	+N/-S (usft)	+E/-W (usft)	Vertical Section (usft)	Dogleg Rate (°/100usft)	Build Rate (°/100usft)	Turn Rate (°/100usft)

Design Targets									
Target Name	Dip Angle (°)	Dip Dir. (°)	TVD (usft)	+N/-S (usft)	+E/-W (usft)	Northing (usft)	Easting (usft)	Latitude	Longitude
- hit/miss target									
- Shape									
Anschutz State 5-62-26-	0.00	0.00	6,108.00	699.25	9,906.22	1,382,216.419	3,344,502.777	40° 22' 33.571 N	104° 15' 48.420 W
- plan hits target center									
- Point									

Casing Points					
Measured Depth (usft)	Vertical Depth (usft)	Name	Casing Diameter (")	Hole Diameter (")	
6,496.31	6,188.00	7" Csg.	7	8-3/4	

Formations						
Measured Depth (usft)	Vertical Depth (usft)	Name	Lithology	Dip (°)	Dip Direction (°)	
4,044.75	4,019.00	Sussex		-0.47	88.37	
4,859.98	4,827.00	Shannon		-0.47	88.37	
6,003.48	5,957.00	Sharon Springs		-0.47	88.37	
6,143.47	6,065.00	Niobrara		-0.47	88.37	
6,213.12	6,108.00	A Chalk		-0.47	88.37	
6,235.37	6,120.00	B Marl		-0.47	88.37	
6,345.73	6,166.00	Top B2 Target		-0.47	88.37	

Plan Annotations					
Measured Depth (usft)	Vertical Depth (usft)	Local Coordinates		Comment	
		+N/-S (usft)	+E/-W (usft)		
900.00	900.00	0.00	0.00	Start Build 2.00	
1,268.59	1,267.57	18.99	-14.15	Start 3605.19 hold at 1268.59 MD	
4,873.78	4,842.97	389.92	-290.52	Start Drop -2.00	
5,242.37	5,210.54	408.91	-304.67	Start 500.01 hold at 5242.37 MD	
5,742.38	5,710.55	408.91	-304.67	Start Build 12.00	
6,496.31	6,188.00	422.59	176.52	Start 9733.96 hold at 6496.31 MD	
16,230.26	6,108.00	699.25	9,906.22	TD at 16230.26	