

PHOTO: VIEW FROM CORNER #5 TO LOCATION STAKE

CAMERA ANGLE: NORTHERLY

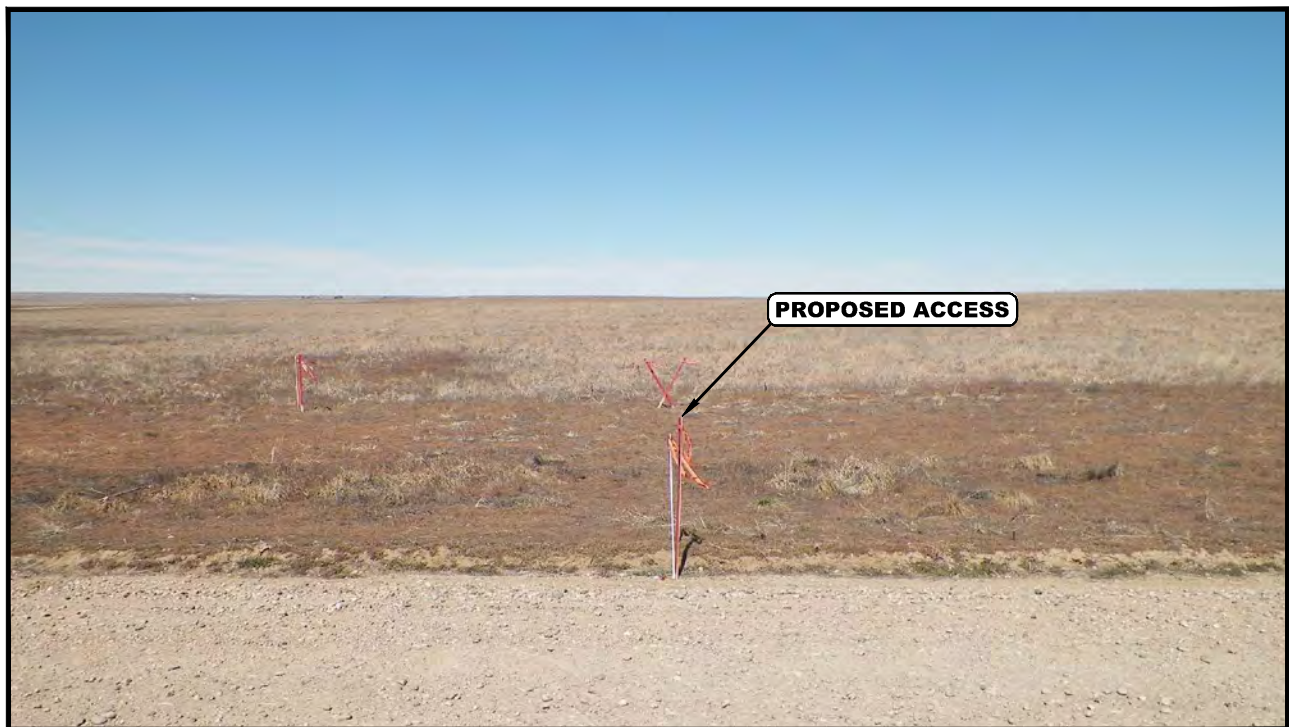

PHOTO: VIEW FROM BEGINNING OF PROPOSED ACCESS

CAMERA ANGLE: NORTHERLY

BILL BARRETT CORPORATION

CB RUDD 6-61-18 19 SW7 PAD
 #6-61-18-0263BH2
 LOT 4, SECTION 7, T6N, R61W, 6th P.M.
 250' FSL 770' FWL



UELS, LLC
 Corporate Office * 85 South 200 East
 Vernal, UT 84078 * (435) 789-1017

DRAWN BY: T.W.	DATE DRAWN: 07-14-14
TAKEN BY: G.W.	REVISED: 00-00-00
LOCATION PHOTOS	PHOTO 1



PHOTO: VIEW OF LOCATION STAKE

CAMERA ANGLE: NORTHERLY



PHOTO: VIEW OF LOCATION STAKE

CAMERA ANGLE: EASTERLY

BILL BARRETT CORPORATION

CB RUDD 6-61-18 19 SW7 PAD
 #6-61-18-0263BH2
 LOT 4, SECTION 7, T6N, R61W, 6th P.M.
 250' FSL 770' FWL



UELS, LLC
 Corporate Office * 85 South 200 East
 Vernal, UT 84078 * (435) 789-1017

DRAWN BY: T.W.	DATE DRAWN: 07-14-14
TAKEN BY: G.W.	REVISED: 00-00-00
LOCATION PHOTOS	PHOTO 2



PHOTO: VIEW OF LOCATION STAKE

CAMERA ANGLE: SOUTHERLY



PHOTO: VIEW OF LOCATION STAKE

CAMERA ANGLE: WESTERLY

BILL BARRETT CORPORATION

CB RUDD 6-61-18 19 SW7 PAD
 #6-61-18-0263BH2
 LOT 4, SECTION 7, T6N, R61W, 6th P.M.
 250' FSL 770' FWL



UELS, LLC
 Corporate Office * 85 South 200 East
 Vernal, UT 84078 * (435) 789-1017

DRAWN BY: T.W.	DATE DRAWN: 07-14-14
TAKEN BY: G.W.	REVISED: 00-00-00
LOCATION PHOTOS	PHOTO 3