

# MULL DRILLING COMPANY

## CHAMPLIN ALDRICH A #7

### Sampling Locations Selection Results Baseline Groundwater Sampling Rule 609

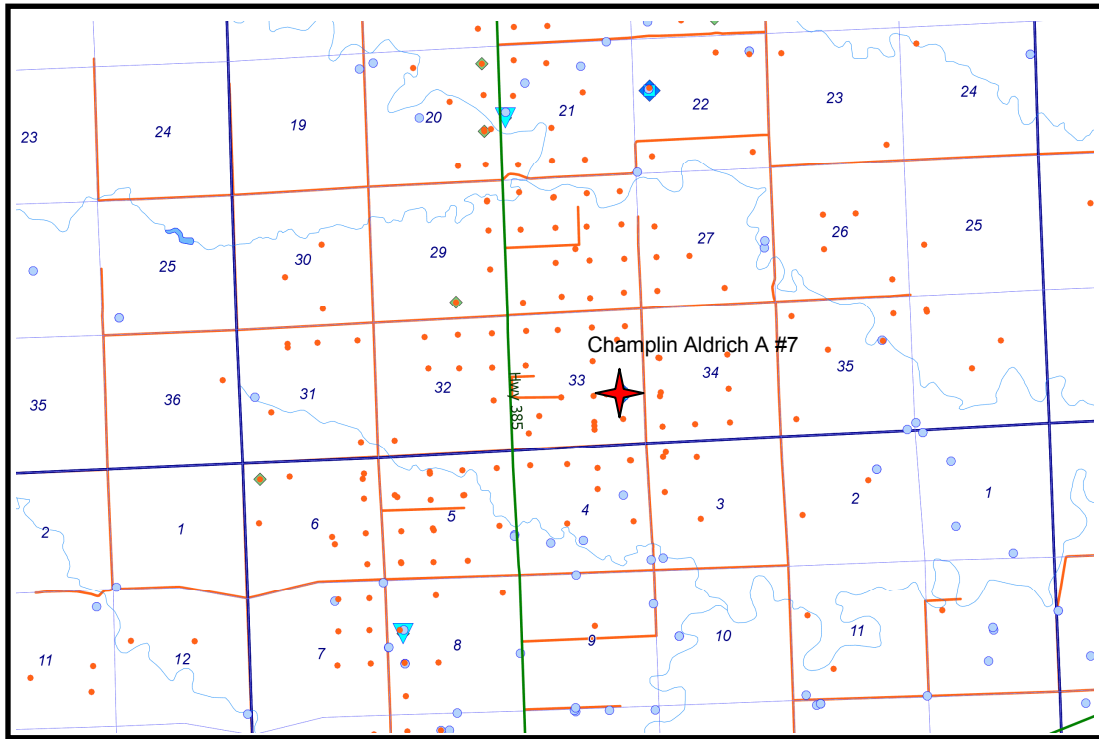

July 8, 2014

*Criteria: Groundwater samples will be collected from all available water sources up to a maximum of four (4) within a ½ mile radius of the proposed well.*

### **Champlin Aldrich A #7 - ½ Mile Radius Zone**

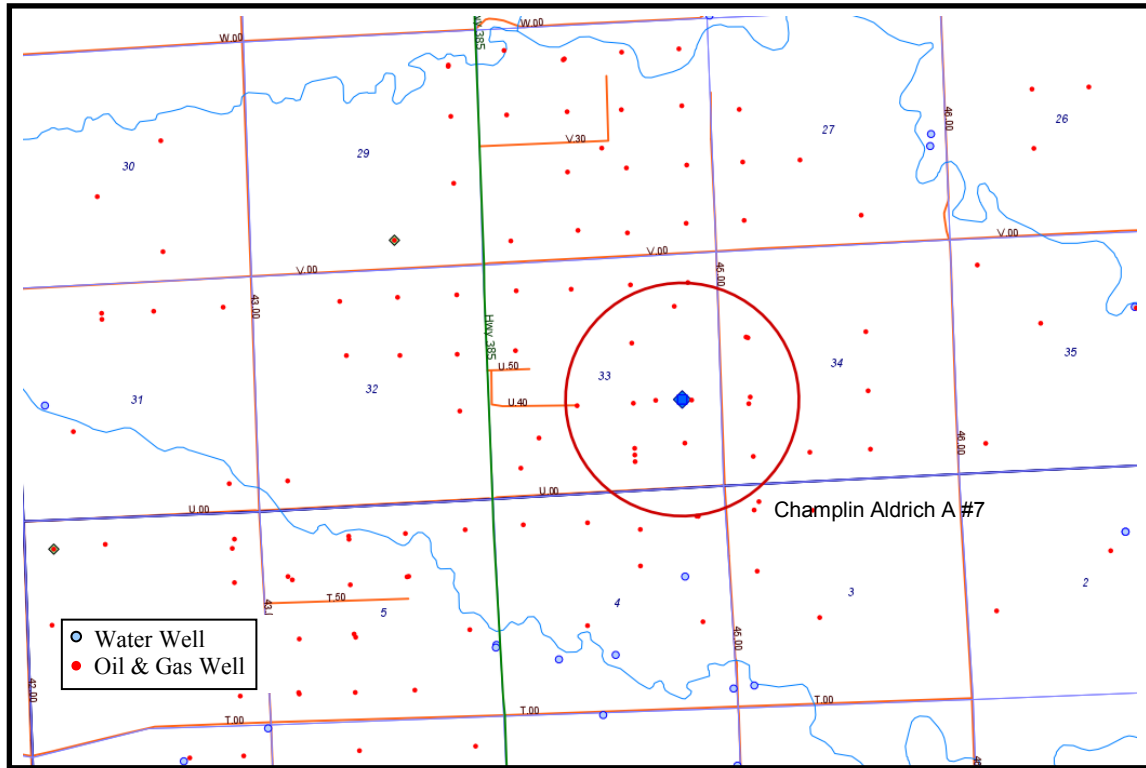

There are no available water sources located within one-half (½) mile of the proposed the well location.

✓ This proposed well site does not meet the criteria for baseline samples and subsequent monitoring under the requirements of Rule 609.

Results Search:

COGCC Mapping Tool Search Criteria

*Oil & Gas Facilities: Wells, Well Names, Well Status*

*COGCC Data: Oil & Gas Locations (2A, Locations)*

*Roads & Railroads: Highways, Local Roads*

*Water Resources: DWR Wells, Lakes, Rivers-Streams*

*DWR Database Well Details*

*\*Seeps and Springs are not an option for this basin*

DNR Mapping Tool AquaMap Search Criteria:

*None*