

# MEAD 9-E PRODUCTION FACILITY LAYOUT

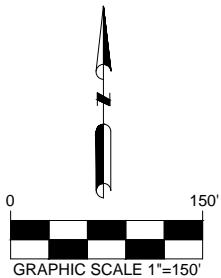
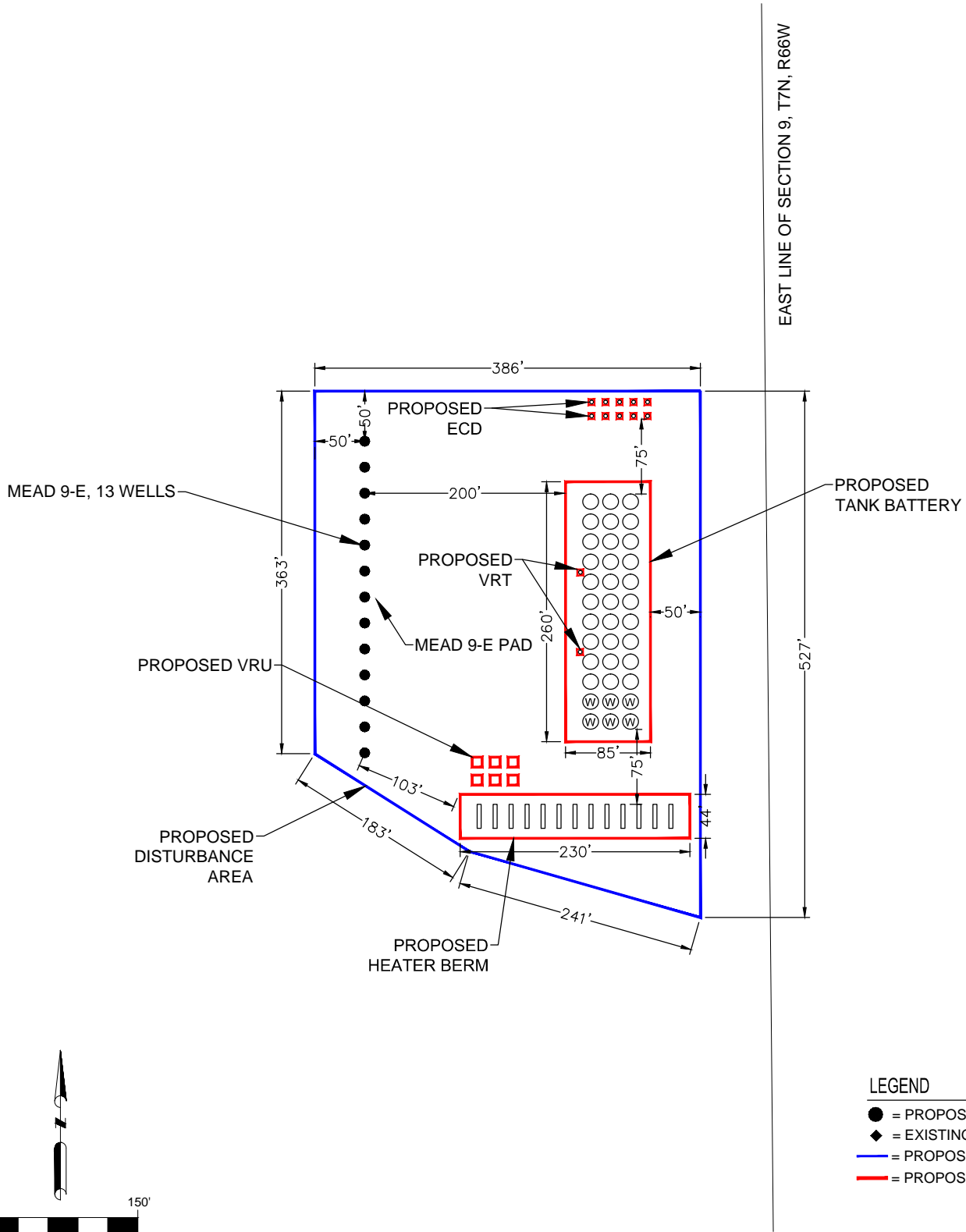

## LEGEND

- = PROPOSED WELL
- ◆ = EXISTING WELL
- = PROPOSED DA
- = PROPOSED FACILITIES

PREPARED BY:



FIELD DATE:  
05-23-14

DRAWING DATE:  
06-27-14

BY:  
TJR

CHECKED BY:  
MLP

SITE NAME:  
MEAD 9-E

SURFACE LOCATION:  
SE 1/4, NE 1/4, SEC. 9, T7N, R66W, 6TH P.M.  
WELD COUNTY, COLORADO

PREPARED FOR:

EXTRACTION  
OIL & GAS