

Physical Address: 345 Comanche St.
Mail to: Box 384, Kiowa, CO 80117
Ph. 303-621-8672 - Fax 303-621-7749
www.highprairiesurvey.com

Job # 14240 Stegas 23-15 #1 (Re-Entry)

Inv # 3319

High Prairie Surveying of Kiowa, Colorado, in accordance with a request from **Pronghorn Operating LLC**, has determined the location of **Stegas 23-15 #1 (Re-Entry)** to be **1980 feet FSL**, and **1993 feet FWL**, (90° off Section lines) of **SECTION 15**, Township **11s**, Range **53w** of the 6th Principal Meridian, **Lincoln County**, Colorado.

Date: Staked on 07/17/14 drawn on 07/23/14

Re: Staked by Elijah Frane

Drawn: Drawn by Dustin Coffer

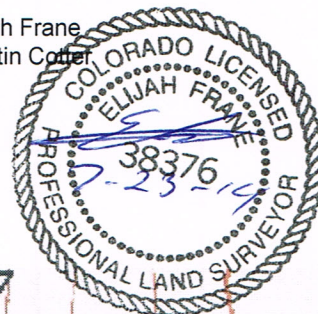

Reference Area

