



August 4, 2014

Mr. Matt Lepore, Director
Colorado Oil and Gas Conservation Commission
1120 Lincoln Street, Suite 801
Denver, Colorado 80203

7535 Hilltop Circle
Denver, CO 80221
www.petro-fs.com

**RE: COGCC Rule 318A.e.: Proposed Wellbore Spacing Unit
Thornton 6 Well: NWSW, Section 8, Township 7 North, Range 66 West
Weld County, Colorado**

Dear Mr. Lepore:

Extraction Oil and Gas, LLC (Extraction) is planning to drill the above referenced well in accordance with the provisions set out in COGCC Rule 318A.e. Extraction's proposed wellbore spacing unit consists of:

S½ of Section 8 and Section 9, Township 7 North, Range 66 West
Containing 640 acres more or less

Extraction is not the only owner within the proposed wellbore spacing unit and has provided notice to the remaining owners within this spacing unit, as required by COGCC Rule 318A.e.(6). Copies of the required notification letters are on file at Extraction's office. The required thirty (30) day notice period has elapsed absent the receipt by Extraction of any objection to their proposal by the owners within the proposed spacing unit for the subject well.

Enclosed is the Proposed Spacing Unit Plat to assist in your review and approval of Extraction's proposed Application for Permit to Drill (APD) for the Thornton 6 Well. Many thanks for your attention to this matter.

Respectfully,

Jeff Annable
Regulatory Technician
Agent for Extraction Oil and Gas, LLC

:ja

Enclosure: Proposed Spacing Unit Plat

We are what we repeatedly do. Excellence, then, is not an act, but a habit.

-Aristotle

PROPOSED 318A.e. WELLBORE SPACING UNIT

SECTION 8 & 9, TOWNSHIP 7 NORTH, RANGE 66 WEST, 6TH P.M.

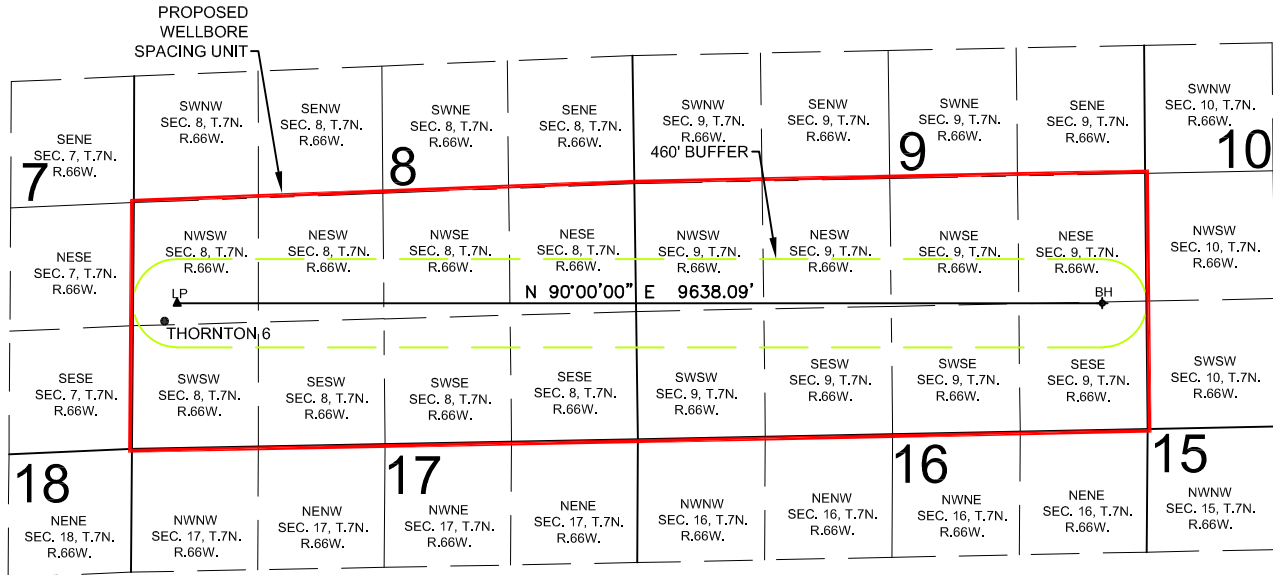

WELL **THORNTON 6** TO BE LOCATED 1325' FSL AND 330' FWL, SEC. 8, T7N, R66W

SURFACE LOCATION

NAD83

LATITUDE= 40.585794°

LONGITUDE= 104.810368°

LANDING POINT LOCATION

NAD83

LATITUDE= 40.586304°

LONGITUDE= 104.809892°

BOTTOM HOLE LOCATION

NAD83

LATITUDE= 40.586093°

LONGITUDE= 104.775191°

LEGEND

- = PROPOSED WELL
- ▲ = LANDING POINT
- ◆ = BOTTOM HOLE
- LP = LANDING POINT
- BH = BOTTOM HOLE

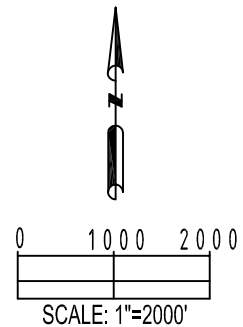

PREPARED BY: PFS Petroleum Field Services, LLC 7535 Hilltop Circle Denver, CO 80221	FIELD DATE: 05-02-14	SURFACE LOCATION: NW 1/4 SW 1/4, SEC. 08, T7N, R66W, 6TH P.M. WELD COUNTY, COLORADO
	DRAWING DATE: 05-21-14	
BY: DWW	CHECKED: MDC	