

LEGEND:

 **PROPOSED LOCATION**



UELS, LLC.
Corporate Office * 85 South 200 East
Vernal, UT 84078 * (435) 789-1017



BILL BARRETT CORPORATION

JENCKS 6-61-8_5 SWSW PAD #6-61-8-6203BH2,
6302BH2 & 6401BH2
SECTION 8, T6N, R61W, 6th P.M.
SW 1/4 SW 1/4

SCALE: 1:100,000

DRAWN BY: J.L.G.

DATE: 04-03-14

ACCESS ROAD MAP

TOPO A

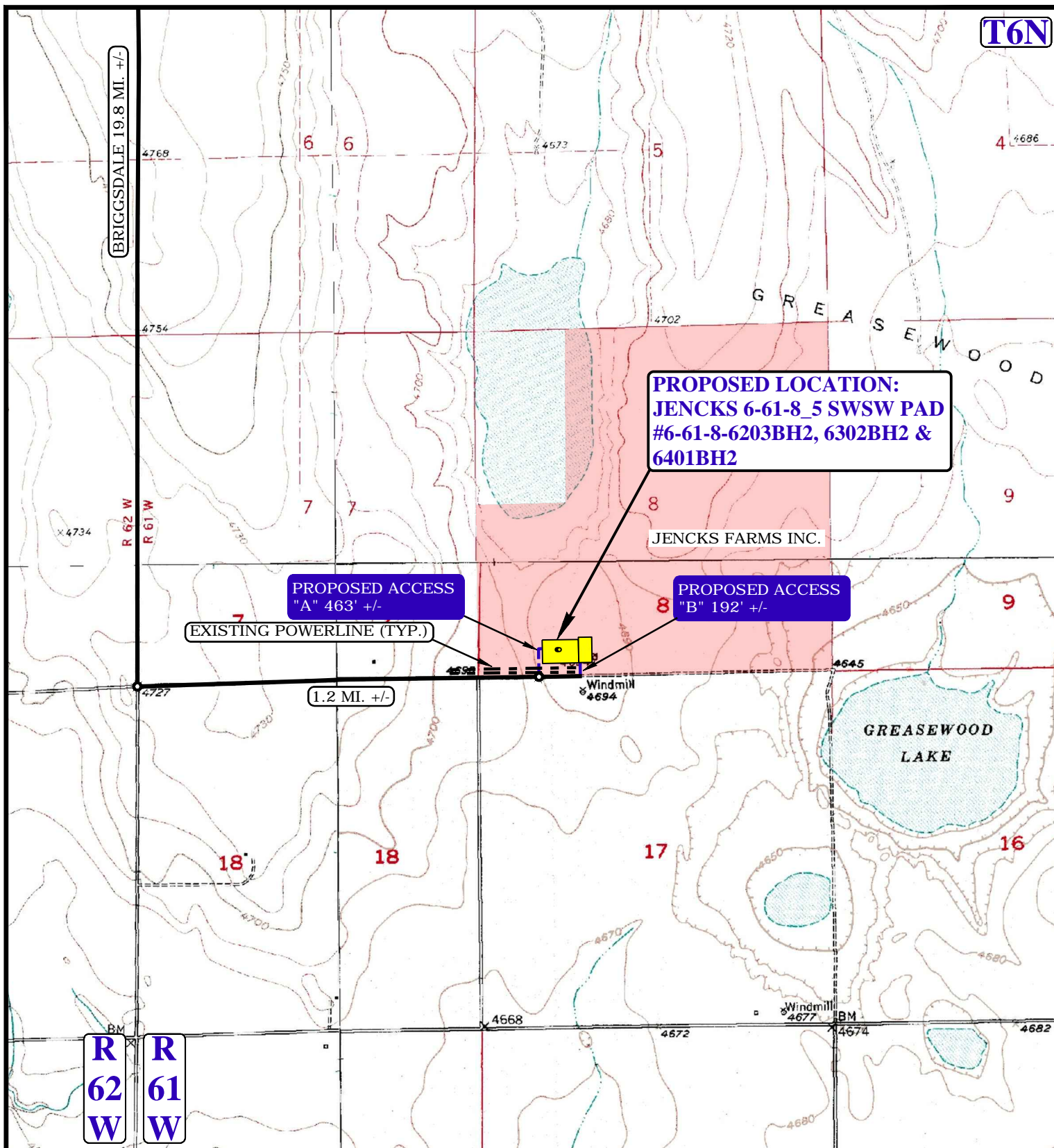

NOTE: PARCEL DATA SHOWN HAS BEEN OBTAINED FROM VARIOUS SOURCES AND SHOULD BE USED FOR MAPPING, GRAPHIC AND PLANNING PURPOSES ONLY. NO WARRANTY IS MADE BY UINTAH ENGINEERING AND LAND SURVEYING (UELS) FOR ACCURACY OF THE PARCEL DATA.

LEGEND:

- EXISTING ROAD
- - - PROPOSED ROAD
- - - EXISTING POWER LINE



UELS, LLC.
Corporate Office * 85 South 200 East
Vernal, UT 84078 * (435) 789-1017



BILL BARRETT CORPORATION

JENCKS 6-61-8_5 SWSW PAD #6-61-8-6203BH2,
6302BH2 & 6401BH2
SECTION 8, T6N, R61W, 6th P.M.
SW 1/4 SW 1/4

SCALE: 1" = 2000'

DRAWN BY: J.L.G.

DATE: 04-03-14

ACCESS ROAD MAP

TOPO B

PROCEED IN A SOUTHERLY, THEN SOUTHWESTERLY DIRECTION FROM BRIGGSDALE, COLORADO ALONG HIGHWAY 392 APPROXIMATELY 9.7 MILES TO THE JUNCTION OF THIS ROAD AND COUNTY ROAD 74 TO THE EAST; TURN LEFT AND PROCEED IN AN EASTERLY DIRECTION APPROXIMATELY 8.1 MILES TO THE JUNCTION OF THIS ROAD AND COUNTY ROAD 85 TO THE SOUTH; TURN RIGHT AND PROCEED IN A SOUTHERLY DIRECTION APPROXIMATELY 2.0 MILES TO THE JUNCTION OF THIS ROAD AND AN EXISTING ROAD TO THE EAST; TURN LEFT AND PROCEED IN AN EASTERLY DIRECTION APPROXIMATELY 1.2 MILES TO THE BEGINNING OF THE PROPOSED ACCESS TO THE NORTH; FOLLOW ROAD FLAGS IN A NORTHERLY, THEN EASTERLY DIRECTION APPROXIMATELY 463' TO THE PROPOSED LOCATION.

TOTAL DISTANCE FROM BRIGGSDALE, COLORADO TO THE EXISTING WELL LOCATION IS APPROXIMATELY 21.0 MILES.

BILL BARRETT CORPORATION

JENCKS 6-61-8_5 SWSW PAD #6-61-8-6203BH2,
6302BH2 & 6401BH2
SECTION 8, T6N, R61W, 6th P.M.
SW 1/4 SW 1/4



UELS, LLC.
Corporate Office * 85 South 200 East
Vernal, UT 84078 * (435) 789-1017

DRAWN BY: J.L.G.

DATE: 04-03-14

ROAD DESCRIPTION