

AUS-TEX EXPLORATION INC

CROSS SECTIONS PATHFINDER C18 #4

Pad Location: NENE Section 18, T20S, R69W, 6th P.M.

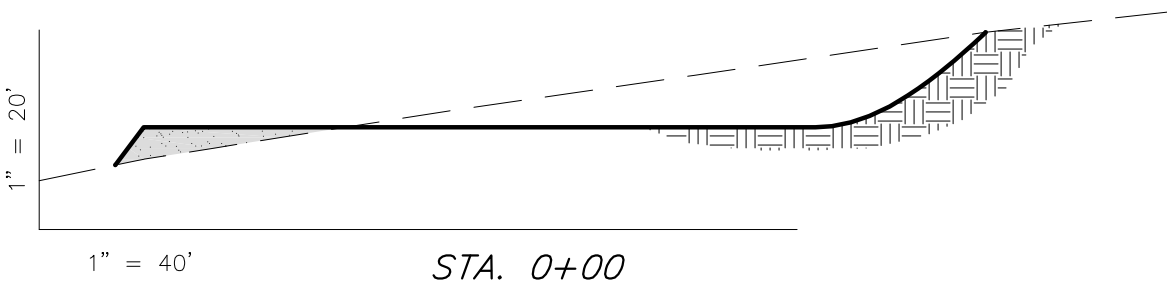
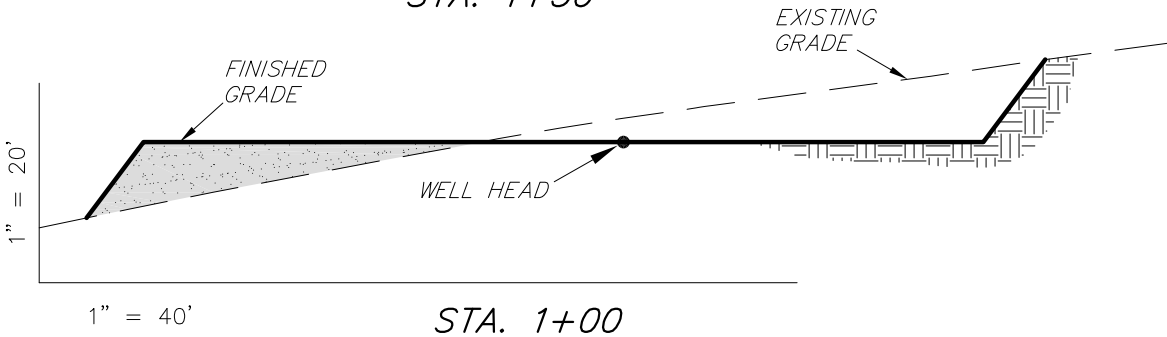
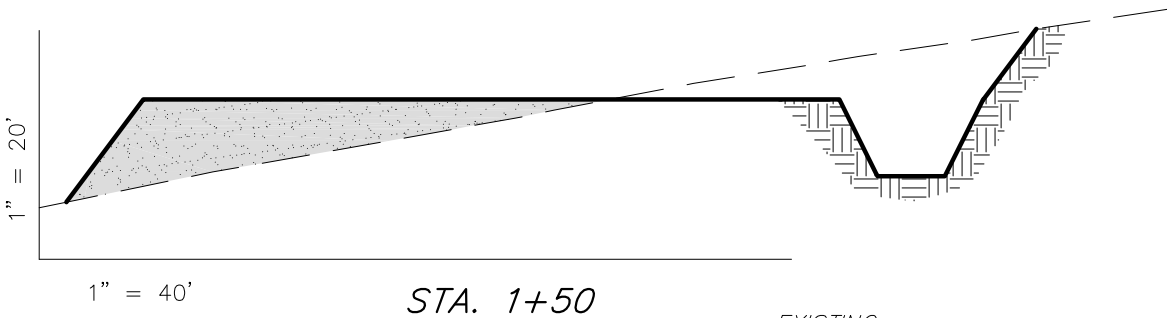
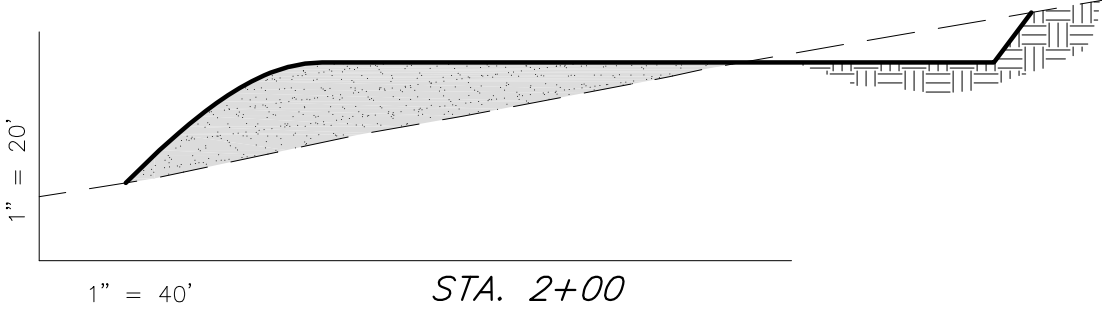

NOTE:
UNLESS OTHERWISE
NOTED ALL CUT/FILL
SLOPES ARE AT 1.5:1

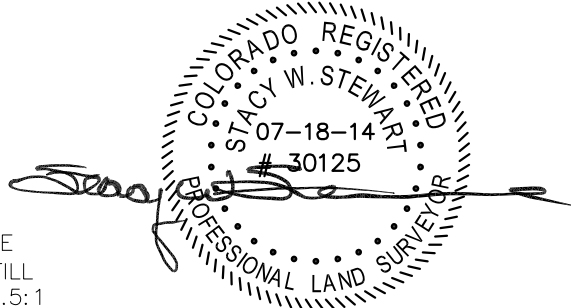

ESTIMATED EARTHWORK QUANTITIES (No Shrink or swell adjustments have been used) (Expressed in Cubic Yards)

ITEM	CUT	FILL	6" TOPSOIL	EXCESS
PAD	2,930	2,930	Topsoil is not included in Pad Cut	0
PIT	340	0		340
TOTALS	3,270	2,930	810	340

SURVEYED BY: M.P. DATE SURVEYED: 07-16-14
DRAWN BY: M.W. DATE DRAWN: 07-18-14
SCALE: 1" = 40' REVISED:

Tri State
Land Surveying, Inc.
180 NORTH VERNAL AVE. VERNAL, UTAH 84078
(435) 781-2501

SHEET
4