

GREAT WESTERN OIL & GAS COMPANY
CONSTRUCTION LAYOUT FOR
GUSTAFSON EF 31-380HN, 31-379HN, 31-378HN, 31-378HC,
31-377HN, 31-374HN, 31-373HC, 31-372HN,
GUSTAFSON 31-H, 31-I, 31-J, 31-K & 31-L
SECTION 31, T7N, R65W, 6th P.M.
LOT 1 & NE 1/4 NW 1/4

FIGURE #1

SCALE: 1" = 100'
DATE: 11-08-13
DRAWN BY: J.W.
REV: 12-03-13 H.K.W.
REV: 05-22-14 J.W.
REV: 06-05-14 J.W.

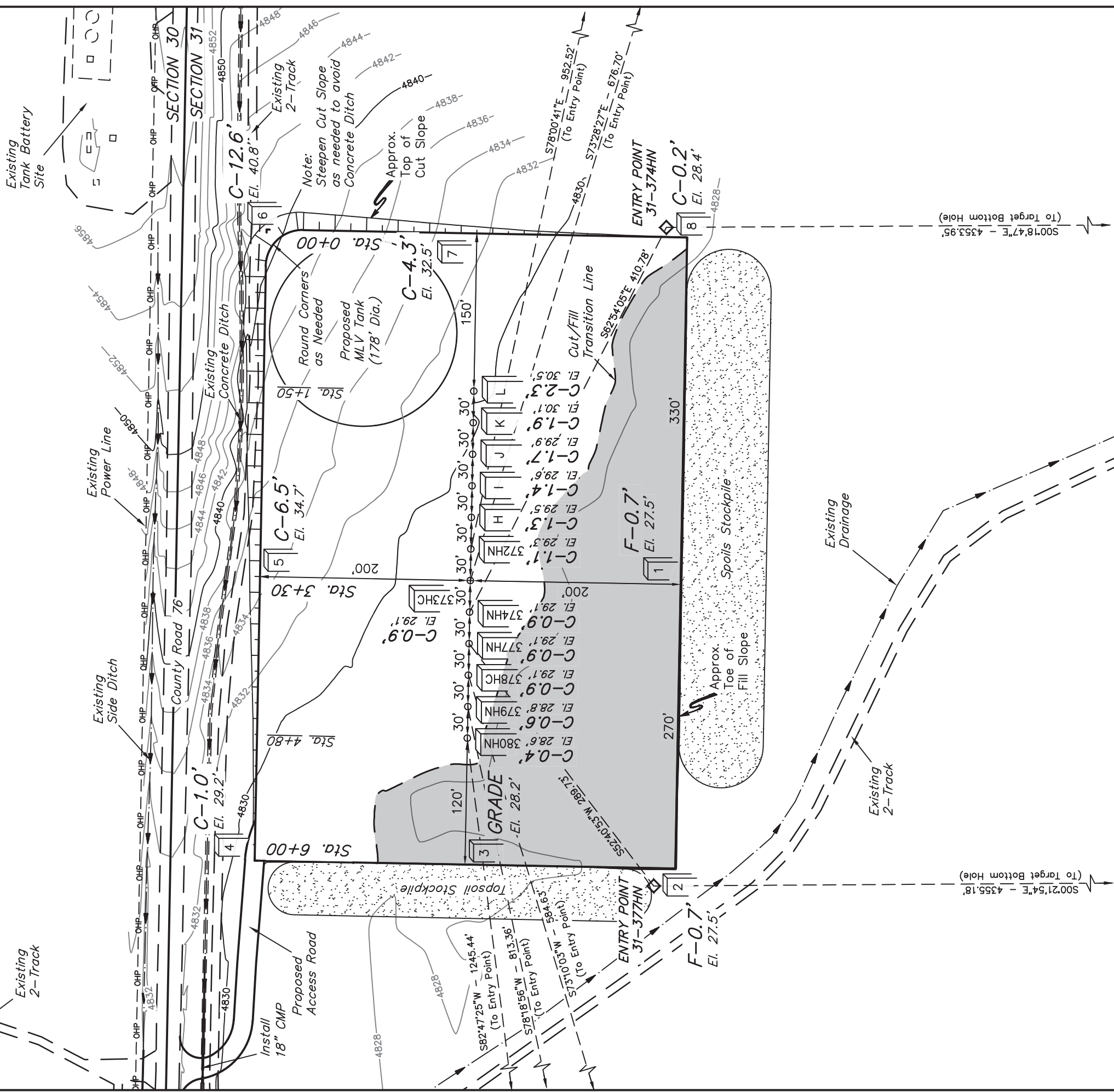

Elev. Ungraded Ground At 31-373HC Loc. Stake = 4829.1'
FINISHED GRADE ELEV. AT 31-373HC LOC. STAKE = 4828.2'

X-Section
Scale
1" = 100'
DATE: 11-08-13
DRAWN BY: J.W.
REV: 12-03-13 H.K.W.

GREAT WESTERN OIL & GAS COMPANY
CONSTRUCTION LAYOUT CROSS SECTIONS FOR
GUSTAFSON EF 31-380HN, 31-379HN, 31-378HC,
31-377HN, 31-374HN, 31-373HC, 31-372HN,
GUSTAFSON 31-H, 31-I, 31-J, 31-K & 31-L
SECTION 31, T7N, R65W, 6th P.M.
LOT 1 & NE 1/4 NW 1/4

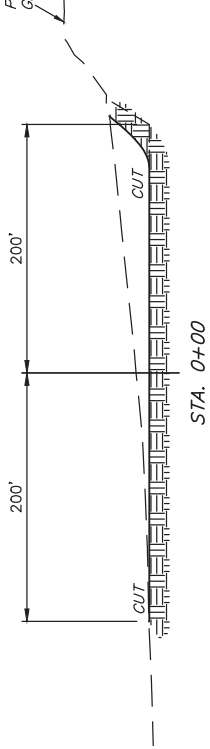
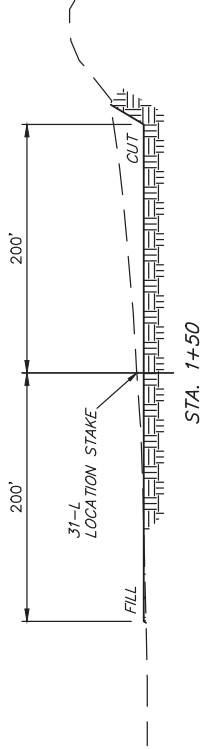
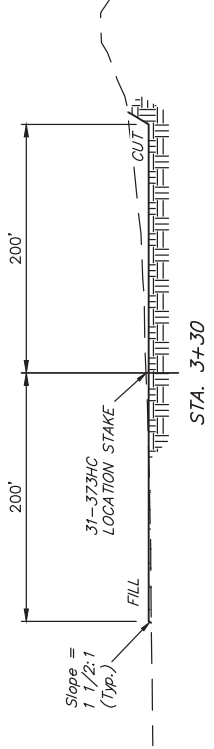
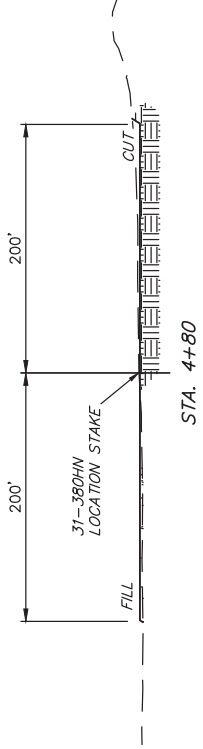
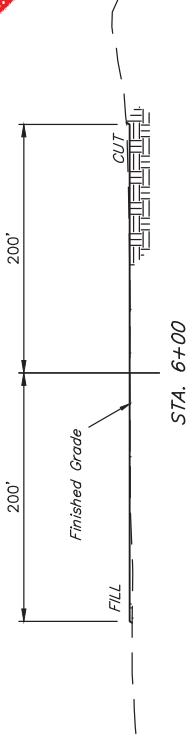

NOTE:
Topsoil should not be
Stripped Below Finished
Grade on Substructure Area.

* NOTE:
FILL QUANTITY INCLUDES
5% FOR COMPACTION

APPROXIMATE YARDAGES

(6") Topsoil Stripping = 4,640 Cu. Yds.
Remaining Location = 15,620 Cu. Yds.
TOTAL CUT = 20,260 CU. YDS.
FILL = 3,430 CU. YDS.

EXCESS MATERIAL
Topsoil = 4,640 Cu. Yds.
EXCESS UNBALANCE
(After Interim Rehabilitation) = 12,190 Cu. Yds.

APPROXIMATE ACREAGE
WELL SITE DISTURBANCE =
ACCESS ROAD DISTURBANCE =
TOTAL =

UNINTAH ENGINEERING & I
85 S. 200 East • Vernal, Utah 8407