



Physical Address: 345 Comanche St.  
Mail to: Box 384 Kiowa, CO 80117  
Ph. 303-621-8672 - Fax 303-621-7749  
www.highprairiesurvey.com

Job # 14162 SNOW KING #9-32

Inv # 3196

High Prairie Surveying of Kiowa, Colorado, in accordance with a request from **Nighthawk Production LLC**, has determined the location of **SNOW KING #9-32** to be **2540 feet FSL**, and **660 feet FEL** (90° off Section lines) of Section **32, Township 6s**, Range **54w** of the 6th Principal Meridian, **Lincoln County**, Colorado.

**Date:** Staked on 05/23/14 drawn on 05/28/14.

**Re:** Staked by Elijah Frane

**Drawn:** Drawn by Dustin Cotter

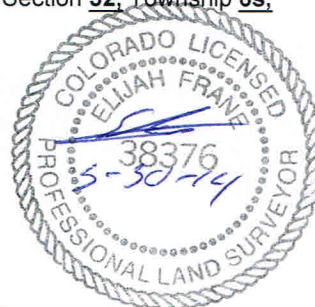

## 500' Location Drawing

There is a barb wire fence approximately 418' East of the proposed well pad and approximately 604' East of the proposed well head.

NIGHTHAWK PRODUCTION LLC  
SE 1/4 SEC. 32-6S-54W  
SNOW KING #9-32  
LINCOLN COUNTY, COLORADO

